

EXISTING VEGETATION PLAN 1of2
SCALE = 1:300

REFER TO TREE CONSERVATION REPORT FOR ADDITIONAL INFORMATION AND DETAIL ABOUT THE INVENTORY AND ASSESSMENT PROCESS

REFER TO PAGE T-3 FOR THE FOLLOWING TABLES:
- TREES TO BE PRESERVED
- TREES TO BE REMOVED

LEGEND

	EXISTING DECIDUOUS TREES TO REMAIN
	EXISTING DECIDUOUS TREES TO BE REMOVED
	EXISTING CONIFEROUS TREES TO REMAIN
	EXISTING CONIFEROUS TREES TO BE REMOVED
	CRITICAL ROOT ZONE - 10cm RADIUS PER 1cm DBH
	TREE PROTECTION BARRIER - SEE DETAIL

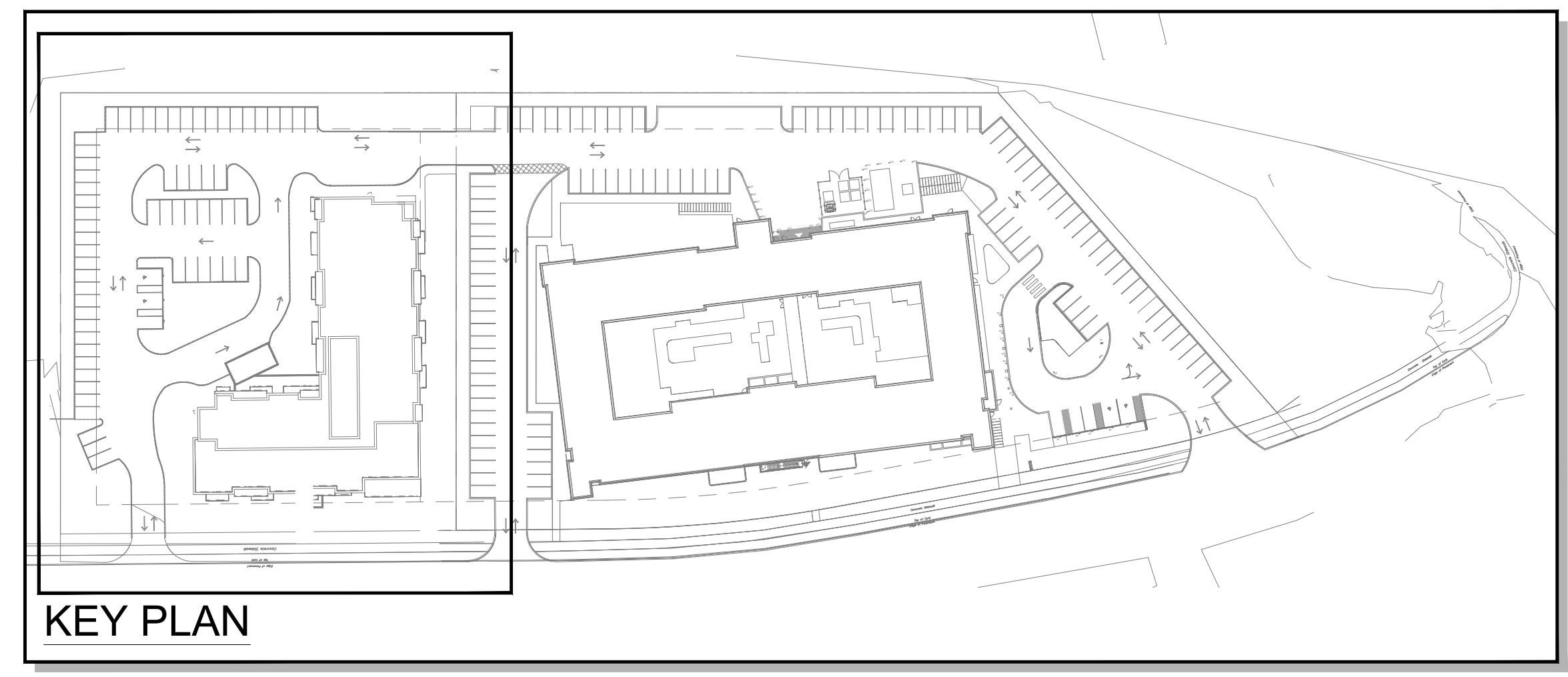

TREE PROTECTION SPECIFICATION

TO BE IMPLEMENTED FOR RETAINED TREES, BOTH ON SITE AND ON ADJACENT SITES, PRIOR TO ANY TREE REMOVAL OR SITE WORKS AND MAINTAINED FOR THE DURATION OF WORK ACTIVITIES ON SITE.

LEGEND

- 1. TREE PROTECTION FENCING MUST BE AT LEAST 1.2M IN HEIGHT, AND CONSTRUCTED OF RIGID OR FRAMED MATERIALS (E.G. MODULUS-STEEL, PLYWOOD HOARDING, OR SNOW FENCE ON A 2"x4" WOOD FRAME) WITH POSTS AND RAILS, SUCH THAT THE FENCE LOCATION CANNOT BE ALTERED. ALL SUPPORTS AND BRACING MUST BE PLACED OUTSIDE OF THE CRZ, AND INSTALLATION MUST MINIMIZE DAMAGE TO EXISTING ROOTS. (SEE DETAIL)
- 2. THE LOCATION OF THE TREE PROTECTION FENCING MUST BE DETERMINED BY AN ARBORIST AND DETAILED ON ANY ASSOCIATED PLANS FOR THE SITE (E.G. TREE CONSERVATION REPORT, TREE INFORMATION REPORT, ETC.). THE PLAN AND CONSTRUCTED FENCING MUST BE APPROVED BY CITY FORESTRY STAFF PRIOR TO THE COMMENCEMENT OF WORK.
- 3. IF THE FENCED TREE PROTECTION AREA MUST BE REDUCED TO FACILITATE CONSTRUCTION, MITIGATION MEASURES MUST BE PRESCRIBED BY AN ARBORIST AND APPROVED BY CITY FORESTRY STAFF. THESE MAY INCLUDE THE PLACEMENT OF PLYWOOD, WOOD CHIPS, OR STEEL PLATING OVER THE ROOTS FOR PROTECTION OR THE PROPER PRUNING AND CARE OF ROOTS WHERE ENCOUNTERED.
- 4. THE CITY'S TREE PROTECTION BY-LAW, 2010-240 PROTECTS BOTH CITY-OWNED TREES, CITY-HIRE, AND PRIVATELY OWNED TREES WITHIN THE URBAN AREA. PLEASE REFER TO WWW.OTTAWA.CA/TREESPLAN FOR MORE INFORMATION ON HOW THE TREE BY-LAW APPLIES.

ACCESSIBLE FORMATS AND COMMUNICATION SUPPORTS ARE AVAILABLE UPON REQUEST

Tree Protection Specification

SCALE: NTS
DATE: MARCH 2021
DRAWING NO.: 1 of 1



ALL DRAWINGS REMAIN THE PROPERTY OF THE LANDSCAPE ARCHITECT AND SHALL NOT BE REPRODUCED OR REUSED WITHOUT THE LANDSCAPE ARCHITECTS WRITTEN PERMISSION.
THIS DRAWING SHALL NOT BE USED FOR CONSTRUCTION OR TENDER PURPOSES UNLESS SIGNED AND DATED BY RONALD H. KOUDYS, O.A.L.A. C.S.L.A. LANDSCAPE ARCHITECT, LONDON, ONTARIO (519) 687-3322.

Ronald H. Koudys, O.A.L.A. C.S.L.A. DATE



#	date	revision	by
12.	MAR.10.2023	RE-ISSUED FOR SITE PLAN CONTROL APPLICATION	MCB
11.	JAN.27.2023	RE-ISSUED FOR SITE PLAN CONTROL APPLICATION & ZONING BY-LAW AMENDMENT	MCB
10.	DEC.16.2022	RE-ISSUED FOR MULTICITY WORKING DRAWINGS	MCB
9.	AUG.19.2022	ISSUED FOR SITE PLAN CONTROL APPLICATION	MCB
8.	AUG.19.2022	ISSUED FOR ZONING BY-LAW AMENDMENT	MCB
7.	JUL.29.2022	ISSUED FOR ZONING BY-LAW AMENDMENT	MCB
6.	FEB.24.2022	ISSUED FOR ZONING BY-LAW AMENDMENT	MCB
5.	DEC.02.2021	ISSUED FOR SPA & ZONING BY-LAW AMENDMENT	MCB
4.	NOV.19.2021	ISSUED FOR 100% DD	MCB
3.	NOV.19.2021	ISSUED FOR 25% SPA	MCB
2.	OCT.22.2021	ISSUED FOR 50% DD	MCB
1.	AUG.26.2021	ISSUED FOR 100% SD	MCB

All drawing and specifications are the property of the architect. The contractor shall verify all dimensions and information on site and report any discrepancy to architect before proceeding.

Arch Corp - Orleans
375 Famille-Laporte Avenue (formerly 1161 OLD MONTREAL RD.), ORLEANS ON, K4A 3N6

TREE PRESERVATION PLAN 1of5

scale: AS NOTED
drawn by: MCB
reviewed by: MCB
job number: 21-164Lq
plot date: 23-03-10
drawing number:

T-1