

THIS PLAN IS ISSUED FOR SITE PLAN CONTROL ONLY. ADDITIONAL DETAILING AND SPECIFICATIONS ARE REQUIRED PRIOR TO TENDERING AND CONSTRUCTION.

PLAN TO BE READ IN CONJUNCTION WITH TREE CONSERVATION REPORT PREPARED BY IFS ASSOCIATES DATED DECEMBER 09, 2022

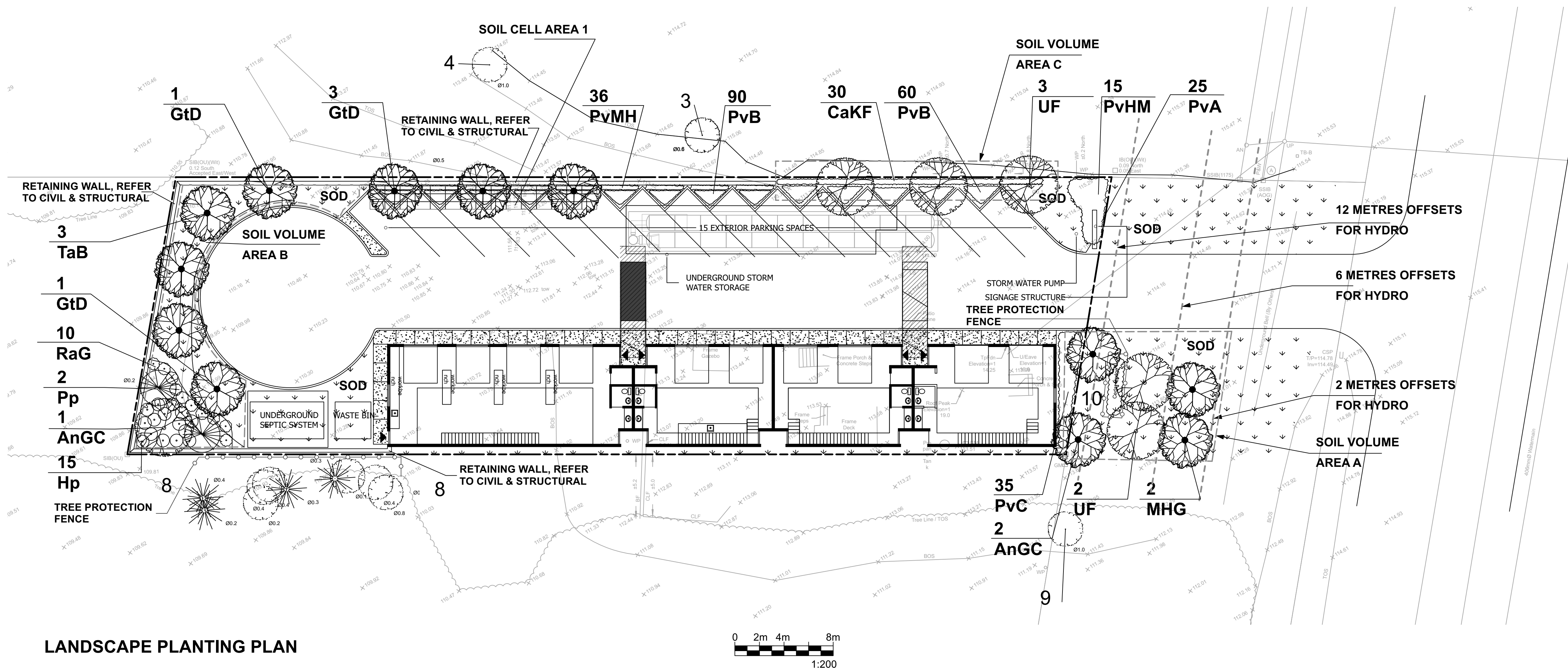

LANDSCAPE PLANTING PLAN

SOIL VOLUME CALCULATIONS - 5254 Bank Street				
Soil Volume Area, Tree Quantity and Size	Tree Quantity	OTTAWA Target Soil Volume (m³)	Design Soil Volume	Soil Adequacy percentage
<b>AREA A - 2 ornamental trees, 2 small trees, 2 medium trees</b> plant bed (135 sq m x 0.6 ave metre deep)	6	72.0	81.0	112.50%
<b>AREA B - 6 medium trees, 2 conifers</b> plant bed (125 sq m x 0.8 ave metre deep)	8	120.0	106.0	88.33%
<b>AREA C - 3 medium trees (typical)</b> plant bed (60 sq m x 0.8 ave metre deep)	3	45.0	48.0	106.67%
<b>Soil Cell Area 1 - 3 medium trees</b> soil cell (45 soil cells x 0.95 volume per cell)	3	45.0	48.2	107.00%

\* Small ornamental trees with growth to 8-15cm DBH, large shrubs, and columnar conifers calculated using 'How much soil to grow a big tree' by DeepRoot as a guide

PLANT LIST

ID	Qty	Botanical Name	Common Name	Scheduled Size	Remarks
<b>Trees</b>					
AnGC	3	Acer nigrum 'Green Column'	Green Column Black Maple	70mm cal.	WB, Staked
GtD	5	Gleditsia triacanthos 'Drakes'	Streetkeeper Honeylocust	70mm cal.	WB, Staked
Pp	2	Picea pungens	Colorado Spruce	2000mm ht.	WB, Staked
TaB	3	Tilia americana 'Boulevard'	Boulevard Linden	70mm cal.	WB, Staked
<b>Small trees (6.0-12m max under 6m-12m hydro offset)</b>					
MHG	2	Malus x 'Harvest Gold'	Harvest Gold Crabapple	50mm cal.	WB, Staked
<b>Small trees Ornamental Trees (6.0m max under 2m-6m hydro offset)</b>					
UF	5	Ulmus x 'Frontier'	Frontier Elm	70mm cal.	WB staked
<b>Shrubs</b>					
Hp	15	Hypericum prolificum	Shrubby St. Johnswort	2 gallon pot	Potted
RaG	10	Rhus aromatica 'Gro-Low'	Gro-Low Fragrant Sumac	40 cm ht.	Potted
<b>Perennials / Ornamental Grasses</b>					
PvA	25	Low Flowering Perennials		150mm Pot	50cm o.c.
PvB	150	Sun Flowering Perennials		150mm Pot	50cm o.c.
PvC	35	Mid Height Flowering Perennials		150mm Pot	60cm o.c.
CaKF	30	Calamagrostis acutifolia 'Karl Foers'	Karl Foerster Feather Reed Grass	1 gallon Pot	80cm o.c.
PvHM	51	Panicum virgatum 'Heavy Metal'	Heavy Metal Switch Grass	1 gallon Pot	75cm o.c.

Note:

Perennial types: (invasives such as miscanthus or purple loosestrife are not to be planted)

PvA: Low Perennial Mix - <30cm ht: Thrift Seapink, Yellow Hardy Ice Plant, Arizona Apricot Blanket Flower, Moss Phlox, Dragon's Blood Sedum  
PvB: Sun Flowering Perennials - Shasta Daisy, Daylily, Conflower, Rudbeckia varieties  
PvC: Mid Height Flowering Perennials - <125cm ht: Daylily varieties, Hosta varieties, Bishop's Hat, Artemisia

LEGEND

- EXISTING TREES TO REMAIN
- TREE PROTECTION FENCE
- PROPOSED PLANTING
- SOIL CELLS
- SOIL VOLUME AREA
- SOD
- CONCRETE

GENERAL NOTES

- .1 All general site information and conditions compiled from existing plans, surveys and consultant's field notes. Report all discrepancies prior to any work. No responsibility is born by the Consultant for unknown subsurface conditions.
- .2 The location of the utilities is approximate only, and the exact location should be determined by consulting the municipal authorities and utility companies concerned. The Contractor shall prove the location of utilities and shall be responsible for adequate protection from damage.
- .3 All dimensions shown are to be verified on site prior to any construction. No deviations are to be made from the layouts as shown on this plan without prior consultation with the Landscape Architect and Owner.
- .4 No other trees to be removed without prior approval by Landscape Architect.

7		
6		
5		
4		
3		
2		
1	Issued for Site Plan Control	Dec. 12/22

No. ISSUE DATE  
SCALE: AS SHOWN

OWNER: Rayan Zaher  
364 Wisteria Crescent Ottawa ON

ARCHITECT: unPoised Architecture INC  
5-16 Sweetland Avenue Ottawa ON

Ruhland & Associates Ltd  
200-1750 Courtwood Crescent, Ottawa, Ontario K2C 2B5  
P (613) 224-4744 x 232 F (613) 224-1131 info@ra.ca www.ra.ca

PROJECT NORTH: PROFESSIONAL STAMP:

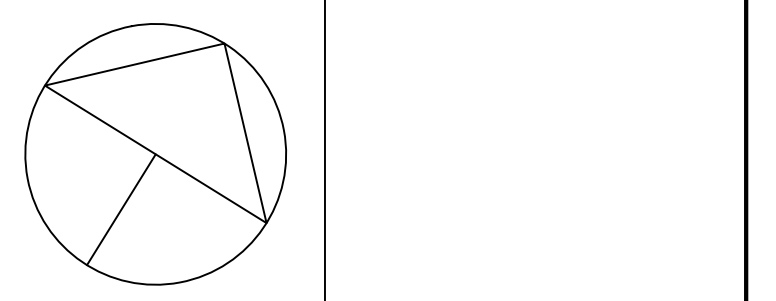

PROFESSIONAL STAMP: PROFESSIONAL STAMP:

PROJECT: SERVICE REPAIR FACILITY  
5254 Bank Street, Ottawa ON

DRAWING: LANDSCAPE PLAN

DESIGN: M.R.	DRAWING NO: L-01
DRAWN: M.M.	
CHECKED: M.R.	G-C NO:
PLOTTED:	



**NOTES:**  
 TREES ARE TO BE INSTALLED AS PER CITY STANDARD DETAILS; SOIL VOLUME AS PER BELOW NOTES AND MATRIX ON SHEET L-01.  
 - STANDARD TREE SOIL VOLUMES QUANTITIES INCLUDE THE TOP 900-1000mm OF SOIL/EXISTING SUBSOIL LAYER TO CALCULATE TOTAL SOIL VOLUMES REQUIRED BY THE CITY OF OTTAWA FOR SUSTAINABLE TREE GROWTH. WHERE LARGER SOFT AREAS ARE AVAILABLE, THE TOP 400-500mm LAYER IS USED TO CALCULATE SOIL VOLUMES.  
 - WHERE EXISTING MATERIAL BELOW THE SPECIFIED TOPSOIL IS NOT CONDUCTIVE TO TREE GROWTH, AN ADDITIONAL LAYER OF PLANTING MEDIUM IS TO BE INSTALLED BELOW SPECIFIED TOPSOIL DEPTH TO OBTAIN THE SOIL VOLUME DEPTH REQUIRED.  
 - REFER TO SOIL VOLUME MATRIX AND PLANS FOR AREA WHERE TREE SOIL VOLUMES ARE REQUIRED.

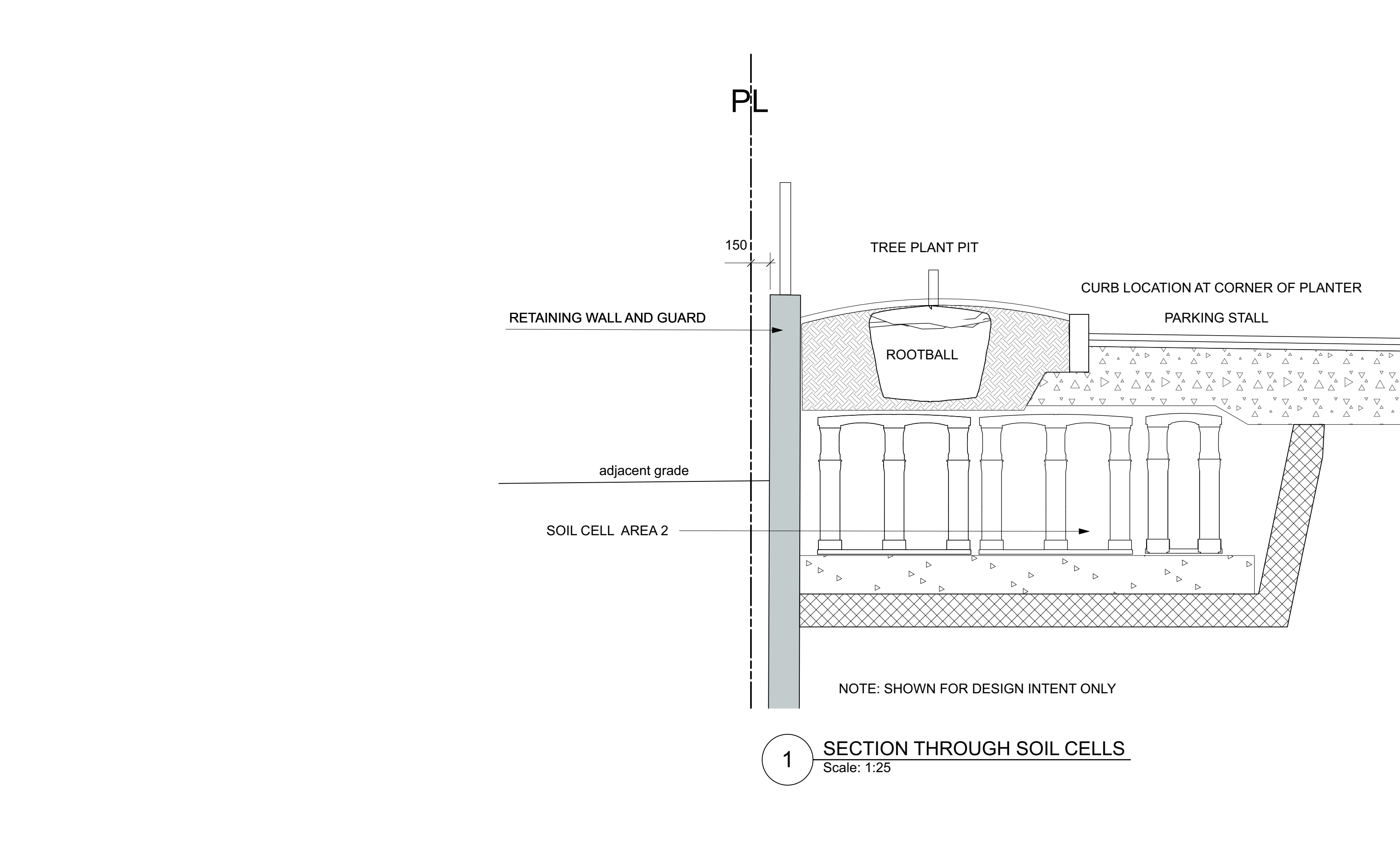
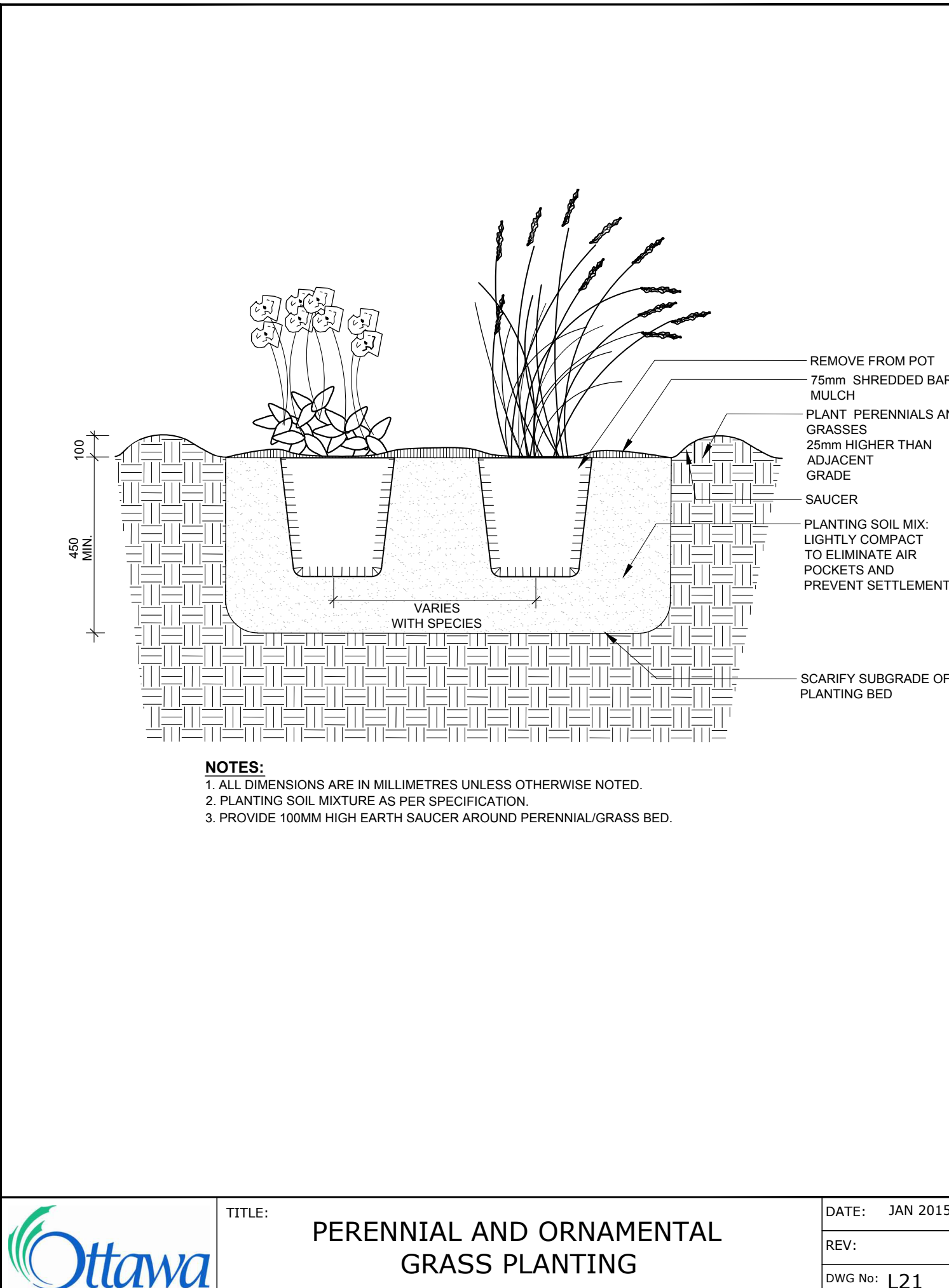
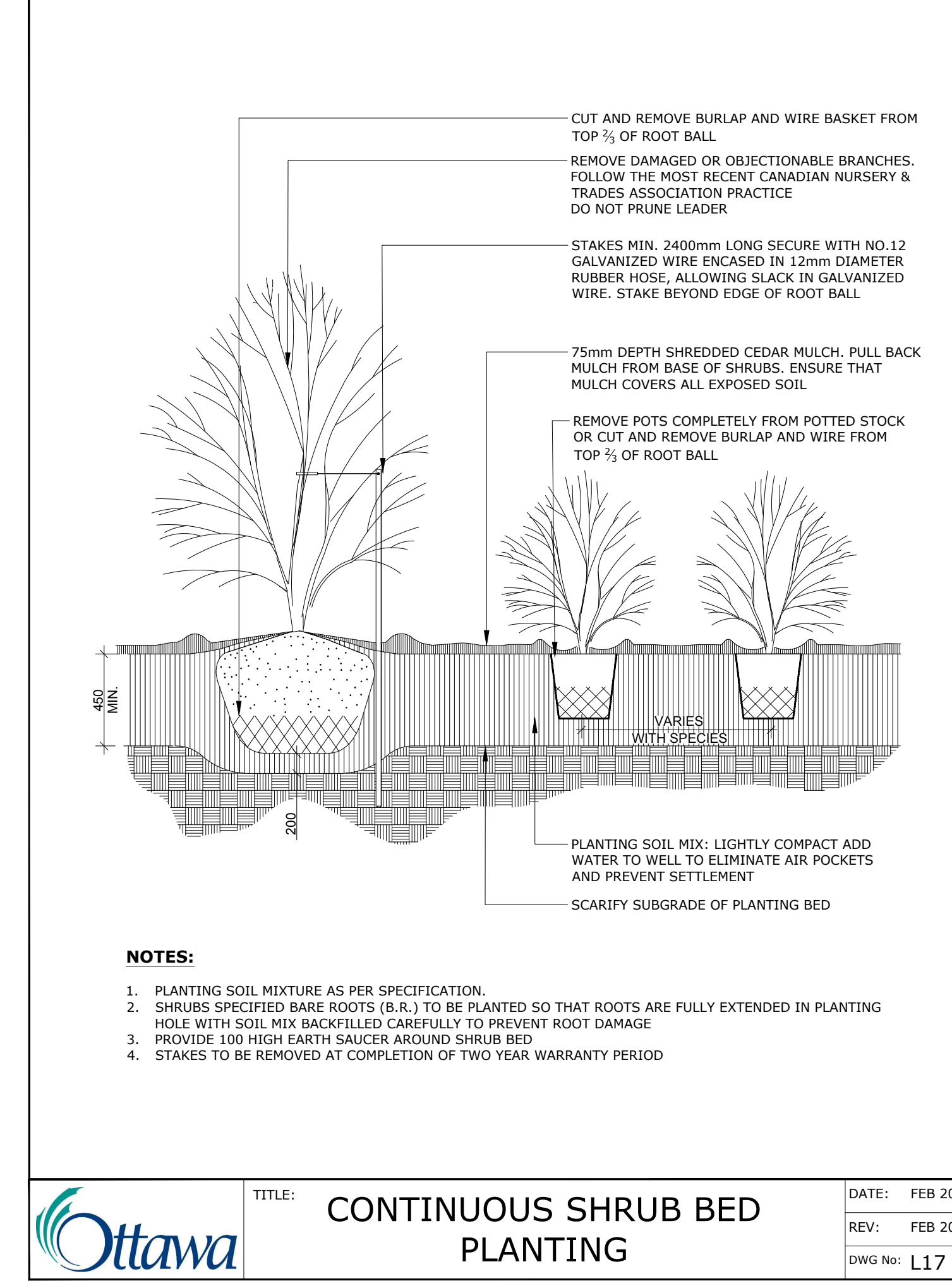
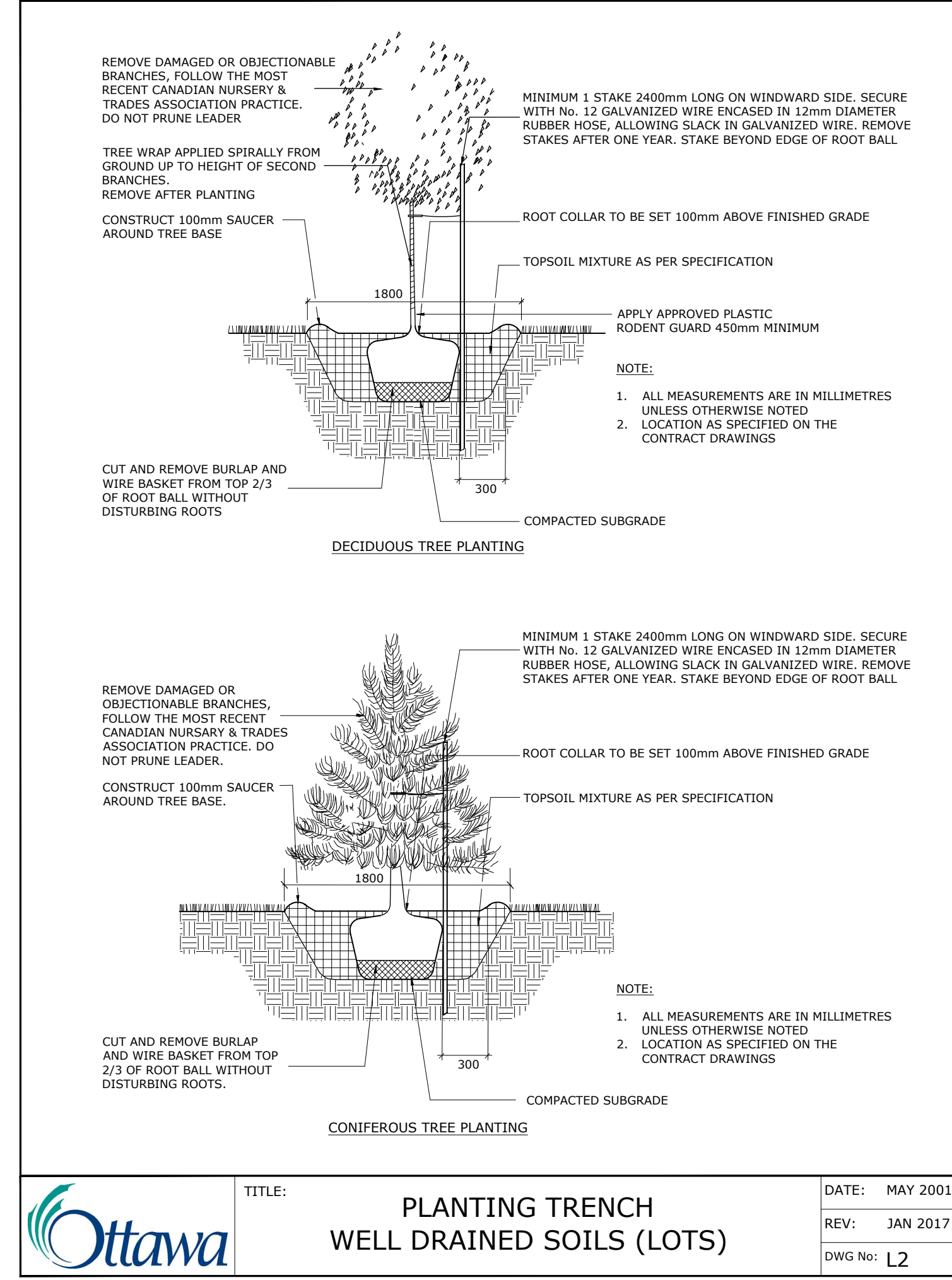
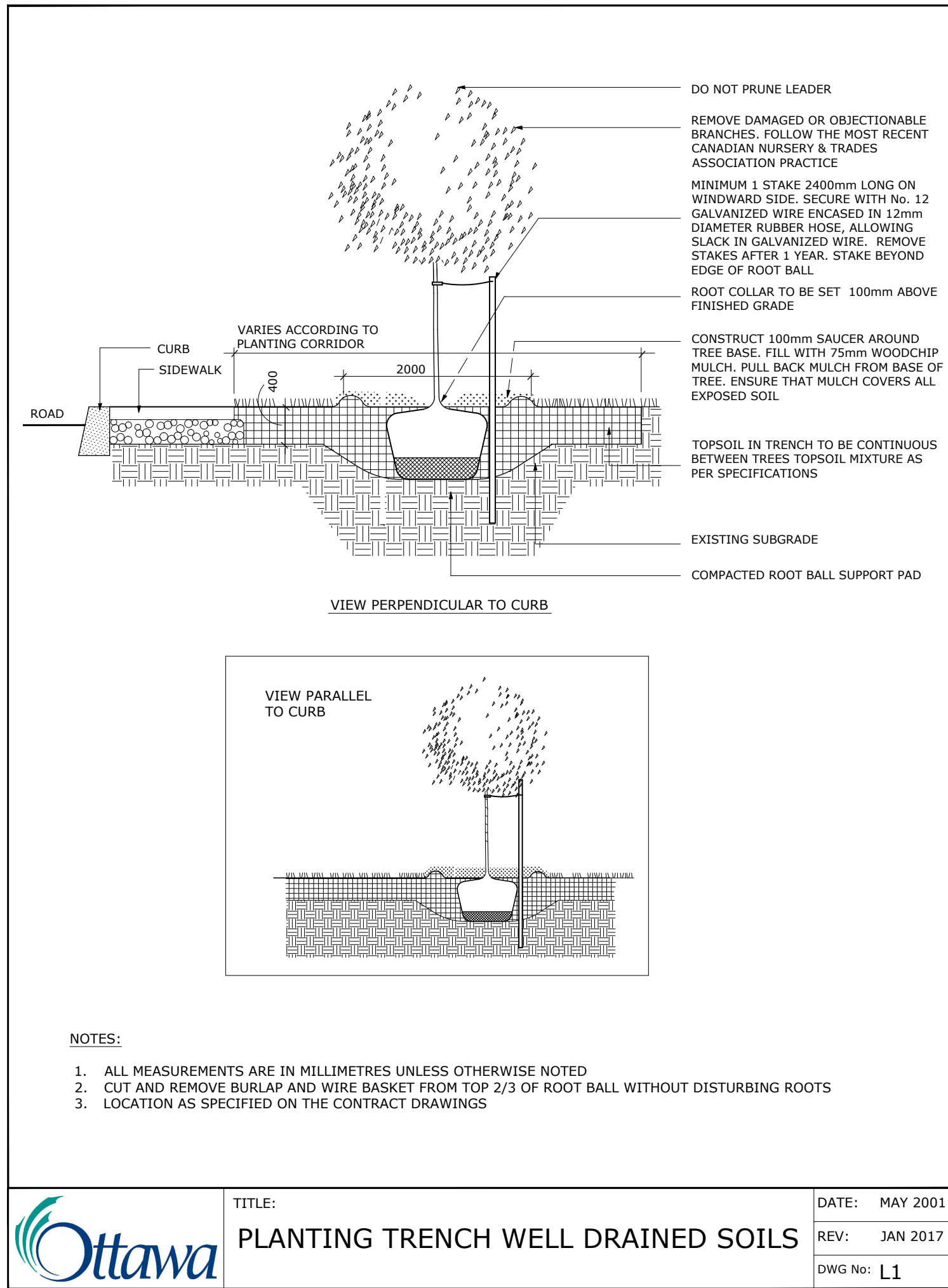

7		
6		
5		
4		
3		
2		
1	Issued for Site Plan Control	Dec. 12/22

No. ISSUE DATE  
 SCALE: NTS  
 OWNER: Rayan Zaher  
 364 Wisteria Crescent Ottawa ON

ARCHITECT: unPoised Architecture INC  
 5-16 Sweetland Avenue Ottawa ON

Ruhland & Associates Ltd  
 200-1750 Courtwood Crescent, Ottawa, Ontario K2C 2B5  
 P (613) 224-4744 x 232 F (613) 224-1131 info@ra.ca www.ra.ca

PROJECT NORTH: PROFESSIONAL STAMP:  
 PROFESSIONAL STAMP: PROFESSIONAL STAMP:

PROJECT: SERVICE REPAIR FACILITY  
 5254 Bank Street, Ottawa ON

DRAWING: LANDSCAPE DETAILS  
 DESIGN: M.R. DRAWING NO: L-02  
 DRAWN: M.M.  
 CHECKED: M.R. G-C NO:  
 PLOTTED: