

PART OF BLOCK 11  
REGISTERED PLAN 4M-1651  
CITY OF OTTAWA

Surveyed by Annis, O'Sullivan, Vollebakk Ltd.

Scale 1:250



Metric

DISTANCES SHOWN ON THIS PLAN ARE IN METRES AND CAN BE CONVERTED TO FEET BY DIVIDING BY 0.3048

Surveyor's Certificate

I CERTIFY THAT:

1. This survey and plan are correct and in accordance with the Surveys Act, the Surveyors Act and the regulations made under them.
2. The survey was completed on the 5th day of April, 2022.

April 13, 2022  
Date

*A.J. Broxham*  
Andrew J. Broxham  
Ontario Land Surveyor

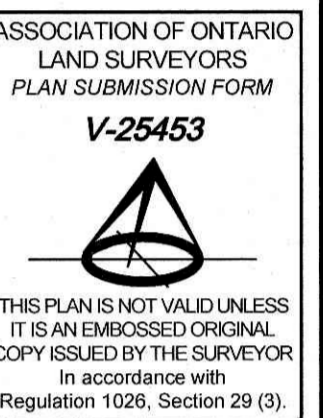

Notes & Legend

Symbol	Denotes
□	Survey Monument Planted
■	Survey Monument Found
SIB	Standard Iron Bar
SSIB	Short Standard Iron Bar
IB	Iron Bar
(WIT)	Witness
Meas.	Measured
(AOG)	Annis, O'Sullivan, Vollebakk Ltd.
(PI)	Plan 4R-34408
○ FH	Fire Hydrant
○ LS	Light Standard
⊗ WV	Water Valve
○ M+ST	Maintenance Hole (Storm Sewer)
○ M+S	Maintenance Hole (Sanitary)
○ M+H	Maintenance Hole (Hydro)
○ M	Maintenance Hole (Unidentified)
□ CB	Catch Basin
T/G	Top of Grate
— P —	Underground Power
— G —	Underground Gas
— — —	Underground Shared Conduit
B/C	Shared Bell and Cable
B/C/G	Shared Bell, Cable and Gas
B/C/P	Shared Bell, Cable and Power
H-T	Hydro Transformer Pad
+ 85.00	Location of Elevations

Bearings are grid, derived from the westerly limit of rue Michael Stouqua Street, shown to be N0°00'00"E on Plan 4R-34408, and are referred to the central meridian of MTM Zone 9 (76°30' West Longitude) NAD-83 (original).

Dimensions illustrated hereon are consistent with Plan 4R-34408 unless otherwise noted. All found survey monuments are (AOG) unless otherwise noted.

ELEVATION NOTES

1. Elevations shown are geodetic and are referred to City of Ottawa Vertical Benchmark No. 396 (01919680138), having an elevation of 95.06 metres (CGVD28 geodetic datum).
2. It is the responsibility of the user of this information to verify that the job benchmark has not been altered or disturbed and that its relative elevation and description agrees with the information shown on this drawing.

UTILITY NOTES

1. This drawing cannot be accepted as acknowledging all of the utilities and it will be the responsibility of the user to contact the respective utility authorities for confirmation.
2. Only visible surface utilities were located.
3. A field location of underground plant by the pertinent utility authority is mandatory before any work involving breaking ground, probing, excavating etc.
4. Location of underground services derived from composite utility plan drawing No. 301 (IB) project 118863, Revision 7 dated April 11, 2021.

