

PLANT MATERIAL

KEY	COMMON NAME	BOTANICAL NAME	QTY	SIZE	COND
Ag	AMUR MAPLE	<i>Acer ginnala</i> (multi-stem)	2	40cmcl	UB
Am	MULTI-STEM SERVICEBERRY	<i>Aelaeocharis canadensis</i> multi-stem	8	50cm	POT
Ar	RED MAPLE	<i>Acer rubrum</i> 'Sunset'	6	60cmcl	UB
Bx	GREEN GEM BOXYWOOD	<i>Buxus x Green Gem</i>	15	5gpl	POT
Co	HACKBERRY TREE	<i>Celtis occidentalis</i>	2	60cmcl	UB
Di	PARDON ME DAYLILY	<i>Hemerocallis 'Pardon Me'</i>	45	2yrgal	POT
Ge	ROZANNE GERANIUM	<i>Geranium 'Rozanne'</i>	43	2yrgal	POT
Gt	SHADEMASTER LOCUST	<i>Gladiolus 'Shademaster'</i>	4	60cmcl	UB
Hl	ANNABELLE HYDRANGEA	<i>Hydrangea arborescens</i> 'Annabelle'	16	2yrgal	POT
Jh	PRINCE OF WALES JUNIPER	<i>Juniperus horizontalis</i> 'Prince of Wales'	21	60cm	POT
Kf	KARL FOENSTER REED GRASS	<i>Calamagrostis acutifolia</i> 'Karl Foerster'	8	2yrgal	POT
Pf	WHITE SPRUCE	<i>Picea glauca</i>	15	50cm	UB
Qp	PIN OAK	<i>Quercus palustris</i>	6	60cmcl	UB
Qr	RED OAK	<i>Quercus rubra</i>	1	60cmcl	UB
Rr	FLOWER CARPET SHRUB ROSE	<i>Rosa Flower Carpet</i>	16	60cm	POT
Se	AUTUMN JOY SEDUM	<i>Sedum spectabile</i> 'Autumn Joy'	96	2yrgal	POT
Sv	IVORY SILK TREE LILAC	<i>Syringa reticulata</i>	1	2yrgal	POT
Tm	HICK'S YEW	<i>Taxus x media</i> 'Hickall'	15	60cm	POT
Tn	DENSE YEW	<i>Taxus x media</i> 'Densiformis'	11	40cm	POT

LEGEND

- PROPOSED DECIDUOUS TREES
- PROPOSED CONIFEROUS TREES
- PROPOSED PLANTINGS
- PLANT KEYS - SEE PLANT MATERIALS LIST ON L-1
- PROPOSED CONCRETE PAVING
- PROPOSED CONCRETE PAVING SWIRL PATTERN
- SEEDING - SEE NOTES
- PROPOSED RAISED PLANTER SEE DETAIL
- PROPOSED BENCH SEE DETAIL
- PROPOSED TRASH RECEPTACLE SEE DETAIL
- PROPOSED BIKE RACK SEE DETAIL
- PROPOSED FIRE HYDRANT LOCATION
- PROPOSED LIGHTING SEE ELECTRICAL PLAN
- EXISTING DECIDUOUS TREES TO REMAIN
- CRITICAL ROOT ZONE - 10cm RADIUS PER 1cm DBH



ALL DRAWINGS REMAIN THE PROPERTY OF THE LANDSCAPE ARCHITECT AND SHALL NOT BE REPRODUCED OR REUSED WITHOUT THE LANDSCAPE ARCHITECTS WRITTEN PERMISSION.
THIS DRAWING SHALL NOT BE USED FOR CONSTRUCTION OR TENDER PURPOSES UNLESS SIGNED AND DATED BY RONALD H. KOUDY'S, O.A.L.A. C.S.L.A. LANDSCAPE ARCHITECT, LONDON, ONTARIO (519) 687-3322.

Ronald H. Koudy's, O.A.L.A. C.S.L.A. DATE



#	date:	revision:	by:
11.	JAN 27 2023	RE-ISSUED FOR SITE PLAN CONTROL APPLICATION & ZONING BY-LAW AMENDMENT	MCB
10.	DEC 16 2022	RE-ISSUED FOR MULTIC WORKING DRAWINGS	MCB
9.	AUG 19 2022	ISSUED FOR SITE PLAN CONTROL APPLICATION	MCB
8.	AUG 19 2022	ISSUED FOR ZONING BY-LAW AMENDMENT	MCB
7.	JUL 29 2022	ISSUED FOR ZONING BY-LAW AMENDMENT	MCB
6.	FEB 24 2022	ISSUED FOR ZONING BY-LAW AMENDMENT	MCB
5.	DEC 02 2021	ISSUED FOR SPA & ZONING BY-LAW AMENDMENT	MCB
4.	NOV 19 2021	ISSUED FOR 100% DD	MCB
3.	NOV 19 2021	ISSUED FOR 25% SPA	MCB
2.	OCT 22 2021	ISSUED FOR 50% DD	MCB
1.	AUG 26 2021	ISSUED FOR 100% SD	MCB

All drawing and specifications are the property of the architect. The contractor shall verify all dimensions and information on site and report any discrepancy to architect before proceeding.

Arch Corp - Orleans
1161 OLD MONTREAL RD, ORLEANS ON, K4A 3N6

LANDSCAPE PLAN 1of2

scale: AS NOTED
drawn by: MCB
reviewed by: MCB
job number: 21-164lp
plot date: 22-12-16
drawing number:

OVERALL LANDSCAPE PLAN 1of2
SCALE = 1:250

KEY	COMMON NAME	BOTANICAL NAME	QTY	SIZE	COND
A	AMUR MAPLE	Acer ginnala (multi-stem)	1	40cmcl	UB
AB	MULTI-STEM SERVICEBERRY	Amaranthus canadensis multi-stem	2	50cm	POT
B	RED MAPLE	Acer rubrum 'Sunset'	6	60cmcl	UB
Bx	GREEN GEM BOXWOOD	Buxus x Green Gem	11	3gal	POT
C	HACKBERRY TREE	Celtis occidentalis	1	60cmcl	UB
D	PARSONS PE DAYLILY	Hemerocallis 'Parson Pe'	40	2 1/2gal	POT
Dx	ROZANE GERANIUM	Geranium 'Rozane'	1	2 1/2gal	POT
E	SHADEMASTER LOCUST	Gleditsia triacanthos 'Shademaster'	1	60cmcl	UB
F	KARL FOERSTER REED GRASS	Calamagrostis acutifolia 'Karl Foerster'	13	2 1/2gal	POT
G	WHITE SPRUCE	Picea glauca	3	50cm	UB
H	FRY OAK	Quercus palustris	6	60cmcl	UB
I	RED OAK	Quercus rubra	9	60cmcl	UB
J	FLOWER CARPET SHRUB ROSE	Rosa 'Flower Carpet'	138	60cm	POT
K	AUTUMN JOY SEDUM	Sedum spectabile 'Autumn Joy'	39	2 1/2gal	POT
L	IVORY BULK TREE LILAC	Syringa reticulata	1	2 1/2gal	POT
M	BASSWOOD	Tilia americana	1	60cmcl	UB
N	HICKS YEW	Taxus x media 'Hickall'	35	60cm	POT
O	DENSE YEW	Taxus x media 'DensaFormis'	8	40cm	POT

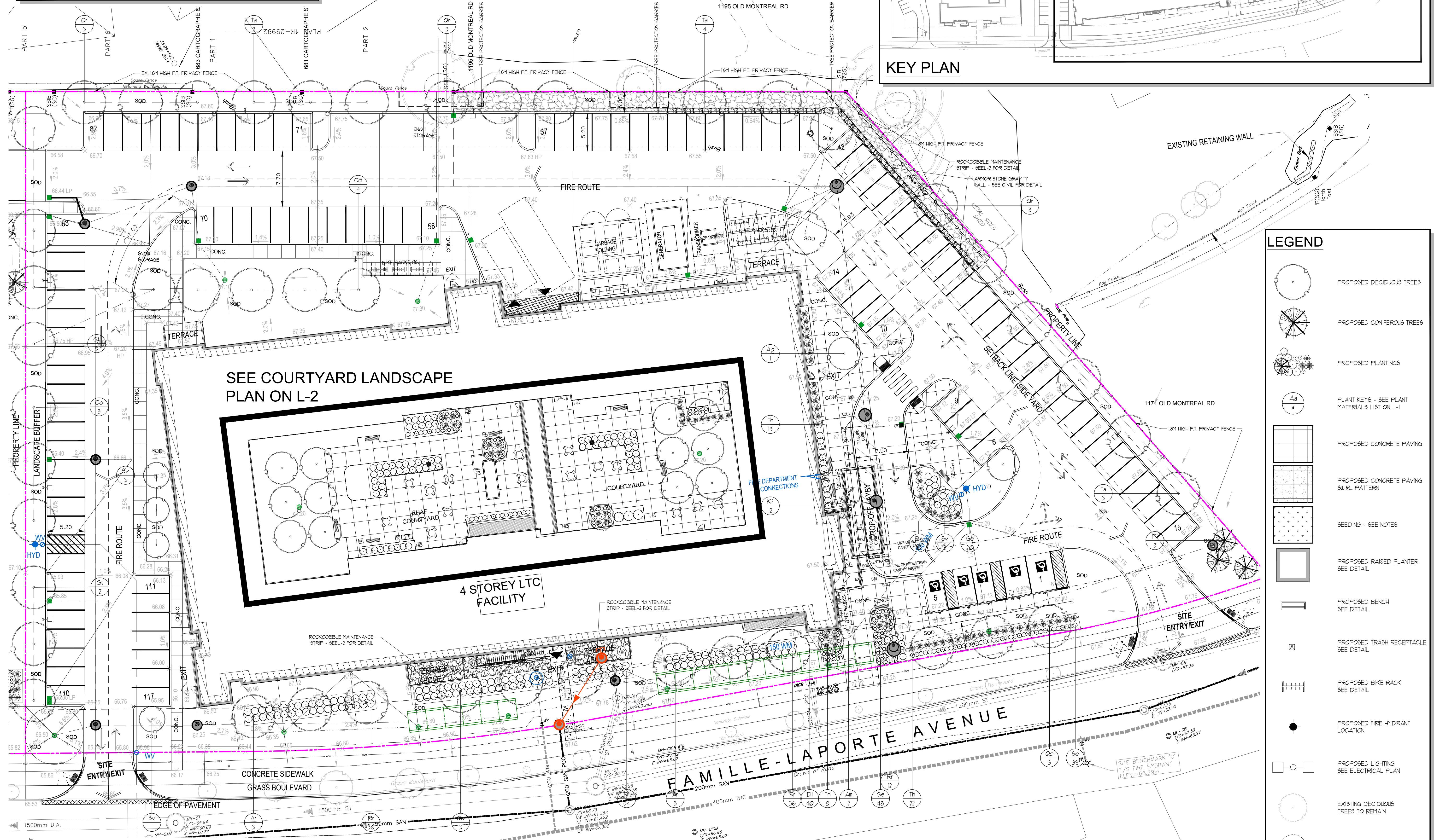
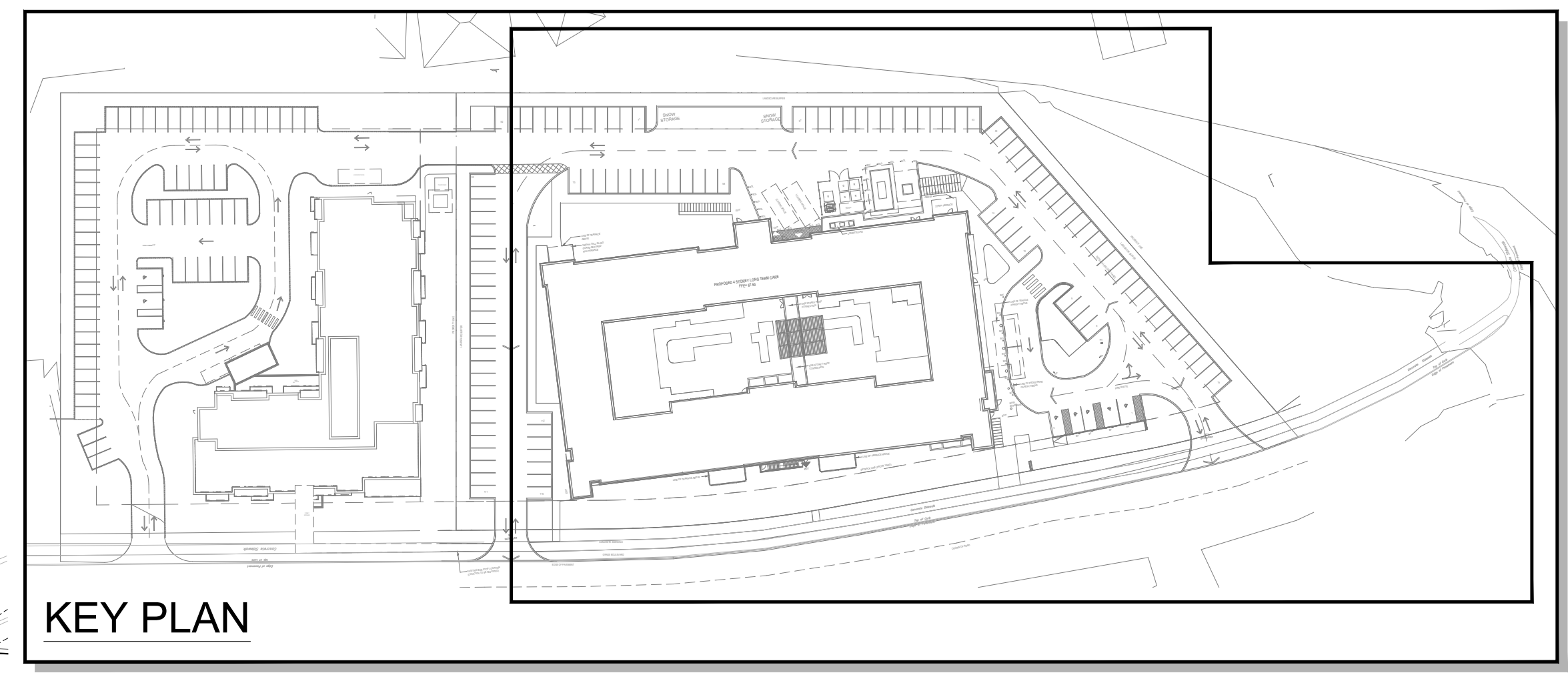

LEGEND

- PROPOSED DECIDUOUS TREES
- PROPOSED CONIFEROUS TREES
- PROPOSED PLANTINGS
- PLANT KEYS - SEE PLANT MATERIALS LIST ON L-1
- PROPOSED CONCRETE PAVING
- PROPOSED CONCRETE PAVING SWIRL PATTERN
- SEEDING - SEE NOTES
- PROPOSED RAISED PLANTER SEE DETAIL
- PROPOSED BENCH SEE DETAIL
- PROPOSED TRASH RECEPTACLE SEE DETAIL
- PROPOSED BIKE RACK SEE DETAIL
- PROPOSED FIRE HYDRANT LOCATION
- PROPOSED LIGHTING SEE ELECTRICAL PLAN
- EXISTING DECIDUOUS TREES TO REMAIN
- CRITICAL ROOT ZONE - 10cm RADIUS PER 1cm DBH



ALL DRAWINGS REMAIN THE PROPERTY OF THE LANDSCAPE ARCHITECT AND SHALL NOT BE REPRODUCED OR REUSED WITHOUT THE LANDSCAPE ARCHITECTS WRITTEN PERMISSION.

THIS DRAWING SHALL NOT BE USED FOR CONSTRUCTION OR TENDER PURPOSES UNLESS SIGNED AND DATED BY RONALD H. KOUDYS, O.A.L.A. C.S.L.A. LANDSCAPE ARCHITECT, LONDON, ONTARIO (519) 687-3322.

Ronald H. Koudys, O.A.L.A. C.S.L.A. DATE

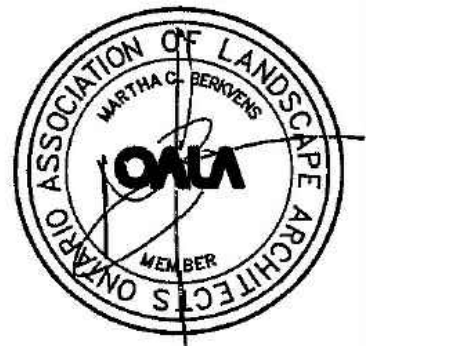

#	date	revision	by
11.	JAN 27 2023	RE-ISSUED FOR SITE PLAN CONTROL APPLICATION & ZONING BY-LAW AMENDMENT	MCB
10.	DEC 16 2022	RE-ISSUED FOR MULTIC WORKING DRAWINGS	MCB
9.	AUG 19 2022	ISSUED FOR SITE PLAN CONTROL APPLICATION	MCB
8.	AUG 19 2022	ISSUED FOR ZONING BY-LAW AMENDMENT	MCB
7.	JUL 29 2022	ISSUED FOR ZONING BY-LAW AMENDMENT	MCB
6.	FEB 24 2022	ISSUED FOR ZONING BY-LAW AMENDMENT	MCB
5.	DEC 02 2021	ISSUED FOR SPA & ZONING BY-LAW AMENDMENT	MCB
4.	NOV 19 2021	ISSUED FOR 100% DD	MCB
3.	NOV 19 2021	ISSUED FOR 25% SPA	MCB
2.	OCT 22 2021	ISSUED FOR 50% DD	MCB
1.	AUG 26 2021	ISSUED FOR 100% SD	MCB

All drawing and specifications are the property of the architect. The contractor shall verify all dimensions and information on site and report any discrepancy to architect before proceeding.

Arch Corp - Orleans

1161 OLD MONTREAL RD, ORLEANS ON, K4A 3N6

LANDSCAPE PLAN 2of2

scale: AS NOTED
 drawn by: MCB
 reviewed by: MCB
 job number: 21-164lp
 plot date: 22-12-16
 drawing number:

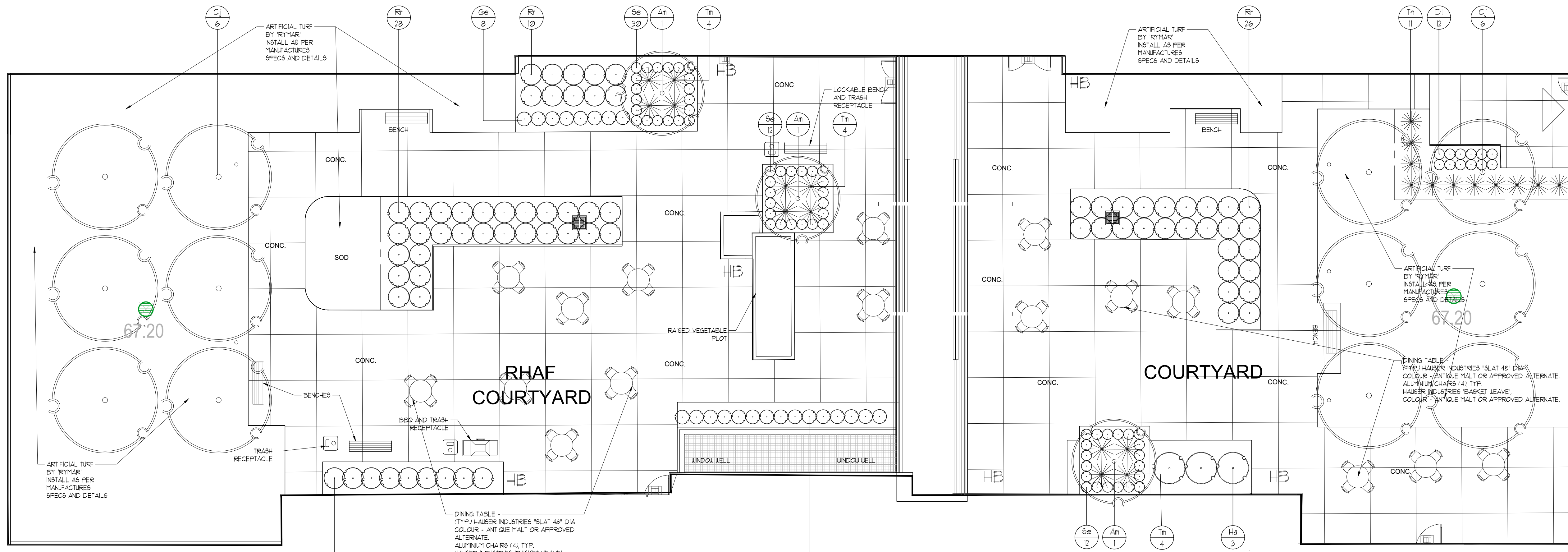
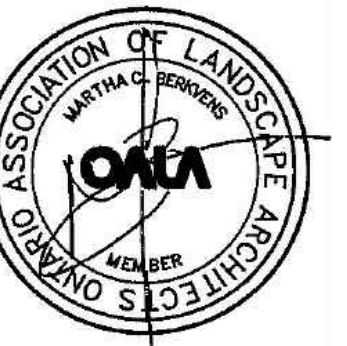

COURTYARD LANDSCAPE PLAN
SCALE = 1:100

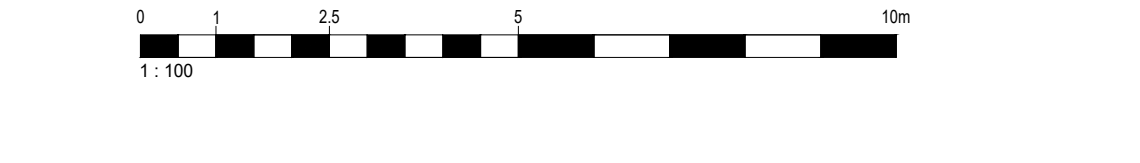

KEY	COMMON NAME	BOTANICAL NAME	QTY	SIZE	COND
Am	MULTI-STEM SERVICEBERRY	<i>Amelanchier canadensis</i> multi-stem	3	150cm	POT
Cj	KATSURU TREE	<i>Cercidiphyllum japonicum</i>	2	60cm	UB
Dj	FAN-PALM VEGETATIVE	<i>Homalium</i> 'Fandom Palm'	2	2yr	POT
Ge	ROZANNE GERANIUM	<i>Geranium 'Rozanne'</i>	8	2yr	POT
Hu	ANNABELLE HYDRANGEA	<i>Hydrangea arborescens</i> 'Annabelle'	3	2yr	POT
Ho	PALACE PURPLE CORAL BELL	<i>Hesperis matronalis</i> 'Palace Purple'	3	2yr	POT
Kf	KARL FORSTERER REED GRASS	<i>Calamagrostis acutifolia</i> 'Karl Forsterer'	5	2yr	POT
Rr	SHRUB ROSE	<i>Rosa rugosa</i>	64	60cm	POT
Se	ALUMINUM JOY SEDUM	<i>Sedum spectabile</i> 'Aluminum Joy'	54	2yr	POT
Th	HICKS YEW	<i>Taxus x media</i> 'Hicksii'	11	60cm	POT
Tm	DENSE YEW	<i>Taxus x media</i> 'Densiformis'	2	40cm	POT

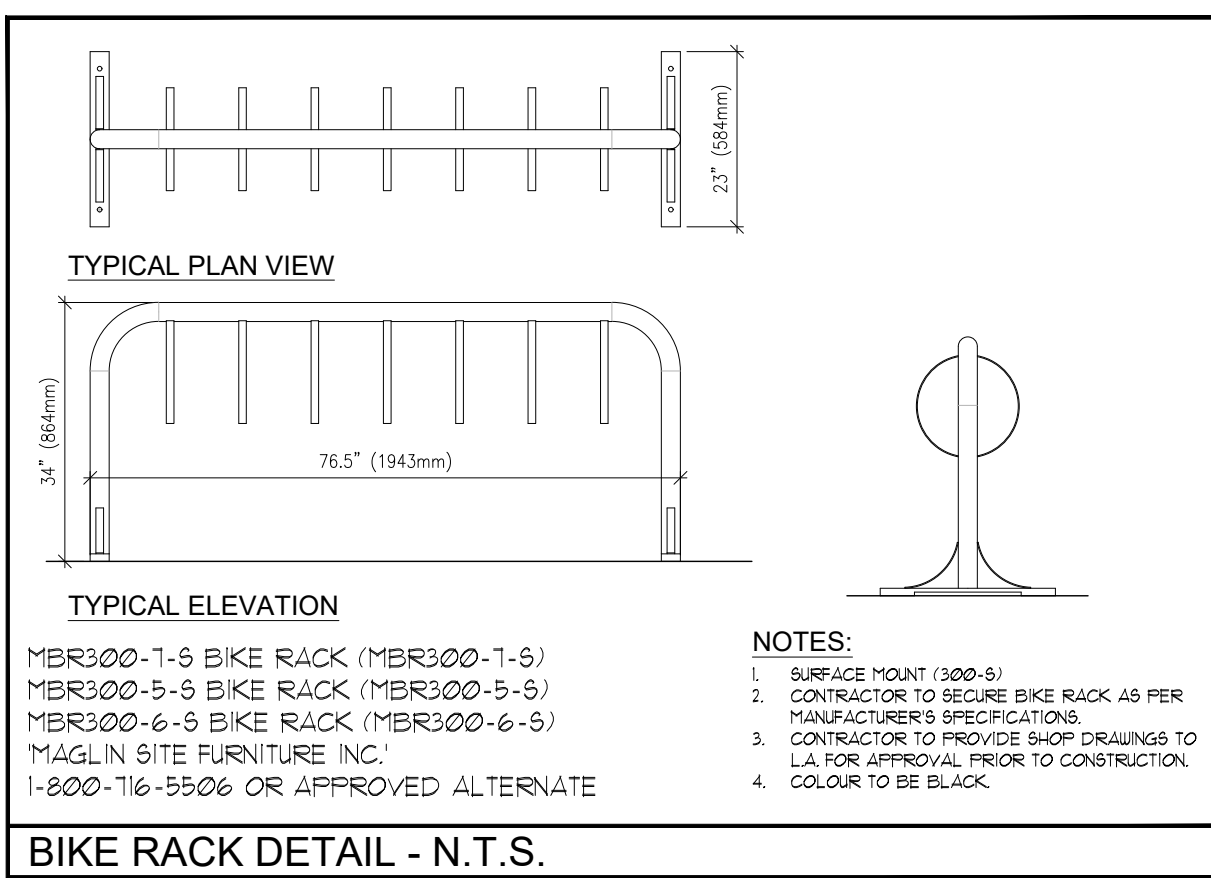

GENERAL PLANTING SPECIFICATIONS:

- BASE INFORMATION SUPPLIED BY HONGSEPT'S SISIANG ARCHITECTS INC.
 - CONTRACTOR TO MAKE THEMSELVES FAMILIAR WITH ALL RELATED SPECIFICATIONS.
 - CONTRACTOR TO SECURE BIKE RACK AS PER MANUFACTURER'S SPECIFICATIONS.
 - CONTRACTOR TO NOTIFY LANDSCAPE ARCHITECT DURING TENDERING PROCESS ERRORS AND/OR OMISSIONS WILL BE THE RESPONSIBILITY OF THE CONTRACTOR.
 - CONTRACTOR SHALL MAINTAIN ALL LANDSCAPED AREAS UNTIL OWNER ACCEPTANCE OF PROJECT. CONTRACTOR TO NOTIFY LANDSCAPE ARCHITECT IN WRITING ON COMPLETION OF PROJECT FOR A SITE WORK COMPLETION CERTIFICATE AS WELL AS THE COMPLETION OF THE ACCEPTANCE OF PROJECT.
 - ALL WORKMANSHIP TO BE GUARANTEED FOR ONE YEAR UNLESS OTHERWISE STATED. WARRANTY PERIOD WILL BEGIN ON FINAL ACCEPTANCE OF PROJECT.
 - ALL WORKMANSHIP TO COMPLY WITH THE CANADIAN LANDSCAPE STANDARDS.
 - ALL NURSERY STOCK TO BE "NURSERY GROWN AND MUST COMPLY WITH THE CANADIAN NURSERY LANDSCAPE ASSOCIATION'S 'CANADIAN NURSERY STOCK STANDARD', LATEST EDITION.
 - ALL LANDSCAPING IS TO BE INSTALLED PRIOR TO THE END OF THE FIRST GROWING SEASON FOLLOWING THE OCCUPANCY OF THE SITE. DEVELOPMENT UNLESS OTHERWISE STATED.
 - CONTRACTOR IS RESPONSIBLE FOR ALL UNDERGROUND UTILITIES AND MUST SUPPLY THE LANDSCAPE ARCHITECT WITH COPIES OF LOCATE CERTIFICATES PRIOR TO COMMENCEMENT OF WORK.
- GRADING**
- CONTRACTOR TO ENSURE POSITIVE DRAINAGE IN ALL AREAS.
 - ALL GRADING TO BE IN ACCORDANCE WITH SITE ENGINEER'S DRAWINGS.
 - SOIL SHALL BE SCARIFIED FREE OF ALL STONES, ROOTS, BRANCHES LARGER THAN 1" (25mm) AND COMPACTED TO 95% S.P.D.
 - ALL SUBSOIL TO BE EXPOSED TO A DEPTH OF 150mm PRIOR TO THE INSTALLATION OF TOPSOIL TO ENSURE NO HARDPAN CONDITIONS.
 - CONTRACTOR TO NOTIFY LANDSCAPE ARCHITECT PRIOR TO INSTALLATION OF TOPSOIL TO APPROVE SUBBASE.
 - DIRECT ALL RAINLEADERS AND SUMP LEADERS AWAY FROM PLANTING BEDS AND TO THE DESIGNATED SWALES.
 - NOTIFY LANDSCAPE ARCHITECT IN WRITING OF ANY SUBSTANTIAL SET CONDITIONS.
- TOPSOIL**
- AT THE CONTRACTOR'S EXPENSE A SOIL TEST IS TO BE COMPLETED BY A REPUTABLE LABORATORY. THE SOIL TEST IS TO BE COMPLETED AND IF NECESSARY, RECOMMENDATIONS FROM THE LABORATORY ARE TO BE INCLUDED. THE RESULTS OF SOIL TESTS AND RECOMMENDATIONS ARE TO BE PROVIDED TO THE LANDSCAPE ARCHITECT PRIOR TO COMMENCING WORK.
 - TOPSOIL FOR PLANTING BEDS IS TO BE A FERTILE, FRIABLE, NATURAL LOAM TO A MINIMUM DEPTH OF 8" (200mm) AND A MINIMUM DEPTH OF 4" (100mm) FOR TURF AREAS - UNLESS OTHERWISE STATED. TOPSOIL SHALL CONTAIN NOT LESS THAN 4% ORGANIC MATTER FOR CLAY LOAMS AND NOT LESS THAN 2% ORGANIC MATTER FOR SANDY LOAM TO A MAXIMUM OF 8% AND CAPABLE OF SUSTAINING VIGOROUS PLANT GROWTH, FREE OF SUBSOIL, CONTAMINATION, ROOTS AND STONES OVER 50mm DIAMETER, REASONABLY FREE OF WEEDS AS DETERMINED BY THE LANDSCAPE ARCHITECT, AND HAVING A pH RANGING FROM 6.0 TO 7.0.
 - TOPSOIL IS TO BE STOCKPILED FOR USE ON SITE DEVELOPMENT. AVOID MIXING TOPSOIL WITH SUBSOIL. LIMIT HEIGHT OF STOCKPILE TO 3M TO RETAIN SOIL MICROORGANISMS AND SOIL VIABILITY AND FERTILITY.
 - IF APPLICABLE, ALL WORK IN ANY ROAD ALLOWANCE SHALL MEET THE MINIMUM SPECIFICATIONS OF THE MUNICIPALITY. ENSURE A MINIMUM OF 100mm TOPSOIL IS INSTALLED IN BOULEVARDS.
 - PROTECT THE MUNICIPALITY OWNED ROAD ALLOWANCE(S) (BOULEVARDS) FROM COMPACTION OR SOIL CONTAMINATION.
- MULCH**
- ALL TREES, SHRUBS AND PLANTING AREAS ARE TO BE MULCHED UNLESS OTHERWISE NOTED.
 - CONTRACTOR TO INSTALL 3" (75mm) OF GROUND-BARK MULCH IN ALL AREAS.
 - ALTERNATIVES MAY BE ACCEPTED - CONTRACTOR TO PROVIDE 3 SAMPLES FOR WRITTEN APPROVAL TO THE LANDSCAPE ARCHITECT.
- PLANT MATERIALS**
- CONTRACTOR TO VERIFY ALL PLANT MATERIAL ON DRAWINGS AND PLANT MATERIAL LIST(S) AND REPORT ALL DISCREPANCIES AT TENDERING PROCESS.
 - SUBSTITUTIONS WILL NOT BE ACCEPTED WITHOUT WRITTEN CONFIRMATION BY THE LANDSCAPE ARCHITECT.
 - PLANTINGS MAY BE ADJUSTED TO SUIT UTILITIES STRUCTURES AND AESTHETIC CONCERNS. ADJUSTMENTS ARE TO BE MADE UNDER THE DIRECTION OF THE LANDSCAPE ARCHITECT. ADJUSTMENTS TO PLANTING WITHOUT CONSENT OF LANDSCAPE ARCHITECT OR PROJECT MANAGER MAY NOT MEET INTENT OF DESIGN AND/OR MUNICIPAL APPROVALS. PLANT MATERIAL THAT HAS TO BE RELOCATED AS A RESULT WILL BE AT THE COST OF THE CONTRACTOR.
 - LANDSCAPE ARCHITECT TO INSPECT ALL PLANT MATERIAL ON SITE OR AT ITS SOURCE PRIOR TO INSTALLATION. CONTRACTOR IS TO GIVE LANDSCAPE ARCHITECT 48 HRS NOTICE FOR INSPECTION.
 - CONTRACTOR TO NOTIFY LANDSCAPE ARCHITECT IN WRITING IF ADVERSE WEATHER MAY IMPACT THE HEALTH OF THE PLANT MATERIALS AT THE TIME OF PLANTING. IF TEMPERATURE PRECIPITATION.
 - ALL TREE FITS SHALL BE AT LEAST 1 1/2" (40mm) UNDER THAN BALL OF THE TREE TO BE PLANTED AND SHALL BE DEEP ENOUGH SO THAT THE TOP OF BALL IS AT THE SAME LEVEL AS SURROUNDING GRADE. A MINIMUM OF 6" (150mm) OF BACKFILL SHALL BE PLACED UNDER BALL. TREE FITS ARE NOT TO BE LEFT OPEN OVER NIGHT.
 - SHRUB BEDS SHALL BE EXCAVATED TO A DEPTH OF 8" (200mm) AND FILLED WITH APPROVED BACKFILL MATERIAL. SHRUB BEDS ARE TO BE LEFT OPEN OVER NIGHT.
 - ALL TREES SHALL HAVE AN EARTH SALTER AT ITS BASE WITH A DIAMETER AS LARGE AS EXCAVATED AREA AND SHAPED TO RETAIN WATER (SEE DETAIL). EARTH SALTER SHALL BE AT LEAST 1 1/2" (40mm) UNDER THAN BALL OF THE TREE AND SHALL BE DEEP ENOUGH SO THAT THE TOP OF BALL IS AT THE SAME LEVEL AS SURROUNDING GRADE. A MINIMUM OF 6" (150mm) OF BACKFILL SHALL BE PLACED UNDER BALL. TREE FITS ARE NOT TO BE LEFT OPEN OVER NIGHT.
 - ALL BURLAP SHALL BE CUT AND BURIED BELOW SURFACE DURING PLANTING.
 - ALL EVERGREENS ARE TO UNRAFFED THE FIRST WINTER AT THE EXPENSE OF THE LANDSCAPE CONTRACTOR.
 - CRITICAL WATERING AREAS WITHIN 5' OF SALT-TOLERANT ROADWAYS, PARKING AND SIDEWALKS TO BE PROTECTED WITH SILT FENCING THROUGHOUT THE FIRST WINTER. AFTER INSTALLATION AT THE EXPENSE OF THE LANDSCAPE CONTRACTOR (OPTIONAL).
 - DIRECT ALL RAINLEADERS AWAY FROM PLANTING BEDS AND TO DESIGNATED DRAINAGE SWALES.
 - DO NOT INSTALL PLANT MATERIAL IN DRAINAGE SWALES.
 - CONTRACTOR IS TO REMOVE ALL STAKES AND GUY WIRES AFTER 2 FULL GROWING SEASONS.
- SOIL**
- ALL LANDSCAPED AREAS TO BE SOCCDED TO THE STREET CURB (S) UNLESS OTHERWISE STATED.
 - CONTRACTOR TO ENSURE (WHERE APPLICABLE) ALL PLANTING BEDS ADJACENT TO TRAFFIC ISLANDS, INTERIOR SITE CURBING, AND SIDEWALKS HAVE A 3" (75mm) 500 MAINTENANCE STRIP INSTALLED.
 - ANY SOCCDED AREAS WITHIN THE PROPERTY FROM THE LOT LINES TO SIDEWALK AND CURBING SHALL BE COMPLETED OR REPAIRED TO THE SATISFACTION OF THE LANDSCAPE ARCHITECT, CITY, AND/OR REGIONAL MUNICIPALITY UNLESS OTHERWISE STATED.
 - CRITICAL WATERING AREAS WITHIN 5' OF SALT-TOLERANT ROADWAYS, PARKING AND SIDEWALKS TO BE PROTECTED WITH SILT FENCING THROUGHOUT THE FIRST WINTER. AFTER INSTALLATION AT THE EXPENSE OF THE LANDSCAPE CONTRACTOR (OPTIONAL).
 - CONTRACTOR TO REPAIR ALL DAMAGED AREAS TO THE SATISFACTION OF THE LANDSCAPE ARCHITECT AND/OR CLIENT.
- WATERING**
- DURING THE WARRANTY PERIOD, BETWEEN MAY 15 AND SEPTEMBER 15 OF EACH YEAR, WATERING OF ALL PLANTS SHALL BE CARRIED OUT NO LESS THAN 6 TIMES PER YEAR IN ACCORDANCE WITH THE WATERING SCHEDULE TO BE DETERMINED BY THE OWNER UNLESS OTHERWISE STATED ON THE DRAWINGS. CRITICAL WATERING AREAS ARE TO BE WATERED AS INDICATED BY THE LANDSCAPE ARCHITECT.
 - NO AUTOMATIC IRRIGATION SYSTEM HAS BEEN PROVIDED FOR WATERING OPERATIONS. CONTRACTOR TO PROVIDE WATER TO THE SITE IF HOSE BIBS WITHIN THE BUILDING ENVELOPE ARE NOT AVAILABLE.
 - MANUAL WATERING SHALL ENSURE DEEP WATERING OF TREES, SHRUBS, GROUND COVERS AND GRASSED AREAS. WATERING OF GRASSED AREAS TO COMPEHNSION ON A REGULAR BASIS AND CONTINUE WITH INTENSITY DEPENDING ON AMOUNT OF RAINFALL. NEW SOIL THAT HAS BEEN LAID SHOULD BE KEPT MOIST FOR 4 TO 5 WEEKS OR UNTIL IT HAS FINELY ROOTED INTO THE EXISTING SOIL.
 - ALL CONIFEROUS TREES SHALL BE WATERED PRIOR TO FREEZING UP.
 - WATER SHALL BE APPLIED SO THAT THE WASHING OF THE SOIL OR DISLOCATING OF MULCH OR TREE GUARDS DOES NOT OCCUR. DAMAGE SHALL BE IMMEDIATELY REPAIRED TO THE SATISFACTION OF THE OWNER AT NO ADDITIONAL COST.

LEGEND

- PROPOSED DECIDUOUS TREES
- PROPOSED CONIFEROUS TREES
- PROPOSED PLANTINGS
- PLANT KEYS - SEE PLANT MATERIALS LIST
- PROPOSED CONCRETE PAVING
- PROPOSED CONCRETE PAVING SWIRL PATTERN
- SEEDING - SEE NOTES
- PROPOSED RAISED PLANTER
- PROPOSED BENCH
- PROPOSED TRASH RECEPTACLE
- PROPOSED BIKE RACK
- PROPOSED FIRE HYDRANT LOCATION
- PROPOSED LIGHTING

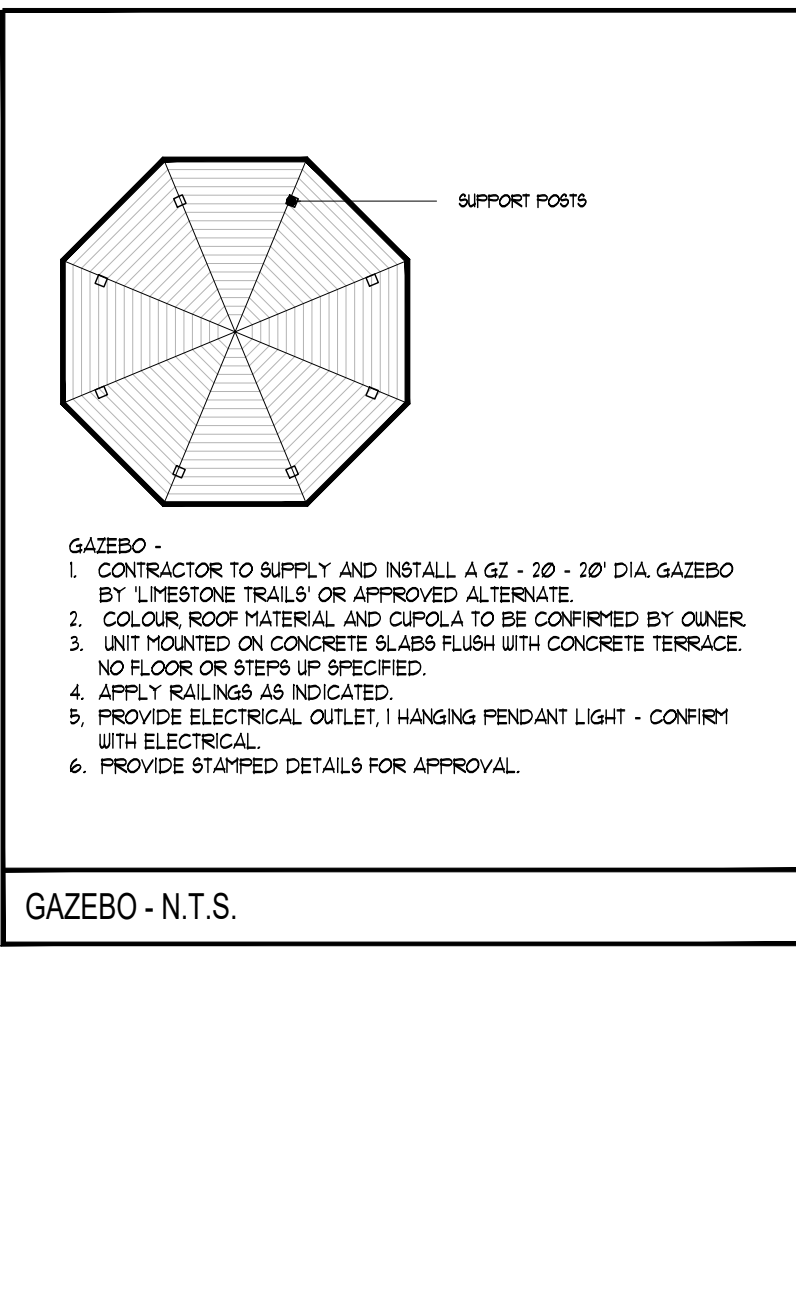
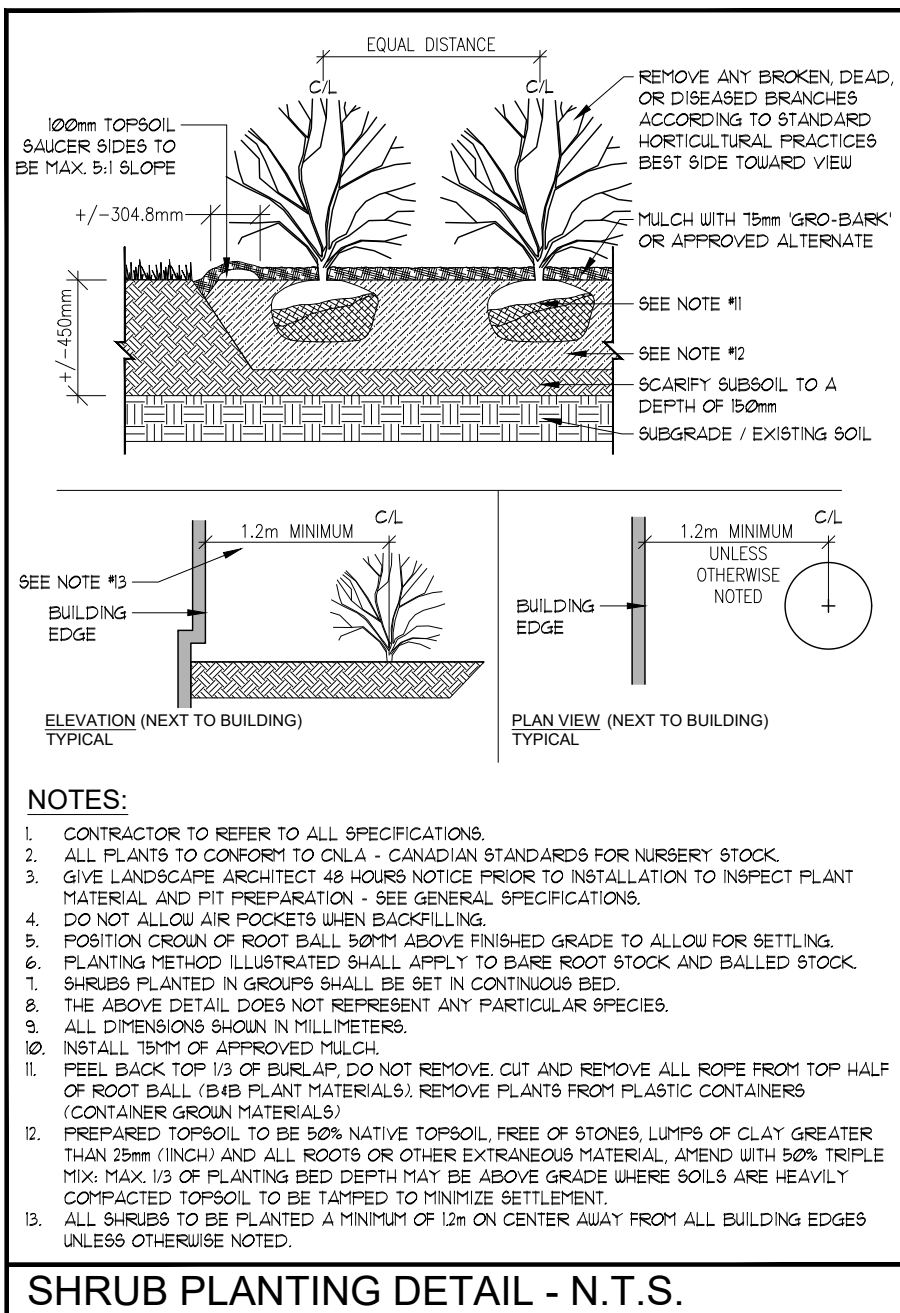
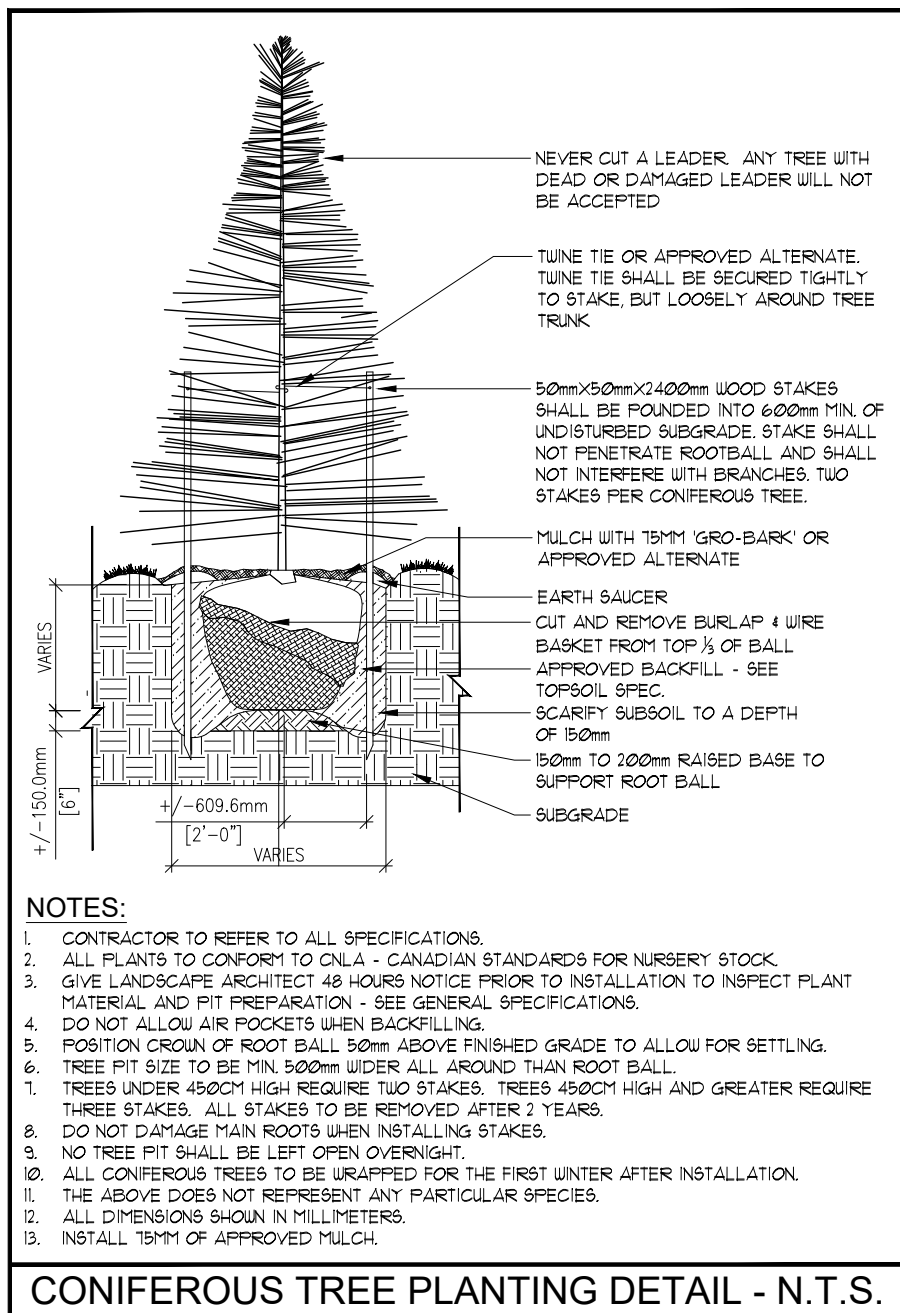
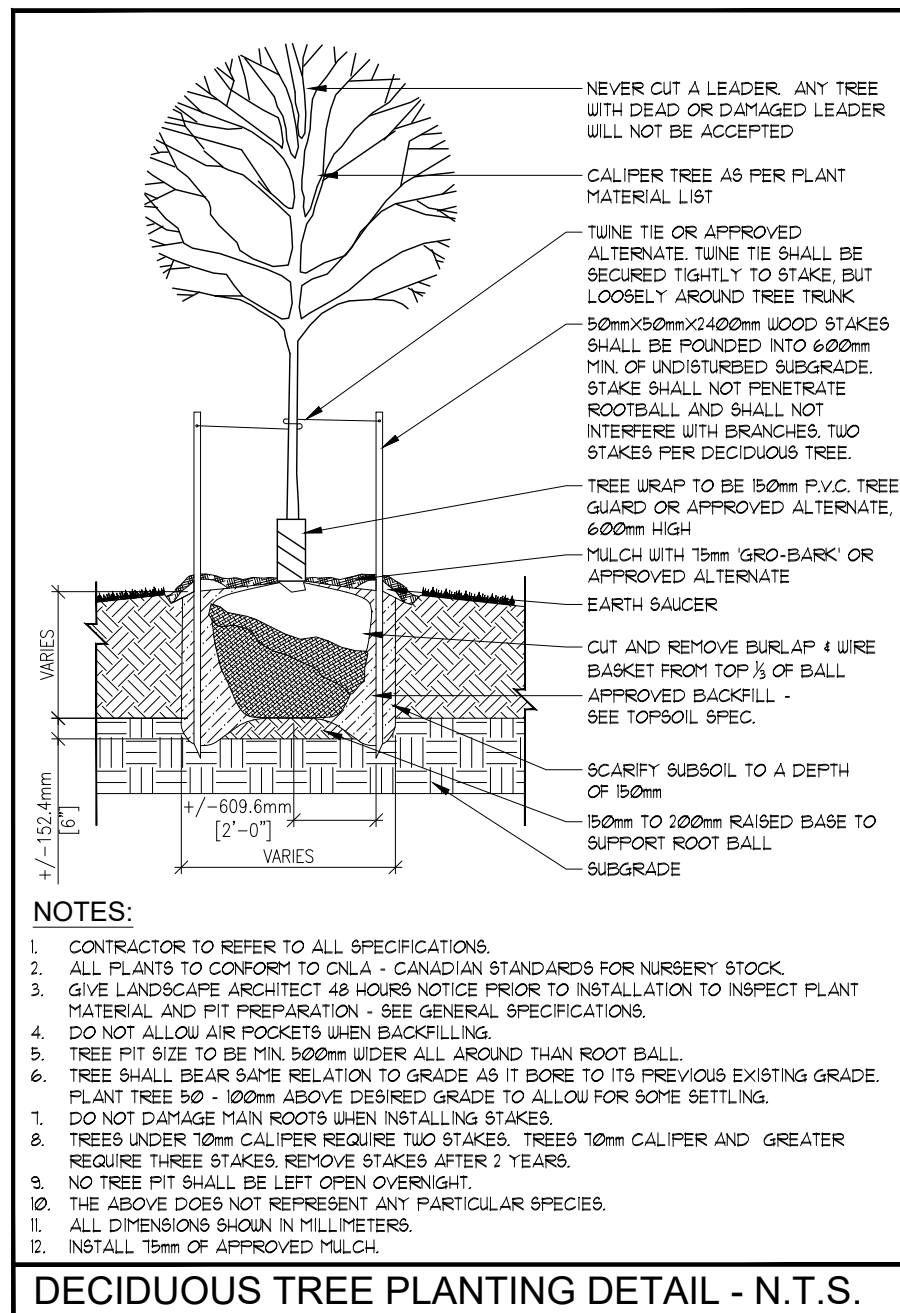

#	DATE	REVISION	BY
11	JAN 27 2023	RE-ISSUED FOR SITE PLAN CONTROL APPLICATION & ZONING BY-LAW AMENDMENT	MCB
10	DEC 16 2022	RE-ISSUED FOR MULTIC WORKING DRAWINGS	MCB
9	AUG 19 2022	ISSUED FOR SITE PLAN CONTROL APPLICATION	MCB
8	AUG 19 2022	ISSUED FOR ZONING BY-LAW AMENDMENT	MCB
7	JUL 23 2022	ISSUED FOR ZONING BY-LAW AMENDMENT	MCB
6	FEB 24 2022	ISSUED FOR ZONING BY-LAW AMENDMENT	MCB
5	DEC 02 2021	ISSUED FOR SPA & ZONING BY-LAW AMENDMENT	MCB
4	NOV 19 2021	ISSUED FOR 100% DD	MCB
3	NOV 19 2021	ISSUED FOR 25% SPA	MCB
2	OCT 22 2021	ISSUED FOR 50% DD	MCB
1	AUG 26 2021	ISSUED FOR 100% SD	MCB

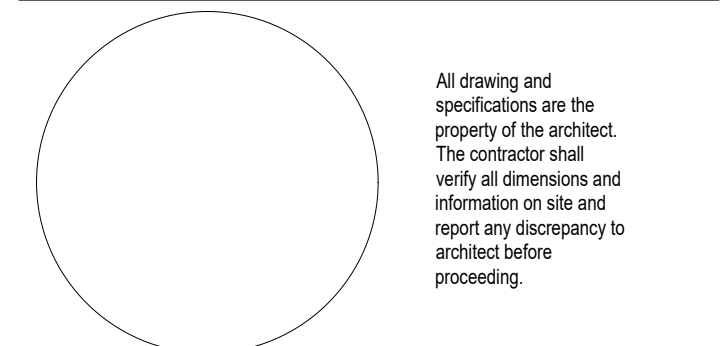

Arch Corp - Orleans
1161 OLD MONTREAL RD
ORLEANS ON, K4A 3N6

LANDSCAPE DETAILS
1of2

scale:	AS NOTED
drawn by:	MCB
reviewed by:	MCB
job number:	21-164-p
plot date:	22-12-16
drawing number:	L-3

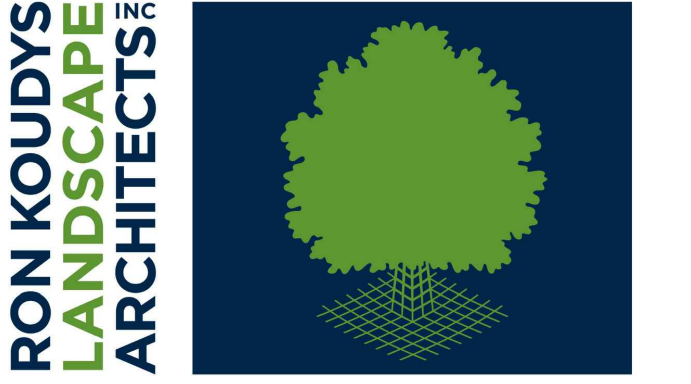
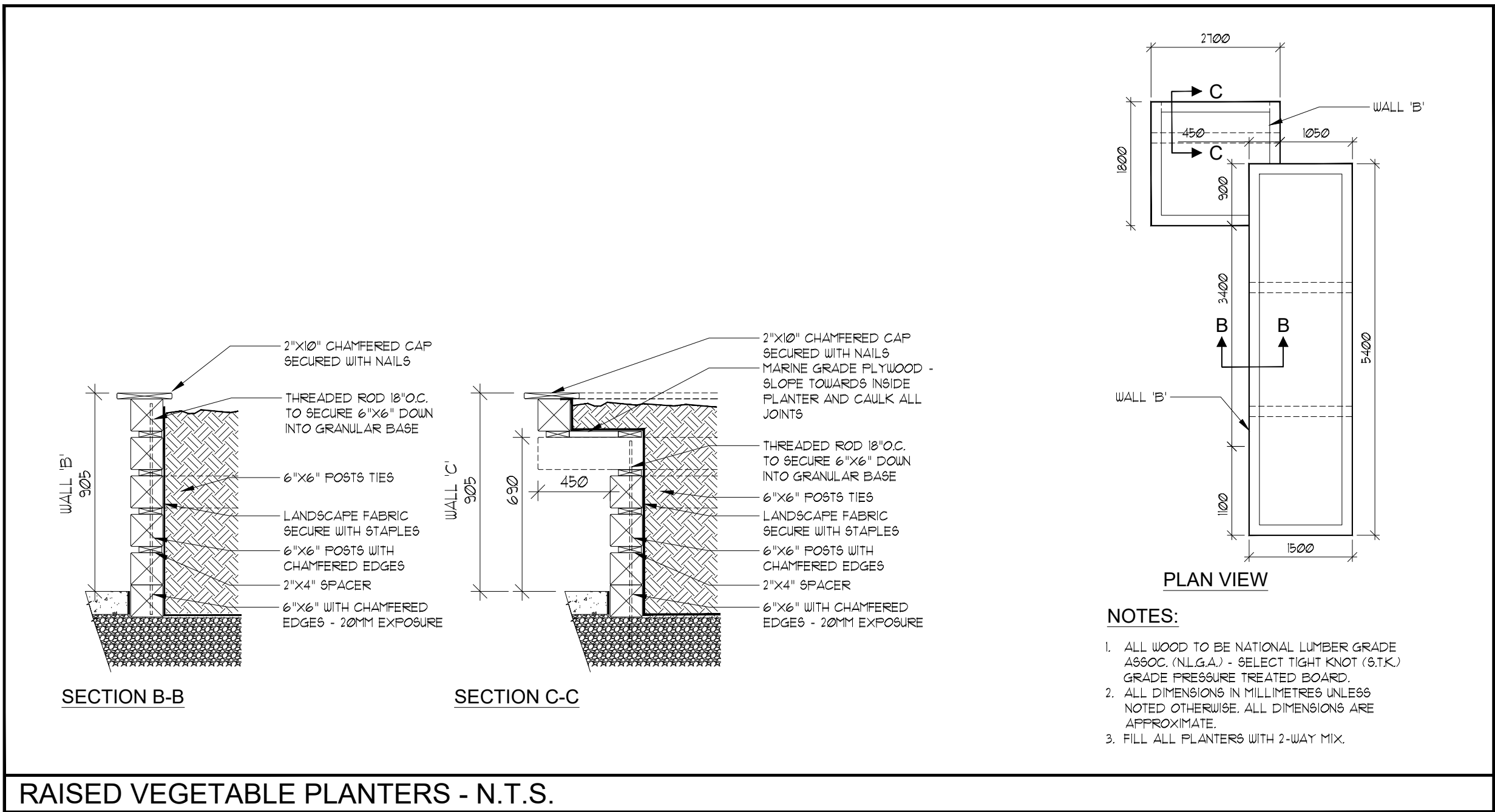
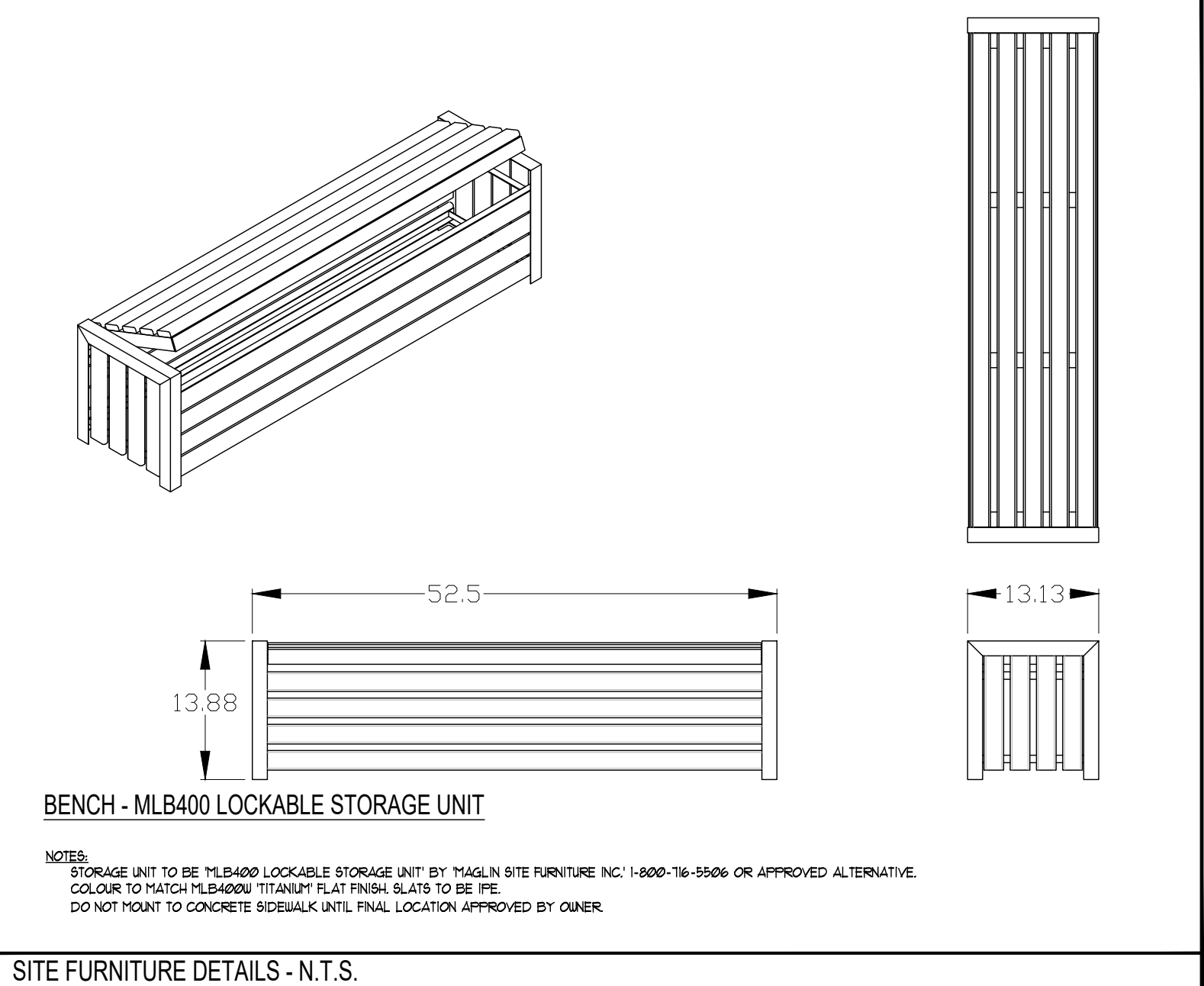
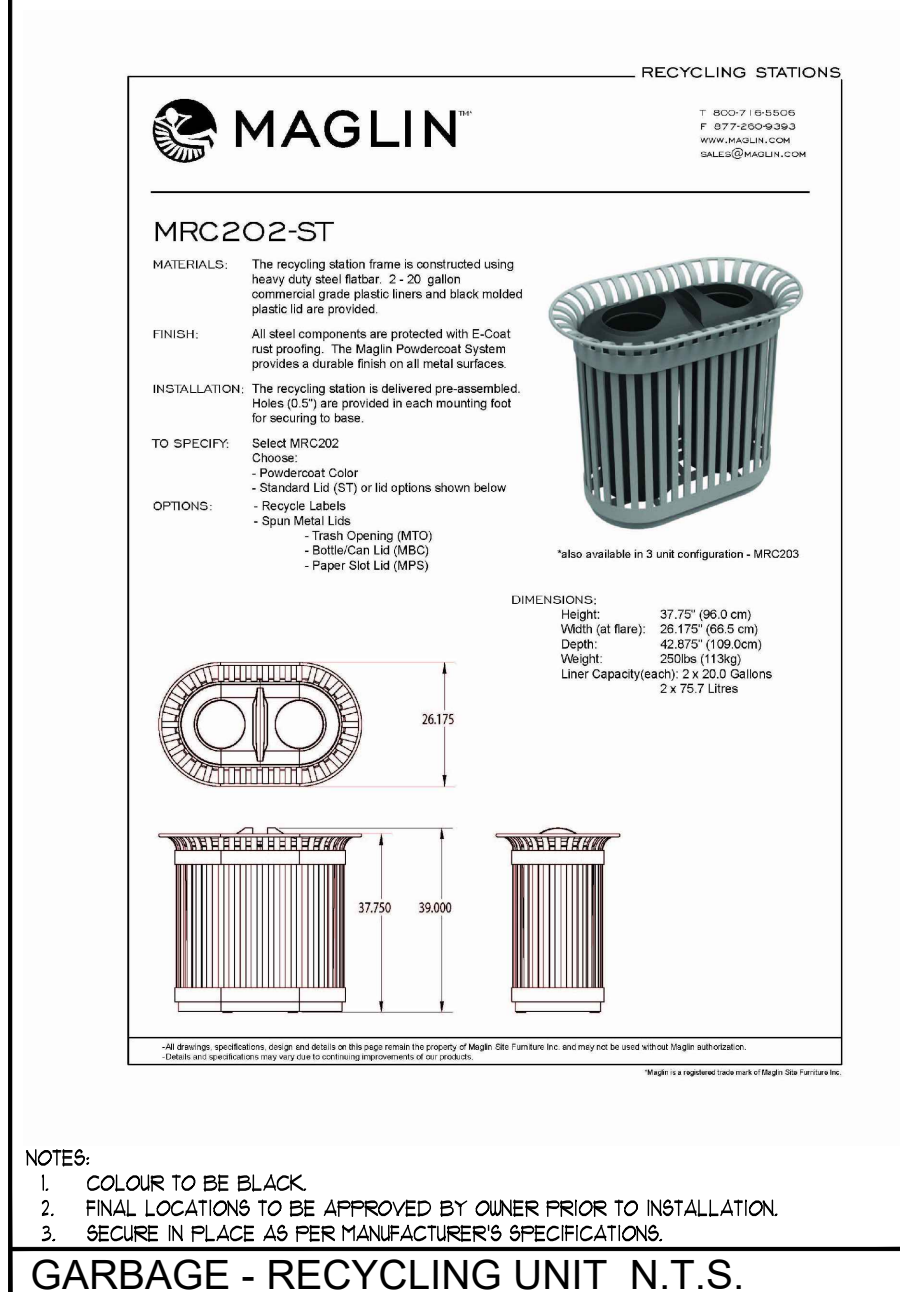
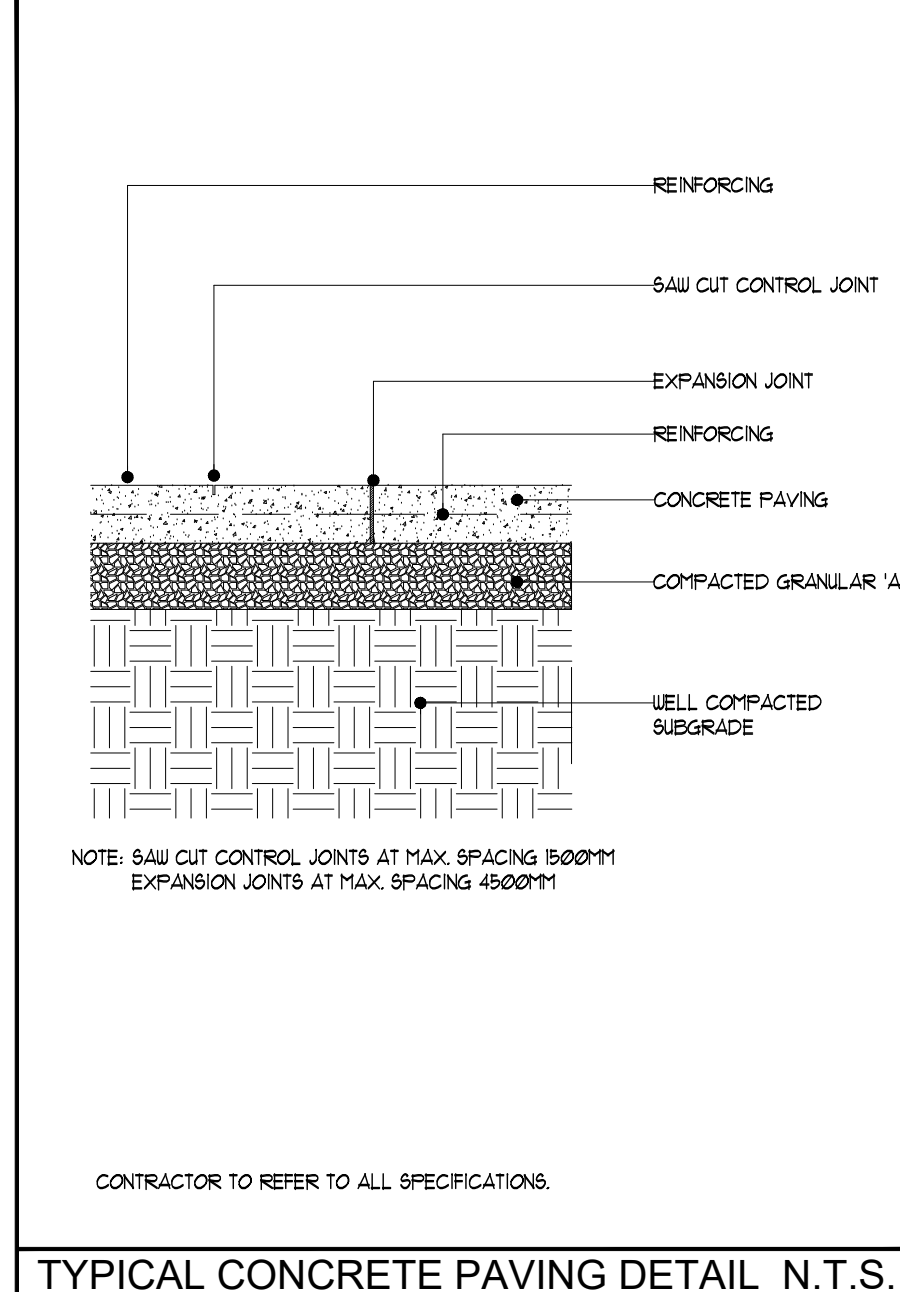
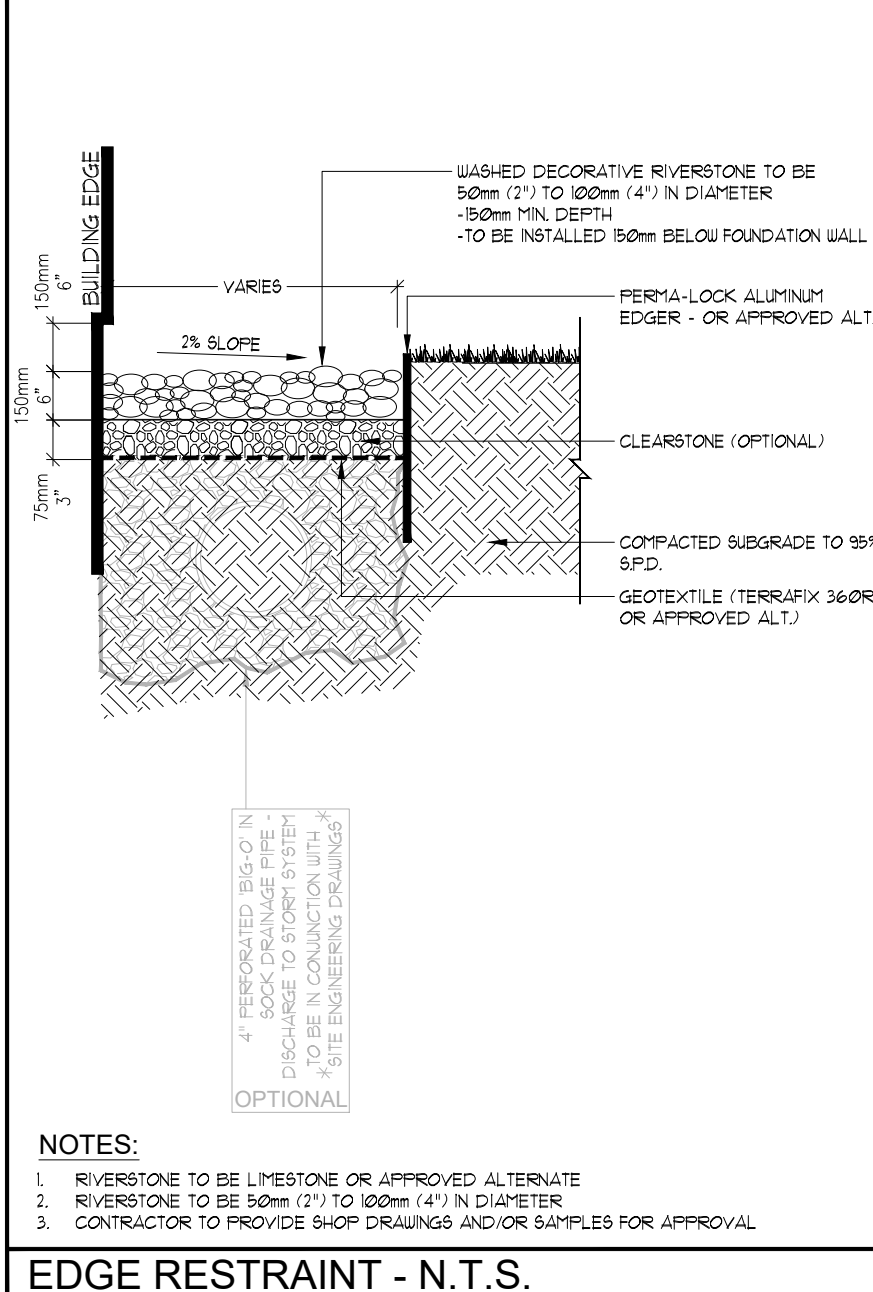
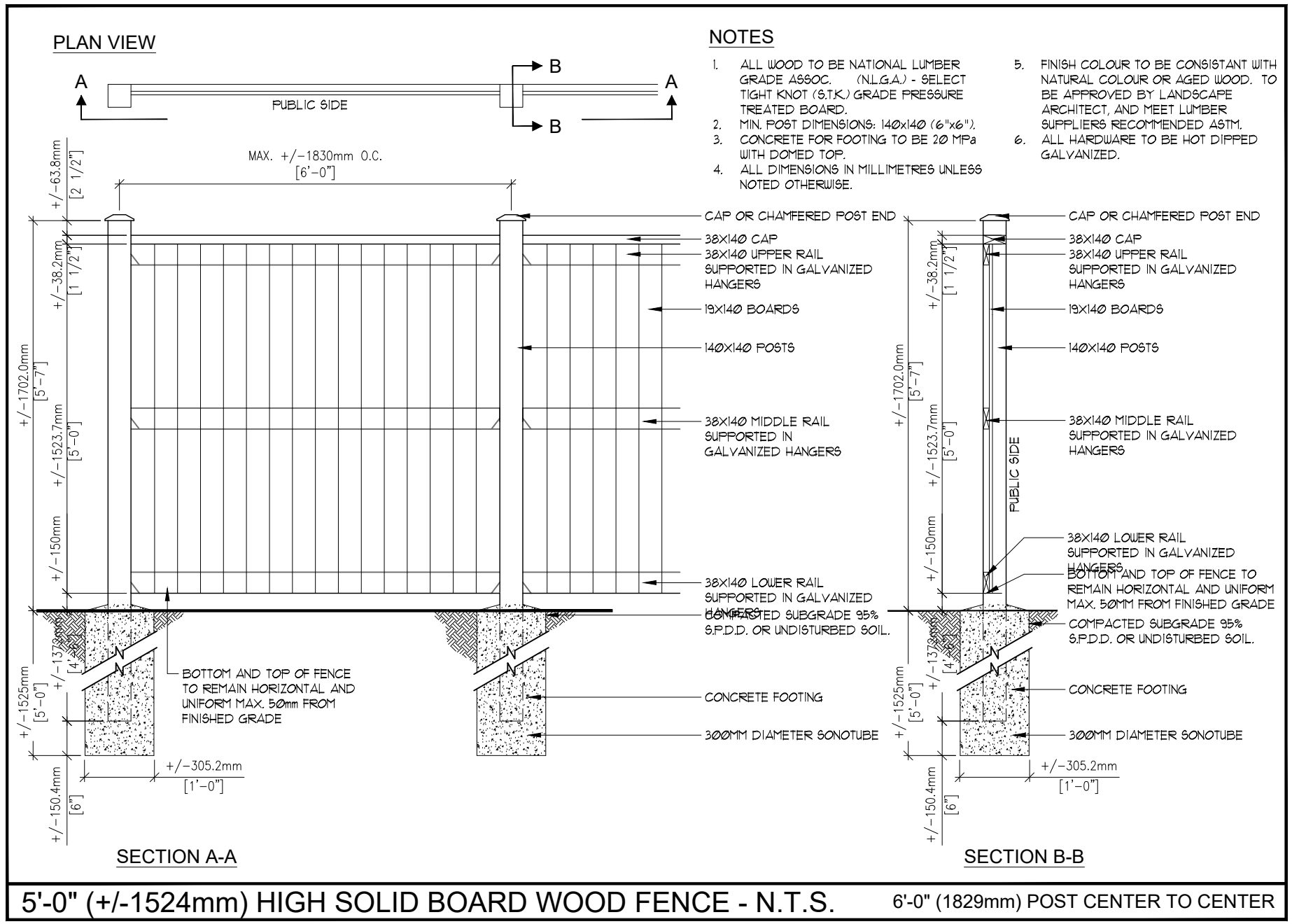
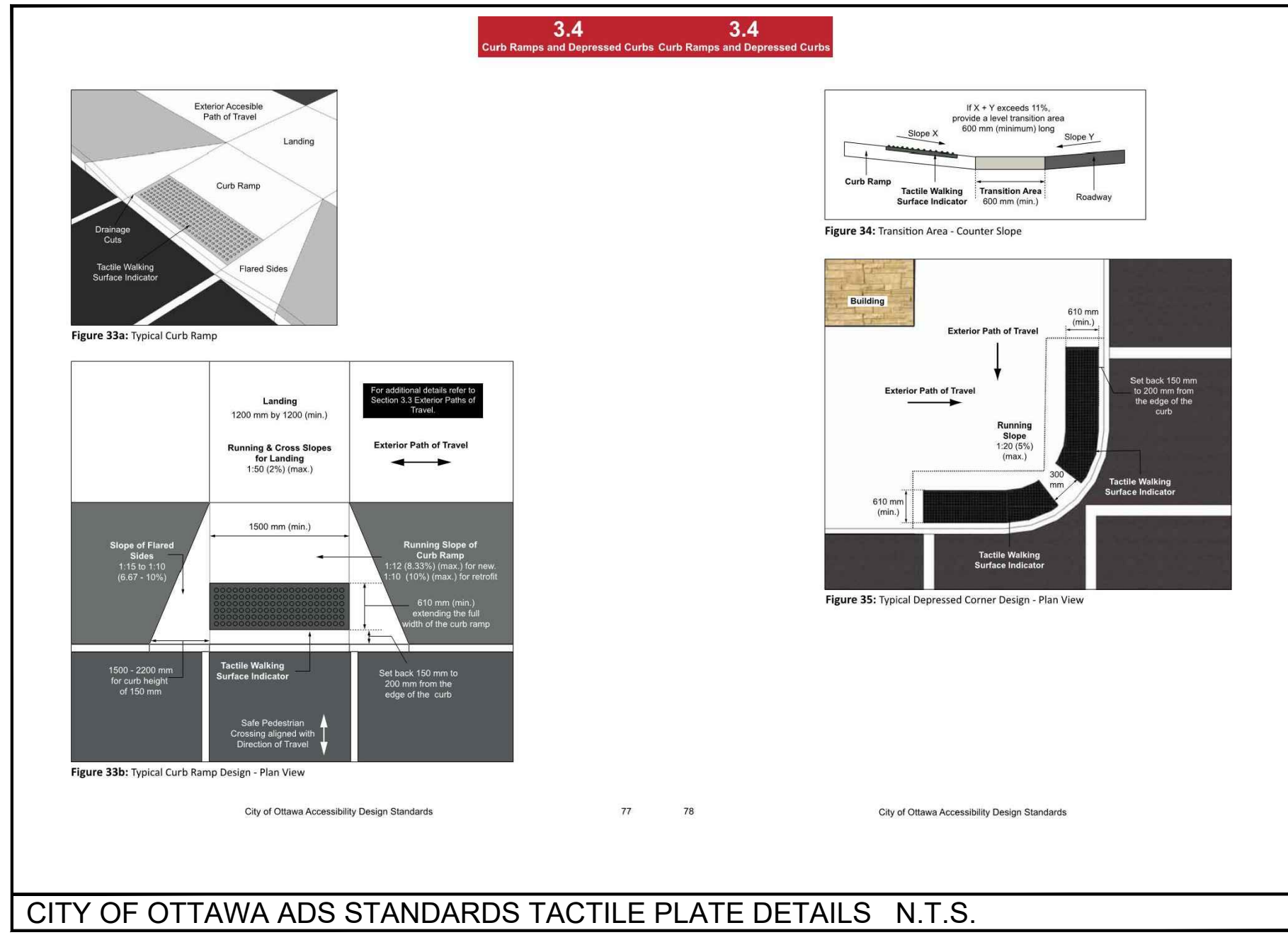
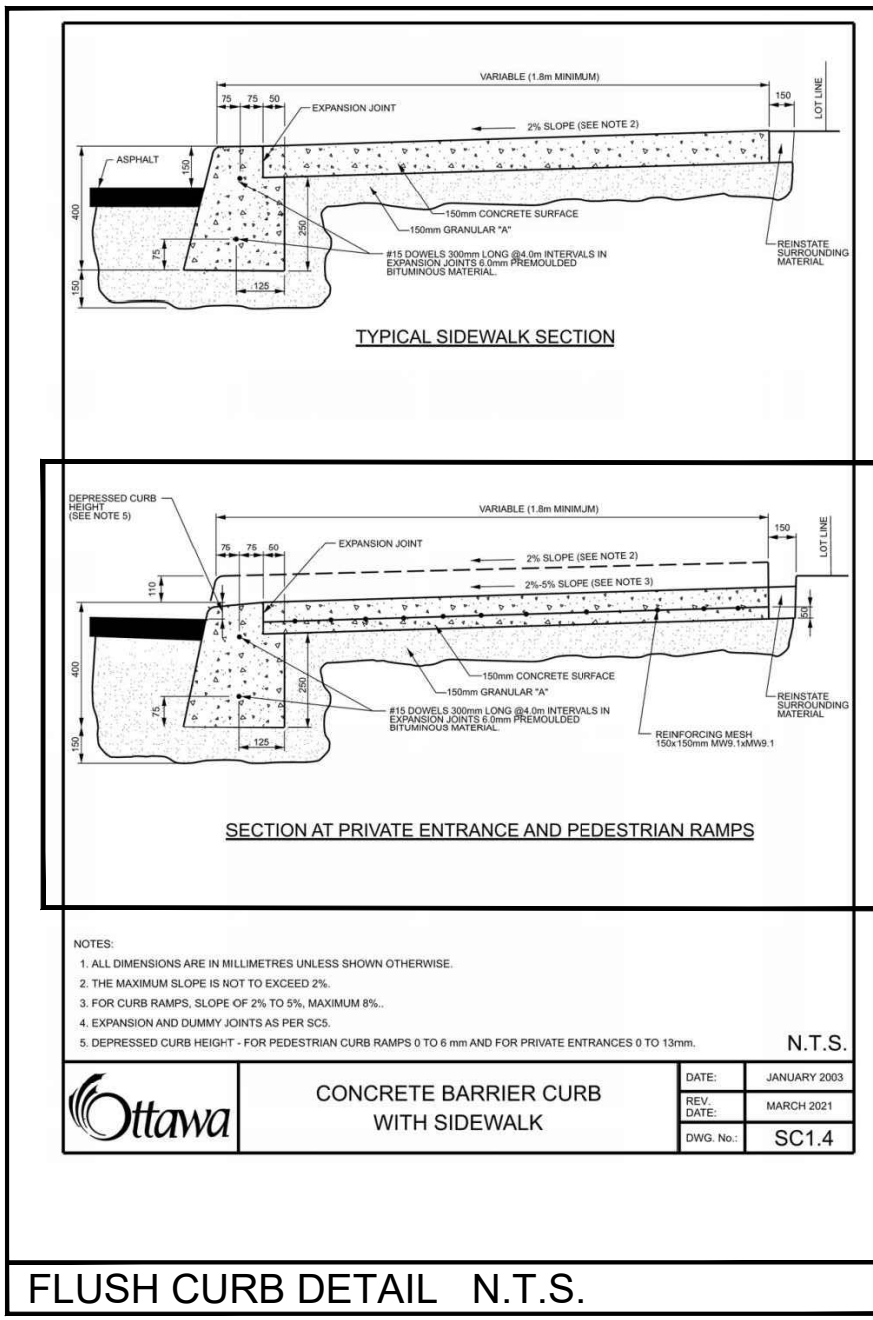

ALL DRAWINGS REMAIN THE PROPERTY OF THE LANDSCAPE ARCHITECT AND SHALL NOT BE REPRODUCED OR REUSED WITHOUT THE LANDSCAPE ARCHITECT'S WRITTEN PERMISSION.

THIS DRAWING SHALL NOT BE USED FOR CONSTRUCTION OR TENDER PURPOSES UNLESS SIGNED AND DATED BY RONALD H. KOUDYS, O.A.L.A. C.S.L.A. LANDSCAPE ARCHITECT, LONDON, ONTARIO (519) 687-3322.

Ronald H. Koudys, O.A.L.A. C.S.L.A. DATE

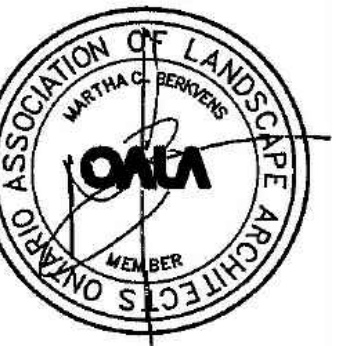

#	date	revision	by
11.	JAN 27 2023	RE-ISSUED FOR SITE PLAN CONTROL APPLICATION & ZONING BY-LAW AMENDMENT	MCB
10.	DEC 16 2022	RE-ISSUED FOR MULTIC WORKING DRAWINGS	MCB
9.	AUG 19 2022	ISSUED FOR SITE PLAN CONTROL APPLICATION	MCB
8.	AUG 19 2022	ISSUED FOR ZONING BY-LAW AMENDMENT	MCB
7.	JUL 29 2022	ISSUED FOR ZONING BY-LAW AMENDMENT	MCB
6.	FEB 04 2022	ISSUED FOR ZONING BY-LAW AMENDMENT	MCB
5.	DEC 02 2021	ISSUED FOR SPA & ZONING BY-LAW AMENDMENT	MCB
4.	NOV 19 2021	ISSUED FOR 100% DD	MCB
3.	NOV 19 2021	ISSUED FOR 25% SPA	MCB
2.	OCT 22 2021	ISSUED FOR 50% DD	MCB
1.	AUG 26 2021	ISSUED FOR 100% SD	MCB

All drawing and specifications are the property of the architect. The contractor shall verify all dimensions and information on site and report any discrepancy to architect before proceeding.

Arch Corp - Orleans

1161 OLD MONTREAL RD, ORLEANS ON, K4A 3N6

LANDSCAPE DETAILS
 2of2

scale: AS NOTED
 drawn by: MCB
 reviewed by: MCB
 job number: 21-164p
 plot date: 22-12-16
 drawing number: