

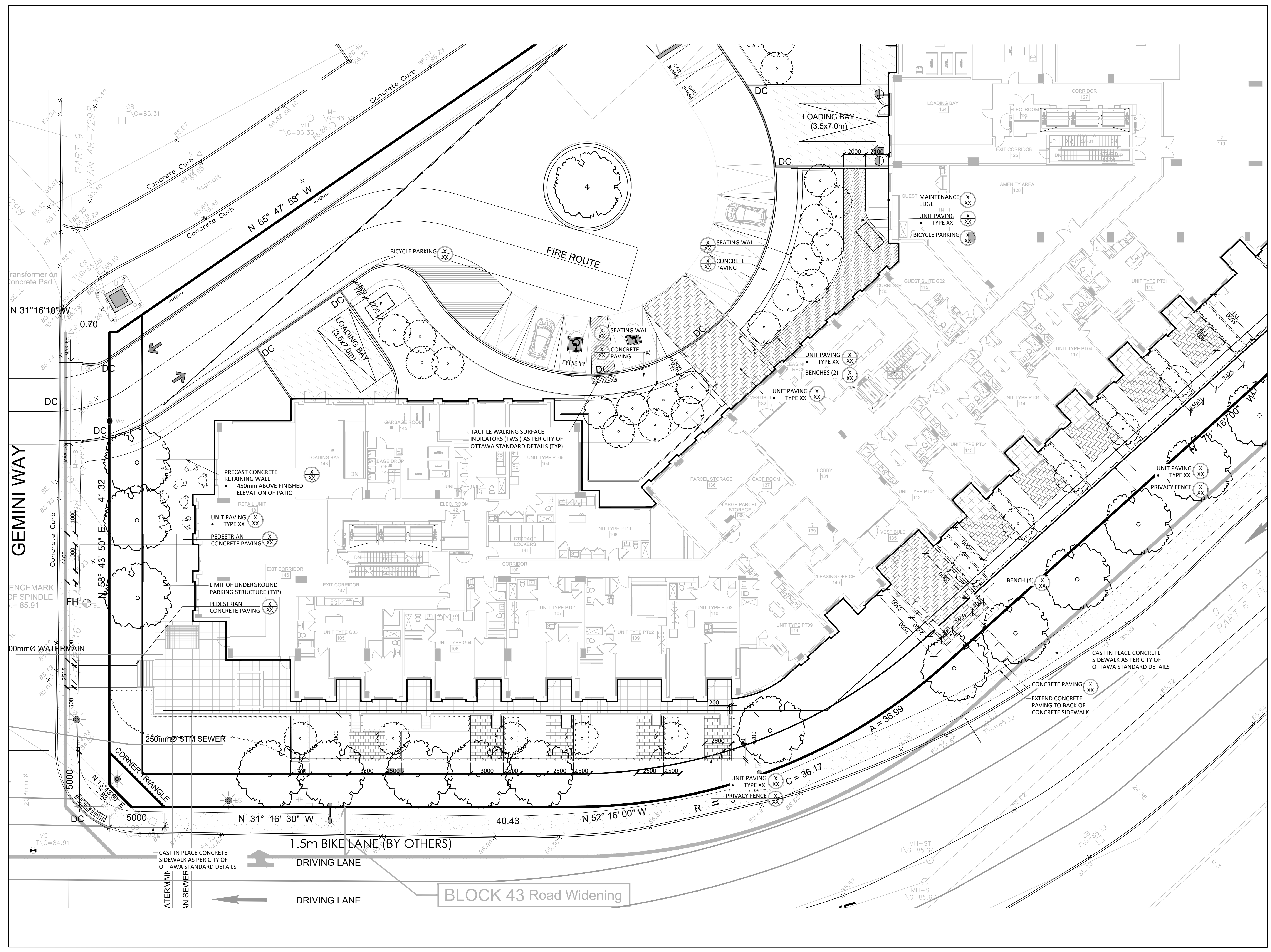

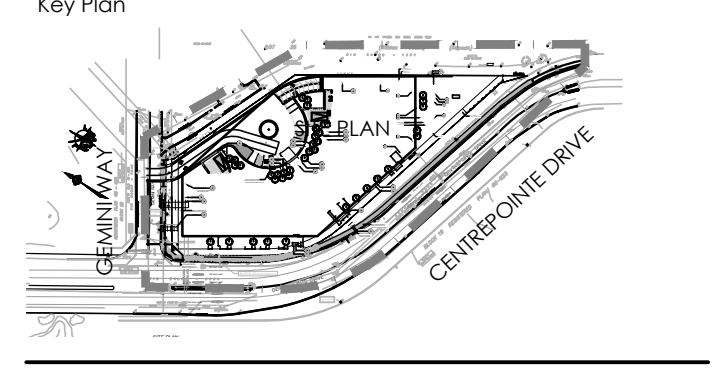

Contractor shall check all dimensions on the work and report any discrepancy to the Landscape Architect before proceeding. All drawings and specifications are the property of the Landscape Architect and must be returned at the completion of the work. This drawing is not to be used for construction until signed by the Landscape Architect.



No.	Description	Date
9	Issued for 60% Review	Oct 20/22
8	Issued for Foundation Permit	Oct 14/22
7	Progress Submission	Sept 16/22
6	Issued for Planting Review	May 30/22
5	Issued for Review	May 26/22
4	Re-issued for Third Submission	Feb 25/22
3	Issued for Third Submission	Jan 12/22
2	Issued for Second Submission	Sept 8/21
1	Issued for First Submission	May 4/21

CONSULTANTS	
ARCHITECT	ROBERTS LANEY ARCHITECTS INC. 54 BEECH STREET, OTTAWA, ON K1S 3A4
ENGINEER	DAVID SCHAFER ENGINEERING LTD. 15 BEECH STREET, OTTAWA, ON K1S 3A4
SURVEYOR	ZI BARNES LTD. 15 240 LANCHESTER ROAD, OTTAWA, ON K1B 8H0
OWNER	RECHART HOMES 2280 ST. LAWRENCE BLVD. SUITE 201, OTTAWA, ON K1G 4E1
PLANNING	FORIN PLANNING + DESIGN 223 MCLEOD STREET, OTTAWA, ON K2P 0B8

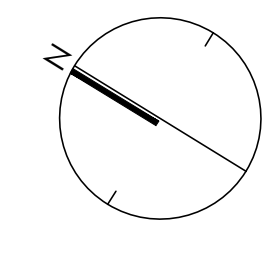

**NAK**  
design strategies

1285 WELLINGTON STREET WEST, OTTAWA, ON K1Y 3A8 CANADA  
T 613.237.2345 F 613.237.4423 [NAKDESIGNSTRATEGIES.COM](http://NAKDESIGNSTRATEGIES.COM)

19 CENTREPOINTE DRIVE

Title	GROUND FLOOR NORTH LAYOUT PLAN	
Date	April 07, 2021	Sheet
Scale	1:150	
Drawn	AM	
Checked	SC	
Job No.	20-039	
		L-02



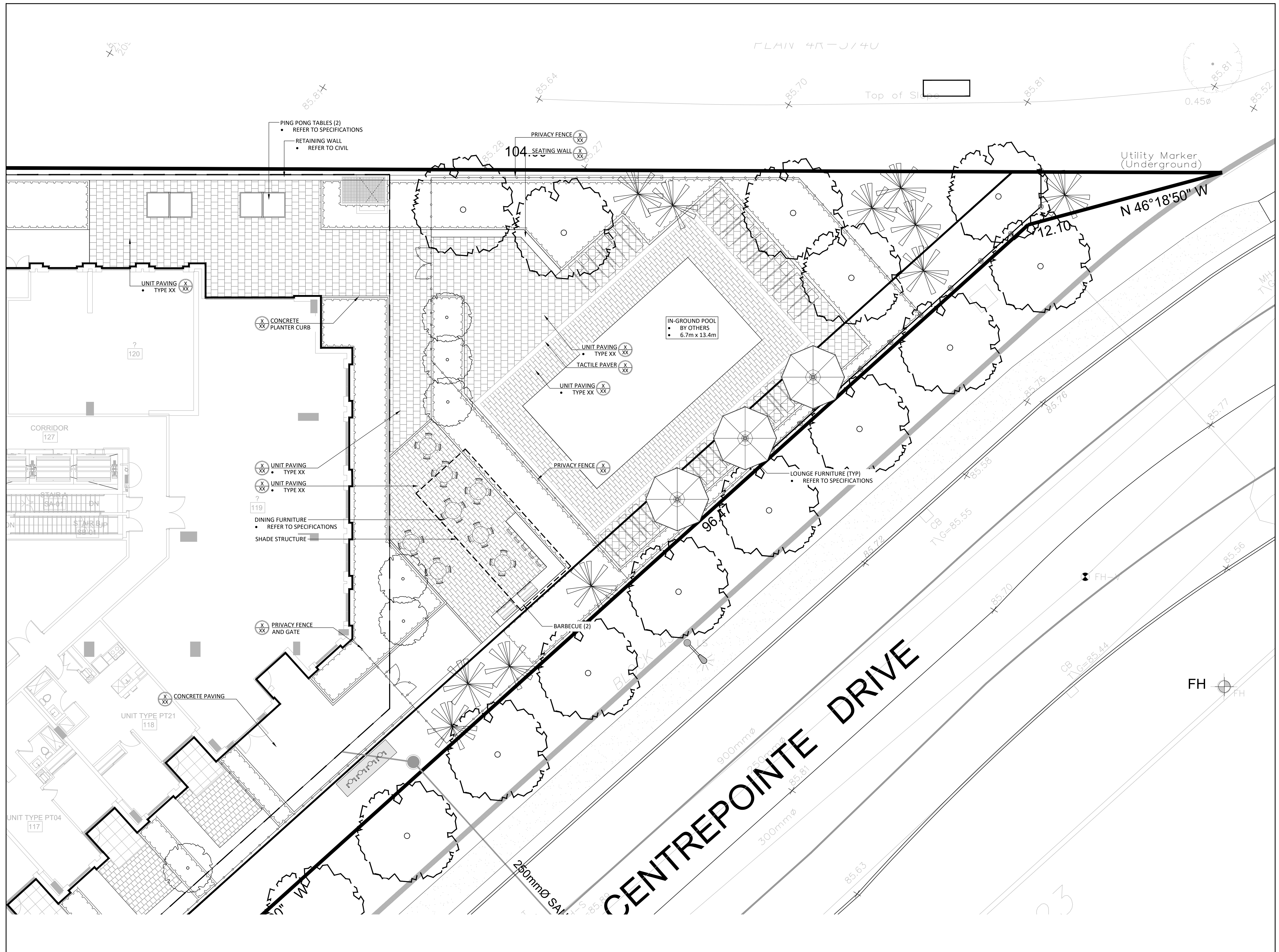

Contractor shall check all dimensions on the work and report any discrepancy to the Landscape Architect before proceeding. All drawings and specifications are the property of the Landscape Architect and must be returned at the completion of the work. This drawing is not to be used for construction until signed by the Landscape Architect.

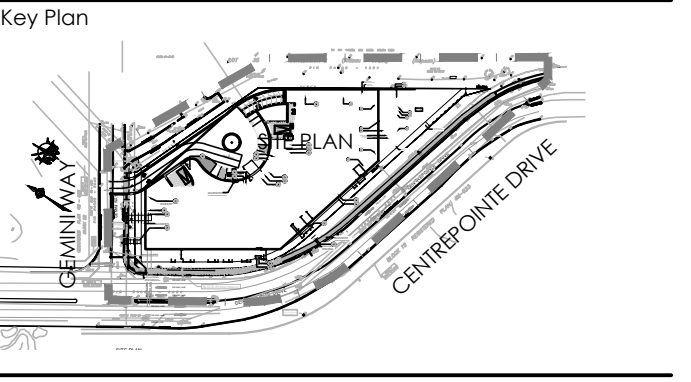

No.	Description	Date
9	Issued for 60% Review	Oct 20/22
8	Issued for Foundation Permit	Oct 14/22
7	Progress Submission	Sept 16/22
6	Issued for Planting Review	May 30/22
5	Issued for Review	May 26/22
4	Re-issued for Third Submission	Feb 25/22
3	Issued for Third Submission	Jan 12/22
2	Issued for Second Submission	Sept 8/21
1	Issued for First Submission	May 4/21

CONSULTANTS	
ARCHITECT	ROSENCK LANEY ARCHITECTS INC. 54 BEECH STREET, OTTAWA, ON, K1S 3J4
ENGINEER	DAVID SCHAFER ENGINEERING LTD. 15 BEECH ST. SUITE 201, OTTAWA, ON, K1S 3J4
SURVEYOR	JZ BARNES LTD. 15-2450 LANCASTER ROAD, OTTAWA, ON, K1B 9H3
OWNER	BECHTEL INVEST 2280 ST. LAWRENCE BLVD. SUITE 201, OTTAWA, ON, K1G 4E1
PLANNING	FOURIN PLANNING + DESIGN 223 MCLEOD STREET, OTTAWA, ON, K2P 0B8

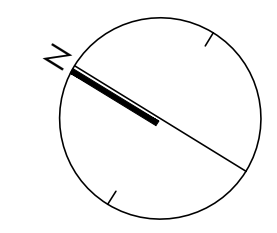

**NAK**  
design strategies

1285 WELLINGTON STREET WEST, OTTAWA, ON K1Y 3A8 CANADA  
T 613.237.2345 F 613.237.4423 [NAKDESIGNSTRATEGIES.COM](http://NAKDESIGNSTRATEGIES.COM)  
Project

19 CENTREPOINTE DRIVE

Title  
GROUND FLOOR AMENITY

Date April 07, 2021 Sheet  
Scale 1:100  
Drawn AM  
Checked SC  
Job No. 20-039

**L-03**



Contractor shall check all dimensions on the work and report any discrepancy to the Landscape Architect before proceeding. All drawings and specifications are the property of the Landscape Architect and must be returned at the completion of the work. This drawing is not to be used for construction until signed by the Landscape Architect.

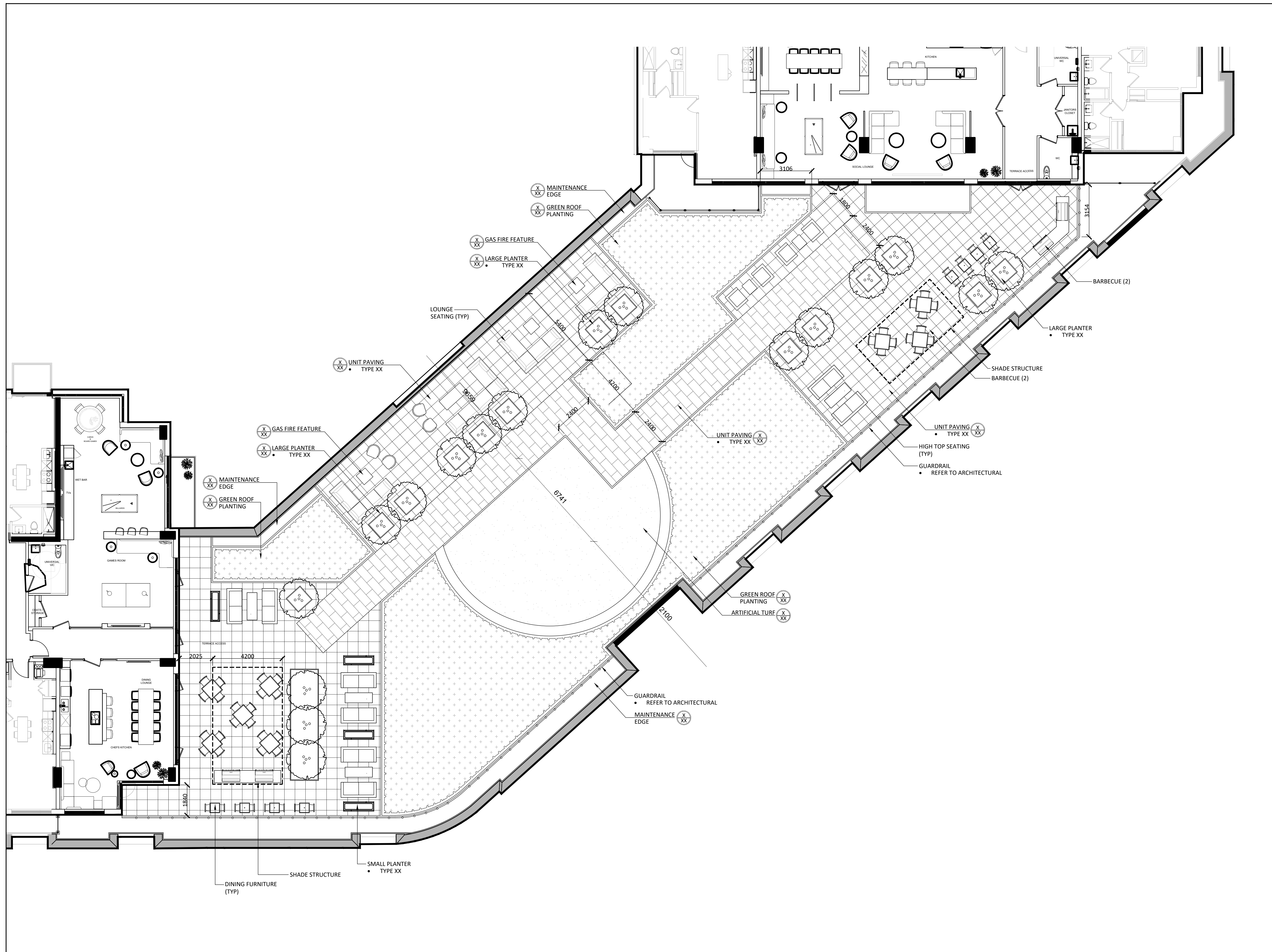
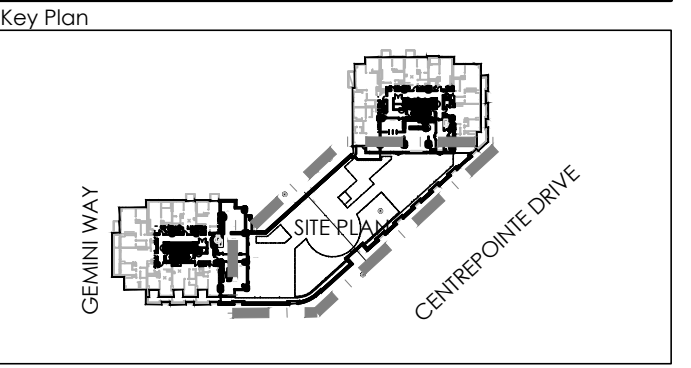

No.	Description	Date
9	Issued for 60% Review	Oct 20/22
8	Issued for Foundation Permit	Oct 14/22
7	Progress Submission	Sept 16/22
6	Issued for Planting Review	May 30/22
5	Issued for Review	May 26/22
4	Re-Issued for Third Submission	Feb 25/22
3	Issued for Third Submission	Jan 12/22
2	Issued for Second Submission	Sept 8/21
1	Issued for First Submission	May 4/21

CONSULTANTS	
ARCHITECT	RODRICK LANEY ARCHITECTS INC. 24 BEECH STREET, OTTAWA, ON K1S 3J4
ENGINEER	DAVID SCHAFER ENGINEERING LTD. 125 BIRK RD, SUITE 103, OTTAWA, ON K2S 1E9
SURVEYOR	JD BARNES LTD. 15-0400 CASCADE ROAD, OTTAWA, ON K1B 9K0
OWNER	RECHRAFT HOMES 2280 ST. LAURENT BLVD, SUITE 201, OTTAWA, ON K1G 4E1
PLANNING	FOTENI PLANNING + DESIGN 222 MCLEOD STREET, OTTAWA, ON K2P 0Z8

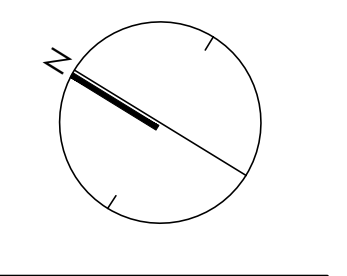

**NAK**  
design strategies

1285 WELLINGTON STREET WEST, OTTAWA, ON K1Y 3A8 CANADA  
T 613.237.2345 F 613.237.4423 [NAKDESIGNSTRATEGIES.COM](http://NAKDESIGNSTRATEGIES.COM)  
Project

19 CENTREPOINTE DRIVE

Title  
ROOF TERRACE

Date	April 07, 2021	Sheet	
Scale	1:100		
Drawn	AM		
Checked	SC		
Job No.	20-039		

L-06



Contractor shall check all dimensions on the work and report any discrepancy to the Landscape Architect before proceeding. All drawings and specifications are the property of the Landscape Architect and must be returned at the completion of the work. This drawing is not to be used for construction until signed by the Landscape Architect.

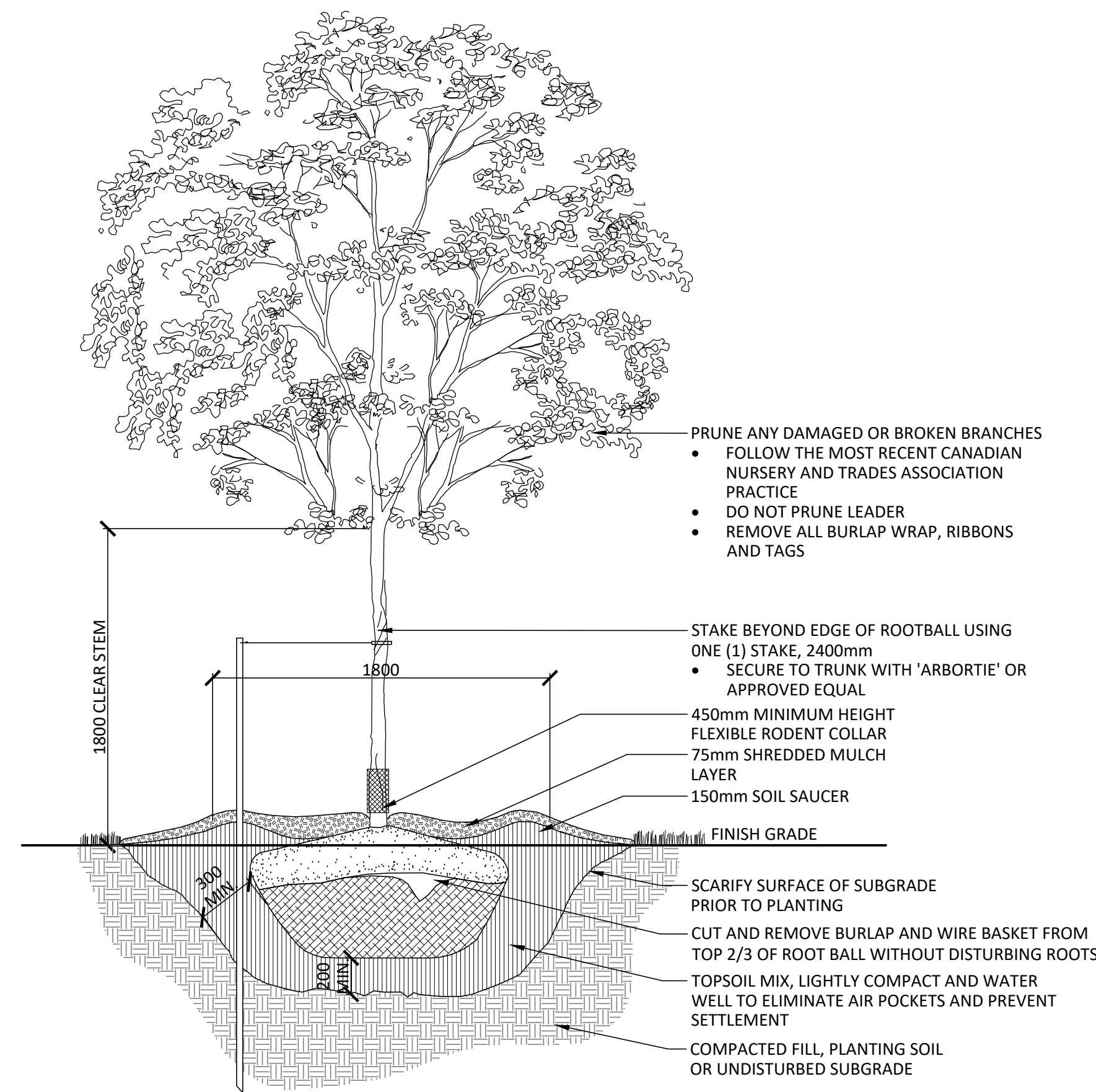

- PRUNE ANY DAMAGED OR BROKEN BRANCHES
- FOLLOW THE MOST RECENT CANADIAN NURSERY AND TRADES ASSOCIATION PRACTICE
- DO NOT PRUNE LEADER
- REMOVE ALL BURLAP WRAP, RIBBONS AND TAGS

- STAKE BEYOND EDGE OF ROOTBALL USING ONE (1) STAKE, 2400mm
- SECURE TO TRUNK WITH 'ARBORTIE' OR APPROVED EQUAL
- 450mm MINIMUM HEIGHT FLEXIBLE RODENT COLLAR
- 75mm SHREDDED MULCH LAYER
- 150mm SOIL SAUCER
- FINISH GRADE
- SCARIFY SURFACE OF SUBGRADE PRIOR TO PLANTING
- CUT AND REMOVE BURLAP AND WIRE BASKET FROM TOP 2/3 OF ROOT BALL WITHOUT DISTURBING ROOTS
- TOPSOIL MIX, LIGHTLY COMPACT AND WATER WELL TO ELIMINATE AIR POCKETS AND PREVENT SETTLEMENT
- COMPACTED FILL, PLANTING SOIL OR UNDISTURBED SUBGRADE

- NOTES:
- REMOVE STAKES AND RODENT GUARD AFTER ONE YEAR OR UNTIL TAKEOVER, UNLESS OTHERWISE DIRECTED BY THE LANDSCAPE ARCHITECT.
  - TOPSOIL MIXTURE AND SHREDDED MULCH AS PER SPECIFICATION
  - REMOVE TREE WRAP AFTER PLANTING
  - CALIPER TO BE MEASURED AT THE BASE OF TREE AT ROOT BALL

**X** DECIDUOUS TREE PLANTING

1:25

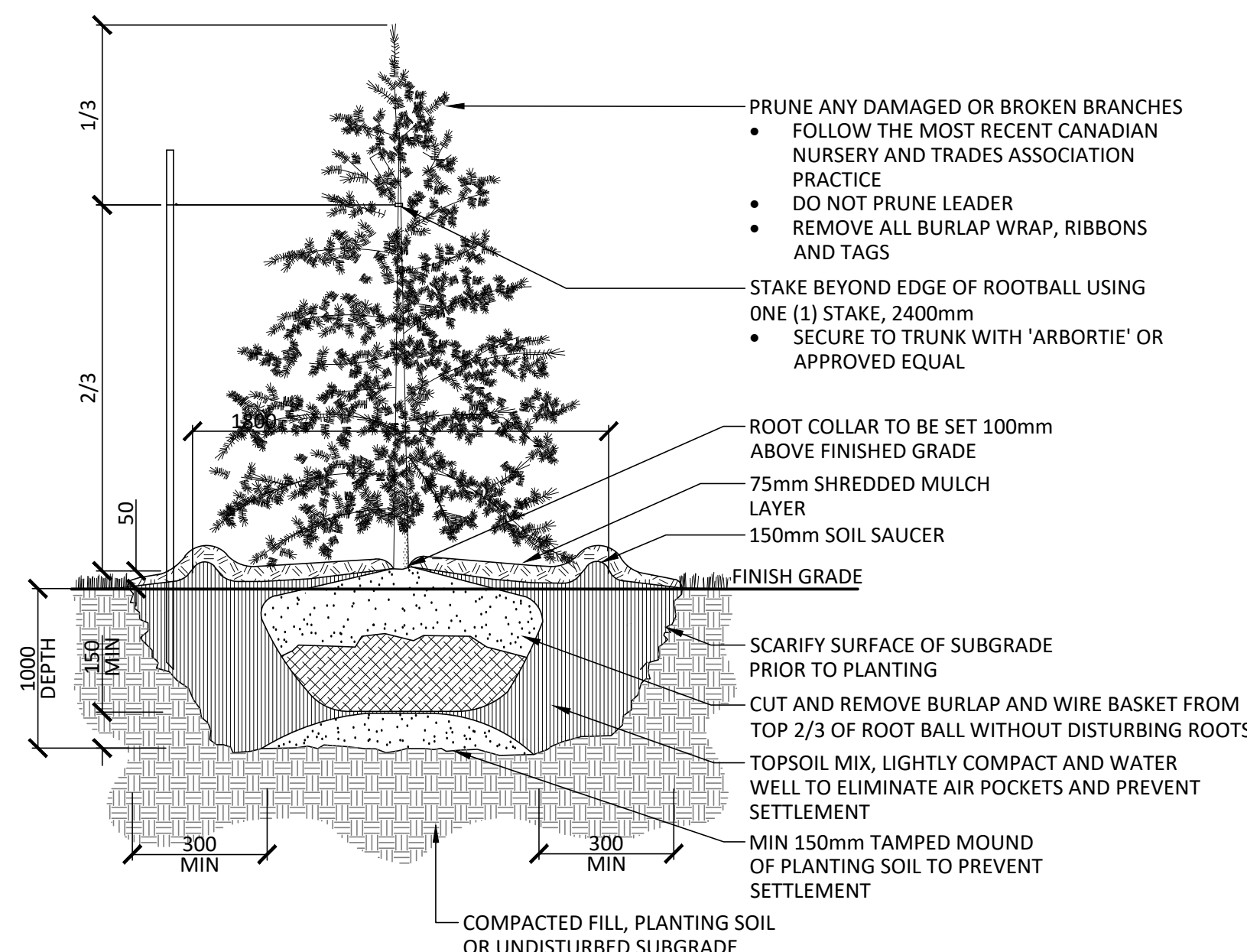

- PRUNE ANY DAMAGED OR BROKEN BRANCHES
- FOLLOW THE MOST RECENT CANADIAN NURSERY AND TRADES ASSOCIATION PRACTICE
- DO NOT PRUNE LEADER
- REMOVE ALL BURLAP WRAP, RIBBONS AND TAGS

- STAKE BEYOND EDGE OF ROOTBALL USING ONE (1) STAKE, 2400mm
- SECURE TO TRUNK WITH 'ARBORTIE' OR APPROVED EQUAL
- ROOT COLLAR TO BE SET 100mm ABOVE FINISHED GRADE
- 75mm SHREDDED MULCH LAYER
- 150mm SOIL SAUCER
- FINISH GRADE
- SCARIFY SURFACE OF SUBGRADE PRIOR TO PLANTING
- CUT AND REMOVE BURLAP AND WIRE BASKET FROM TOP 2/3 OF ROOT BALL WITHOUT DISTURBING ROOTS
- TOPSOIL MIX, LIGHTLY COMPACT AND WATER WELL TO ELIMINATE AIR POCKETS AND PREVENT SETTLEMENT
- MIN 150mm TAMPED MOUND OF PLANTING SOIL TO PREVENT SETTLEMENT
- COMPACTED FILL, PLANTING SOIL OR UNDISTURBED SUBGRADE

- NOTES:
- REMOVE STAKES AFTER ONE YEAR OR UNTIL TAKEOVER UNLESS OTHERWISE DIRECTED BY THE LANDSCAPE ARCHITECT.
  - TOPSOIL MIXTURE AND SHREDDED MULCH AS PER SPECIFICATION

**X** CONIFEROUS TREE PLANTING

1:25

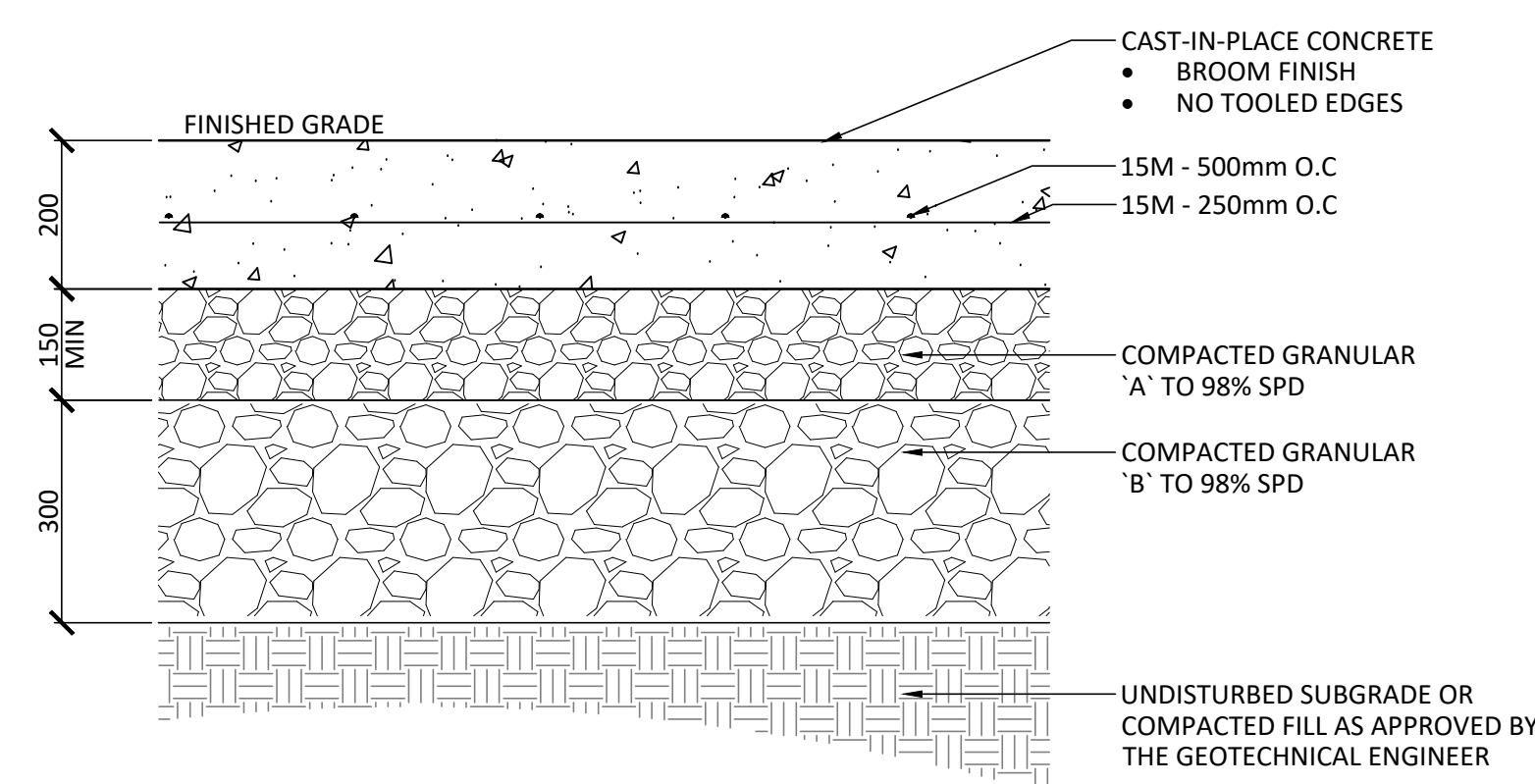

**X** VEHICULAR CONCRETE PAVING

1:10

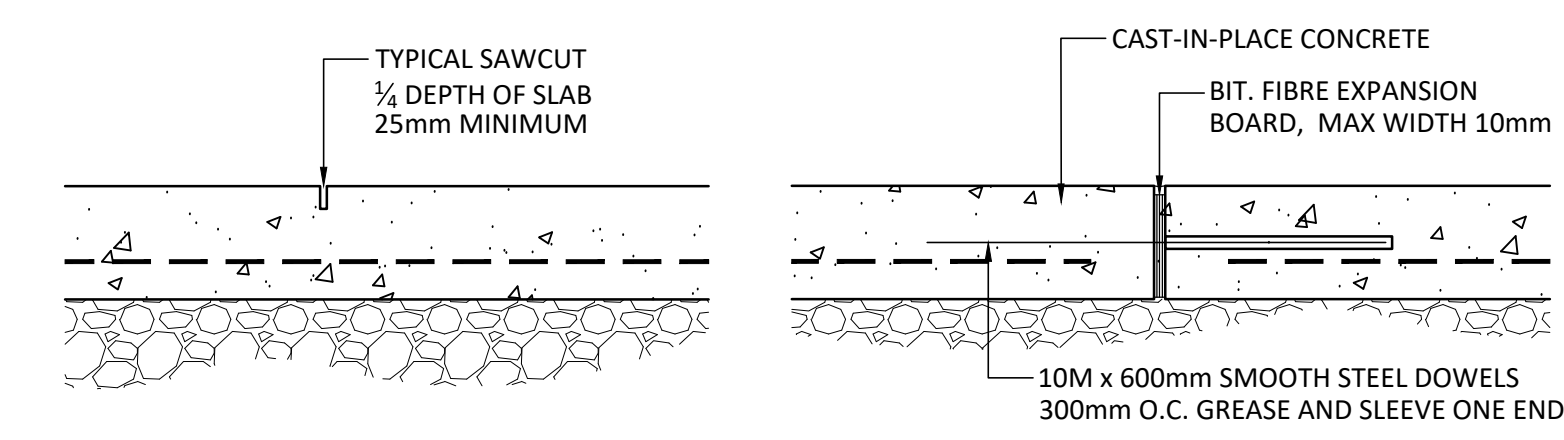

- NOTES:
- REFER TO DRAWINGS FOR JOINT LAYOUT
  - SAWCUT WITHIN 48 HOURS OF POUR
  - NO TOOLED EDGES

- NOTES:
- REFER TO DRAWINGS FOR JOINT LAYOUT
  - NO TOOLED EDGES
  - NO CAULKED JOINTS

**X** CONCRETE JOINTING

1:10

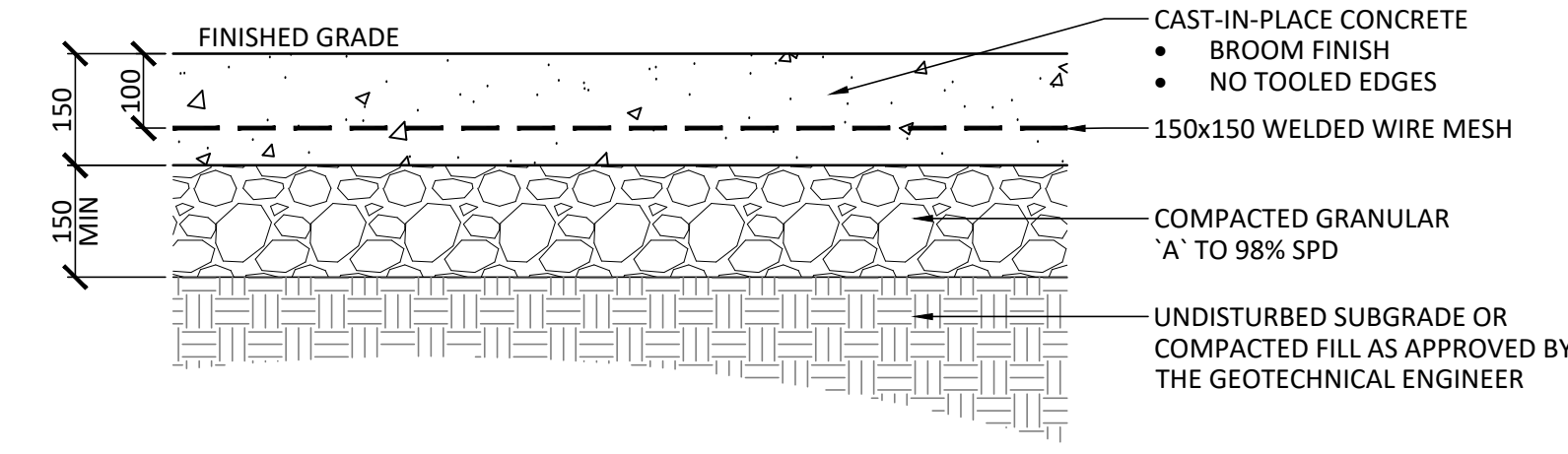

**X** PEDESTRIAN CONCRETE PAVING

1:10

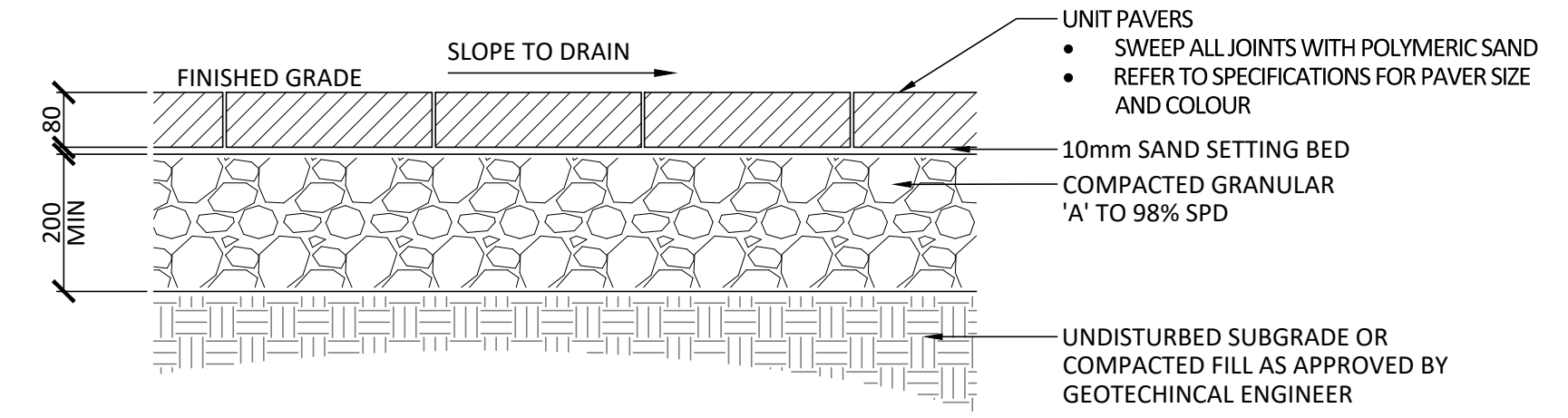

**X** UNIT PAVING

1:10

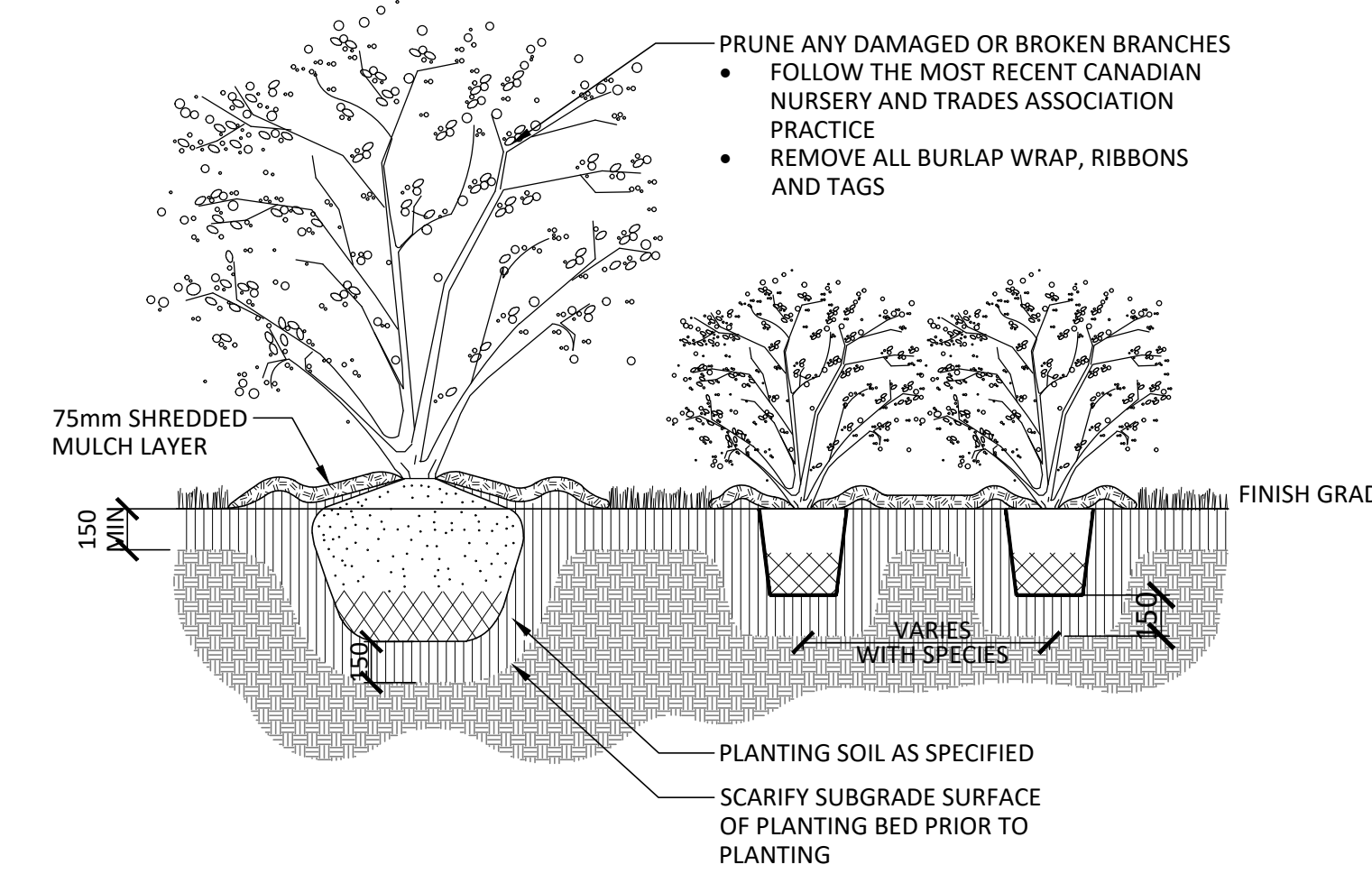

- PRUNE ANY DAMAGED OR BROKEN BRANCHES
- FOLLOW THE MOST RECENT CANADIAN NURSERY AND TRADES ASSOCIATION PRACTICE
- REMOVE ALL BURLAP WRAP, RIBBONS AND TAGS

- NOTES:
- SHRUBS SPECIFIED TO BE PLANTED SO THAT ROOTS ARE FULLY EXTENDED IN PLANTING HOLE WITH SOIL MIX BACKFILLED CAREFULLY TO PREVENT ROOT DAMAGE
  - PROVIDE 100mm HIGH EARTH SAUCER AROUND SHRUB BED

**X** SHRUB PLANTING

1:25

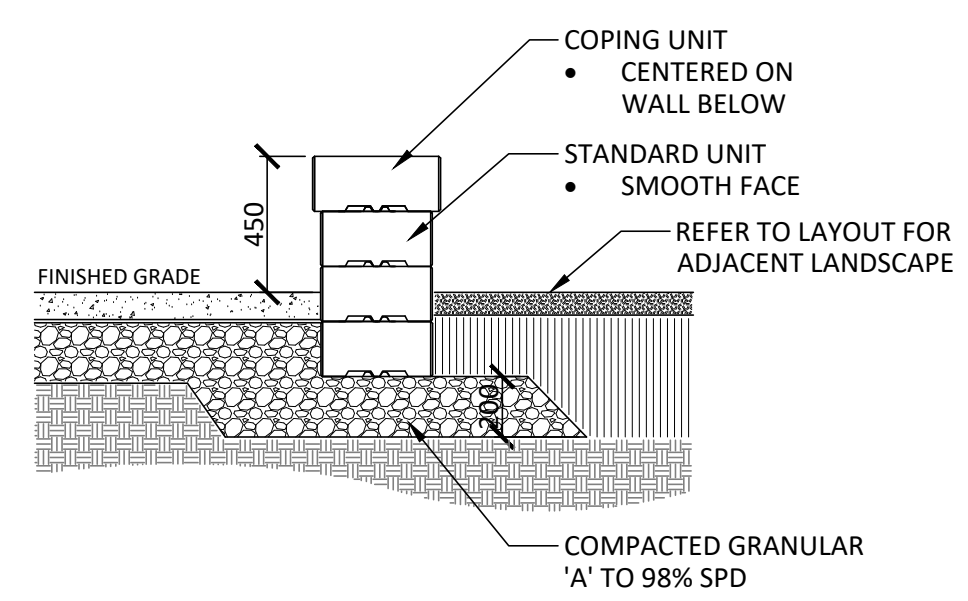

- NOTES:
- CONTRACTOR TO PROVIDE SHOP DRAWINGS FOR APPROVAL PRIOR TO INSTALLATION
  - SMOOTH FINISH
  - REFER TO SPECIFICATIONS

**X** PRECAST CONCRETE SEATING WALL

1:25

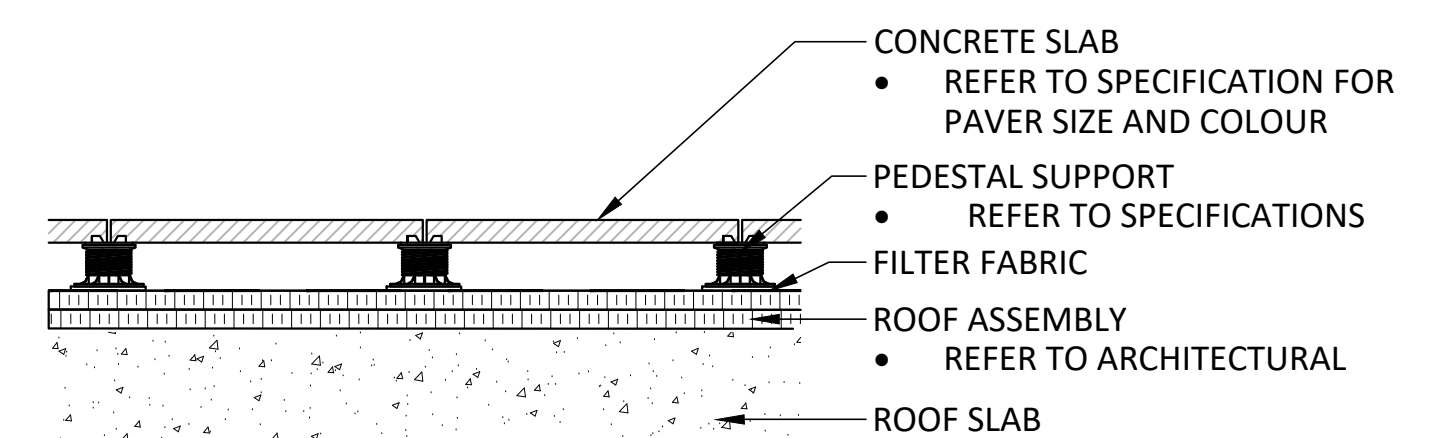

**X** ROOF TERRACE PAVING - PEDESTAL

1:20

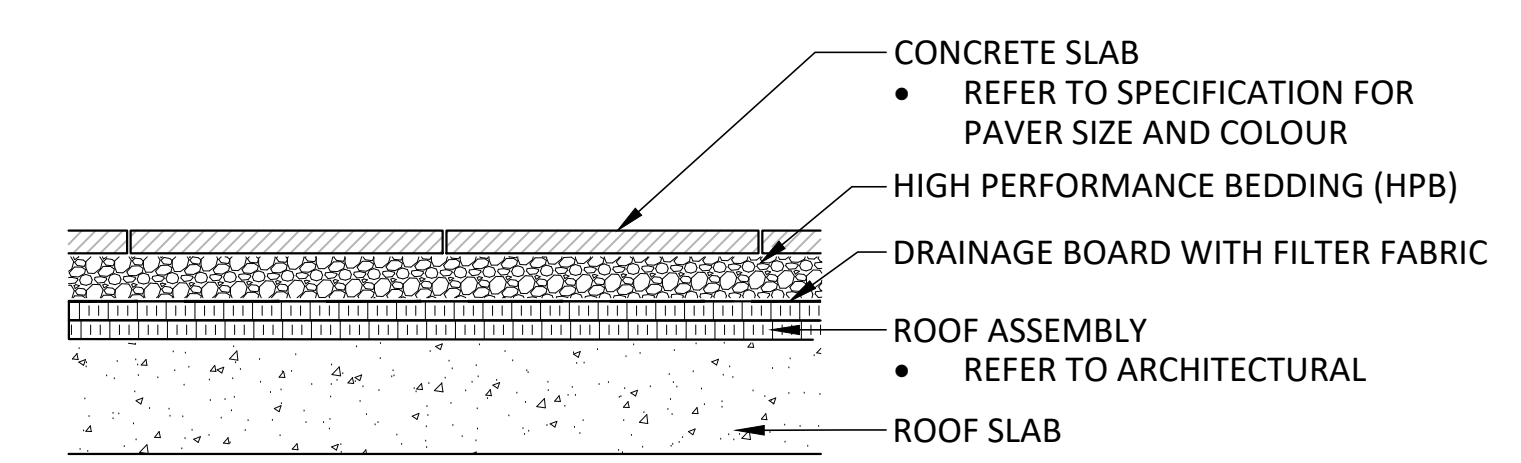

**X** UNIT PAVING ON DECK

1:20

No.	Description	Date
6	Issued for 60% Review	Oct 20/22
5	Progress Submission	Sept 16/22
4	Re-issued for Third Submission	Feb 25/22
3	Issued for Third Submission	Jan 12/22
2	Issued for Second Submission	Sept 8/21
1	Issued for First Submission	May 4/21

Revision	
No.	Description

**NAK** design strategies  
 1285 WELLINGTON STREET WEST, OTTAWA, ON K1Y 3A8 CANADA  
 T 613.237.2345 F 613.237.6423 NAKDESIGNSTRATEGIES.COM

19 CENTREPOINTE DRIVE

GROUND FLOOR DETAILS

Date	April 07, 2021	Sheet	<b>X</b>
Scale	N.T.S.		
Drawn	Ty, SH		
Checked	JSC		
Job No.	20-039		