

LEGEND

- PROPERTY LIMIT
- [Pattern] SOD
- [Pattern] SEED MIX, SEE SEED APPLICATION NOTES
- [Pattern] ORNAMENTAL GRASSES
- (Circle) PROPOSED DECIDUOUS TREE
- (Star) PROPOSED CONIFEROUS TREE
- [Pattern] PROPOSED SHRUBS
- (Circle with #) SPECIES (SEE PLANT LIST)
- (Circle with ##) QUANTITY
- [Pattern] PROPOSED PAINTED STRIPED PEDESTRIAN WALKWAYS

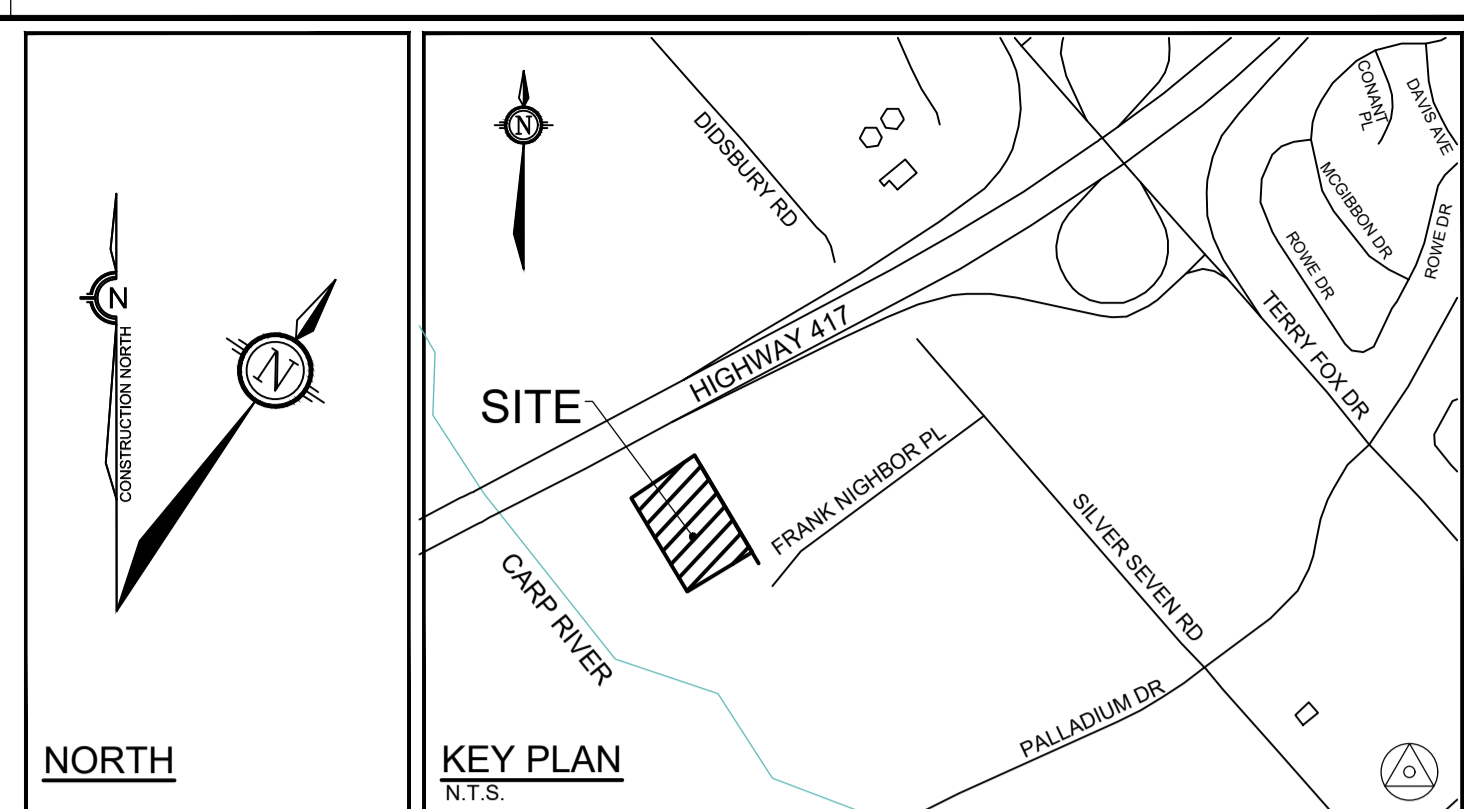

TREE PLANTING IN SENSITIVE CLAY GENERAL

- The landscape plans have been developed in accordance with the Geotechnical Investigation "PG6153-1, Revision 1" by paterson group, dated April 28, 2022, which includes the letter/memo from Joey R. Villeneuve, dated April 28, 2022, and map "Test Hole Location Plan" dated 04/2022 that confirms the categories and locations of clay soils.
- The following City of Ottawa clay soils guideline applies: Guidelines for Tree Planting in Sensitive Marine Clay Soils (2017).
- The soil volumes provided are sufficient for a reasonable chance of tree survival. Unless otherwise noted, all new trees on City property meet the minimum soil volume requirements of the following, based on a depth of 1.5m below finished grade, and subtracting the volume of utility trenches.
 - a. Small tree (mature height up to 7.5m) - 25m³/ minimum soil volume provided.
 - b. Medium tree (mature height 7.5-14m) - 30m³/ minimum soil volume provided.

Where trees share a continuous greenspace:

- c. Two (2) small trees - 15m³/ minimum soil volume provided per tree.
- d. Two (2) medium trees - 18m³/ minimum soil volume provided per tree.

SEED MIX AND APPLICATION

For areas steeper than 3:1, Contractor to apply erosion control blanket. Erosion control blanket to be machine woven mats made from natural wood, coco or cotton fiber, or combination depending on manufacturer, with stitching between two photo-degradable natural organic fiber nettings. Submit products for approval by Consultant. OPSS 804 applies except as may be amended and extended herein.

In addition to the specified seed mixes, all applications are to include a nurse crop as noted.

- NURSE CROP**
- Annual Ryegrass
 - Seeding Rate: 25kg/hectare

CUSTOM SEED MIX BY DLF PICKSEED
To be determined.

NOVATECH DETAILS

- Found on Sheet L2.
- Standard Deciduous Tree Planting
 - Standard Coniferous Tree Planting
 - Shrub and Perennial Planting
 - Bike Layout
- Plant locations are schematic / approximate only. Contractor is to stake out locations on site for approval by the Landscape Architect prior to installation.
 - The illustrated number of plants shown in the Planting Plan supersedes the estimated number in the Plant List. Contractor to report any discrepancies to the Landscape Architect prior to installation. Contractor will assume full responsibility if the Landscape Architect is not notified.
 - Ensure trees are thoroughly watered following planting. Monitor material and ensure adequate moisture until acceptance.
 - In heavy clay or poorly drained soils, set root ball with root collar 75-100mm higher than finished grade.
 - Approved topsoil depths are as follows:
 - a. Plant Beds - 450mm continuous depth. Applies to shrubs, perennials, vines, and groundcovers.
 - b. Sod/Seed Areas - 100mm depth.
 - Sod to be No. 1 Kentucky Bluegrass Sod grown from minimum mixture of 3 Kentucky Bluegrass cultivars. Quality and source are to comply with Canadian Standards for Nursery Stock, Section 17, (latest edition) published by the Canadian Nursery Landscape Nursery Landscape Association.
 - Apply the following mineral fertilizer unless soil tests show other requirements:
 - a. Plant Beds - (8-32-16), i.e. 8% Nitrogen, 32% Phosphorus, 16% Potash per manufacturer specifications.
 - b. Sod Areas - (8-32-16), i.e. 8% Nitrogen, 32% Phosphorus, 16% Potash at a rate of 350kg/ha
 - Where applicable, for any plant areas with a mix of species/cultivars notes, Contractor is to cluster like plants in groups of 3-5 and evenly distribute these in the noted area.

PLANT LIST

KEY	QTY	BOTANICAL NAME	COMMON NAME	SIZE	COND	SPACING
Deciduous Trees						
AR	3	<i>Acer rubrum</i>	Red Maple	50mm Cal	WB	As Shown
ASI	8	<i>Acer saccharinum</i>	Silver Maple	50mm Cal	WB	As Shown
AEG	9	<i>Aesculus glabra</i>	Ohio Buckeye	50mm Cal	WB	As Shown
CEL	7	<i>Callis occidentalis</i>	Hackberry	50mm Cal	WB	As Shown
PAM	9	<i>Phellodendron amurense 'His Majesty'</i>	His Majesty Cork Tree	50mm Cal	WB	As Shown
GM	1	<i>Quercus macrocarpa</i>	Burr Oak	50mm Cal	WB	As Shown
UAV	3	<i>Ulmus americana 'Valley Forge'</i>	Valley Forge Elm	50mm Cal	WB	As Shown
Coniferous Trees						
ABA	3	<i>Abies balsamea</i>	Balsam Fir	200cm Ht	WB	As Shown
PS	5	<i>Pinus strobus</i>	Eastern White Pine	200cm Ht	WB	As Shown
PG	5	<i>Picea glauca</i>	White Spruce	200cm Ht	WB	As Shown
Deciduous Shrubs						
Cak	111	<i>Cornus sericea 'Kelsey'</i>	Kelsey Dogwood	2g	PT	As Shown
Ra	8	<i>Rhus aromatica</i>	Fragrant Sumac	3g	PT	As Shown
Rtb	12	<i>Rhus typhina 'Baltiger'</i>	Tiger Eyes Outleaf Staghorn Sumac	3g	PT	160cm O.C
Coniferous Shrubs						
Jcc	66	<i>Juniperus communis 'Green Carpet'</i>	Green Carpet Juniper	40cm Spr	PT	60cm O.C
Broadleaf Evergreens						
Iva	28	<i>Ilex verticillata 'Afterglow'</i>	Afterglow Winterberry	3g	PT	150cm O.C
Ij	5	<i>Ilex verticillata 'Jim Dandy'</i>	Jim Dandy Winterberry (Male)	3g	PT	As Shown
Ornamental Grasses						
cdk	81	<i>Calamagrostis acutiflora 'Karl Foerster'</i>	Karl Foerster Feather Reed Grass	1g	PT	70cm O.C

APPROVED
By Allison Hamlin at 5:10 pm, Jan 25, 2023

Allison Hamlin
ALLISON HAMLIN
MANAGER (A), DEVELOPMENT REVIEW WEST
PLANNING, REAL ESTATE & ECONOMIC DEVELOPMENT
DEPARTMENT, CITY OF OTTAWA

NOT FOR CONSTRUCTION

OWNER INFORMATION
U-HAUL CANADA
3636 INNES ROAD
OTTAWA, ONTARIO, K1C 1T1
DAVID POLLOCK
PHONE: 1-602-263-6555
david_pollock@uhhaul.com

NOTE:
THE POSITION OF ALL POLE LINES, CONDUITS, WATERMANS, SEWERS AND OTHER UNDERGROUND AND OVERGROUND UTILITIES AND STRUCTURES IS NOT NECESSARILY SHOWN ON THE CONTRACT DRAWINGS, AND WHERE SHOWN, THE ACCURACY OF THE POSITION OF SUCH UTILITIES AND STRUCTURES IS NOT GUARANTEED. BEFORE STARTING WORK, DETERMINE THE EXACT LOCATION OF ALL SUCH UTILITIES AND STRUCTURES AND ASSUME ALL LIABILITY FOR DAMAGE TO THEM.

No.	REVISION	DATE	BY
3.	REVISED PER CITY COMMENTS	NOV 14/22	RGJ
2.	REVISED PER CITY COMMENTS	SEPT 15/22	RGJ
1.	ISSUED FOR SITE PLAN APPROVAL	MAY 20/22	RGJ

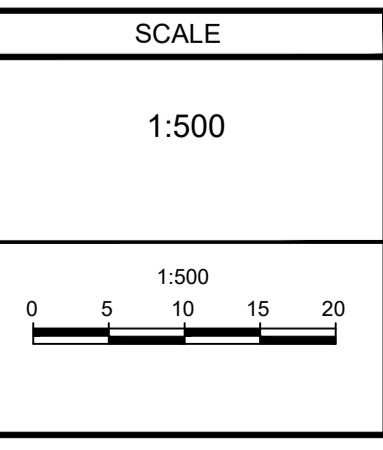

FOR REVIEW ONLY

DESIGN: JMK
CHECKED: RGJ
DRAWN: JMK
CHECKED: RGJ
APPROVED: RGJ



NOVATECH
Engineers, Planners & Landscape Architects
Suite 200, 240 Michael Cowpland Drive
Ottawa, Ontario, Canada K2M 1P6
Telephone: (613) 254-9643
Facsimile: (613) 254-5867
Website: www.novatech-eng.com

LOCATION
CITY OF OTTAWA
30 FRANK NIGHBOR PLACE

DRAWING NAME
LANDSCAPE PLAN

PROJECT No: 121326
REV # 3
DRAWING No: 121326-L1

C:\temp\p\p\Pub\121326_L1.dwg, L1 (landscape), Nov 14, 2022, 4:58pm, tharale

D07-12-22-0088

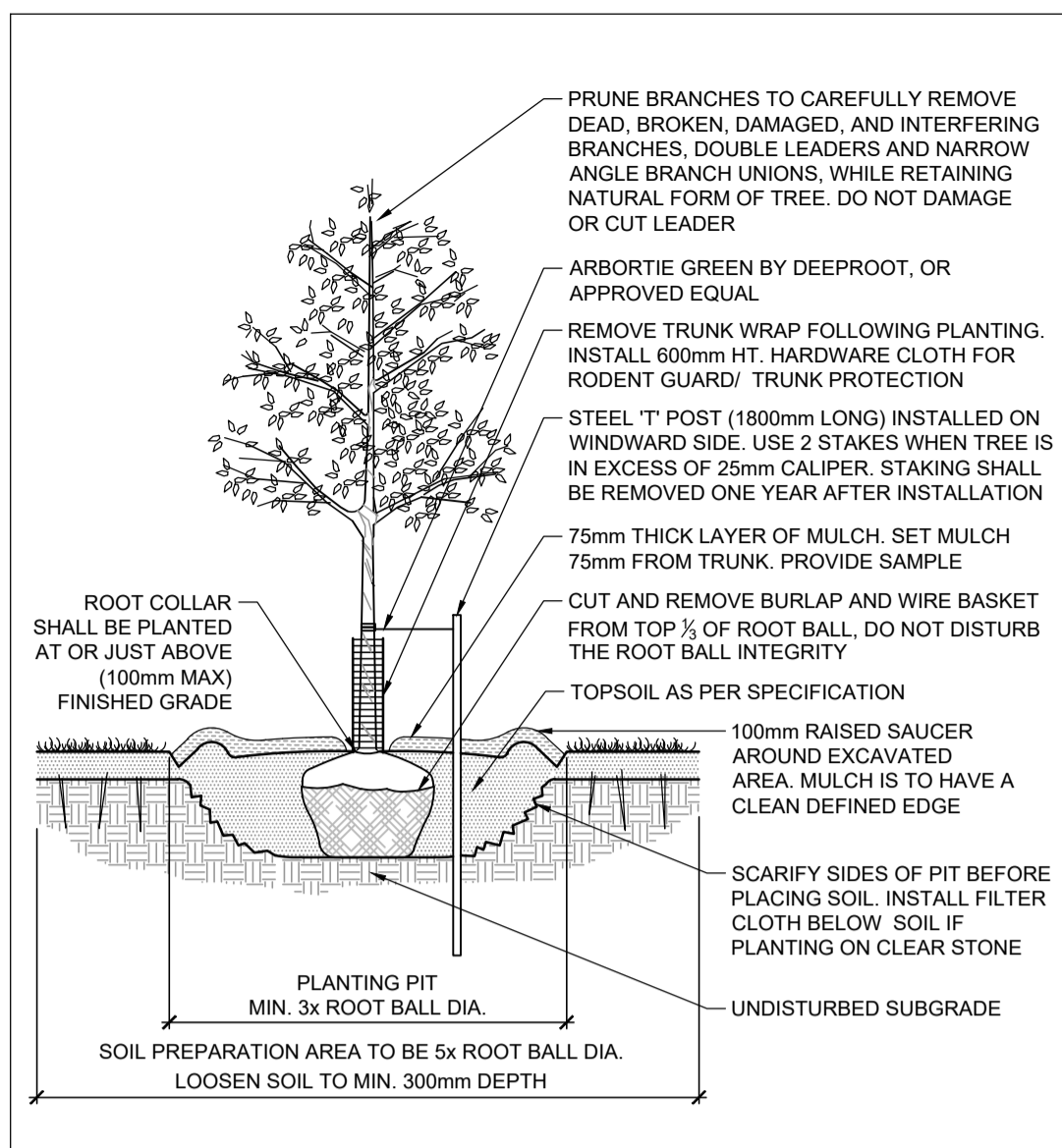

STANDARD DECIDUOUS TREE PLANTING

D1

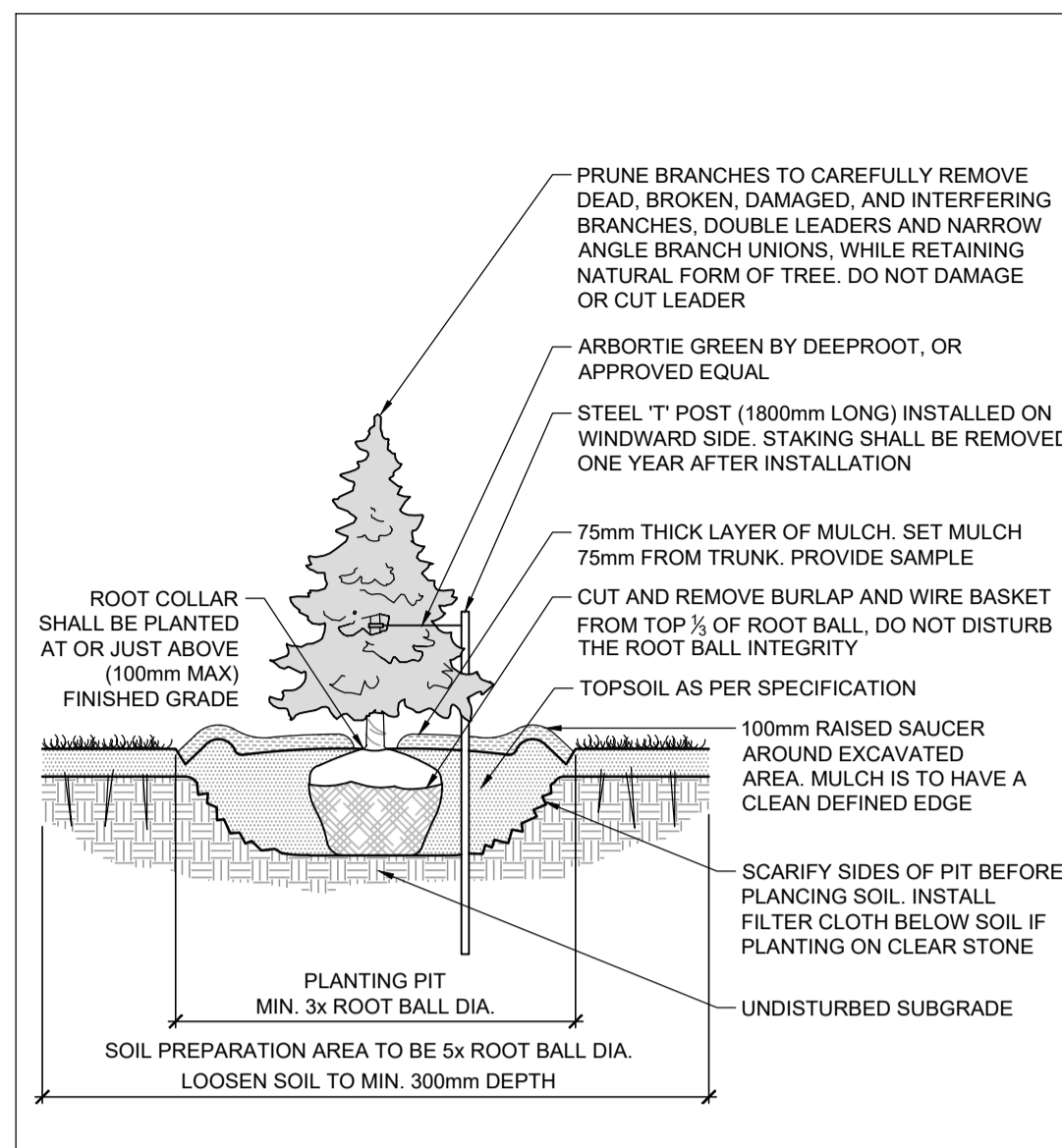

STANDARD CONIFEROUS TREE PLANTING

D2

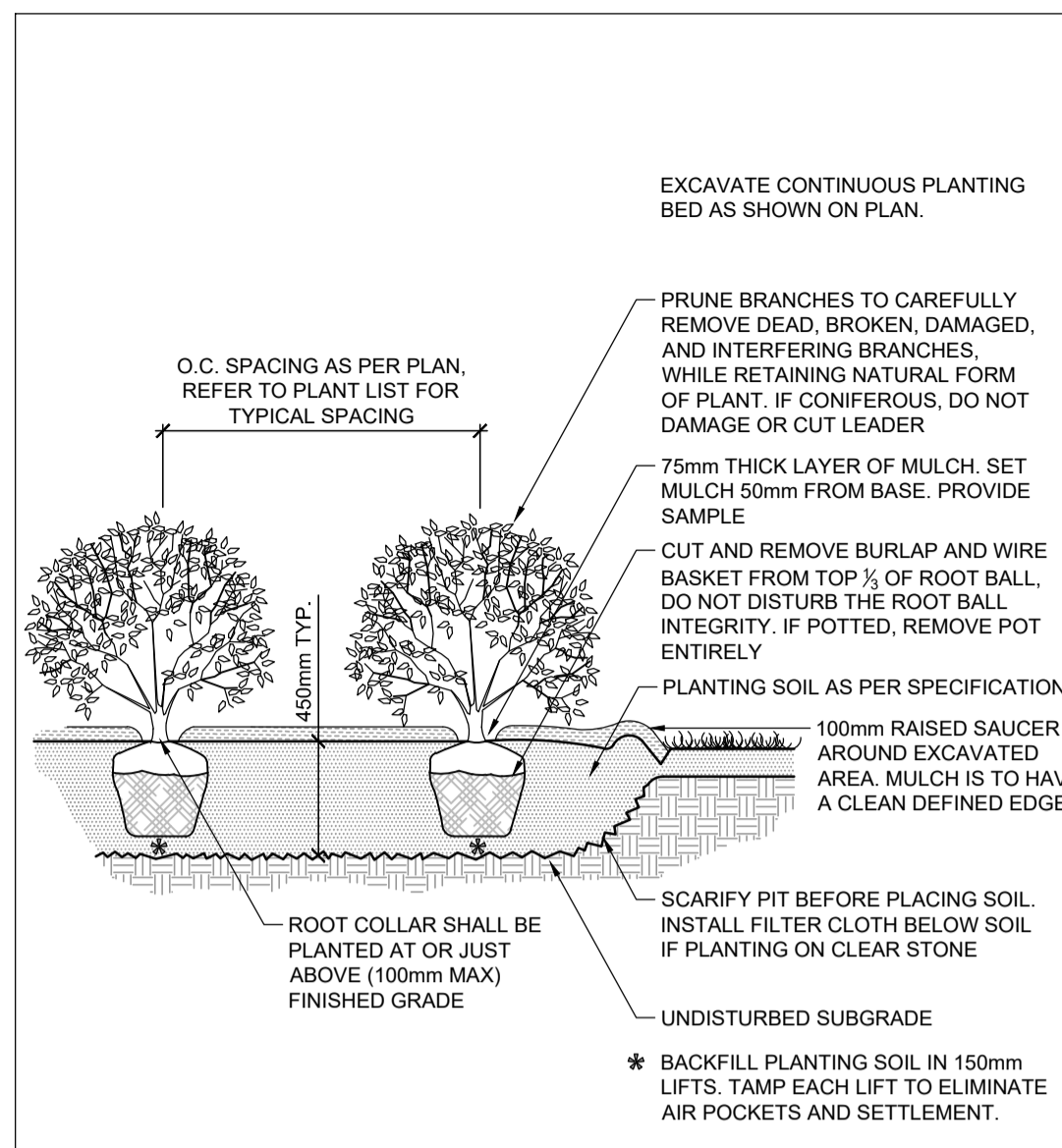

SHRUB AND PERENNIAL PLANTING

D3

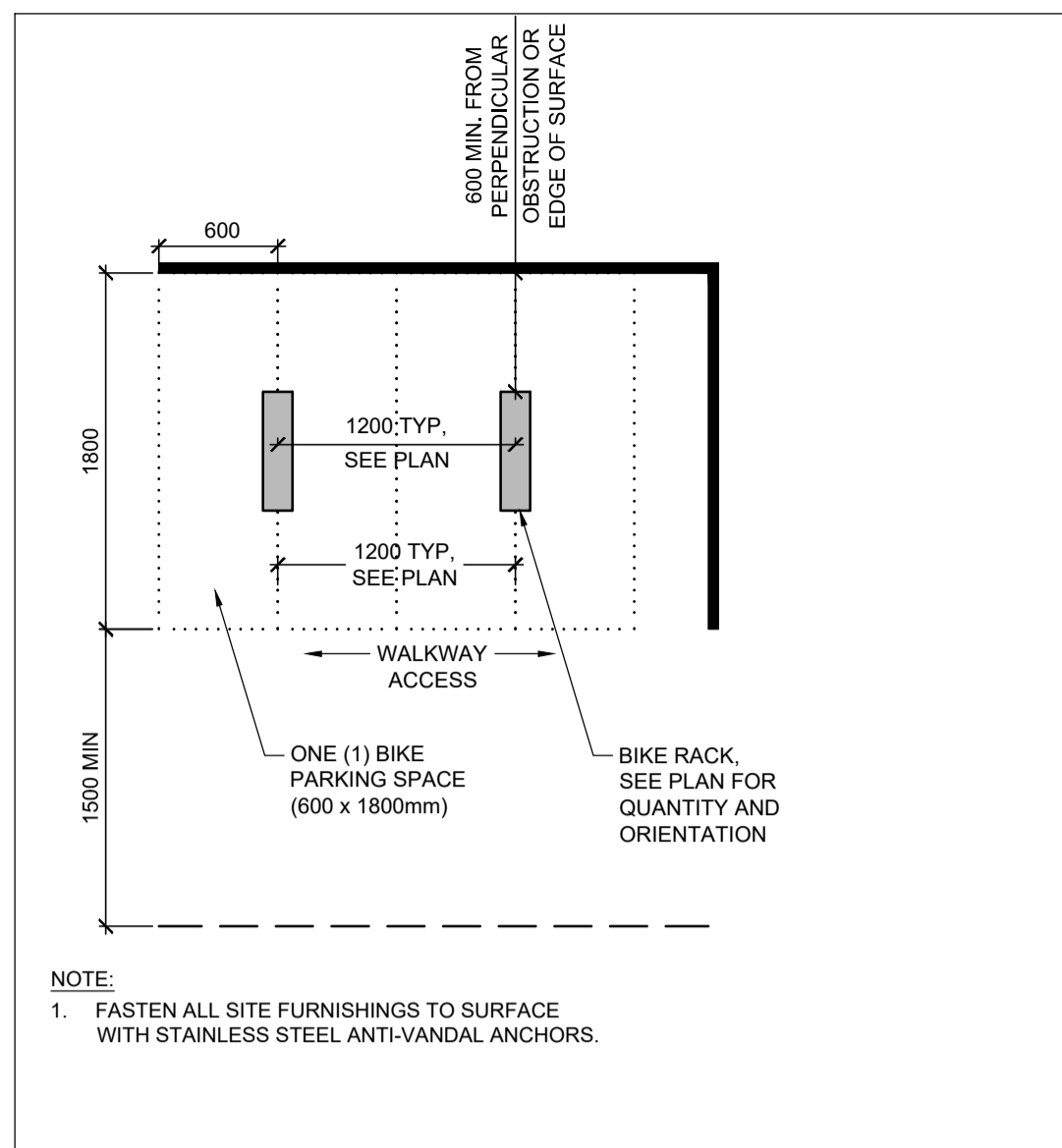

BIKE LAYOUT

D4

APPROVED
By Allison Hamlin at 5:10 pm, Jan 25, 2023

Allison Hamlin
ALLISON HAMLIN
MANAGER (A), DEVELOPMENT REVIEW WEST
PLANNING, REAL ESTATE & ECONOMIC DEVELOPMENT
DEPARTMENT, CITY OF OTTAWA

NOTE:
THE POSITION OF ALL POLE LINES, CONDUITS, WATERMANS, SEWERS AND OTHER UNDERGROUND AND OVERGROUND UTILITIES AND STRUCTURES IS NOT NECESSARILY SHOWN ON THE CONTRACT DRAWINGS, AND WHERE SHOWN, THE ACCURACY OF THE POSITION OF SUCH UTILITIES AND STRUCTURES IS NOT GUARANTEED. BEFORE STARTING WORK, DETERMINE THE EXACT LOCATION OF ALL SUCH UTILITIES AND STRUCTURES AND ASSUME ALL LIABILITY FOR DAMAGE TO THEM.

OWNER INFORMATION
U-HAUL CANADA
3636 INNES ROAD
OTTAWA, ONTARIO, K1C 1T1
DAVID POLLOCK
PHONE: 1-602-263-6555
david_pollock@uhhaul.com

NOT FOR CONSTRUCTION

No.	REVISION	DATE	BY
3.	REVISED PER CITY COMMENTS	NOV 14/22	RGJ
2.	REVISED PER CITY COMMENTS	SEPT 15/22	RGJ
1.	ISSUED FOR SITE PLAN APPROVAL	MAY 20/22	RGJ

DESIGN	CHECKED	DRAWN	CHECKED	APPROVED
JMK	RGJ	JMK	RGJ	RGJ

SCALE

FOR REVIEW ONLY

NOVATECH
Engineers, Planners & Landscape Architects
Suite 200, 240 Michael Cowpland Drive
Ottawa, Ontario, Canada K2M 1P6
Telephone (613) 254-9643
Facsimile (613) 254-5867
Website www.novatech-eng.com

LOCATION
CITY OF OTTAWA
30 FRANK NIGHBOR PLACE
DRAWING NAME
LANDSCAPE DETAILS

PROJECT No.	121326
REV	REV # 3
DRAWING No.	121326-L2

C:\temp\p\p\publish_274836\121326_L2.dwg, L2, Nov. 14, 2022 - 4:58pm, lbarakale

D07-12-22-0088