

- GENERAL NOTES:**
- IT IS THE RESPONSIBILITY OF THE APPROPRIATE CONTRACTOR OR OFFICIAL TO REPORT ANY ERRORS, OMISSIONS OR DISCREPANCIES ON THIS PLAN WITH ACTUAL SITE CONDITIONS TO THE LANDSCAPE ARCHITECT BEFORE PROCEEDING WITH CONSTRUCTION.
  - THE CONTRACTOR IS TO NOTIFY ALL UTILITY COMPANIES AND AUTHORITIES PRIOR TO ANY EXCAVATION AND ASCERTAIN LOCATIONS OF UNDERGROUND SERVICES.
  - THE CONTRACTOR IS TO REINSTATE ALL AREAS AND ITEMS DAMAGED AS A RESULT OF CONSTRUCTION ACTIVITY.
  - THE CONTRACTOR IS TO COMPLY WITH ALL PERTINENT CODES AND BY-LAWS.
  - THE CONTRACTOR IS TO MAINTAIN A POSITIVE SURFACE RUN-OFF THROUGHOUT THE ENTIRE CONSTRUCTION PERIOD.
  - THE LANDSCAPE ARCHITECT IS NOT RESPONSIBLE FOR SUBSURFACE CONDITIONS.
  - THE CONTRACTOR IS TO IDENTIFY ALL EXISTING TREES TO REMAIN ON SITE WITH THE LANDSCAPE ARCHITECT PRIOR TO CONSTRUCTION.
  - THE CONTRACTOR IS TO STAKE THE PROPOSED LOCATION OF ALL PLANT MATERIAL IN CONJUNCTION WITH THE LANDSCAPE ARCHITECT PRIOR TO EXCAVATION.
  - MINIMUM DISTANCES FOR SELECTED DECIDUOUS TREES ARE AS FOLLOWS:
    - BUILDING FOUNDATIONS - 7.5M
    - SIDEWALKS - 1.5M
    - PUBLIC STREETS - 2.5M
    - UNDERGROUND INFRASTRUCTURE - 2.0M
  - ALL TREES WITHIN 1M OF UNDERGROUND UTILITY TRENCHES ARE TO BE EXCAVATED BY HAND.
  - REMOVE ALL PROTECTIVE WRAPPING FROM TREE TRUNKS AFTER INSTALLATION.
  - STAKING OF TREES SHALL ONLY BE PERFORMED IF NECESSARY.
  - ENSURE THAT MULCH IS PULLED BACK A MINIMUM DISTANCE OF 75MM FROM BASE OF TREE TRUNK.

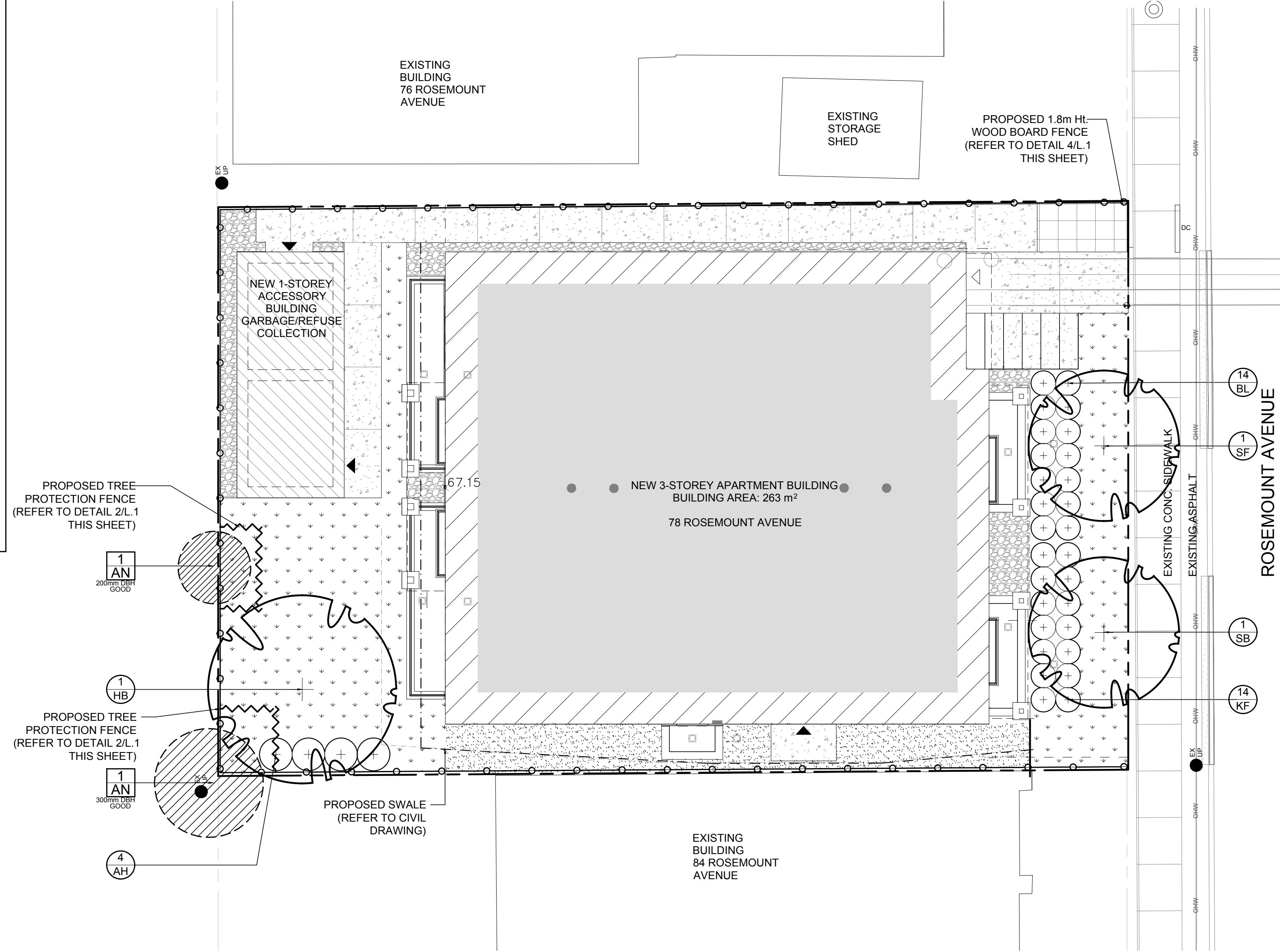

**1 TREE CONSERVATION REPORT & LANDSCAPE PLAN**  
SCALE: 1:100

KEY	QTY.	BOTANICAL NAME	COMMON NAME	SIZE	CONDITION	REMARKS	OWNERSHIP
AN	2	<i>Acer negundo</i>	Manitoba Maple	300-200mm DBH	GOOD	To remain	11 Beverley Avenue

KEY	QTY.	BOTANICAL NAME	COMMON NAME	SIZE	CONDITION	REMARKS
<b>TREES</b>						
HB	1	<i>Celtis occidentalis</i>	Common Hackberry	60mm CAL.	B&B	
SB	1	<i>Amelanchier canadensis</i>	Serviceberry	60mm CAL.	B&B	Single leader
SF	1	<i>Amelanchier laevis</i> 'JSF-ARB'	Spring Flurry Serviceberry	60mm CAL.	B&B	Single leader
<b>SHRUBS</b>						
AH	4	<i>Hydrangea arborescens</i> 'Annabelle'	Annabelle Hydrangea	3 gallon pot	Potted	1000mm o.c.
<b>ORNAMENTAL GRASSES</b>						
BL	14	<i>Leymus arenarius</i> 'Blue Dune'	Blue Lyme Grass	250mm pot	Potted	800mm o.c.
KF	14	<i>Calamagrostis x acutiflora</i> 'Karl Foerster'	Feather Reed Grass	250mm pot	Potted	800mm o.c.

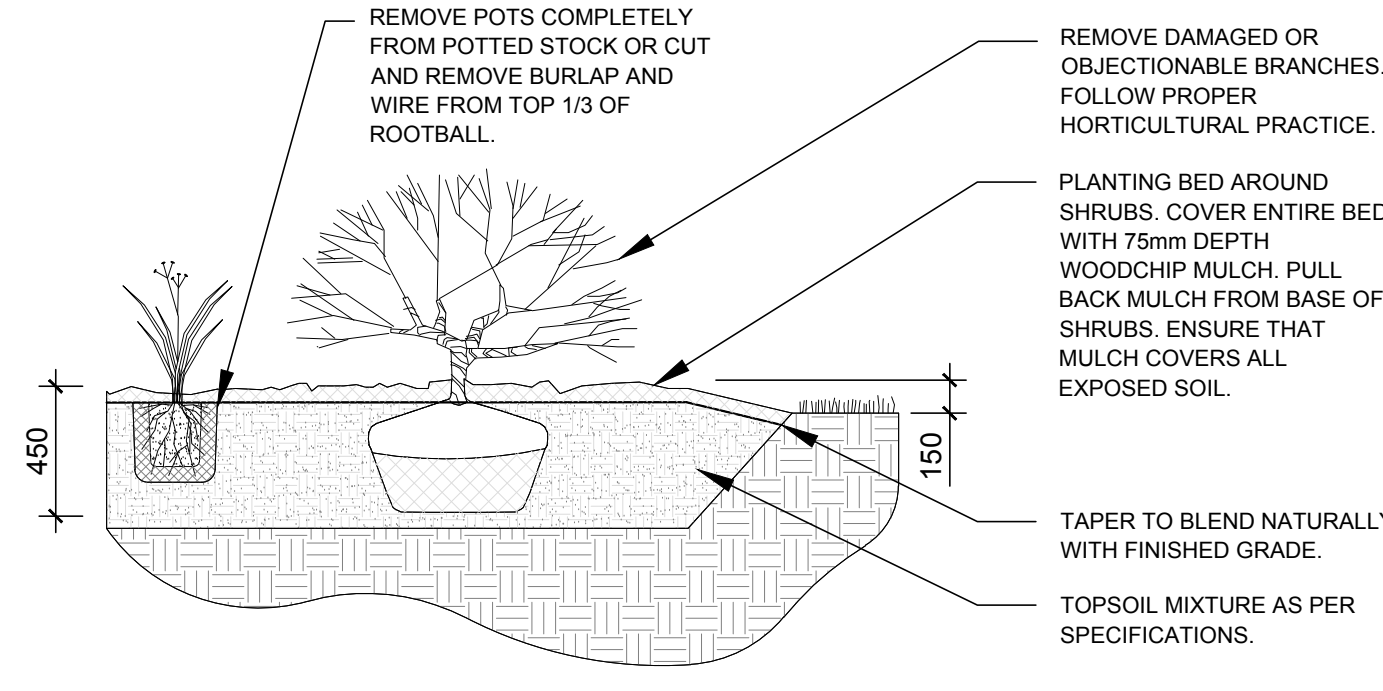

**5 SHRUB / ORNAMENTAL GRASS PLANTING**  
SCALE: NTS

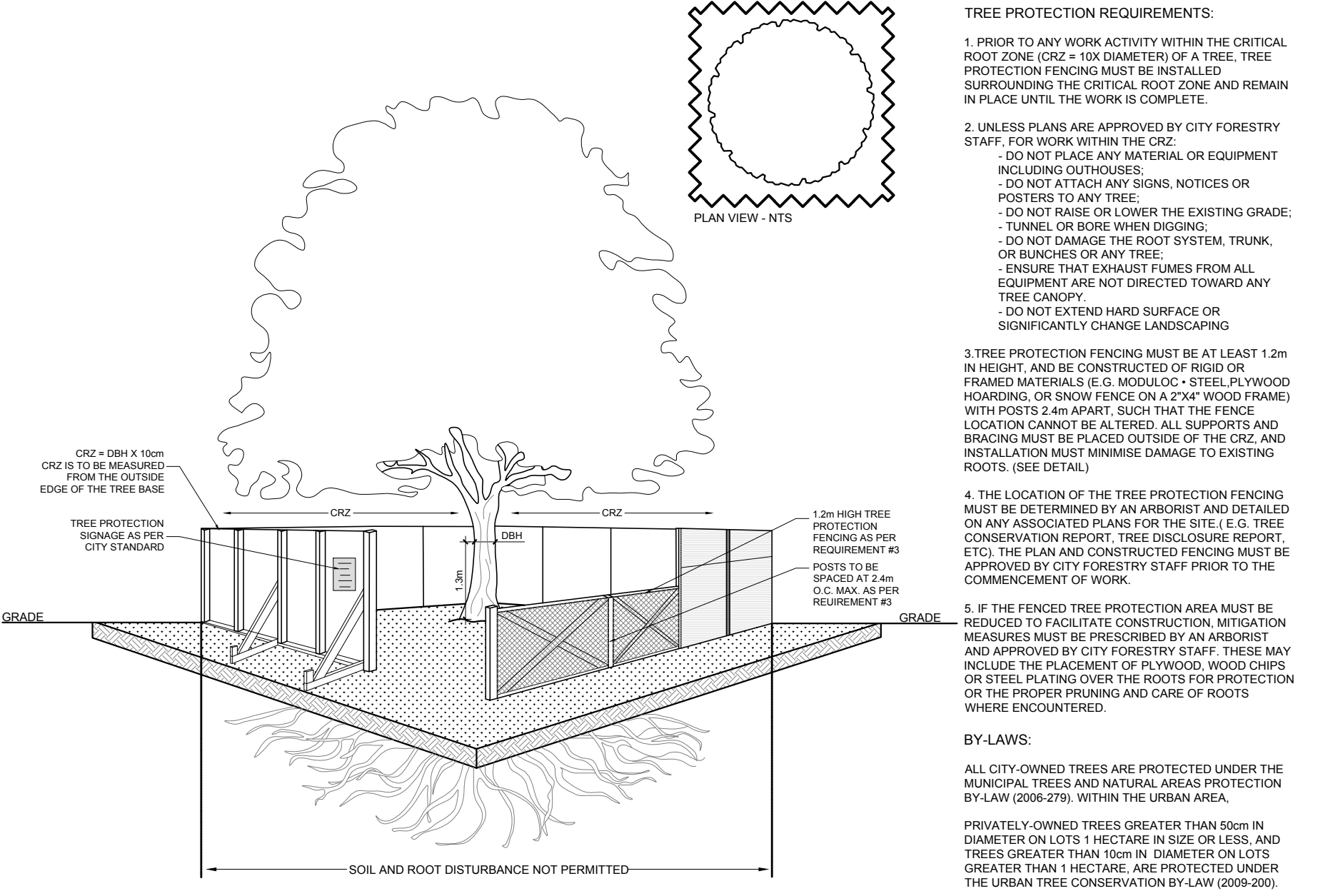

**2 TREE PROTECTION FENCE**  
SCALE: NTS

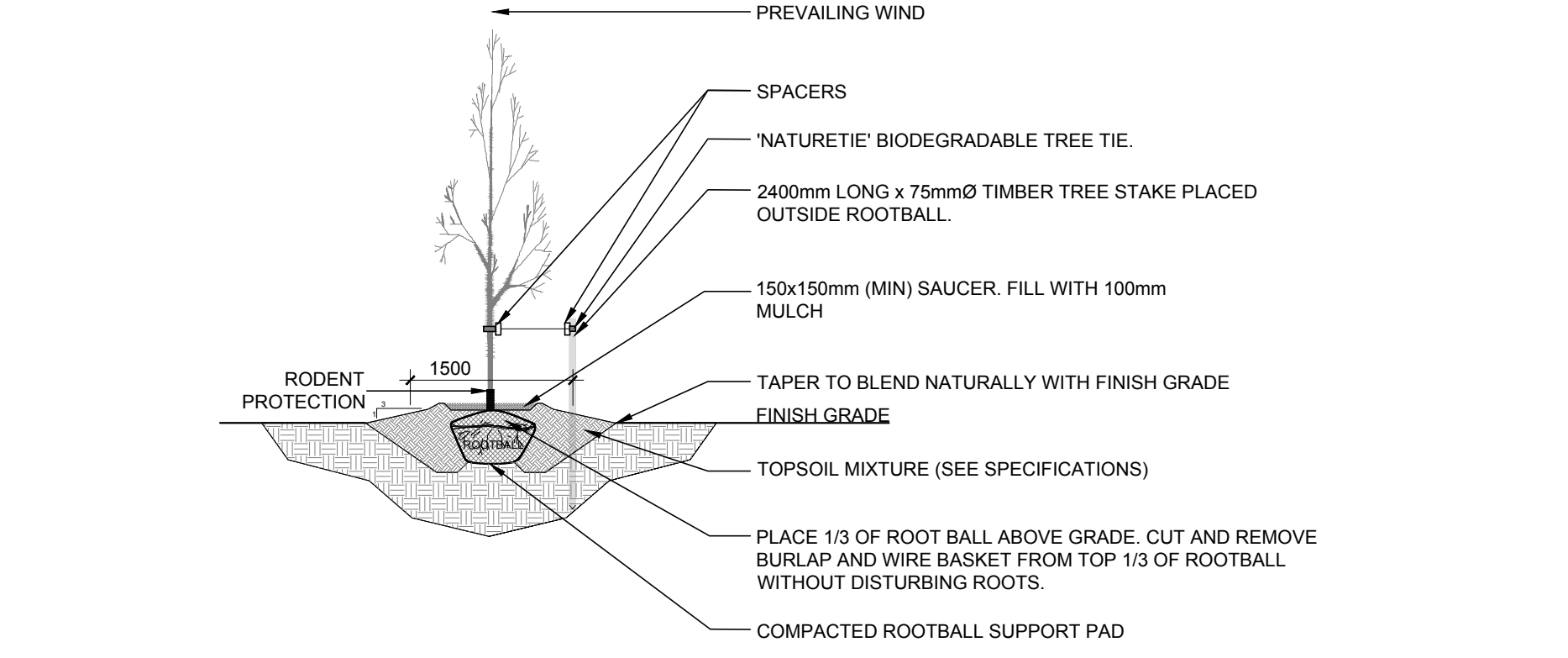

**3 DECIDUOUS TREE PLANTING**  
SCALE: NTS

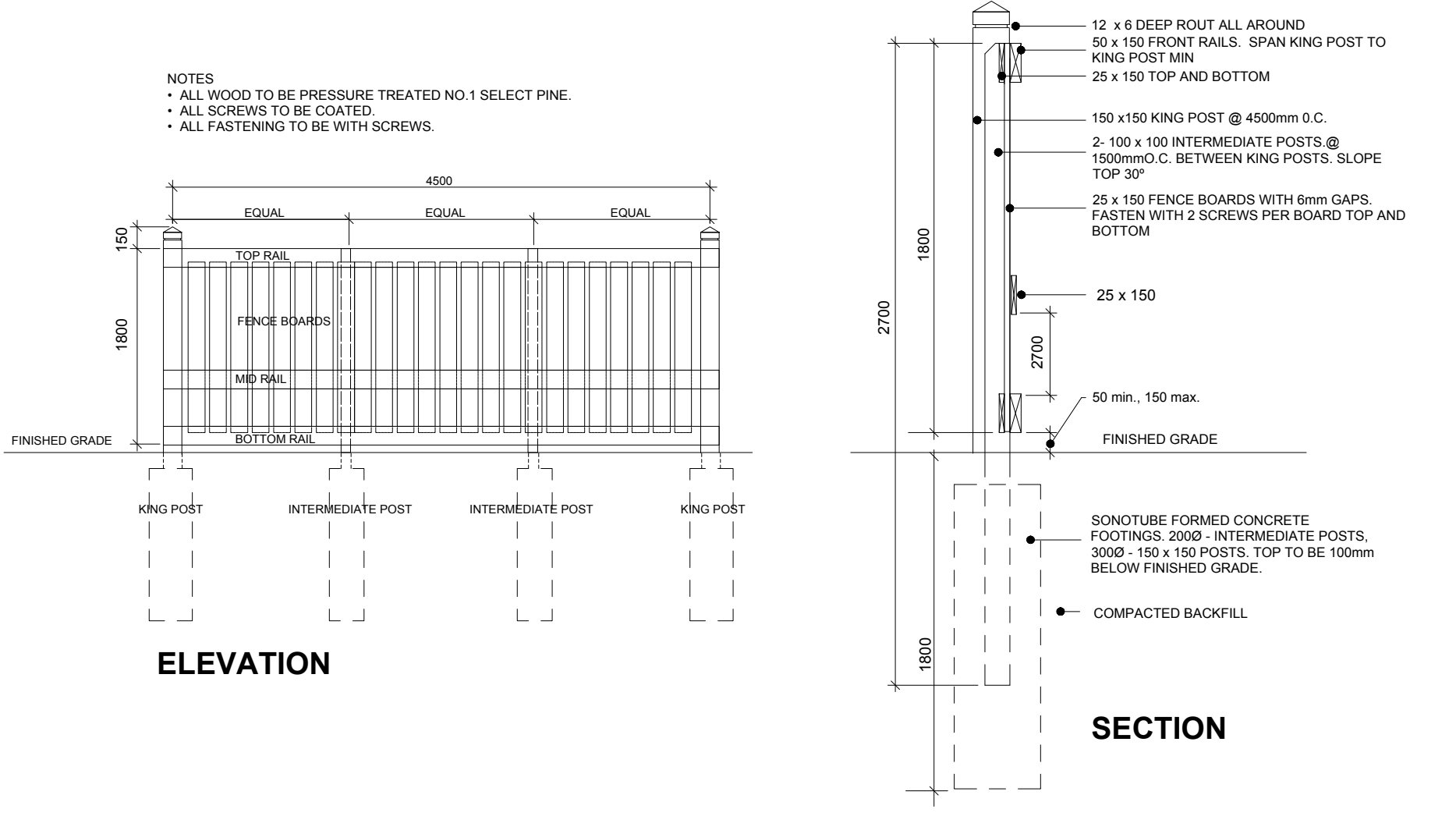

**4 1.8m Ht. WOOD SCREEN FENCE**  
SCALE: NTS

CLIENT  
**78 ROSEMOUNT AVE INC.**

CONSULTANTS  
ARCHITECTS:  
**CSV ARCHITECTS**  
sustainable design · conception écologique  
613.564.8118 190 O'Connor Street, Suite 100  
www.csv.ca Ottawa, Ontario, K2P 2R3

CIVIL ENGINEERS:  
CIVIL ENGINEER  
McIntosh Perry  
115 Walgreen Road, R.R. 3  
Carp, ON K0A 1L0  
613-936-2184  
www.mcintoshperry.com

**LEGEND**

- PROPOSED DECIDUOUS TREE
- PROPOSED SHRUBS / ORNAMENTAL GRASSES
- PROPOSED CLOVER SEED
- PROPOSED PEASTONE MULCH
- PROPOSED RIVERSTONE MULCH
- PROPOSED PRECAST CONCRETE PAVERS
- PROPOSED CONCRETE SIDEWALK
- EXISTING TREE TO REMAIN
- TREE PROTECTION FENCE
- PROPOSED 1.8m Ht. WOOD SCREEN FENCE

No.	Issue	Date	ML	JL	DR	CK
2	REVISED PER CITY COMMENTS	01/18/2023	ML	JL		
1	ISSUED FOR SITE PLAN CONTROL	08/04/2022	ML	JL		

**JAMES B. LENNOX & ASSOCIATES INC.**  
LANDSCAPE ARCHITECTS  
3312 CARLING AVE. OTTAWA, ONTARIO K2H 5A8  
Tel. (613) 722-5168 Fax. (1866) 343-3942

PROJECT  
**PROPOSED THREE STOREY APARTMENT BUILDING**  
78 ROSEMOUNT AVENUE, OTTAWA ON

DRAWING  
**TREE CONSERVATION REPORT & LANDSCAPE PLAN**

SCALE	AS SHOWN
START DATE	JULY 2022
PROJECT NO.	

PROJECT NORTH

DRAWING NO.  
**L.1**

PLOT SIZE ARCH-D