

Legend

- PROPOSED WATERMAIN
- PROPOSED VALVE AND VALVE BOX
- PROPOSED REDUCER
- PROPOSED FIRE HYDRANT
- PROPOSED WATER METER
- PROPOSED REMOTE WATER METER
- PROPOSED SANITARY SEWER
- PROPOSED STORM SEWER
- PROPOSED CATCHBASIN
- EXISTING WATERMAIN
- EXISTING VALVE CHAMBER
- EXISTING FIRE HYDRANT
- EXISTING SANITARY SEWER
- EXISTING STORM SEWER
- EXISTING CATCHBASIN
- PROPOSED DEPRESSED CURB LOCATIONS
- APPROXIMATE LOCATION OF PROPOSED SCUPPER. REFER TO ARCHITECTURAL PLANS FOR DETAILS.
- APPROXIMATE LOCATION OF PROPOSED ROOF DRAIN. REFER TO ARCHITECTURAL PLANS FOR DETAILS.
- EXISTING OVERHEAD WIRES

- Notes**
- EXISTING AS-RECORDED SEWER AND WATER INFORMATION HAS BEEN DERIVED FROM AS-BUILT INFORMATION PROVIDED BY THE CITY OF OTTAWA.
 - CONTRACTOR TO VERIFY AS-RECORDED INFORMATION AND IMMEDIATELY REPORT ANY DISCREPANCIES OR CONFLICTS TO CIVIL ENGINEER PRIOR TO PROCEEDING WITH CONSTRUCTION.
 - SERVICE SIZES AND ELEVATIONS TO BE CONFIRMED BY MECHANICAL ENGINEER.

NO.	REVISION	DATE	BY	APP'D.
5	REVISED AS PER CITY COMMENTS	22.11.18	WAJ	KJK
4	REVISED SITE PLAN	22.06.10	WAJ	KJK
3	REVISED SITE PLAN	22.03.25	WAJ	KJK
2	REVISED AS PER CITY COMMENTS	22.03.04	WAJ	KJK
1	ISSUED FOR REVIEW	21.06.18	WAJ	KJK

Revision

File Name:	Rev.	By	Appd.
160401679-08.dwg	1	WAJ	KJK
	2	WAJ	KJK
	3	WAJ	KJK
	4	WAJ	KJK
	5	WAJ	KJK

Permit-Seal

Client/Project
2473493 ONTARIO INC

1983 CARLING AVE

Ottawa, ON

Title
SITE SERVICING PLAN

Project No. 160401679
Drawing No. SSP-1

Scale 0 1.5 4.5 7.5m
1:150

Sheet 2 of 6

Revision 5
PLAN No. 18587

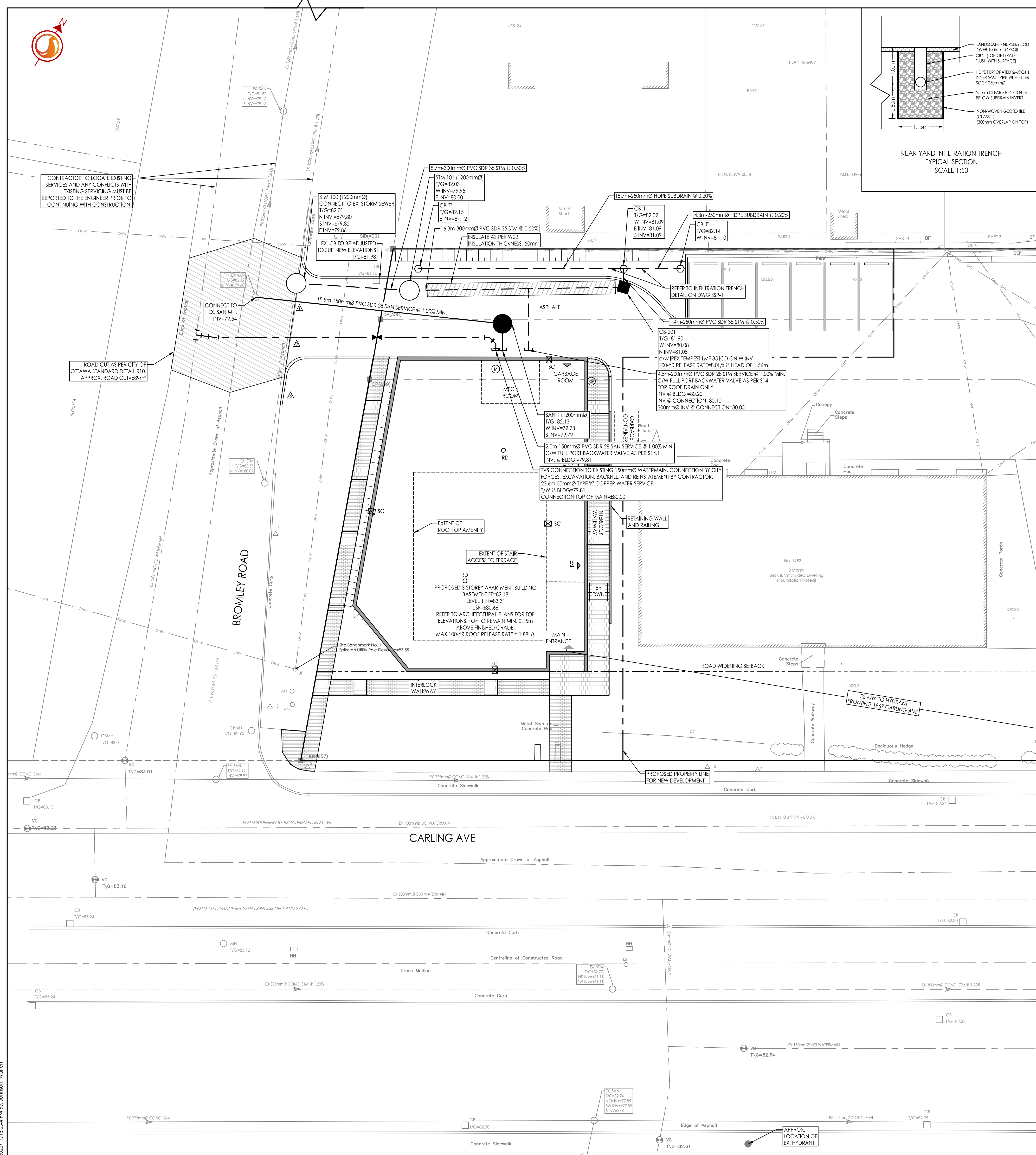

- GENERAL NOTES**
- ALL WORK SHALL BE CARRIED OUT IN COMPLIANCE WITH THE ONTARIO OCCUPATIONAL HEALTH AND SAFETY ACT AND REGULATIONS FOR CONSTRUCTION PROJECTS.
 - ALL WORK AND MATERIALS TO CONFORM WITH CURRENT MINISTRY OF THE ENVIRONMENT & ENERGY OF ONTARIO, CITY OF OTTAWA AND ONTARIO PROVINCIAL STANDARDS AND SPECIFICATIONS. LOCAL UTILITY STANDARDS AND MINISTRY OF TRANSPORTATION STANDARDS WILL APPLY WHERE REQUIRED.
 - THE CONTRACTOR IS ADVISED THAT WORKS BY OTHERS MAY BE ONGOING DURING THE PERIOD OF THIS CONTRACT. THE CONTRACTOR SHALL COORDINATE CONSTRUCTION ACTIVITIES AND COORDINATION WITH ALL OTHER CONTRACTORS AND PREVENT CONSTRUCTION CONFLICTS.
 - THE INFORMATION SHOWN FOR EXISTING UTILITIES WAS PROVIDED BY OTHERS. THE CONTRACTOR IS RESPONSIBLE FOR LOCATING AND PROTECTING ALL UTILITIES DURING CONSTRUCTION. ALL EXISTING UTILITIES MUST BE LOCATED AND VERIFIED BY EACH UTILITY PRIOR TO COMMENCEMENT OF WORK. ANY VARIANCE IS TO BE IMMEDIATELY REPORTED TO THE ENGINEER. LOST TIME DUE TO FAILURE OF THE CONTRACTOR TO CONFIRM UTILITY LOCATIONS AND NOTIFY THE ENGINEER OF POSSIBLE CONFLICTS PRIOR TO CONSTRUCTION WILL BE AT THE CONTRACTOR'S EXPENSE.
 - ALL CONSTRUCTION SHALL BE CARRIED OUT IN ACCORDANCE WITH THE RECOMMENDATIONS MADE IN THE GEOTECHNICAL REPORT.
 - THE CONTRACTOR IS RESPONSIBLE FOR OBTAINING ALL PERMITS REQUIRED AND TO BEAR THE COST OF SAME INCLUDING WATER PERMIT AND ASSOCIATED COSTS.
 - ALL DISTURBED AREAS SHALL BE REINSTATED TO EQUAL OR BETTER CONDITION TO THE SATISFACTION OF THE ENGINEER AND THE CITY. PAVEMENT REINSTATEMENT FOR SERVICE AND UTILITY CUTS SHALL BE IN ACCORDANCE WITH CITY STANDARD R10, OPSD 509.010 AND OPSD 510.
 - BENCHMARKS: IT IS THE RESPONSIBILITY OF THE CONTRACTOR TO VERIFY THAT THE SITE BENCHMARK(S) HAS NOT BEEN ALTERED OR DISTURBED AND THAT ITS RELATIVE ELEVATION AND DESCRIPTION AGREES WITH THE INFORMATION SHOWN ON DRAWING GP-1.
 - THE CONTRACTOR SHALL PROVIDE TO THE ENGINEER 1 (ONE) SET OF AS CONSTRUCTED SITE SERVICING, GRADING, AND SITE ELECTRICAL DWGS.
 - EXISTING STORM AND SANITARY SERVICE (LATERALS TO BE ABANDONED PER S11.4 EXISTING WATER SERVICE TO BE BLANKED AT THE MAIN [TYP.]
 - TOPOGRAPHIC SURVEY SUPPLIED BY ANNIS, O'SULLIVAN, VOLLEBECK LTD. DATED JULY 2, 2020.
BENCHMARK 1: SPIKE ON UTILITY POLE ON BROMLEY ROAD WEST OF THE PROPOSED SITE WITH AN ELEVATION OF 83.55.
BENCHMARK 2: TOP OF SPINDLE OF FIRE HYDRANT ON CARLING AVENUE SOUTH EAST OF THE PROPOSED SITE WITH AN ELEVATION OF 83.01.
 - SITE PLAN PREPARED BY FIGURR DATED NOVEMBER 3, 2022 DRAWING NO. A105.
 - GEOTECHNICAL INVESTIGATION 289578 PREPARED BY PINCHIN DATED MAY 4, 2021. GEOTECHNICAL INFORMATION PRESENTED ON THESE DRAWINGS MAY BE INTERPOLATED FROM THE ORIGINAL REPORT. REFER TO ORIGINAL GEOTECHNICAL REPORT FOR ADDITIONAL DETAILS AND TO VERIFY ASSUMPTIONS MADE HERE.

- WATER SUPPLY SERVICING**
- THE CONTRACTOR SHALL CONSTRUCT WATERMAIN, WATER SERVICES, CONNECTIONS & APPURTENANCES AS PER CITY OF OTTAWA SPECIFICATIONS & SHALL CO-ORDINATE AND PAY ALL RELATED COSTS INCLUDING THE COST OF CONNECTION, INSPECTION & DISINFECTION BY CITY PERSONNEL.
 - WATER SERVICE TO BE INSTALLED 1.0m OFF BUILDING FACE. STAND POST TO BE INSTALLED AT PROPERTY LINE AS SHOWN ON DRAWING.
 - WATERMAIN TRENCH AND BEDDING SHALL BE IN ACCORDANCE WITH CITY OF OTTAWA STD. W17 UNLESS OTHERWISE SPECIFIED. BEDDING AND COVER MATERIAL TO BE SPECIFIED BY PROJECT GEOTECHNICAL CONSULTANT.
 - SERVICE CONNECTIONS SHALL BE INSTALLED A MINIMUM OF 2400mm FROM ANY CATCHBASIN, MANHOLE, OR OBJECT THAT MAY CONTRIBUTE TO FREEZING. THERMAL INSULATION SHALL BE INSTALLED ON ALL PROPOSED STRUCTURES AND WATER SERVICES ON THE W/M STREET SIDE WHERE 2400mm SEPARATION CANNOT BE ACHIEVED. (AS PER CITY OF OTTAWA W22 & W23)
 - CATHODIC PROTECTION TO BE SUPPLIED ON METALLIC FITTINGS AS PER CITY OF OTTAWA W40 AND W42.
 - ALL WATERMAIN BENDS, JOINTS, TEES AND PLUGS SHALL BE MECHANICALLY RESTRAINED IN ACCORDANCE WITH CITY OF OTTAWA STANDARDS.
 - WATERMAIN TO HAVE MIN. 2.4m COVER. WHERE WATERMAIN COVER IS LESS THAN 2.4m, INSULATION TO BE SUPPLIED IN ACCORDANCE WITH CITY STANDARD W22.
 - WATERMANS MUST COMPLY WITH MINIMUM HORIZONTAL AND VERTICAL CLEARANCES IN ACCORDANCE WITH LOCAL PROVINCIAL GUIDELINES AND THE APPLICABLE BUILDING AND PLUMBING CODE. WHERE HORIZONTAL SEPARATIONS CANNOT BE ACHIEVED, APPROVAL FROM THE ENGINEER MUST BE OBTAINED AND A MINIMUM 500mm VERTICAL SEPARATION MUST BE MAINTAINED.
 - ALL WATERMANS SHALL BE BACTERIOLOGICALLY TESTED IN ACCORDANCE WITH THE CITY OF OTTAWA AND ONTARIO GUIDELINES. ALL CHLORINATED WATER TO BE DISCHARGED AND PRETREATED TO ACCEPTABLE LEVELS PRIOR TO DISCHARGE. ALL DISCHARGED WATER MUST BE CONTROLLED AND TREATED SO AS NOT TO ADVERSELY EFFECT THE ENVIRONMENT. IT IS THE RESPONSIBILITY OF THE CONTRACTOR TO ENSURE THAT ALL MUNICIPAL AND/OR PROVINCIAL REQUIREMENTS ARE FOLLOWED.

- STORM AND SANITARY SERVICES**
- SEWER TRENCH SHALL CONSIST OF CLASS 'B' BEDDING PER CITY OF OTTAWA STANDARDS S6 AND S7. COMPACTION SHALL BE A MINIMUM OF 98% STANDARD PROCTOR DENSITY.
 - FOR CONSTRUCTION DETAILS NOT SHOWN ON PLANS, REFERENCE SHALL BE MADE TO THE ONTARIO PROVINCIAL STANDARDS DRAWINGS AND CITY OF OTTAWA STANDARDS.
 - SERVICES TO BUILDINGS TO BE TERMINATED 1.0m FROM THE FACE OF BUILDING UNLESS OTHERWISE NOTED.
 - THE CONTRACTOR IS TO PROVIDE CCTV CAMERA INSPECTIONS OF ALL SANITARY AND STORM SERVICES, INCLUDING PICTORIAL REPORT. ONE (1) CD COPY AND TWO (2) VIDEO TAPES IN A FORMAT SATISFACTORY TO THE ENGINEER. ALL SEWERS ARE TO BE FLUSHED PRIOR TO CAMERA INSPECTION. ASPHALT WEAR COURSE SHALL NOT BE PLACED UNTIL THE VIDEO INSPECTION OF SEWERS & NECESSARY REPAIRS HAVE BEEN CARRIED OUT TO THE SATISFACTION OF THE CONSULTANT.
 - LASER ALIGNMENT CONTROL TO BE UTILIZED ON ALL SEWER INSTALLATIONS.
 - FROST PROTECTION PER CITY OF OTTAWA STANDARD DRAWING W22 WHERE THERE IS LESS THAN 2.1m OF COVER ABOVE THE SEWER SERVICES.
 - CONTRACTOR SHALL PERFORM LEAKAGE TESTING, IN THE PRESENCE OF THE CONSULTANT, FOR SANITARY SEWERS IN ACCORDANCE WITH OPSD 410 AND OPSD 407. A COPY OF THE INSPECTION REPORT SHALL BE SUBMITTED TO THE CONSULTANT FOR REVIEW.
 - STORM SERVICE CONNECTION AS PER CITY STD DWG S11; SANITARY SERVICE CONNECTION AS PER CITY STD DWG S11. SERVICES TO CONNECT TO THE OVERTOP OF THE MAIN UNLESS OTHERWISE NOTED.
 - CONTRACTOR TO VERIFY EXISTING SEWERS AND INVERTS, AND REPORT ANY DISCREPANCIES TO SITE ENGINEER BEFORE PROCEEDING WITH CONSTRUCTION.
 - STORM AND SANITARY MANHOLES SHALL BE 1200mm DIAMETER IN ACCORDANCE WITH OPSD-701.01 (UNLESS OTHERWISE NOTED) c/w FRAME AND COVER AS PER CITY OF OTTAWA S24, S24.1, AND S25. STORM MANHOLES SHALL BE COMPLETED WITH 300mm SUMPS AS PER CITY STANDARDS. SANITARY MANHOLES SHALL NOT HAVE SUMPS.

SCHEDULE OF INLET CONTROL DEVICES

CATCHBASIN ID	AREA ID	TYPE	SYR HEAD (m)	100YR HEAD (m)	SYR RELEASE RATE (L/s)	100YR RELEASE RATE (L/s)
CB-201	CB200A	IPEX TEMPST LMF B5	1.02	1.56	6.5	8.0

SCHEDULE OF ROOF RELEASE RATES

DRAINAGE AREA ID	DRAIN TYPE	# DRAINS	SYR HEAD (m)	100 YEAR HEAD (m)	SYR RELEASE RATE (L/s)	100 YEAR RELEASE RATE (L/s)
BLDG	WAITS R1100 ACCUTROL (25% OPEN)	2	0.11	0.15	1.64	1.88

SEWER AND WATERMAIN CROSSING TABLE

CROSSING	STM INV	STM OVB	SAN INV	SAN OVB	WIR TOP	WIR Btm	NOTES
1	79.83	80.13	79.57	79.72			
2	79.87	80.17			80.72	80.87	DEFLECT WATER OVER STORM (AS PER W25.3)
3	79.93	80.23			80.78	80.75	DEFLECT WATER OVER STORM (AS PER W25.3)

*BRACKETS DENOTE ADJUSTED VALUE WITH CONCRETE PIPE THICKNESS

W:\Projects\160401679\Design\Drawings\160401679-08.dwg
 2022/11/22 2:41:48 PM by: [redacted]
 ORIGINAL SHEET - ARCH D