

PRODUCT INFORMATION

Install products as per manufacturer specifications. Shop drawings required.

SITE FURNITURE

- Fasten all site furnishing to surface with stainless steel anti-vandal anchors.
- Accessible 400 Bench by Maglin
Product Number: MMP-0400-00034
Size: 72.75" Length
Frame colour: Gunmetal
Slats: Ipe
Options: Steel ends, end arms and centre arm 9" ht.
- Mug Bike Rack by Maglin
Product Number: MBR-2900-00001
Fixture: Direct Burial
Colour: Gunmetal Gloss Post
Custom #EF4A81 (Pantone 1915 c) Frame

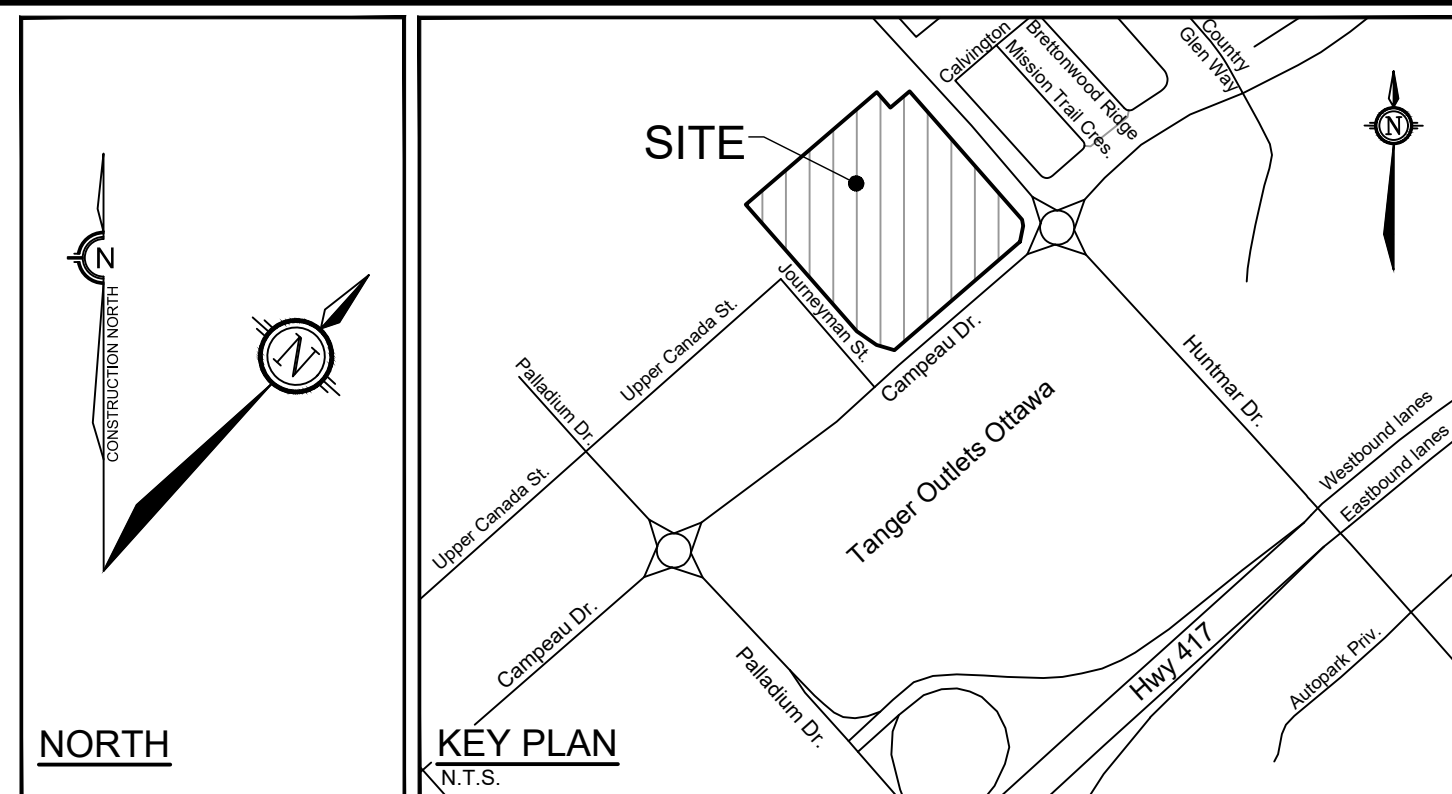

LEGEND

- 3-D1** DETAIL SHEET # NOVATECH OR CITY DETAIL NUMBER SEE LIST FOR CODE
- PROPERTY LIMIT
- [Pattern] PROPOSED CONCRETE
- [Pattern] SOD
- [Pattern] PROPOSED PLANTING BED
- [Pattern] SEED MIX A
- [Symbol] PROPOSED DECIDUOUS TREE
- [Symbol] PROPOSED CONIFEROUS TREE
- [Symbol] EXISTING TREE TO REMAIN

GENERAL

1. Read and interpret this drawing/ drawing set in conjunction with all the contract details and specifications, including related civil, utility, structural, architectural, mechanical, electrical, environmental, geotechnical, and survey information.
2. The Contractor is to determine the exact location, size, material, and elevation of all existing utilities prior to commencing construction. Protect and assume responsibility for all existing utilities regardless of being shown on the drawings.
3. It is essential to use the plans and details in conjunction with the specifications and notes.
4. Do not scale drawings. Work to dimensions only.
5. Protect all existing and retained vegetation for the duration of construction according to the contract details and specifications.
6. Reinstatement all areas and items damaged or disturbed, beyond the Limit of Work, because of construction activities, including but not limited to construction staging areas, haul roads, stockpile areas, etc. to the satisfaction of the Consultant. Unless otherwise noted, Contractor is to reinstate all areas to pre-construction condition or better to the satisfaction of the Contract Administrator.

CITY DETAILS

Related details from City of Ottawa Standard Tender Documents Volume No. 2 Standard Detail Drawings.

- SC4. Typical Concrete Sidewalk in Boulevard
- SC5. Sidewalk Construction Joints

NOVATECH DETAILS

Found on Sheet L7.

CALIPER TREES PLANT LIST

Code	Tree Name	Common Name	Caliper	Height	Width	Notes
ARM	Acer rubrum 'Armstrong Gold'	Armstrong Gold Red Maple	50mm Cal	WB	As Shown	
ARF	Acer rubrum 'Autumn Flame'	Autumn Flame Red Maple	50mm Cal	WB	As Shown	
ARB	Acer rubrum 'Bowhall'	Bowhall Red Maple	50mm Cal	WB	As Shown	
ABW	Acer rubrum 'Brandywine'	Brandywine Red Maple	50mm Cal	WB	As Shown	
AFCM	Acer x freemanii 'Celtzam'	Celebration Maple	50mm Cal	WB	As Shown	
ALS	Amelanchier laevis 'Spring Flurry'	Spring Flurry Serviceberry	50mm Cal	WB	As Shown	
AMB	Amelanchier x grandiflora 'Ballerina'	Ballerina Serviceberry	50mm Cal	WB	As Shown	
CEL	Celtis occidentalis	Hackberry	50mm Cal	WB	As Shown	
CRC	Crataegus crus-galli 'Inermis'	Thornless Cockspur Hawthorn	50mm Cal	WB	As Shown	
GTI	Gleditsia triacanthos var. inermis 'Impicola'	Imperial Honeylocust	50mm Cal	WB	As Shown	
GTH	Gleditsia triacanthos var. inermis 'Halka'	Halka Honeylocust	50mm Cal	WB	As Shown	
GYE	Gymnocladus dioica 'Espresso-JFS'	Espresso Kentucky Coffee Tree	50mm Cal	WB	As Shown	
MPF	Malus 'Prairie Fire'	Prairie Crabapple	50mm Cal	WB	As Shown	
MLS	Malus 'Spring Snow'	Spring Snow Crabapple	50mm Cal	WB	As Shown	
MST	Malus 'Sugar Tyme'	Sugar Tyme Crabapple	50mm Cal	WB	As Shown	
SAM	Sorbus aucuparia 'Michred'	Cardinal Royal Mountain Ash	50mm Cal	WB	As Shown	
TAB	Tilia americana 'Boulevard'	Boulevard Linden	50mm Cal	WB	As Shown	
UAB	Ulmus americana 'Brandon'	Brandon Elm	50mm Cal	WB	As Shown	
UF	Ulmus americana 'Frontier'	Frontier Elm	50mm Cal	WB	As Shown	
UAP	Ulmus americana 'Princeton'	Princeton Elm	50mm Cal	WB	As Shown	

PARKING LOT PLANT LIST

Code	Shrub Name	Common Name	Height	Width	Notes
Jco	Juniperus horizontalis 'Plumosa Compacta'	Compact Andorra Juniper	60cm Spr	PT	100cm O.C.
Pfs	Potentilla fruticosa 'Bella Sol'	Bella Sol Potentilla	40cm Ht	PT	60cm O.C.
Rag	Rhus aromatica 'Gro-Low'	Gro-Low Fragrant Sumac	60cm Ht	PT	90cm O.C.
Rdp	Rosa 'Dwarf Pavement'	Dwarf Pavement Rose	60cm Ht	PT	120cm O.C.
Sjs	Spiraea japonica 'Shirobana'	Shirobana Spirea	40cm Ht	PT	60cm O.C.
Sac	Spiraea x arguta 'Compacta'	Dwarf Garland Spirea	60cm Ht	PT	90cm O.C.
acmf	Achillea millefolium	Common Yarrow	1tr	PT	45cm O.C.
acmt	Achillea millefolium 'Terra Cotta'	Terra Cotta Yarrow	1tr	PT	45cm O.C.
epp	Echinacea purpurea	Purple Coneflower	1g	PT	45cm O.C.
gai	Gaillardia x grandiflora	Blanket Flower	1g	PT	30cm O.C.
rwj	Wepeta faasseni 'Walker's Low'	Walker's Low Catmint	1tr	PT	60cm O.C.
pls	Perovskia atriplicifolia 'Little Spire'	Dwarf Russian Sage	1g	PT	60cm O.C.
son	Solidago nemoralis	Old Field Goldenrod	1tr	PT	30cm O.C.
sor	Solidago rigida	Stiff Goldenrod	1tr	PT	45cm O.C.
al	Symphotrichum laeve	Smooth Aster	1tr	PT	60cm O.C.
ckf	Calamagrostis acutiflora 'Karl Foerster'	Karl Foerster Feather Reed Grass	1g	PT	60cm O.C.
dcg	Deschampsia cespitosa 'Goldtau'	Gold Dew Tufted Hair Grass	1g	PT	30cm O.C.
scb	Schizachyrium scoparium 'The Blues'	The Blues Little Bluestem	1g	PT	60cm O.C.
sh	Sporobolus heterolepis	Prairie Dropseed	1g	PT	60cm O.C.

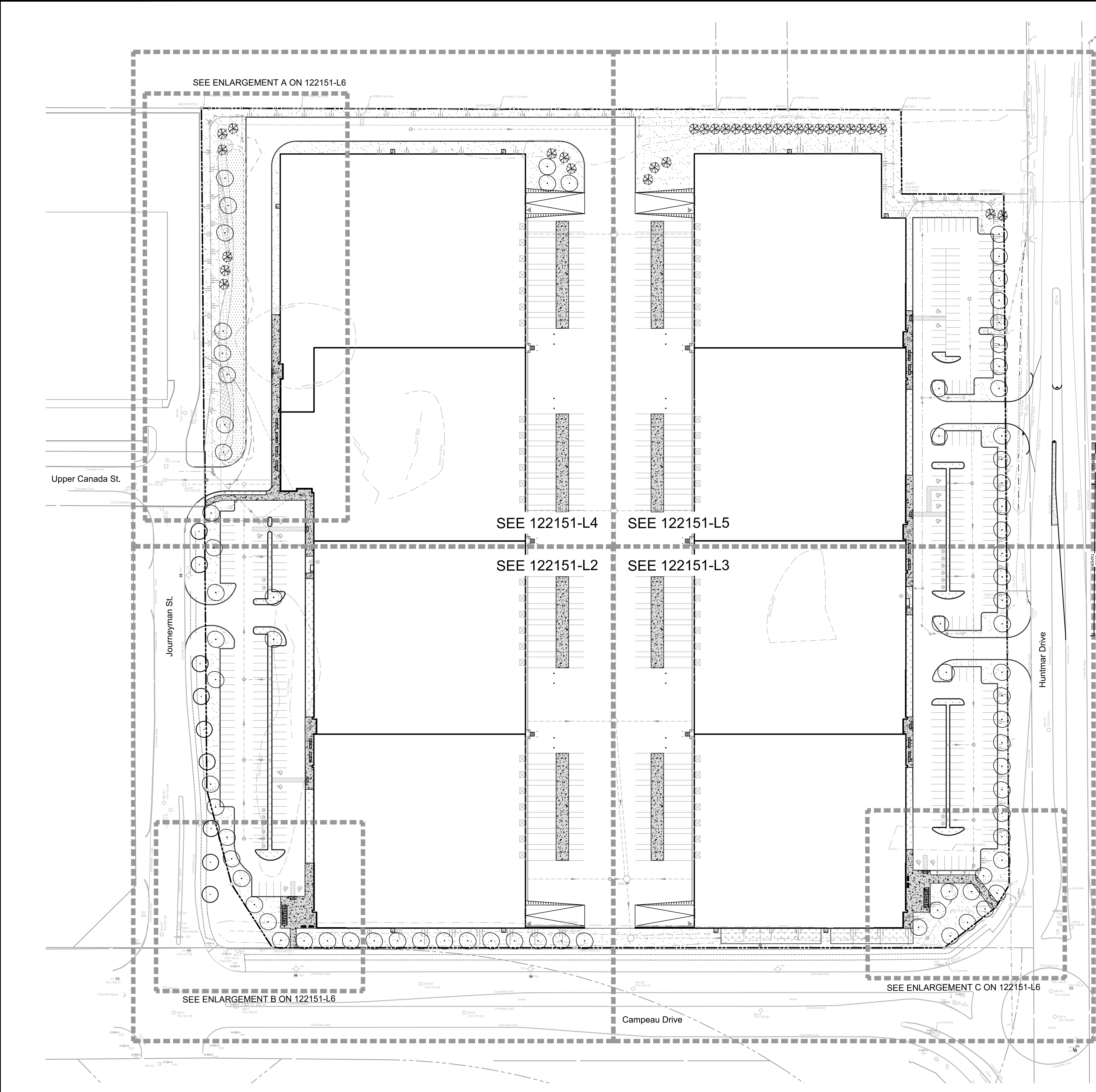

NOTE:
THE POSITION OF ALL POLE LINES, CONDUITS, WATERMANS, SEWERS AND OTHER UNDERGROUND AND OVERGROUND UTILITIES AND STRUCTURES IS NOT NECESSARILY SHOWN ON THE CONTRACT DRAWINGS, AND WHERE SHOWN, THE ACCURACY OF THE POSITION OF SUCH UTILITIES AND STRUCTURES IS NOT GUARANTEED. BEFORE STARTING WORK, DETERMINE THE EXACT LOCATION OF ALL SUCH UTILITIES AND STRUCTURES AND ASSUME ALL LIABILITY FOR DAMAGE TO THEM.

Owner:
Rosefellow
c/o Julian Nieli
750 Mariek Laun, Suite 210
Saint-Laurent, QC H4M 2M4
Phone: (514) 532-1080

NOT FOR CONSTRUCTION

No.	REVISION	DATE	BY
1.	ISSUED FOR CITY OF OTTAWA REVIEW	DEC 16/22	RGJ

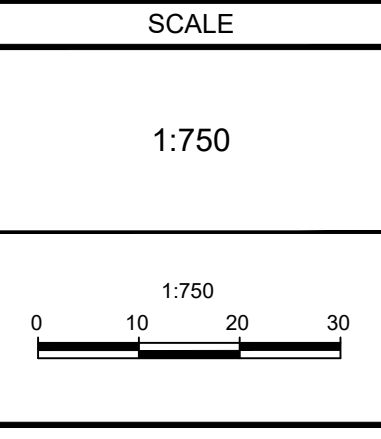

DESIGN	KW
CHECKED	RGJ
DRAWN	KW
CHECKED	KW
APPROVED	RGJ

FOR REVIEW ONLY

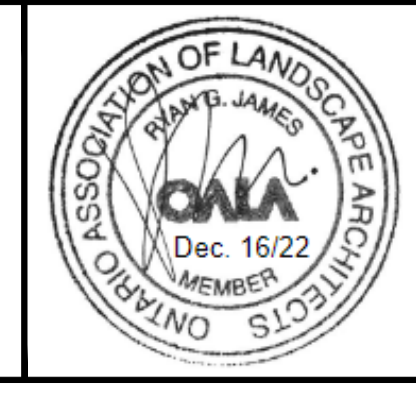

NOVATECH
Engineers, Planners & Landscape Architects
Suite 200, 240 Michael Cowpland Drive
Ottawa, Ontario, Canada K2M 1P6
Telephone: (613) 254-9643
Facsimile: (613) 254-5867
Website: www.novatech-eng.com

LOCATION
CITY OF OTTAWA
405 HUNTMAR DRIVE - WAREHOUSE DEVELOPMENT

DRAWING NAME
OVERALL LANDSCAPE PLAN

PROJECT No. 122151
REV #1
DRAWING No. 122151-L1

SEE 122151-L4

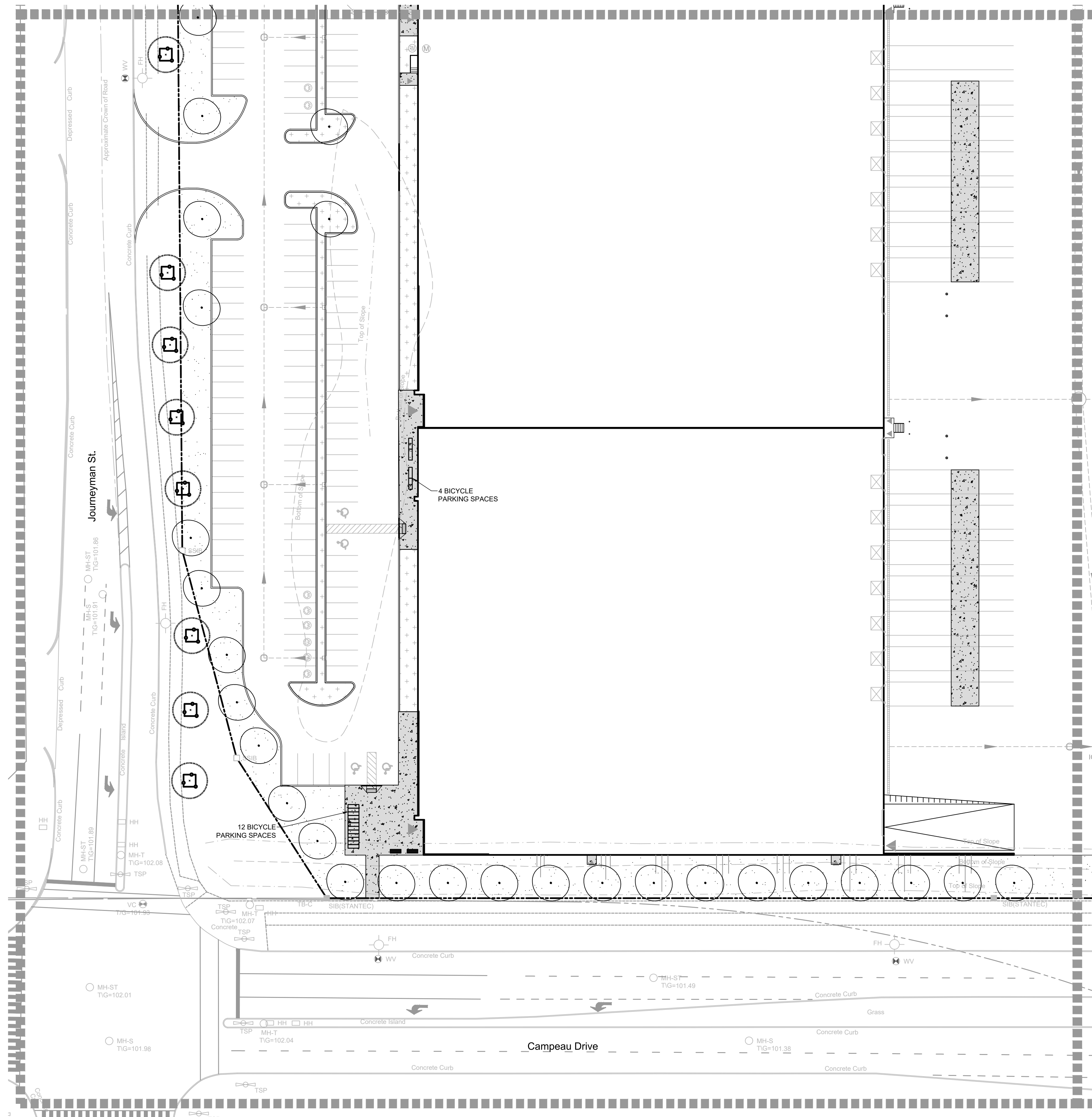

SEE 122151-L3

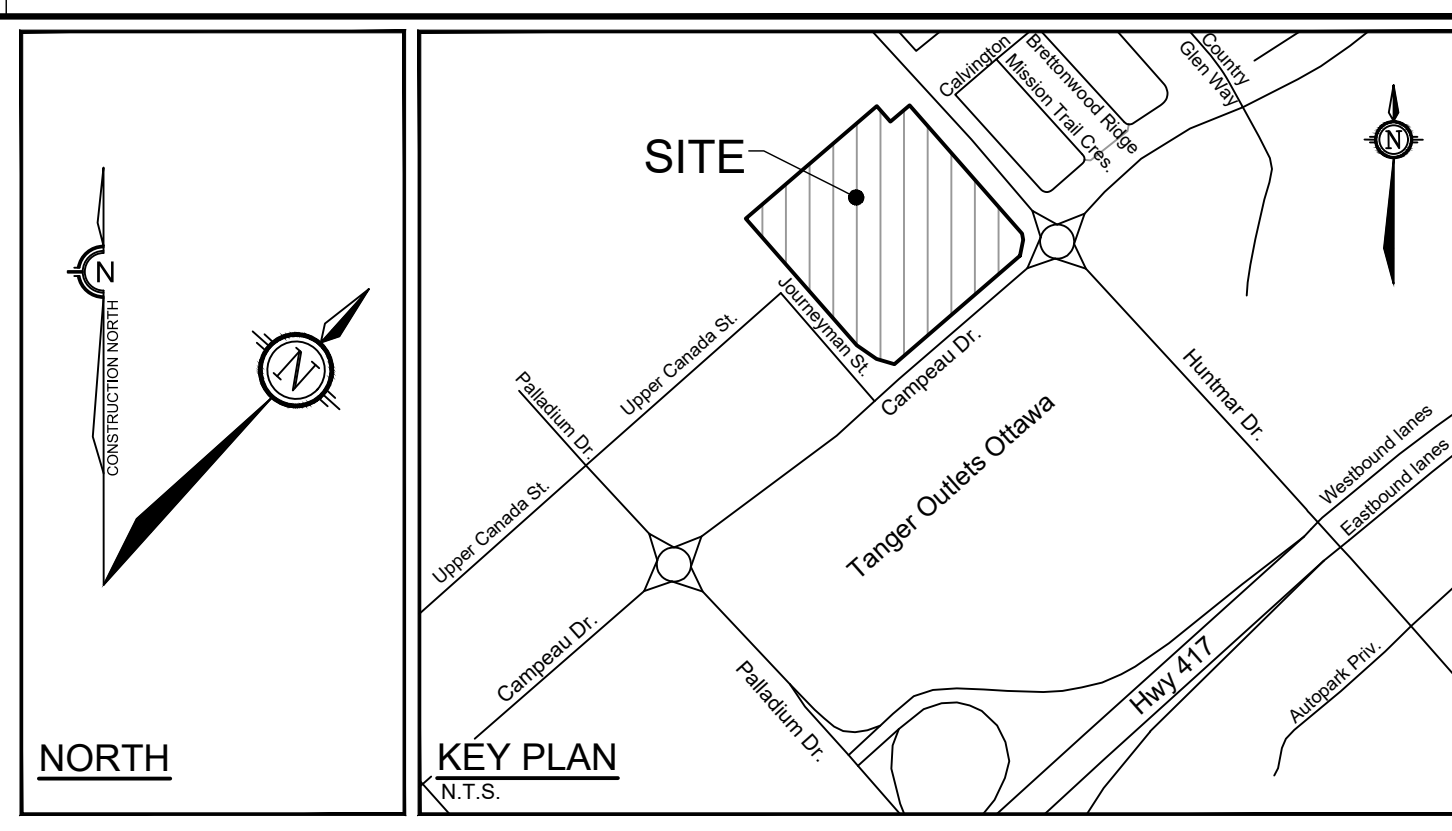

LEGEND

- 3-D1** DETAIL SHEET # NOVATECH OR CITY DETAIL NUMBER SEE LIST FOR CODE
- PROPERTY LIMIT
- TREE PROTECTION FENCE
- [Pattern] PROPOSED CONCRETE
- [Pattern] SOD
- [Pattern] PROPOSED PLANTING BED
- [Pattern] SEED MIX A
- [Pattern] PROPOSED DRY SHRUB MIX
- [Pattern] PROPOSED WET SHRUB MIX
- [Symbol] PROPOSED DECIDUOUS TREE
- [Symbol] PROPOSED CONIFEROUS TREE
- [Symbol] EXISTING TREE TO REMAIN
- [Symbol] BENCH
- [Symbol] SPECIES (SEE PLANT LIST)
- [Symbol] QUANTITY
- [Symbol] NATURALIZATION MIX
- [Symbol] AREA

TREE PROTECTION

- Implement the following protection measures for retained trees, both on site and on adjacent sites, prior to any work activity, including tree removal. Maintain tree protection fence in place and in good condition for the duration of site works:
- The Landscape Architect or Certified Arborist is to determine the location of the tree protection fencing and detail it on any associated plans for the site (e.g. tree conservation report, tree disclosure report, etc.).
 - Under the guidance of a Landscape Architect or Certified Arborist, erect a fence at the critical root zone (CRZ) of trees. Diameter at breast height (DBH) is the trunk diameter measured at 1.3m height on the tree trunk. The CRZ is calculated as DBH x 10. Refer to the Tree Protection Fence detail.
 - Refer to the Tree Protection Plan for fence location. City Forestry Staff are to approve both the plan and the installed fence prior to work commencement.
 - Do not place any material or equipment within 2m of the CRZ of any tree, including outhouses.
 - Do not attach any signs, notices, or posters to any tree.
 - Do not disturb, raise, or lower the existing grade within the CRZ without approval.
 - Only tunnel or bore when digging within the CRZ of a tree. Hand work only where required within the CRZ, absolutely no machinery permitted.
 - Do not damage the root system, trunk, or branches, or any tree.
 - Do not extend hard surface or significantly change landscaping.
 - Ensure that exhaust fumes from all equipment are directed away from any tree canopy.
 - When trees marked for removal overlap with the CRZ of trees marked for preservation: cut roots at the edge of the CRZ and grind down stumps after tree removals, do not pull out stumps. Ensure there is not root pulling or disturbance of the ground within the CRZ.
 - Prior to work taking place, notify and consult the Landscape Architect and City Forestry Staff if roots must be cut. Roots 20mm or larger should be cut at right angles with clean, sharp horticultural tools without tearing, crushing, or pulling. Refer to City of Ottawa Specification S.P. F-8011 Tree Protection, Excavation of Root Zone.
 - If damaged or objectionable branches are observed, consult the Landscape Architect, before any work is conducted. Do not prune leaders. Do not prune more than 1/4 of crown.
 - Set up a water and fertilizing program, if trees are being affected by site works, to the satisfaction of the Landscape Architect.
 - The Landscape Architect is to prescribe mitigation measures if the protected fenced area must be reduced to facilitate construction. Measures may include the placement of plywood, wood chips, or steel plating over the roots for protection. City Forestry Staff are to approve said measures prior to fence movement.
 - City of Ottawa By-law: Protects municipal trees and municipal natural areas in the City of Ottawa and trees on private property in the urban area of the City of Ottawa (2020-340).

PLANTING

- Plant material to be No. 1 Grade and is to comply with Canadian Standards for Nursery Stock (latest edition).
- Plant material substitutions are not to be permitted without the written approval from the Consultant, with 48 hours notice, prior to shipping plant material.
- Plant locations are schematic / approximate only. Contractor is to stake out locations on site for approval by the Landscape Architect prior to installation.
- The illustrated number of plants shown in the Planting Plan supersedes the estimated number in the Plant List. Contractor to report any discrepancies to the Landscape Architect prior to installation. Contractor will assume full responsibility if the Landscape Architect is not notified.
- Ensure trees are thoroughly watered following planting. Monitor material and ensure adequate moisture until acceptance.
- In heavy clay or poorly drained soils, set root ball with root collar 75-100mm higher than finished grade.
- Approved topsoil depths are as follows:
 - a. Plant Beds - 450mm continuous depth. Applies to shrubs, perennials, vines, and groundcovers.
 - b. Sod/Seed Areas - 100mm depth.
- Sod to be No. 1 Kentucky Bluegrass Sod grown from minimum mixture of 3 Kentucky Bluegrass cultivars. Quality and source are to comply with Canadian Standards for Nursery Stock, Section 17, (latest edition) published by the Canadian Nursery Landscape Nursery Landscape Association.
- Install a 1.2m sod strip adjacent to all hard surfaces. Note, sod is not typically graphically shown on plans.
- Apply the following mineral fertilizer unless soil tests show other requirements:
 - a. Plant Beds - (8-32-16), i.e. 8% Nitrogen, 32% Phosphorus, 16% Potash per manufacturer specifications.
 - b. Sod Areas - (8-32-16), i.e. 8% Nitrogen, 32% Phosphorus, 16% Potash at a rate of 350kg/ha.
- Where applicable, for any plant areas with a mix of species/cultivars notes, Contractor is to cluster like plants in groups of 3-5 and evenly distribute these in the noted area.

CITY DETAILS

- Related details from City of Ottawa Standard Tender Documents Volume No. 2 Standard Detail Drawings.
- SC4. Typical Concrete Sidewalk in Boulevard
 - SC5. Sidewalk Construction Joints

NOVATECH DETAILS

- Found on Sheet L7.
- D1. Standard Deciduous Tree Planting
 - D2. Standard Coniferous Tree Planting
 - D3. Shrub and Perennial Planting
 - D4. Tree Protection Fence
 - D5. Bike Layout
 - D6. Site furniture installation
 - D7. Reforestation

NOTE:
THE POSITION OF ALL POLE LINES, CONDUITS, WATERMANS, SEWERS AND OTHER UNDERGROUND AND OVERGROUND UTILITIES AND STRUCTURES IS NOT NECESSARILY SHOWN ON THE CONTRACT DRAWINGS, AND WHERE SHOWN, THE ACCURACY OF THE POSITION OF SUCH UTILITIES AND STRUCTURES IS NOT GUARANTEED. BEFORE STARTING WORK, DETERMINE THE EXACT LOCATION OF ALL SUCH UTILITIES AND STRUCTURES AND ASSUME ALL LIABILITY FOR DAMAGE TO THEM.

Owner:
[corporation name]
c/o [contact name]
[address line 1]
Ottawa, ON [postal]
Phone: XXXX XXX-XXXX

NOT FOR CONSTRUCTION

No.	REVISION	DATE	BY
1.	ISSUED FOR CITY OF OTTAWA REVIEW	DEC 16/22	RGJ

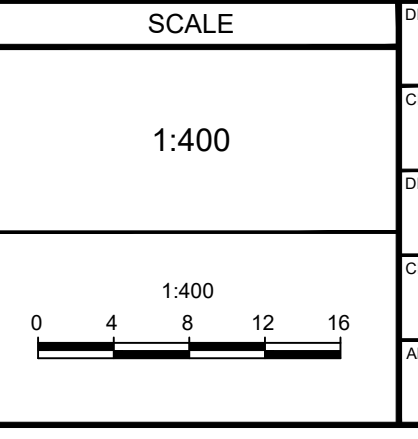

DESIGN	FOR REVIEW ONLY
KW	
CHECKED RGJ	
DRAWN KW	
CHECKED KW	
APPROVED RGJ	

NOVATECH
Engineers, Planners & Landscape Architects
Suite 200, 240 Michael Cowpland Drive
Ottawa, Ontario, Canada K2M 1P6
Telephone (613) 254-9643
Facsimile (613) 254-5867
Website www.novatech-eng.com

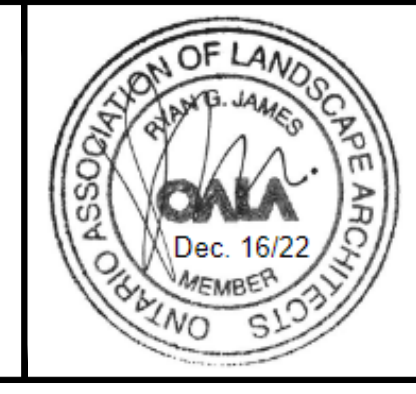

LOCATION		PROJECT No.
CITY OF OTTAWA 405 HUNTMAR DRIVE - WAREHOUSE DEVELOPMENT		122151
DRAWING NAME		REV #1
LANDSCAPE PLAN		122151-L2

M:\2022\122151\122151-L2.dwg L2 Dec 16 2022 2:57pm Wambler

SEE 122151-L5

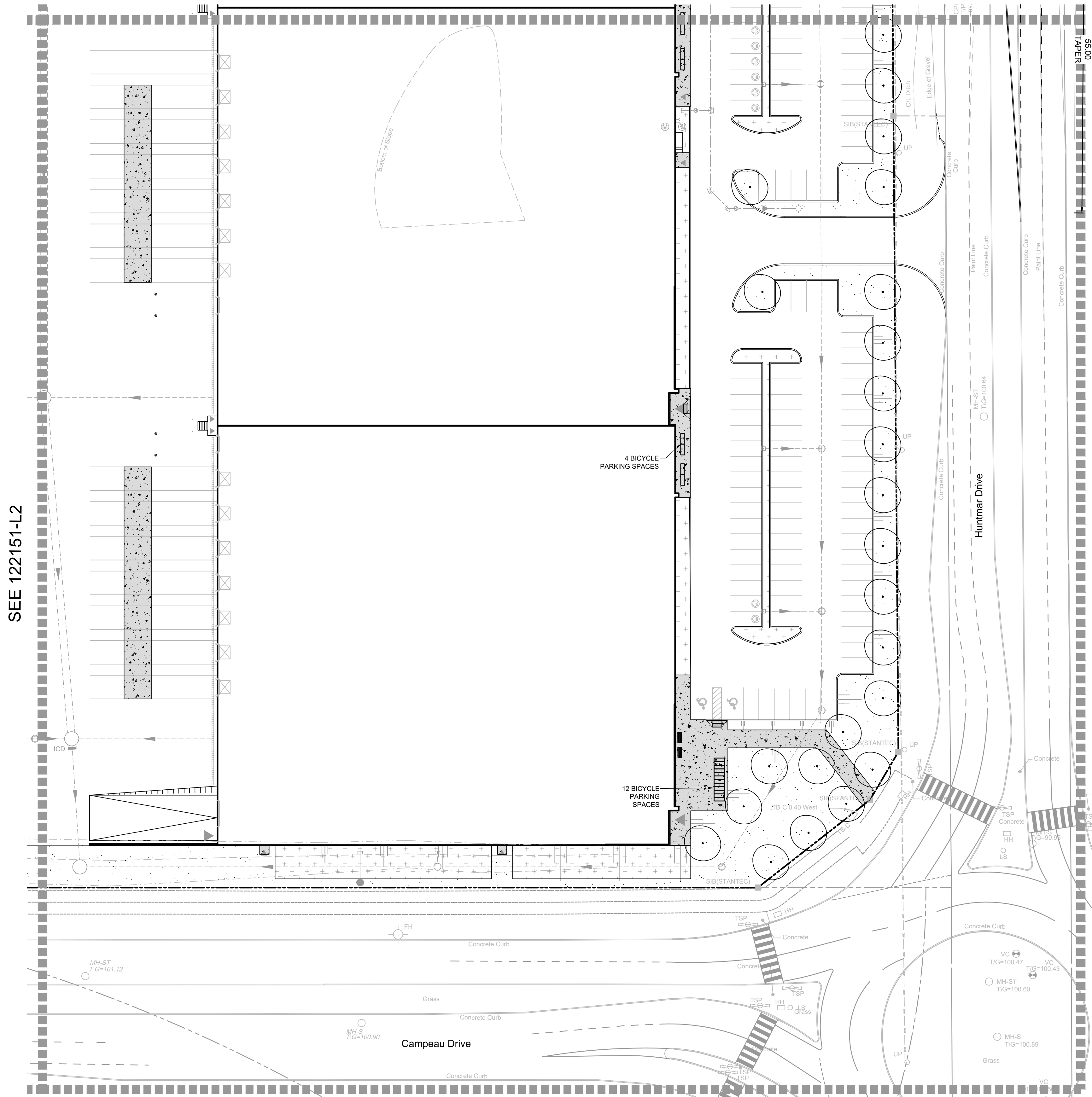

SEE 122151-L2

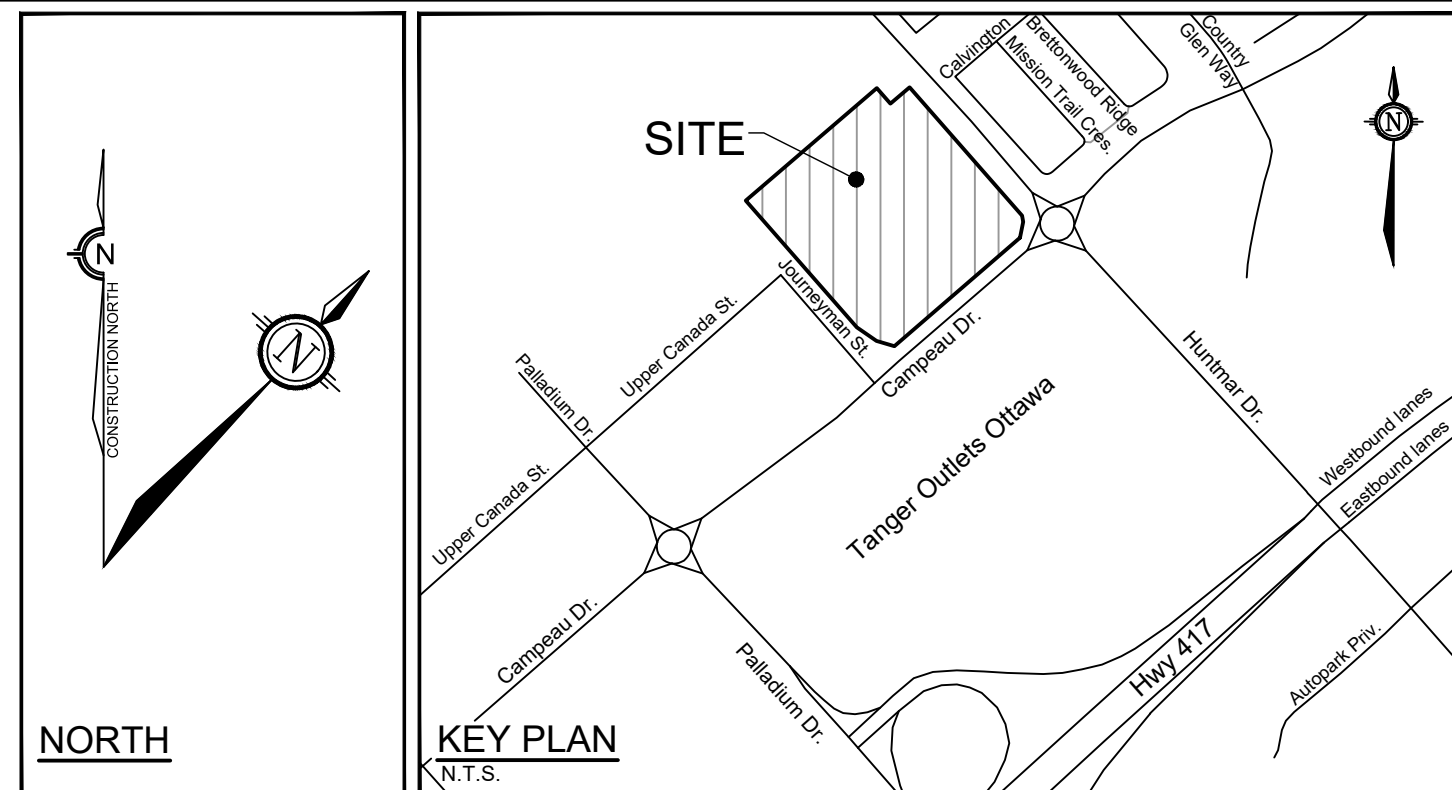

LEGEND

- 3-D1** DETAIL SHEET # NOVATECH OR CITY
EG. L1, L2, ETC. DETAIL NUMBER SEE LIST
FOR CODE
- PROPERTY LIMIT
- TREE PROTECTION FENCE
- PROPOSED CONCRETE
- SOD
- PROPOSED PLANTING BED
- SEED MIX A
- PROPOSED DRY SHRUB MIX
- PROPOSED WET SHRUB MIX
- PROPOSED DECIDUOUS TREE
- PROPOSED CONIFEROUS TREE
- EXISTING TREE TO REMAIN
- BENCH
- KEY ## SPECIES (SEE PLANT LIST)
- QUANTITY
- NATURALIZATION MIX
- AREA

TREE PROTECTION

- Implement the following protection measures for retained trees, both on site and on adjacent sites, prior to any work activity, including tree removal. Maintain tree protection fence in place and in good condition for the duration of site works:
- The Landscape Architect or Certified Arborist is to determine the location of the tree protection fencing and detail it on any associated plans for the site (e.g. tree conservation report, tree disclosure report, etc.).
 - Under the guidance of a Landscape Architect or Certified Arborist, erect a fence at the critical root zone (CRZ) of trees. Diameter at breast height (DBH) is the trunk diameter measured at 1.3m height on the tree trunk. The CRZ is calculated as DBH x 10. Refer to the Tree Protection Fence detail.
 - Refer to the Tree Protection Plan for fence location. City Forestry Staff are to approve both the plan and the installed fence prior to work commencement.
 - Do not place any material or equipment within 2m of the CRZ of any tree, including outhouses.
 - Do not attach any signs, notices, or posters to any tree.
 - Do not disturb, raise, or lower the existing grade within the CRZ without approval.
 - Only tunnel or bore when digging within the CRZ of a tree. Hand work only where required within the CRZ, absolutely no machinery permitted.
 - Do not damage the root system, trunk, or branches, or any tree.
 - Do not extend hard surface or significantly change landscaping.
 - Ensure that exhaust fumes from all equipment are directed away from any tree canopy.
 - When trees marked for removal overlap with the CRZ of trees marked for preservation: cut roots at the edge of the CRZ and grind down stumps after tree removals, do not pull out stumps. Ensure there is no root pulling or disturbance of the ground within the CRZ.
 - Prior to work taking place, notify and consult the Landscape Architect and City Forestry Staff if roots must be cut. Roots 20mm or larger should be cut at right angles with clean, sharp horticultural tools without tearing, crushing, or pulling. Refer to City of Ottawa Specification S.P. F-8011 Tree Protection, Excavation of Root Zone.
 - If damaged or objectionable branches are observed, consult the Landscape Architect, before any work is conducted. Do not prune leaders. Do not prune more than 1/4 of crown.
 - Set up a water and fertilizing program, if trees are being affected by site works, to the satisfaction of the Landscape Architect.
 - The Landscape Architect is to prescribe mitigation measures if the protected fenced area must be reduced to facilitate construction. Measures may include the placement of plywood, wood chips, or steel plating over the roots for protection. City Forestry Staff are to approve said measures prior to fence movement.
 - City of Ottawa By-law: Protects municipal trees and municipal natural areas in the City of Ottawa and trees on private property in the urban area of the City of Ottawa (2020-340).

PLANTING

- Plant material to be No. 1 Grade and is to comply with Canadian Standards for Nursery Stock (latest edition) published by the Canadian Nursery Landscape Association.
- Use structurally sound plant material with strong fibrous root system free of disease, defects, and injuries. Use trees with straight trunks, well and characteristically branched for species. Obtain approval from consultant of plant material at source prior to digging. All trees and shrubs to be container grown, potted, W/B or B/B, as indicated on Plant List. Bare root plants are only acceptable for certain species and as approved by the Landscape Architect.
- Plant material substitutions are not to be permitted without the written approval from the Consultant, with 48 hours notice, prior to shipping plant material.
- Plant locations are schematic / approximate only. Contractor is to stake out locations on site for approval by the Landscape Architect prior to installation.
- The illustrated number of plants shown in the Planting Plan supersedes the estimated number in the Plant List. Contractor to report any discrepancies to the Landscape Architect prior to installation. Contractor will assume full responsibility if the Landscape Architect is not notified.
- Ensure trees are thoroughly watered following planting. Monitor material and ensure adequate moisture until acceptance.
- In heavy clay or poorly drained soils, set root ball with root collar 75-100mm higher than finished grade.
- Approved topsoil depths are as follows:
 - Plant Beds - 450mm continuous depth. Applies to shrubs, perennials, vines, and groundcovers.
 - Sod/ Seed Areas - 100mm depth.
- Sod to be No. 1 Kentucky Bluegrass Sod grown from minimum mixture of 3 Kentucky Bluegrass cultivars. Quality and source are to comply with Canadian Standards for Nursery Stock, Section 17, (latest edition) published by the Canadian Nursery Landscape Nursery Landscape Association.
- Install a 1.2m sod strip adjacent to all hard surfaces. Note, sod is not typically graphically shown on plans.
- Apply the following mineral fertilizer unless soil tests show other requirements:
 - Plant Beds - (8-32-16), i.e. 8% Nitrogen, 32% Phosphorus, 16% Potash per manufacturer specifications.
 - Sod Areas - (8-32-16), i.e. 8% Nitrogen, 32% Phosphorus, 16% Potash at a rate of 350kg/ha.
- Where applicable, for any plant areas with a mix of species/ cultivars notes, Contractor is to cluster like plants in groups of 3-5 and evenly distribute these in the noted area.

CITY DETAILS

- Related details from City of Ottawa Standard Tender Documents Volume No. 2 Standard Detail Drawings.
- SC4. Typical Concrete Sidewalk in Boulevard
 - SC5. Sidewalk Construction Joints

NOVATECH DETAILS

- Found on Sheet L7.
- D1. Standard Deciduous Tree Planting
 - D2. Standard Coniferous Tree Planting
 - D3. Shrub and Perennial Planting
 - D4. Tree Protection Fence
 - D5. Bike Layout
 - D6. Site furniture installation
 - D7. Reforestation

NOTE:
THE POSITION OF ALL POLE LINES, CONDUITS, WATERMANS, SEWERS AND OTHER UNDERGROUND AND OVERGROUND UTILITIES AND STRUCTURES IS NOT NECESSARILY SHOWN ON THE CONTRACT DRAWINGS, AND WHERE SHOWN, THE ACCURACY OF THE POSITION OF SUCH UTILITIES AND STRUCTURES IS NOT GUARANTEED. BEFORE STARTING WORK, DETERMINE THE EXACT LOCATION OF ALL SUCH UTILITIES AND STRUCTURES AND ASSUME ALL LIABILITY FOR DAMAGE TO THEM.

Owner:
[corporation name]
c/o [contact name]
[address line 1]
Ottawa, ON [postal]
Phone: XXX-XXX-XXXX

NOT FOR CONSTRUCTION

No.	REVISION	DATE	BY
1.	ISSUED FOR CITY OF OTTAWA REVIEW	DEC 16/22	RGJ

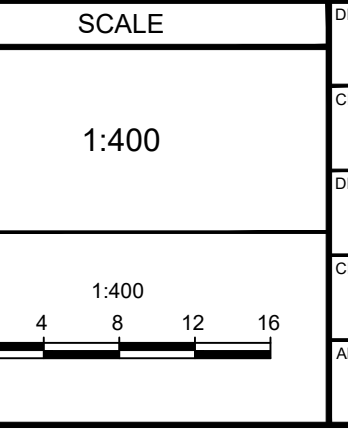

DESIGN	KW
CHECKED	RGJ
DRAWN	KW
CHECKED	KW
APPROVED	RGJ

FOR REVIEW ONLY

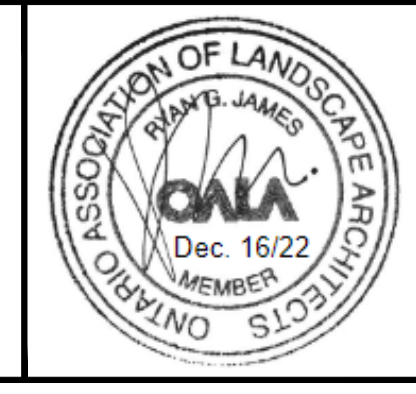

NOVATECH
Engineers, Planners & Landscape Architects
Suite 200, 240 Michael Cowpland Drive
Ottawa, Ontario, Canada K2M 1P6
Telephone (613) 254-9643
Facsimile (613) 254-5867
Website www.novatech-eng.com

LOCATION CITY OF OTTAWA 405 HUNTMAR DRIVE - WAREHOUSE DEVELOPMENT	
DRAWING NAME LANDSCAPE PLAN	PROJECT No. 122151
	REV #1
	DRAWING No. 122151-L3

M:\2022\122151\122151-L3.dwg L3 Dec 16 2022 2:57pm Wambson

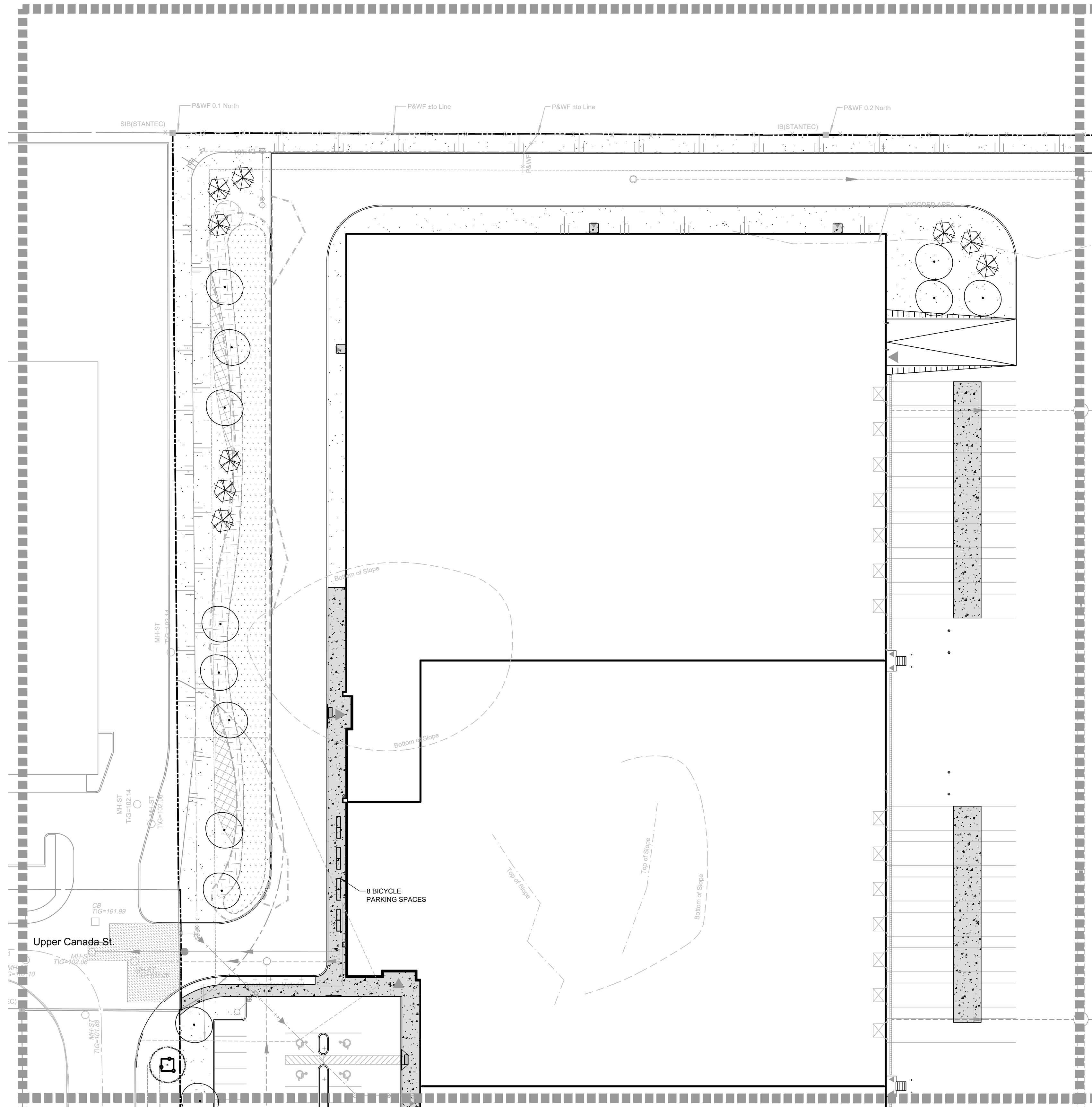

SEE 122151-L2

SEE 122151-L5

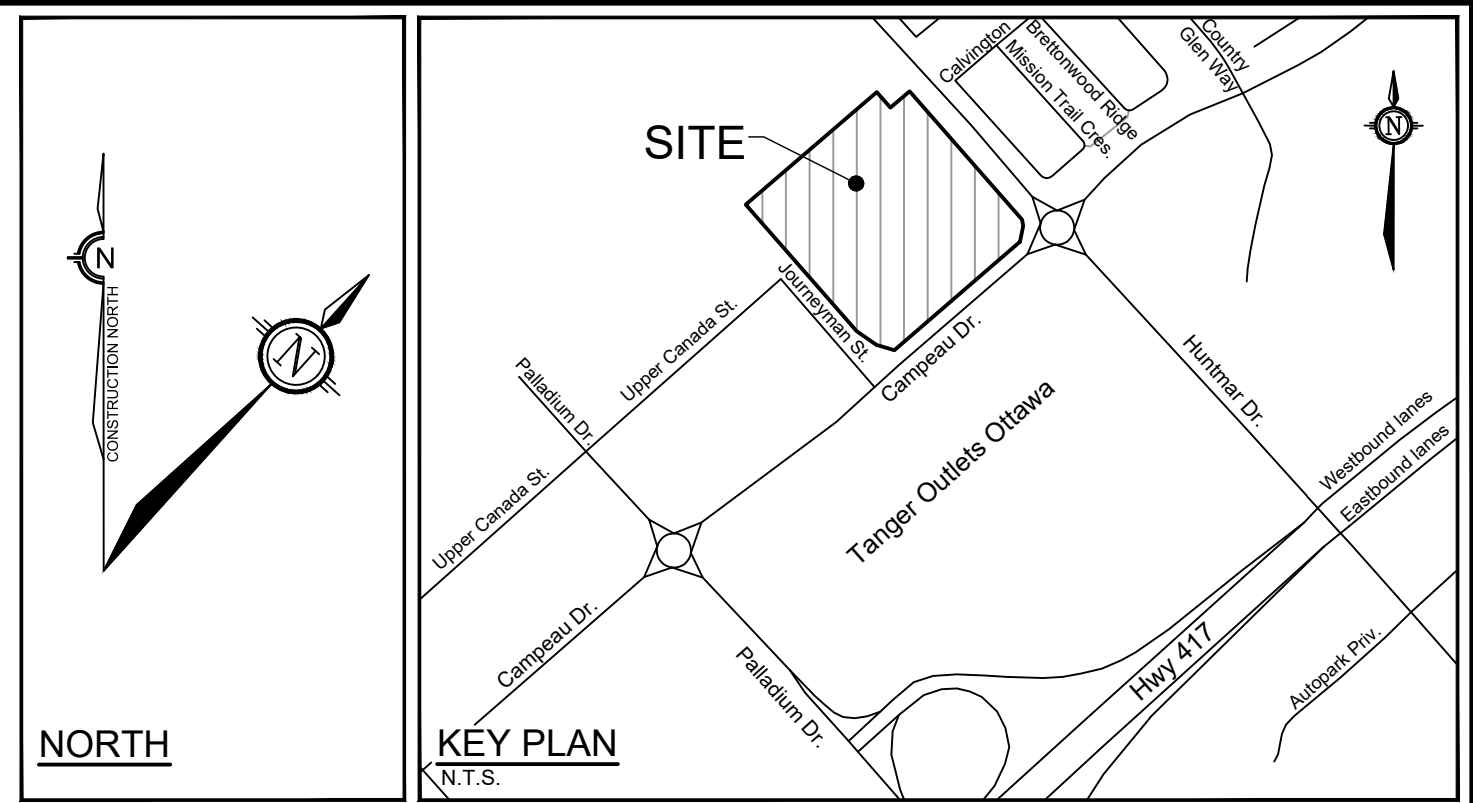

LEGEND

- 3-D1** DETAIL SHEET # NOVATECH OR CITY
EG. L1, L2, ETC. DETAIL NUMBER SEE LIST FOR CODE
- PROPERTY LIMIT
- TREE PROTECTION FENCE
- PROPOSED CONCRETE
- SOD
- PROPOSED PLANTING BED
- SEED MIX A
- PROPOSED DRY SHRUB MIX
- PROPOSED WET SHRUB MIX
- PROPOSED DECIDUOUS TREE
- PROPOSED CONIFEROUS TREE
- EXISTING TREE TO REMAIN
- BENCH
- SPECIES (SEE PLANT LIST)
- QUANTITY
- NATURALIZATION MIX
- AREA

TREE PROTECTION

- Implement the following protection measures for retained trees, both on site and on adjacent sites, prior to any work activity, including tree removal. Maintain tree protection fence in place and in good condition for the duration of site works:
- The Landscape Architect or Certified Arborist is to determine the location of the tree protection fencing and detail it on any associated plans for the site (e.g. tree conservation report, tree disclosure report, etc.).
 - Under the guidance of a Landscape Architect or Certified Arborist, erect a fence at the critical root zone (CRZ) of trees. Diameter at breast height (DBH) is the trunk diameter measured at 1.3m height on the tree trunk. The CRZ is calculated as DBH x 10. Refer to the Tree Protection Fence detail.
 - Refer to the Tree Protection Plan for fence location. City Forestry Staff are to approve both the plan and the installed fence prior to work commencement.
 - Do not place any material or equipment within 2m of the CRZ of any tree, including outhouses.
 - Do not attach any signs, notices, or posters to any tree.
 - Do not disturb, raise, or lower the existing grade within the CRZ without approval.
 - Only tunnel or bore when digging within the CRZ of a tree. Hand work only where required within the CRZ, absolutely no machinery permitted.
 - Do not damage the root system, trunk, or branches, or any tree.
 - Do not extend hard surface or significantly change landscaping.
 - Ensure that exhaust fumes from all equipment are directed away from any tree canopy.
 - When trees marked for removal overlap with the CRZ of trees marked for preservation: cut roots at the edge of the CRZ and grind down stumps after tree removals, do not pull out stumps. Ensure there is not root pulling or disturbance of the ground within the CRZ.
 - Prior to work taking place, notify and consult the Landscape Architect and City Forestry Staff if roots must be cut. Roots 20mm or larger should be cut at right angles with clean, sharp horticultural tools without tearing, crushing, or pulling. Refer to City of Ottawa Specification S.P. F-8011 Tree Protection, Excavation of Root Zone.
 - If damaged or objectionable branches are observed, consult the Landscape Architect, before any work is conducted. Do not prune leaders. Do not prune more than 1/4 of crown.
 - Set up a water and fertilizing program, if trees are being affected by site works, to the satisfaction of the Landscape Architect.
 - The Landscape Architect is to prescribe mitigation measures if the protected fenced area must be reduced to facilitate construction. Measures may include the placement of plywood, wood chips, or steel plating over the roots for protection. City Forestry Staff are to approve said measures prior to fence movement.
 - City of Ottawa By-law: Protects municipal trees and municipal natural areas in the City of Ottawa and trees on private property in the urban area of the City of Ottawa (2020-340).

PLANTING

- Plant material to be No. 1 Grade and is to comply with Canadian Standards for Nursery Stock (latest edition) published by the Canadian Nursery Landscape Association.
- Use structurally sound plant material with strong fibrous root system free of disease, defects, and injuries. Use trees with straight trunks, well and characteristically branched for species. Obtain approval from consultant of plant material at source prior to digging. All trees and shrubs to be container grown, potted, W/B or B/B, as indicated on Plant List. Bare root plants are only acceptable for certain species and as approved by the Landscape Architect.
- Plant material substitutions are not to be permitted without the written approval from the Consultant, with 48 hours notice, prior to shipping plant material.
- Plant locations are schematic / approximate only. Contractor is to stake out locations on site for approval by the Landscape Architect prior to installation.
- The illustrated number of plants shown in the Planting Plan supersedes the estimated number in the Plant List. Contractor to report any discrepancies to the Landscape Architect prior to installation. Contractor will assume full responsibility if the Landscape Architect is not notified.
- Ensure trees are thoroughly watered following planting. Monitor material and ensure adequate moisture until acceptance.
- In heavy clay or poorly drained soils, set root ball with root collar 75-100mm higher than finished grade.
- Approved topsoil depths are as follows:
 - Plant Beds - 450mm continuous depth. Applies to shrubs, perennials, vines, and groundcovers.
 - Sod/Seed Areas - 100mm depth.
- Sod to be No. 1 Kentucky Bluegrass Sod grown from minimum mixture of 3 Kentucky Bluegrass cultivars. Quality and source are to comply with Canadian Standards for Nursery Stock, Section 17, (latest edition) published by the Canadian Nursery Landscape Nursery Landscape Association.
- Install a 1.2m sod strip adjacent to all hard surfaces. Note, sod is not typically graphically shown on plans.
- Apply the following mineral fertilizer unless soil tests show other requirements:
 - Plant Beds - (8-32-16), i.e. 8% Nitrogen, 32% Phosphorus, 16% Potash per manufacturer specifications.
 - Sod Areas - (8-32-16), i.e. 8% Nitrogen, 32% Phosphorus, 16% Potash at a rate of 350kg/ha.
- Where applicable, for any plant areas with a mix of species/cultivars notes, Contractor is to cluster like plants in groups of 3-5 and evenly distribute these in the noted area.

CITY DETAILS

- Related details from City of Ottawa Standard Tender Documents Volume No. 2 Standard Detail Drawings.
- SC4. Typical Concrete Sidewalk in Boulevard
 - SC5. Sidewalk Construction Joints

NOVATECH DETAILS

- Found on Sheet L7.
- D1. Standard Deciduous Tree Planting
 - D2. Standard Coniferous Tree Planting
 - D3. Shrub and Perennial Planting
 - D4. Tree Protection Fence
 - D5. Bike Layout
 - D6. Site furniture installation
 - D7. Reforestation

NOTE:
THE POSITION OF ALL POLE LINES, CONDUITS, WATERMANS, SEWERS AND OTHER UNDERGROUND AND OVERGROUND UTILITIES AND STRUCTURES IS NOT NECESSARILY SHOWN ON THE CONTRACT DRAWINGS, AND WHERE SHOWN, THE ACCURACY OF THE POSITION OF SUCH UTILITIES AND STRUCTURES IS NOT GUARANTEED. BEFORE STARTING WORK, DETERMINE THE EXACT LOCATION OF ALL SUCH UTILITIES AND STRUCTURES AND ASSUME ALL LIABILITY FOR DAMAGE TO THEM.

Owner:
[corporation name]
c/o [contact name]
[address line 1]
Ottawa, ON [postal]
Phone: XXXX XXX-XXXX

NOT FOR CONSTRUCTION

No.	REVISION	DATE	BY
1.	ISSUED FOR CITY OF OTTAWA REVIEW	DEC 16/22	RGJ

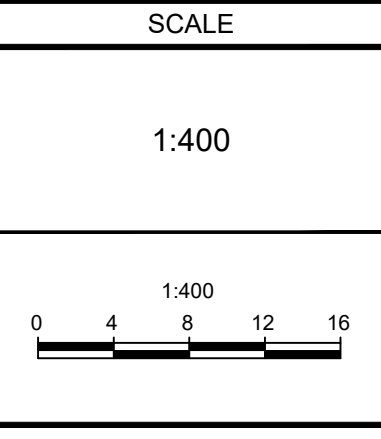

DESIGN	FOR REVIEW ONLY
KW	
CHECKED RGJ	
DRAWN KW	
CHECKED KW	
APPROVED RGJ	

NOVATECH
Engineers, Planners & Landscape Architects
Suite 200, 240 Michael Cowpland Drive
Ottawa, Ontario, Canada K2M 1P6

Telephone (613) 254-9643
Facsimile (613) 254-5867
Website www.novatech-eng.com

LOCATION	PROJECT No.
CITY OF OTTAWA 405 HUNTMAR DRIVE - WAREHOUSE DEVELOPMENT	122151
DRAWING NAME	REV #1
LANDSCAPE PLAN	122151-L4

M:\2022\122151\122151-L4.dwg L4 Dec 16 2022 2:57pm Wamban

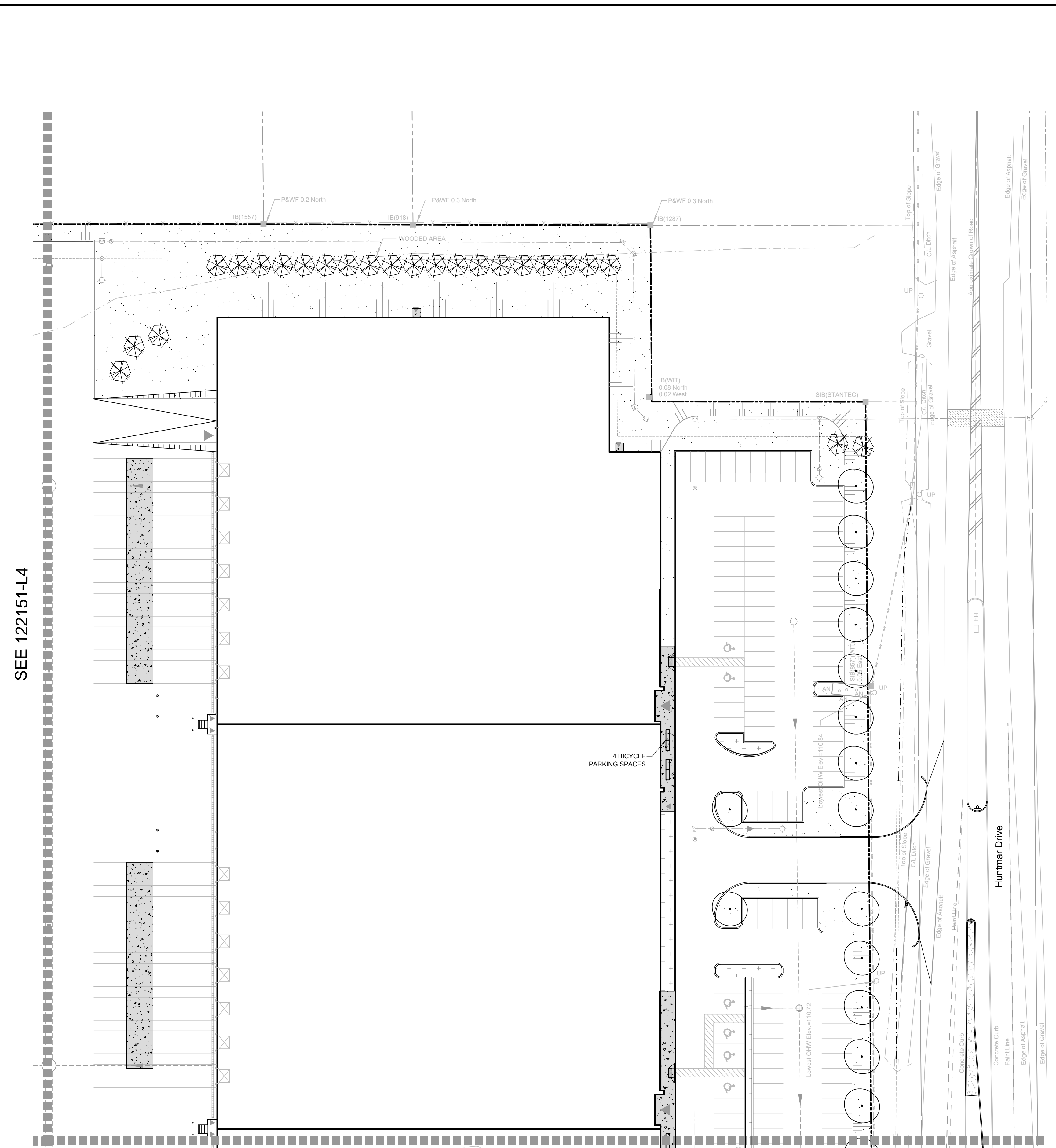

SEE 122151-L4

SEE 122151-L3

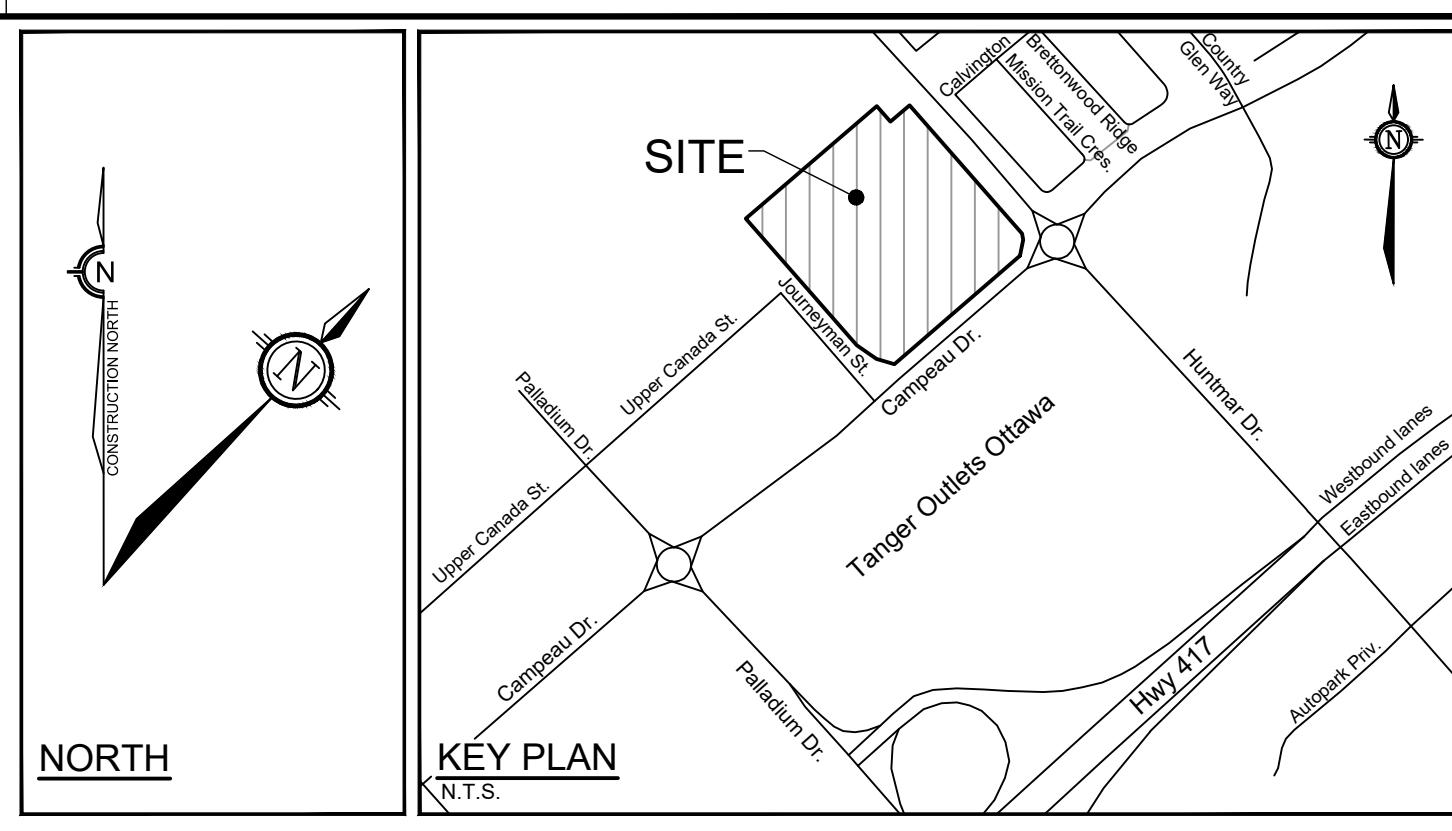

LEGEND

- 3-D1** DETAIL SHEET # NOVATECH OR CITY DETAIL NUMBER SEE LIST FOR CODE
- PROPERTY LIMIT
- TREE PROTECTION FENCE
- PROPOSED CONCRETE
- SOD
- PROPOSED PLANTING BED
- SEED MIX A
- PROPOSED DRY SHRUB MIX
- PROPOSED WET SHRUB MIX
- PROPOSED DECIDUOUS TREE
- PROPOSED CONIFEROUS TREE
- EXISTING TREE TO REMAIN
- BENCH
- SPECIES (SEE PLANT LIST)
- QUANTITY
- NATURALIZATION MIX
- AREA

TREE PROTECTION

- Implement the following protection measures for retained trees, both on site and on adjacent sites, prior to any work activity, including tree removal. Maintain tree protection fence in place and in good condition for the duration of site works:
- The Landscape Architect or Certified Arborist is to determine the location of the tree protection fencing and detail it on any associated plans for the site (e.g. tree conservation report, tree disclosure report, etc.).
 - Under the guidance of a Landscape Architect or Certified Arborist, erect a fence at the critical root zone (CRZ) of trees. Diameter at breast height (DBH) is the trunk diameter measured at 1.3m height on the tree trunk. The CRZ is calculated as DBH x 10. Refer to the Tree Protection Fence detail.
 - Refer to the Tree Protection Plan for fence location. City Forestry Staff are to approve both the plan and the installed fence prior to work commencement.
 - Do not place any material or equipment within 2m of the CRZ of any tree, including outhouses.
 - Do not attach any signs, notices, or posters to any tree.
 - Do not disturb, raise, or lower the existing grade within the CRZ without approval.
 - Only tunnel or bore when digging within the CRZ of a tree. Hand work only where required within the CRZ, absolutely no machinery permitted.
 - Do not damage the root system, trunk, or branches, or any tree.
 - Do not extend hard surface or significantly change landscaping.
 - Ensure that exhaust fumes from all equipment are directed away from any tree canopy.
 - When trees marked for removal overlap with the CRZ of trees marked for preservation: cut roots at the edge of the CRZ and grind down stumps after tree removals, do not pull out stumps. Ensure there is no root pulling or disturbance of the ground within the CRZ.
 - Prior to work taking place, notify and consult the Landscape Architect and City Forestry Staff if roots must be cut. Roots 20mm or larger should be cut at right angles with clean, sharp horticultural tools without tearing, crushing, or pulling. Refer to City of Ottawa Specification S.P. F-8011 Tree Protection, Excavation of Root Zone.
 - If damaged or objectionable branches are observed, consult the Landscape Architect, before any work is conducted. Do not prune leaders. Do not prune more than 1/4 of crown.
 - Set up a water and fertilizing program, if trees are being affected by site works, to the satisfaction of the Landscape Architect.
 - The Landscape Architect is to prescribe mitigation measures if the protected fenced area must be reduced to facilitate construction. Measures may include the placement of plywood, wood chips, or steel plating over the roots for protection. City Forestry Staff are to approve said measures prior to fence movement.
 - City of Ottawa By-law: Protects municipal trees and municipal natural areas in the City of Ottawa and trees on private property in the urban area of the City of Ottawa (2020-340).

PLANTING

- Plant material to be No. 1 Grade and is to comply with Canadian Standards for Nursery Stock (latest edition) published by the Canadian Nursery Landscape Association.
- Use structurally sound plant material with strong fibrous root system free of disease, defects, and injuries. Use trees with straight trunks, well and characteristically branched for species. Obtain approval from consultant of plant material at source prior to digging. All trees and shrubs to be container grown, potted, W/B or B/B, as indicated on Plant List. Bare root plants are only acceptable for certain species and as approved by the Landscape Architect.
- Plant material substitutions are not to be permitted without the written approval from the Consultant, with 48 hours notice, prior to shipping plant material.
- Plant locations are schematic / approximate only. Contractor is to stake out locations on site for approval by the Landscape Architect prior to installation.
- The illustrated number of plants shown in the Planting Plan supersedes the estimated number in the Plant List. Contractor to report any discrepancies to the Landscape Architect prior to installation. Contractor will assume full responsibility if the Landscape Architect is not notified.
- Ensure trees are thoroughly watered following planting. Monitor material and ensure adequate moisture until acceptance.
- In heavy clay or poorly drained soils, set root ball with root collar 75-100mm higher than finished grade.
- Approved topsoil depths are as follows:
 - a. Plant Beds - 450mm continuous depth. Applies to shrubs, perennials, vines, and groundcovers.
 - b. Sod/Seed Areas - 100mm depth.
- Sod to be No. 1 Kentucky Bluegrass Sod grown from minimum mixture of 3 Kentucky Bluegrass cultivars. Quality and source are to comply with Canadian Standards for Nursery Stock, Section 17, (latest edition) published by the Canadian Nursery Landscape Nursery Landscape Association.
- Install a 1.2m sod strip adjacent to all hard surfaces. Note, sod is not typically graphically shown on plans.
- Apply the following mineral fertilizer unless soil tests show other requirements:
 - a. Plant Beds - (8-32-16), i.e. 8% Nitrogen, 32% Phosphorus, 16% Potash per manufacturer specifications.
 - b. Sod Areas - (8-32-16), i.e. 8% Nitrogen, 32% Phosphorus, 16% Potash at a rate of 350kg/ha.
- Where applicable, for any plant areas with a mix of species/cultivars notes, Contractor is to cluster like plants in groups of 3-5 and evenly distribute these in the noted area.

CITY DETAILS

- Related details from City of Ottawa Standard Tender Documents Volume No. 2 Standard Detail Drawings.
- SC4. Typical Concrete Sidewalk in Boulevard
 - SC5. Sidewalk Construction Joints

NOVATECH DETAILS

- Found on Sheet L7.
- D1. Standard Deciduous Tree Planting
 - D2. Standard Coniferous Tree Planting
 - D3. Shrub and Perennial Planting
 - D4. Tree Protection Fence
 - D5. Bike Layout
 - D6. Site furniture installation
 - D7. Reforestation

NOTE:
THE POSITION OF ALL POLE LINES, CONDUITS, WATERMANS, SEWERS AND OTHER UNDERGROUND AND OVERGROUND UTILITIES AND STRUCTURES IS NOT NECESSARILY SHOWN ON THE CONTRACT DRAWINGS, AND WHERE SHOWN, THE ACCURACY OF THE POSITION OF SUCH UTILITIES AND STRUCTURES IS NOT GUARANTEED. BEFORE STARTING WORK, DETERMINE THE EXACT LOCATION OF ALL SUCH UTILITIES AND STRUCTURES AND ASSUME ALL LIABILITY FOR DAMAGE TO THEM.

Owner:
[corporation name]
c/o [contact name]
[address line 1]
Ottawa, ON [postal]
Phone: XXX XXX-XXXX

NOT FOR CONSTRUCTION

No.	REVISION	DATE	BY
1.	ISSUED FOR CITY OF OTTAWA REVIEW	DEC 16/22	RGJ

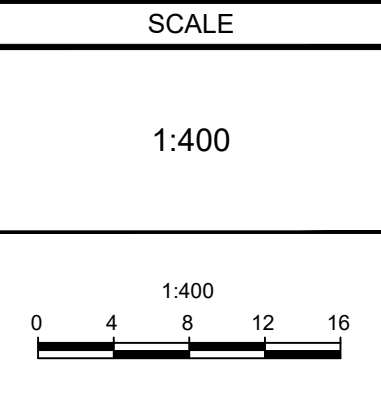

DESIGN	KW
CHECKED	RGJ
DRAWN	KW
CHECKED	KW
APPROVED	RGJ

FOR REVIEW ONLY



NOVATECH
Engineers, Planners & Landscape Architects
Suite 200, 240 Michael Cowpland Drive
Ottawa, Ontario, Canada K2M 1P6
Telephone (613) 254-9643
Facsimile (613) 254-5867
Website www.novatech-eng.com

LOCATION	CITY OF OTTAWA
405 HUNTMAR DRIVE - WAREHOUSE DEVELOPMENT	
DRAWING NAME	LANDSCAPE PLAN
PROJECT No.	122151
REV	REV #1
DRAWING No.	122151-L5

M:\2022\122151\122151-L5.dwg LS Dec 16 2022 2:57pm Wamban

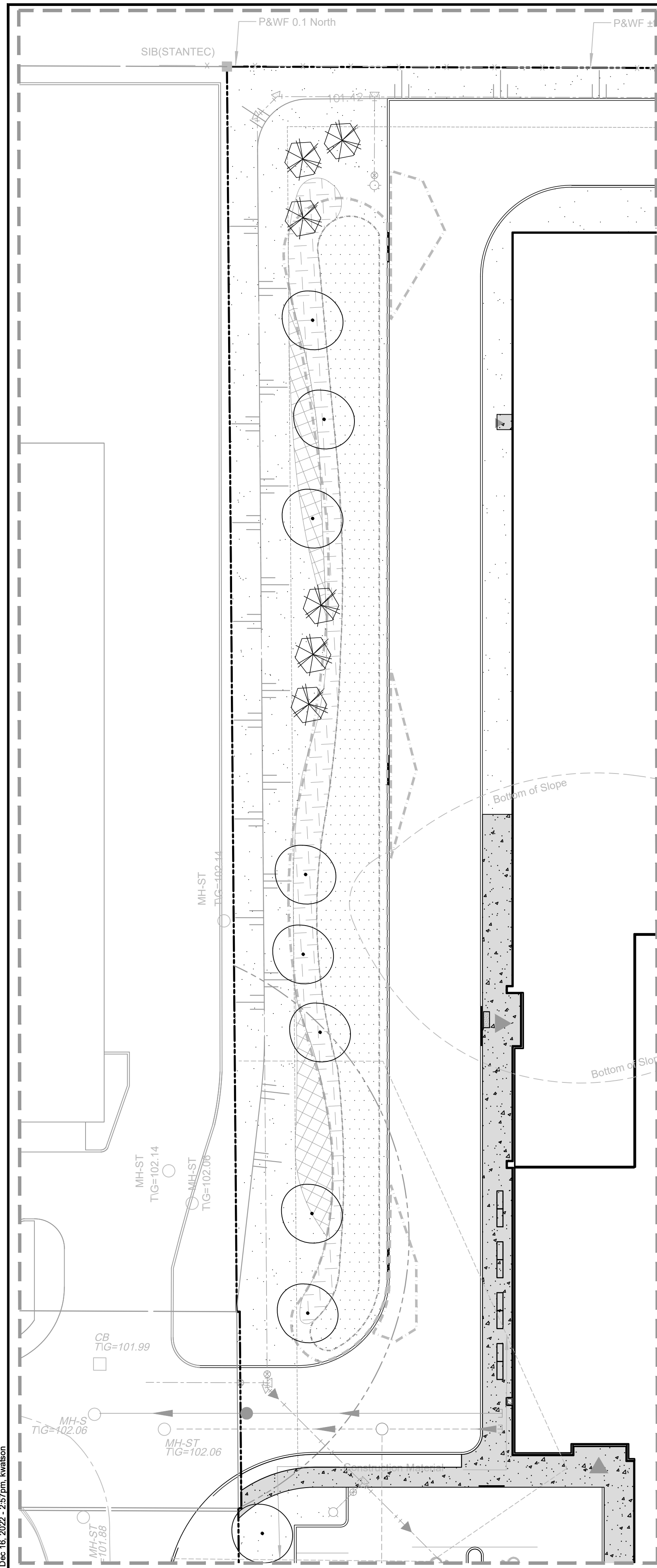

ENLARGEMENT A - RAIN GARDENS

ENLARGEMENT A : PLANT LISTS

KEY	QTY	BOTANICAL NAME	COMMON NAME	SIZE	COND	SPACING
Coniferous Trees						
LL		<i>Larix laricina</i>	Tamarack	200cm Ht	WB	As Shown
TO		<i>Thuja occidentalis</i>	Eastern White Cedar	200cm Ht	WB	As Shown
Deciduous Trees						
AR		<i>Acer rubrum</i>	Red Maple	50mm Cal	WB	As Shown
AI		<i>Alnus incana ssp. rugosa</i>	Speckled Alder	50mm Cal	WB	As Shown
BPM		<i>Betula papyrifera (multistem)</i>	Multistem Paper Birch	50mm Cal	WB	As Shown
UAP		<i>Ulmus americana 'Princeton'</i>	Princeton Elm	50mm Cal	WB	As Shown

Enlargement A
Dry Shrub Mix - Only plant above the 100 YR line

m ²			1500 mm O.C.	0.51 pcs/m ²
25%	0	<i>Ceanothus americanus</i>	New Jersey Tea	0.60m Ht BR 1.5m O.C.
20%	0	<i>Diervilla lonicera</i>	Bush Honeysuckle	0.60m Ht BR 1.5m O.C.
5%	0	<i>Physocarpus opulifolius</i>	Common Ninebark	0.60m Ht BR 1.5m O.C.
5%	0	<i>Rhus aromatica</i>	Fragrant Sumac	0.60m Ht BR 1.5m O.C.
25%	0	<i>Rubus occidentalis</i>	Black Raspberry	0.60m Ht BR 1.5m O.C.
20%	0	<i>Symphoricarpos alba</i>	Snowberry	0.60m Ht BR 1.5m O.C.

Enlargement A
Wet Shrub Mix - Only plant below the 100 YR line

m ²			1500 mm O.C.	0.51 pcs/m ²
25%	0	<i>Aronia melanocarpa</i>	Black Chokeberry	0.60m Ht BR 1.5m O.C.
20%	0	<i>Cornus sericea</i>	Red Osier Dogwood	0.60m Ht BR 1.5m O.C.
5%	0	<i>Myrica gale</i>	Sweet Gale	0.60m Ht BR 1.5m O.C.
5%	0	<i>Salix petiolaris</i>	Slender Willow	0.60m Ht BR 1.5m O.C.
25%	0	<i>Spiraea alba</i>	White Meadowsweet	0.60m Ht BR 1.5m O.C.
20%	0	<i>Viburnum lentago</i>	Nannyberry	0.60m Ht BR 1.5m O.C.

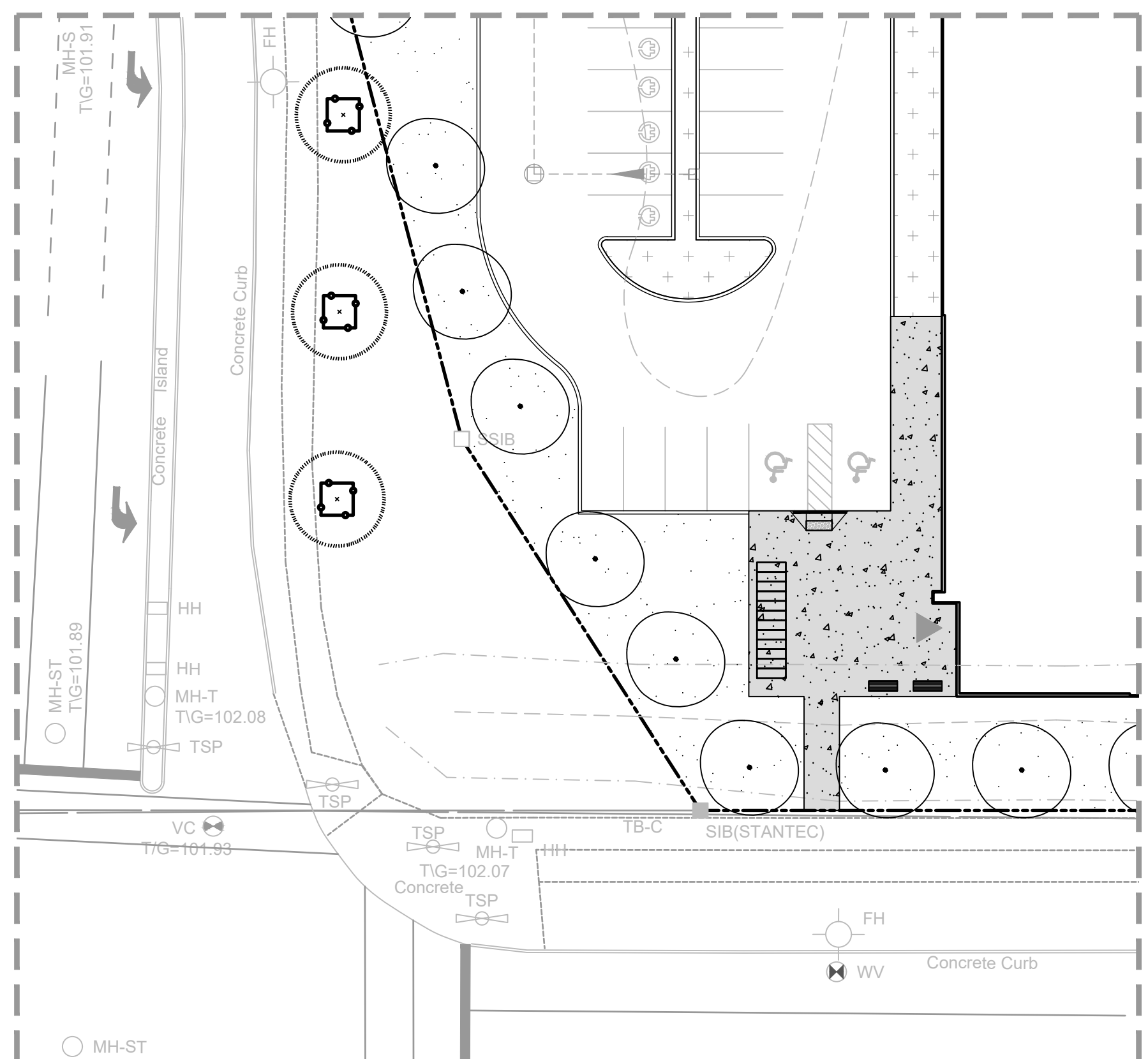

ENLARGEMENT B - BUILDING ENTRANCE - SOUTH

ENLARGEMENT B : PLANT LISTS

KEY	QTY	BOTANICAL NAME	COMMON NAME	SIZE	COND	SPACING
Coniferous Shrubs						
Jco		<i>Juniperus horizontalis 'Plumosa Compacta'</i>	Compact Andorra Juniper	60cm Spr	PT	100cm O.C.
Psm		<i>Pinus mugo 'Stowmound'</i>	Stowmound Mugo Pine	60cm Spr	PT	100cm O.C.
Deciduous Shrubs						
Amm		<i>Amelanchier canadensis (Multi stem)</i>	Canadian Serviceberry	150cm Ht	WB	As Shown
Am		<i>Aronia melanocarpa</i>	Black Chokeberry	60cm Ht	PT	120cm O.C.
Csa		<i>Cornus sericea 'Farrow'</i>	Arctic Fire Dogwood	60cm Ht	PT	120cm O.C.
Csf		<i>Cornus sericea 'Flaviramea'</i>	Yellow Twig Dogwood	60cm Ht	PT	200cm O.C.
Poj		<i>Physocarpus opulifolius 'JEFAM'</i>	Amber Jubilee Ninebark	60cm Ht	PT	120cm O.C.
Rdp		<i>Rosa 'Dwarf Pavement'</i>	Dwarf Pavement Rose	60cm Ht	PT	120cm O.C.
Perennials						
acmf		<i>Achillea millefolium</i>	Common Yarrow	1ltr	PT	45cm O.C.
acmt		<i>Achillea millefolium 'Terra Cotta'</i>	Terra Cotta Yarrow	1ltr	PT	45cm O.C.
epp		<i>Echinacea purpurea</i>	Purple Coneflower	1g	PT	45cm O.C.
gg		<i>Gaillardia x grandiflora</i>	Blanket Flower	1g	PT	30cm O.C.
nwl		<i>Nepeta faassenii 'Walker's Low'</i>	Walker's Low Catmint	1ltr	PT	60cm O.C.
pls		<i>Perovskia atriplicifolia 'Little Spire'</i>	Dwarf Russian Sage	1g	PT	60cm O.C.
son		<i>Solidago nemoralis</i>	Old Field Goldenrod	1ltr	PT	30cm O.C.
al		<i>Symphoricarpos alba</i>	Smooth Aster	1ltr	PT	60cm O.C.
Ornamental Grasses						
ckf		<i>Calamagrostis acutiflora 'Karl Foerster'</i>	Karl Foerster Feather Reed Grass	1g	PT	60cm O.C.
dcg		<i>Deschampsia cespitosa 'Goldau'</i>	Gold Dew Tufted Hair Grass	1g	PT	30cm O.C.
scb		<i>Schizachyrium scoparium 'The Blues'</i>	The Blues Little Bluestem	1g	PT	60cm O.C.
sh		<i>Sporobolus heterolepis</i>	Prarie Dropseed	1g	PT	60cm O.C.

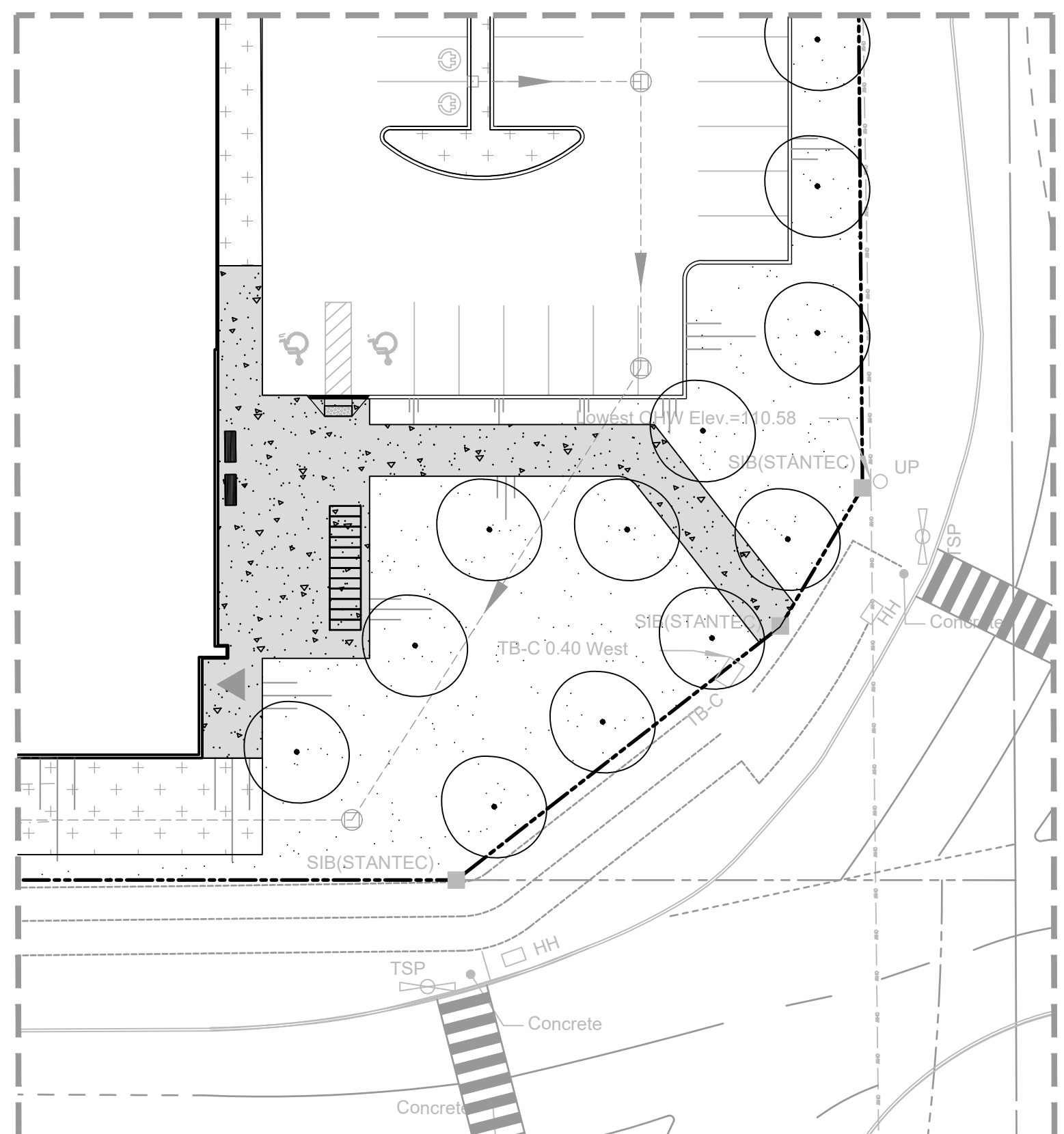

ENLARGEMENT C - BUILDING ENTRANCE - EAST

ENLARGEMENT C : PLANT LISTS

KEY	QTY	BOTANICAL NAME	COMMON NAME	SIZE	COND	SPACING
Coniferous Shrubs						
Jco		<i>Juniperus horizontalis 'Plumosa Compacta'</i>	Compact Andorra Juniper	60cm Spr	PT	100cm O.C.
Psm		<i>Pinus mugo 'Stowmound'</i>	Stowmound Mugo Pine	60cm Spr	PT	100cm O.C.
Pnh		<i>Pinus nigra 'Heiga'</i>	Heiga Austrian Pine	60cm Spr	PT	240cm O.C.
Deciduous Shrubs						
Am		<i>Aronia melanocarpa</i>	Black Chokeberry	60cm Ht	PT	120cm O.C.
Csa		<i>Cornus sericea 'Farrow'</i>	Arctic Fire Dogwood	60cm Ht	PT	120cm O.C.
Csf		<i>Cornus sericea 'Flaviramea'</i>	Yellow Twig Dogwood	60cm Ht	PT	200cm O.C.
Poj		<i>Physocarpus opulifolius 'JEFAM'</i>	Amber Jubilee Ninebark	60cm Ht	PT	120cm O.C.
Pfs		<i>Potentilla fruticosa 'Bella Sol'</i>	Bella Sol Potentilla	40cm Ht	PT	60cm O.C.
Rt		<i>Rhus typhina</i>	Staghorn Sumac	60cm Ht	PT	100cm O.C.
Sac		<i>Spiraea x arguta 'Compacta'</i>	Dwarf Garland Spirea	60cm Ht	PT	90cm O.C.
Perennials						
acmf		<i>Achillea millefolium</i>	Common Yarrow	1ltr	PT	45cm O.C.
acmt		<i>Achillea millefolium 'Terra Cotta'</i>	Terra Cotta Yarrow	1ltr	PT	45cm O.C.
epp		<i>Echinacea purpurea</i>	Purple Coneflower	1g	PT	45cm O.C.
gg		<i>Gaillardia x grandiflora</i>	Blanket Flower	1g	PT	30cm O.C.
nwl		<i>Nepeta faassenii 'Walker's Low'</i>	Walker's Low Catmint	1ltr	PT	60cm O.C.
pls		<i>Perovskia atriplicifolia 'Little Spire'</i>	Dwarf Russian Sage	1g	PT	60cm O.C.
son		<i>Solidago nemoralis</i>	Old Field Goldenrod	1ltr	PT	30cm O.C.
al		<i>Symphoricarpos alba</i>	Smooth Aster	1ltr	PT	60cm O.C.
Ornamental Grasses						
ckf		<i>Calamagrostis acutiflora 'Karl Foerster'</i>	Karl Foerster Feather Reed Grass	1g	PT	60cm O.C.
dcg		<i>Deschampsia cespitosa 'Goldau'</i>	Gold Dew Tufted Hair Grass	1g	PT	30cm O.C.
scb		<i>Schizachyrium scoparium 'The Blues'</i>	The Blues Little Bluestem	1g	PT	60cm O.C.
sh		<i>Sporobolus heterolepis</i>	Prarie Dropseed	1g	PT	60cm O.C.

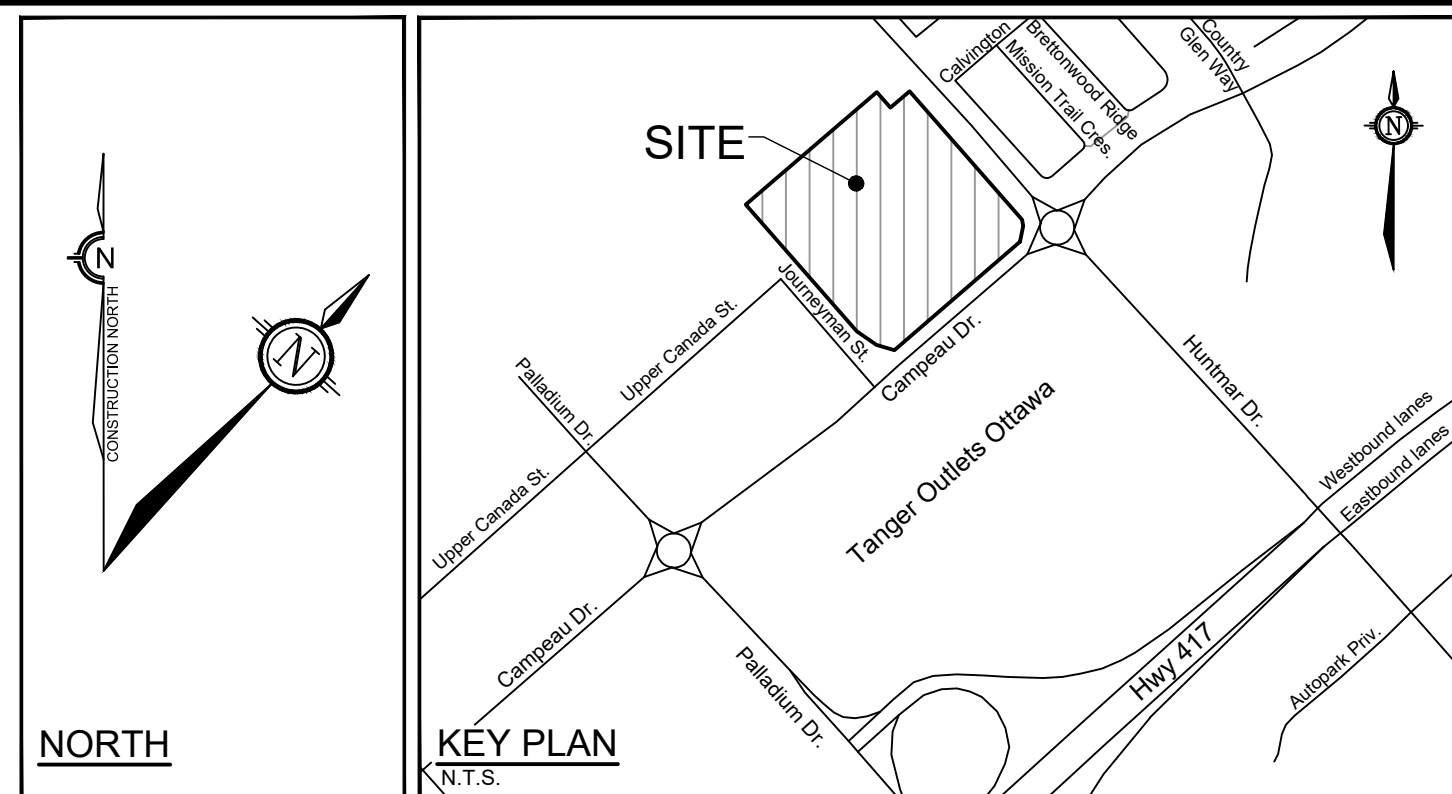

LEGEND

- 3-D1 DETAIL SHEET # NOVATECH OR CITY
- EG. L1, L2, ETC. DETAIL NUMBER SEE LIST FOR CODE
- PROPERTY LIMIT
- TREE PROTECTION FENCE
- PROPOSED CONCRETE
- SOD
- PROPOSED PLANTING BED
- SEED MIX A
- PROPOSED DRY SHRUB MIX.
- PROPOSED WET SHRUB MIX.
- PROPOSED DECIDUOUS TREE
- PROPOSED CONIFEROUS TREE
- EXISTING TREE TO REMAIN
- BENCH
- SPECIES (SEE PLANT LIST)
- QUANTITY
- NATURALIZATION MIX
- AREA

PLANTING

1. Plant material to be No. 1 Grade and is to comply with Canadian Standards for Nursery Stock (latest edition) published by the Canadian Nursery Landscape Association.
2. Use structurally sound plant material with strong fibrous root system free of disease, defects, and injuries. Use trees with straight trunks, well and characteristically branched for species. Obtain approval from consultant of plant material at source prior to digging. All trees and shrubs to be container grown, potted, WB or BB, as indicated on Plant List. Bare root plants are only acceptable for certain species and as approved by the Landscape Architect.
3. Plant material substitutions are not permitted without the written approval from the Consultant, with 48 hours notice, prior to shipping plant material.
4. Plant locations are schematic / approximate only. Contractor is to stake out locations on site for approval by the Landscape Architect prior to installation.
5. The illustrated number of plants shown in the Planting Plan supersedes the estimated number in the Plant List. Contractor to report any discrepancies to the Landscape Architect prior to installation. Contractor will assume full responsibility if the Landscape Architect is not notified.
6. Ensure trees are thoroughly watered following planting. Monitor material and ensure adequate moisture until acceptance.
7. In heavy clay or poorly drained soils, set root ball with root collar 75-100mm higher than finished grade.
8. Approved topsoil depths are as follows:
 - a. Plant Beds - 450mm continuous depth. Applies to shrubs, perennials, vines, and groundcovers.
 - b. Sod/ Seed Areas - 100mm depth.
 - c. Reforestation - 300mm depth.
9. Sod to be No. 1 Kentucky Bluegrass Sod grown from minimum mixture of 3 Kentucky Bluegrass cultivars. Quality and source are to comply with Canadian Standards for Nursery Stock, Section 17, (latest edition) published by the Canadian Nursery Landscape Nursery Landscape Association.
10. Install a 1.2m sod strip adjacent to all hard surfaces. Note, sod is not typically graphically shown on plans.
11. Apply the following mineral fertilizer unless soil tests show other requirements:
 - a. Plant Beds - (8-32-16), i.e. 8% Nitrogen, 32% Phosphorus, 16% Potash per manufacturer specifications.
 - b. Sod Areas - (8-32-16), i.e. 8% Nitrogen, 32% Phosphorus, 16% Potash at a rate of 350g/ha.
12. Where applicable, for any plant areas with a mix of species/ cultivars notes, Contractor is to cluster like plants in groups of 3-5 and evenly distribute these in the noted area.

TREE PROTECTION

- Implement the following protection measures for retained trees, both on site and on adjacent sites, prior to any work activity, including tree removal. Maintain tree protection fence in place and in good condition for the duration of site works:
1. The Landscape Architect or Certified Arborist is to determine the location of the tree protection fencing and detail it on any associated plans for the site (e.g. tree conservation report, tree disclosure report, etc.).
 2. Under the guidance of a Landscape Architect or Certified Arborist, erect a fence at the critical root zone (CRZ) of trees. Diameter at breast height (DBH) is the trunk diameter measured at 1.3m height on the tree trunk. The CRZ is calculated as DBH x 10. Refer to the Tree Protection Fence detail.
 3. Refer to the Tree Protection Plan for fence location. City Forestry Staff are to approve both the plan and the installed fence prior to work commencement.
 4. Do not place any material or equipment within 2m of the CRZ of any tree, including outhouses.
 5. Do not attach any signs, notices, or posters to any tree.
 6. Do not disturb, raise, or lower the existing grade within the CRZ without approval.
 7. Only tunnel or bore when digging within the CRZ of a tree. Hand work only where required within the CRZ, absolutely no machinery permitted.
 8. Do not damage the root system, trunk, or branches, or any tree.
 9. Do not extend hard surface or significantly change landscaping.
 10. Ensure that exhaust fumes from all equipment are directed away from any tree canopy.
 11. When trees marked for removal overlap with the CRZ of trees marked for preservation: cut roots at the edge of the CRZ and grind down stumps after tree removals, do not pull out stumps. Ensure there is not root pulling or disturbance of the ground within the CRZ.
 12. Prior to work taking place, notify and consult the Landscape Architect and City Forestry Staff if roots must be cut. Roots 20mm or larger should be cut at right angles with clean, sharp horticultural tools without tearing, crushing, or pulling. Refer to City of Ottawa Specification S.P. F-8011 Tree Protection, Excavation of Root Zone.
 13. If damaged or objectionable branches are observed, consult the Landscape Architect, before any work is conducted. Do not prune leaders. Do not prune more than 1/4 of crown.
 14. Set up a water and fertilizing program, if trees are being affected by site works, to the satisfaction of the Landscape Architect.
 15. The Landscape Architect is to prescribe mitigation measures if the protected fenced area must be reduced to facilitate construction. Measures may include the placement of plywood, wood chips, or steel plating over the roots for protection. City Forestry Staff are to approve said measures prior to fence movement.
 16. City of Ottawa By-law: Protects municipal trees and municipal natural areas in the City of Ottawa and trees on private property in the urban area of the City of Ottawa (2020-340).

CITY DETAILS

- Related details from City of Ottawa Standard Tender Documents Volume No. 2 Standard Detail Drawings.
- SC4. Typical Concrete Sidewalk in Boulevard
 - SC5. Sidewalk Construction Joints

NOVATECH DETAILS

- Found on Sheet L7.
- D1. Standard Deciduous Tree Planting
 - D2. Standard Coniferous Tree Planting
 - D3. Shrub and Perennial Planting
 - D4. Tree Protection Fence
 - D5. Bike Layout
 - D6. Site furniture installation
 - D7. Reforestation

SEED MIX AND APPLICATION

- For areas steeper than 3:1, Contractor to apply erosion control blanket. Erosion control blanket to be machine woven mats made from natural wood, coco or cotton fiber, or combination depending on manufacturer, with stitching between two photo-degradable natural organic fiber nettings. Submit products for approval by Consultant. OPSS 804 applies except as may be amended and extended herein.
- In addition to the specified seed mixes, all applications are to include a nurse crop as noted.
- NURSE CROP
 - Annual Ryegrass
 - Seeding Rate: 25kg/ha
 - SEED MIX A
 - RETENTION BASIN WILDLIFE BY DLF
 - Seeding Rate: 25kg/ha

NOTE:
THE POSITION OF ALL POLE LINES, CONDUITS, WATERMANS, SEWERS AND OTHER UNDERGROUND AND OVERGROUND UTILITIES AND STRUCTURES IS NOT NECESSARILY SHOWN ON THE CONTRACT DRAWINGS, AND WHERE SHOWN, THE ACCURACY OF THE POSITION OF SUCH UTILITIES AND STRUCTURES IS NOT GUARANTEED. BEFORE STARTING WORK, DETERMINE THE EXACT LOCATION OF ALL SUCH UTILITIES AND STRUCTURES AND ASSUME ALL LIABILITY FOR DAMAGE TO THEM.

Owner:
[corporation name]
c/o [contact name]
(address line 1)
Ottawa, ON [postal]
Phone: (XXX) XXX-XXXX

NOT FOR CONSTRUCTION

No.	REVISION	DATE	BY
1.	ISSUED FOR CITY OF OTTAWA REVIEW	DEC 16/22	RGJ

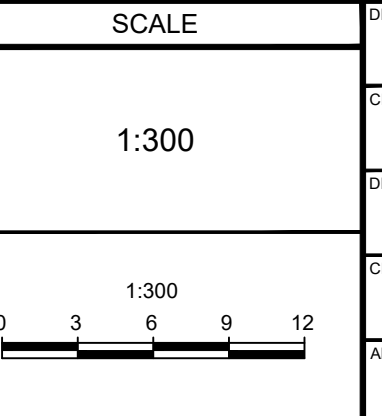

DESIGN	KW	FOR REVIEW ONLY
CHECKED	RGJ	
DRAWN	KW	
CHECKED	KW	
APPROVED	RGJ	



LOCATION	CITY OF OTTAWA	405 HUNTMAR DRIVE - WAREHOUSE DEVELOPMENT
DRAWING NAME	LANDSCAPE ENLARGEMENTS	
PROJECT No.	122151	
REV		REV #1
DRAWING No.	122151-L6	

M:\2022\122151\CD\122151-L6.dwg 16-Dec-16 2:25:27pm Wamban

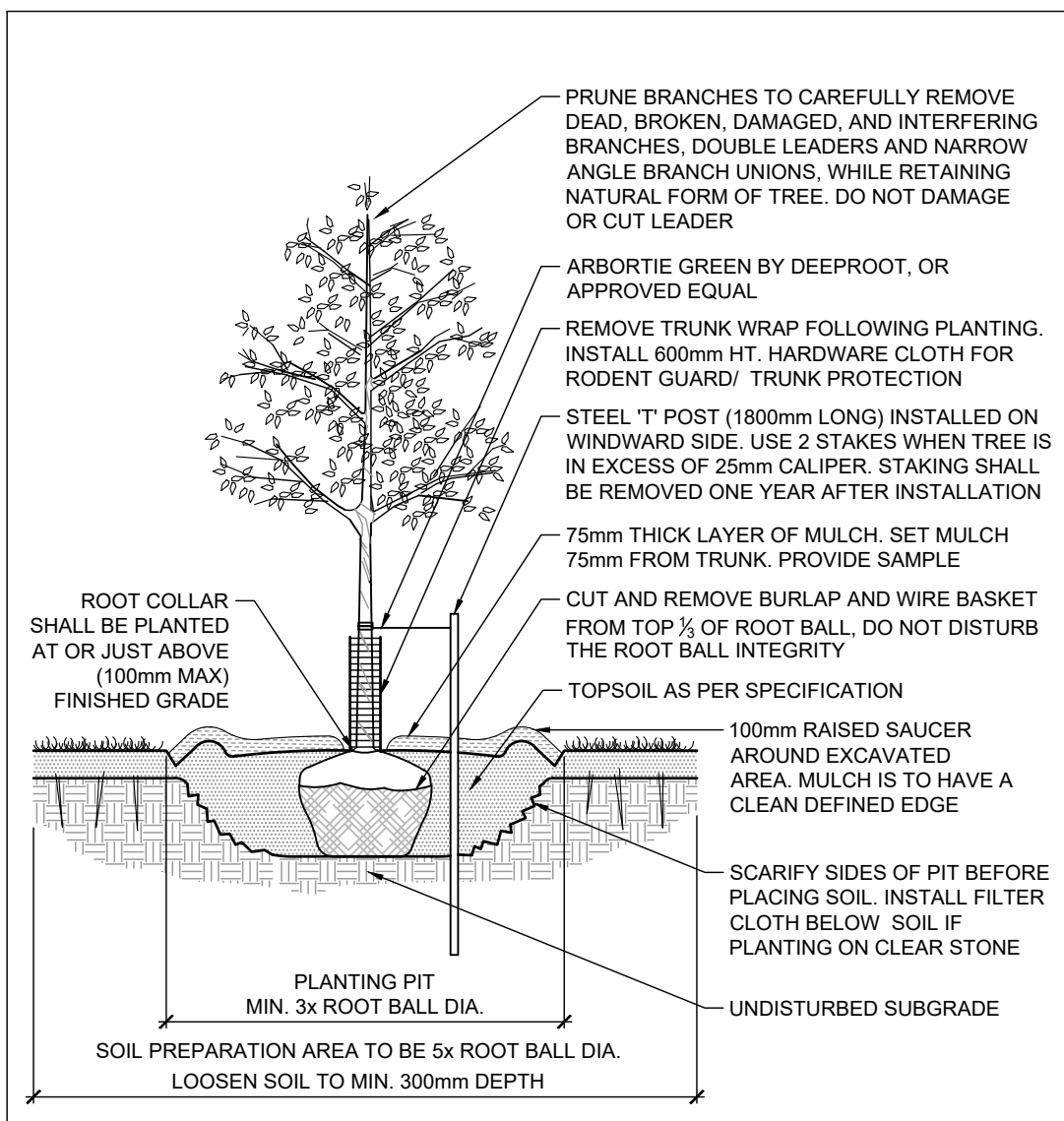

STANDARD DECIDUOUS TREE PLANTING **D1**

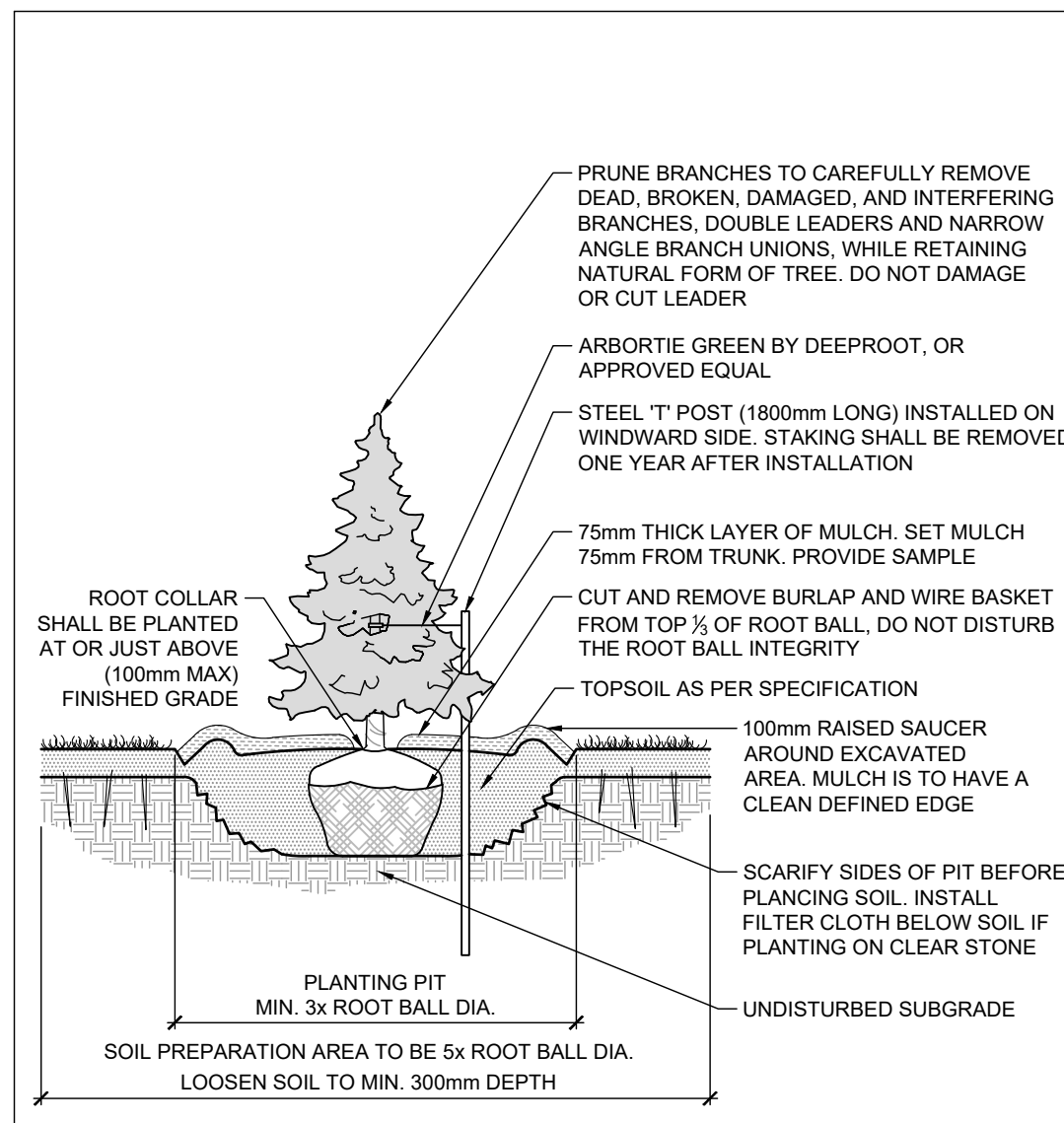

STANDARD CONIFEROUS TREE PLANTING **D2**

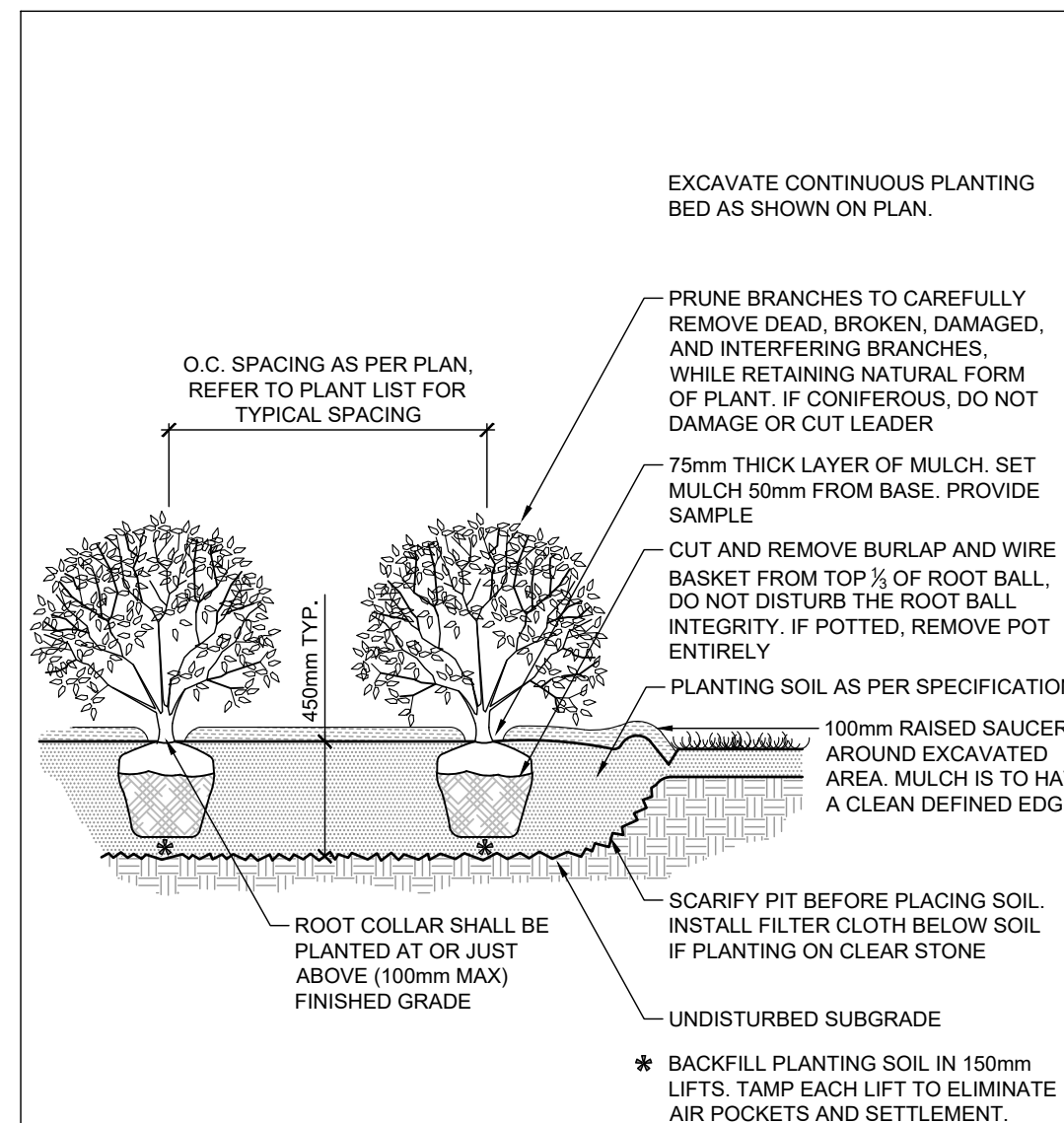

SHRUB AND PERENNIAL PLANTING **D3**

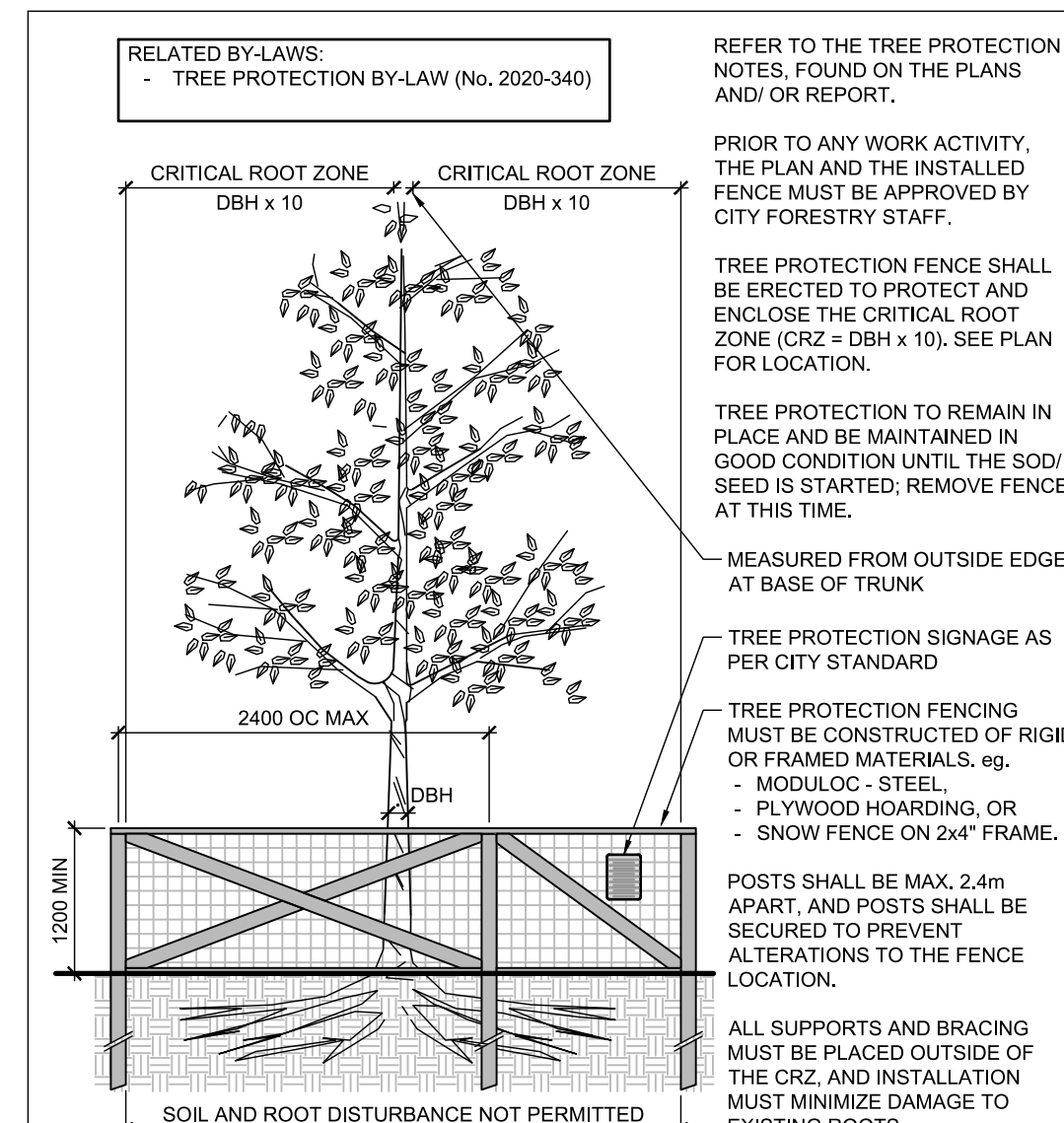

TREE PROTECTION FENCE **D4**

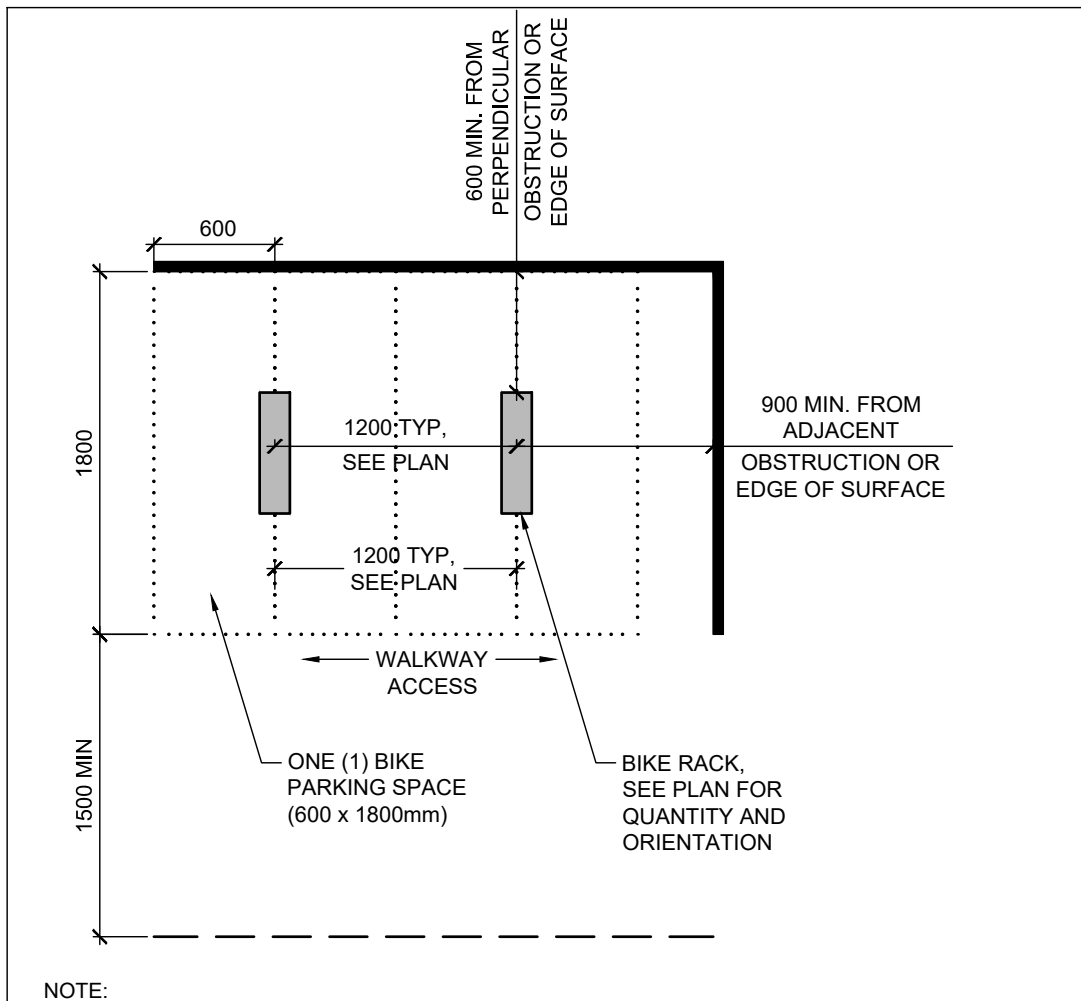

BIKE LAYOUT **D5**

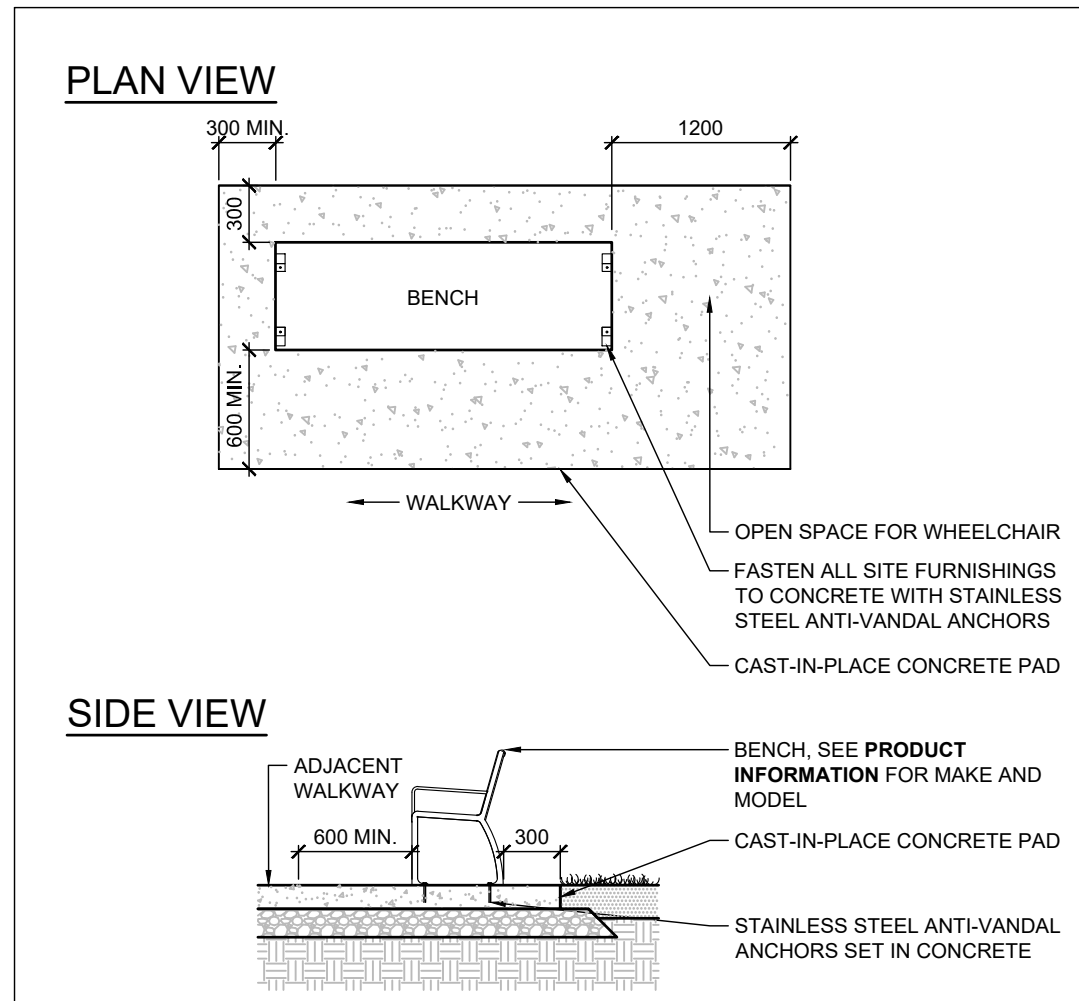

SITE FURNITURE INSTALLATION **D6**

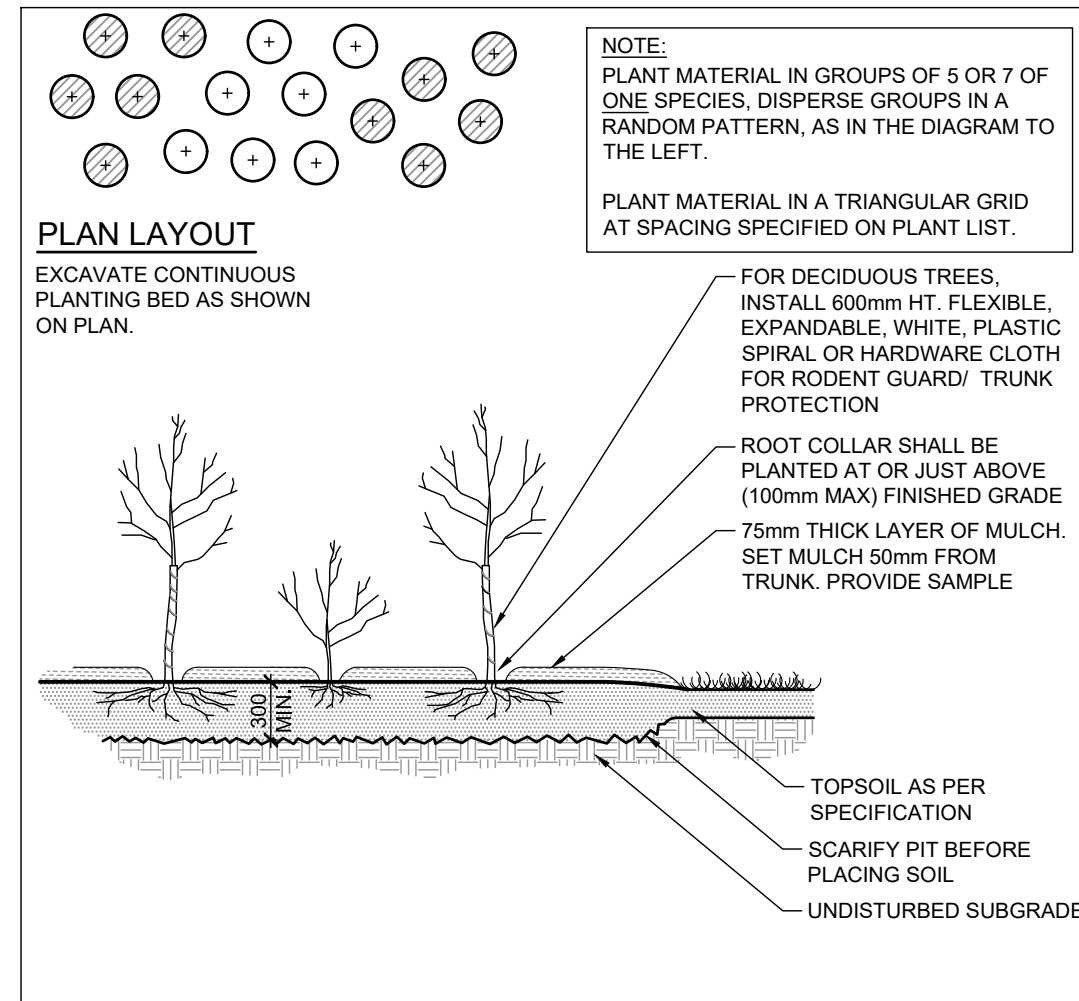

SHRUB NATURALIZATION **D7**

M:\2022\12151-L\CAD\landscape\12151-L.dwg L7 Dec 16 2022 2:57pm wamban

NOTE:
THE POSITION OF ALL POLE LINES, CONDUITS, WATERMANS, SEWERS AND OTHER UNDERGROUND AND OVERGROUND UTILITIES AND STRUCTURES IS NOT NECESSARILY SHOWN ON THE CONTRACT DRAWINGS, AND WHERE SHOWN, THE ACCURACY OF THE POSITION OF SUCH UTILITIES AND STRUCTURES IS NOT GUARANTEED. BEFORE STARTING WORK, DETERMINE THE EXACT LOCATION OF ALL SUCH UTILITIES AND STRUCTURES AND ASSUME ALL LIABILITY FOR DAMAGE TO THEM.

Owner:
[corporation name]
c/o [contact name]
[address line 1]
Ottawa, ON [postal]
Phone: (XXX) XXX-XXXX

NOT FOR CONSTRUCTION

No.	REVISION	DATE	BY
1.	ISSUED FOR CITY OF OTTAWA REVIEW	DEC 16/22	RGJ

SCALE	DESIGN
	KW
	CHECKED RGJ
	DRAWN KW
	CHECKED KW
	APPROVED RGJ

FOR REVIEW ONLY



NOVATECH
Engineers, Planners & Landscape Architects
Suite 200, 240 Michael Cowpland Drive
Ottawa, Ontario, Canada K2M 1P6
Telephone (613) 254-9643
Facsimile (613) 254-5867
Website www.novatech-eng.com

LOCATION CITY of OTTAWA 405 HUNTMAR DRIVE - WAREHOUSE DEVELOPMENT	PROJECT No. 122151
DRAWING NAME LANDSCAPE DETAILS	REV # 1
	DRAWING No. 122151-L7