

## Site Plan Control Application Summary Revision - Standard - Non-Rural

---

**File Number:** D07-12-22-0167  
**Applicant:** Xu Feng  
**Email:** xuf@cuhaci.com  
**Phone:** 613-236-7135  
**Owner:** Ottawa-Carleton District School Board

**Date:** December 19, 2022  
**Comments due date:** January 6, 2023  
**Planner:** Alex Gatien  
**Ward:** 6 - Stittsville  
**Councillor:** Glen Gower

---

### Site Location

40 Granite Ridge Dr.

### Applicant's Proposal

A Site Plan Control Revision application to construct a pick-up and drop-off lane in the boulevard next to the existing sidewalk in front of the school along Granite Ridge Drive. No changes are proposed to the school site.

### Proposal Details

The site is located along Granite Ridge Drive to the south of Amethyst Crescent and north of Feldspar Crescent.

There is an existing school building on the site and the surrounding environment is residential. No changes are proposed on the school site itself. The existing trees on the boulevard will be preserved.

The new pick-up and drop-off lane will be located in the boulevard between the existing sidewalk and the street. The lane will be approximately 60 metres in length. The lane is intended to improve traffic flow in the area for student pick-up and drop-off.

### Related Planning Applications

N/A

### Roadway Modifications



See proposal details.

### How to Provide Comments

For additional information, please contact:

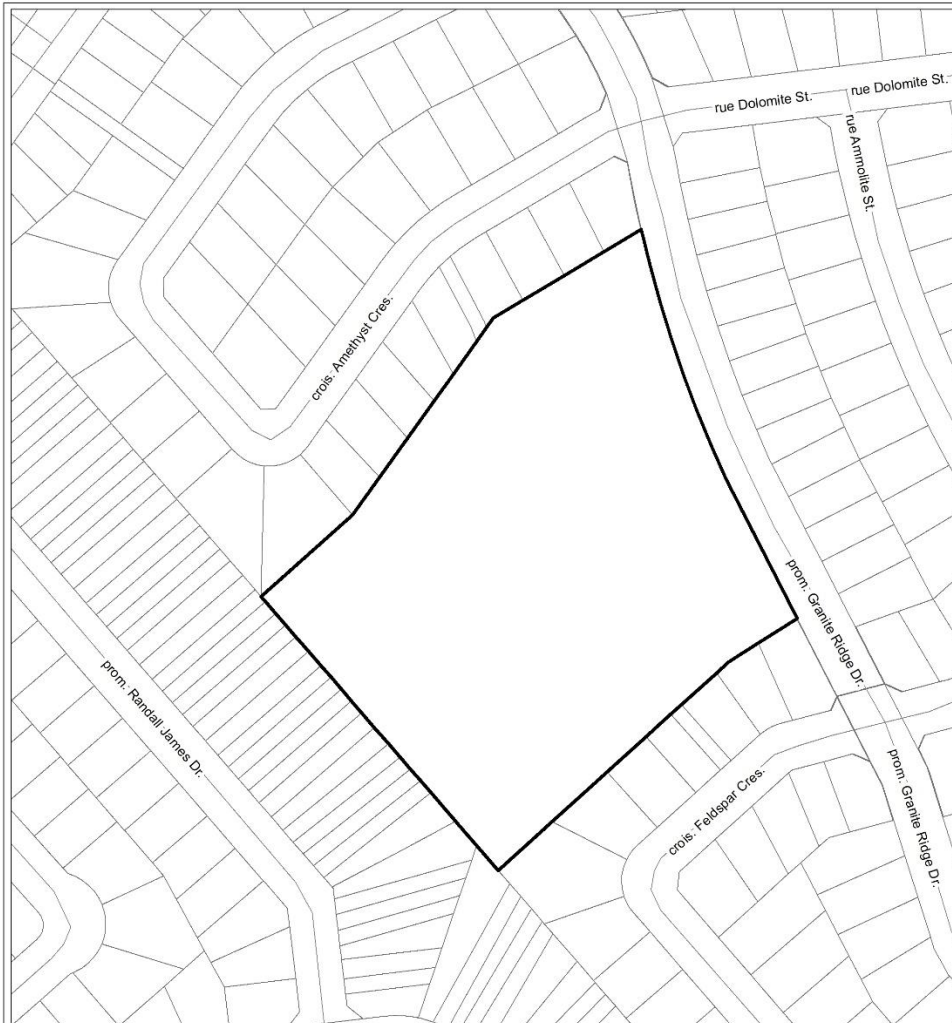
Alex Gatien  
Planner I  
Development Review, West  
110 Laurier Avenue West, 4<sup>th</sup> floor  
Ottawa, ON K1P 1J1



		LOCATION MAP / PLAN DE LOCALISATION SITE PLAN / PLAN D'EMPLACEMENT	
D07-12-22-0167	22-1237-K		
I:\CO\2022\Site\GraniteRidge_40			
<small>©Parcel data is owned by Teranet Enterprises Inc. and its suppliers                  All rights reserved. May not be produced without permission.                  THIS IS NOT A PLAN OF SURVEY</small>		 40 prom. Granite Ridge Dr.	
<small>©Les données de parcelles appartiennent à Teranet Enterprises Inc. et à ses fournisseurs. Tous droits réservés. Ne peut être reproduit sans autorisation. CE CI N'EST PAS UN PLAN D'ARPENTAGE</small>		 <small>USE TO SCALE</small>	
REVISION / RÉVISION - 2022 / 12 / 19			