

TOPOGRAPHICAL PLAN OF SURVEY
 PART OF LOT 1
 CONCESSION 5 (RIDEAU FRONT)
 Geographic Township of Nepean
 CITY OF OTTAWA
 Surveyed by Annis, O'Sullivan, Volebekk Ltd.
 Plan Amended September 7, 2017 to illustrate additional services.

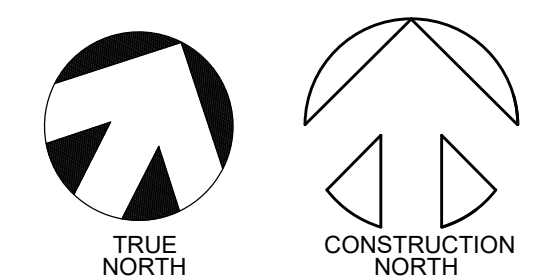

OWNERS
 CHORAC
 1196 Wellington St. West,
 Ottawa, ON, K1Y 2Z5
 (613) PHONE #: 725-1432

APPLICANT
 REINDERS + LAW LTD.
 64 ONTARIO STREET NORTH,
 MILTON ON L9T 2T1
 P (905)457-1618
 F (905)457-8852

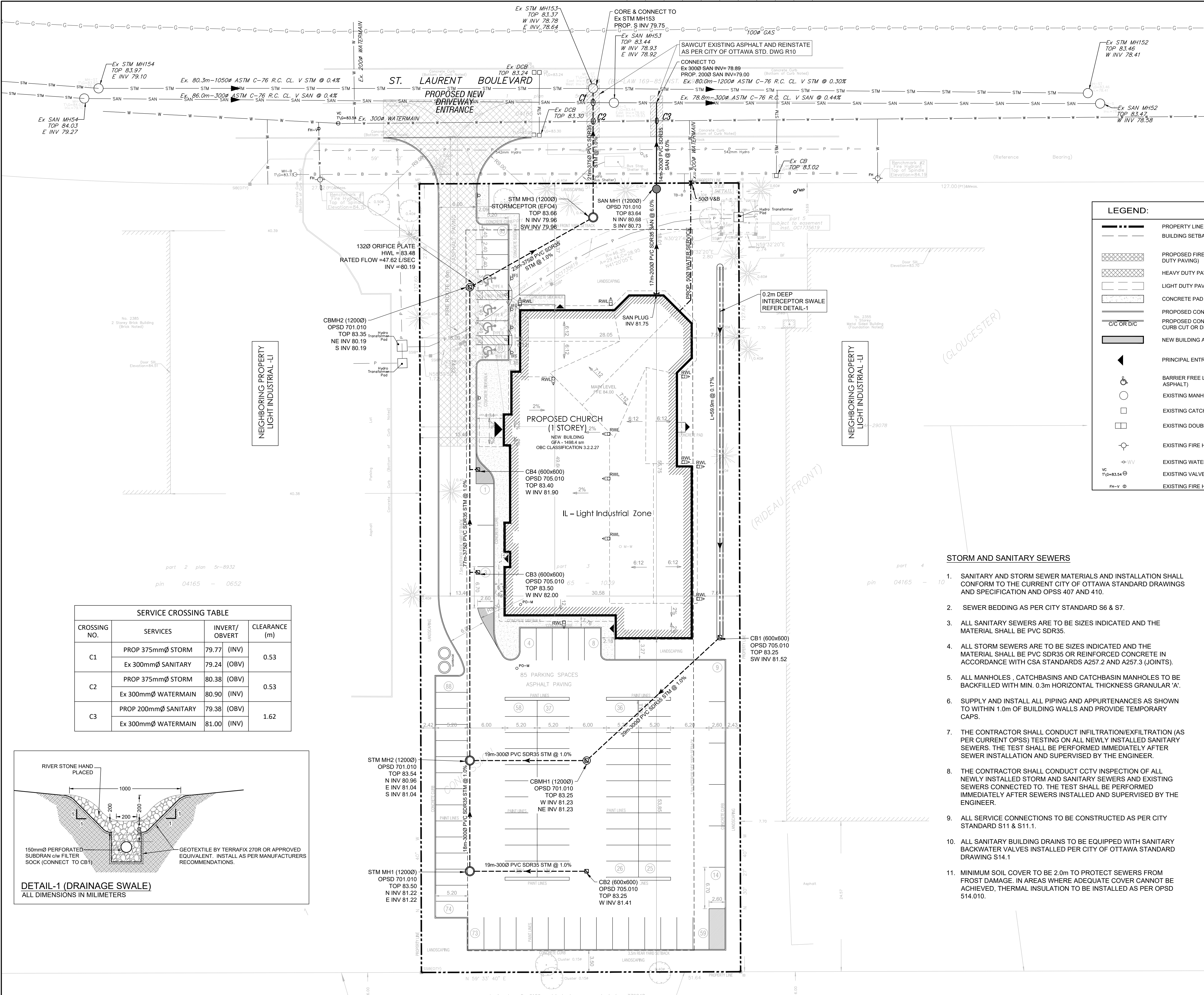
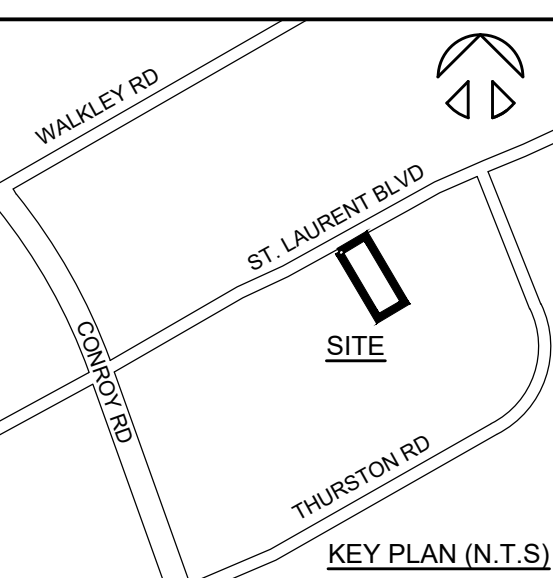

LEGEND:

---	PROPERTY LINE	○	PROPOSED SANITARY MANHOLE
- - -	BUILDING SETBACK LINE	○	PROPOSED STORM MANHOLE
▨	PROPOSED FIRE ROUTE (USING HEAVY DUTY PAVING)	○	PROPOSED CATCH BASIN MANHOLE
▩	HEAVY DUTY PAVING	□	PROPOSED CATCH BASIN
▧	LIGHT DUTY PAVING	◀▶	PROPOSED VALVE & BOX
▤	CONCRETE PAD OR SIDEWALK	—G—G—	EXISTING GAS
▥	PROPOSED CONCRETE CURB	—P—	EXISTING UNDERGROUND POWER
▦	PROPOSED CONCRETE CURB WITH CURB CUT OR DEPRESSED CURB	—B—	EXISTING UNDERGROUND BELL
▧	NEW BUILDING AREA (FOOTPRINT)	—W—	EXISTING WATER PIPE
◀	PRINCIPAL ENTRANCE TO THE BUILDING	—SAN—	EXISTING SANITARY PIPE
♿	BARRIER FREE LOGO (PAVED ON ASPHALT)	—STM—	EXISTING STORM PIPE
○	EXISTING MANHOLE	—	PROPOSED WATER PIPE
□	EXISTING CATCH BASIN	—	PROPOSED SANITARY PIPE
▭	EXISTING DOUBLE CATCH BASIN	—	PROPOSED STORM PIPE
⊙	EXISTING FIRE HYDRANT	○	PIPE CROSSING
⊕	EXISTING WATER VALVE	○	RAIN WATER LEADER
⊖	EXISTING VALVE CHAMBER FOR WATERMAIN	—	SLOPE ROOF DOWN IN DIRECTION INDICATED
⊗	EXISTING FIRE HYDRANT VALVE	—	

1	ISSUED FOR APPROVAL	12/13/2022	YA
0	ISSUED FOR APPROVAL	02/14/2022	YA

no. revisions date init.

GENERAL NOTE:
 THESE DRAWINGS ARE COPYRIGHT AND THE PROPERTY OF REINDERS + LAW LTD. THE DRAWINGS MAY NOT BE USED FOR CONSTRUCTION WITHOUT THE PERMISSION OF REINDERS + LAW LTD. AND UNLESS SEALED AND SIGNED BY THE ARCHITECT/ENGINEER REPRODUCTION OF THESE DRAWINGS WITHOUT THE CONSENT OF REINDERS + LAW LTD. IS STRICTLY PROHIBITED.
 DO NOT SCALE THESE DRAWINGS. ANY ERROR OR DISCREPANCY IS TO BE REPORTED IMMEDIATELY TO: REINDERS + LAW LTD.

cad file 20037_SP3
 date plotted 12/13/2022 plot scale 1:1

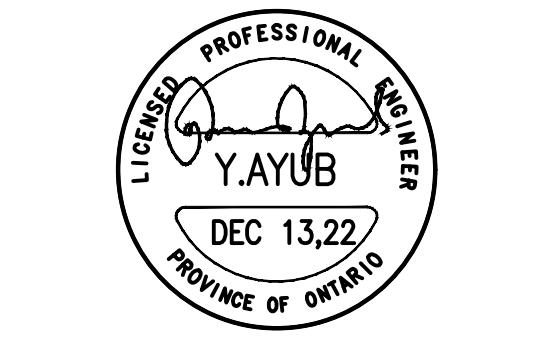

drawn CC
 designed YA
 reviewed YA
 date 12/13/2022
 scale 1:300
 project CHORAC OTTAWA 2375 ST. LAURENT BLVD OTTAWA, ON

drawing SITE SERVICING PLAN

PLAN#18738
 007-12-22-0061

REINDERS + LAW
 ARCHITECTURE, ENGINEERING
 REINDERS + LAW LTD.
 ARCHITECTURE, ENGINEERING
 64 ONTARIO STREET NORTH
 MILTON ON L9T 2T1
 T. 905.457.1618 F. 905.457.8852
 EMAIL@REINDERS.CA WWW.REINDERS.CA

drawing no. 20037_SP3 rev. no. 1

SERVICE CROSSING TABLE

CROSSING NO.	SERVICES	INVERT/OBVERT	CLEARANCE (m)
C1	PROP 375mmØ STORM	79.77 (INV)	0.53
	Ex 300mmØ SANITARY	79.24 (OBV)	
C2	PROP 375mmØ STORM	80.38 (OBV)	0.53
	Ex 300mmØ WATERMAIN	80.90 (INV)	
C3	PROP 200mmØ SANITARY	79.38 (OBV)	1.62
	Ex 300mmØ WATERMAIN	81.00 (INV)	

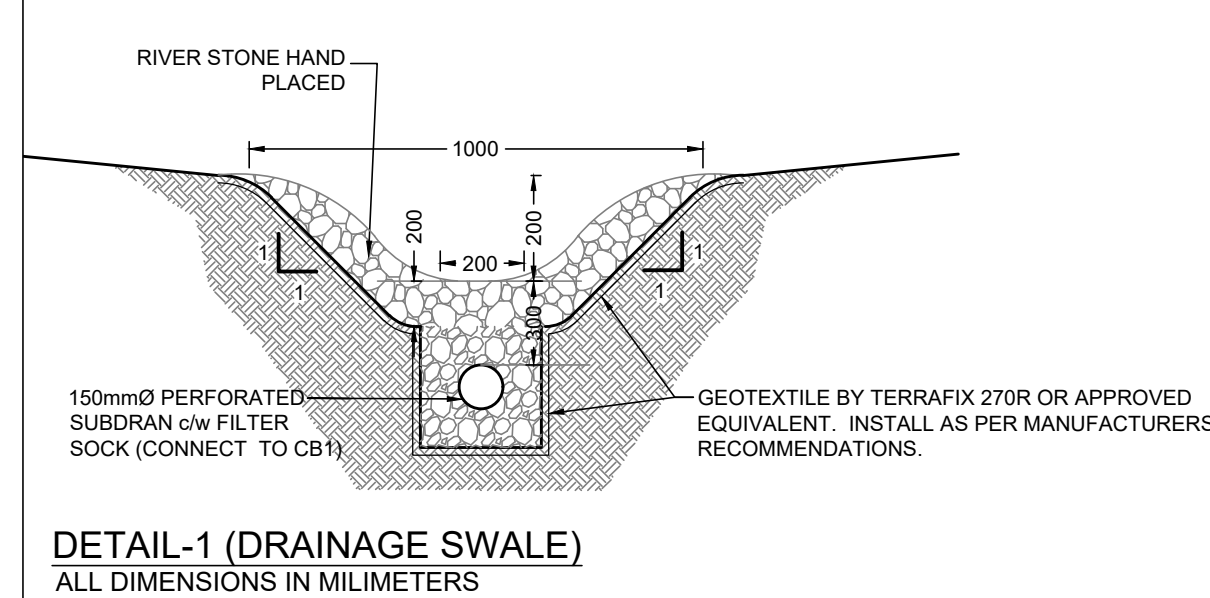

STORM AND SANITARY SEWERS

- SANITARY AND STORM SEWER MATERIALS AND INSTALLATION SHALL CONFORM TO THE CURRENT CITY OF OTTAWA STANDARD DRAWINGS AND SPECIFICATION AND OPSS 407 AND 410.
- SEWER BEDDING AS PER CITY STANDARD S6 & S7.
- ALL SANITARY SEWERS ARE TO BE SIZES INDICATED AND THE MATERIAL SHALL BE PVC SDR35.
- ALL STORM SEWERS ARE TO BE SIZES INDICATED AND THE MATERIAL SHALL BE PVC SDR35 OR REINFORCED CONCRETE IN ACCORDANCE WITH CSA STANDARDS A257.2 AND A257.3 (JOINTS).
- ALL MANHOLES, CATCHBASINS AND CATCHBASIN MANHOLES TO BE BACKFILLED WITH MIN. 0.3m HORIZONTAL THICKNESS GRANULAR 'A'.
- SUPPLY AND INSTALL ALL PIPING AND APPURTENANCES AS SHOWN TO WITHIN 1.0m OF BUILDING WALLS AND PROVIDE TEMPORARY CAPS.
- THE CONTRACTOR SHALL CONDUCT INFILTRATION/EXFILTRATION (AS PER CURRENT OPSS) TESTING ON ALL NEWLY INSTALLED SANITARY SEWERS. THE TEST SHALL BE PERFORMED IMMEDIATELY AFTER SEWER INSTALLATION AND SUPERVISED BY THE ENGINEER.
- THE CONTRACTOR SHALL CONDUCT CCTV INSPECTION OF ALL NEWLY INSTALLED STORM AND SANITARY SEWERS AND EXISTING SEWERS CONNECTED TO. THE TEST SHALL BE PERFORMED IMMEDIATELY AFTER SEWERS INSTALLED AND SUPERVISED BY THE ENGINEER.
- ALL SERVICE CONNECTIONS TO BE CONSTRUCTED AS PER CITY STANDARD S11 & S11.1.
- ALL SANITARY BUILDING DRAINS TO BE EQUIPPED WITH SANITARY BACKWATER VALVES INSTALLED PER CITY OF OTTAWA STANDARD DRAWING S14.1.
- MINIMUM SOIL COVER TO BE 2.0m TO PROTECT SEWERS FROM FROST DAMAGE. IN AREAS WHERE ADEQUATE COVER CANNOT BE ACHIEVED, THERMAL INSULATION TO BE INSTALLED AS PER OPSS 514.010.

WATERMAIN

- ALL WATERMAIN AND WATER SERVICE MATERIALS AND INSTALLATION SHALL CONFORM TO THE CURRENT CITY OF OTTAWA STANDARD DRAWINGS AND SPECIFICATIONS.
- ALL WATERMAIN TO BE INSTALLED AT MINIMUM COVER OF 2.4m. THERMAL INSULATION SHALL BE INSTALLED WHERE ADEQUATE SEPARATION CANNOT BE ACHIEVED AS PER CITY STANDARD W21, W22 AND W23.
- ALL WATERMAIN WORK AND MATERIAL SHALL BE IN ACCORDANCE WITH CITY OF OTTAWA STANDARDS. NO WORK SHALL COMMENCE UNLESS A CITY WATER WORKS INSPECTOR IS ON SITE. WATERMAIN CONNECTIONS BY CITY OF OTTAWA FORCES WITH ALL EXCAVATION BACKFILL AND ROAD REINSTATEMENT BY CONTRACTOR.
- WATERMAIN IS TO BE PVC DR18 WITH TRACER WIRE AS PER CITY OF OTTAWA STANDARD W36 UNLESS OTHERWISE NOTED.
- VALVE BOXES AS PER CITY OF OTTAWA DETAIL W24.
- ALL FIRE HYDRANTS TO BE INSTALLED AS PER CITY STANDARD W19 AND LOCATED AS PER CITY STANDARD W18 AND/OR CITY STANDARD CROSS SECTIONS.
- WATERMAIN BEDDING IS TO BE AS PER CITY OF OTTAWA DETAIL W17.
- THRUST BLOCKS AND RESTRAINT AS PER CITY OF OTTAWA DWGS: W25.3, W25.4, W25.5 AND W25.6.
- CATHODIC PROTECTION REQUIRED FOR ALL IRON FITTINGS PER CITY OF OTTAWA DWGS W389, W40, W41.
- IF WATERMAIN MUST BE DEFLECTED TO MEET ALIGNMENT, ENSURE THAT THE AMOUNT OF DEFLECTION USED IS LESS THAN HALF THAT RECOMMENDED BY THE MANUFACTURER.
- DISINFECTION AND TESTING OF WATERMAIN TO BE IN ACCORDANCE WITH CITY OF OTTAWA STANDARDS.
- WATER SERVICES TO BE INSTALLED AS PER CITY OF OTTAWA STANDARD W26 AND W35.
- WITHIN THE FROST ZONE, THE BACKFILL IN THE SERVICE TRENCHES SHOULD MATCH THE SOIL ON SIDES TO MINIMIZE DIFFERENTIAL FROST HEAVING IN THE SUBGRADE.
- INSTALLATION OF WATER METER AND REMOTE RECEPTACLE SHALL BE IN ACCORDANCE WITH CITY OF OTTAWA STANDARDS.
- GATE VALVE TO BE INSTALLED INSIDE THE WATER ROOM OF THE EXISTING BUILDING FOR THE PHASE 2 WATER SUPPLY AND SHALL REMAIN CLOSED UNTIL PHASE 2 IS COMMISSION TO ENSURE NO STAGNANT WATER RESIDES WITHIN THE SERVICE STUB.
- BACKFLOW VALVE TO BE INSTALLED TO PREVENT CROSS-CONNECTION BETWEEN WELL AND MUNICIPAL WATER SUPPLIES.

SHEET SIZE: A1 800.0mm X 914.4mm