

**LEGEND**

- FFL FINISHED FLOOR ELEVATION
- TOF TOP OF FOUNDATION
- BFL BASEMENT FLOOR ELEVATION
- USF UNDERSIDE OF FOOTING
- PROPERTY LINE
- CB CATCH-BASIN
- MH STORM MANHOLE
- +99.99 EXISTING GRADE ELEVATION
- +99.99 PROPOSED GRADE ELEVATION
- 2% PROPOSED SLOPE OF GRADE
- CENTERLINE OF SWALE
- 150mm BARRIER CURB
- D.C. DEPRESSED CURB
- ROOF DRAIN
- /// PAVEMENT
- CONCRETE

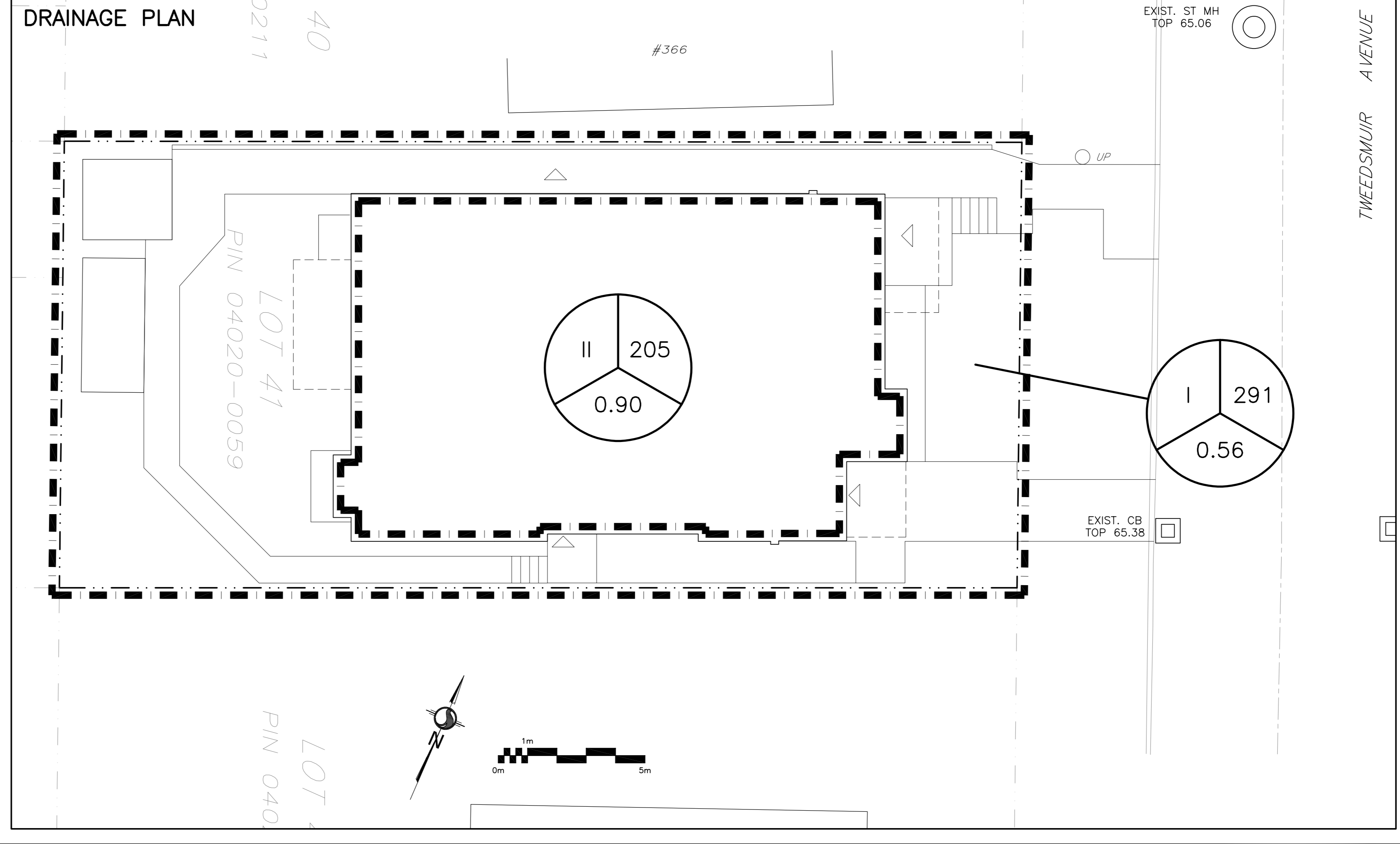
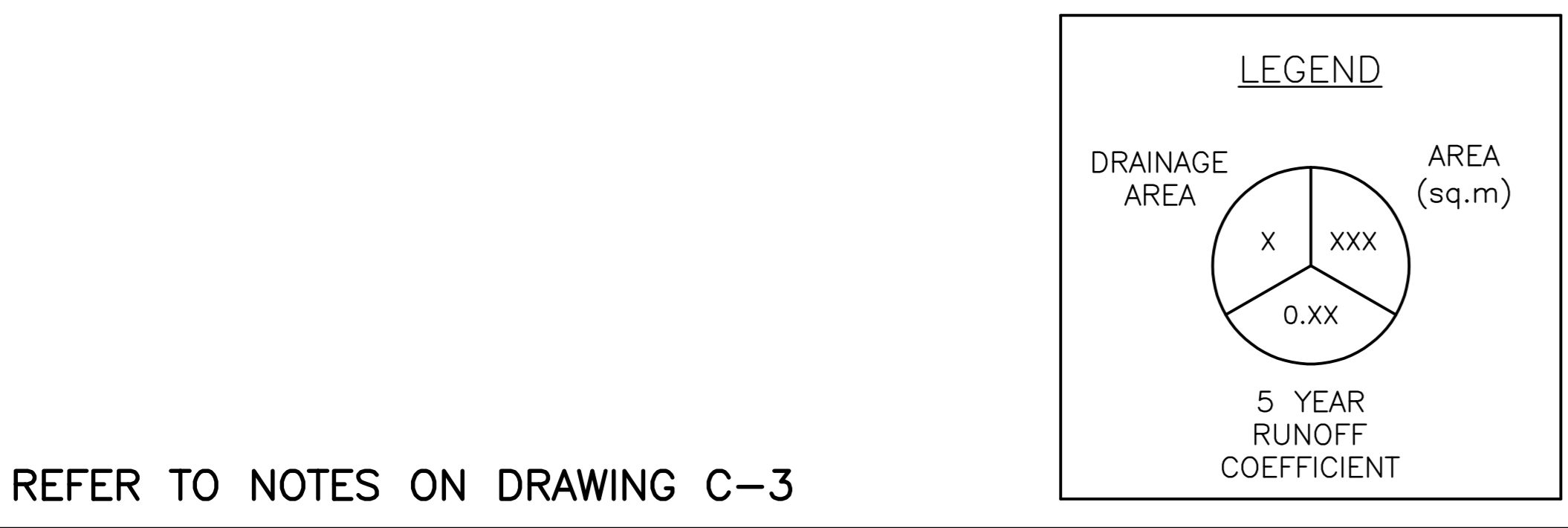
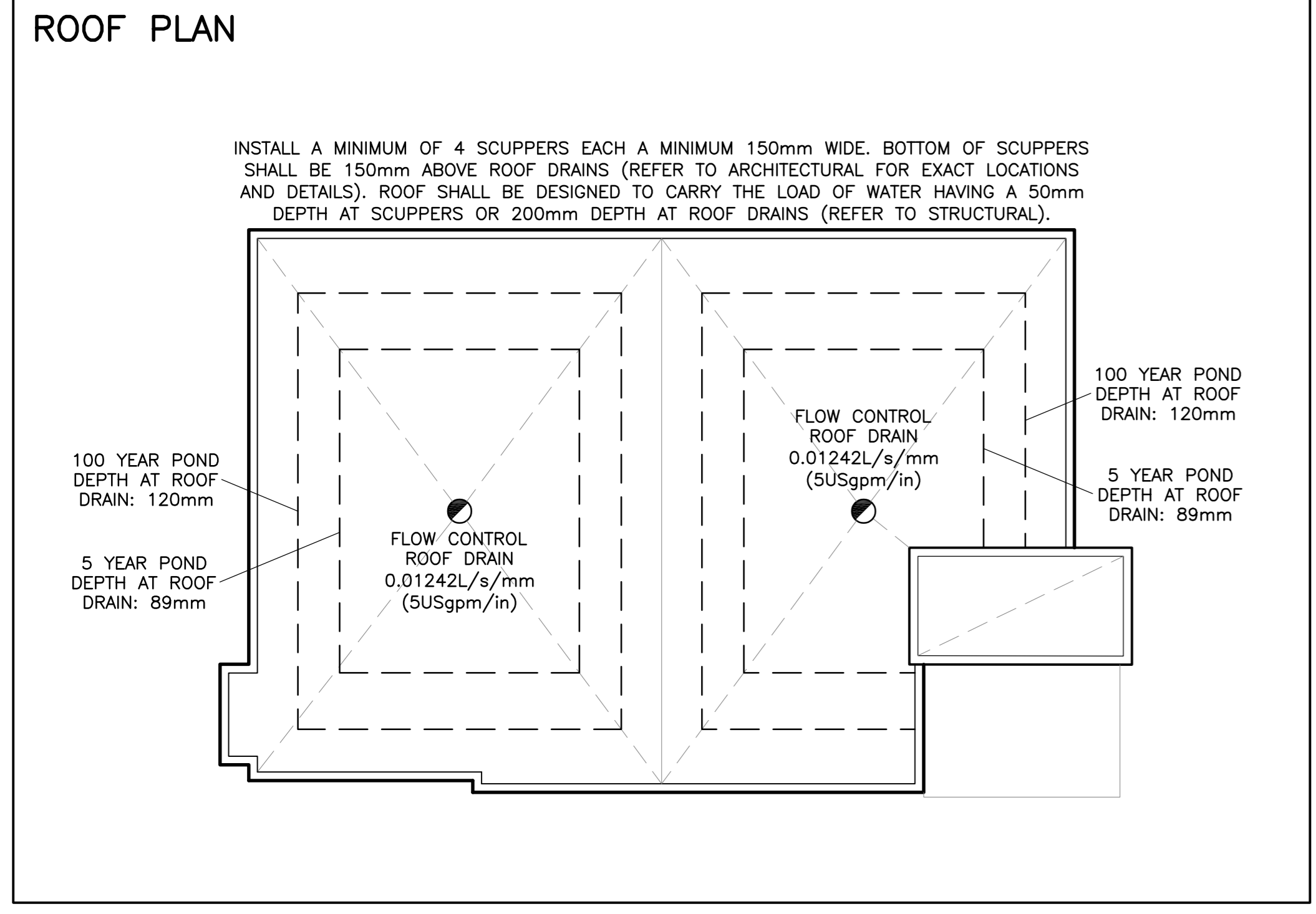
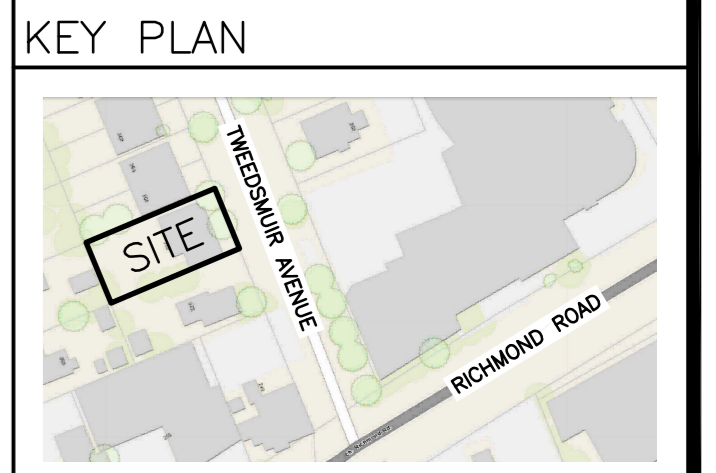

No.	DATE	REVISION
4	NOV 30-22	RE-ISSUED FOR APPROVAL
3	OCT 25-22	RE-ISSUED FOR APPROVAL
2	MAY 12-22	ISSUED FOR APPROVAL
1	APR 22-22	ISSUED FOR COORDINATION

**D. B. GRAY ENGINEERING INC.**  
 Stormwater Management - Grading & Drainage - Storm & Sanitary Sewers - Waterworks  
 700 Long Point Circle 613-425-8044  
 Ottawa, Ontario d.gray@dbgrayengineering.com

Project  
**PROPOSED 3.5-STOREY APARTMENT BUILDING**  
 368 TWEEDSMUIR AVENUE  
 OTTAWA, ONTARIO

Drawing Title  
**GRADING PLAN, SEDIMENT CONTROL PLAN AND DRAINAGE PLAN**

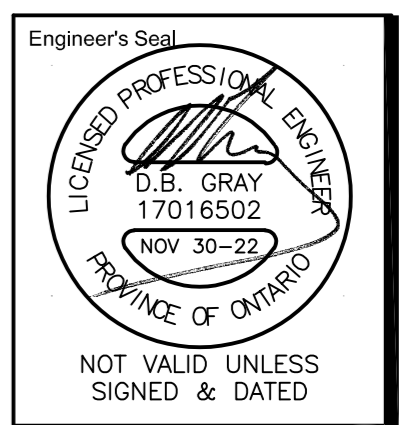

Drawn D.B.G.  
 H. Scale 1:100  
 V. Scale  
 Date APR 22-22  
 Job No. 22028

Drawing No.  
**C-2 of 3**

REFER TO NOTES ON DRAWING C-3