

LEGEND

- EXISTING TREE TO REMAIN
- EXISTING TREE TO BE REMOVED
- PROPOSED DECIDUOUS TREE
- PROPOSED SHRUBS / PERENNIALS
- PROPOSED SOD
- PROPOSED PEASTONE
- PROPOSED RIVERSTONE
- PROPOSED TEMPORARY GRAVEL PATHWAY
- PROPOSED CONCRETE WALKWAY
- PROPOSED WOOD RAMP
- PROPOSED TREE PROTECTION FENCE
- PROPOSED 1.5m Ht. WOOD BOARD FENCE
- PROPOSED BOULDERS

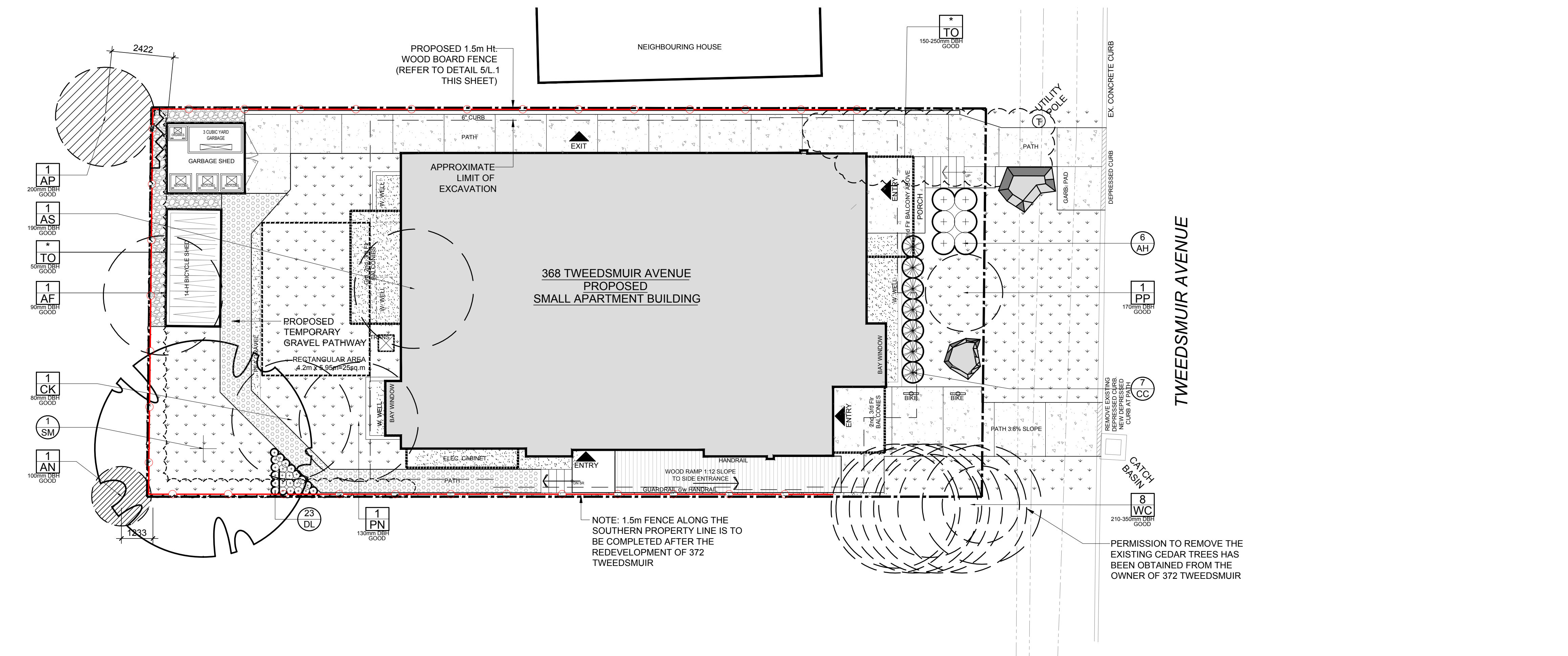

1 TREE CONSERVATION REPORT & LANDSCAPE PLAN
SCALE: 1:100

- GENERAL NOTES:**
- It is the responsibility of the appropriate contractor or official to report any errors, omissions or discrepancies on this plan with actual site conditions to the Landscape Architect before proceeding with construction.
 - The contractor is to notify all utility companies and authorities prior to any excavation and ascertain locations of underground services.
 - The contractor is to reinstate all areas and items damaged as a result of construction activity.
 - The contractor is to comply with all pertinent codes and by-laws.
 - The contractor is to maintain a positive surface run-off throughout the entire construction period.
 - The Landscape Architect is not responsible for subsurface conditions.
 - The contractor is to identify all existing trees to remain on site with the Landscape Architect prior to construction.
 - The contractor is to stake the proposed location of all plant material in conjunction with the Landscape Architect prior to excavation.
 - Minimum distances for selected deciduous trees are as follows:
 - Building Foundations 7.5m
 - Sidewalks 1.5m
 - Public Streets 2.5m
 - Underground Infrastructure 2.0m
 - All trees within 1m of underground utility trenches are to be excavated by hand.
 - Remove all protective wrapping from tree trunks after installation.
 - Staking of trees shall only be performed if necessary.
 - Ensure that mulch is pulled back a min. distance of 75mm from base of tree trunk.

EXISTING TREE LIST

KEY	QTY	BOTANICAL NAME	COMMON NAME	SIZE	CONDITION	REMARKS	OWNERSHIP
AF	1	<i>Acer x freemanii</i>	Freeman's Maple	130mm DBH	GOOD	To be removed	368 Tweedsmuir
AN	1	<i>Acer negundo</i>	Manitoba Maple	100mm DBH	GOOD	To remain	365 Athlone
AP	1	<i>Acer platanoides</i>	Norway Maple	200mm DBH	GOOD	To be removed	365 Athlone
AS	1	<i>Acer saccharum</i>	Sugar Maple	190mm DBH	GOOD	To be removed	368 Tweedsmuir
CK	1	<i>Acer platanoides 'Crimson King'</i>	Crimson King Maple	80mm DBH	GOOD	To be removed	368 Tweedsmuir
PN	1	<i>Pinus nigra</i>	Austrian Pine	130mm DBH	GOOD	To be removed	368 Tweedsmuir
PP	1	<i>Picea pungens</i>	Colorado Spruce	170mm DBH	GOOD	To be removed	368 Tweedsmuir
TO	*	<i>Thuja occidentalis</i>	White Cedar	50-250mm DBH	GOOD	To be removed	368 Tweedsmuir
WC	8	<i>Thuja occidentalis</i>	White Cedar	210-350mm DBH	GOOD	To be removed	372 Tweedsmuir

*DENOTES NUMEROUS

PROPOSED PLANT LIST

KEY	QTY	BOTANICAL NAME	COMMON NAME	SIZE	CONDITION	Remarks
DECIDUOUS TREES						
SM	1	<i>Acer saccharum</i>	Sugar Maple	60mm cal.	B&B	
SHRUBS						
AH	6	<i>Hydrangea arborescens 'Annabelle'</i>	Annabelle Hydrangea	1 gallon pot	Potted	Space 1000mm o.c.
CC	7	<i>Juniperus sabina 'Calgary Carpet'</i>	Calgary Carpet Juniper	600mm spr.	Potted	Space 800mm o.c.
PERENNIALS						
DL	23	<i>Hemerocallis 'Purple D'Oro'</i>	Purple D'Oro Daylily	150mm pot.	Potted	Space 400mm o.c.

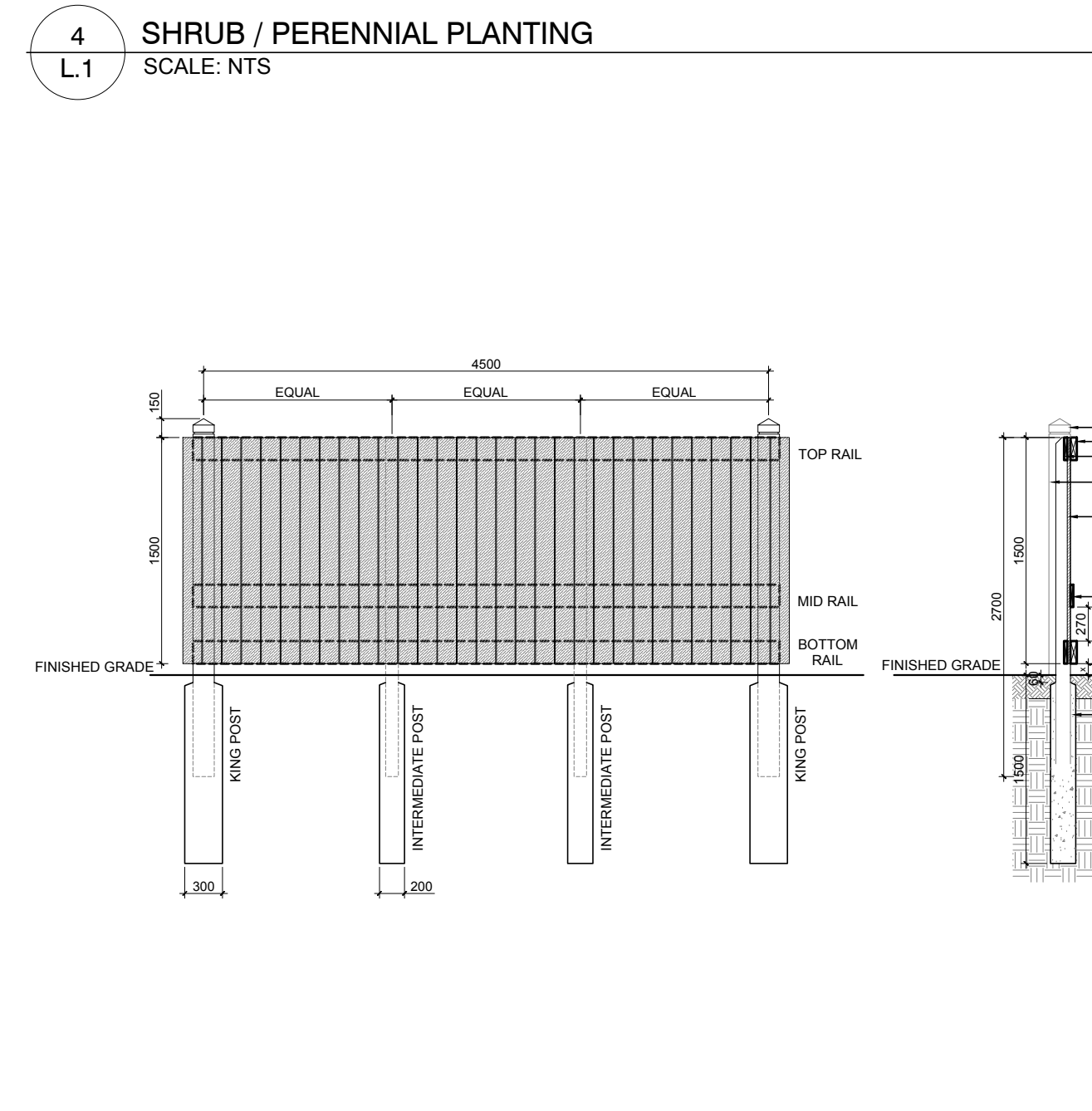
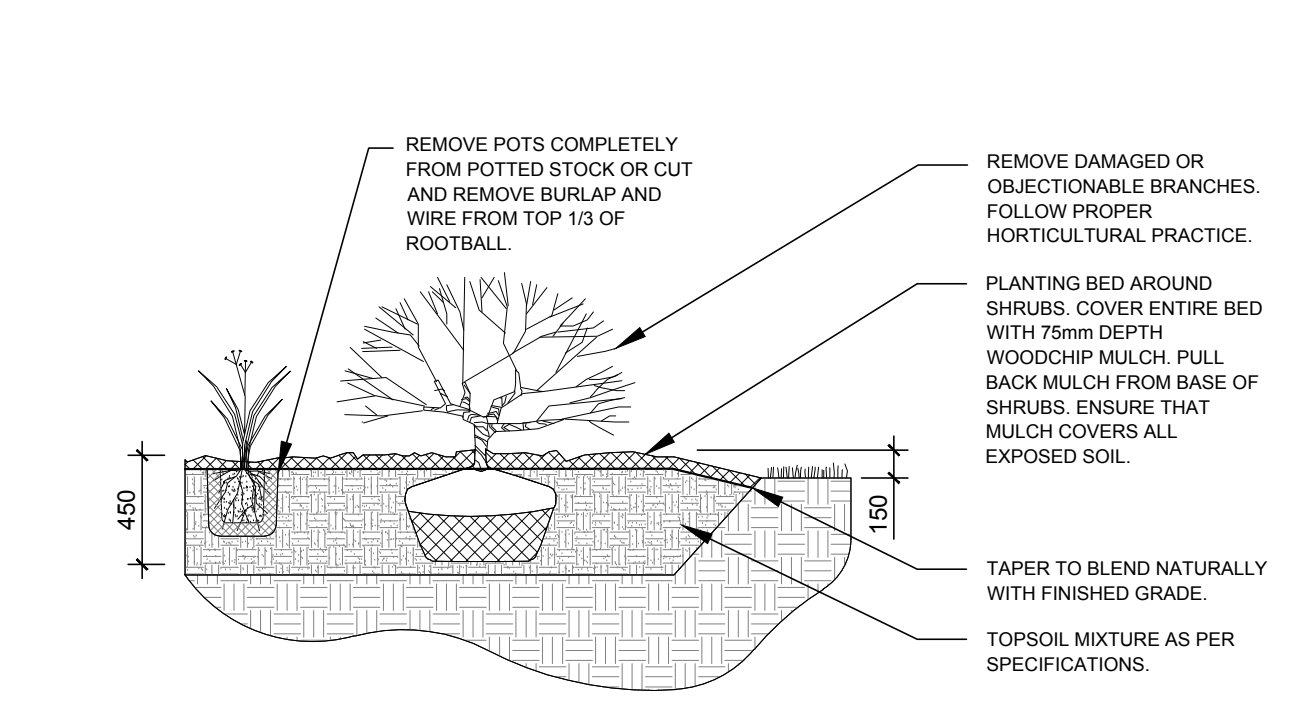
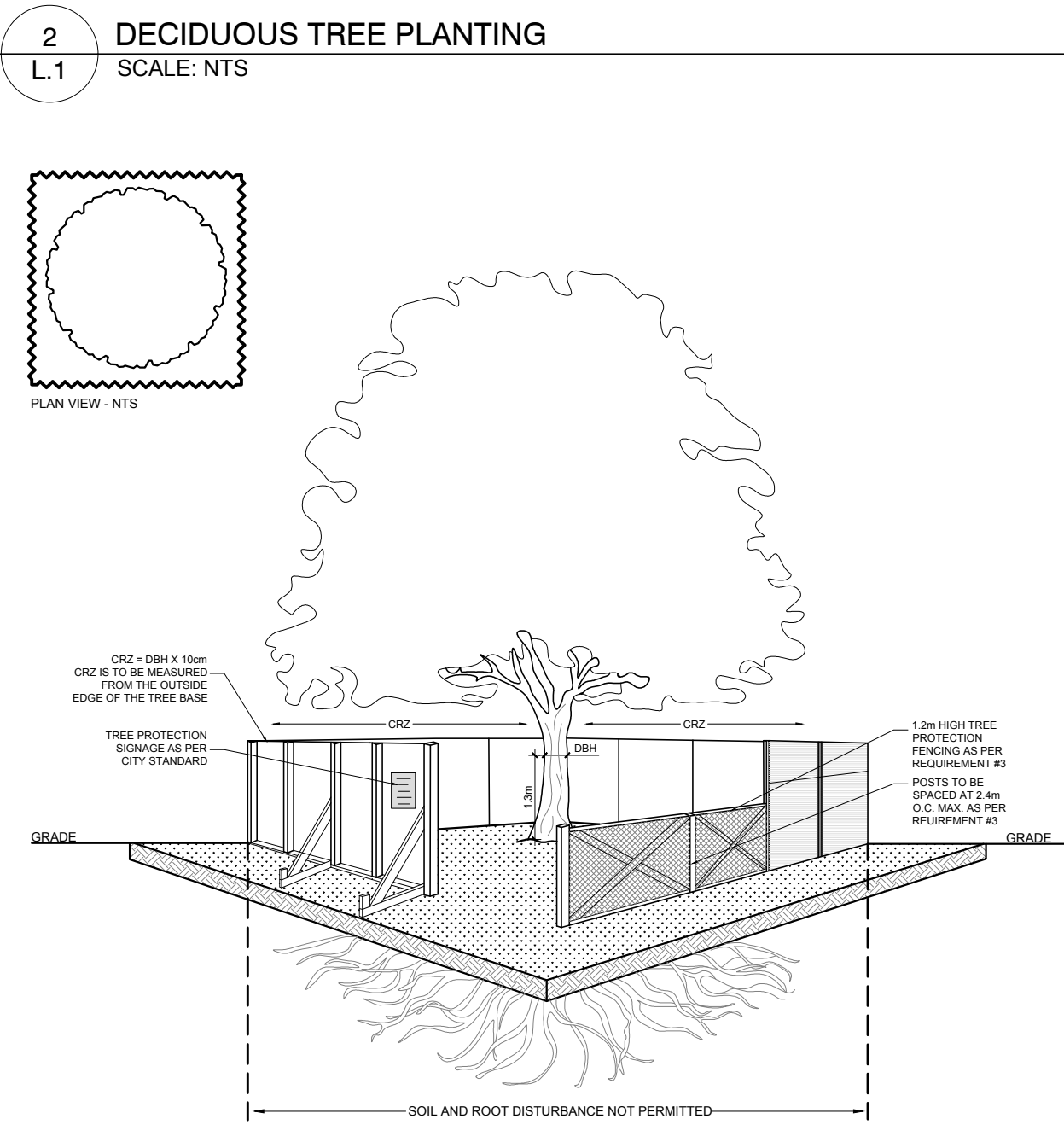
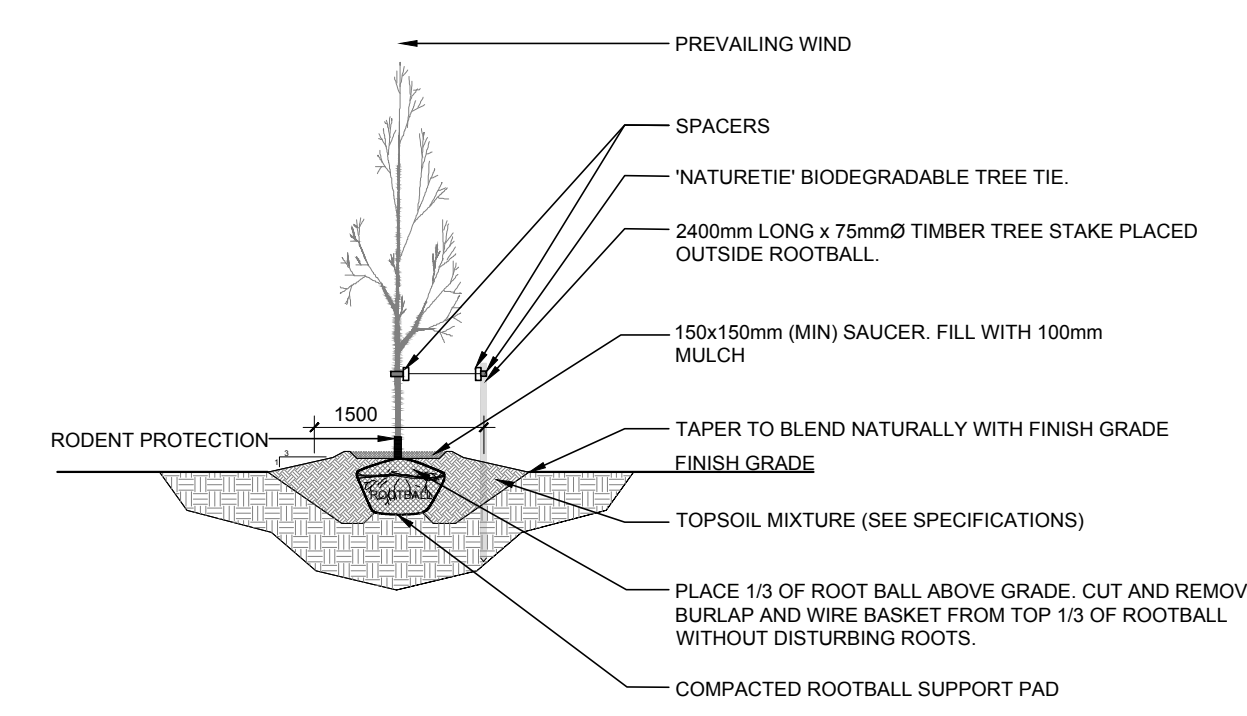

No.	Issue	Date	MM/DD/YY	DR.	CK
8	REVISED PER RJH COMMENTS	10/20/2022	ML	JL	
7	REVISED PER NEW SITE PLAN	10/14/2022	ML	JL	
6	REVISED PER CITY COMMENTS	09/16/2022	ML	JL	
5	REVISED PER ARCHITECT'S COMMENTS	05/13/2022	ML	JL	
4	SURFACING REVISED	05/06/2022	ML	JL	
3	REVISED PER ARCHITECT'S COMMENTS	05/05/2022	ML	JL	
2	ISSUED FOR DISCUSSION AND REVIEW	05/03/2022	ML	JL	
1	ISSUED FOR DISCUSSION AND REVIEW	04/29/2022	ML	JL	

JAMES B. LENNOX & ASSOCIATES INC.
LANDSCAPE ARCHITECTS
3332 CARLING AVE. OTTAWA, ONTARIO K2H 5A8
Tel: (613) 723-5168 Fax: (866) 343-3942

PROJECT
PROPOSED 3.5 STOREY APARTMENT BUILDING
368 TWEEDSMUIR AVENUE, OTTAWA ON

DRAWING
TREE CONSERVATION REPORT & LANDSCAPE PLAN

STAMP

SCALE
AS SHOWN

START DATE
APRIL 2022

PROJECT NO.
22MIS2245

PROJECT NORTH

DRAWING NO.
L.1

PLOT SIZE ARCH-D