

STM STRUCTURE TABLE				
NAME	RIM ELEV.	INVERT IN	INVERT OUT	DESCRIPTION
LSCB1	101.54		N100.540	PER CITY STANDARD S31
LSCB2	101.46	S100.461	E100.428	PER CITY STANDARD S30
LSCB3	101.30	W100.264	S100.241	PER CITY STANDARD S30
LSCB4	101.11	N100.057	S100.030	PER CITY STANDARD S30
LSCB5	100.26	N99.250	SW99.220	PER CITY STANDARD S30
STMH1	100.31	N99.220	W98.689	COVER CITY S24.1 FRAME CITY S25 STRUC OPSD 701.010
STMH2	100.88	N99.790	S99.763	COVER CITY S24.1 FRAME CITY S25 STRUC OPSD 701.010
STMH3	101.23	E99.940	S99.907	COVER CITY S24.1 FRAME CITY S25 STRUC OPSD 701.010

SAN STRUCTURE TABLE				
NAME	RIM ELEV.	INVERT IN	INVERT OUT	DESCRIPTION
MH1	101.22	E99.620	S99.593	COVER CITY S24 FRAME CITY S25 STRUC OPSD 701.010
MH2	100.90	N99.380	S99.348	COVER CITY S24 FRAME CITY S25 STRUC OPSD 701.010

CROSSING CONFLICT TABLE		
LOCATION	DESCRIPTION	SEPARATION
1	250mm STM SERVICE INV 98.68 150mm SAN SERVICE OBY 98.38	0.30
2	250mm PROP. STM SERVICE INV 99.29 250mm EX. STM SERVICE OBY 98.93	0.36
3	250mm STM SERVICE INV 99.71 150mm SAN SERVICE OBY 99.41	0.30
4	250mm PROP. STM SERVICE INV 99.71 200mm EX. STM SERVICE OBY 99.27	0.44
5	250mm STM SERVICE INV 99.87 150mm EX. WTR SERVICE TOP +98.62	1.25

**GENERAL NOTES**

1. THE ORIGINAL TOPOGRAPHY, GROUND ELEVATION AND SURVEY DATA SHOWN ARE SUPPLIED FOR INFORMATION PURPOSES ONLY, AND INVOLVING NO GUARANTEE OF ACCURACY. IT SHALL BE THE RESPONSIBILITY OF THE CONTRACTOR TO VERIFY ALL INFORMATION SHOWN.
2. THIS PLAN IS NOT A CADASTRAL SURVEY SHOWING LEGAL PROPERTY BOUNDARIES AND EASEMENTS. THE PROPERTY BOUNDARIES SHOWN HEREON HAVE BEEN DERIVED FROM INFORMATION SUPPLIED BY (OR SHOWN ON) PARCEL MAPS AND DRAWINGS 318 (A)-10 AND CANNOT BE RELIED UPON TO BE ACCURATE OR COMPLETE. THE PRECISE LOCATION OF THE CURRENT PROPERTY BOUNDARIES AND EASEMENTS CAN ONLY BE DETERMINED BY AN UP-TO-DATE LAND TITLES SEARCH AND A SUBSEQUENT CADASTRAL SURVEY PERFORMED AND CERTIFIED BY AN ONTARIO LAND SURVEYOR.
3. THE CONTRACTOR IS TO OBTAIN AND PAY FOR ALL NECESSARY PERMITS AND APPROVALS FROM THE CITY BEFORE COMMENCING CONSTRUCTION.
4. THE CONTRACTOR IS RESPONSIBLE FOR ALL LAYOUT.
5. THE CONTRACTOR IS TO DETERMINE THE EXACT LOCATION, SIZE, MATERIAL AND ELEVATION OF ALL EXISTING UTILITIES PRIOR TO COMMENCING CONSTRUCTION. PROTECT AND ASSUME ALL RESPONSIBILITY FOR EXISTING UTILITIES WHETHER OR NOT SHOWN ON THESE DRAWINGS. IF THERE IS ANY DISCREPANCY THE CONTRACTOR IS TO NOTIFY THE ENGINEER PROMPTLY.
6. RESTORE ALL TRENCHES AND SURFACES OF PUBLIC ROAD ALLOWANCES TO CONDITION EQUAL OR BETTER THAN ORIGINAL CONDITION AND TO THE SATISFACTION OF THE CITY AUTHORITIES.
7. EXCAVATE AND DISPOSE OF ALL EXCESS EXCAVATED MATERIAL, SUCH AS ASPHALT, CURBING AND DEBRIS, OFF SITE AS DIRECTED BY THE ENGINEER AND THE CITY.
8. TOPSOIL TO BE STRIPPED AND STOCKPILED FOR REHABILITATION. CLEAN FILL TO BE PLACED IN FILL AREAS AND COMPACTED TO 95% STANDARD PROCTOR DENSITY.

**WATERMAIN NOTES**

1. CONSTRUCT ALL WATERMANS AND APPURTENANCES IN ACCORDANCE WITH OPSD STANDARDS AND SPECIFICATIONS, AS WELL AS CITY STANDARDS.
2. WATERMANS AND/OR WATER SERVICES ARE TO HAVE A MINIMUM COVER OF 2.4m. OTHERWISE THERMAL INSULATION IS REQUIRED AS PER CITY STANDARDS (IF AVAILABLE) OR OPSD 1109.030.
3. IF THE WATERMAIN MUST BE DEFLECTED TO MEET ALIGNMENT, ENSURE THAT THE AMOUNT OF DEFLECTION USED IS EQUAL TO OR LESS THAN THAT WHICH IS RECOMMENDED BY THE MANUFACTURER.
4. THERMAL INSULATION OF WATERMANS AT OPEN STRUCTURES AS PER CITY STANDARDS (IF AVAILABLE) OR OPSD 1109.030.
5. VALVES TO BE OPERATED BY CITY STAFF ONLY.
6. NO CONNECTION TO EXISTING WATER SERVICES SHALL BE COMPLETED UNTIL A WATER PERMIT IS OBTAINED FROM THE CITY. CITY TO BE PRESENT FOR WATERMAIN CONNECTION, CONNECTION, EXCAVATION, BACKFILLING AND REINSTATEMENT TO BE COMPLETED BY CONTRACTOR.
7. IT WILL BE THE RESPONSIBILITY OF THE CONTRACTOR TO PERFORM ANY WATERMAIN CONNECTION(S) REQUIRED. THIS SHALL BE COMPLETED IN THE PRESENCE OF A DESIGNATED MUNICIPAL WATER OPERATOR AND THE SELECTED CONTRACTOR SHALL PROVE TO THE SATISFACTION OF THE CITY THAT THEY ARE COMPETENT TO PERFORM THE WORKS PRIOR TO INITIATING CONSTRUCTION.
8. CONCRETE THRUST BLOCKS TO CONFORM TO OPSD 1103.010 AND OPSD 1103.020.
9. ALL WATERMAIN TO BE CLASS 150 DR-18 OR APPROVED EQUIVALENT.
10. ALL WATERMAIN TO BE EQUIPPED WITH TRACER WIRE.

**SEWER NOTES:**

1. CONSTRUCT ALL SEWERS, CATCH BASINS, MANHOLES AND APPURTENANCES IN ACCORDANCE WITH OPSD STANDARDS AND SPECIFICATIONS, AS WELL AS CITY.
2. SEWER TRENCHING AND BEDDING SHALL CONFORM TO OPSD 802.010 AND 802.013 UNLESS NOTED OTHERWISE.
  - 2.1. BEDDING SHALL BE A MINIMUM 150mm OF GRANULAR "A", COMPACTED TO MINIMUM 95% STANDARD PROCTOR DRY DENSITY. CLEAR STONE BEDDING SHALL NOT BE PERMITTED.
  - 2.2. SUB-BEDDING, IF REQUIRED SHALL CONSIST OF 450mm OF COMPACTED GRANULAR "B" TYPE 1.
  - 2.3. BACKFILL TO AT LEAST 300mm ABOVE TOP OF PIPE WITH GRANULAR "A" OR GRANULAR "B" TYPE 1.
  - 2.4. TO MINIMIZE DIFFERENTIAL FROST HEAVING, TRENCH BACKFILL FROM PAVEMENT SUBGRADE TO 2.0 METRES BELOW FINISHED GRADE) SHALL MATCH EXISTING SOIL CONDITIONS.
3. SANITARY SEWERS AND CONNECTIONS 150mm AND SMALLER TO BE PVC SDR-28.
4. SEWERS AND CONNECTIONS 200mm AND LARGER TO BE PVC SDR-35. BEDDING TO BE TYPE "B" EXCEPT AT RISERS, UNLESS NOTED OTHERWISE.
5. INSULATE ALL STORM AND SANITARY SEWERS/SERVICES THAT HAVE LESS THAN 2.0m OF COVER WITH THERMAL INSULATION AS PER OPSD 1109.030.
6. SEWER CONNECTIONS ARE TO BE MADE ABOVE THE SPRINGLINE OF THE SEWERMAIN AS PER CITY OF OTTAWA STANDARD DRAWING S11, S11.1 & S11.2.
7. SUPPLY AND INSTALL ALL PIPING AND APPURTENANCES AS SHOWN AND DETAILED TO WITHIN 1.0m OF BUILDING. ALL ENDS OF SERVICES TO BE PROPERLY CAPPED AND LOCATED WITH 2"x4"X8" LONG MARKER.
8. CONTRACTOR TO TELETEST [CITY] ALL PROPOSED SEWERS ON SITE. OUTLET CONNECTION TO THE MAIN AND PIPES 150mm OR GREATER PRIOR TO BASE COURSE ASPHALT. UPON COMPLETION OF CONTRACT, THE CONTRACTOR IS RESPONSIBLE TO FLUSH AND CLEAN ALL SEWERS & APPURTENANCES.
9. DYE TESTING IS TO BE COMPLETED ON SANITARY SERVICE TO CONFIRM PROPER CONNECTION TO SANITARY SEWER MAIN.

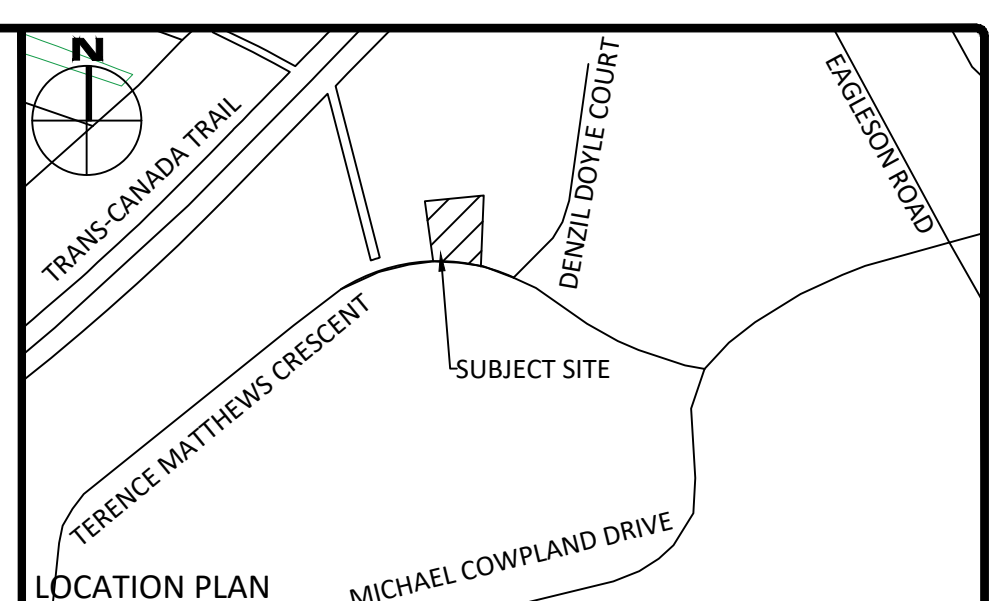

**LEGEND**

	CONCRETE BARRIER CURB		LIMIT OF CONSTRUCTION
	CONCRETE WALKWAY		DRAINAGE SWALE
	PROPOSED ASPHALT		DRAINAGE DITCH
	PROPOSED PAVERS		SLOPING AT 3:1 UNLESS SPECIFIED
	LANDSCAPING CATCHBASIN		SURFACE ELEVATION
	CATCHBASIN MANHOLE		SWALE ELEVATION
	CATCHBASIN		TOP OF WALL ELEVATION
	SANITARY SEWER MANHOLE		OVERLAND FLOW ROUTE
	FIRE HYDRANT		SILT FENCE BARRIER
	WATER VALVE		MUD MAT
	WATER METER		DEPRESSED CURB
	REMOTE WATER METER		

**FOR REVIEW ONLY**  
NOT FOR CONSTRUCTION

1	ISSUED FOR REVIEW	OCT. 07, 2022
No.	Revisions	Date

Check and verify all dimensions before proceeding with the work. Do not scale drawings.

SCALE 1:250

**McINTOSH PERRY**  
115 Walgreen Road, RR3, Carp, ON K0A 1L0  
Tel: 613-836-2184 Fax: 613-836-3742  
www.mcintoshperry.com

Client: **DS STUDIO INC**  
95 PELHAM AVENUE  
TORONTO, ON M6N 1A5

Project: **BUILDING ADDITION**  
100 TERENCE MATTHEWS CRESCENT

Drawing Title: **SITE SERVICING PLAN**

Scale: 1:250	Project Number: CCO-23-0422
Drawn By: FV	Checked By: AG
Designed By: AG	Drawing Number: C102

FILENAME: C:\Other\01\Projects - 2022\04\23\0422 DS Studio - Office Insurance\_03 - 0422 DS Studio - Office Insurance\_03 - 0422 - Presentation.dwg  
 LAST SAVED: Friday, October 07, 2022 10:56:56 AM  
 LAST PLOTTED: Friday, October 07, 2022 10:56:56 AM

D07-12-XX-XXXX