

BENCHMARK INFO:

CITY OF OTTAWA MONUMENT NO. 2011-0127 LOCATED NEAR THE SOUTH-WEST CORNER OF THE INTERSECTION OF LEES AVENUE AND ROBINSON AVENUE.
GEODETIC ELEVATION = 63.60m.
ALL ELEVATIONS ARE REFERRED TO THE CGVD28 GEODETIC DATUM, DERIVED FROM VERTICAL CONTROL MONUMENT NO. 3603 HAVING AN ELEVATION OF 76.959 METRES. BEARINGS ARE GRID, DERIVED FROM THE NORTHERLY LIMIT OF PART 1 ON PLAN 4R-1381 AND ARE REFERRED TO THE CENTRAL MERIDIAN OF MTM ZONE 9 (76°30' WEST LONGITUDE) NAD-83 (ORIGINAL).
THE EXISTING GRADES SHOWN ON THE PLANS ARE TAKEN DIRECTLY FROM TOPOGRAPHICAL SURVEY PLAN (Ref. # 21029-20 JRE L17 PL 49 F1), PREPARED BY ANNIS, O'SULLIVAN, VOLLEBEKK SIGNED AND DATED AUGUST 14, 2020.
SURROUNDING BACKGROUND TOPO INFORMATION BEYOND THE LIMITS OF THE SITE SURVEY ARE SHOWN FROM CITY OF OTTAWA 1:1000 MAPPING FOR CONTEXT ONLY.

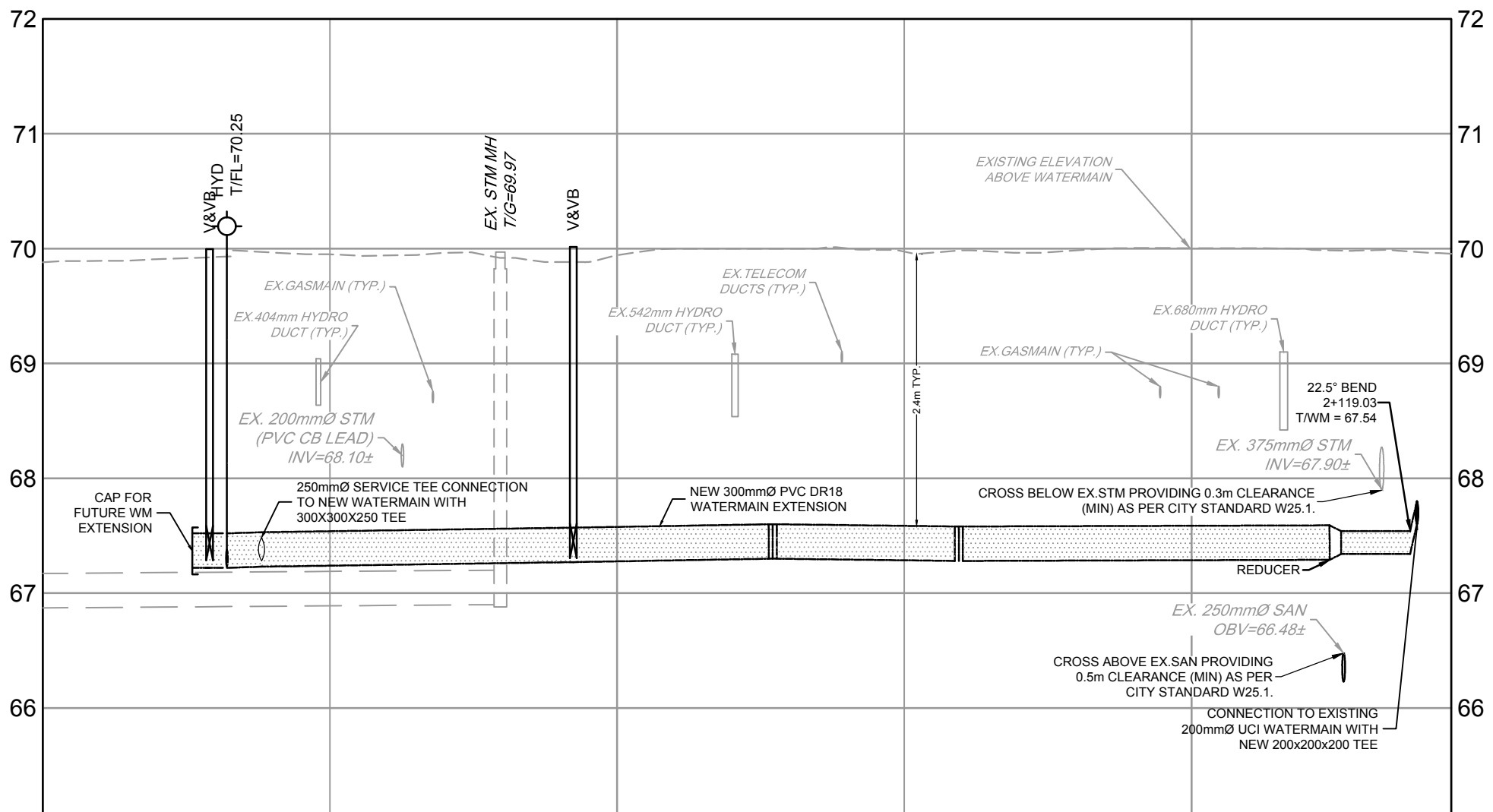

| PROPOSED ELEVATION | 69.91 | 69.97 | 69.95 | 69.95 | 69.94 | 69.92 | 69.94 | 69.99 | 70.00 | 69.97 | 69.98 | 70.00 | 70.00 | 69.97 | 69.98 | 70.00 | 70.00 | 69.97 | PROPOSED ELEVATION |
|------------------------|-------|------------------|------------------|--------------|-------|-------|------------------|------------------|-------|-----------------------|-------|-------|-------|-------|-------|-------|-------|-------|------------------------|
| TOP OF WM ELEVATION | 67.80 | 67.80 | 67.80 | 67.80 | 67.80 | 67.80 | 67.80 | 67.80 | 67.80 | 67.80 | 67.80 | 67.80 | 67.80 | 67.80 | 67.80 | 67.80 | 67.80 | 67.80 | TOP OF WM ELEVATION |
| STORM SEWER INVERTS | | | | | | | | | | | | | | | | | | | STORM SEWER INVERTS |
| SANITARY SEWER INVERTS | | | | | | | | | | | | | | | | | | | SANITARY SEWER INVERTS |
| EXISTING ELEVATION | 69.99 | 69.97 | 69.97 | 69.95 | 69.94 | 69.92 | 69.94 | 69.99 | 70.00 | 69.97 | 69.98 | 70.00 | 70.00 | 69.97 | 69.98 | 70.00 | 70.00 | 69.97 | EXISTING ELEVATION |
| CHAINAGE | 2+000 | 2+044.03 EX. VMB | 2+046.03 EX. VMB | 2+048.04 TEE | 2+050 | 2+052 | 2+054.04 EX. STM | 2+056.04 EX. VMB | 2+058 | 2+060.05 22.5° H BEND | 2+062 | 2+064 | 2+066 | 2+068 | 2+070 | 2+072 | 2+074 | 2+076 | CHAINAGE |

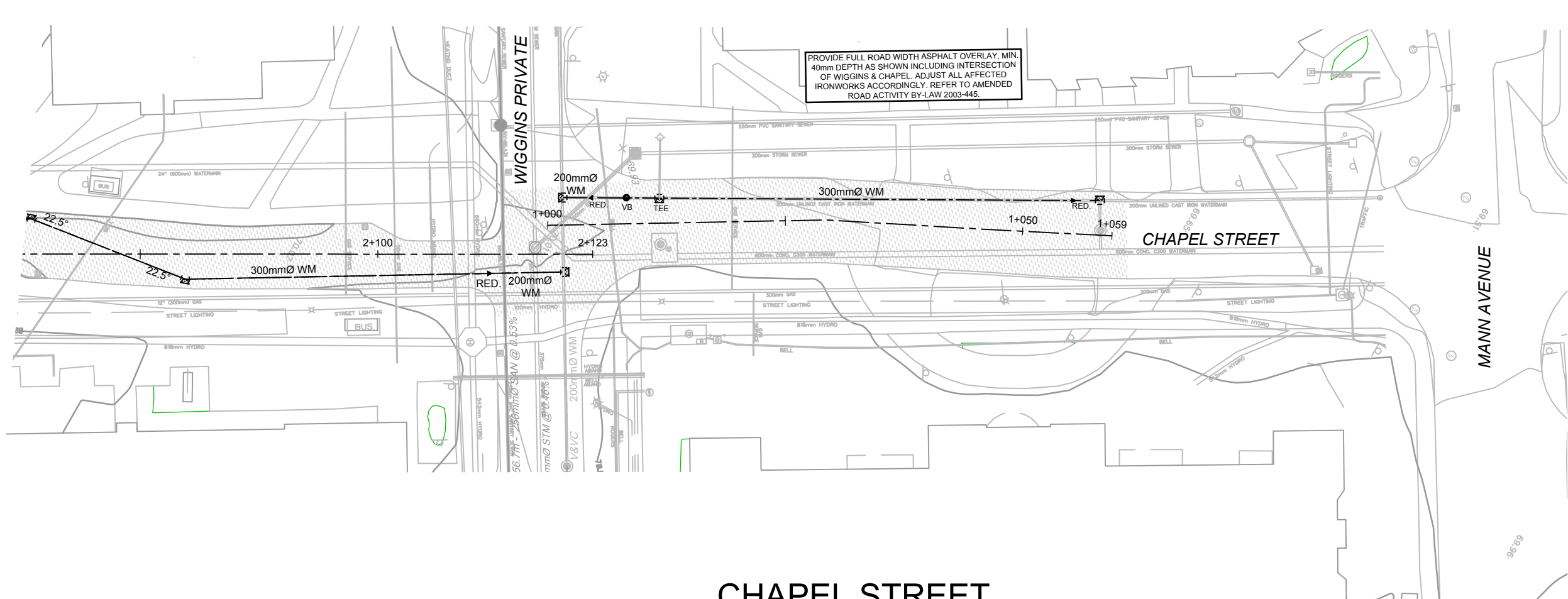
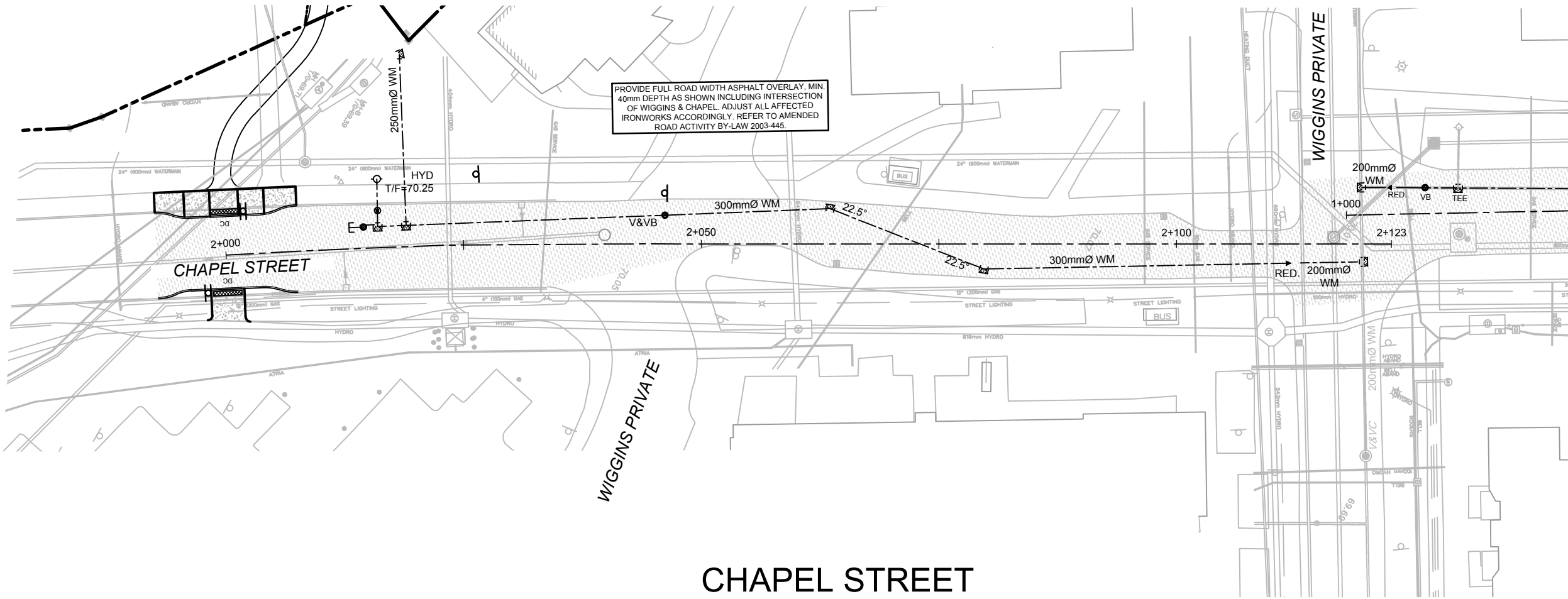
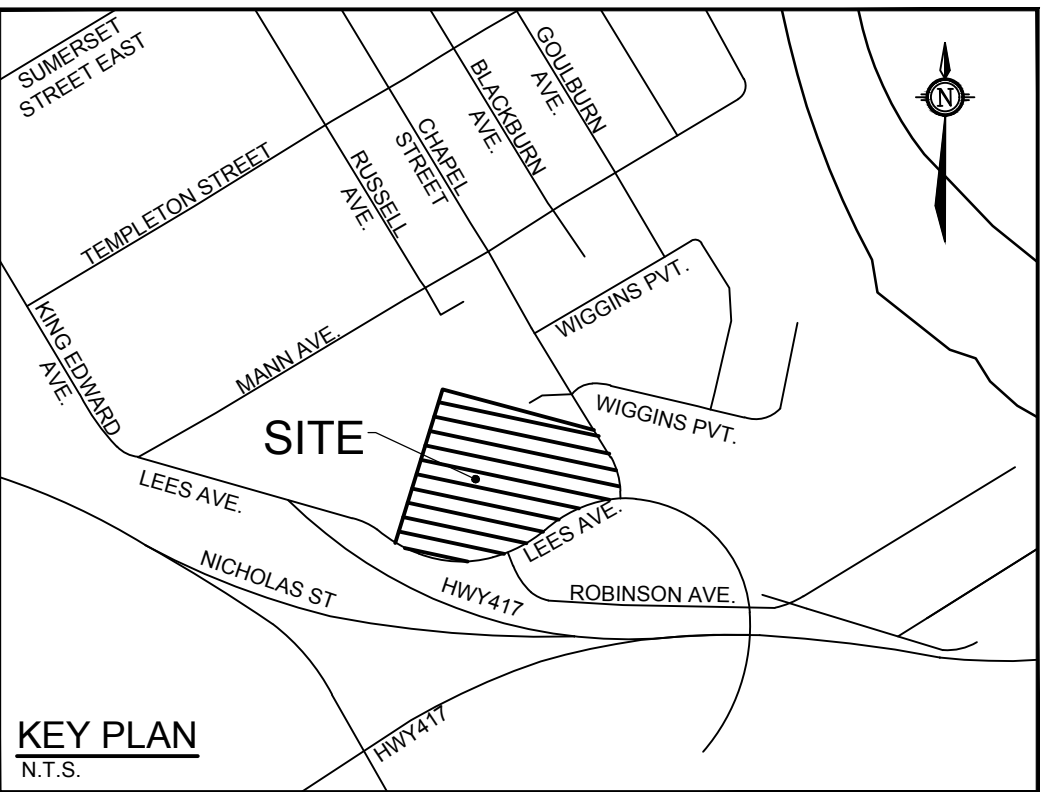
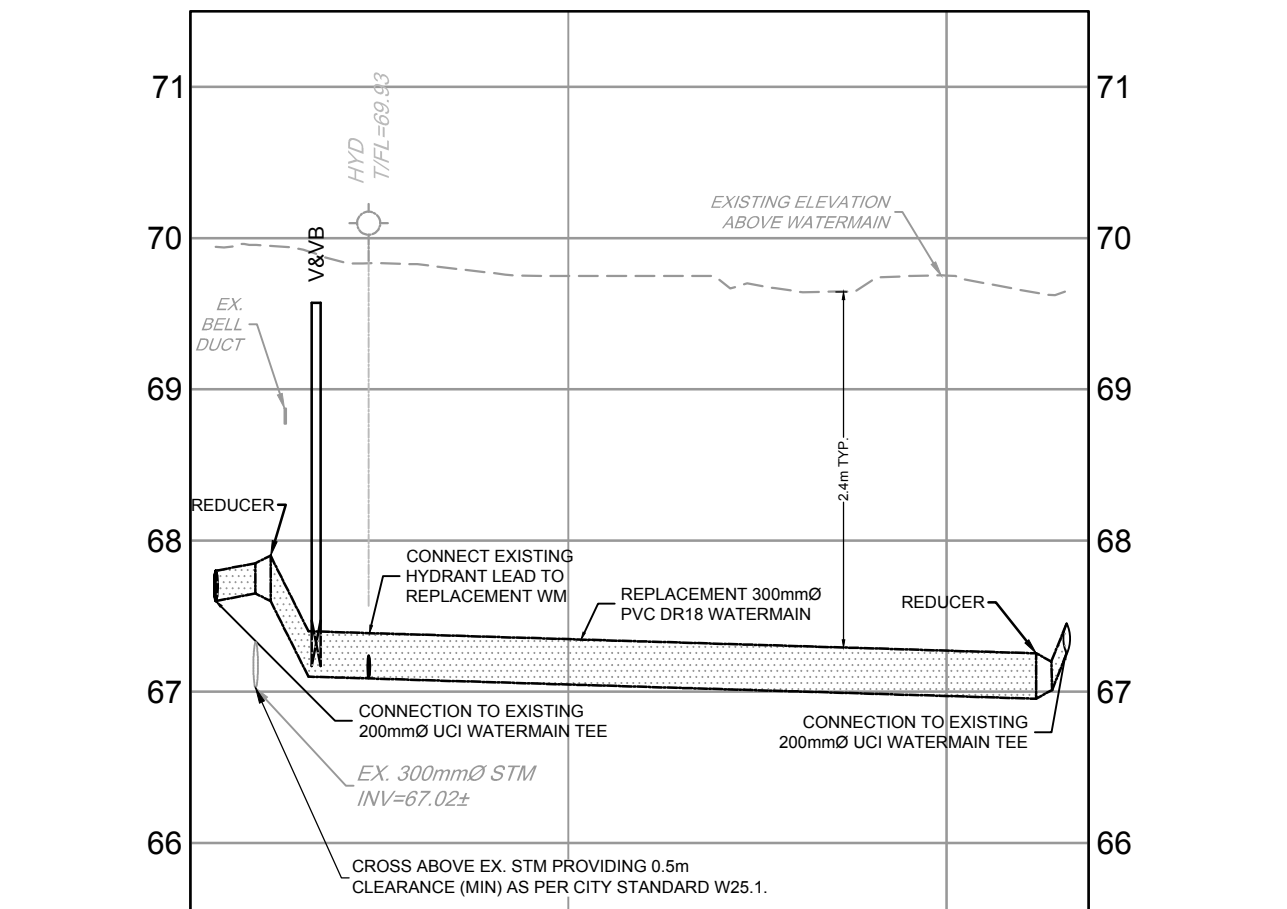

| | | | | | | | | | | |
|-------------------|------------------------|------------------|-------|-------|------------------|----------|----------|-------|--------------------|------------------------|
| CHAINAGE 1+000 | PROPOSED ELEVATION | 69.96 | 69.94 | 69.77 | 69.75 | 69.99 | 69.65 | 69.75 | 69.62 | PROPOSED ELEVATION |
| | TOP OF WM ELEVATION | 67.80 | 67.80 | 67.40 | 67.24 | | | 67.22 | | TOP OF WM ELEVATION |
| | STORM SEWER INVERTS | | | | | | | | | STORM SEWER INVERTS |
| | SANITARY SEWER INVERTS | | | | | | | | | SANITARY SEWER INVERTS |
| | EXISTING ELEVATION | 69.94 | 69.77 | 69.75 | 69.75 | 69.65 | 69.75 | | EXISTING ELEVATION | |
| 1+004.32 REDUCER | 1+008.33 VMB | 1+011.69 EX. STD | 1+025 | 1+050 | 1+056.05 REDUCER | 1+059.41 | CHAINAGE | | | |

NOTE:
THE POSITION OF ALL POLE LINES, CONDUITS, WATERMAINS, SEWERS AND OTHER UNDERGROUND AND OVERGROUND UTILITIES AND STRUCTURES IS NOT NECESSARILY SHOWN ON THE CONTRACT DRAWINGS, AND WHERE SHOWN, THE ACCURACY OF THE POSITION OF SUCH UTILITIES AND STRUCTURES IS NOT GUARANTEED. BEFORE STARTING WORK, DETERMINE THE EXACT LOCATION OF ALL SUCH UTILITIES AND STRUCTURES AND ASSUME ALL LIABILITY FOR DAMAGE TO THEM.

| No | REVISION | DATE | BY |
|----|----------------------------------|-----------|-----|
| 3 | RE-ISSUED FOR SITE PLAN APPROVAL | OCT 07/22 | FST |
| 2 | REVISED PER CITY COMMENTS | MAR 30/21 | FST |
| 1 | ISSUED FOR SITE PLAN APPROVAL | NOV 19/21 | FST |

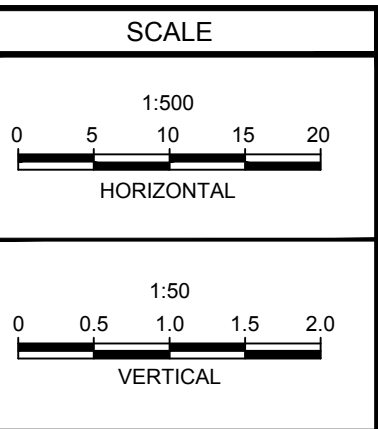

| DESIGN | DWM |
|----------|-----|
| CHECKED | FST |
| DRAWN | DWM |
| CHECKED | FST |
| APPROVED | FST |

FOR REVIEW ONLY

LICENSED PROFESSIONAL ENGINEER
F.S. THAUVETTE
100041599
OCT 07, 2022
PROVINCE OF ONTARIO

NOVATECH
Engineers, Planners & Landscape Architects
Suite 200, 240 Michael Cowland Drive
Ottawa, Ontario, Canada K2M 1P6
Telephone (613) 254-9643
Facsimile (613) 254-5867
Website www.novatech-eng.com

| LOCATION | OTTAWA, ONTARIO 2 ROBINSON AVE. |
|--------------|--|
| DRAWING NAME | PLAN AND PROFILE CHAPEL AVENUE, STATION 1+000 TO 1+060 CHAPEL AVENUE, STATION 2+000 TO 2+123 |
| PROJECT No | 119171 |
| REV | REV # 3 |
| DRAWING No | 119171-PR1 |