

- LEGEND**
- PROPERTY LINE
PROPOSED ELEVATION
EXISTING ELEVATION
GRADE AND DIRECTION
PROPOSED TOP OF CURB ELEVATION
PROPOSED TERRACE ELEVATION
MAXIMUM 3:1 SIDESLOPE
EMERGENCY OVERLAND FLOW ROUTE
PROPOSED SANITARY MANHOLE
PROPOSED CATCHBASIN MANHOLE
PROPOSED STORM MANHOLE
PROPOSED CATCHBASIN
PROPOSED HYDRANT AND VALVE
PROPOSED BARRIER CURB
PROPOSED DEPRESSIONED CURB
PROPOSED ROLL CURB (60m HEIGHT)
PROPOSED INLET CONTROL DEVICE
EXISTING EDGE OF PAVEMENT
EXISTING VALVE & VALVE BOX
EXISTING SERVICE POST
EXISTING HYDRANT
EXISTING COMBINED MH
EXISTING CATCHBASIN
EXISTING CATCHBASIN MH
EXISTING UTILITY POLE
- SAN MH 1
CBMH 3
STM MH 1
CB
HYD
DC
RC
ICD
- V8/V9
HYD
COMB MH
CB
CKUP

PAVEMENT STRUCTURE:

- LIGHT DUTY PAVEMENT
50mm HL-3 or SUPERPAVE 12.5
150mm GRANULAR "A"
300mm GRANULAR "B" TYPE II
ASPHALT GRADE PG 58-34 - TRAFFIC LEVEL "B"
*INSTALLED PER GEOTECHNICAL REPORT
- HEAVY DUTY PAVEMENT
40mm HL-3 or SUPERPAVE 12.5
50mm HL-8 or SUPERPAVE 19.0
150mm GRANULAR "A"
450mm GRANULAR "B" TYPE II
ASPHALT GRADE PG 58-34 - TRAFFIC LEVEL "B"
*INSTALLED PER GEOTECHNICAL REPORT
- HEAVY DUTY CONCRETE ROADWAY
CONCRETE AND HEAVY DUTY GRANULAR
BASE INSTALLED PER GEOTECHNICAL REPORT
- HEAVY DUTY PAVEMENT - ROADWAY RE-INSTATEMENT
MATCH EXISTING GRANULAR STRUCTURE OF ROADWAY IN TRENCHES
MATCH EXISTING ASPHALT THICKNESSES IN TRENCHES
NEW ASPHALT GRADE PG 58-34
PROVIDE FULL ROAD WIDTH ASPHALT OVERLAY, MIN 40mm DEPTH AS SHOWN INCLUDING INTERSECTION OF LEES & ROBINSON AVENUES.
REFER TO AMENDED ROAD ACTIVITY BY-LAW 2003-445.

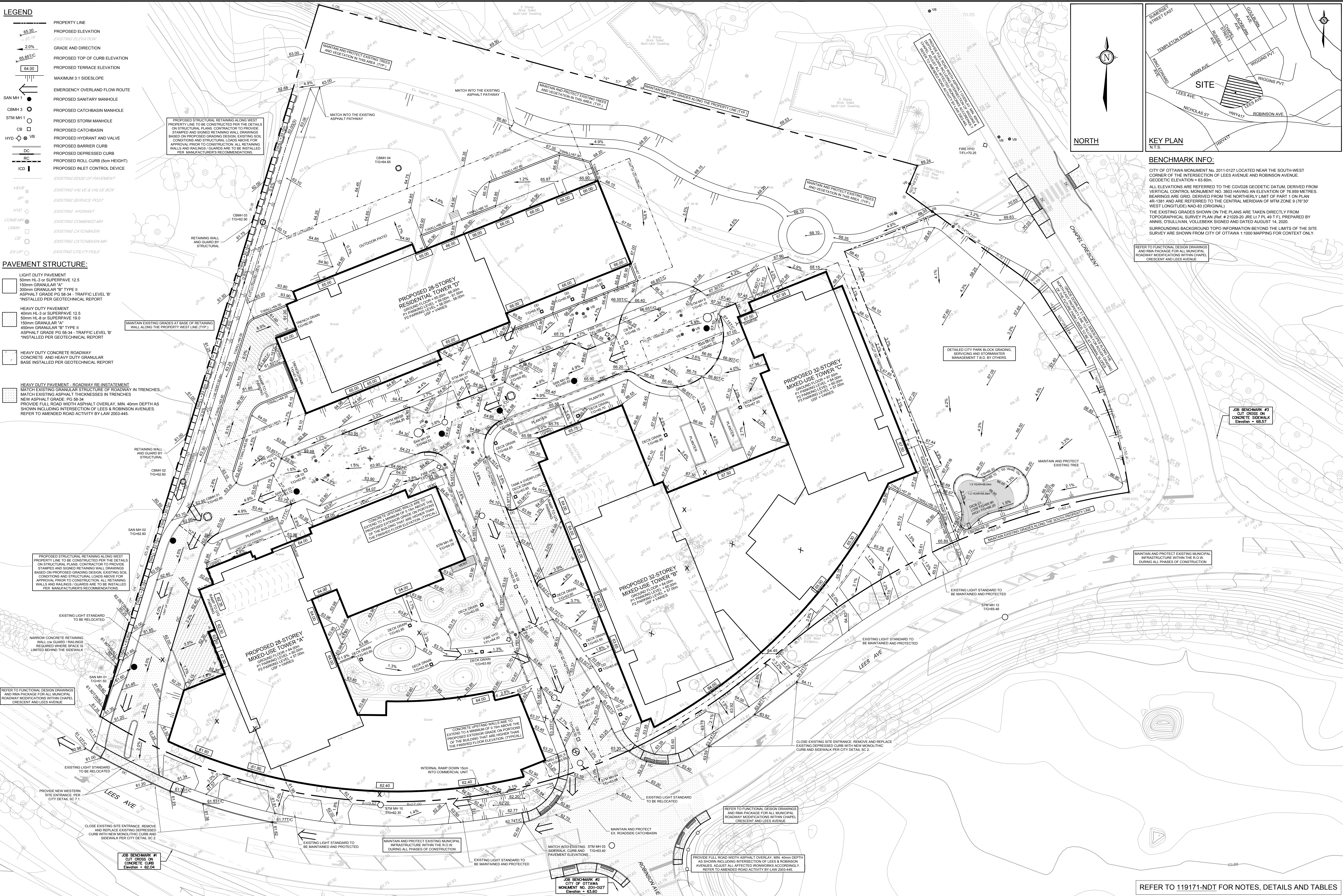

BENCHMARK INFO:
CITY OF OTTAWA MONUMENT NO. 2011-0127 LOCATED NEAR THE SOUTH-WEST CORNER OF THE INTERSECTION OF LEES AVENUE AND ROBINSON AVENUE. GEODETIC ELEVATION = 63.60m.
ALL ELEVATIONS ARE REFERRED TO THE CGVD28 GEODETIC DATUM, DERIVED FROM VERTICAL CONTROL MONUMENT NO. 3803 HAVING AN ELEVATION OF 76.959 METRES. BEARINGS ARE GRID, DERIVED FROM THE NORTHERLY LIMIT OF PART 1 ON PLAN 4R-1381 AND ARE REFERRED TO THE CENTRAL MERIDIAN OF MTM ZONE 9 (76°30' WEST LONGITUDE) NAD-83 (ORIGINAL).
THE EXISTING GRADES SHOWN ON THE PLANS ARE TAKEN DIRECTLY FROM TOPOGRAPHICAL SURVEY PLAN (Ref. # 21029-20 JRE L17 PL 49 F1), PREPARED BY ANNIS O'SULLIVAN, VOLLEBERG SIGNED AND DATED AUGUST 14, 2020.
SURROUNDING BACKGROUND TOPO INFORMATION BEYOND THE LIMITS OF THE SITE SURVEY ARE SHOWN FROM CITY OF OTTAWA 1:1000 MAPPING FOR CONTEXT ONLY.

REFER TO FUNCTIONAL DESIGN DRAWINGS AND RMA PACKAGE FOR ALL MUNICIPAL ROADWAY MODIFICATIONS WITHIN CHAPEL CRESCENT AND LEES AVENUE.

JOB BENCHMARK #3
CUT CROSS ON
CONCRETE SIDEWALK
Elevation = 68.57

REFER TO FUNCTIONAL DESIGN DRAWINGS AND RMA PACKAGE FOR ALL MUNICIPAL ROADWAY MODIFICATIONS WITHIN CHAPEL CRESCENT AND LEES AVENUE.

EXISTING LIGHT STANDARD TO BE MAINTAINED AND PROTECTED

EXISTING LIGHT STANDARD TO BE MAINTAINED AND PROTECTED

EXISTING LIGHT STANDARD TO BE MAINTAINED AND PROTECTED

EXISTING LIGHT STANDARD TO BE MAINTAINED AND PROTECTED

EXISTING LIGHT STANDARD TO BE MAINTAINED AND PROTECTED

EXISTING LIGHT STANDARD TO BE MAINTAINED AND PROTECTED

EXISTING LIGHT STANDARD TO BE MAINTAINED AND PROTECTED

EXISTING LIGHT STANDARD TO BE MAINTAINED AND PROTECTED

EXISTING LIGHT STANDARD TO BE MAINTAINED AND PROTECTED

EXISTING LIGHT STANDARD TO BE MAINTAINED AND PROTECTED

EXISTING LIGHT STANDARD TO BE MAINTAINED AND PROTECTED

EXISTING LIGHT STANDARD TO BE MAINTAINED AND PROTECTED

NOTE:
THE POSITION OF ALL POLE LINES, CONDUITS, WATERMANS, SEWERS AND OTHER UNDERGROUND AND OVERGROUND UTILITIES AND STRUCTURES IS NOT NECESSARILY SHOWN ON THE CONTRACT DRAWINGS, AND WHERE SHOWN, THE ACCURACY OF THE POSITION OF SUCH UTILITIES AND STRUCTURES IS NOT GUARANTEED. BEFORE STARTING WORK, DETERMINE THE EXACT LOCATION OF ALL SUCH UTILITIES AND STRUCTURES AND ASSUME ALL LIABILITY FOR DAMAGE TO THEM.

OWNER INFORMATION
2 ROBINSON AVENUE LIMITED PARTNERSHIP
88 ALBERT STREET
OTTAWA, ONTARIO, K1P 5E9
CONTACT: MR. KIERAN WAUGH
PHONE: (416) 903-1377
EMAIL: kwaugh@placemore.com

| No | REVISION | DATE | BY |
|----|---|-----------|-----|
| 3 | RE-ISSUED FOR SITE PLAN APPROVAL | OCT 07/22 | FST |
| 2 | REVISED PER CITY COMMENTS / UPDATED SITE PLAN | MAR 30/22 | FST |
| 1 | ISSUED FOR SITE PLAN APPROVAL | NOV 15/21 | FST |

| SCALE |
|------------|
| 1:300 |
| 0 3 6 9 12 |

| DESIGN |
|----------|
| SM / FST |
| CHECKED |
| DRAWN |
| DM / SM |
| CHECKED |
| SM / FST |
| APPROVED |
| FST |

FOR REVIEW ONLY



NOVATECH
Engineers, Planners & Landscape Architects
Suite 200, 240 Michael Cowland Drive
Ottawa, Ontario, Canada K2M 1P6
Telephone (613) 254-9643
Facsimile (613) 254-5867
Website www.novatech-eng.com

| | |
|---|-----------------------|
| LOCATION CITY OF OTTAWA 320 LEES AVENUE (2 ROBINSON AVENUE) | PROJECT No. 119171 |
| DRAWING NAME GRADING PLAN | REV #3 |
| DRAWING No. 119171-GR | |

D07-12-21-0202