

- LEGEND:
- BICYCLE RACKS
 - BOLLARD
 - BENCH
 - PROPOSED DECIDUOUS TREE
 - TREE GRATE
 - PEDESTRIAN LIGHT POST
 - LIMIT OF TEMPORARY ASPHALT
 - LIMIT OF WORK (204 APPLICATION)

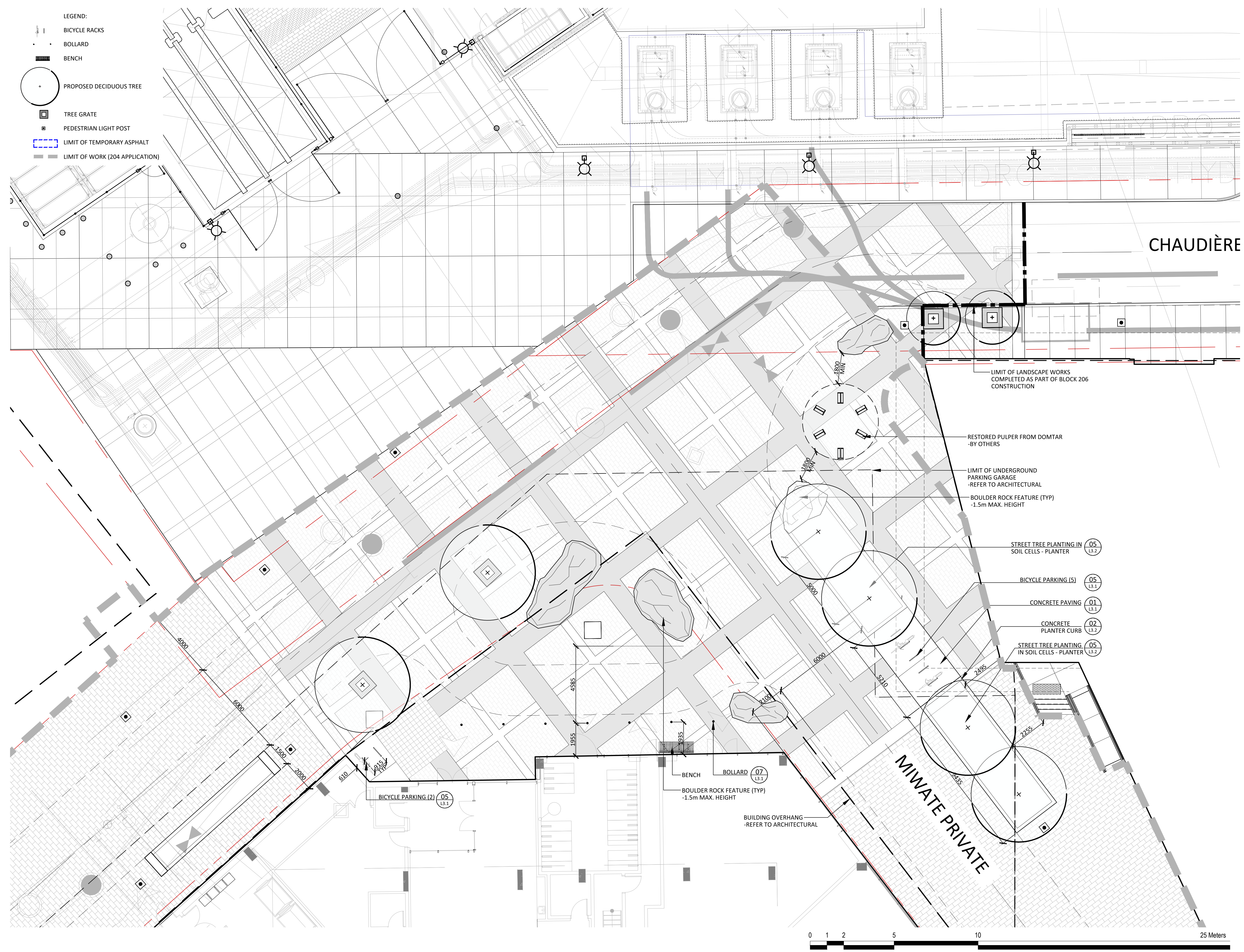

- GENERAL NOTES:
- All measurements in millimeters unless specified otherwise. Do not scale drawing. All drawings to be read in conjunction with written specifications.
 - Copyright reserved. This drawing is the exclusive property of CSW Landscape Architects Ltd. and shall not be used without the consent thereof.
 - This Drawing may not be used for construction until signed by the landscape architect. It is the responsibility of the contractor to:
 - check and verify all dimensions on site;
 - report all errors and/or omissions to the landscape architect;
 - comply with all pertinent codes and by-laws;
 - check and verify locations of all underground services with all local utilities prior to any digging.
 - Proposed grades are to be read in conjunction with landscape, architectural, and engineering drawings. Report any discrepancies to the Construction Manager.

No.	Revision	Date
4	RE-ISSUED FOR SPA	15 SEPT 2022
3	ISSUED FOR SPA	19 APR 2022
2	ISSUED FOR COORDINATION	11 APR 2022
1	ISSUED FOR COORDINATION	11 MAR 2022

North:

Stamp:

CSW Landscape Architecture
 Urban Design
 Site Planning
 Recreation and Park Planning
 Project Management

319 McRae Avenue, Suite 502, Ottawa, Ontario, K1Z 0B9
 Tel: (613) 729-4536

ZIBI

dream **theia**

Project:
ZIBI BLOCK 204

Chaudière Island West
 OTTAWA, ONTARIO

Drawing:
**LANDSCAPE PLAN
 GROUND FLOOR**

Scale:	1:100	Date:	March 2022
Design By:	SC/SMc	Drawn By:	SMc
Project Number:	1981-20	Sheet Number:	L1.2

Last Saved: 2022-09-15 7:08:22 AM
 File Location: Z:\Projects\1981-20_ZIBI Infrastructure_Central\Chaudière Island West_Mcrae_SPA(2022_Landscape)_P2.dwg

D07-12-22-0071