

Conditions of Use

Verify elevations and/or dimensions on drawing prior to use. Report any discrepancies to Dillon Consulting Limited.
Do not scale dimensions from drawing.
Do not modify drawing, re-use, or use it for purposes other than those intended at the time of its preparation without prior written permission from Dillon Consulting Limited.

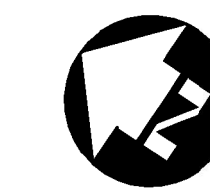

2	19/08/2021	RE-ISSUED FOR SITE PLAN CONTROL APPLICATION AND ZONING BY-LAW AMENDMENT	CDP, DS
1	12/02/2021	SPA / ZBA SUBMISSION	CDP

date: revision: by:

revisions



All drawing and specifications are the property of the architect. The contractor shall verify all dimensions and information on site and report any discrepancy to architect before proceeding.

Arch Corp - Orleans

1161 OLD MONTREAL RD.
ORLEANS ON, K4A 3N6

SITE SERVICING PLAN

scale: 1:250
drawn by: DS
reviewed by: CDP
job number: 21-2647
plot date: August 22, 2022
drawing number:

CIV-1

18697

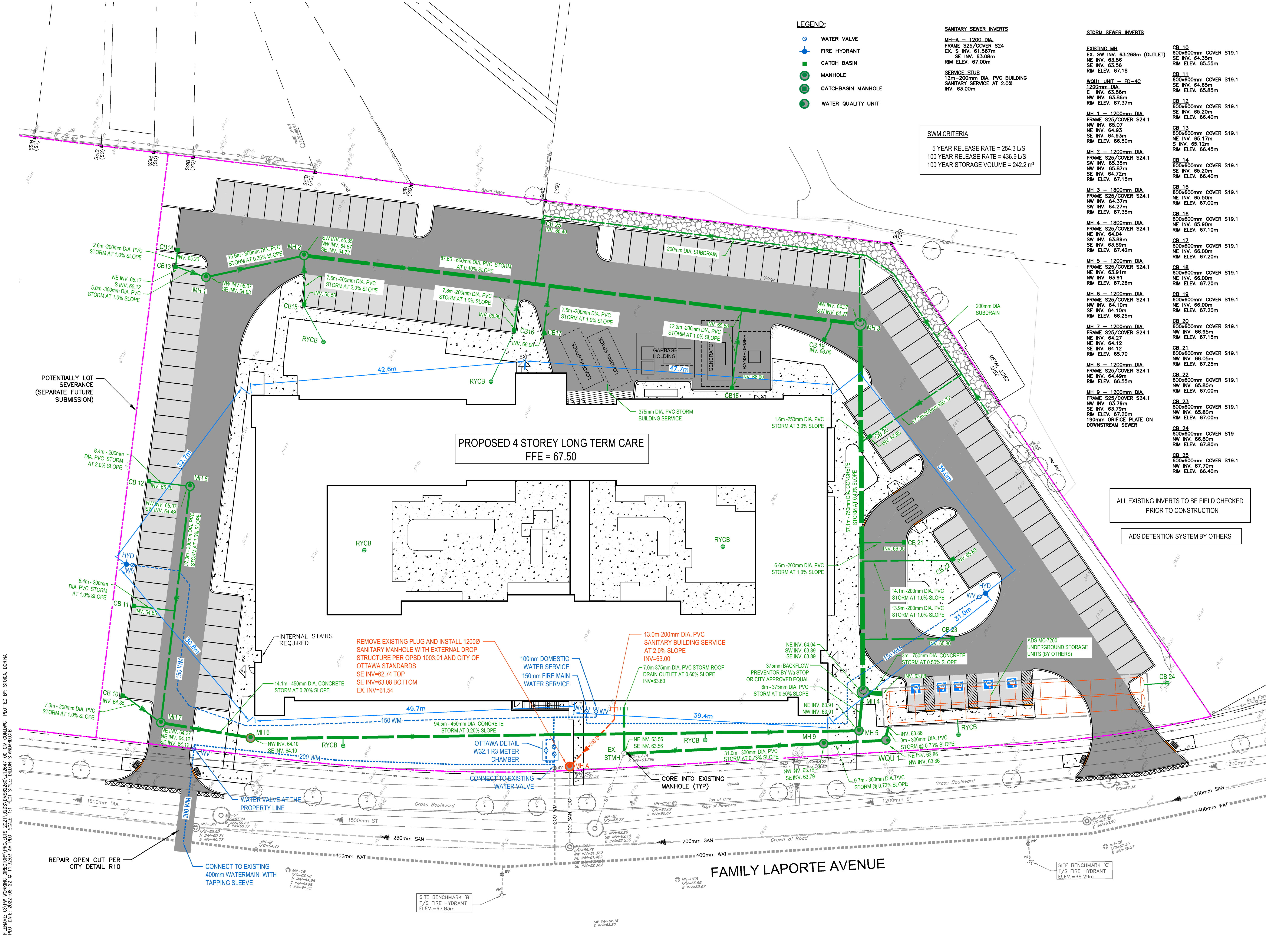

- LEGEND:**
- WATER VALVE
 - FIRE HYDRANT
 - CATCH BASIN
 - MANHOLE
 - CATCHBASIN MANHOLE
 - WATER QUALITY UNIT
- SANITARY SEWER INVERTS**
- MH-A - 1200 DIA. FRAME S25/COVER S24
EX. S INV. 61.567m
SE INV. 63.08m
RIM ELEV. 67.00m
- SERVICE STUB**
12m-200mm DIA. PVC BUILDING
SANITARY SERVICE AT 2.0%
INV. 63.00m

SWM CRITERIA

5 YEAR RELEASE RATE = 254.3 L/S
100 YEAR RELEASE RATE = 436.9 L/S
100 YEAR STORAGE VOLUME = 242.2 m³

- STORM SEWER INVERTS**
- EXISTING MH**
EX. SW INV. 63.268m (OUTLET)
NE INV. 64.35m
SE INV. 63.56
RIM ELEV. 67.18
- WQU1 UNIT - FD-4C**
1200mm DIA.
E INV. 63.86m
NW INV. 63.86m
RIM ELEV. 67.37m
- MH 1 - 1200mm DIA.**
FRAME S25/COVER S24.1
NW INV. 65.07
NE INV. 64.93
SE INV. 64.93m
RIM ELEV. 66.50m
- MH 2 - 1200mm DIA.**
FRAME S25/COVER S24.1
SW INV. 65.35m
NW INV. 65.87m
SE INV. 64.72m
RIM ELEV. 67.15m
- MH 3 - 1800mm DIA.**
FRAME S25/COVER S24.1
NW INV. 64.37m
SW INV. 64.27m
RIM ELEV. 67.35m
- MH 4 - 1800mm DIA.**
FRAME S25/COVER S24.1
NE INV. 64.04
NW INV. 63.89m
SE INV. 63.89m
RIM ELEV. 67.42m
- MH 5 - 1200mm DIA.**
FRAME S25/COVER S24.1
NE INV. 63.91m
NW INV. 63.91m
SE INV. 63.91m
RIM ELEV. 67.28m
- MH 6 - 1200mm DIA.**
FRAME S25/COVER S24.1
NW INV. 64.10m
SE INV. 64.10m
RIM ELEV. 66.25m
- MH 7 - 1200mm DIA.**
FRAME S25/COVER S24.1
NE INV. 64.27
NE INV. 64.12
SE INV. 64.12
RIM ELEV. 65.70
- MH 8 - 1200mm DIA.**
FRAME S25/COVER S24.1
NE INV. 64.99m
RIM ELEV. 66.55m
- MH 9 - 1200mm DIA.**
FRAME S25/COVER S24.1
NW INV. 63.79m
SE INV. 63.79m
RIM ELEV. 67.20m
190mm ORIFICE PLATE ON DOWNSTREAM SEWER
- CB 10**
600x600mm COVER S19.1
SE INV. 64.35m
RIM ELEV. 65.55m
- CB 11**
600x600mm COVER S19.1
SE INV. 64.65m
RIM ELEV. 65.85m
- CB 12**
600x600mm COVER S19.1
SE INV. 65.20m
RIM ELEV. 66.40m
- CB 13**
600x600mm COVER S19.1
NE INV. 65.17m
S INV. 65.12m
RIM ELEV. 66.45m
- CB 14**
600x600mm COVER S19.1
SE INV. 65.20m
RIM ELEV. 66.40m
- CB 15**
600x600mm COVER S19.1
NE INV. 65.50m
RIM ELEV. 67.00m
- CB 16**
600x600mm COVER S19.1
NE INV. 65.90m
RIM ELEV. 67.10m
- CB 17**
600x600mm COVER S19.1
NE INV. 66.00m
RIM ELEV. 67.20m
- CB 18**
600x600mm COVER S19.1
NE INV. 66.00m
RIM ELEV. 67.20m
- CB 19**
600x600mm COVER S19.1
NE INV. 66.00m
RIM ELEV. 67.20m
- CB 20**
600x600mm COVER S19.1
NW INV. 66.95m
RIM ELEV. 67.15m
- CB 21**
600x600mm COVER S19.1
NW INV. 66.05m
RIM ELEV. 67.25m
- CB 22**
600x600mm COVER S19.1
NW INV. 65.90m
RIM ELEV. 67.00m
- CB 23**
600x600mm COVER S19.1
NW INV. 65.80m
RIM ELEV. 67.00m
- CB 24**
600x600mm COVER S19.1
NW INV. 67.70m
RIM ELEV. 66.40m

ALL EXISTING INVERTS TO BE FIELD CHECKED PRIOR TO CONSTRUCTION

ADS DETENTION SYSTEM BY OTHERS

FILENAME: C:\P\WORKING DIRECTORIES\PROJECTS\2021\1025-DMS\2021-1025-00-CIV-CONVING PLOTTED BY: STODCA, DORNA PLOT DATE: 2022-08-22 @ 11:52:03 AM PLOT SCALE: 1:1 SCALE: DILLON-SPRINGFIELD