

CONIFEROUS TREE PLANTING **DECIDUOUS TREE PLANTING**

Notes:
 1. All plant material incl. trees, shrubs, and perennials, as well as boulders, to be placed on site under the direction of the landscape architect. Minor adjustments to locations and layouts may be necessary to accommodate buried services, at grade structures, retaining walls, etc.. Locations of all trees and shrub bed outlines to be staked out/marked in field by landscape contractor for landscape architect's approval before installation.

2. Top 1/3rd of wire baskets and burlap used to hold the root ball and rope that is tied around the root collar are to be removed at the time of the planting of the trees. Trees planted too deep or too shallow, or without the baskets and rope removed, may be rejected at the time of the F1 inspection regardless of the length of time between the date of planting and the date of the inspection.

PLANTING NOTES:

1. Rootball volume of full-size coniferous street trees is 25 m3.
2. Rootball volume of small deciduous street trees is 20 m3.

Legend

- Existing trees to remain
- Existing trees to be removed
- Proposed deciduous tree
- Proposed coniferous tree
- Proposed perennials
- Asphalt
- Concrete

PLANT LIST						
KEY	QNTY.	BOTANIC NAME	COMMON NAME	SIZE	CONDIT.	REMARKS
PG	3	Picea pungens glauca	Blue Colorado Spruce	2.75 m Ht	B & B	see plan
QR	6	Quercus rubra	Red Oak	70 mm ø	B & B	see plan
QM	2	Quercus macrocarpa	Burr Oak	70 mm ø	B & B	see plan
AS	5	Acer saccharum	Sugar Maple	70 mm ø	B & B	see plan
AR	2	Acer rubrum	Red Maple	70 mm ø	B & B	see plan
RF	150	Rudbeckia fulgida	Blackeyed Susan	2 yr. old	2 yr. old	see plan
NF	65	Nepeta faassenii	Walker's Low Catmint	2 yr. old	Container	see plan

NOTE:

1. Landscape Contractor must advise Project Landscape Architect of the start of construction min. 48 hours by email prior to commencement of work, and obtain approval for planting and paving layouts before installation.
2. Landscape Contractor must keep up-to-date record of all changes to landscape installations, including planting, paving and site furniture placement.
3. Landscape Contractor should adhere closely to organic and geometric layouts as shown on landscape plan to ensure optimum placing, spacing and display of plantings.
4. Landscape Contractor to use discretion and judgement and reject trees or plants on site which do not meet minimum size, shape and branch growth criteria as specified on this drawing.
5. Wire baskets and burlap used to hold the root ball and rope that is tied around the root collar are to be removed at the time of the planting of the trees. Trees planted too deep or too shallow, or without the baskets and rope removed, may be rejected at the time of the F1 inspection regardless of the length of time between the date of planting and the date of the inspection.
6. All deciduous street trees to be planted 0.6 m away from property line and 1.5 m away from any adjacent driveway. coniferous trees to be planted on private property and set back as necessary to avoid conflicts sightlines, especially at daylight triangles.
7. Locations and configurations of driveway and unit footprints are schematic only.
8. Adjust tree locations on site in accordance with utility and easement locations.
9. Before installing, establish correct locations of plant material and fencing on site by checking locations of access easements and other minimum clearances. refer to the site plan, survey plan and engineering drawings prepared by others.
10. Final locations of trees to be adjusted in accordance with building and driveway locations on site.

EXISTING TREE PROTECTION MEASURES

- * Erect a fence at the critical root zone (CRZ) of trees, where CRZ is calculated as the distance equal to 10 x Diameter at Breast Height (DBH) of the tree;
- * Do not place any material or equipment within the CRZ of the tree;
- * Do not attach any signs, notices or posters to any tree;
- * Do not raise or lower the existing grade within the CRZ without approval;
- * Tunnel or bore when digging within the CRZ of a tree;
- * Do not damage the root system, trunk or branches of any tree;
- * Ensure that exhaust fumes from all equipment are NOT directed towards any tree's canopy.

NOTES:

GENERAL

1. DO NOT SCALE THIS DRAWING.
2. THIS DRAWING IS TO BE READ IN CONJUNCTION WITH RELATED ARCHITECTURAL/ENGINEERING DRAWINGS.
3. IT IS THE RESPONSIBILITY OF THE APPROPRIATE CONTRACTOR TO CHECK AND VERIFY ALL DIMENSIONS ON SITE AND REPORT ALL ERRORS AND/OR OMISSIONS TO THE LANDSCAPE ARCHITECT BEFORE PROCEEDING WITH WORK.
4. CONTRACTOR MUST OBTAIN AND COMPLY WITH ALL PERTINENT CODES AND BYLAWS. ALL PERMITS ARE THE RESPONSIBILITY OF THE CONTRACTOR.
5. THIS DRAWING MUST NOT BE USED FOR CONSTRUCTION UNLESS SIGNED BY THE LANDSCAPE ARCHITECT.
6. COPYRIGHT RESERVED THIS DRAWING IS THE EXCLUSIVE PROPERTY OF THAKAR ASSOCIATES DESIGN CONSULTANTS AND SHALL NOT BE USED FOR ANY PURPOSE WHATSOEVER WITHOUT WRITTEN CONSENT. GRAPHIC SYMBOLS, DETAILS AND FORMATS USED ON THIS DRAWING ARE COPYRIGHTED AND MAY NOT BE COPIED, ADAPTED OR REPRODUCED IN ANY FORM WITHOUT THE WRITTEN CONSENT OF THAKAR ASSOCIATES.
7. CONTRACTOR SHALL NOTIFY LANDSCAPE ARCHITECT BY PHONE AND FAX AT LEAST 24 HOURS IN ADVANCE OF THE COMMENCEMENT OF DEMOLITION WORK, REMOVAL OF EXISTING VEGETATION AND THE START OF NEW CONSTRUCTION.
8. BASE INFORMATION TAKEN FROM DRAWINGS PROVIDED BY MALLOT CREEK GROUP ARCHITECTS.

PLANTING/SODDING/FENCING

1. THE CONTRACTOR IS TO VERIFY THE LOCATION OF ALL UNDERGROUND UTILITIES PRIOR TO COMMENCING WORK. PLANTING WHICH CONFLICTS WITH UNDERGROUND UTILITIES IS TO BE RELOCATED AT THE DIRECTION OF THE LANDSCAPE ARCHITECT.
2. ALL STREETSCAPE TREES EXCEPT CONIFERS ARE TO BE LOCATED WITHIN THE MUNICIPAL BOUNDARY AT A DISTANCE OF 0.6M FROM THE PROPERTY LINE.
3. NO PLANT MATERIALS/SUBSTITUTIONS WILL BE ACCEPTED WITHOUT PRIOR APPROVAL FROM THE LANDSCAPE ARCHITECT.
4. ALL PLANT MATERIAL IS TO BE NURSERY GROWN STOCK AND SHALL MEET OR EXCEED THE SPECIFICATIONS OF THE CANADIAN NURSERY TRADES ASSOCIATION (1995) FOR SIZE, HEIGHT, SPREAD, GRADE AND METHOD OF CULTIVATION.
5. ALL EXCAVATED MATERIAL FROM PLANTING PITS TO BE REMOVED FROM SITE. BACKFILL PLANTING INSTALLATIONS WITH IMPORTED PREPARED TOPSOIL OR STOCKPILED TOPSOIL ON SITE, SUBJECT TO LANDSCAPE ARCHITECT'S APPROVAL.
6. SODDING AND SEEDING TO BE INSTALLED ON MINIMUM 150 MM AND 150 MM DEEP LAYERS RESPECTIVELY OF PREPARED IMPORTED TOPSOIL.
7. ALL SHRUBS TO BE INSTALLED IN BEDS (EXCEPT ON SLOPES) WITH MINIMUM DEPTH OF 500 MM AND MULCHED WITH 75 MM MINIMUM LAYER OF SHREDDED PINE BARK MULCH UNLESS OTHERWISE SPECIFIED.
8. ALL TREES TO BE STAKED ACCORDING TO THE STANDARDS INDICATED ON THE PLANTING DETAILS.
9. ALL AREAS DISTURBED DURING CONSTRUCTION, BEYOND THE PROJECT LIMITS, ARE TO BE REINSTATED TO ORIGINAL CONDITIONS AT NO ADDITIONAL EXPENSE.
10. ALL PLANT MATERIAL AND GRASS AREAS INSTALLED UNDER THIS CONTRACT SHALL BE WATERED, WEEDED AND MAINTAINED BY THE CONTRACTOR UNTIL WRITTEN ACCEPTANCE OF THE WORK BY THE LANDSCAPE ARCHITECT.
11. ALL FENCING IS TO BE INSTALLED 0.3M INSIDE PRIVATE PROPERTY PARALLEL TO THE PROPERTY LINE UNLESS OTHERWISE INDICATED.

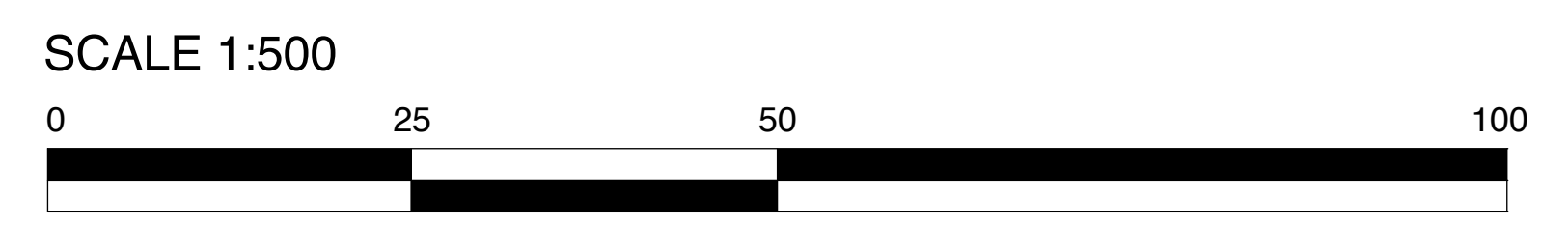
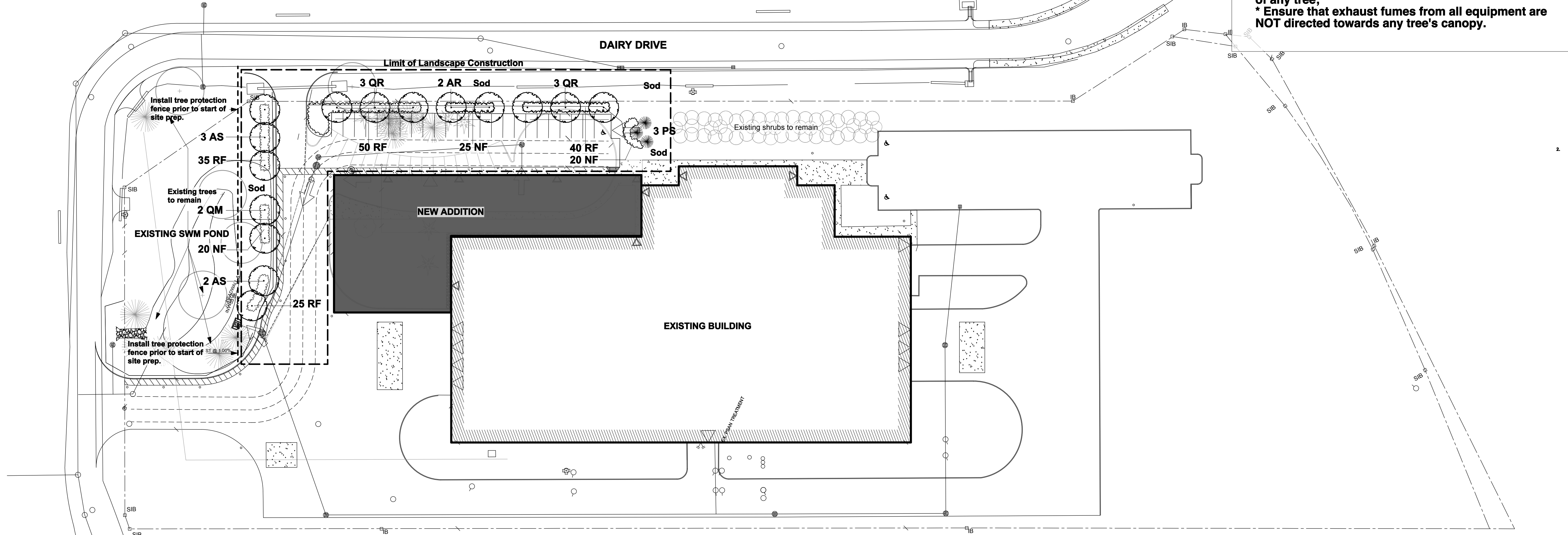

No.	Revision	Date
1.	Site Plan Re-submission	Aug 1997
2.	Site Plan Re-submission	Sept 1997
3.	Client Review	Aug 1997

North

Stamp: LANDSCAPE ARCHITECT, THAKAR ASSOCIATES DESIGN CONSULTANTS, Ottawa, Ontario

apetito HFS
 1010 Dairy Dr.
 Ottawa

Proposed Building Expansion
 1010 Dairy Dr.
 Ottawa

LANDSCAPE PLAN

Drawn: ST	Scale: 1:500	Sheet No: L - 1
Date: 305.1		