

WATERMAIN NOTES

- CONSTRUCT ALL WATERMANS AND APPURTENANCES IN ACCORDANCE WITH OPSD STANDARDS AND SPECIFICATIONS, AS WELL AS CITY STANDARDS.
- WATERMANS AND/OR WATER SERVICES ARE TO HAVE A MINIMUM COVER OF 2.4m. OTHERWISE THERMAL INSULATION IS REQUIRED AS PER CITY STANDARDS (IF AVAILABLE) OR OPSD 1109.030.
- IF THE WATERMAIN MUST BE DEFLECTED TO MEET ALIGNMENT, ENSURE THAT THE AMOUNT OF DEFLECTION USED IS EQUAL TO OR LESS THAN THAT WHICH IS RECOMMENDED BY THE MANUFACTURER.
- THERMAL INSULATION OF WATERMANS AT OPEN STRUCTURES AS PER CITY STANDARDS (IF AVAILABLE) OR OPSD 1109.030.
- VALVES TO BE OPERATED BY CITY STAFF ONLY.
- NO CONNECTION TO EXISTING WATER NETWORK SHALL BE COMPLETED UNTIL A WATER PERMIT IS OBTAINED FROM THE CITY. CITY TO BE PRESENT FOR WATERMAIN CONNECTION. CONNECTION, EXCAVATION, BACKFILLING AND REINSTATEMENT TO BE COMPLETED BY CONTRACTOR.
- IT WILL BE THE RESPONSIBILITY OF THE CONTRACTOR TO PERFORM ANY WATERMAIN CONNECTION(S) REQUIRED. THIS SHALL BE COMPLETED IN THE PRESENCE OF A DESIGNATED MUNICIPAL WATER OPERATOR AND THE SELECTED CONTRACTOR SHALL PROVE TO THE SATISFACTION OF THE CITY THAT THEY ARE COMPETENT TO PERFORM THE WORKS PRIOR TO INITIATING CONSTRUCTION.
- CONCRETE THRUST BLOCKS TO CONFORM TO OPSD 1103.010 AND OPSD 1103.020.
- ALL WATERMAIN TO BE CLASS 150 DR-18 OR APPROVED EQUIVALENT.
- ALL WATERMAIN TO BE EQUIPPED WITH TRACER WIRE.

GENERAL NOTES

- THE ORIGINAL TOPOGRAPHY, GROUND ELEVATION AND SURVEY DATA SHOWN ARE SUPPLIED FOR INFORMATION PURPOSES ONLY, AND IMPLY NO GUARANTEE OF ACCURACY. IT SHALL BE THE RESPONSIBILITY OF THE CONTRACTOR TO VERIFY ALL INFORMATION SHOWN.
- THIS PLAN IS NOT A CADASTRAL SURVEY SHOWING LEGAL PROPERTY BOUNDARIES AND EASEMENTS. THE PROPERTY BOUNDARIES SHOWN HEREIN HAVE BEEN DERIVED FROM INFORMATION SUPPLIED BY ANNIS O'SULLIVAN VOLLEBEK LTD (OR SHOWN ON) DRAWING V-22629 AND CANNOT BE RELIED UPON TO BE ACCURATE OR COMPLETE. THE PRECISE LOCATION OF THE CURRENT PROPERTY BOUNDARIES AND EASEMENTS CAN ONLY BE DETERMINED BY AN UP-TO-DATE LAND TITLES SEARCH AND A SUBSEQUENT CADASTRAL SURVEY PERFORMED AND CERTIFIED BY AN ONTARIO LAND SURVEYOR.
- THE CONTRACTOR IS TO OBTAIN AND PAY FOR ALL NECESSARY PERMITS AND APPROVALS FROM THE CITY BEFORE COMMENCING CONSTRUCTION.
- THE CONTRACTOR IS RESPONSIBLE FOR ALL LAAYOUT.
- THE CONTRACTOR IS TO DETERMINE THE EXACT LOCATION, SIZE, MATERIAL AND ELEVATION OF ALL EXISTING UTILITIES PRIOR TO COMMENCING CONSTRUCTION. PROTECT AND ASSUME ALL RESPONSIBILITY FOR EXISTING UTILITIES WHETHER OR NOT SHOWN ON THESE DRAWINGS. IF THERE IS ANY DISCREPANCY THE CONTRACTOR IS TO NOTIFY THE ENGINEER PROMPTLY.
- RESTORE ALL TRENCHES AND SURFACES OF PUBLIC ROAD ALLOWANCES TO CONDITION EQUAL OR BETTER THAN ORIGINAL CONDITION AND TO THE SATISFACTION OF THE CITY AUTHORITIES.
- EXCAVATE AND DISPOSE OF ALL EXCESS EXCAVATED MATERIAL, SUCH AS ASPHALT, CURBING AND DEBRIS, OFF SITE AS DIRECTED BY THE ENGINEER AND THE CITY.
- TOPSOIL TO BE STRIPPED AND STOCKPILED FOR REHABILITATION. CLEAN FILL TO BE PLACED IN FILL AREAS AND COMPACTED TO 95% STANDARD PROCTOR DENSITY.
- ALL DISTURBED AREAS TO BE RESTORED TO ORIGINAL CONDITION OR BETTER UNLESS OTHERWISE SPECIFIED.
- THE CONTRACTOR SHALL BE RESPONSIBLE FOR ALL TRAFFIC CONTROL AND SAFETY MEASURES DURING THE CONSTRUCTION PERIOD, INCLUDING THE SUPPLY, INSTALLATION, AND REMOVAL OF ALL NECESSARY SIGNAGE, DELINEATORS, MARKERS AND BARRIERS.
- DO NOT ALTER GRADING OF THE SITE WITHOUT PRIOR APPROVAL OF THE ENGINEER/CITY.
- ALL ROADWAY PARKING LOT, AND GRADING WORKS TO BE UNDERTAKEN IN ACCORDANCE WITH CITY STANDARDS AND SPECIFICATIONS. THE CONTRACTOR IS TO PROVIDE POSITIVE DRAINAGE AWAY FROM THE BUILDING.
- CONTACT THE CITY FOR INSPECTION OF ROUGH GRADING OF PARKING LOTS, ROADWAYS AND LANDSCAPED AREAS PRIOR TO PLACEMENT OF ASPHALT AND TOPSOIL. ALL DEFICIENCIES NOTED SHALL BE RECTIFIED TO THE CITY'S SATISFACTION PRIOR TO PLACEMENT OF ANY ASPHALT, TOPSOIL, SEED & MULCH AND/OR SOD.
- ALL DIMENSIONS AND INVERTS MUST BE VERIFIED PRIOR TO CONSTRUCTION. IF THERE IS ANY DISCREPANCY THE CONTRACTOR IS TO NOTIFY THE ENGINEER PROMPTLY.
- ELECTRICAL, GAS, TELEPHONE AND TELEVISION SERVICE LOCATIONS ARE SUBJECT TO THE INDIVIDUAL AGENCY:
 - ELECTRICAL SERVICE - HYDRO ONE,
 - GAS SERVICE - ENBRIDGE,
 - TELEPHONE SERVICE - BELL CANADA,
 - TELEVISION SERVICE - ROGERS.
- INSTALLATION TO BE IN ACCORDANCE WITH CURRENT CODES AND STANDARDS OF APPROVAL AGENCIES HYDRO ONE, BELL AND THE CITY.
- CONTRACTOR TO ENSURE ALL APPLICABLE OPS SPECIFICATIONS ARE FOLLOWED DURING CONSTRUCTION.
- ALL PROPOSED CURB TO BE CONCRETE BARRIER CURB UNLESS OTHERWISE SPECIFIED.

SEWER NOTES:

- CONSTRUCT ALL SEWERS, CATCH BASINS, MANHOLES AND APPURTENANCES IN ACCORDANCE WITH OPSD STANDARDS AND SPECIFICATIONS, AS WELL AS CITY.
- SEWER TRENCHING AND BEDDING SHALL CONFORM TO OPSD 802.010 AND 802.013 UNLESS NOTED OTHERWISE.
 - BEDDING SHALL BE A MINIMUM 150mm OF GRANULAR "A", COMPACTED TO MINIMUM 95% STANDARD PROCTOR DRY DENSITY. CLEAR STONE BEDDING SHALL NOT BE PERMITTED.
 - SUB-BEDDING, IF REQUIRED SHALL CONSIST OF 450mm OF COMPACTED GRANULAR "B" TYPE 1.
 - BACKFILL TO AT LEAST 300mm ABOVE TOP OF PIPE WITH GRANULAR "A" OR GRANULAR "B" TYPE 1.
 - TO MINIMIZE DIFFERENTIAL FROST HEAVING, TRENCH BACKFILL (FROM PAVEMENT SUBGRADE TO 2.0 METRES BELOW FINISHED GRADE) SHALL MATCH EXISTING SOIL CONDITIONS.
- SANITARY SEWERS AND CONNECTIONS 150mmØ AND SMALLER TO BE PVC SDR-28.
- SEWERS AND CONNECTIONS 200mmØ AND LARGER TO BE PVC SDR-35. BEDDING TO BE TYPE "B" EXCEPT AT RISERS, UNLESS NOTED OTHERWISE.
- INSULATE ALL STORM AND SANITARY SEWERS/SERVICES THAT HAVE LESS THAN 2.0m OF COVER WITH THERMAL INSULATION AS PER OPSD 1109.030.
- SEWER CONNECTIONS ARE TO BE MADE ABOVE THE SPRINGLINE OF THE SEWERMAIN AS PER CITY OF OTTAWA STANDARD DRAWING S11, S11.1 & S11.2.
- SUPPLY AND INSTALL ALL PIPING AND APPURTENANCES AS SHOWN AND DETAILED TO WITHIN 1.0m OF BUILDING. ALL ENDS OF PIPING TO BE PROPERLY CAPPED AND LOCATED WITH 2"x4"x8" LONG MARKER.
- CONTRACTOR TO TELEWISE (CCTV) ALL PROPOSED SEWERS ON SITE, OUTLET CONNECTION TO THE MAIN AND PIPES 150mmØ OR GREATER PRIOR TO BASE COURSE ASPHALT. UPON COMPLETION OF CONTRACT, THE CONTRACTOR IS RESPONSIBLE TO FRESH AND CLEAN ALL SEWERS & APPURTENANCES.
- DYE TESTING IS TO BE COMPLETED ON SANITARY SERVICE TO CONFIRM PROPER CONNECTION TO SANITARY SEWER MAIN.

" AVIATION PARKWAY " EAST HALF OF LOT 25 PIN 04269 - 0787 part 1 plan 5r - 252

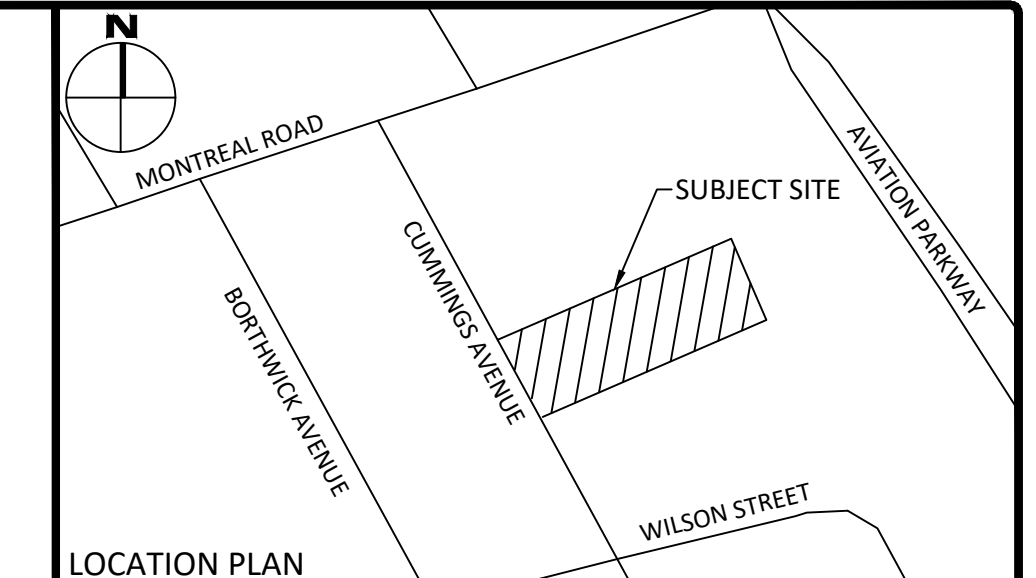
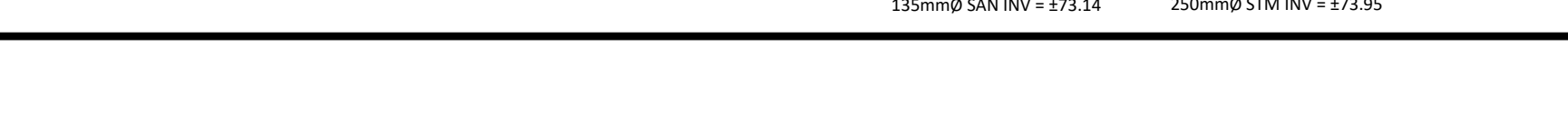
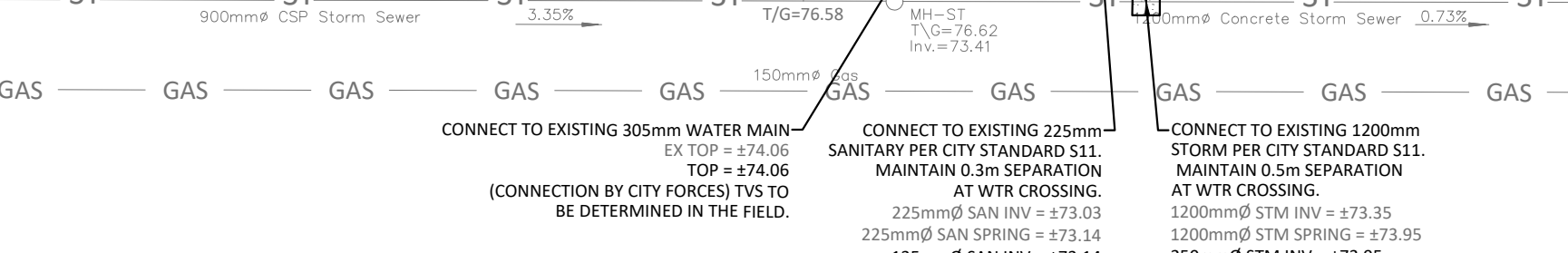
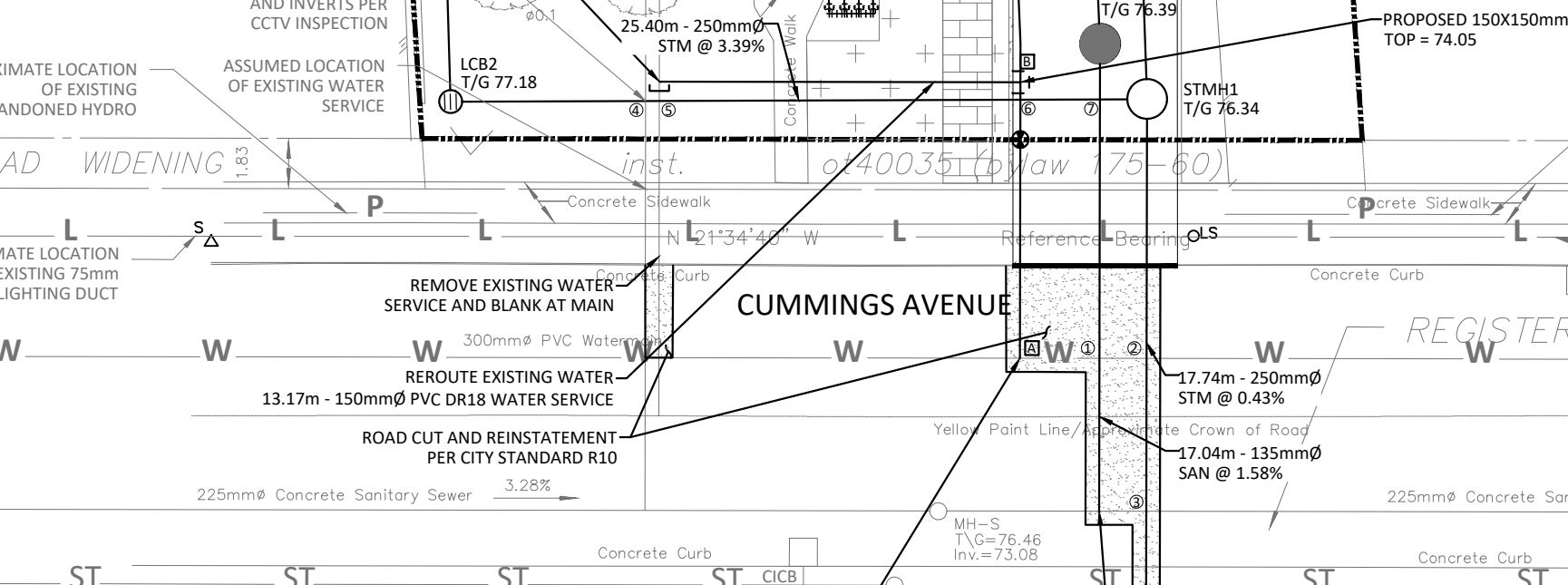
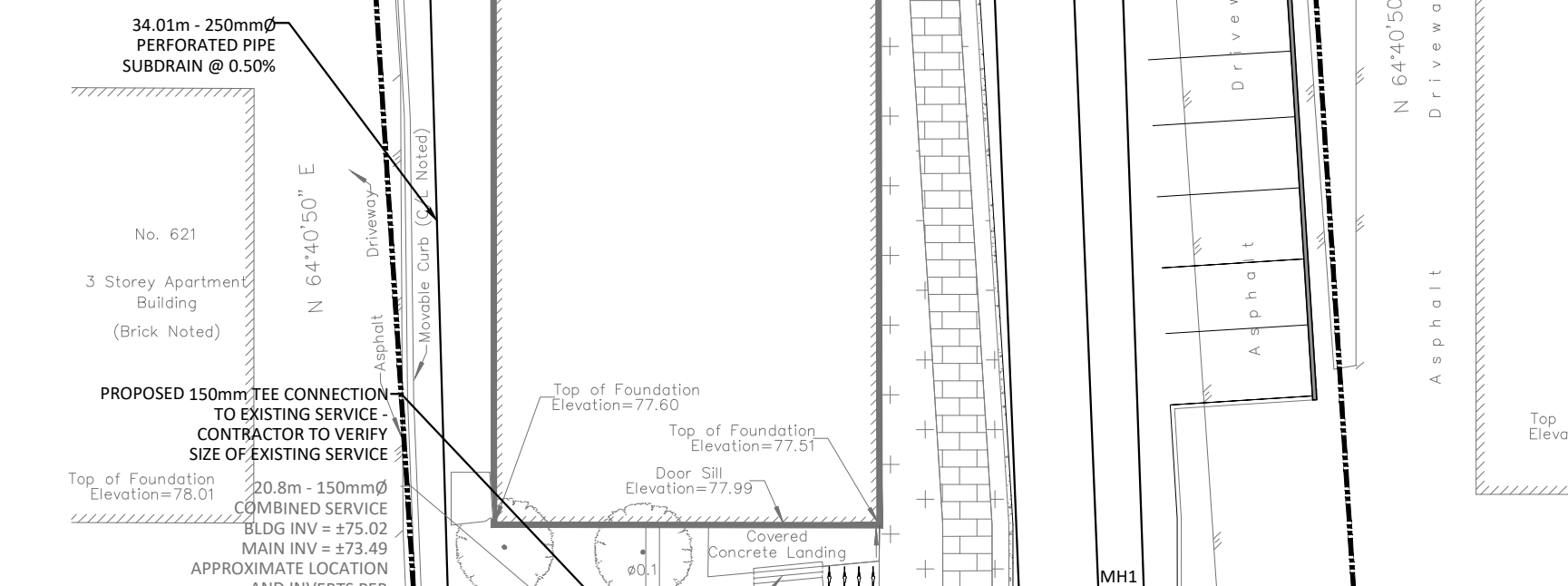
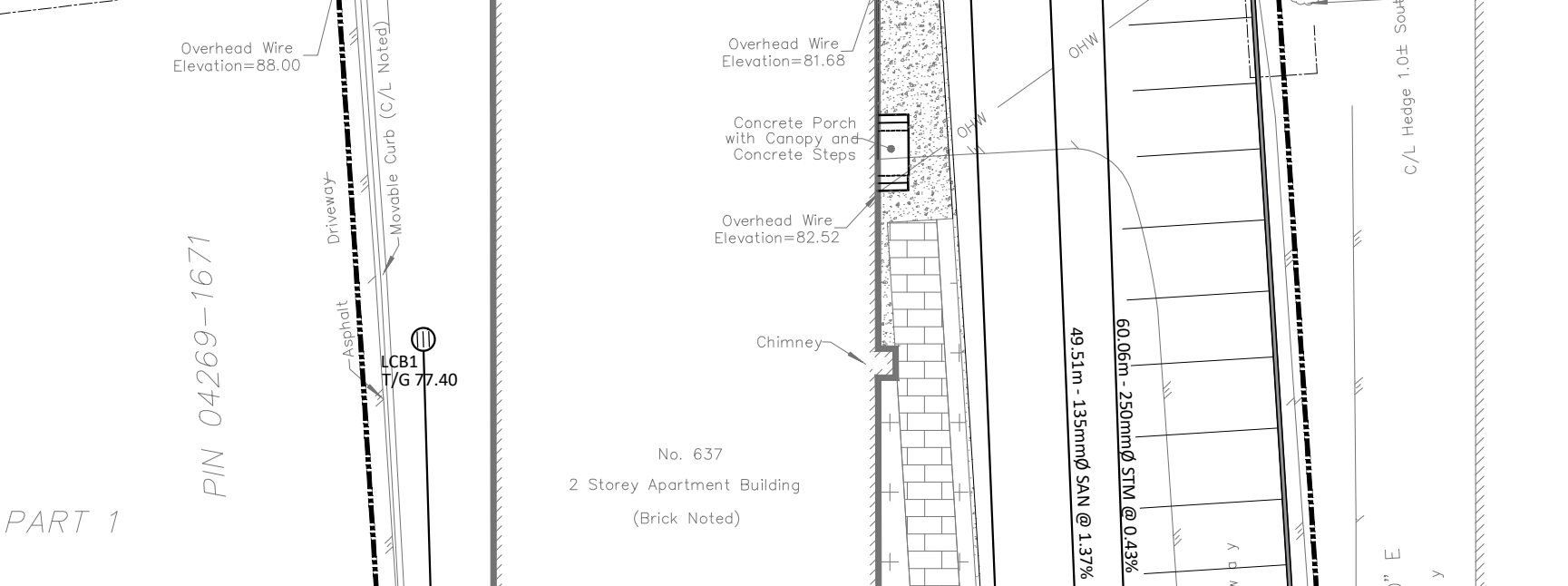
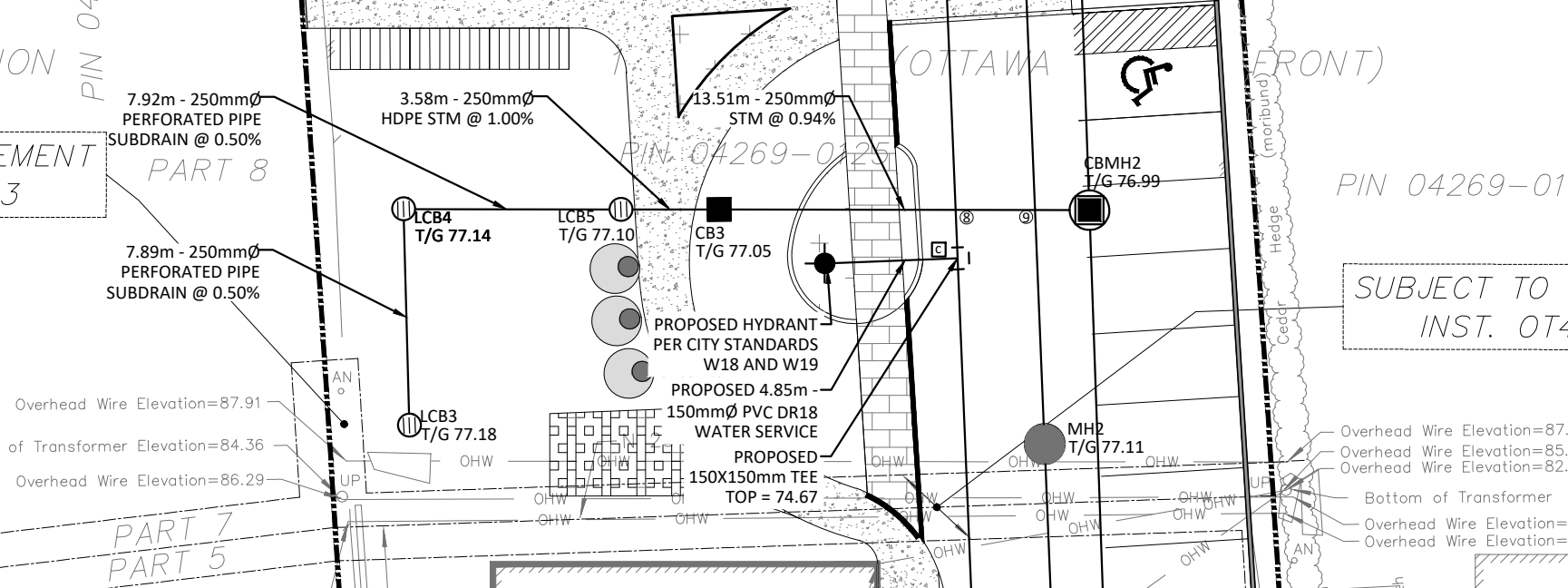
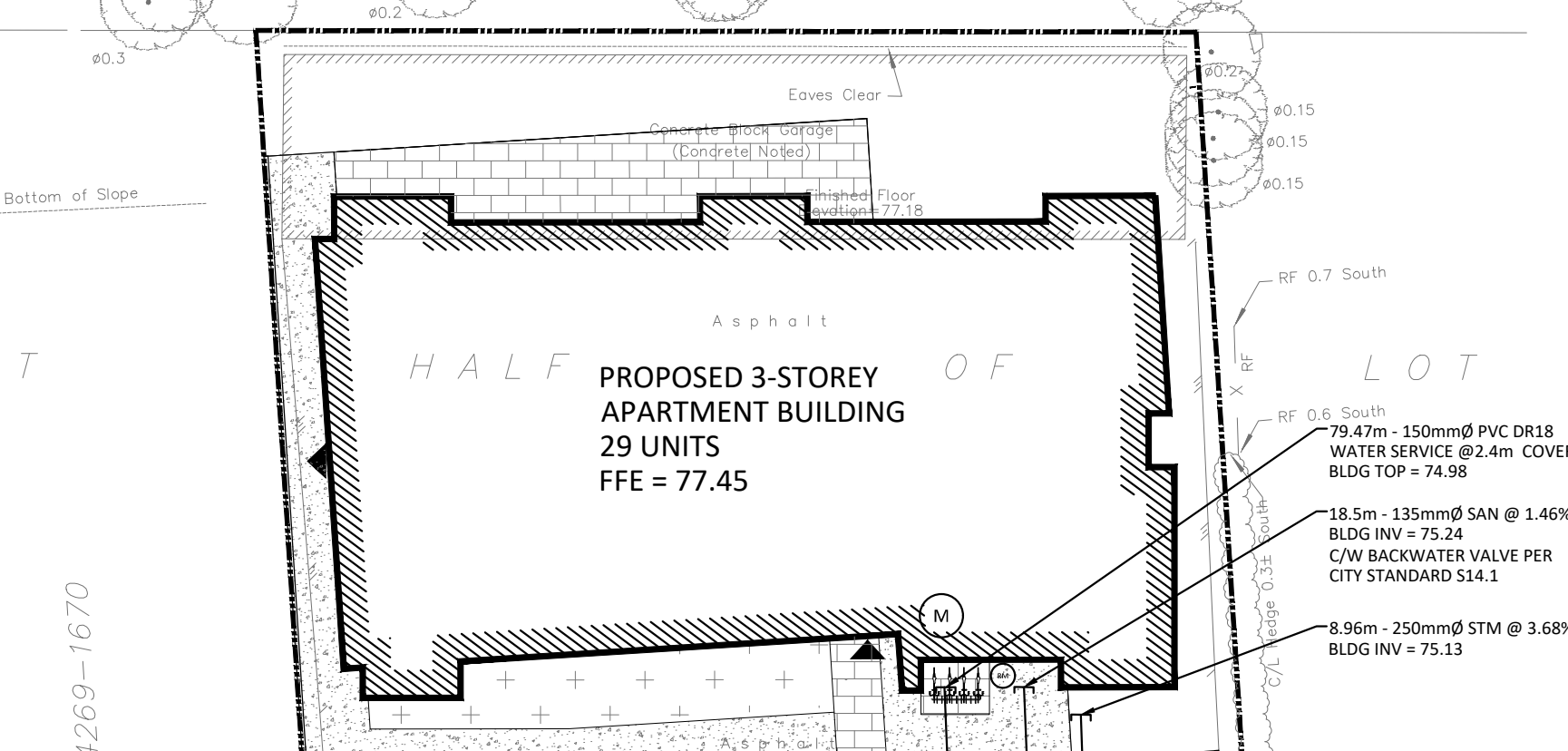
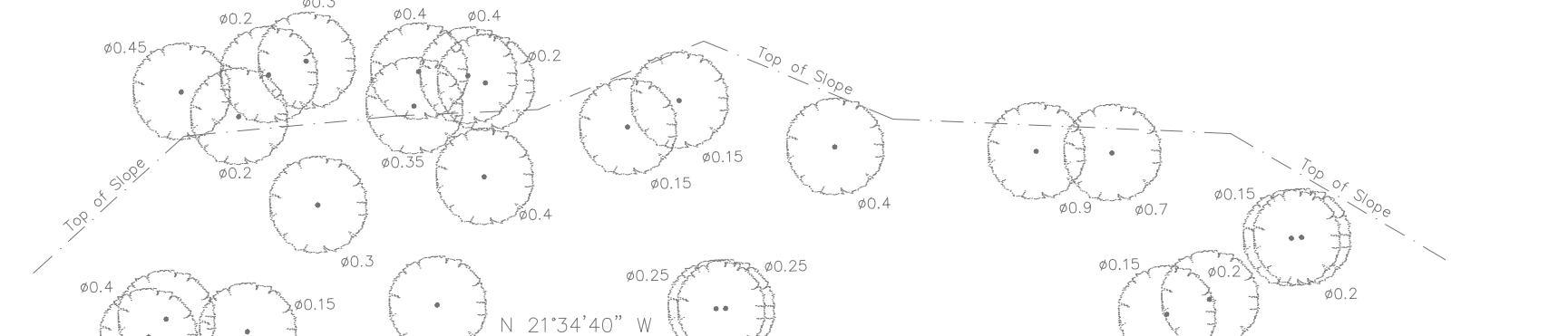

LEGEND

CONCRETE BARRIER CURB	LIMIT OF CONSTRUCTION
CONCRETE WALKWAY	DRAINAGE SWALE
PROPOSED ASPHALT	DRAINAGE DITCH
LANDSCAPING CATCHBASIN	SLOPING AT 3:1 UNLESS SPECIFIED
CATCHBASIN MANHOLE	95.50 SURFACE ELEVATION
CATCHBASIN	95.50 (S) TOP OF WALL ELEVATION
SANITARY SEWER MANHOLE	7/W/95.50 BOTTOM OF WALL ELEVATION
FIRE HYDRANT	OVERLAND FLOW ROUTE
WATER VALVE	SILT FENCE BARRIER
WATER METER	STRAW BALE CHECK DAM
REMOTE WATER METER	MUD MAT
	PAVERS

WATER COVER TABLE

LOCATION	STATION	FINISHED GRADE	TOP OF PIPE	COVER
A - 300 X 150 TEE	0+100.00	76.41	74.06	2.35
VALVE	0+107.97	76.43	74.03	2.40
150 X 150 TEE	0+110.06	76.45	74.05	2.40
150 X 150 TEE	0+167.75	77.07	74.67	2.40
BUILDING	0+179.47	77.38	74.98	2.40
B - 150 X 150 TEE	0+200.00	76.45	74.05	2.40
TEE CONNECTION TO EXISTING SERVICE	0+213.17	77.24	74.84	2.40
C - 150 X 150 TEE	0+300.00	77.07	74.67	2.40
HYDRANT PER W18 & W19	0+304.85	77.21	74.81	2.40

CROSSING CONFLICT TABLE

LOCATION	DESCRIPTION	SEPARATION
1	135mmØ SAN SERVICE OBV 73.36	0.30
2	305mmØ WTR MAIN OBV 73.66	0.50
3	250mmØ STM SERVICE INV 74.45	1.19
4	305mmØ WTR MAIN OBV 73.95	1.22
5	250mmØ STM SERVICE INV 74.43	0.65
6	250mmØ STM SERVICE INV 75.40	1.41
7	250mmØ STM SERVICE INV 75.45	1.88
8	135mmØ SAN SERVICE OBV 73.52	0.77
9	250mmØ WTR SERVICE OBV 74.68	0.31
	250mmØ STM SERVICE INV 75.43	
	135mmØ SAN SERVICE OBV 75.12	

STM STRUCTURE TABLE

NAME	RIM ELEV.	INVERT IN	INVERT OUT	DESCRIPTION
CB3	77.05	N76.009	S75.550	STRUC: OPSD 705.010 FRAME: CITY S19 COVER: CITY S19
CBMH2	76.99	NE74.800 N75.422	SW74.770	STRUC: OPSD 701.010 FRAME: CITY S25 COVER: CITY S28.1
LCB1	77.40		SW76.400	PER CITY STANDARD S31
LCB2	77.18	NE76.230	S76.200	PER CITY STANDARD S30
LCB3	77.18		NE76.180	PER CITY STANDARD S30
LCB4	77.14	SW76.141	S76.110	PER CITY STANDARD S30
LCB5	77.10	N76.070	S76.045	PER CITY STANDARD S30
STMH1	76.34	NE74.510 N75.340	W74.490	STRUC: OPSD 701.010 FRAME: CITY S25 COVER: CITY S24.1

SAN STRUCTURE TABLE

NAME	RIM ELEV.	INVERT IN	INVERT OUT	DESCRIPTION
MH1	76.39	NE74.260	W73.410	STRUC: OPSD 701.010 FRAME: CITY S25 COVER: CITY S24
MH2	77.11	NE74.970	SW74.940	STRUC: OPSD 701.010 FRAME: CITY S25 COVER: CITY S24

FOR REVIEW ONLY
NOT FOR CONSTRUCTION

1	ISSUED FOR MUNICIPAL REVIEW	AUG. 29, 2022
No.	Revisions	Date

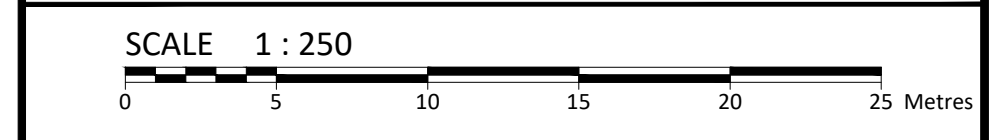

McINTOSH PERRY
115 Walgreen Road, RR3, Carp, ON K0A 1L0
Tel: 613-836-2184 Fax: 613-836-3742
www.mcintoshperry.com

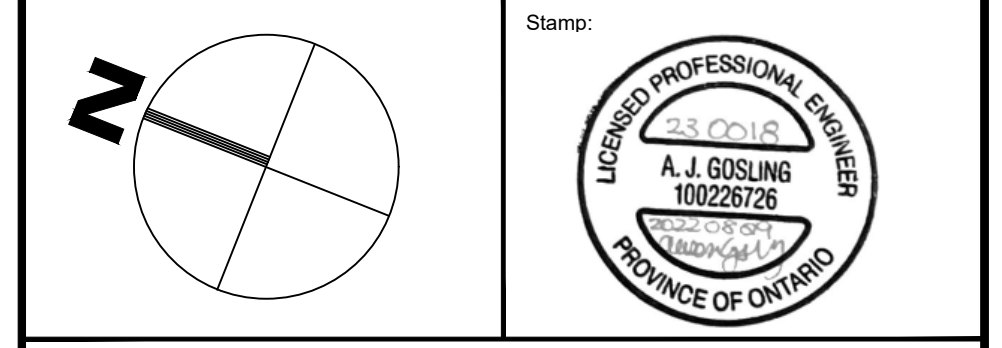

Client: **JAWAN PROPERTIES INC.**
200 SKIPPER DRIVE
MANOTICK, ON K4M 0M5

Project: **637 CUMMINGS AVE**

Drawing Title: **SITE SERVICING PLAN**

Scale: 1:250	Project Number: CCO-23-0018
Drawn By: FV	Checked By: AG
Designed By: AG	Drawing Number: C102

FILENAME: I:\CHAWW\01 Project - Proposed 2023\06\CCO-23-0018 Main Project\Apartment_637 Cumming_07 Cumming_07 CCO-23-0018_Presentation.dwg
 LAST SAVED: Monday, August 29, 2022 1:52:54 PM
 USER: JAWAN
 PLOT DATE: Monday, August 29, 2022 1:52:54 PM
 PLOT BY: JAWAN

D07-12-XX-XXXX

#XXXX