

NOTES:

GENERAL:

- GOVERNING CODE: ONTARIO BUILDING CODE 2012.
- ALL DIMENSIONS AND DETAILS GIVEN ON STRUCTURAL DRAWINGS MUST BE CHECKED WITH THE OTHER DISCIPLINES INVOLVED; ANY INCONSISTENCY MUST BE REPORTED TO THE STRUCTURAL ENGINEER BEFORE PROCEEDING WITH THE WORK.
- THESE DRAWINGS TO BE READ IN CONJUNCTION WITH THE RELEVANT SITE AND GRADING PLANS.
- DRAWINGS MUST NOT BE SCALED.
- ALL CONSTRUCTION, SHORING, DETAILING, EXCAVATIONS, ETC. MUST BE AS PER LATEST NATIONAL BUILDING CODE, OCCUPATIONAL HEALTH AND SAFETY ACT AND REGULATIONS FOR CONSTRUCTION PROJECTS. GENERAL CONTRACTOR WILL BE RESPONSIBLE FOR ALL COSTS ASSOCIATED WITH TEMPORARY WORKS.
- SUFFICIENT TEMPORARY BRACING SHALL BE PROVIDED TO KEEP THE WALL FORMS AND ALL SHORING SAFE, PLUMB, AND IN TRUE ALIGNMENT DURING CONSTRUCTION.
- WORK DONE BY SUB-CONTRACTORS WILL BE THE RESPONSIBILITY OF GENERAL CONTRACTOR.

SOILS/FOUNDATIONS:

- OVER EXCAVATED LEVELS AT FOUNDATIONS TO BE BACKFILLED WITH LEAN CONCRETE UNLESS OTHERWISE APPROVED.
- ALL FOOTINGS SHALL BE FOUNDED ON NATIVE SOIL OR PROPERLY COMPACTED ENGINEERED FILL WITH A MINIMUM ALLOWABLE BEARING CAPACITY OF 90 kPa; IN THE CASE OF A LOWER BEARING CAPACITY, CONTACT STRUCTURAL ENGINEER TO REDESIGN THE FOOTINGS.
- ALL FOOTINGS SHALL BE FOUNDED A MINIMUM OF 1.8m (5'-10") BELOW FINISHED GRADE UNLESS NOTED OTHERWISE.

- FOUNDATION AND EXCAVATION SUBJECT TO FROST DURING CONSTRUCTION SHALL BE ADEQUATELY PROTECTED.
- EXCAVATION SHALL BE KEPT FREE OF WATER.
- COORDINATE WITH GEOTECHNICAL CONSULTANT FOR GEOTECHNICAL REPORT AND GEOTECHNICAL RELATED MATTERS.
- EXCAVATION SLOPES TO BE MAINTAINED AS PER GEOTECHNICAL REPORT OR GEOTECHNICAL ENGINEER'S ADVICE.
- IN THE EVENT OF WATER FOUNDED DURING FOUNDATION EXCAVATION NOT NOTED IN GEOTECHNICAL STUDY, REPORT TO GEOTECHNICAL & STRUCTURAL ENGINEERS RIGHT AWAY FOR THEIR ADVICE.
- FOUNDING SOIL SHALL BE INSPECTED AND APPROVED BY SOIL CONSULTANT PRIOR TO PLACING CONCRETE.
- ALL SLAB-ON-GRADE SHALL BE CONSTRUCTED ON GRANULAR MATERIAL COMPACTED TO 98% SPDD AND TO BE APPROVED BY SOIL CONSULTANT.
- EXCAVATION SLOPES ARE NOT TO EXCEED 7V:10H UNLESS DIRECTED OTHERWISE BY GEOTECHNICAL ENGINEER.

REINFORCED AND PLAIN CONCRETE:

- CONCRETE AND REINFORCEMENT INSTALLATION TO CONFORM TO CSA A231-14, A232-14 AND A234-14.
- CONCRETE STRENGTH TO BE 25 MPa AT 28 DAYS FOR FOOTINGS AND WALLS, EXPOSURE CLASS F2.
- MAX W/C TO BE 0.4; MAX AGGREGATE SIZE 20MM.
- REINFORCING BARS TO CONFORM TO CAN CSA G30.18-M92(R2002) LATEST EDITION.
- F_y FOR REINFORCING BARS: 400 MPa.
- CONCRETE COVER SHALL BE AS INDICATED IN TABLE 4, AS PER CAN/CSA A23.1 TABLE 17.
- NO OPENING, PENETRATION OR SLEEVE THROUGH STRUCTURAL ELEMENTS SHALL BE INSTALLED UNLESS APPROVED BY STRUCTURAL ENGINEER OR SHOWN ON STRUCTURAL DRAWINGS.
- CURING OF CONCRETE SHALL BE DONE ACCORDING TO CAN/CSA A23.1 §7.4.2 AND LAST 3 DAYS MINIMUM.
- KEEP FORMS UNSTRIPPED FOR 2 DAYS MINIMUM AFTER PLACING CONCRETE.

- CONCRETE TO BE PROTECTED FROM EXCESSIVE HEAT AND COLD; REFER TO COLD AND HOT WEATHER PROTECTION PROCEDURES.
- DO NOT BACKFILL NEAR SLAB AND WALLS BEFORE 7 DAYS AFTER POURING CONCRETE.
- REINFORCING BARS IN FOOTINGS AND SLABS CAST DIRECTLY OVER EARTH, AND CONCRETE MEMBERS EXPOSED TO WEATHER FOR ARCHITECTURAL REASONS, SHALL BE SUPPORTED DIN DESIGNATED POSITION BY MEANS OF PRECAST CONCRETE SUPPORTS OR EQUIVALENT.
- ALL CONCRETE TO BE VIBRATED THOROUGHLY DURING PLACEMENT.
- PROVIDE CONTROL JOINT AT OUTSIDE FACE OF FOUNDATION WALL AT 914mm (30") c/c, UNLESS NOTED OTHERWISE.
- PROVIDE 15M U-BARS AT ENDS AND 15M L-BARS AT CORNERS AND T'S OF FOUNDATION WALLS SPLICED TO HORIZONTAL REINFORCING WITH 600mm LAP, UNLESS NOTED OTHERWISE. SPACING TO MATCH SMALLER SPACING OF THE JOINING WALLS.

USE AND INTERPRETATION OF DRAWINGS

GENERAL CONDITIONS OF THE CONTRACT FOR CONSTRUCTION ARE PART OF THE CONTRACT DOCUMENTS AND DESCRIBE USE AND INTENT OF THE DRAWING. THE CONTRACT DOCUMENTS INCLUDE NOT ONLY THE DRAWINGS, BUT ALSO THE OWNER-CONTRACTOR AGREEMENT, CONDITIONS OF THE CONTRACT, THE SPECIFICATIONS, ADDENDA, AND MODIFICATIONS ISSUED AFTER EXECUTION OF THE CONTRACT. THESE CONTRACT DOCUMENTS ARE COMPLEMENTARY, AND WHAT IS REQUIRED BY ANY ONE SHALL BE BINDING AS IF REQUIRED BY ALL. WORK NOT COMPLETELY DELINEATED HEREON SHALL BE CONSTRUCTED OF THE SAME MATERIALS AND DETAIL SIMILARLY AS WORK SHOWN MORE COMPLETELY ELSEWHERE IN THE CONTRACT DOCUMENTS.

BY USE OF THE DRAWINGS FOR CONSTRUCTION OF THE PROJECT, THE OWNER CONFIRMS THAT HE HAS REVIEWED AND APPROVED THE DRAWINGS. THE CONTRACTOR CONFIRMS THAT HE HAS VISITED THE SITE, FAMILIARIZED HIMSELF WITH THE LOCAL CONDITIONS, VERIFIED FIELD DIMENSIONS AND CORRELATED HIS OBSERVATIONS WITH THE REQUIREMENTS OF THE CONTRACT DOCUMENTS.

AS INSTRUMENTS OF SERVICE, ALL DRAWINGS, SPECIFICATIONS, GOOD PRACTICES OR OTHER ELECTRONIC MEDIA AND COPIES THEREOF FURNISHED BY THE ENGINEER ARE HIS PROPERTY. THEY ARE TO BE USED ONLY FOR THE PROJECT AND ARE NOT TO BE USED ON ANY OTHER PROJECT, INCLUDING REPEATS OF THE PROJECT. CHANGES TO THE DRAWINGS MAY ONLY BE MADE BY THE ENGINEER.

UNLESS THE REVISION TITLE IS "ISSUED FOR CONSTRUCTION", THESE DRAWINGS SHALL BE CONSIDERED PRELIMINARY AND SHALL NOT BE USED AS A CONSTRUCTION DOCUMENT.

THESE DRAWINGS ILLUSTRATE THE WORK TO BE DONE. THE ENGINEER IS NOT RESPONSIBLE FOR THE MEANS, METHODS, TECHNIQUES, SEQUENCES, AND PROCEDURES USED TO DO THE WORK, OR THE SAFETY ASPECTS OF CONSTRUCTION, AND NOTHING ON THESE DRAWINGS SUPPRESSES OR IMPROVES CHANGES THIS CONDITION. CONTRACTOR SHALL DETERMINE ALL CONDITIONS AT THE SITE AND SHALL BE RESPONSIBLE FOR KNOWING HOW THEY AFFECT THE WORK. SUBMITTAL OF A BID TO PERFORM THIS WORK IS ACKNOWLEDGEMENT OF THE RESPONSIBILITIES, AND THAT THEY HAVE BEEN FULLY CONSIDERED IN PLANNING OF THE WORK, AND THE BID PRICE. NO CLAIMS FOR EXTRA CHARGES DUE TO THESE CONDITIONS WILL BE FORTHCOMING.

UNAUTHORIZED CHANGES:
IN THE EVENT THE CLIENT, THE CLIENT'S CONTRACTORS OR SUBCONTRACTORS, OR ANYONE FOR WHOM THE CLIENT IS LEGALLY LIABLE MAKES OR PERMITS TO BE MADE ANY CHANGES TO ANY REPORTS, PLANS, SPECIFICATIONS OR OTHER CONSTRUCTION DOCUMENTS PREPARED BY LRJ ASSOCIATES LTD. (LRJ) WITHOUT OBTAINING LRJ'S PRIOR WRITTEN CONSENT, THE CLIENT SHALL ASSUME FULL RESPONSIBILITY FOR THE RESULTS OF SUCH CHANGES. THEREFORE THE CLIENT AGREES TO WAIVE ANY CLAIM AGAINST LRJ AND TO RELEASE LRJ FROM ANY LIABILITY ARISING DIRECTLY OR INDIRECTLY FROM SUCH UNAUTHORIZED CHANGES.

IN ADDITION, THE CLIENT AGREES TO THE FULLEST EXTENT PERMITTED BY LAW, TO INDEMNIFY AND HOLD HARMLESS LRJ FROM ANY DAMAGES, LIABILITIES OR COSTS, INCLUDING REASONABLE ATTORNEY'S FEES AND COST OF DEFENSE, ARISING FROM SUCH CHANGES.

IN ADDITION, THE CLIENT AGREES TO INCLUDE IN ANY CONTRACTS FOR CONSTRUCTION APPROPRIATE LANGUAGE THAT PROHIBITS THE CONTRACTOR OR ANY SUBCONTRACTORS OF ANY TIER FROM MAKING ANY CHANGES OR MODIFICATIONS TO LRJ'S CONSTRUCTION DOCUMENTS WITHOUT THE PRIOR WRITTEN APPROVAL OF LRJ AND THAT FURTHER REQUIRES THE CONTRACTOR TO INDEMNIFY BOTH LRJ AND THE CLIENT FROM ANY LIABILITY OR COST ARISING FROM SUCH CHANGES MADE WITHOUT SUCH PROPER AUTHORIZATION.

GENERAL NOTES:
EXISTING SERVICES AND UTILITIES SHOWN ON THESE DRAWINGS ARE TAKEN FROM THE BEST AVAILABLE RECORDS, BUT MAY NOT BE COMPLETE OR TO DATE. CONTRACTOR SHALL VERIFY IN FIELD FOR LOCATION AND ELEVATION OF PIPES AND CHECK WITH THE UTILITY COMPANIES BEFORE DIGGING OR PERFORMING WORK.

CONTRACTOR IS ADVISED TO COLLECT INFORMATION ON SOIL CONDITIONS BEFORE START OF CONSTRUCTION.

THE ENGINEER WAIVES ANY AND ALL RESPONSIBILITY AND LIABILITY FOR PROBLEMS WHICH ARISE FROM FAILURE TO FOLLOW THESE PLANS, SPECIFICATIONS AND THE DESIGN INTENT THEY CONVEY, OR FOR PROBLEMS WHICH ARISE FROM OTHERS' FAILURE TO OBTAIN AND/OR FOLLOW THE ENGINEER'S GUIDANCE WITH RESPECT TO ANY ERRORS, OMISSIONS, INCONSISTENCIES, AMBIGUITIES OR CONFLICTS WHICH ARE ALLEGED.

CONTRACTOR TO VERIFY ALL DIMENSIONS AND NOTIFY THE ENGINEER OF ANY DISCREPANCIES BEFORE WORK COMMENCES. DO NOT SCALE DRAWINGS.

02	ISSUE FOR APPROVAL	S.P.	MAY 13, 2022
01	99% REVIEW	S.P.	APR 14, 2022

No.	REVISIONS	BY	DATE
-----	-----------	----	------



NOT AUTHENTIC UNLESS SIGNED AND DATED



LRJ
ENGINEERING | INGÉNIÉRIE
5430 Canotek Road | Ottawa, ON, K1J 9G2
www.lrl.ca | (613) 842-3434

CLIENT
DE SAULNIERS CONSTRUCTION LTD.

DESIGNED BY: S.P. DRAWN BY: S.P. APPROVED BY: S.L.

PROJECT

**BENSON AUTO PARTS
2020 BANTREE ST, OTTAWA, ON**

DRAWING TITLE

RETAINING WALL

PROJECT NO.
180357
DATE
APR. 09, 2022

S01

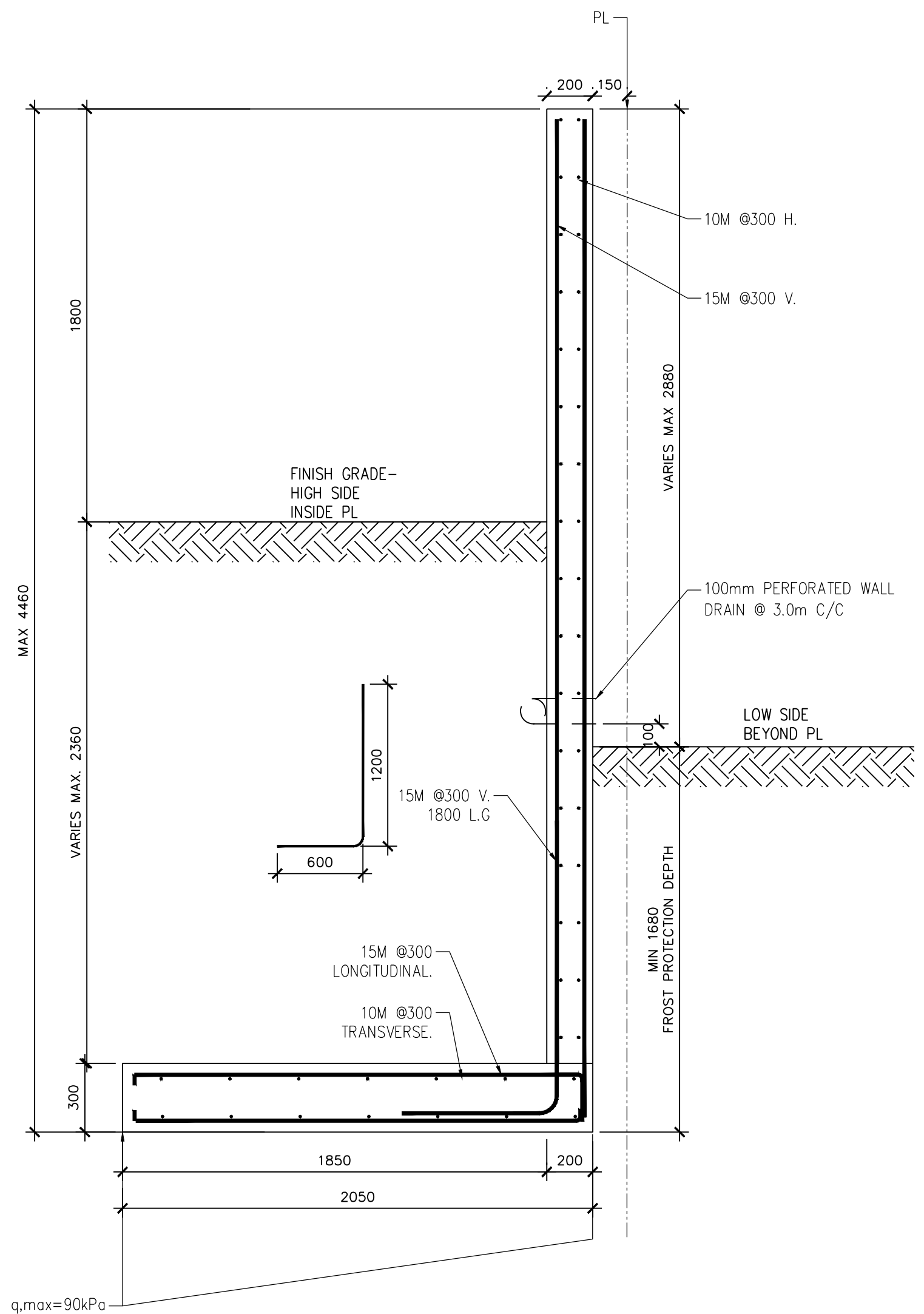
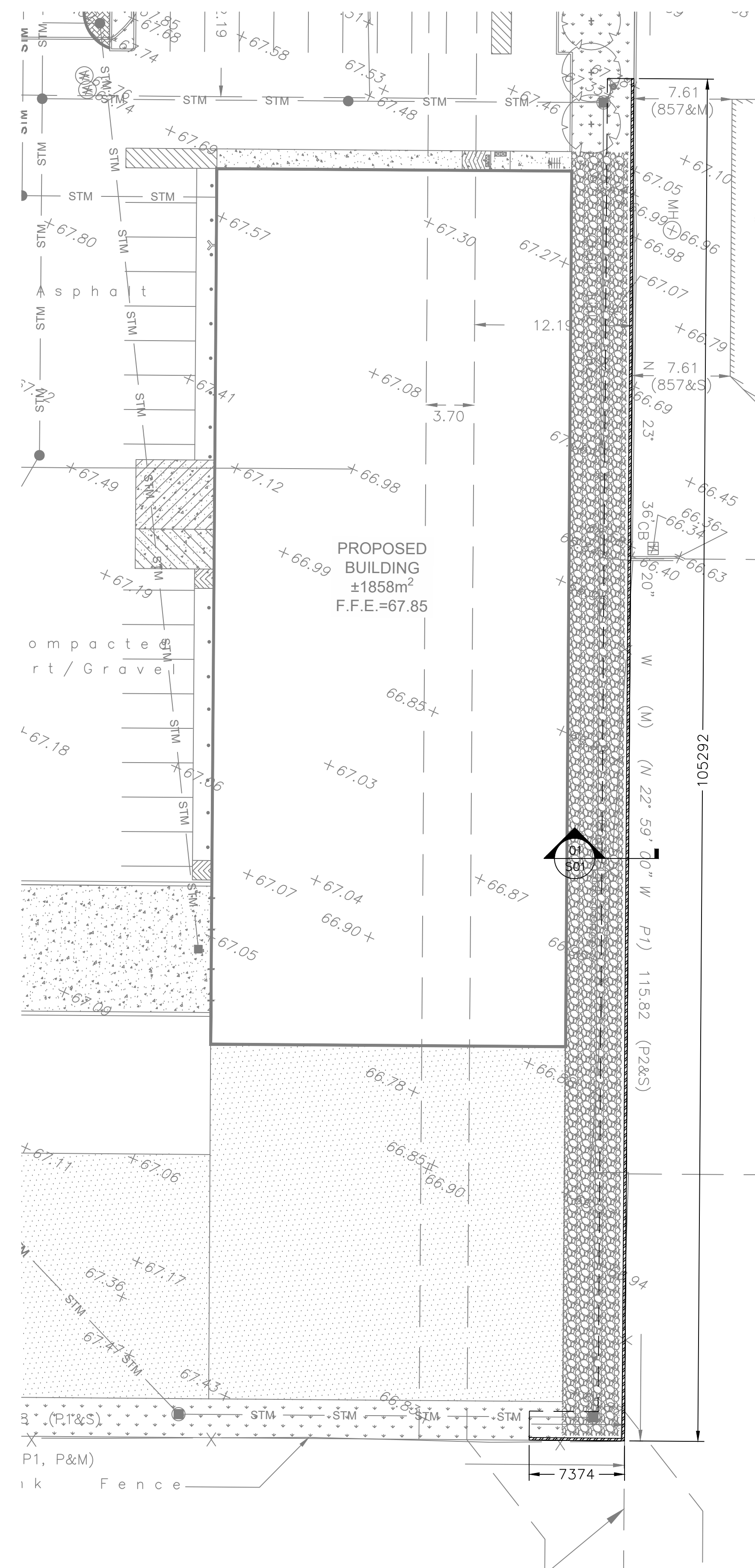

A
S01
PLAN
SCALE:1:250

01
S01
SECTION
SCALE:1:20