

AtHamlin

ALLISON HAMLIN  
MANAGER (A), DEVELOPMENT REVIEW WEST  
PLANNING, REAL ESTATE & ECONOMIC DEVELOPMENT  
DEPARTMENT, CITY OF OTTAWA

APPROVED  
By Allison Hamlin at 12:11 pm, Aug 19, 2022

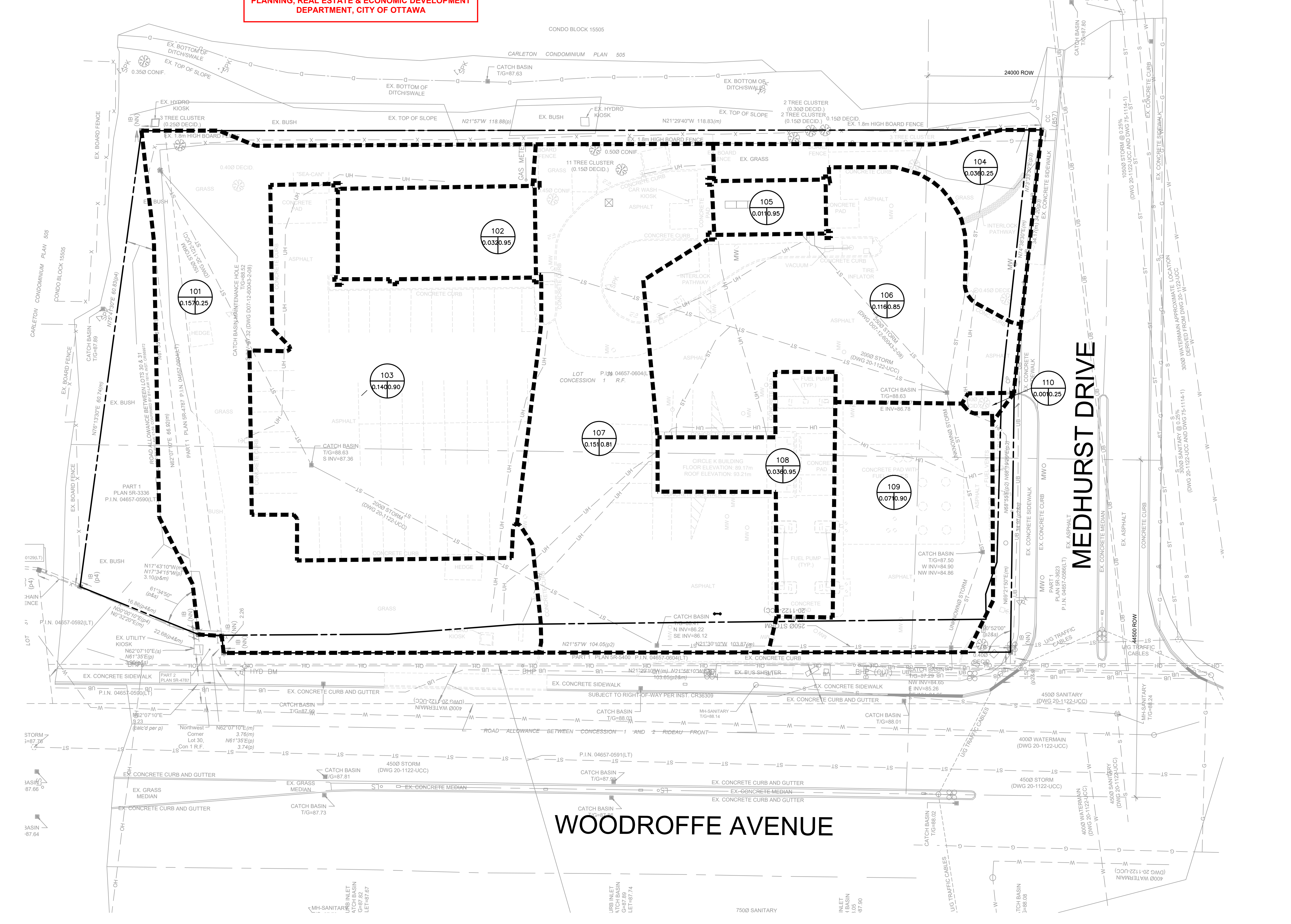
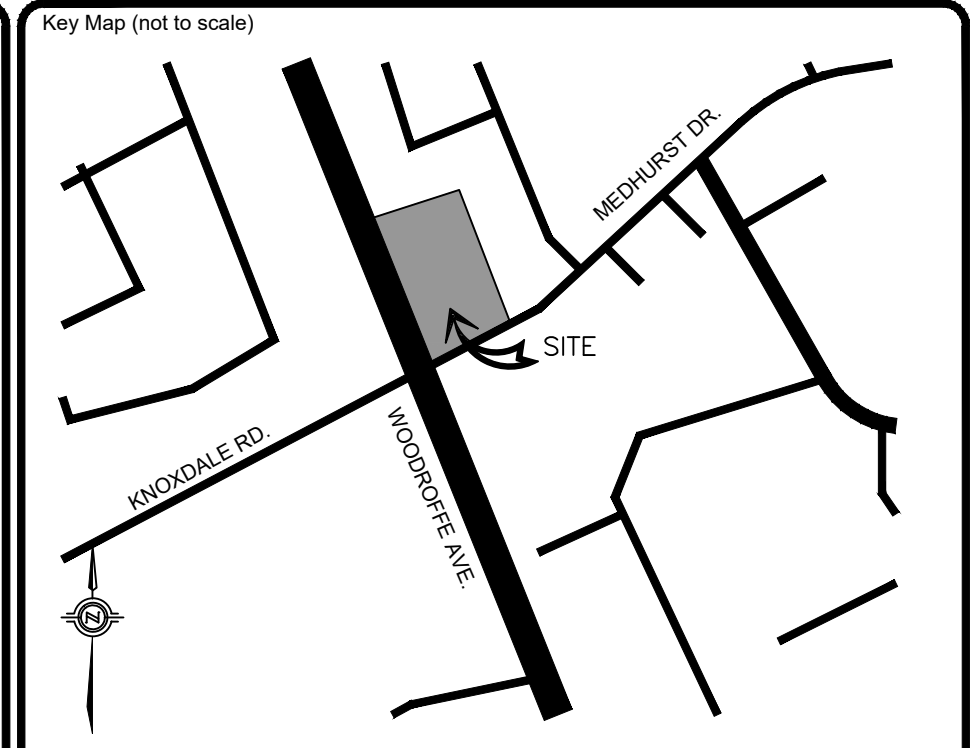

**LEGEND:**

- IRON BAR
- BENCHMARK
- EX FIRE HYDRANT
- EX LIGHT POLE
- EX LIGHT STANDARD
- EX STORM MH
- EX SANITARY MH
- EX STORM CB
- EX WATER VALVE
- EX VALVE CHAMBER
- EX BELL & HYDRO POLE
- EX GUY WIRE AND ANCHOR
- EX TRAFFIC SIGNAL
- EX GAS VALVE
- EX SIGN
- EX TREE
- SUBJECT PROPERTY
- PROPERTY LINE
- EX CONC. CURB
- EX CENTERLINE OF DITCH
- EX ROAD CENTERLINE
- EX FENCE
- EX STORM SEWER
- EX CONTOUR
- NEW YARD LIGHT
- NEW 1.8m HIGH WOOD FENCE
- OVERLAND FLOW
- - - - DRAINAGE AREA BOUNDARY
- Catchment I.D.
- Area (ha) | Run-off Coefficient

No.	REVISIONS	Date	By	App.
E	PER SITE CHANGES	JULY 15 2022	YS	J.S.
D	RE-ISSUED FOR SPA	MAR 28 2022	ML	J.S.
C	RE-ISSUED FOR SPA	DEC 03 2021	ML	J.S.
B	RE-ISSUED FOR SPA	SEPT 24 2021	ML	J.S.
A	ISSUED FOR SPA	APR 27 2021	LMB	J.S.



**exp Services Inc.**  
+1 905 793 9800 | +1 905 793 0641  
1595 Clark Boulevard  
Brampton, ON L6T 4V1  
Canada  
www.exp.com



- BUILDINGS • EARTH & ENVIRONMENT • ENERGY •
- INDUSTRIAL • INFRASTRUCTURE • SUSTAINABILITY •

Owner/Clien:

Location:  
1545 WOODROFFE AVE.  
OTTAWA, ON

Title:  
PRE-DEVELOPMENT  
DRAINAGE PLAN

Designed By: L.M.B.	Drawn By: L.M.B.	Checked By: J.S.
Scale: 1:250	Date: APRIL 2020	City Drawing No.
Project No.: BRM00606364-B0		Drawing No.: <b>C06</b>

CITY DWG. # 17094

CITY # 007-1221-0005