

**LEGEND**

PARKING - CARS	
MIN. PARKING PLACES REQUIRED AREA Z SCHEDULE 1A	NO MIN. REQUIRED
EXISTING PARKING PLACES (TO KEEP)	19
PARKING PLACES PROPOSED	120
FUTURE PARKING PLACES	
HANDICAP PARKING PROPOSED (4%)	5

PARKING - BICYCLES	
MIN. PARKING PLACES REQUIRED AREA B SCHEDULE 1	137 (1 PER 100 m <sup>2</sup> OF GROSS FLOOR AREA)
GROSS FLOOR AREA	13,700 m <sup>2</sup>
PARKING PLACES PROPOSED	138

No.	Date	Émis pour / Object
1	21-09-2021	ISSUE FOR COSTING
2	10-01-2022	FOR SITE PLAN APPLICATION ET PERMIS
3	19-01-2022	FOR SPA AND PERMIT REVIEW
4	16-02-2022	FOR SPA - CITY COMMENTS #1
5	05-10-2022	FOR SPA - CITY COMMENTS #2 (EXIT DOOR ADDED)

**NOT FOR CONSTRUCTION**

Landscape Architect  
Gino Aiello

Ingénieur / Engineer  
Electrical / Électrotechnicien / Mechanical & Electrical

Ingénieur / Engineer  
(Structure / Structure)

Client / Client

Architecte / Architect

3050, Saint-Antoine O.  
Montréal QC H3C 1A9  
T. 514 861-9122

100 Somerset St W #206  
Ottawa ON K1P 0A4  
T. 613 695-8122

Droit d'auteur / Copyright

Ce dessin est sujet au droit d'auteur. Il ne peut être reproduit pour quelques intentions ou usages que ce soit, il ne peut être utilisé en conjonction avec l'apposition de la signature et de l'estampe originale.

This drawing is subject to copyright. It is not to be reproduced for any purpose or by any means, and may only be used if it bears an original stamp and signature.

Seau / Seal

Note:  
L'entrepreneur doit vérifier toutes les dimensions et informations sur le site et avoir immédiatement l'architecte de toutes erreurs ou omissions.  
Contractor shall verify all information and dimensions on site and immediately report any errors or omissions to the architect.

Project / Project

**LYCÉE CLAUDEL - REFURBISHMENT OF OUTDOOR SPACES**

1635 RIVERSIDE DR. OTTAWA, ON K1G 0E5

Title / Titre

**SITE PLAN - CONSTRUCTION**

Drawn by / Dessiné par	No. projet / Project number
AUTHOR	2122
Verified by / Vérifié par	No. dessin / Drawing number
S.D.	
Scale / Echelle	Revision / Révision
As indicated	5

Date de création du dessin / Drawing creation date  
07/16/21

**A-101**

**LEGEND**

	NEW PARKING		HANDICAP PARKING
	EXISTING PARKING		FUTURE PARKING
	PROPERTY LINE		SYMBOL LEVEL
Name: 888.88°			

**LEGEND - GROUND FINISHES**

	ASPHALT, OR LANDSCAPE
	CONCRETE - SEE LANDSCAPE
	GRASS OR PLANTING BED, SEE LANDSCAPE
	CEDAR MULCH, SEE LANDSCAPE
	POST FOR CANOPY, SEE A-130 ELIMINATED
	NEW CHAIN LINK FENCE, SEE CIVIL
	IDENTIFICATION OF EXISTING PLAY STRUCTURES, SEE PLAY STRUCTURE SCHEDULE ON DEMOLITION SHEETS
	EXIT

**SURVEY PLAN REFERENCE**

TITLE: PART OF LOTS 13 AND 14 JUNCTION GORE, CITY OF OTTAWA  
ISSUED BY: J.D BARNES LTD  
DATE: JUNE 14TH, 2021

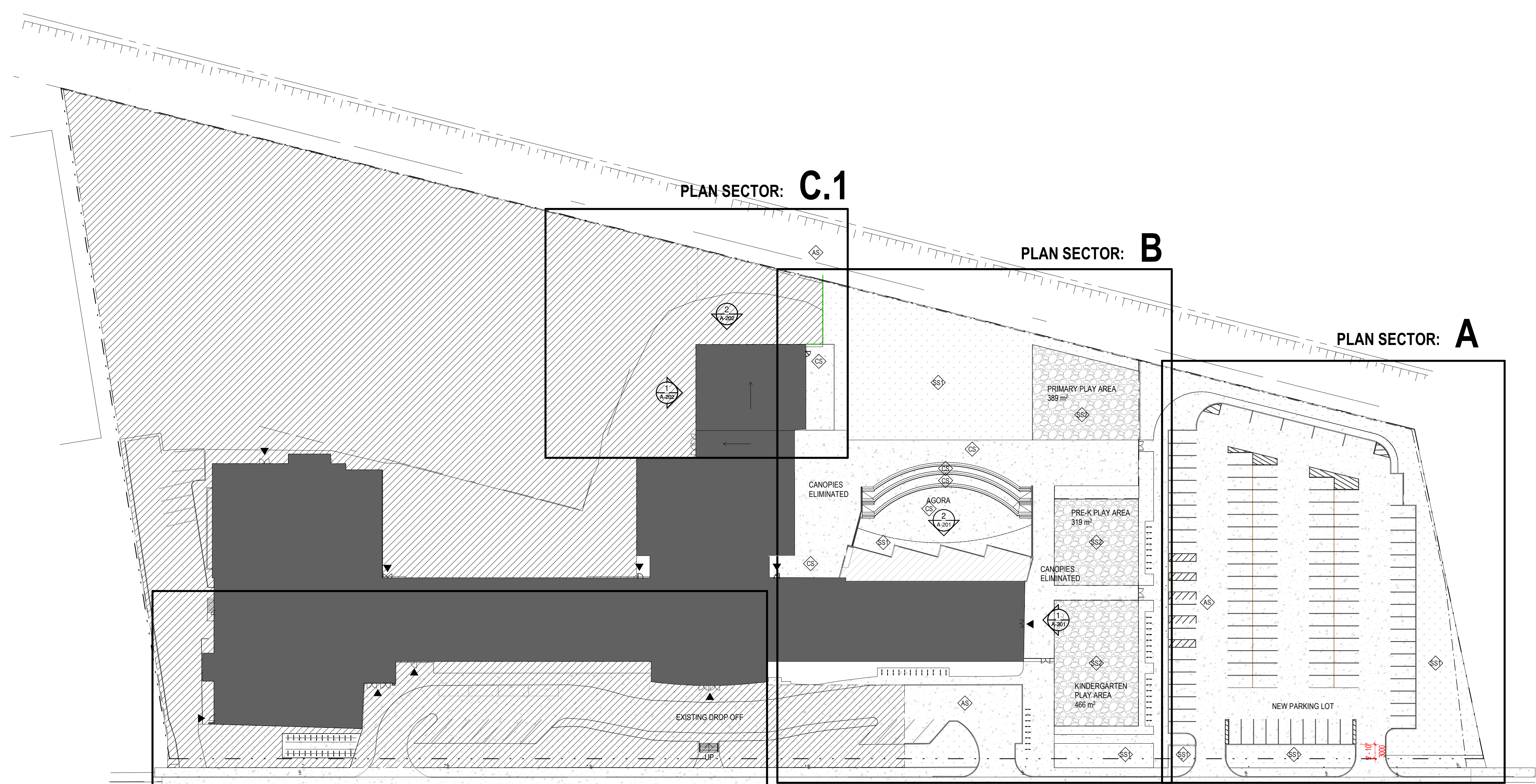

**NADER KADRI**  
PLANNER II  
PLANNING, REAL ESTATE & ECONOMIC DEVELOPMENT  
DEPARTMENT, CITY OF OTTAWA

1 SITE PLAN  
A-101 ECHELLE / SCALE: 1:500



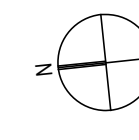

GENERAL NOTES - CONSTRUCTION

1. ARCHITECTURE PLANS ARE TO BE READ IN CONJUNCTION WITH CIVIL, STRUCTURE, ELECTRICAL & LANDSCAPE PLANS. IN CASE OF DISCREPANCIES, LANDSCAPING PLANS SHALL PREVAIL.
2. FOR DRAINAGE, GRADING AND CHAIN-LINK FENCES : REFER TO CIVIL
3. FOR PLANTING, SODDING AND GROUND FINISHES : REFER TO LANDSCAPE
4. FOR BIKE RACKS : REFER TO LANDSCAPE
5. FOR STEEL CANOPIES AND RETAINING WALLS : REFER TO STRUCTURE
6. FOR OUTDOOR SIGNAGE AND PAVEMENT MARKING : REFER TO SPECIFICATION BOOK
7. FOR PLAY AREA FINISHES, EQUIPMENT AND REQUIREMENTS : REFER TO SPECIFICATION BOOK

ELIMINATED

SPECIFIC NOTES - CONSTRUCTION

1. EXISTING BRICK WALL TO REPOINT, SEE ELEVATION
2. NEW HORIZONTAL PREPAINTED STEEL FLASHING AT THE JUNCTION OF BRICK FINISH & METAL SIDING, SEE ELEVATIONS
3. NEW ALUMINUM GUTTER, COLOUR TO MATCH EXISTING, SEE ELEVATIONS
4. NEW ALUMINUM DOWNSPOUT, COLOUR TO MATCH EXISTING, SEE ELEVATIONS
5. NEW FENCE WITH PRIVACY SCREEN AND DOORS, SEE CIVIL
6. NEW CONTINUOUS STEEL GUARDRAIL
7. SIGNAGE FOR BARRIER FREE PARKING, SEE DETAIL-2
8. NEW CURB CUT, SEE CIVIL
9. NEW DEPRESSED CURB, SEE CIVIL
10. EXISTING PIPES TO REMAIN
11. CANOPY ABOVE, SEE STRUCTURE - ELIMINATED
12. RELOCATED PLAY STRUCTURES
13. NEW BIKE RACKS, SEE LANDSCAPE ARCHITECT
14. NEW BOLLARD

LEGEND - CONSTRUCTION

- AS ASPHALT, OR LANDSCAPE
- CS CONCRETE - SEE LANDSCAPE
- SS1 GRASS OR PLANTING BED, SEE LANDSCAPE
- SS2 CEDAR MULCH, SEE LANDSCAPE
- POST FOR CANOPY, SEE A-130 - ELIMINATED
- NEW CHAIN LINK FENCE, SEE CIVIL
- PS #XXX IDENTIFICATION OF EXISTING PLAY STRUCTURES, SEE PLAY STRUCTURE SCHEDULE ON DEMOLITION SHEETS
- EXIT

No.	Date	Émis pour / Object
1	21-09-2021	ISSUE FOR COSTING
2	10-01-2022	FOR SITE PLAN APPLICATION ET PERMIS
3	19-01-2022	FOR SPA AND PERMIT REVIT
4	16-02-2022	FOR SPA - CITY COMMENTS #1
5	05-10-2022	FOR SPA - CITY COMMENTS #2 (EXIT DOOR ADDED)

NOT FOR CONSTRUCTION

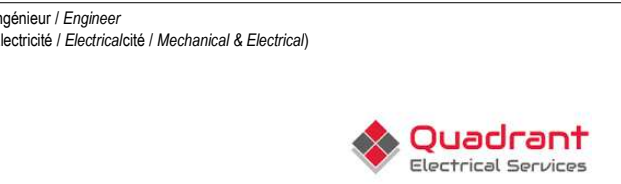

Dr. de l'architecte / Copyright

Ce dessin est sujet au droit d'auteur. Il ne peut être reproduit pour quelque intention ou usage que ce soit, sans la permission écrite préalable de l'architecte et de l'estampeur original.

This drawing is subject to copyright. It is not to be reproduced for any purpose or by any means, and may only be used if it bears an original stamp and signature.

Site / Seal

Note:

L'entrepreneur doit vérifier toutes les dimensions et informations sur le site et aviser immédiatement l'architecte de toutes erreurs ou omissions.

Contractor shall verify all information and dimensions on site and immediately report any errors or omissions to the architect.

Projet / Project

LYCÉE CLAUDEL - REFURBISHMENT OF OUTDOOR SPACES

1635 RIVERSIDE DR. OTTAWA, ON K1G 0E5

"CONSTRUCTION PLAN - GROUND LEVEL SECTOR 'A'

Dessiné par / Drawn by: MIB No. projet / Project number: 2122

Vérifié par / Verified by: S.D. No. dessin / Drawing number: Révision / Revision: 5

Échelle / Scale: As indicated

Date de création du dessin / Drawing creation date: 05/18/18

A-121A

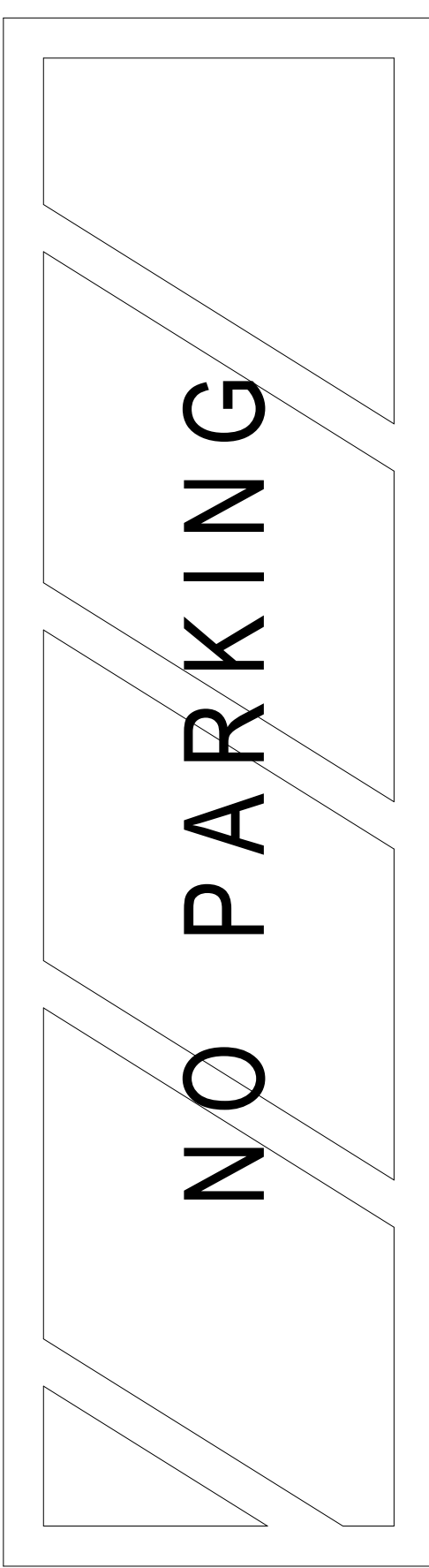
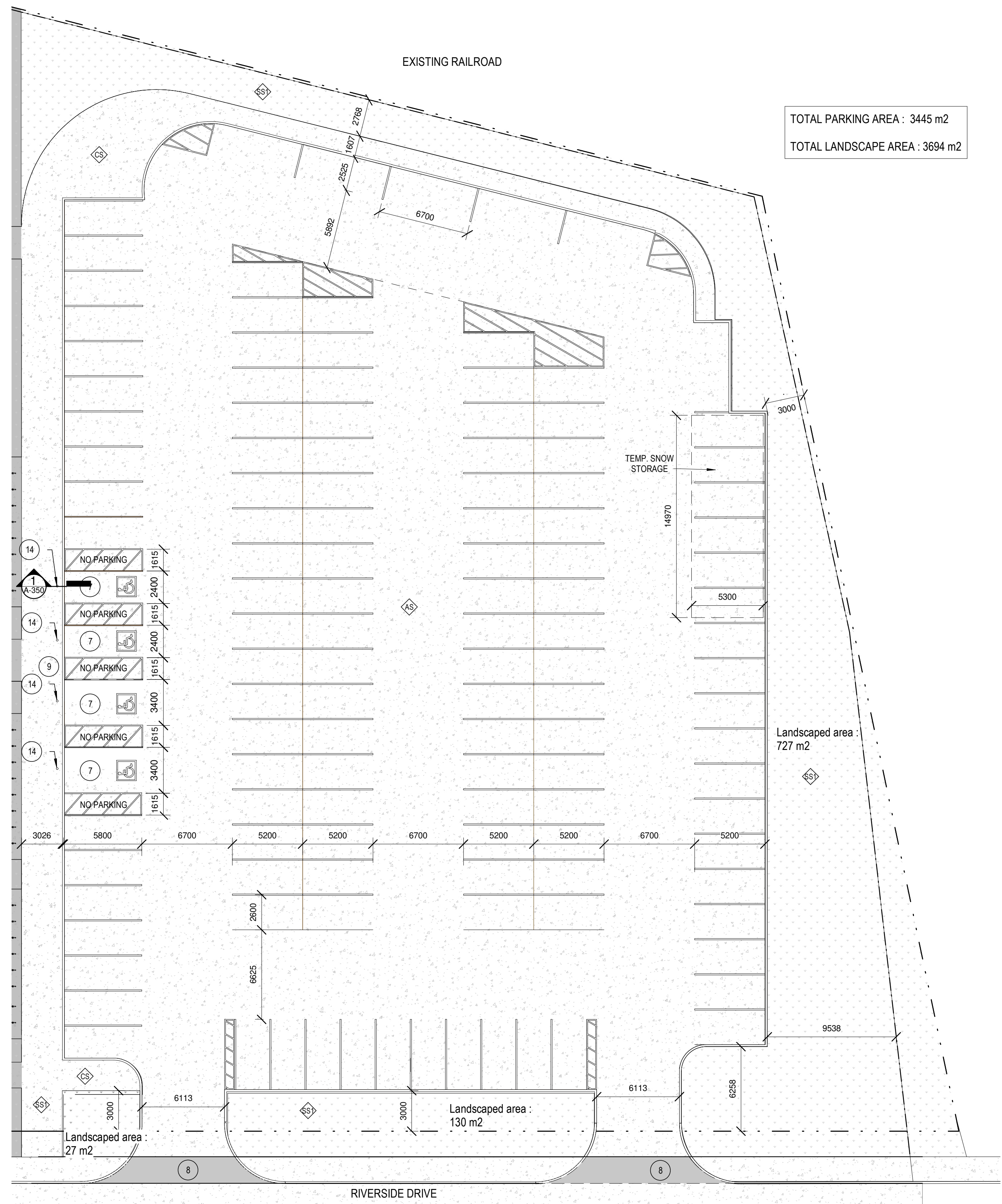

2 TYPICAL ACCESSIBLE PARKING  
A-121A ÉCHELLE / SCALE: 1:25

1 01A - CONSTRUCTION PLAN - GROUND LEVEL  
A-121A ÉCHELLE / SCALE: 1:200



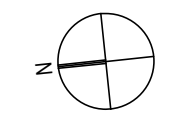
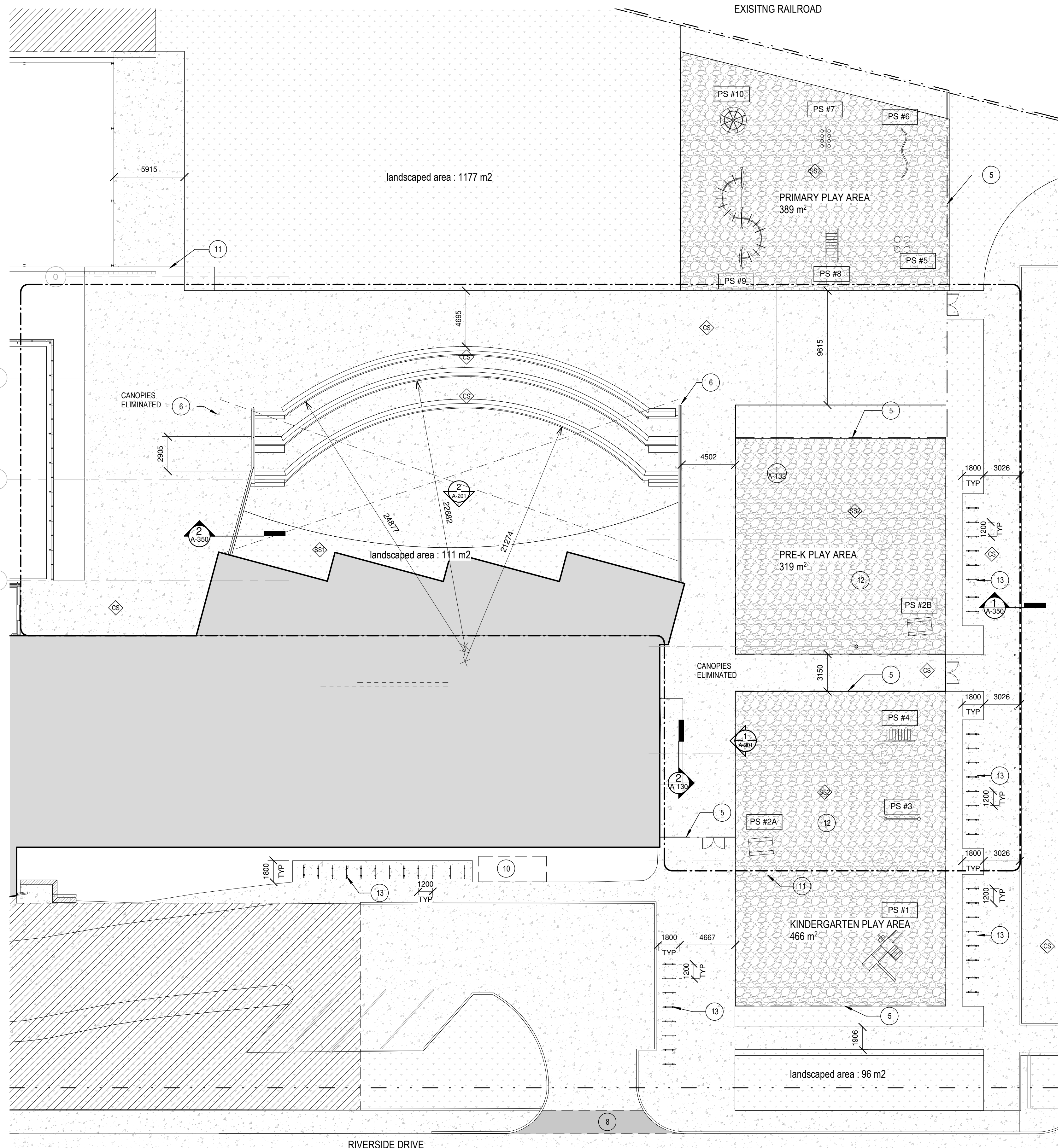

**GENERAL NOTES**

1. ARCHITECTURE PLANS ARE TO BE READ IN CONJUNCTION WITH CIVIL, STRUCTURE, ELECTRICAL & LANDSCAPE PLANS. IN CASE OF DISCREPANCIES, LANDSCAPING PLANS SHALL PREVAIL.
2. FOR DRAINAGE, GRADING AND CHAIN-LINK FENCES : REFER TO CIVIL
3. FOR PLANTING, SODDING AND GROUND FINISHES : REFER TO LANDSCAPE
4. FOR BIKE RACKS : REFER TO LANDSCAPE
5. FOR STEEL CANOPIES AND RETAINING WALLS : REFER TO STRUCTURE
6. FOR OUTDOOR SIGNAGE AND PAVEMENT MARKING : REFER TO SPECIFICATION BOOK
7. FOR PLAY AREA FINISHES, EQUIPMENT AND REQUIREMENTS : REFER TO SPECIFICATION BOOK

**SPECIFIC NOTES**

1. EXISTING BRICK WALL TO REPOINT, SEE ELEVATION
2. NEW HORIZONTAL PREPAINTED STEEL FLASHING AT THE JUNCTION OF BRICK FINISH & METAL SIDING, SEE ELEVATIONS
3. NEW ALUMINUM GUTTER, COLOUR TO MATCH EXISTING, SEE ELEVATIONS
4. NEW ALUMINUM DOWNSPOUT, COLOUR TO MATCH EXISTING, SEE ELEVATIONS
5. NEW FENCE WITH PRIVACY SCREEN AND DOORS, SEE CIVIL
6. NEW CONTINUOUS STEEL GUARDRAIL
7. SIGNAGE FOR BARRIER FREE PARKING, SEE DETAIL-2
8. NEW CURB CUT, SEE CIVIL
9. NEW DEPRESSED CURB, SEE CIVIL
10. EXISTING PIPES TO REMAIN
11. CANOPY ABOVE, SEE STRUCTURE - ELIMINATED
12. RELOCATED PLAY STRUCTURES
13. NEW BIKE RACKS, SEE LANDSCAPE ARCHITECT
14. NEW BOLLARD

**LEGEND**

- AS ASPHALT, OR LANDSCAPE
- CS CONCRETE - SEE LANDSCAPE
- GS1 GRASS OR PLANTING BED, SEE LANDSCAPE
- GS2 CEDAR MULCH, SEE LANDSCAPE
- POST FOR CANOPY, SEE A-130 - ELIMINATED
- NEW CHAIN LINK FENCE, SEE CIVIL
- PS #XX IDENTIFICATION OF EXISTING PLAY STRUCTURES, SEE PLAY STRUCTURE SCHEDULE ON DEMOLITION SHEETS
- EXIT

No.	Date	Émis pour / Object
1	21-09-2021	ISSUE FOR COSTING
2	19-01-2022	FOR SITE PLAN APPLICATION ET PERMIS
3	19-01-2022	FOR SPA AND PERMIT REV.1
4	06-05-2022	FOR SPA - CITY COMMENTS #1
5	06-10-2022	FOR SPA - CITY COMMENTS #2 (EXIT DOOR ADDED)

NOT FOR CONSTRUCTION

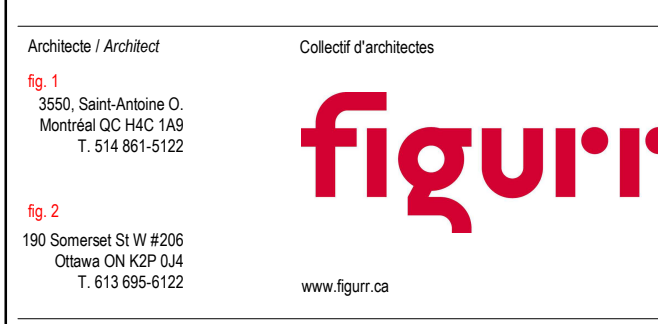
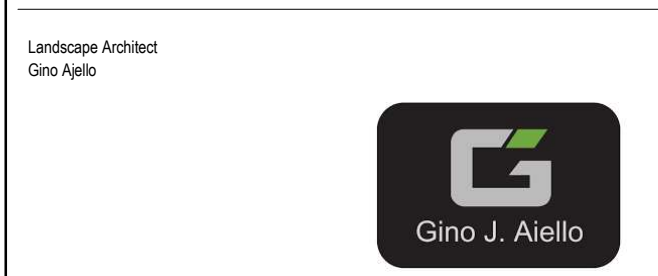

Ca dessin est sujet au droit d'auteur. Il ne peut être reproduit pour quelques intentions ou usages que ce soit, il ne peut être utilisé en conjonction avec l'apposition de la signature et de l'estampe originale.  
This drawing is subject to copyright. It is not to be reproduced for any purpose or by any means, and may only be used if it bears an original stamp and signature.

Le professionnel doit vérifier toutes les dimensions et informations sur le site et avant immédiatement l'architecte de toutes erreurs ou omissions.  
Contributor shall verify all information and dimensions on site and immediately report any errors or omissions to the architect.

**LYCÉE CLAUDEL - REFURBISHMENT OF OUTDOOR SPACES**

1635 RIVERSIDE DR. OTTAWA, ON K1G 0E5

"CONSTRUCTION PLAN - GROUND LEVEL SECTOR 'B'"

Drawn by / Dessiné par / MB	Project / Project number / 2122
Checked by / Vérifié par / S.D.	Revision / Revision / 5
Scale / Echelle / As indicated	

Date de création du dessin / Drawing creation date / 07/16/21

01B - CONSTRUCTION PLAN - GROUND LEVEL  
ÉCHELLE / SCALE: 1:200

**A-121B**