

**NOTE:**  
A GEOTECHNICAL ENGINEER LICENSED IN THE PROVINCE OF ONTARIO IS TO INSPECT ALL SUBGRADE SURFACES FOR FOOTING AND PAVEMENT STRUCTURES PRIOR TO CONSTRUCTION

**NOTE:**  
ALL EXISTING POST & WIRE FENCE, CULVERTS, UTILITY WIRE / POLES, TREES, SHRUBS ETC. WITHIN LOTS, BLOCKS AND ROADS TO BE REMOVED, UNLESS OTHERWISE NOTED

**NOTE RE: PERFORATED PIPE**  
PERFORATED PIPE IS REQUIRED FOR SWALE SLOPE LESS THAN 1.5%. REFER TO CITY STD. S29, S30 FOR REAR YARD TRENCH AND PIPE DETAIL ONLY

**NOTE:**  
ALL SWALES SHALL BE 0.15m DEEP WITH 3:1 SIDE SLOPES UNLESS OTHERWISE INDICATED

ANY DISTURBED AREA DURING CONSTRUCTION TO BE RESTORED TO THE ORIGINAL CONDITION OR BETTER TO THE SATISFACTION OF THE AUTHORITIES HAVING JURISDICTION

CONTRACTOR TO VERIFY THE PRECISE LOCATIONS AND INVERT ELEVATIONS OF EX. UNDERGROUND SERVICES AND EX. UTILITIES PRIOR TO STARTING CONSTRUCTION

PERMISSION REQUIRED FOR WORK ON ADJACENT LANDS

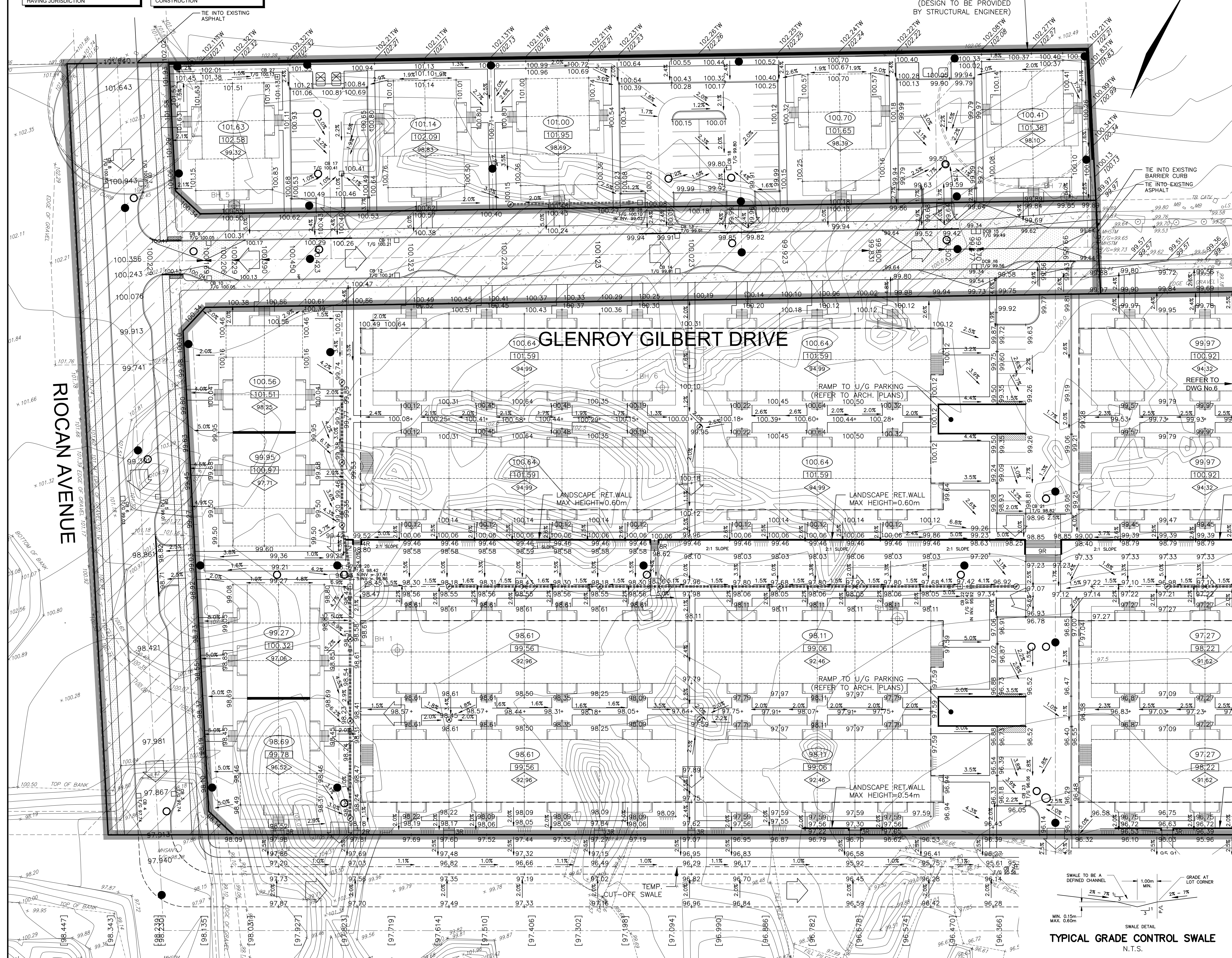
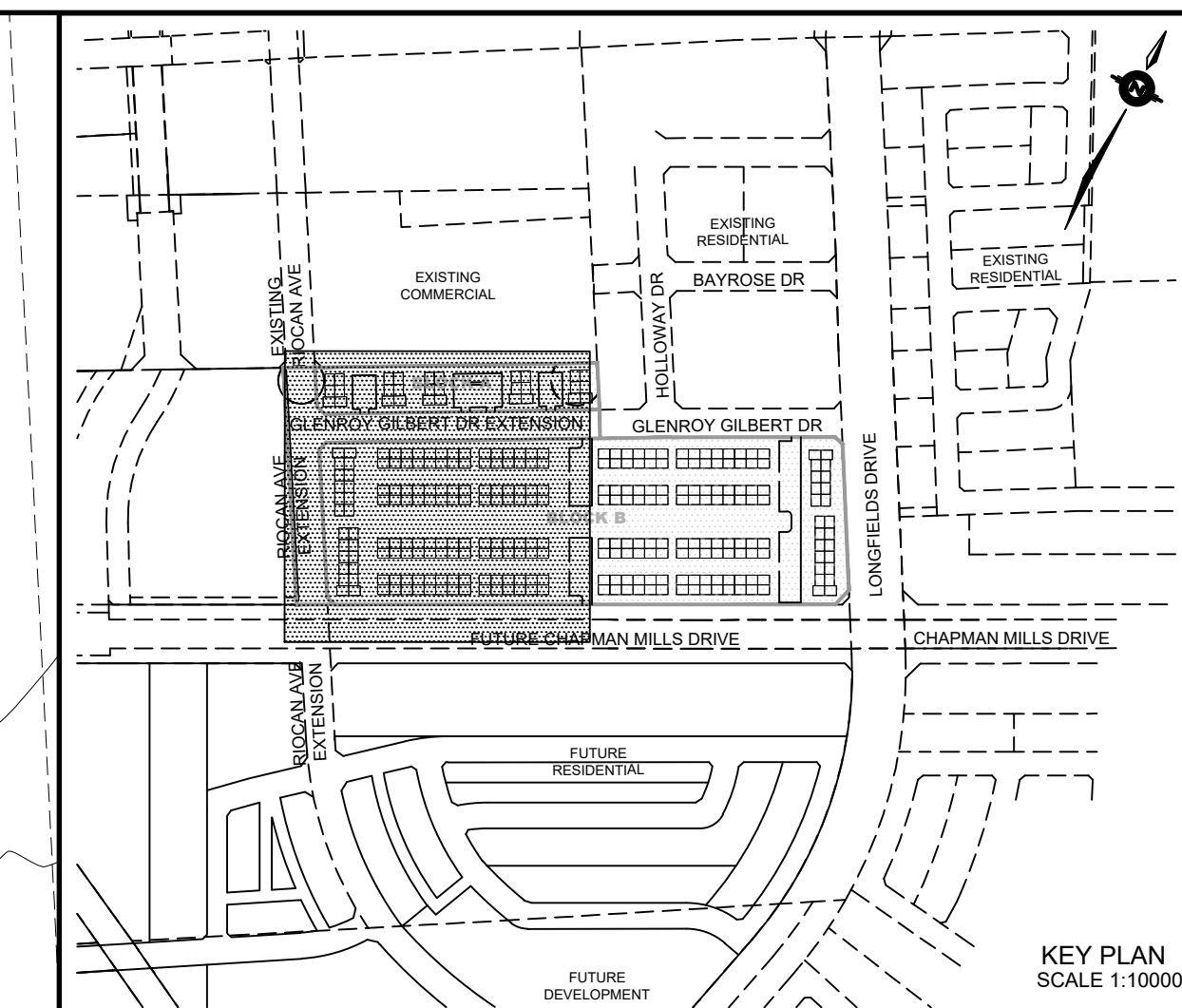

**LEGEND**

PROPOSED ELEVATION	103.45	OVERLAND FLOW DIRECTION	→
EXISTING ELEVATION	102.73	EXTERNAL OVERLAND FLOW DIRECTION	→
FUTURE ELEVATION	[93.90]	EMERGENCY OVERLAND FLOW DIRECTION	→
PROPOSED SWALE GRADE	1.5%	RETAINING WALL AND ELEVATIONS	1/7m=103.10 8/7m=102.44
HIGH POINT	102.16	CHAIN LINK FENCE (1.5m UNLESS OTHERWISE NOTED)	— —
STREET CATCHBASIN	○	NOISE BARRIER (3.0m UNLESS OTHERWISE NOTED)	— —
TOP OF FOUNDATION (TOF)	□	DECORATIVE FENCE (SEE LANDSCAPE DWGS FOR DETAIL)	— —
CATCHBASIN MANHOLE	○	CONSTRUCTION FENCE	— —
TEE CATCHBASIN	○	PROPERTY BOUNDARY	— —
ELBOW CATCHBASIN	○	3:1 TERRACING MAXIMUM SLOPE	— —
HYDRANT, VALVE & VB	○	UNDERSIDE OF FOOTING ELEVATION (USF)	— —
VALVE & VC	○	UNITS REQUIRING WATER PRESSURE REDUCING VALVES	— —
VALVE & VB	○	WALKOUT UNITS	— —
BUILDING ENVELOPE	□	SLAB ON GRADE	— —
TOP OF FOUNDATION (TOF)	□	HYDRO SWITCHGEAR	— —
FINISHED FLOOR ELEVATION (FFE)	□	HYDRO TRANSFORMER	— —
PROPERTY BOUNDARY	— —	STREET LIGHT STANDARD	— —
3:1 TERRACING MAXIMUM SLOPE	— —	TACTILE WALKING SURFACE INDICATOR (AS PER CITY OF OTTAWA STD. SC6)	— —
UNDERSIDE OF FOOTING ELEVATION (USF)	— —	PREVIOUS PHASES / PHASES NOT PART OF CURRENT GRADING APPROVAL	— —
UNITS REQUIRING WATER PRESSURE REDUCING VALVES	— —		
WALKOUT UNITS	— —		
SLAB ON GRADE	— —		
HYDRO SWITCHGEAR	— —		
HYDRO TRANSFORMER	— —		
STREET LIGHT STANDARD	— —		
TACTILE WALKING SURFACE INDICATOR (AS PER CITY OF OTTAWA STD. SC6)	— —		
PREVIOUS PHASES / PHASES NOT PART OF CURRENT GRADING APPROVAL	— —		

**NOT FOR CONSTRUCTION**

1	S.L.M.	22-06-10	1ST SUBMISSION
---	--------	----------	----------------

**TOPOGRAPHIC INFORMATION**  
TOPOGRAPHIC INFORMATION PROVIDED BY STANTEC GEOMATICS LTD., PROJECT No. 161614291-111, DATED MARCH 1, 2022

**SITE PLAN INFORMATION**  
SITE PLAN PROVIDED BY SRN ARCHITECTS LTD., PROJECT No. S21001, DATED FEBRUARY 3, 2022

**LEGAL INFORMATION**  
CALCULATED M-PLAN PROVIDED BY STANTEC GEOMATICS LTD., PROJECT No. 161614291-111, DATED MARCH 1, 2022

**BENCH MARK**  
ELEVATIONS ARE REFERRED TO THE CANADIAN GEODETIC VERTICAL DATUM (CGVD-1928:1978) AND ARE DERIVED FROM BENCHMARK MONUMENT No. 196530071\*, HAVING A PUBLISHED ELEVATION OF 99.742 METRES

**MINTO COMMUNITIES INC.**  
**BARRHAVEN TOWN CENTRE STAGE 1**

**DSEL**  
120 Ber Road Unit 103  
Stittsville, Ontario, K2S 1E9  
Tel. (613) 836-0856  
Fax. (613) 836-7183  
www.DSEL.ca

**S.L. MERRICK**  
100166523  
2022-06-10  
PROVINCE OF ONTARIO

**Ottawa**  
110 Laurier Ave W  
Ottawa, Ontario, K1P 1J1  
Tel. (613) 580-2400  
www.Ottawa.ca

**GRADING PLAN**

DRAWN BY: AM	CHECKED BY: BC	PROJECT No. 15-816
DESIGNED BY: BC	CHECKED BY: SM	SHEET No. 5
SCALE: 1:400	HORIZ. 1:500	

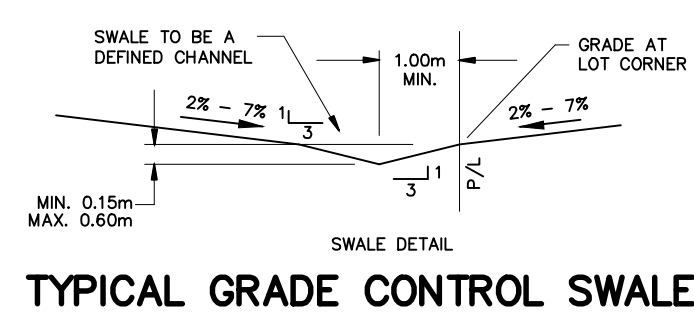

CITY PLAN No. XXXXX  
CITY FILE No. D07-XX-XX-XXXX