

NOTE:
A GEOTECHNICAL ENGINEER LICENSED IN THE PROVINCE OF ONTARIO IS TO INSPECT ALL SUBGRADE SURFACES FOR FOOTING AND PAVEMENT STRUCTURES PRIOR TO CONSTRUCTION

NOTE:
ALL EXISTING POST & WIRE FENCE, CULVERTS, UTILITY WIRE / POLES, TREES, SHRUBS ETC. WITHIN LOTS, BLOCKS AND ROADS TO BE REMOVED, UNLESS OTHERWISE NOTED

NOTE RE: PERFORATED PIPE
PERFORATED PIPE IS REQUIRED FOR SWALE SLOPE LESS THAN 1.5%. REFER TO CITY STD. S29, S30 FOR REAR YARD TRENCH AND PIPE DETAIL ONLY

NOTE:
ALL SWALES SHALL BE 0.15m DEEP WITH 3:1 SIDE SLOPES UNLESS OTHERWISE INDICATED

ANY DISTURBED AREA DURING CONSTRUCTION TO BE RESTORED TO THE ORIGINAL CONDITION OR BETTER TO THE SATISFACTION OF THE AUTHORITIES HAVING JURISDICTION

CONTRACTOR TO VERIFY THE PRECISE LOCATIONS AND INVERT ELEVATIONS OF EX. UNDERGROUND SERVICES AND EX. UTILITIES PRIOR TO STARTING CONSTRUCTION

PERMISSION REQUIRED FOR WORK ON ADJACENT LANDS

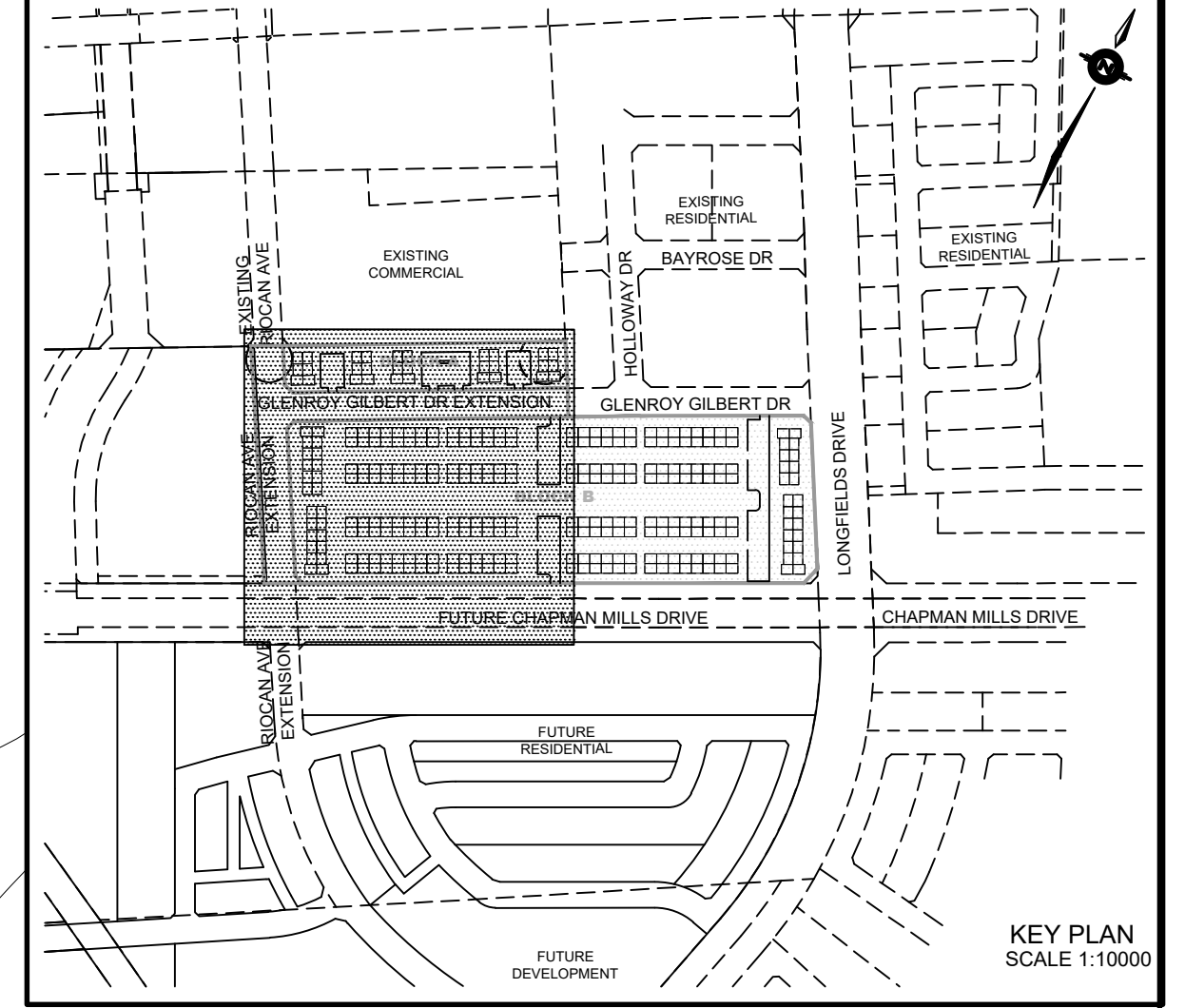

LEGEND

PROPOSED ELEVATION	103.45	OVERLAND FLOW DIRECTION	→
EXISTING ELEVATION	102.73	EXTERNAL OVERLAND FLOW DIRECTION	→
FUTURE ELEVATION	[93.90]	EMERGENCY OVERLAND FLOW DIRECTION	→
PROPOSED SWALE GRADE	1.5%	RETAINING WALL AND ELEVATIONS	1.7m-103.10 8.7m-102.44
HIGH POINT	102.16	CHAINLINK FENCE (1.5m UNLESS OTHERWISE NOTED)	□
STREET CATCHBASIN	○	NOISE BARRIER (3.0m UNLESS OTHERWISE NOTED)	▬
STREET CATCHBASIN WITH CLOSED LID	○	DECORATIVE FENCE (SEE LANDSCAPE DWGS FOR DETAIL)	▬
CATCHBASIN MANHOLE	○	CONSTRUCTION FENCE	▬
TEE CATCHBASIN	○	PROPERTY BOUNDARY	▬
ELBOW CATCHBASIN	○	3:1 TERRACING MAXIMUM SLOPE	▬
HYDRANT, VALVE & VB	○	UNDERSIDE OF FOOTING ELEVATION (USP)	▬
VALVE & VC	○	UNITS REQUIRING WATER PRESSURE REDUCING VALVES	▬
VALVE & VB	○	WALKOUT UNITS	▬
BUILDING ENVELOPE	▬	SLAB ON GRADE	▬
TOP OF FOUNDATION (TOF)	▬	HYDRO SWITCHGEAR	▬
FINISHED FLOOR ELEVATION (FFE)	▬	HYDRO TRANSFORMER	▬
UNDERSIDE OF FOOTING ELEVATION (USP)	▬	STREET LIGHT STANDARD	▬
INDICATOR (AS PER CITY OF OTTAWA STD. S06)	▬	TACTILE WALKING SURFACE INDICATOR (AS PER CITY OF OTTAWA STD. S06)	▬
PREVIOUS PHASES / PHASES NOT PART OF CURRENT GRADING APPROVAL	▬		

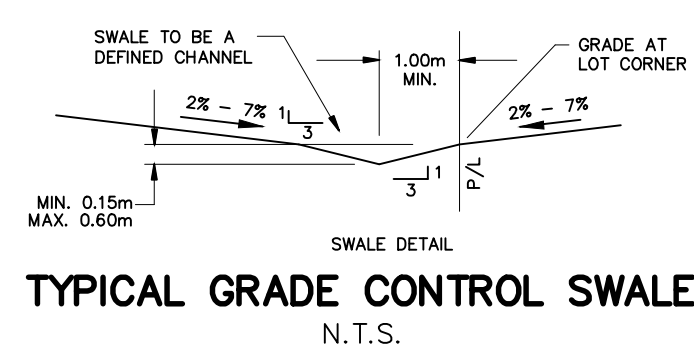
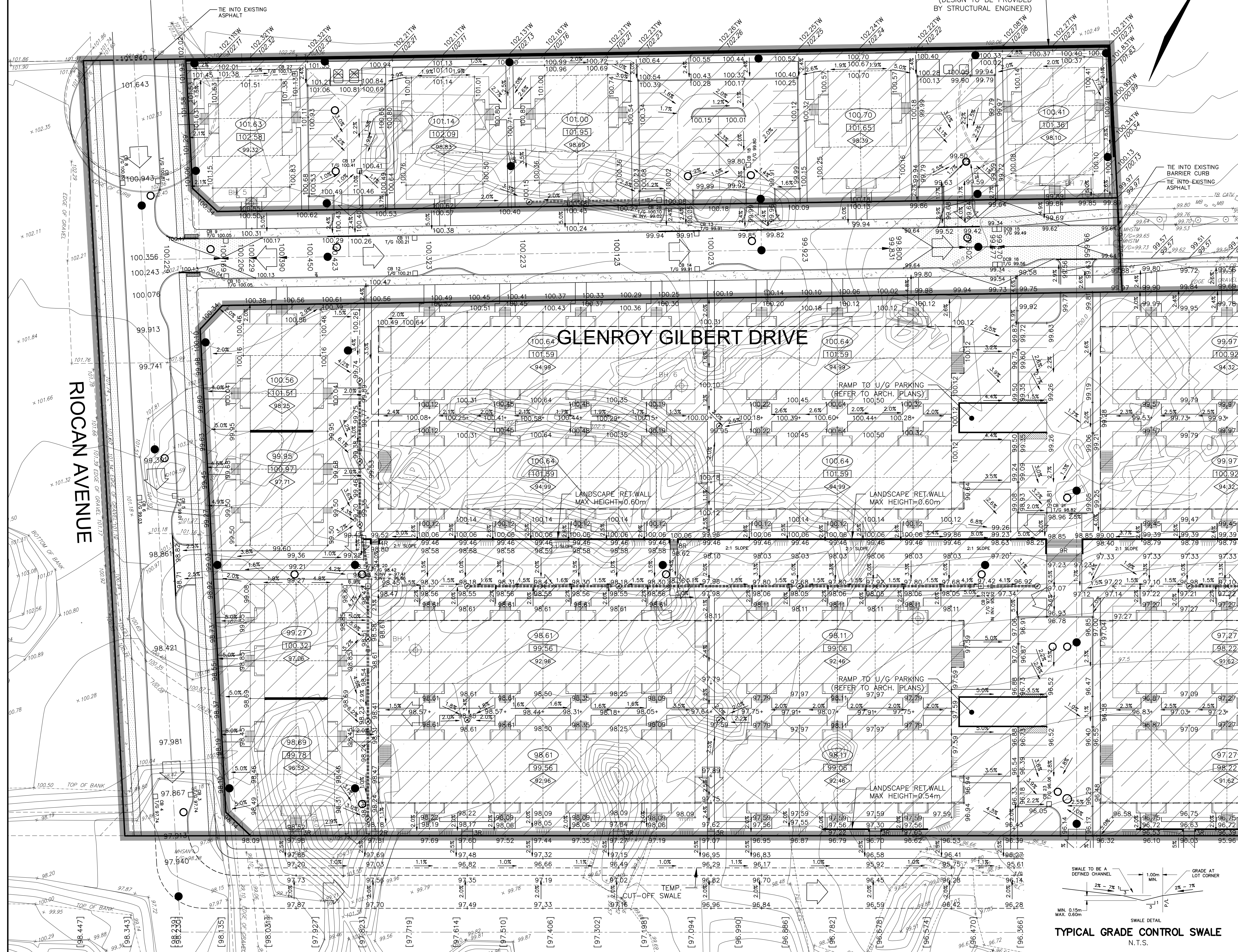

NOT FOR CONSTRUCTION

1	S.L.M.	22-06-10	1ST SUBMISSION
TOPOGRAPHIC INFORMATION			
TOPOGRAPHIC INFORMATION PROVIDED BY STANTEC GEOMATICS LTD., PROJECT No. 161614291-111, DATED MARCH 1, 2022			
SITE PLAN INFORMATION			
SITE PLAN PROVIDED BY SRN ARCHITECTS LTD., PROJECT No. S21001, DATED FEBRUARY 3, 2022			
LEGAL INFORMATION			
CALCULATED I-PLAN PROVIDED BY STANTEC GEOMATICS LTD., PROJECT No. 161614291-111, DATED MARCH 1, 2022			
BENCH MARK			
ELEVATIONS ARE REFERRED TO THE CANADIAN GEODETIC VERTICAL DATUM (CGVD-1928:1978) AND ARE DERIVED FROM BENCHMARK MONUMENT No. 196530071*, HAVING A PUBLISHED ELEVATION OF 99.742 METRES			
MINTO COMMUNITIES INC.		BARRHAVEN TOWN CENTRE GLENROY GILBERT DRIVE & RIOCAN AVENUE ROADWAY EXTENSIONS	
<p>120 Ber Road Unit 103 Slitsville, Ontario, K2S 1E9 Tel. (613) 836-0856 Fax. (613) 836-7183 www.DSEL.ca</p>			
<p>110 Laurier Ave W Ottawa, Ontario, K1P 1J1 Tel. (613) 580-2400 www.Ottawa.ca</p>			
© DSEL			
GRADING PLAN		PROJECT No. 15-816	
DRAWN BY: AM		CHECKED BY: BC	
DESIGNED BY: BC		CHECKED BY: SM	
SCALE: 1:400		SHEET No. 7	

CITY PLAN No. XXXXX
CITY FILE No. D07-XX-XX-XXXX