

LEGEND

- Existing Deciduous Tree to Remain
- Existing Coniferous Tree to Remain
- Proposed Deciduous Tree
- Proposed Coniferous Tree
- Proposed Deciduous Shrub
- Proposed Coniferous Shrub
- Proposed Perennial
- Proposed Bike Rack
- Proposed Barrier-free Signage
- Proposed 1.8m Shadowbox Wood Fence
- Existing 1.8m Board Fence
- Re. L3.0 for planting and furnishing details
- #1- re. comments from City

Key	Botanical Name	Common Name	Qty	Size	Conditions	Spacing	Remarks
Deciduous Trees							
AF	Acer x freemanii 'Celebration'	Celebration Maple	5	60mm cal	WB		full crown
AM	Amelanchier leavis	Redbark Serviceberry	5	50mm cal	WB		full crown
AR	Acer rubrum	Red Maple	5	60mm cal	WB		full crown
GT	Gleditsia triacanthos	Honey Locust	6	60mm cal	WB		full crown
Coniferous Trees							
AB	Abies concolor	White Fir	3	200cm	WB		uniform spread
PP	Picea glauca	White Spruce	3	200cm	WB		uniform spread
Shrubs							
Co	Cornus alba 'Siberica'	Redbark Dogwood	44	40cm 3gal	Cont.	120cm	min. 5 canes
Ju	Juniperus sabinna 'Blue Danube'	Blue Danube Juniper	60	40cm 3 gal	Cont.	100cm	uniform spread
Po	Potentilla fruticosa 'Red Ace'	Red Ace Cinqufoil	20	40cm 3 gal	Cont.	60cm	plant in offset lines / zig zag pattern to fill space
Rh	Rhus aromatica 'Gro-Low'	Fragrant Sumac	53	2gal	Cont.	100cm	plant in offset lines / zig zag pattern to fill space
Sj	Spiraea japonica 'Flaming Mound'	Flaming Mound Spirea	66	40cm 3 gal	Cont.	75cm	plant in offset lines / zig zag pattern to fill space
Ta	Taxus x media 'Wardii'	Ward's Yew	19	40cm 3 gal	Cont.	100cm	plant in offset lines / zig zag pattern to fill space
Perennials / Ornamental Grasses							
ach	Achillea millefolium 'Paprika'	Paprika Yarrow	129	1gal	Cont.	50cm	plant in offset lines / zig zag pattern to fill space
hem	Hemerocallis 'Anzac'	Anzac Daylily	286	1gal	Cont.	50cm	plant in offset lines / zig zag pattern to fill space
pan	Panicum virgatum 'Prairie Fire'	Prairie Fire Switch Grass	92	1gal	Cont.	60cm	plant in offset lines / zig zag pattern to fill space
rud	Rudbeckia 'Hirta'	Black Eyed Susan	242	1gal	Cont.	50cm	plant in offset lines / zig zag pattern to fill space

PLANT NOTES:
 ALL PLANT MATERIAL SUBJECT TO STANDARD TWO (2) YEAR MAINTENANCE PERIOD COMMENCING UPON ISSUANCE DATE OF THE CERTIFICATE OF SUBSTANTIAL COMPLETION AND ACCEPTANCE OF THE ABOVE GROUND WORKS.
 QUANTITIES INDICATED ON THE PLAN TO GOVERN.
 DO NOT PLANT IN SWALE CENTRES.
 ▲ THE MINIMUM OF SOIL AREA PER TREE IS 10 SQUARE METERS.

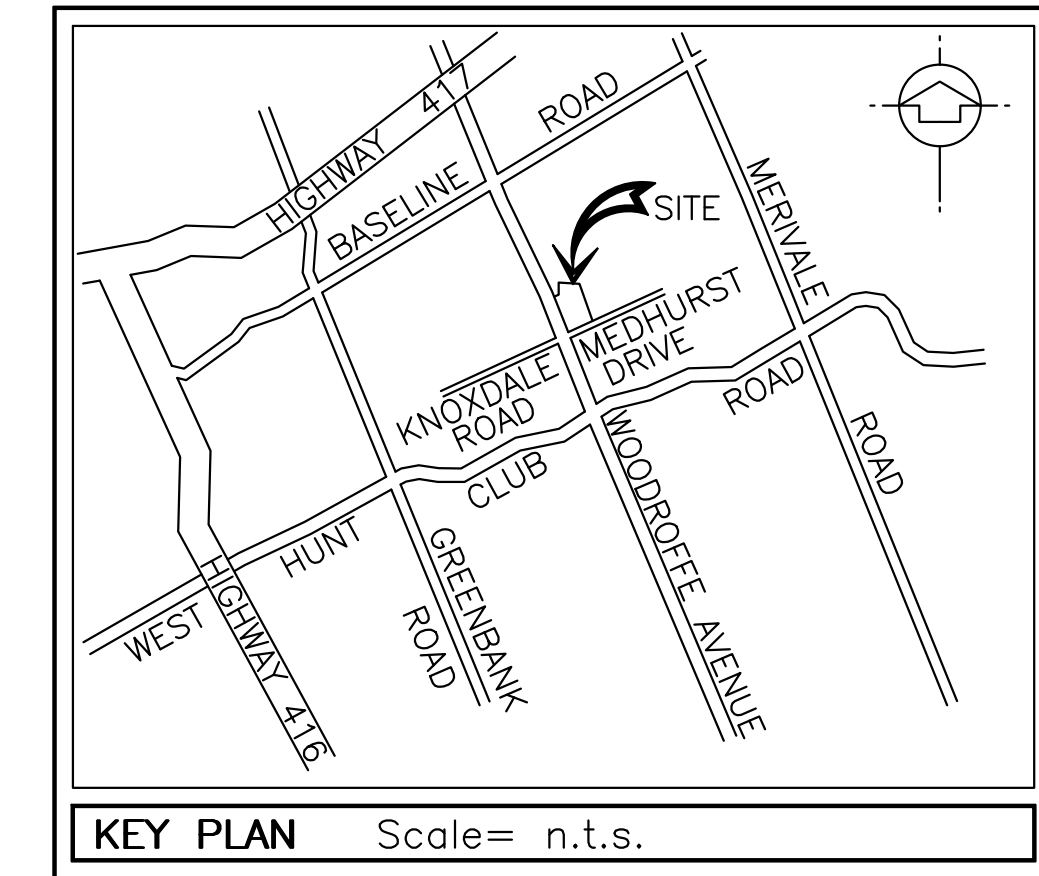

wood.
 Unless otherwise agreed in a written contract between Wood and its client, this document: (i) contains information, data and design that is confidential and may not be copied or disclosed; and (ii) may be used by the client only in the context and for the express purpose for which it was intended. Any use of, or reliance on, this document by any third party is the party's sole risk.
 COPYRIGHT NOTICE
 This drawing is the property of the above referenced Professional and is not to be used for any purpose other than the specific project and site named herein, and cannot be reproduced in any manner without the express written permission from the Professional.
 04/21/21 FOR CLIENT REVIEW
 04/27/21 ISSUED FOR SPA
 09/21/21 RE-ISSUED FOR SPA
 12/03/21 RE-ISSUED FOR SPA
 04/01/22 RE-ISSUED FOR SPA
 06/03/22 RE-ISSUED FOR SPA

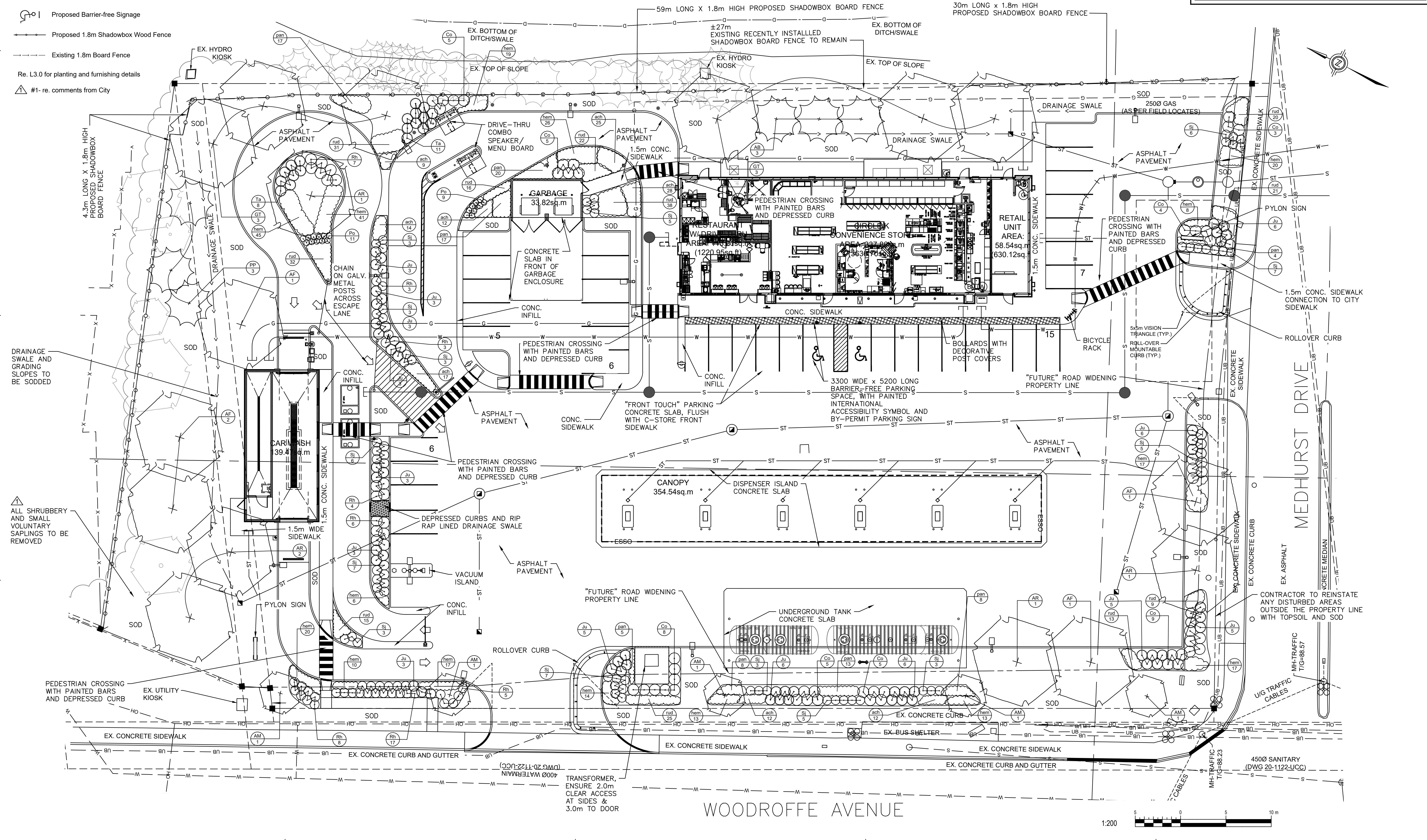

ska
 Stempski Kelly Associates Inc.
 Design Landscape Architecture Planning
 P.O. Box 399, Fergus, ON, N1M 3E2
 Voice (519) 787 4313
 stasio@ska-design.ca www.ska-design.ca

PROFESSIONAL IN CHARGE
 S. STEMPSKI
PROJECT MANAGER
 S. LAWRENCE
QUALITY CONTROL
 F. RIVARD
DRAWN BY
 J. YI

PROJECT NAME
CIRCLE K STORES INC.
R&R No. 52287

NEPEAN ONTARIO
 1545 WOODROFFE AVENUE
 NEPEAN, ON, CANADA
 K2G 1W2



PROJECT NUMBER
 BE20207036
SHEET TITLE

LANDSCAPE PROPOSED PLANTING AND LANDSCAPING PLAN

SHEET NUMBER
L2.0

