

- LEGEND**
- PROPERTY LINE
 - SAN MH 201 ● PROPOSED SANITARY MH & SEWER
 - CBMH 104 ○ PROPOSED CATCHBASIN MANHOLE & SEWER (c/w 3.0m RADIAL SUBDRAINS PER GEOTECH)
 - STM MH 103 ○ PROPOSED STORM MANHOLE & SEWER (c/w 3.0m RADIAL SUBDRAINS PER GEOTECH)
 - CB 03 □ PROPOSED CATCHBASIN AND LEAD
 - HYD 2 ○ VB PROPOSED HYDRANT AND VALVE
 - DC — PROPOSED BARRIER CURB (15cm CURB HEIGHT)
 - MC — PROPOSED DEPRESSED BARRIER CURB (0cm CURB HEIGHT)
 - DMC — PROPOSED MOUNTABLE CURB (5cm CURB HEIGHT)
 - DMC — PROPOSED DEPRESSED MOUNTABLE CURB (0cm CURB HEIGHT)
 - 200mmØ — PROPOSED WATERMAIN AND DIAMETER
 - VB ○ PROPOSED VALVE AND VALVEBOX
 - BEND ○ PROPOSED BEND AND THRUSTBLOCK 11.25°, 22.5°, 45° or TEE
 - Ⓜ ○ PROPOSED WATER METER AND REMOTE METER
 - PROPOSED CAP
 - RESTRICTOR PIPE | PROPOSED RESTRICTOR PIPE / INLET CONTROL DEVICE
 - DS ○ PROPOSED DOWNSPOUT LOCATION
 - THERMAL INSULATION FOR SHALLOW SEWERS
 - ▼ PROPOSED BUILDING ENTRANCE
 - C.S. — PROPOSED CLAY SEAL SEEPAE BARRIER (PER GEOTECHNICAL REPORT)
 - SL ○ PROPOSED SITE LIGHTING POLE (REFER TO ELEC)
 - ▲ PROPOSED TRANSFORMER
 - EXISTING CONCRETE CURB
 - SANMH ○ EXISTING SANITARY MANHOLE AND SEWER
 - CBMH ○ EXISTING CATCHBASIN MANHOLE
 - STM MH ○ EXISTING STORM MANHOLE AND SEWER
 - CB □ EXISTING CATCHBASIN CW CATCHBASIN LEAD
 - HYD ○ EXISTING HYDRANT
 - EX UP ○ EXISTING UTILITY POLE CW WIRES
 - 300mmØ WM — EXISTING WATERMAIN
 - HYD ○ EXISTING HYDRANT CW VALVE & LEAD
 - LS ○ EXISTING LIGHT STANDARD
 - EXISTING FENCE
 - EXISTING OVERHEAD UTILITY WIRES

BENCHMARK INFO:
 CUT CROSS LOCATED ON THE TOP OF THE EXISTING CONCRETE HEADWALL NEAR THE WEST LIMIT OF THE MUNICIPAL STORM SEWER OUTFALL TO THE CARP RIVER. GEODETIC ELEVATION = 93.77m
 ALL ELEVATIONS ARE REFERRED TO THE CGVD28 78 GEODETIC DATUM, DERIVED FROM VERTICAL CONTROL MONUMENT NO. 00119883075 HAVING A PUBLISHED ELEVATION OF 90.612 METRES. BEARINGS ARE GRID, DERIVED FROM THE OLS FIELD OBSERVATIONS USING REAL TIME NETWORK (RTN) OBSERVATIONS AND ARE REFERRED TO THE CENTRAL MERIDIAN OF MTM ZONE 9, NAD-83 (CSRS) 2010.0.
 THE EXISTING GRADES SHOWN ON THE PLANS ARE TAKEN DIRECTLY FROM TOPOGRAPHICAL SURVEY PLAN (Ref. # 21-10-026-00), PREPARED BY J.D. BARNES LIMITED COMPLETED ON APRIL 8, 2021.
 SURROUNDING BACKGROUND TOPO INFORMATION BEYOND THE LIMITS OF THE SITE SURVEY ARE SHOWN FROM CITY OF OTTAWA 1:2000 MAPPING FOR CONTEXT ONLY.

REFER TO PLAN 121326-NDT FOR CIVIL NOTES, DETAILS AND TABLES

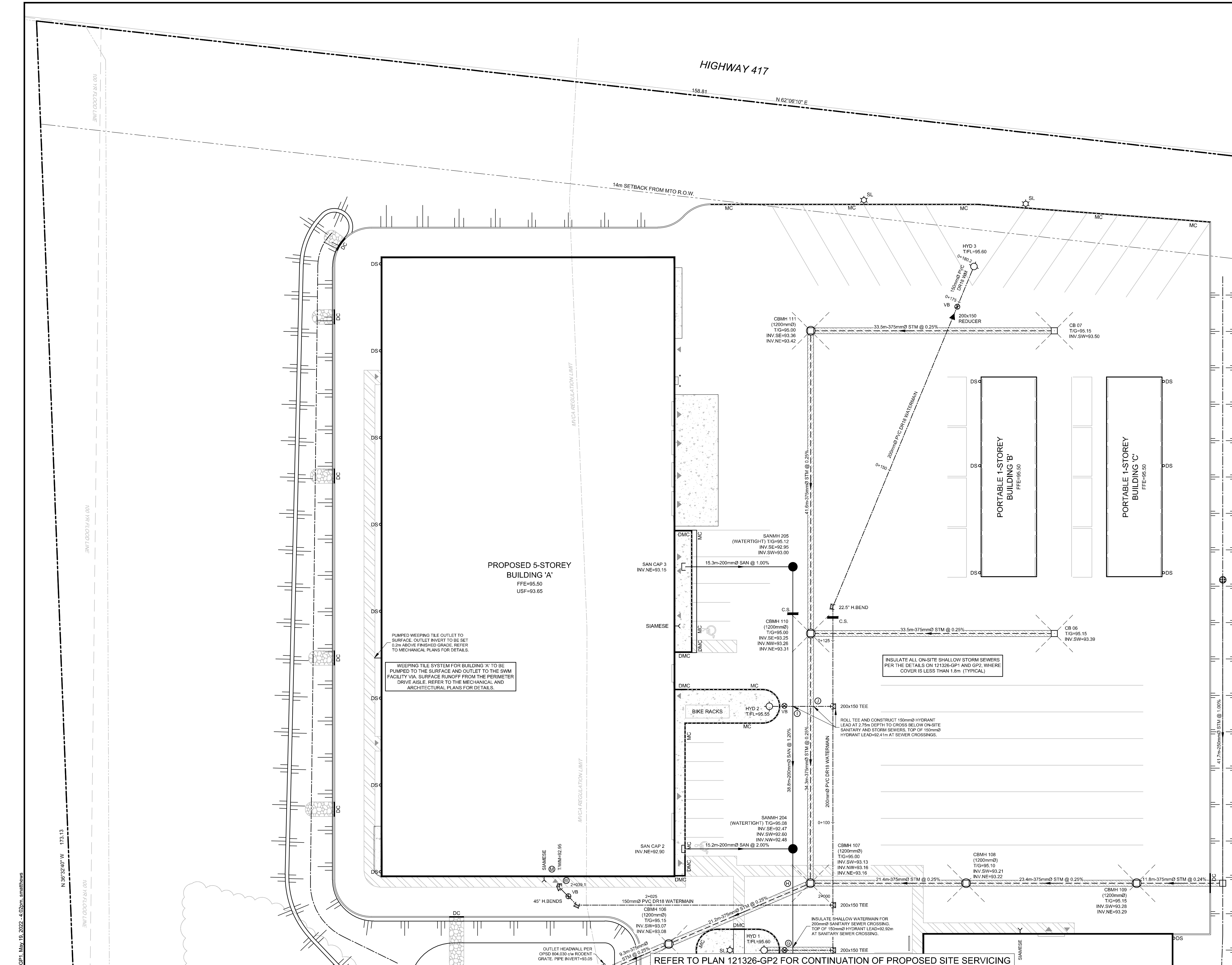

PROPOSED 5-STOREY BUILDING 'A'
 FFE=95.50
 USF=93.65

PUMPED WEIRING TILE OUTLET TO SURFACE, OUTLET INVERT TO BE SET 0.3m ABOVE FINISHED GRADE. REFER TO MECHANICAL PLANS FOR DETAILS.

WEIRING TILE SYSTEM FOR BUILDING 'A' TO BE PUMPED TO THE SURFACE AND OUTLET TO THE SWM FACILITY VIA SURFACE RUNOFF FROM THE PERIMETER DRIVE AISLE. REFER TO THE MECHANICAL AND ARCHITECTURAL PLANS FOR DETAILS.

INSULATE ALL ON-SITE SHALLOW STORM SEWERS PER THE DETAILS ON 121326-GP1 AND GP2, WHERE COVER IS LESS THAN 1.8m (TYPICAL)

REFER TO PLAN 121326-GP2 FOR CONTINUATION OF PROPOSED SITE SERVICING

NOTE:
 THE POSITION OF ALL POLE LINES, CONDUITS, WATERMANS, SEWERS AND OTHER UNDERGROUND AND OVERGROUND UTILITIES AND STRUCTURES IS NOT NECESSARILY SHOWN ON THE CONTRACT DRAWINGS, AND WHERE SHOWN, THE ACCURACY OF THE POSITION OF SUCH UTILITIES AND STRUCTURES IS NOT GUARANTEED. BEFORE STARTING WORK, DETERMINE THE EXACT LOCATION OF ALL SUCH UTILITIES AND STRUCTURES AND ASSUME ALL LIABILITY FOR DAMAGE TO THEM.

OWNER INFORMATION
 U-HAUL CANADA
 3636 INNES ROAD
 OTTAWA, ONTARIO, K1C 1T1
 DAVID POLLOCK
 PHONE: 1-800-263-6555
 david_pollock@uhaul.com

No.	REVISION	DATE	BY
1	ISSUED FOR SITE PLAN APPROVAL	MAY 20/22	FST

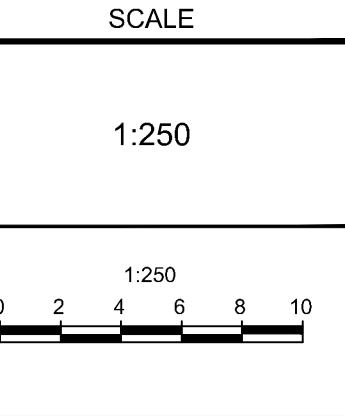

DESIGN	SM / FST
CHECKED	FST
DRAWN	SM
CHECKED	SM / FST
APPROVED	FST



NOVATECH
 Engineers, Planners & Landscape Architects
 Suite 200, 240 Michael Cowpland Drive
 Ottawa, Ontario, Canada K2M 1P6
 Telephone: (613) 254-9643
 Facsimile: (613) 254-5867
 Website: www.novatech-eng.com

LOCATION CITY OF OTTAWA 30 FRANK NIGHBOR PLACE: U-HAUL SITE		PROJECT No. 121326
DRAWING NAME GENERAL PLAN OF SERVICES		REV #1 REV #1
DRAWING No. 121326-GP1		Plan #

M:\2022\121326-GP2\Drawings\121326-GP2.dwg, GP1, May 19, 2022, 4:02pm, smathews

D07-12-22-