

GRADING PLAN AND EROSION & SEDIMENT CONTROL PLAN

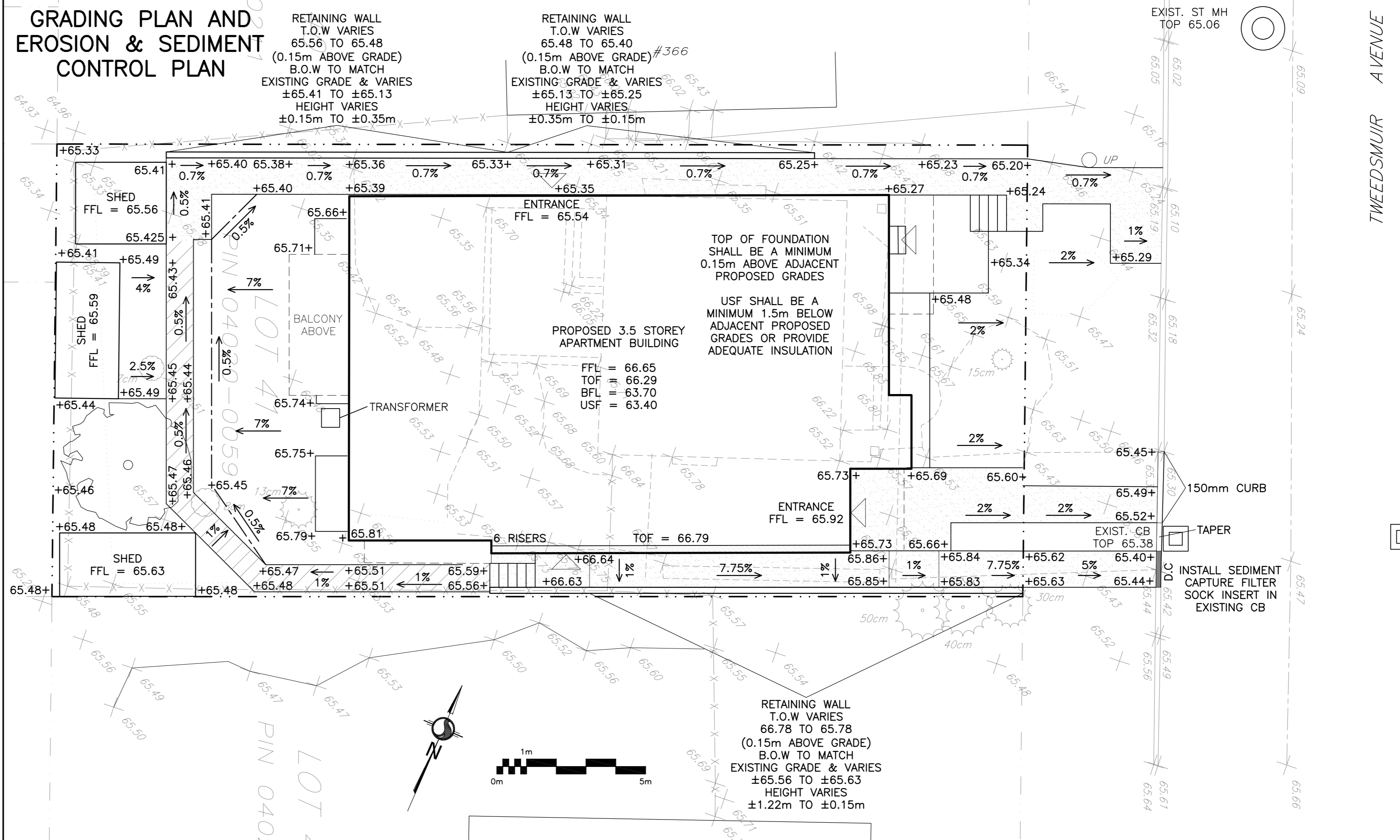

LEGEND

FFL	FINISHED FLOOR ELEVATION
TOF	TOP OF FOUNDATION
BFL	BASEMENT FLOOR ELEVATION
USF	UNDERSIDE OF FOOTING
---	PROPERTY LINE
CB	CATCH-BASIN
MH	STORM MANHOLE
+99.99	EXISTING GRADE ELEVATION
+99.99	PROPOSED GRADE ELEVATION
2%	PROPOSED SLOPE OF GRADE
---	CENTERLINE OF SWALE
---	150mm BARRIER CURB
D.C.	DEPRESSED CURB
○	ROOF DRAIN
///	PAVEMENT
■	CONCRETE

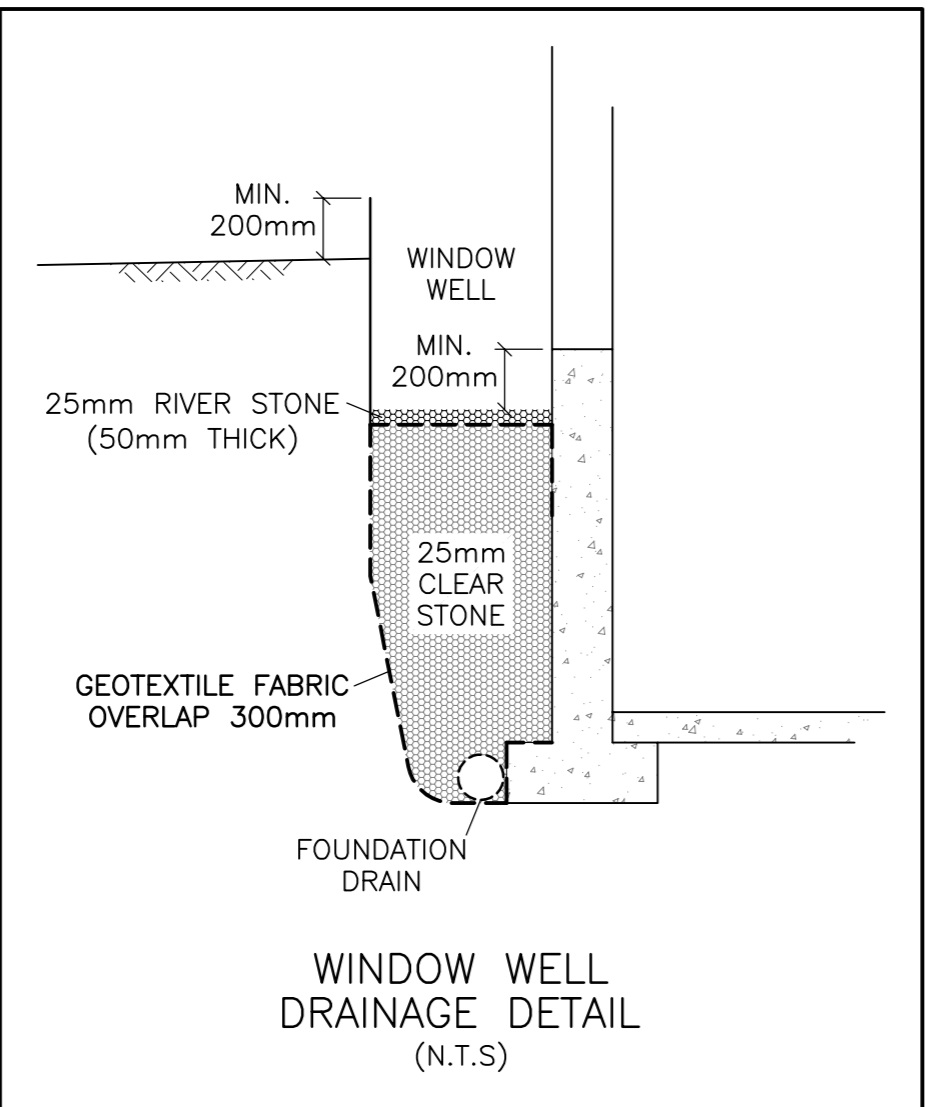
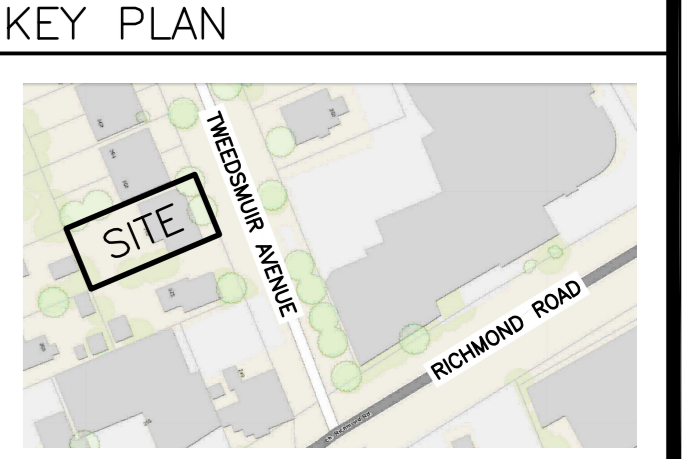

ROOF PLAN

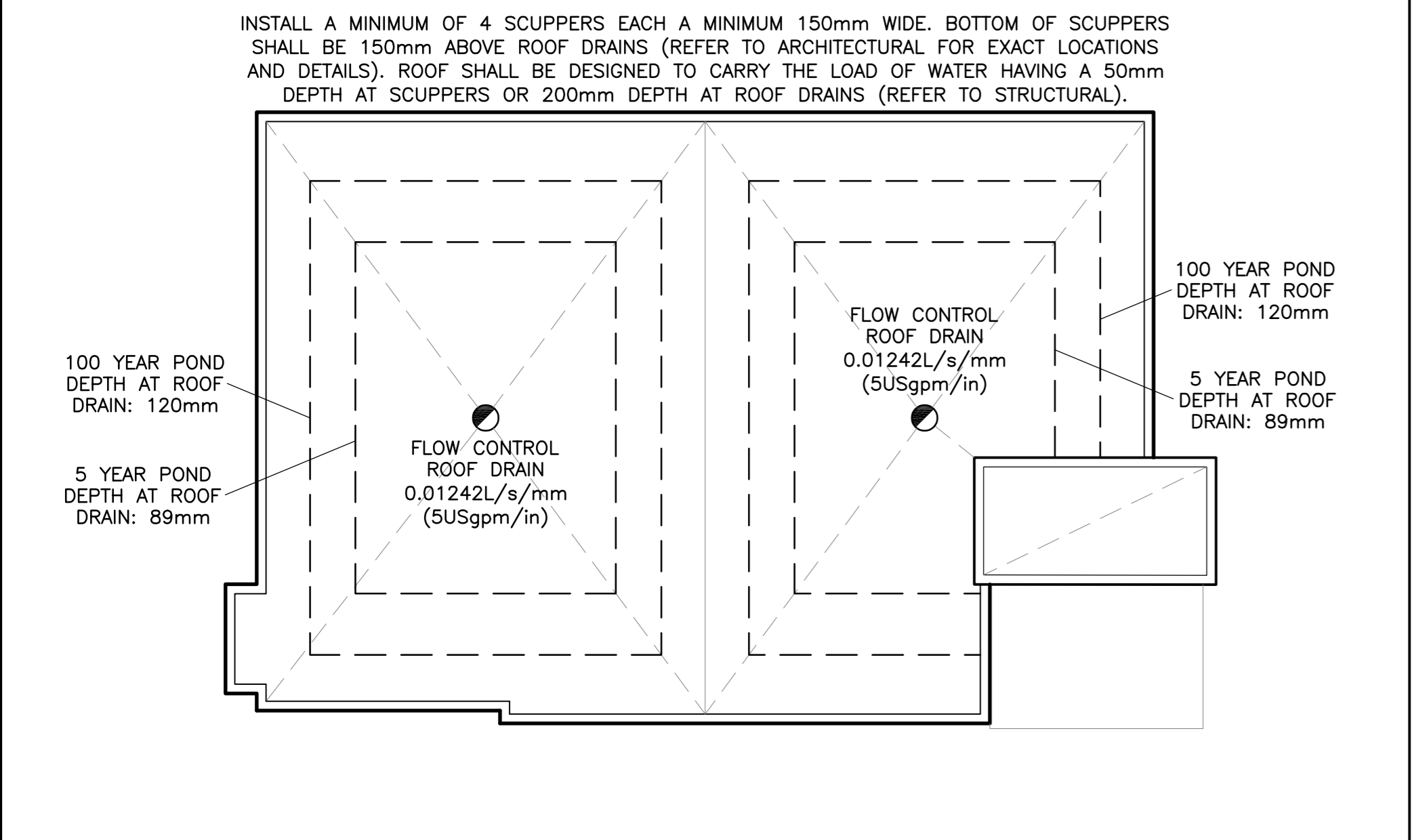

LEGEND

DRAINAGE AREA	AREA (sq.m)
x	xxx
0.xx	

5 YEAR RUNOFF COEFFICIENT

DRAINAGE PLAN

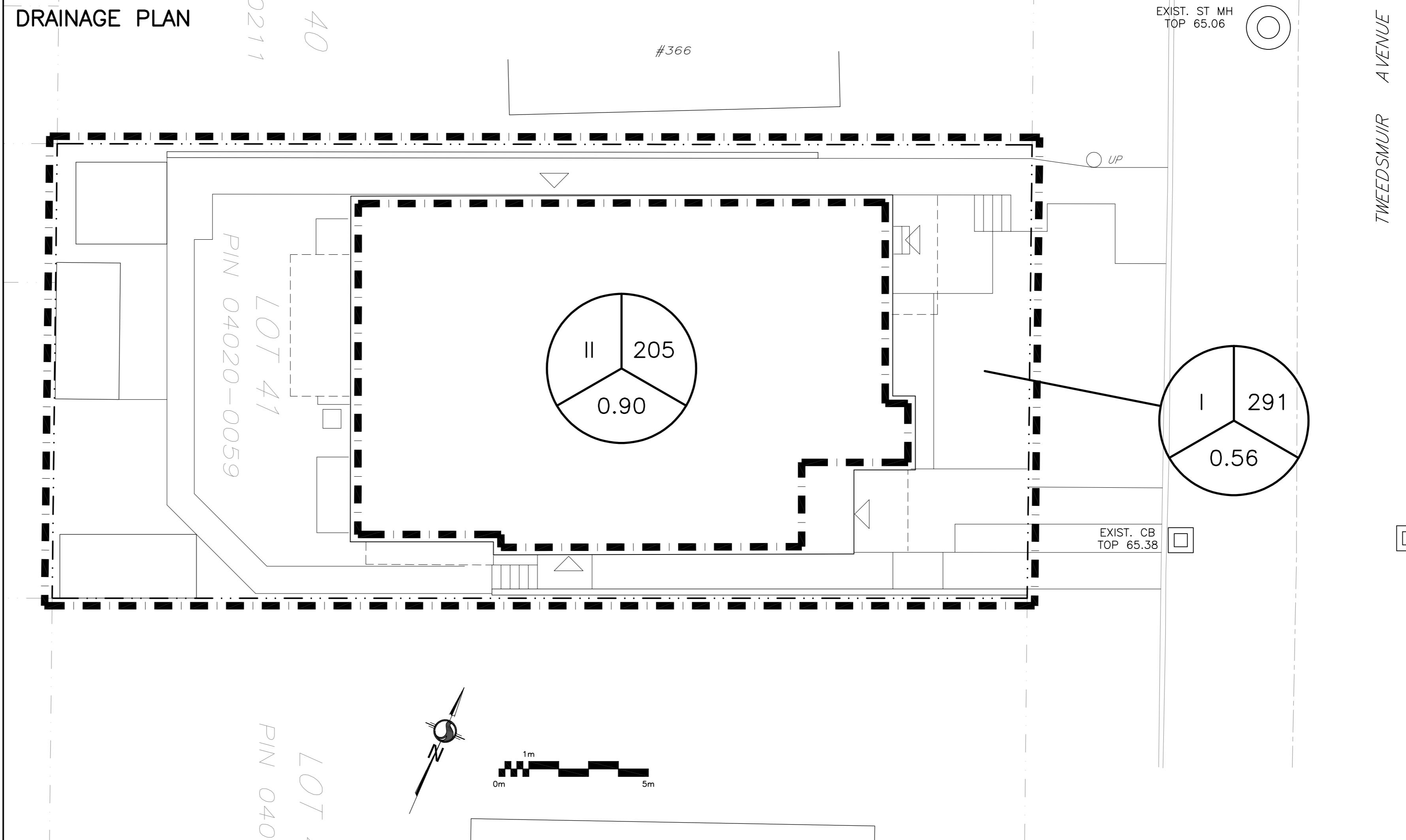

No.	DATE	REVISION
2	MAY 12-22	ISSUED FOR APPROVAL
1	APR 22-22	ISSUED FOR COORDINATION

D. B. GRAY ENGINEERING INC.
Stormwater Management - Grading & Drainage - Storm & Sanitary Sewers - Retention
700 Long Point Circle Ottawa, Ontario
613-425-8044
d.gray@dbgrayengineering.com

Project
PROPOSED 3.5-STORY APARTMENT BUILDING
368 TWEEDSMUIR AVENUE
OTTAWA, ONTARIO

Drawing Title
GRADING PLAN, SEDIMENT CONTROL PLAN AND DRAINAGE PLAN

Engineer's Seal

NOT VALID UNLESS SIGNED & DATED

Drawn	D.B.G
H. Scale	1:100
V. Scale	
Date	APR 22-22
Job No.	22028

Drawing No.
C-2 of 3

REFER TO NOTES DRAWING C-3