

LEVEL P2
 GFA = 15,721 ft²
 RES = 40
 VIS = 0
 TOTAL = 40 PARKING SPACES

BIKE PARKING = 33
 LOCKERS = 32

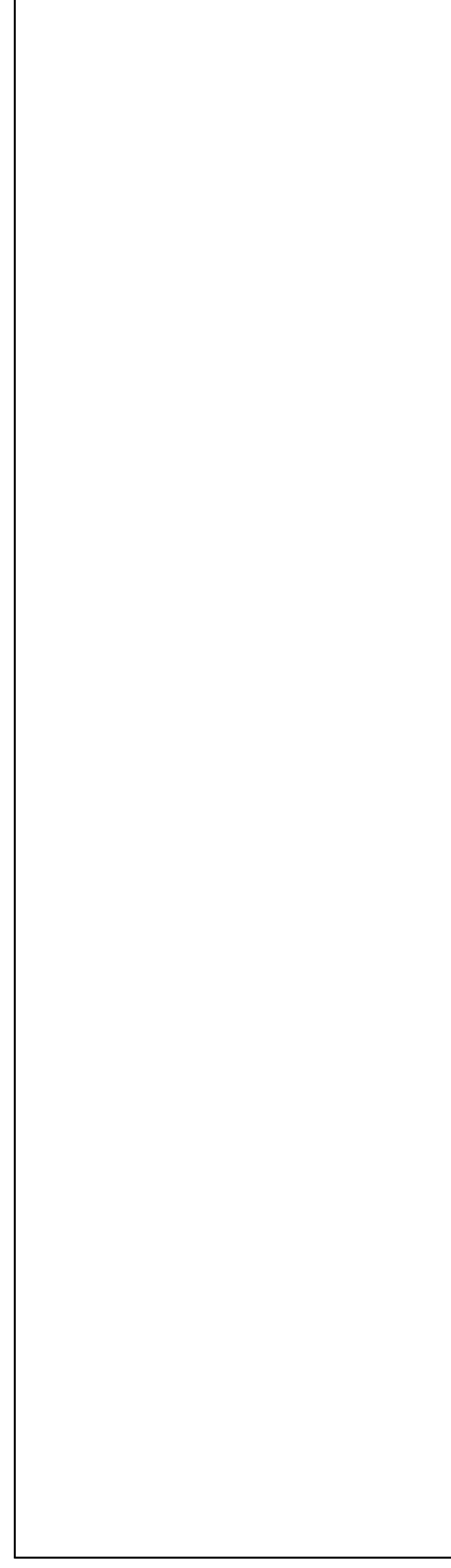
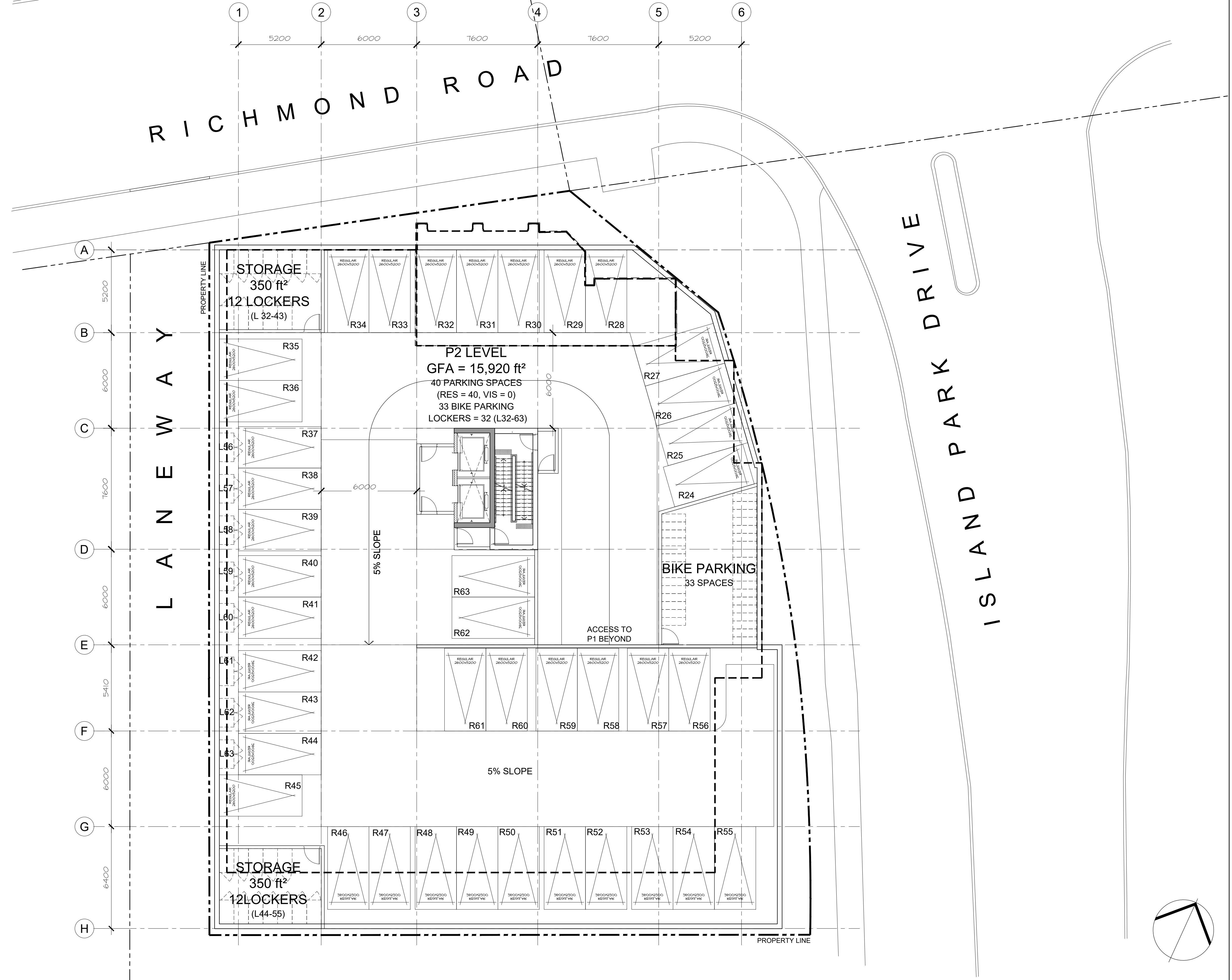

no.	date	revision
01	19/MAY/22	ISSUED FOR SPA

It is the responsibility of the appropriate contractor to check and verify all dimensions on site and report all errors and/or omissions to the architect.

All contractors must comply with all pertinent codes and by-laws.

Do not scale drawings.

This drawing may not be used for construction until signed.

Copyright reserved.

Hobin Architecture Incorporated
 63 Pamela Street
 Ottawa, Ontario
 Canada K1S3K7
 T: 613-236-7200
 F: 613-235-2005
 E: mail@hobinarc.com
 hobinarc.com

HOBIN ARCHITECTURE

PROJECT/LOCATION:
 70 RICHMOND

DRAWING TITLE:
 LEVEL P2 PLAN

DRAWN BY: RL	DATE: 2022-05-13	SCALE: 1:125
PROJECT: 1909		DRAWING NO.:
		A1.02
		REVISION NO.:
		DWG 0000

1 LEVEL P2 PLAN
 A1.02 1:125

DATE PLOT
 DWG NAME