

TOPOGRAPHICAL PLAN OF SURVEY
PART OF LOT 1
CONCESSION 5 (RIDEAU FRONT)
Geographic Township of Nepean
CITY OF OTTAWA
Surveyed by Annis, O'Sullivan, Vollebakk Ltd.
Plan Amended September 7, 2017 to illustrate additional services.

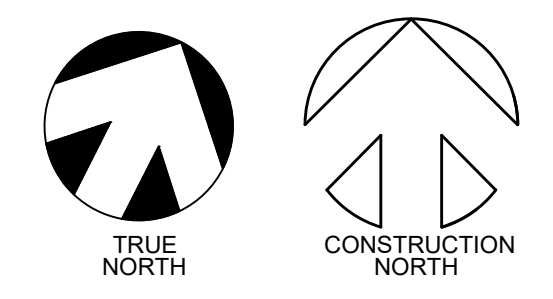

| OWNERS | APPLICANT |
|--|--|
| OWNERS NAME: The Catholic Church of St. Laurent (CHORAC) ADDRESS: 1196 Wellington St. West, Ottawa, ON, K1Y 2Z5 (613) PHONE #: 725-1432 | REINDERS + LAW LTD. 64 ONTARIO STREET NORTH, MILTON ON L9T 2T1 P (905)457-1618 F (905)457-8852 |

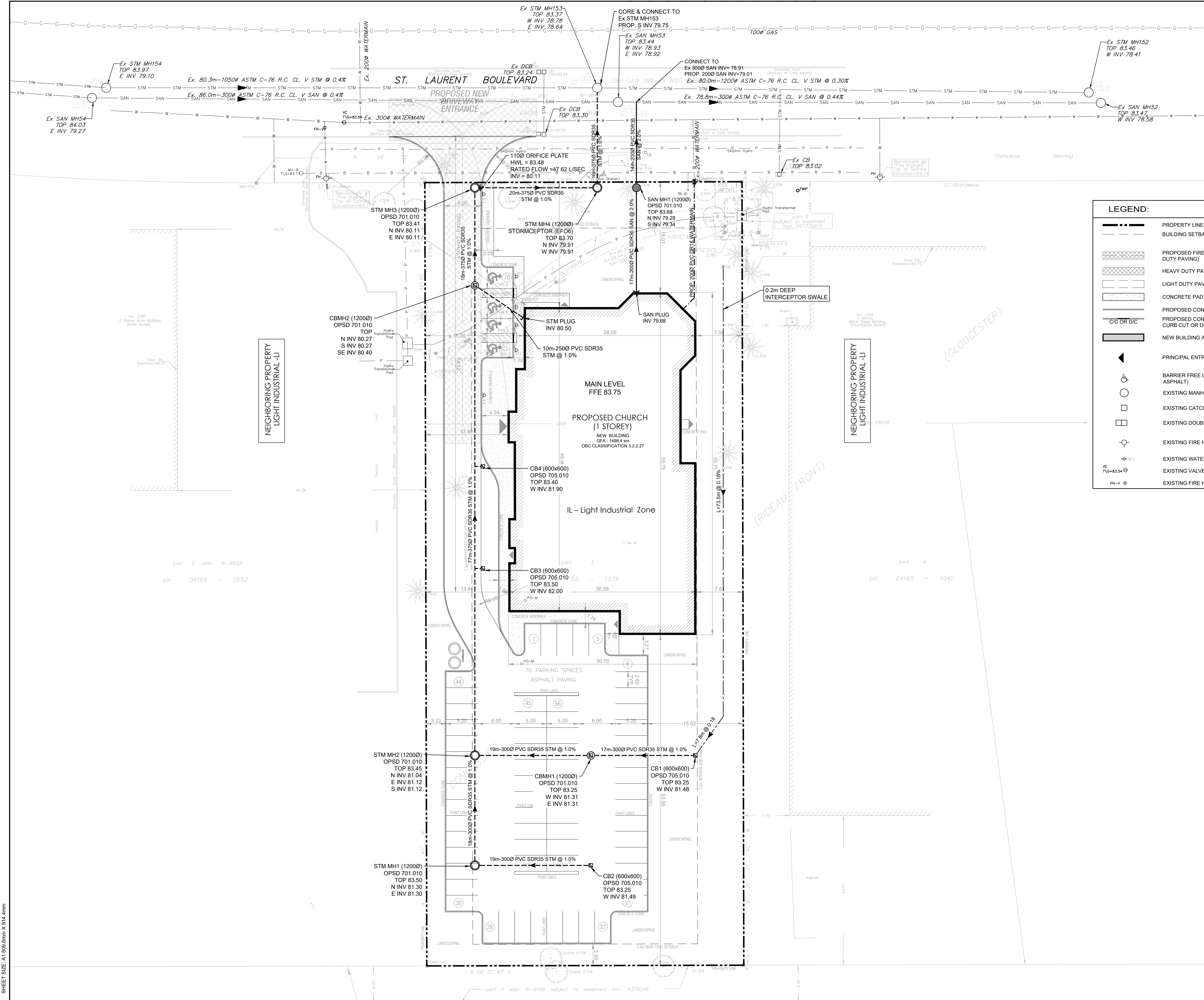
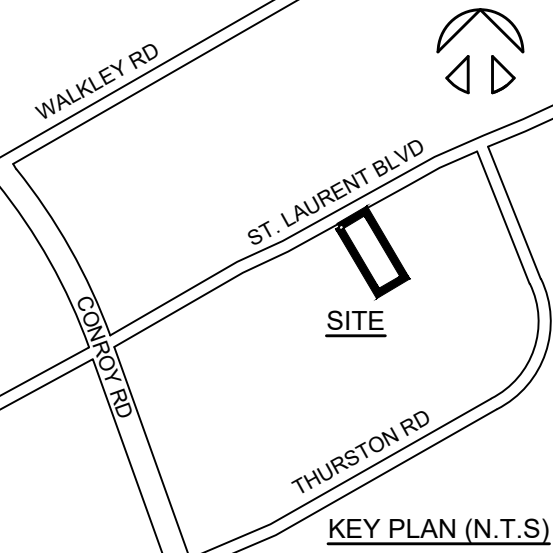

LEGEND:

| | | | |
|--|--|--|------------------------------|
| | PROPERTY LINE | | PROPOSED SANITARY MANHOLE |
| | BUILDING SETBACK LINE | | PROPOSED STORM MANHOLE |
| | PROPOSED FIRE ROUTE (USING HEAVY DUTY PAVING) | | PROPOSED CATCH BASIN MANHOLE |
| | HEAVY DUTY PAVING | | PROPOSED CATCH BASIN |
| | LIGHT DUTY PAVING | | PROPOSED VALVE & BOX |
| | CONCRETE PAD OR SIDEWALK | | EXISTING GAS |
| | PROPOSED CONCRETE CURB | | EXISTING UNDERGROUND POWER |
| | PROPOSED CONCRETE CURB WITH CURB CUT OR DEPRESSED CURB | | EXISTING UNDERGROUND BELL |
| | C/C OR D/C | | EXISTING WATER PIPE |
| | PRINCIPAL ENTRANCE TO THE BUILDING | | EXISTING SANITARY PIPE |
| | BARRIER FREE LOGO (PAVED ON ASPHALT) | | EXISTING STORM PIPE |
| | EXISTING MANHOLE | | PROPOSED WATER PIPE |
| | EXISTING CATCH BASIN | | PROPOSED SANITARY PIPE |
| | EXISTING DOUBLE CATCH BASIN | | PROPOSED STORM PIPE |
| | EXISTING FIRE HYDRANT | | |
| | EXISTING WATER VALVE | | |
| | EXISTING VALVE CHAMBER FOR WATERMAIN | | |
| | EXISTING FIRE HYDRANT VALVE | | |

| | | | |
|-----|---------------------|------------|-------|
| 0 | ISSUED FOR APPROVAL | 02/14/2022 | YA |
| no. | revisions | date | init. |

GENERAL NOTE:
THESE DRAWINGS ARE COPYRIGHT AND THE PROPERTY OF REINDERS + LAW LTD. THE DRAWINGS MAY NOT BE USED FOR CONSTRUCTION WITHOUT THE PERMISSION OF REINDERS + LAW LTD. AND UNLESS SEALED AND SIGNED BY THE ARCHITECT/ENGINEER REPRODUCTION OF THESE DRAWINGS WITHOUT THE CONSENT OF REINDERS + LAW LTD. IS STRICTLY PROHIBITED.
DO NOT SCALE THESE DRAWINGS. ANY ERROR OR DISCREPANCY IS TO BE REPORTED IMMEDIATELY TO: REINDERS + LAW LTD.

cad file 20037_SP3
date plotted 12/09/2021 plot scale 1:1

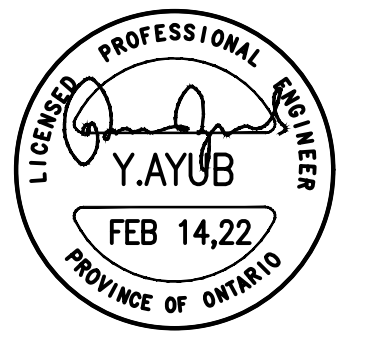

drawn CC
designed YA
reviewed YA
date 2/14/2022
scale 1:300

project
CHORAC OTTAWA
2375 ST. LAURENT BLVD
OTTAWA, ON

drawing
COMPOSITE UTILITY PLAN

REINDERS + LAW
ARCHITECTURE, ENGINEERING
REINDERS + LAW LTD.
ARCHITECTURE, ENGINEERING
64 ONTARIO STREET NORTH
MILTON ON L9T 2T1
T. 905.457.1618 F. 905.457.8852
EMAIL@REINDERS.CA WWW.REINDERS.CA

drawing no. 20037_SP6 rev. no. 0