

EROSION AND SEDIMENT CONTROL NOTES

1. THE CONTRACTOR SHALL IMPLEMENT BEST MANAGEMENT PRACTICES, TO PROVIDE FOR PROTECTION OF THE AREA DRAINAGE SYSTEM AND THE RECEIVING WATERCOURSE, DURING CONSTRUCTION ACTIVITIES. THIS INCLUDES LIMITING THE AMOUNT OF EXPOSED SOIL, USING FILTER CLOTH UNDER THE GRATES OF CATCHBASINS AND MANHOLES, AND INSTALLING SILT FENCES AND OTHER EFFECTIVE SEDIMENT TRAPS. THE CONTRACTOR ACKNOWLEDGES THAT FAILURE TO IMPLEMENT APPROPRIATE EROSION AND SEDIMENT CONTROL MEASURES MAY BE SUBJECT TO PENALTIES IMPOSED BY ANY APPLICABLE REGULATORY AGENCY.
2. THE SEDIMENT CONTROL MEASURES SHALL ONLY BE REMOVED WHEN, IN THE OPINION OF THE ENGINEER, THE MEASURES ARE NO LONGER REQUIRED. NO CONTROL MEASURES MAY BE PERMANENTLY REMOVED WITHOUT PRIOR AUTHORIZATION FROM THE ENGINEER.
3. REGULAR INSPECTION AND MAINTENANCE OF THE EROSION AND SEDIMENT MEASURES SHALL BE UNDERTAKEN. THE IMPLEMENTATION AND ADJUSTMENT AND/OR CORRECTIVE MAINTENANCE OF THE EROSION AND SEDIMENT MEASURES IS AN INTEGRAL PART OF THE PLAN AND MUST BE PERFORMED.
4. GEOTEXTILE FILTER FABRIC SHALL BE PLACED BETWEEN THE STRUCTURE FRAME AND COVER FOR ALL MANHOLES, CATCHBASINS, AND CATCHBASIN MANHOLES IN THE VICINITY OF WORK.
5. THE CONTRACTOR SHALL MAINTAIN ADJACENT ROADS IN A CLEAN CONDITION AT ALL TIMES.
6. PROVIDE MUD MATS AT SITE CONSTRUCTION ENTRANCE(S) AND EGRESS(S).

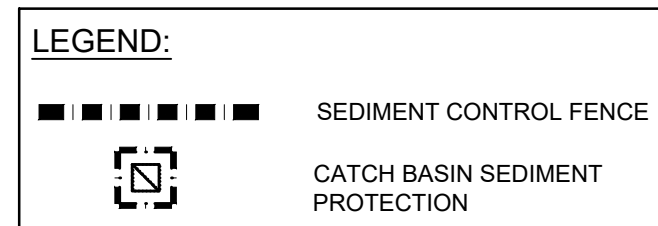

TOPOGRAPHICAL PLAN OF SURVEY
 PART OF LOT 1
 CONCESSION 5 (RIDEAU FRONT)
 Geographic Township of Nepean
 CITY OF OTTAWA
 Surveyed by Annis, O'Sullivan, Vollebek Ltd.
 Plan Amended September 7, 2017 to illustrate additional services.

OWNERS	APPLICANT
OWNERS NAME: The Catholic House of Refuge Apostolic Church (CHORAC) ADDRESS: 1196 Wellington St. West, Ottawa, ON, K1Y 2Z5 (613) PHONE #: 725-1432	REINDERS + LAW LTD. 64 ONTARIO STREET NORTH, MILTON ON L9T 2T1 P (905)457-1618 F (905)457-8852

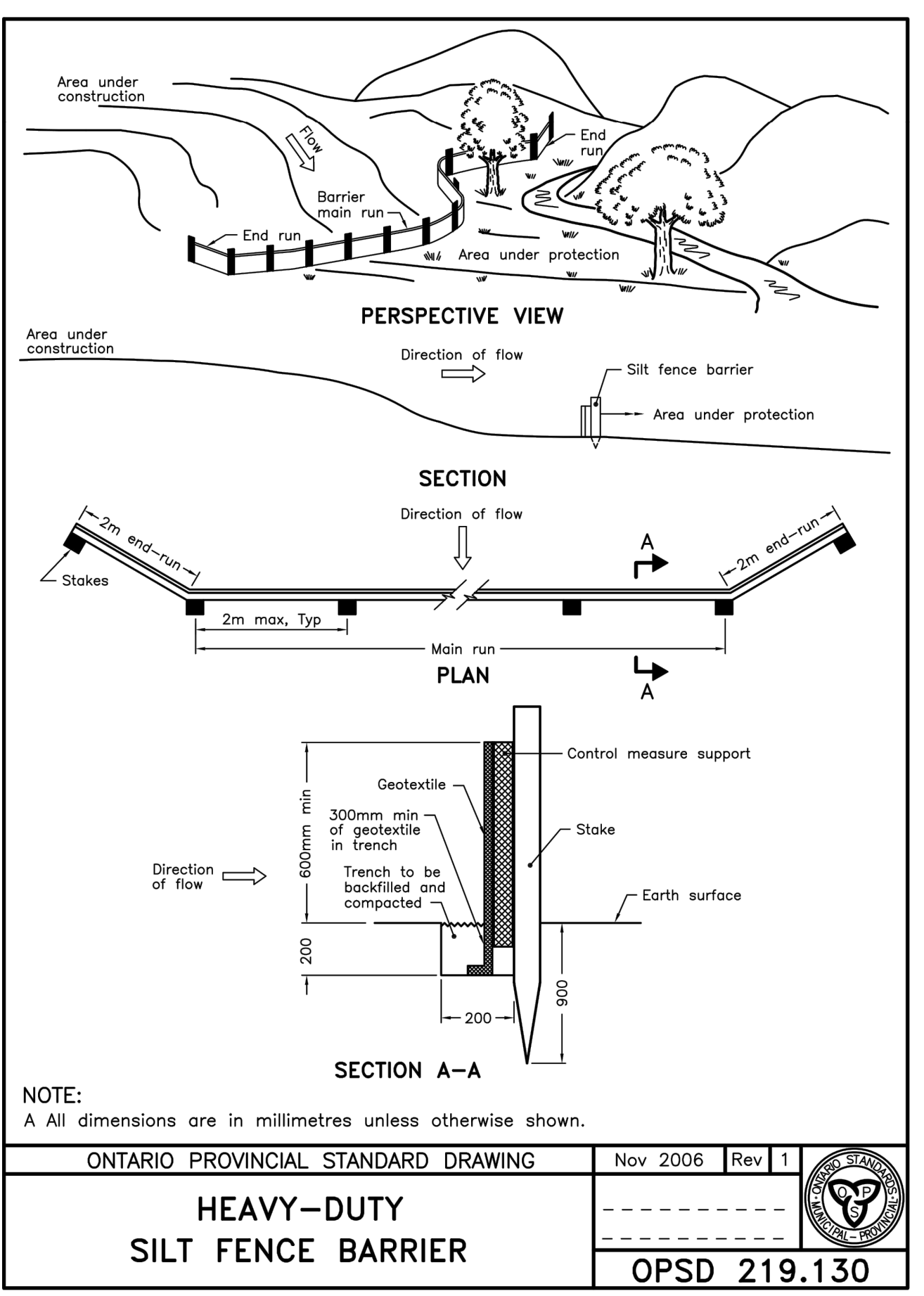
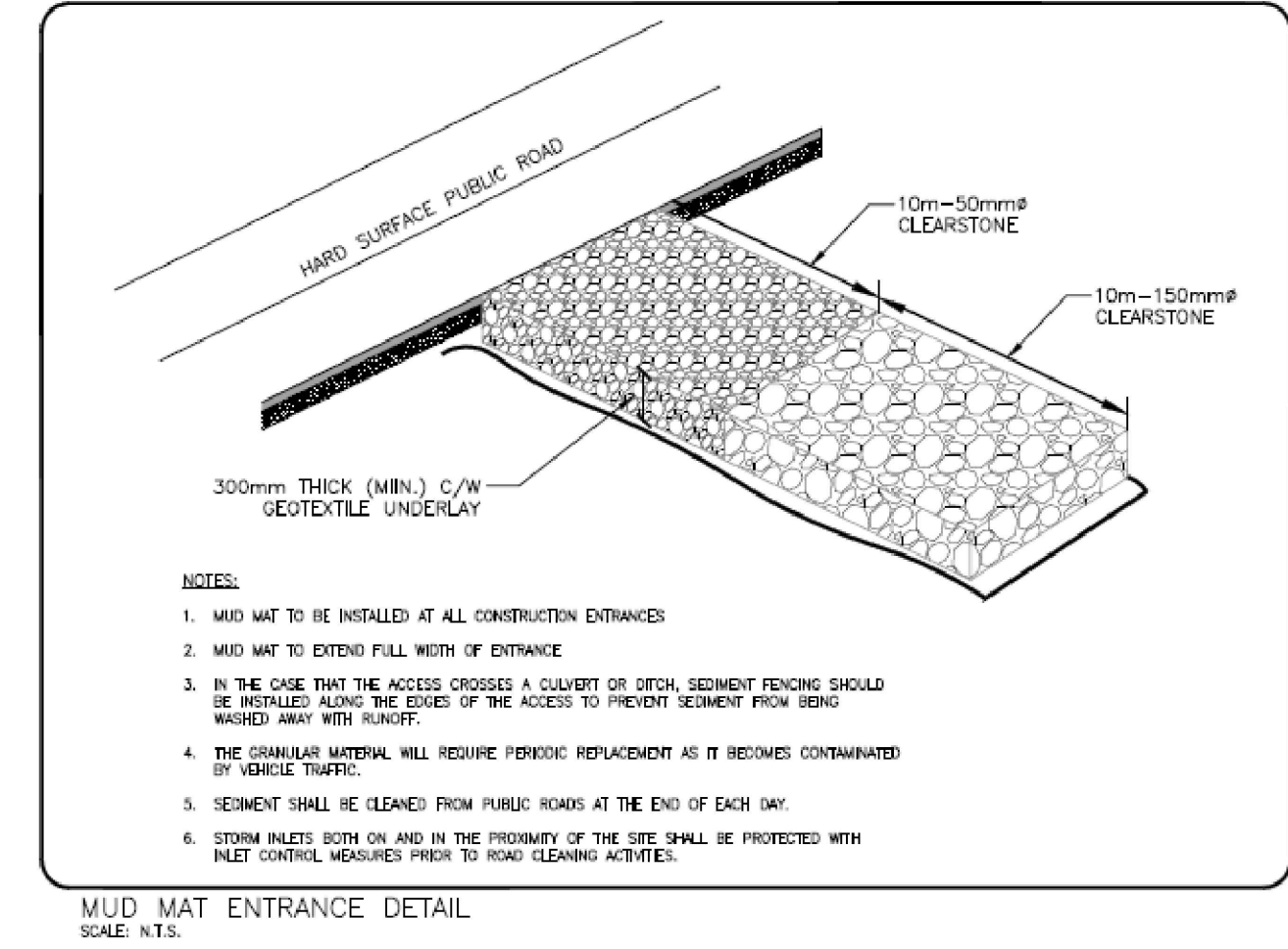
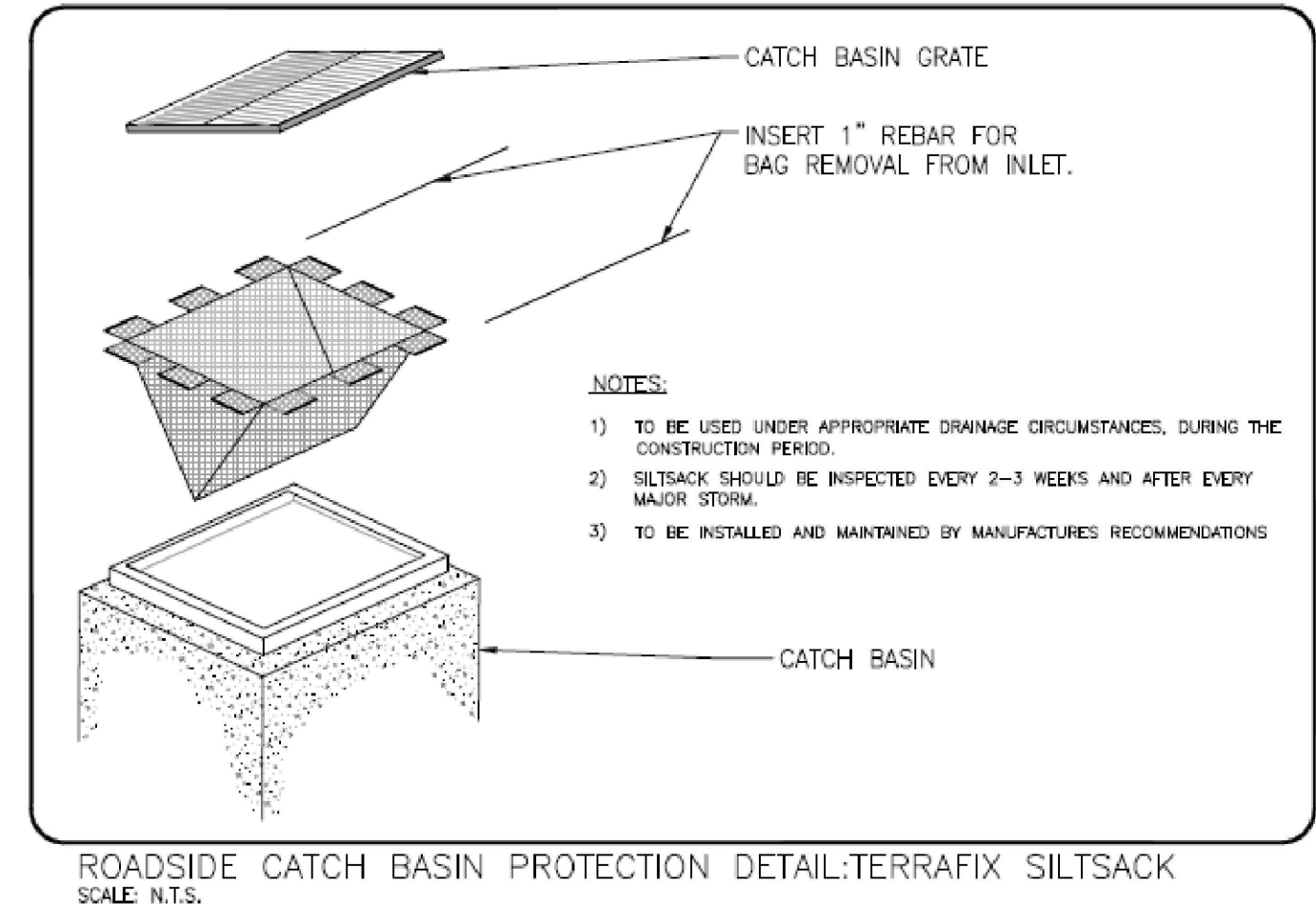
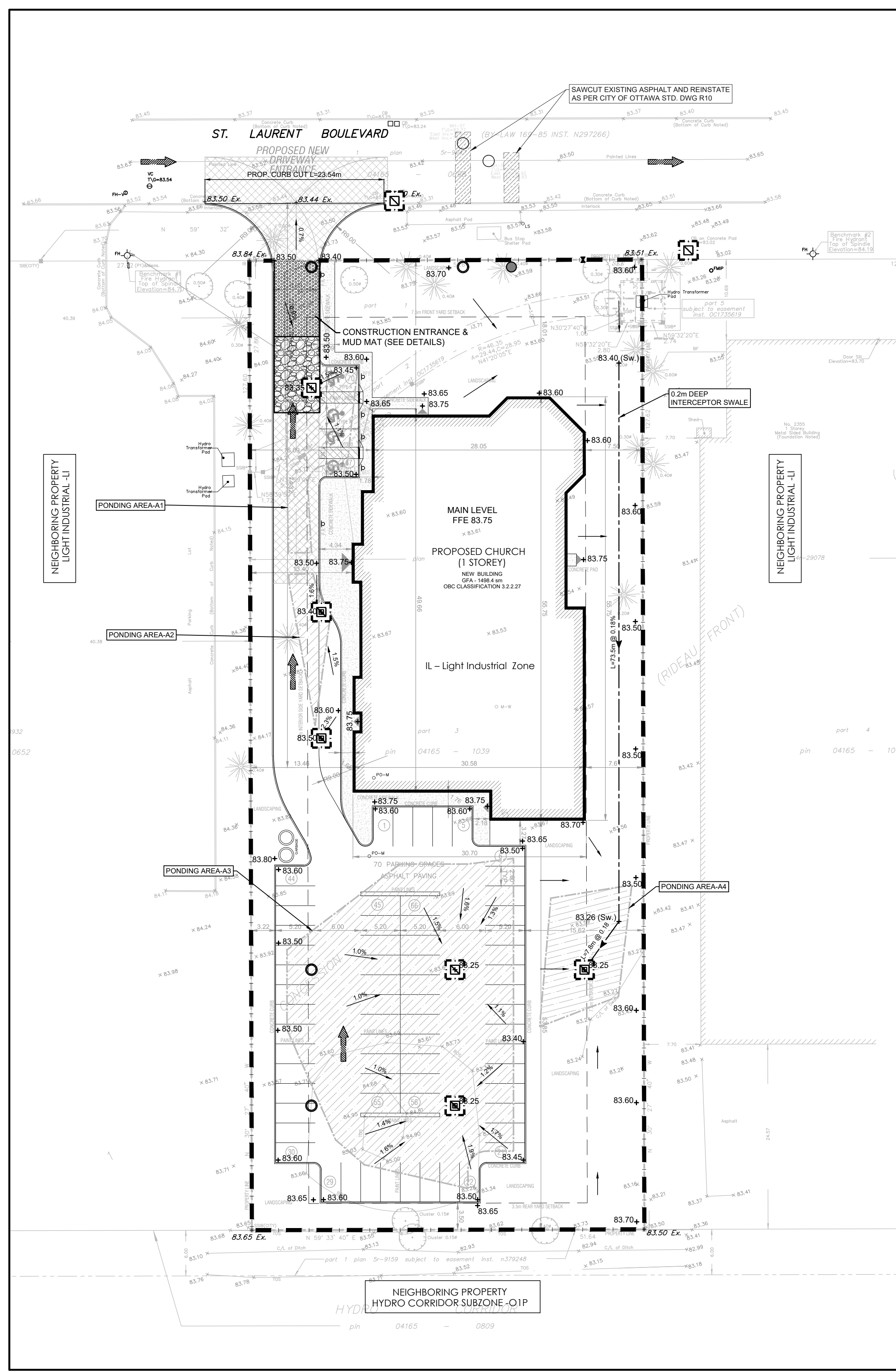
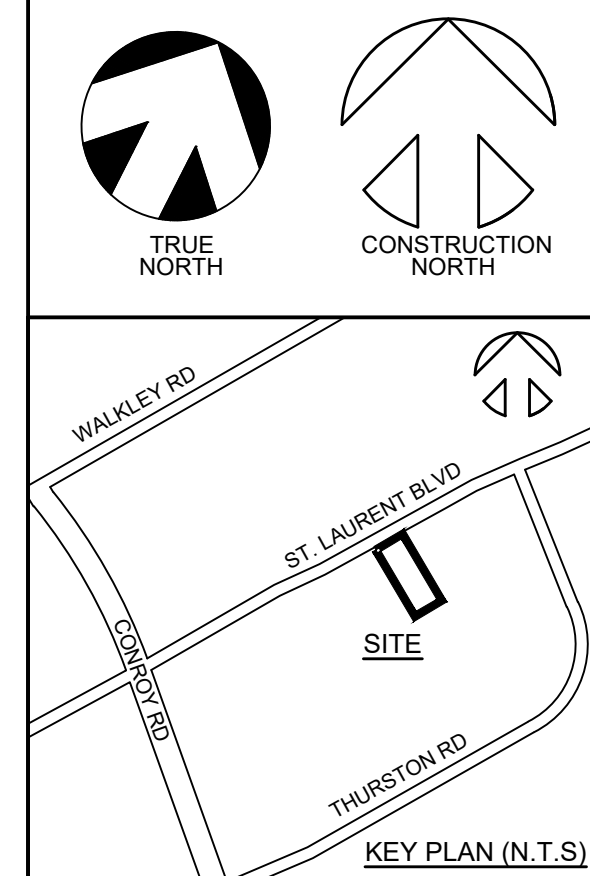

0	ISSUED FOR APPROVAL	02/14/2022	YA
no.	revisions	date	init.

GENERAL NOTE:
 THESE DRAWINGS ARE COPYRIGHT AND THE PROPERTY OF REINDERS + LAW LTD. THE DRAWINGS MAY NOT BE USED FOR CONSTRUCTION WITHOUT THE PERMISSION OF REINDERS + LAW LTD. AND UNLESS SEALED AND SIGNED BY THE ARCHITECT/ENGINEER REPRODUCTION OF THESE DRAWINGS WITHOUT THE CONSENT OF REINDERS + LAW LTD. IS STRICTLY PROHIBITED.
 DO NOT SCALE THESE DRAWINGS. ANY ERROR OR DISCREPANCY IS TO BE REPORTED IMMEDIATELY TO: REINDERS + LAW LTD.

cad file 20037_SP3
 date plotted 12/09/2021 plot scale 1:1

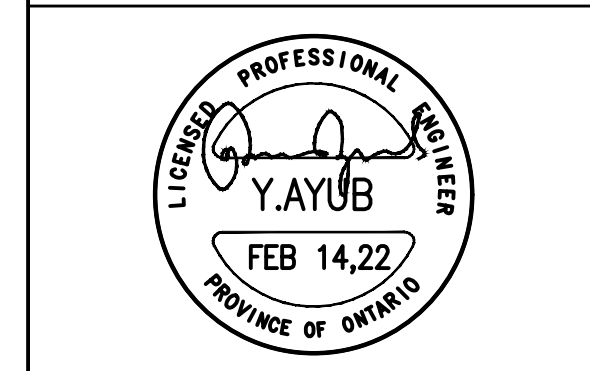

drawn CC
 designed YA
 reviewed YA
 date 2/14/2022
 scale AS SHOWN

project
 CHORAC OTTAWA
 2375 ST. LAURENT BLVD
 OTTAWA, ON

drawing
 EROSION AND SEDIMENT CONTROL PLAN, NOTES & DETAILS

REINDERS + LAW
 ARCHITECTURE, ENGINEERING
REINDERS + LAW LTD.
 ARCHITECTURE, ENGINEERING
 64 ONTARIO STREET NORTH
 MILTON ON L9T 2T1
 T. 905.457.1618 F. 905.457.8852
 EMAIL@REINDERS.CA WWW.REINDERS.CA

drawing no.	20037_SP5	rev. no.	0
-------------	-----------	----------	---

SHEET SIZE: A1 600.0mm X 914.4mm

PLAN OF SEDIMENT CONTROL FENCE & MUD MAT
 SCALE : 1:400