

CB	CATCH-BASIN
MH	STORM MANHOLE
CB/MH	CATCH BASIN/MANHOLE
MH	SANITARY MANHOLE
VC	VALVE CHAMBER
SPL	SPRINGLINE OF PIPE
INV	INVERT OF PIPE
SAN	SANITARY SEWER
ST	STORM SEWER
WS/WM	WATER SERVICE/WATERMAIN
CS	CURB STOP & STANDPOST
VB	VALVE & VALVE BOX
FH	FIRE HYDRANT
+	EXISTING GRADE ELEVATION
—	OVER HEAD WIRE
—	HYDRO
— B —	BELL TELEPHONE
— G —	CABLE
— T —	GAS
---	TRAFFIC
---	PROPERTY LINE

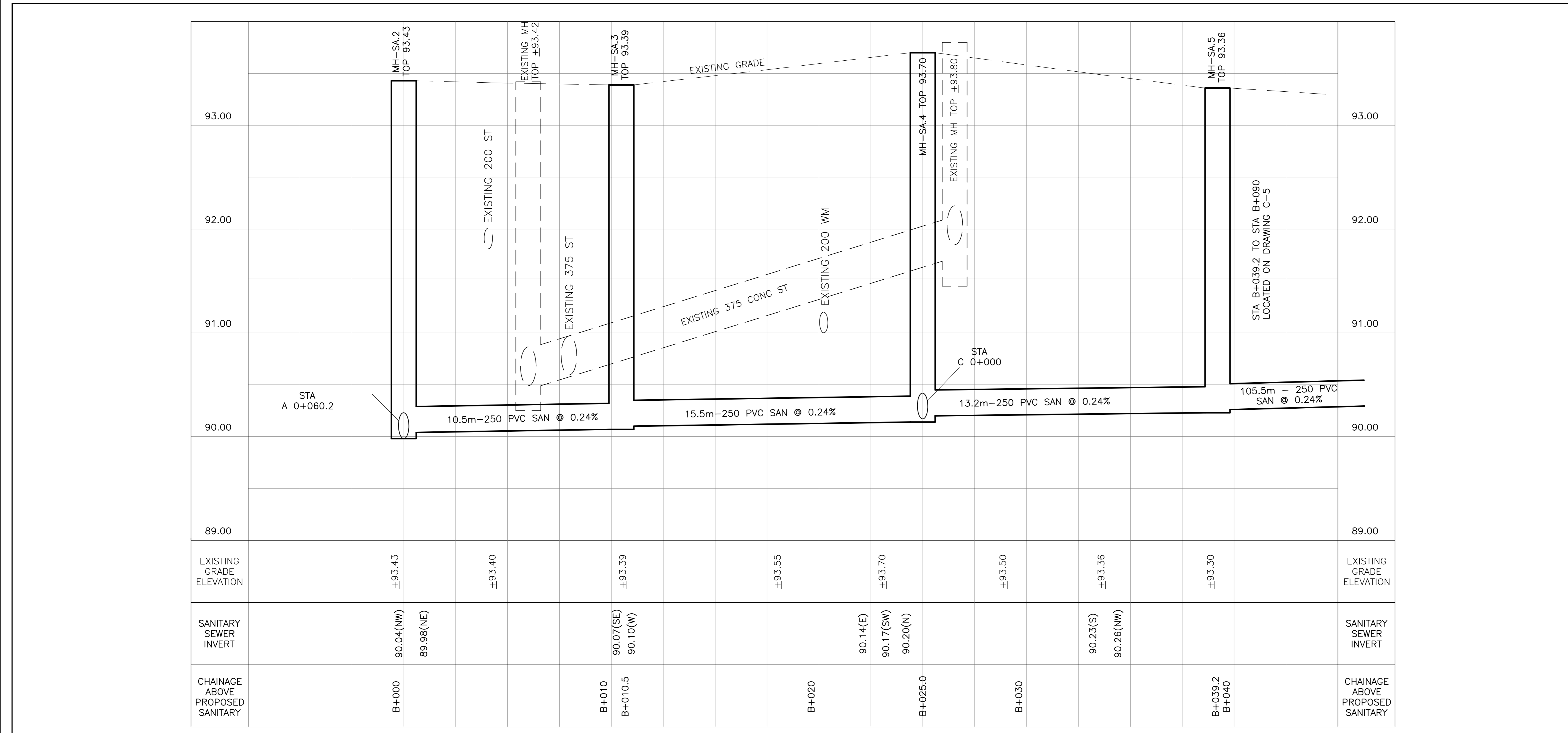
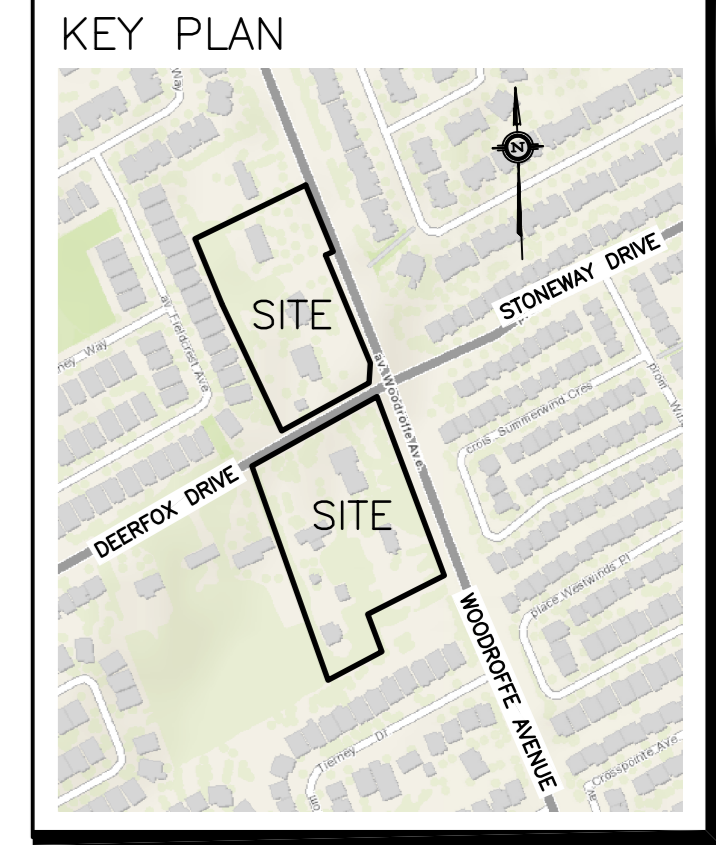

No.	DATE	REVISION
3	MAR 17-22	RE-ISSUED TO CITY FOR APPROVAL
2	DEC 21-21	ISSUED TO CITY FOR APPROVAL
1	SEP 28-21	PRELIMINARY

D. B. GRAY ENGINEERING INC.
 Stormwater Management • Grading & Drainage • Storm & Sanitary Sewers • Watermain
 700 Long Point Circle
 Ottawa, Ontario
 613-425-8044
 d.gray@dbgrayengineering.com

Project: **MUNICIPAL SANITARY SEWER EXTENSION**
 CROSSING WOODROFFE AVE
 WEST FROM STONEWAY DR
 NORTH ON WOODROFFE AVE &
 WEST ON DEERFOX DR
 OTTAWA, ONTARIO

Drawing Title:
PLAN AND PROFILE
 STA B+000 TO STA B+039.2

Engineer's Seal

 NOT VALID UNLESS SIGNED & DATED

Drawn: D.B.G.
 Hor. Scale: 1:100
 Vert. Scale: 1:20
 Date: OCT 1-21
 Job No.: 20055
 Drawing No.:
C-4
 of 9