

TOPOGRAPHIC PLAN OF SURVEY OF  
**PART OF LOT 20**  
**CONCESSION 2 (OTTAWA FRONT)**  
**GEOGRAPHIC TOWNSHIP OF NEPEAN**  
**AND**  
**PART OF LOTS 1 AND 2**  
**REGISTERED PLAN 482**  
**CITY OF OTTAWA**  
 Surveyed by Annis, O'Sullivan, Vollebek Ltd.

Scale 1 : 250  
 0 5 10 15 20 25 30 35 40 45 50 55 60 65 70 75 80 85 90 95 100 Metres

Metric  
 DISTANCES SHOWN ON THIS PLAN ARE IN METRES AND  
 CAN BE CONVERTED TO FEET BY DIVIDING BY 0.3048

Surveyor's Certificate  
 I CERTIFY THAT:  
 1. This survey and plan are correct and in accordance with the Survey Act and the Surveyors Act and the regulations made under them.  
 2. The survey was completed on the 17th day of May, 2021.

4/21  
 Date  
 T. Harwood  
 Ontario Land Surveyor

Notes & Legend

- |   |   |   |   |
|---|---|---|---|
| — | Ditches   | — | Survey Monument Planted                           |
| — | Survey Monument Found                             | — | Standard Iron Bar                                 |
| — | Wholes  | — | Maintenance Hole (Storm Sewer)                    |
| — | Measured  | — | Maintenance Hole (Sanitary)                       |
| — | Annis, O'Sullivan, Vollebek Ltd.                  | — | Maintenance Hole (Bell Telephone)                 |
| — | Registered Plan 482                               | — | Maintenance Hole (Traffic)                        |
| — | Plan 482-422                                      | — | Maintenance Hole (Hydro)                          |
| — | (84) Plan dated July 22, 1982                     | — | Maintenance Hole (Unidentified)                   |
| — | (A03) Notes Referenced as "Lot 20 Con 20 NPOF"    | — | Underground Storm Sewer                           |
| — | (87) Plan dated September 18, 1990                | — | Underground Sanitary Sewer                        |
| — | (871) Plan dated July 30, 1999                    | — | Underground Bell                                  |
| — | Plan 4R-209                                       | — | Underground Power                                 |
| — | Deciduous Tree                                    | — | Overhead Wires                                    |
| — | Coniferous Tree                                   | — | Catch Basin                                       |
| — | Fire Hydrant                                      | — | Catch Basin Inlet                                 |
| — | Water Valve                                       | — | Top of Crane                                      |
| — | Maintenance Hole (Storm Sewer)                    | — | Gas Meter   |
| — | Maintenance Hole (Sanitary)                       | — | Handhole  |
| — | Maintenance Hole (Bell Telephone)                 | — | Ball Terminal Box                                 |
| — | Maintenance Hole (Traffic)                        | — | Cable Terminal Box                                |
| — | Maintenance Hole (Hydro)                          | — | Traffic Terminal Box                              |
| — | Maintenance Hole (Unidentified)                   | — | Unidentified Terminal Box                         |
| — | Underground Storm Sewer                           | — | Traffic Signal Post                               |
| — | Underground Sanitary Sewer                        | — | Electric Charging Station                         |
| — | Underground Bell                                  | — | Sign  |
| — | Underground Power                                 | — | Parking Meter                                     |
| — | Overhead Wires                                    | — | Chain Link Fence                                  |
| — | Catch Basin                                       | — | Board Fence                                       |
| — | Catch Basin Inlet                                 | — | Concrete Retaining Wall                           |
| — | Top of Crane                                      | — | Stone Retaining Wall                              |
| — | Gas Meter   | — | Brick Retaining Wall                              |
| — | Handhole  | — | Concrete Sidewalk                                 |
| — | Ball Terminal Box                                 | — | Asphalt Sidewalk                                  |
| — | Cable Terminal Box                                | — | Utility Pole                                      |
| — | Traffic Terminal Box                              | — | Anchor  |
| — | Unidentified Terminal Box                         | — | Light Standard                                    |
| — | Traffic Signal Post                               | — | Disimeter   |
| — | Electric Charging Station                         | — | Location of Elevations                            |
| — | Sign  | — | Top of Concrete Curb and Retaining Wall Elevation |
| — | Parking Meter                                     | — | Centerline  |
| — | Chain Link Fence                                  | — | Property Line                                     |
| — | Board Fence                                       | — |   |
| — | Concrete Retaining Wall                           | — |   |
| — | Stone Retaining Wall                              | — |   |
| — | Brick Retaining Wall                              | — |   |
| — | Concrete Sidewalk                                 | — |   |
| — | Asphalt Sidewalk                                  | — |   |
| — | Utility Pole                                      | — |   |
| — | Anchor  | — |   |
| — | Light Standard                                    | — |   |
| — | Disimeter   | — |   |
| — | Location of Elevations                            | — |   |
| — | Top of Concrete Curb and Retaining Wall Elevation | — |   |
| — | Centerline  | — |   |
| — | Property Line                                     | — |   |

Bearings are grid, derived from Can-Net 2015 Real Time Network GPS observations referenced to Specified Control Points 0191968005 and 0191975075, and are referred to the Central Meridian of NAD 83 (1983 West Longitude) NAD-83 (original).

Coordinate values are to urban accuracy in accordance with O. Reg. 216/01.  
 0191968005    Northing: 5027191.26    Easting: 351496.75  
 0191975075    Northing: 5016816.83    Easting: 360506.84

For comparison purposes, a rotation of 0°25'40" counter clockwise was applied to bearings on P5, P3 and P7, and a rotation of 0°00'00" counter clockwise was applied to bearings on P5 and P6.

**ELEVATION NOTES**  
 1. Elevations shown are geoidals and are referred to the CGVD25 geoid datum.  
 2. It is the responsibility of the user of this information to verify that the job benchmark has not been altered or disturbed and that its relative elevation and description agrees with the information shown on this drawing.

**UTILITY NOTES**  
 1. This drawing cannot be accepted as acknowledging all of the utilities and it will be the responsibility of the user to contact the respective utility authorities for confirmation.  
 2. Only visible surface utilities were located.  
 3. A field location of underground plant by the pertinent utility authority is mandatory before any work involving breaking ground, probing, excavating etc.

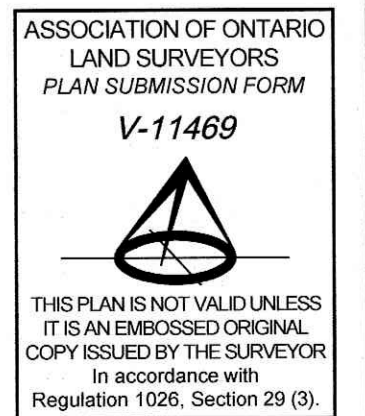

© Annis, O'Sullivan, Vollebek Ltd. 2021. THIS PLAN IS PROTECTED BY COPYRIGHT.  
**ANNIS, O'SULLIVAN, VOLLEBEK LTD.**  
 14 Concourse Gate, Suite 500  
 Nepean, ON K2E 7S5  
 Phone: (613) 727-8850 Fax: (613) 727-1079  
 Email: info@annisov.com  
 Land Surveyors (as of 2008-8-1) Normal PLANS (S-02) & PLANS (S-03)

