

**CLIENT**  
**CLARIDGE HOMES**

**CONSULTANTS**  
**ARCHITECTS:** RLA ARCHITECTURE, RODERICK LAHEY ARCHITECT INC., 90 BUCHAN STREET, OTTAWA, ONTARIO K1S 3A8, TEL: (613) 724-9622  
**CIVIL ENGINEERS:** NOVATECH ENGINEERS, PLANNERS & LANDSCAPE ARCHITECTS, SUITE 202, 245 METCAL COWAN DRIVE, OTTAWA, ONTARIO K2M 1P6, TEL: (613) 224-9843

- LEGEND**
- PROPOSED LARGE DECIDUOUS TREE
  - PROPOSED SMALL DECIDUOUS TREE
  - PROPOSED CONIFEROUS TREE
  - PROPOSED SHRUBS / PERENNIALS
  - PROPOSED SHRUBS
  - PROPOSED SOD
  - PROPOSED BENCH

**CONTINUED ON DRAWING L.2**

No.	Issue	Date	DR	CK
4	REVISED AS PER CITY COMMENTS	02/16/2022	LC	JL
3	REVISED AS PER CIVIL/SITE PLAN CHANGES	11/04/2021	LC	JL
2	REVISED AS PER CITY COMMENTS	10/07/2021	LC	JL
1	ISSUED FOR COMMENTS AND REVIEW	06/18/2021	LC	JL

**JAMES B. LENNOX & ASSOCIATES INC.**  
**LANDSCAPE ARCHITECTS**  
 3332 CARLING AVE. OTTAWA, ONTARIO K2H 5A5  
 TEL: (613) 722-5168 FAX: (613) 343-3942

**PROJECT**  
 TERRY FOX ZENS  
 OTTAWA, ONTARIO

**DRAWING**  
 LANDSCAPE PLAN  
 (NORTH-WEST)

**STAMP**

**SCALE**  
 AS SHOWN  
**START DATE**  
 JUNE, 2021  
**PROJECT NO.**  
 21-CLG-2163

**PROJECT NORTH**

**DRAWING NO.**  
**L.1**  
 PLOT SIZE ARCH-D

- GENERAL NOTES:**
- It is the responsibility of the appropriate contractor or official to report any errors, omissions or discrepancies on this plan with actual site conditions to the Landscape Architect before proceeding with construction.
  - The contractor is to notify all utility companies and authorities prior to any excavation and ascertain locations of underground services.
  - The contractor is to reinstate all areas and items damaged as a result of construction activity.
  - The contractor is to comply with all pertinent codes and by-laws.
  - The contractor is to maintain a positive surface run-off throughout the entire construction period.
  - The Landscape Architect is not responsible for subsurface conditions.
  - The contractor is to identify all existing trees to remain on site with the Landscape Architect prior to construction.
  - The contractor is to stake the proposed location of all plant material in conjunction with the Landscape Architect prior to excavation.
  - Minimum distances for selected deciduous trees are as follows:
    - Building Foundations 7.5m
    - Sidewalks 1.5m
    - Public Streets 2.5m
    - Underground Infrastructure 2.0m
  - All trees within 1m of underground utility trenches are to be excavated by hand.
  - Remove all protective wrapping from tree trunks after installation.
  - Staking of trees shall only be performed if necessary.
  - Ensure that mulch is pulled back a min. distance of 75mm from base of tree trunk.
  - Large tree setbacks equivalent to mature height.

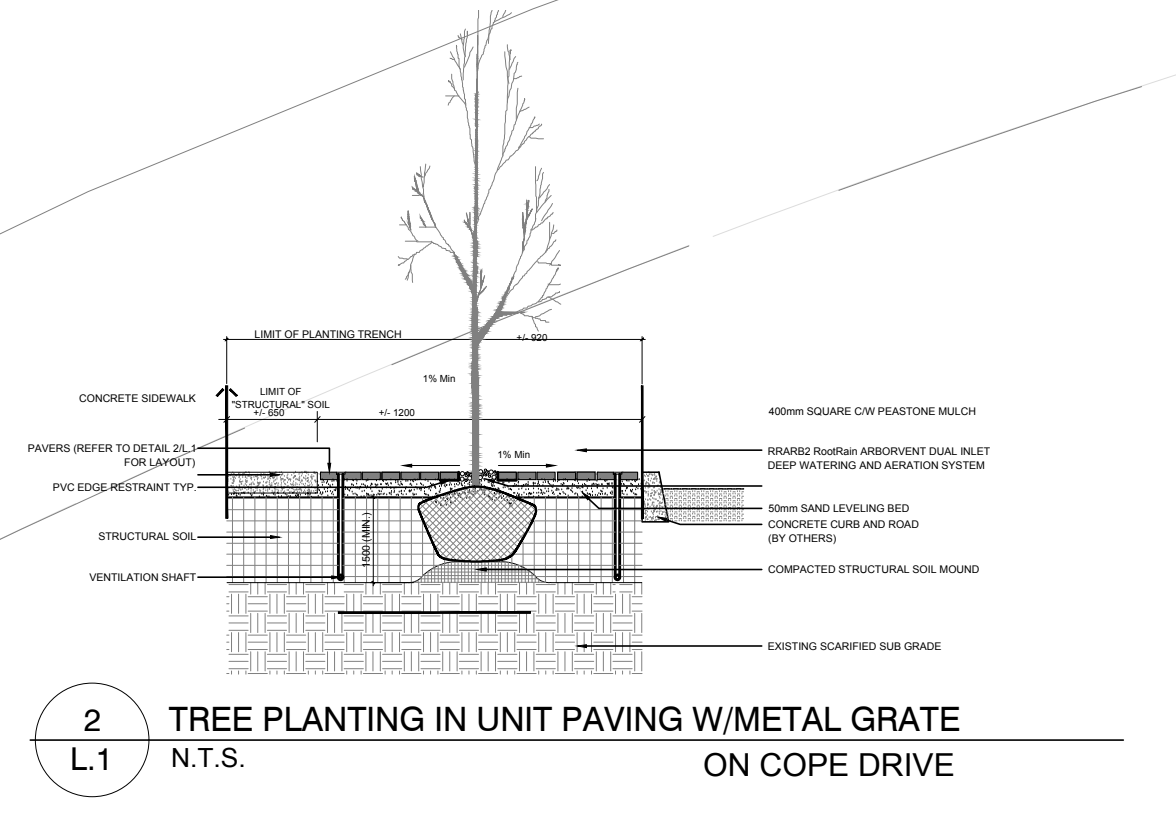

**1**  
**L.1**

**LANDSCAPE PLAN**  
 SCALE 1:300



CONTINUED ON DRAWING L.1

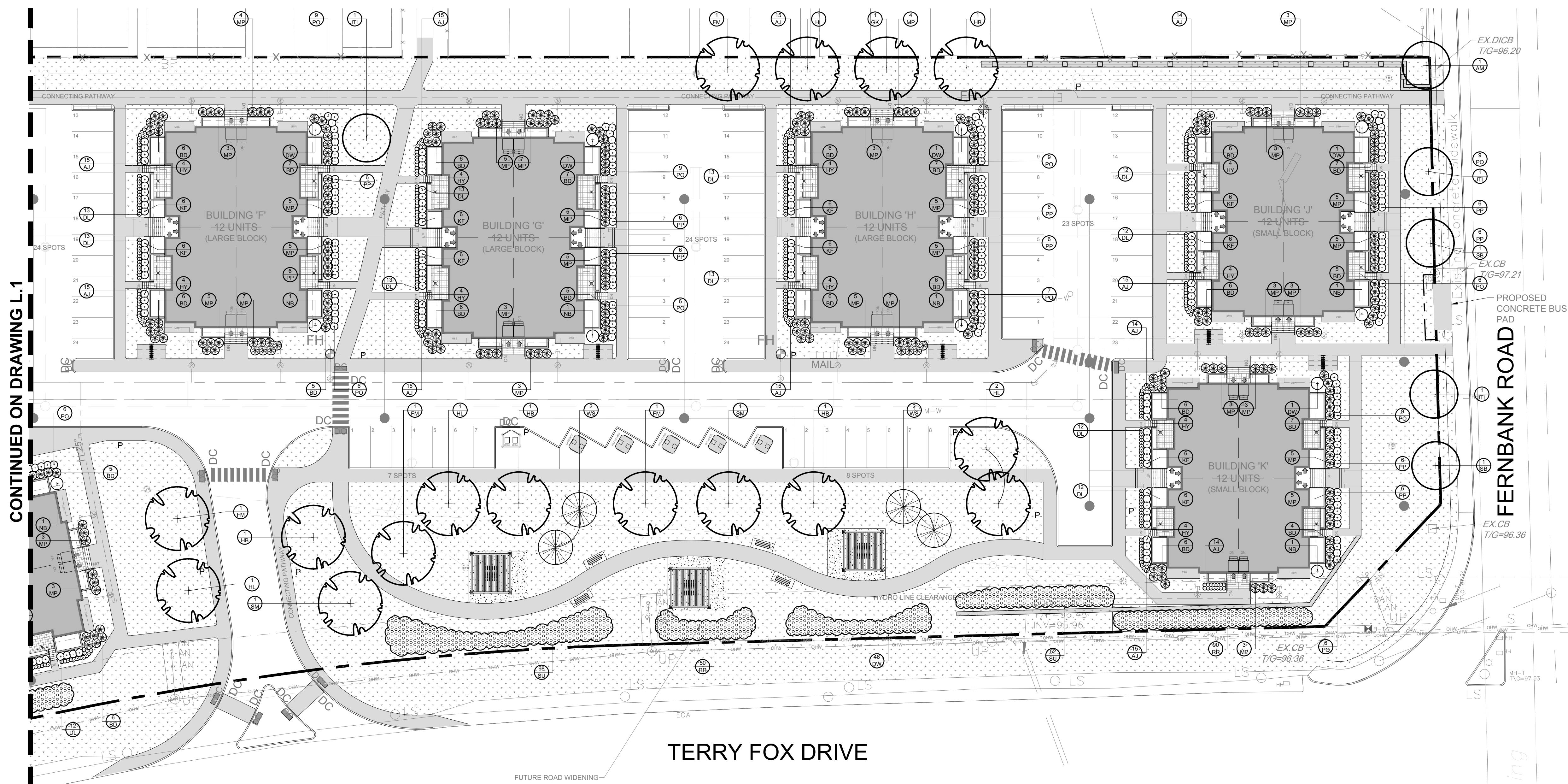

- GENERAL NOTES:**
- It is the responsibility of the appropriate contractor or official to report any errors, omissions or discrepancies on this plan with actual site conditions to the Landscape Architect before proceeding with construction.
  - The contractor is to notify all utility companies and authorities prior to any excavation and ascertain locations of underground services.
  - The contractor is to reinstate all areas and items damaged as a result of construction activity.
  - The contractor is to comply with all pertinent codes and by-laws.
  - The contractor is to maintain a positive surface run-off throughout the entire construction period.
  - The Landscape Architect is not responsible for subsurface conditions.
  - The contractor is to identify all existing trees to remain on site with the Landscape Architect prior to construction.
  - The contractor is to stake the proposed location of all plant material in conjunction with the Landscape Architect prior to excavation.
  - Minimum distances for selected deciduous trees are as follows:
    - Building Foundations 7.5m
    - Sidewalks 1.5m
    - Public Streets 2.5m
    - Underground Infrastructure 2.0m
  - All trees within 1m of underground utility trenches are to be excavated by hand.
  - Remove all protective wrapping from tree trunks after installation.
  - Staking of trees shall only be performed if necessary.
  - Ensure that mulch is pulled back a min. distance of 75mm from base of tree trunk.

1 LANDSCAPE PLAN  
SCALE 1:300

- NOTES:**
- ALL DIMENSIONS ARE IN MILLIMETRES.
  - USE TREE SPECIES TOLERANT TO POORLY DRAINED SOIL CONDITIONS.

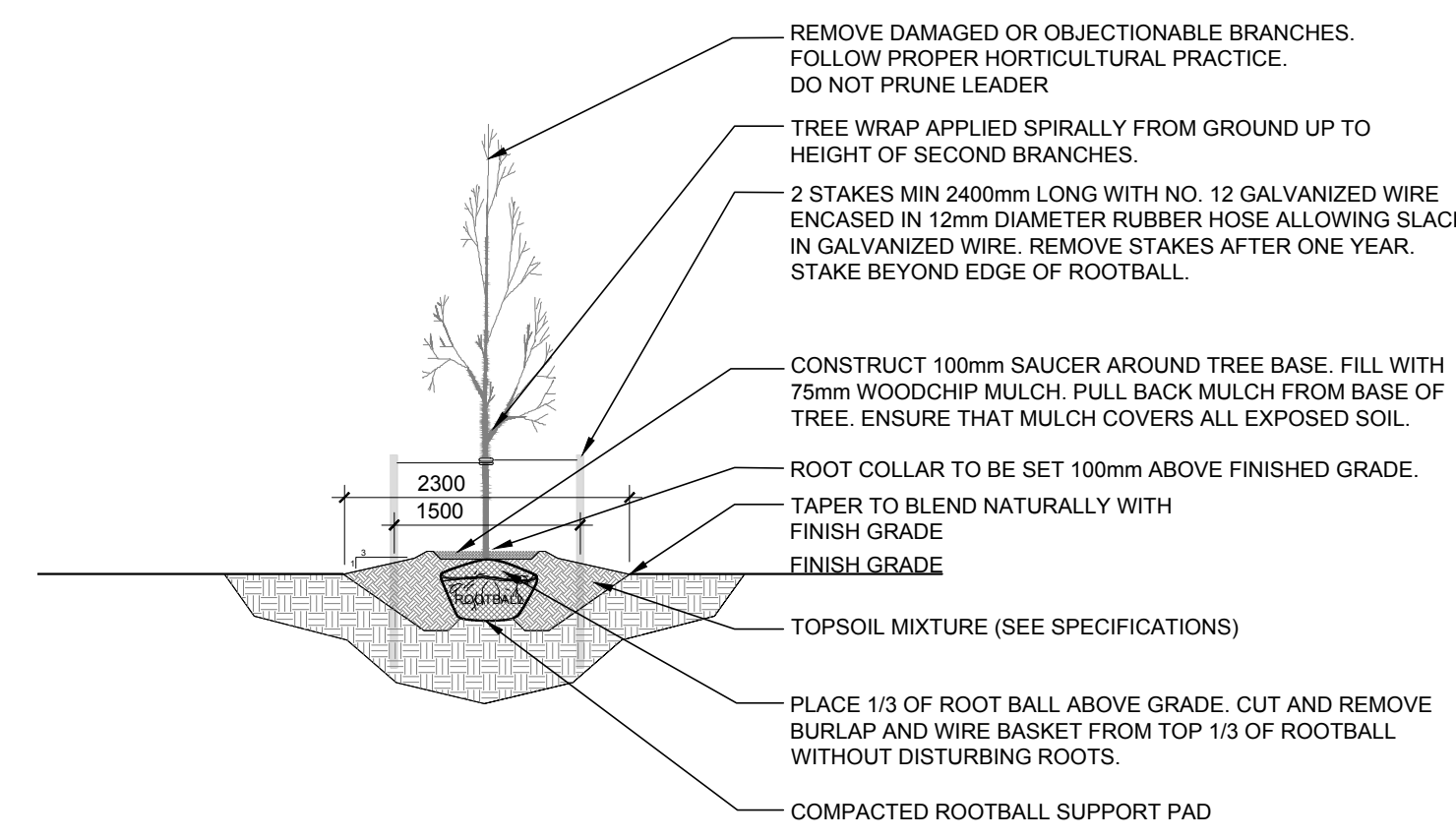

2 DECIDUOUS TREE PLANTING  
L.2 N.T.S.

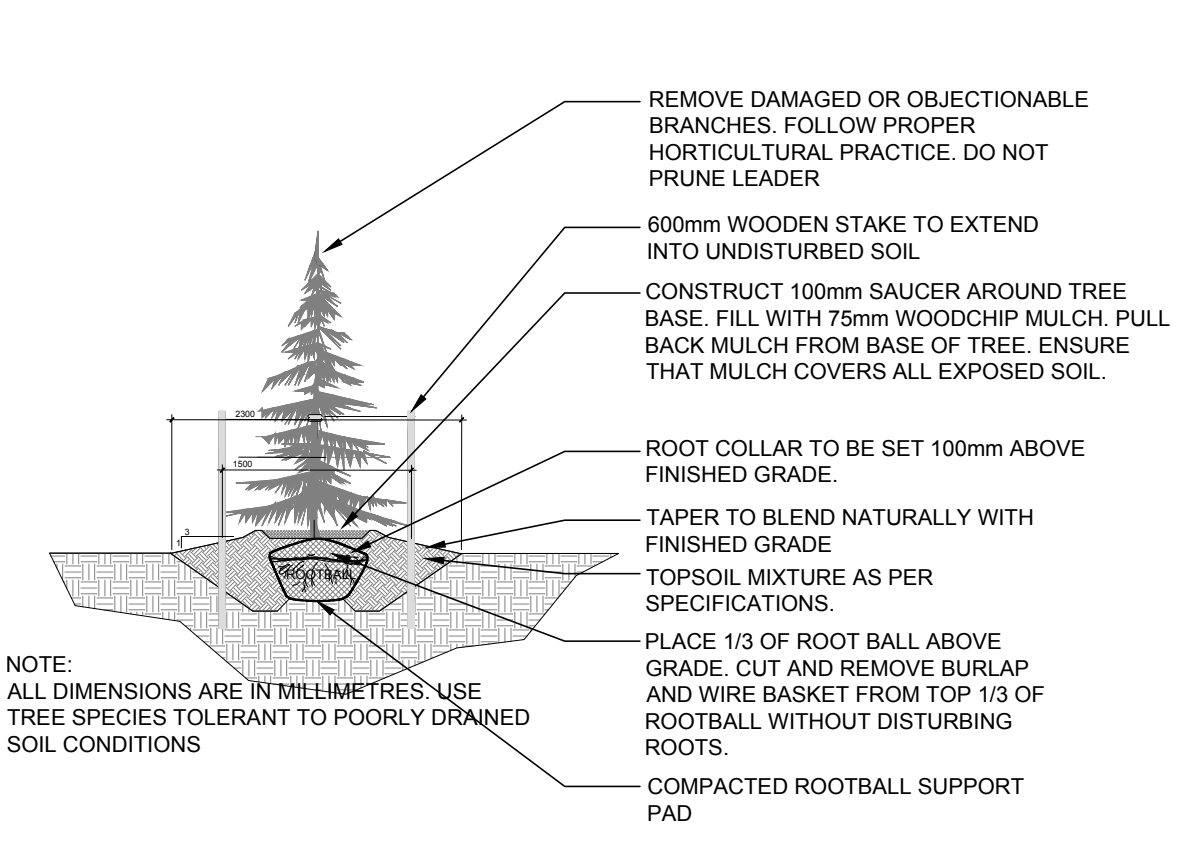

3 CONIFEROUS TREE PLANTING  
L.2 N.T.S.

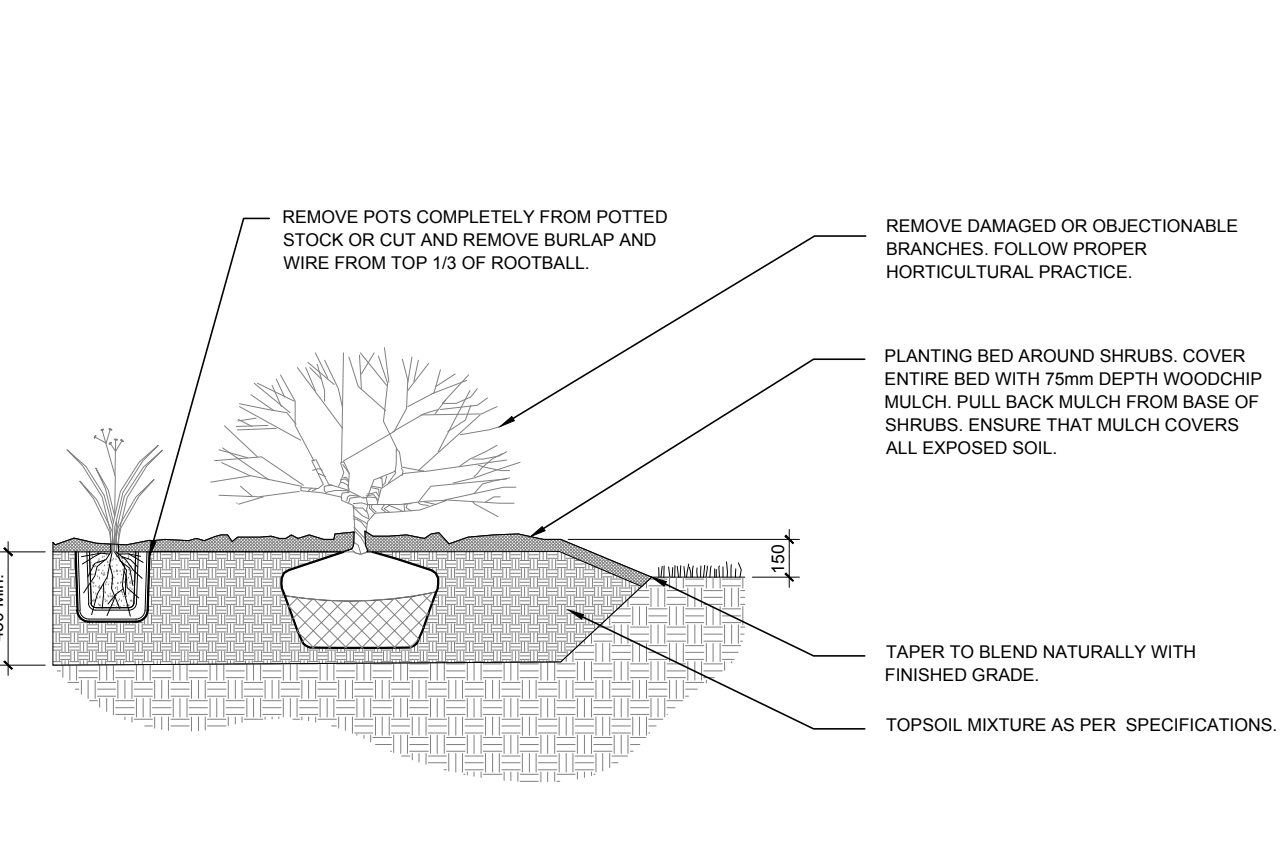

4 SHRUB AND PERENNIAL PLANTING  
L.2 N.T.S.

PROPOSED PLANT LIST						
KEY	qty.	BOTANICAL NAME	COMMON NAME	SIZE	CONDITION	REMARKS
<b>TREES</b>						
AM	8	<i>Acer ginnata</i>	Amur Maple	60mm ø	B&B	
FM	7	<i>Acer x freemanii</i>	Friesman's Maple	60mm ø	B&B	
GK	5	<i>Ginkgo biloba</i>	Maidenhair Tree	60mm ø	B&B	
HB	9	<i>Celtis occidentalis</i>	Hackberry	60mm ø	B&B	
HL	9	<i>Gleditsia triacanthos</i> var. <i>inermis</i> 'Shademaster'	Shademaster Honeylocust	60mm ø	B&B	
JTL	14	<i>Syringa reticulata</i>	Japanese Tree Lilac	60mm ø	B&B	
MC	2	<i>Malus 'Makamik'</i>	Makamik Crabapple	60mm ø	B&B	
SB	6	<i>Amelanchier canadensis</i>	Shadblow Serviceberry	60mm ø	B&B	
SM	4	<i>Acer saccharum</i>	Sugar Maple	60mm ø	B&B	
WS	17	<i>Picea glauca</i>	White Spruce	1800 mm ht.	B&B	
<b>SHRUBS</b>						
BD	373	<i>Juniperus sabinna</i> 'Blue Danube'	Blue Danube Juniper	600mm spr.	Potted	1000mm o.c.
DW	236	<i>Cornus sericea</i>	Red Osier Dogwood	800mm ht.	Potted	1200mm o.c.
HY	120	<i>Hydrangea arborescens</i> 'Annabelle'	Annabelle Hydrangea	3 gal. pot	Potted	800 mm o.c.
MP	401	<i>Pinus mugo</i> 'Pumilio'	Dwarf Mugo Pine	600mm spr.	Potted	1000mm o.c.
NB	16	<i>Physocarpus opulifolius</i>	Common Ninebark	600mm ht.	Potted	
PD	225	<i>Potentilla fruticosa</i> 'Goldfinger'	Goldfinger Potentilla	600mm ht.	Potted	800mm o.c.
PP	192	<i>Spiraea japonica</i> 'Little Princess'	Little Princess Spiraea	600mm pot	Potted	800 mm o.c.
RR	311	<i>Rosa rugosa</i>	Rugosa Rose	800mm ht.	Potted	800mm o.c.
SU	330	<i>Rhus typhina</i> 'Laciniata'	Cuteleaf Staghorn Sumac	800 mm ht.	Potted	1200 mm o.c.
<b>ORNAMENTAL GRASS AND PERENNIALS</b>						
AJ	522	<i>Sedum telephium</i> 'Autumn Joy'	Autumn Joy Sedum	150mm pot	Potted	400 mm o.c.
DL	412	<i>Hemerocallis</i> 'Stella D'Oro'	Stella D'Oro Day Lily	150mm pot	Potted	400 mm o.c.
KF	192	<i>Calamagrostis</i> 'Karl Foerster'	Karl Foerster Grass	250mm pot	Potted	800 mm o.c.

**CLIENT**  
**CLARIDGE HOMES**

**CONSULTANTS**  
 ARCHITECTS: RLA ARCHITECTURE, RODERICK LAHEY ARCHITECT INC., 95 BEICH STREET, OTTAWA, ONTARIO K1S 3A8, TEL: (613) 724-9622  
 CIVIL ENGINEERS: NOVATECH ENGINEERS, PLANNERS & LANDSCAPE ARCHITECTS, SUITE 202, 245 METCAL COWLAND DRIVE, OTTAWA, ONTARIO K2M 1P6, TEL: (613) 254-9643

**LEGEND**

4	REVISED AS PER CITY COMMENTS	02/16/2022	LC	JL
3	REVISED AS PER CIVIL/SITE PLAN CHANGES	11/04/2021	LC	JL
2	REVISED AS PER CITY COMMENTS	10/07/2021	LC	JL
1	ISSUED FOR COMMENTS AND REVIEW	06/18/2021	LC	JL

No. Issue Date DR CK

**JAMES B. LENNOX & ASSOCIATES INC.**  
 LANDSCAPE ARCHITECTS  
 3332 CARLING AVE. OTTAWA, ONTARIO K2H 5A8  
 TEL: (613) 722-5168 FAX: (613) 343-3942

**PROJECT**  
 TERRY FOX ZENS  
 OTTAWA, ONTARIO

**DRAWING**  
 LANDSCAPE PLAN (SOUTH-EAST)

**SCALE**  
 AS SHOWN

**START DATE**  
 JUNE, 2021

**PROJECT NO.**  
 21-CLG-2163

**DRAWING NO.**  
**L.2**

**PLOT SIZE ARCH-D**

D07-12-21-0080