

Storm STRUCTURE TABLE				
NAME	RIM ELEV.	INVERT IN	INVERT OUT	DESCRIPTION
CB3	59.25		SW58.528	COVER CITY STD S19 FRAME CITY STD S19 STRUC. OPSD 705.010 GEOTECH TO REVIEW PIPE COVER
CB7	60.47		W59.707	COVER CITY STD S19 FRAME CITY STD S19 STRUC. OPSD 705.010
CBM8	60.47	E59.550	W59.513	COVER CITY STD S28.1 FRAME CITY STD S25 STRUC. OPSD 701.010
EX MH6	61.09	558.170		AS PER EXISTING REPLACE INLET AND OUTLET INVERTS AS SPECIFIED
LCB1	60.90		559.533	AS PER DETAIL S31
LCB2	60.71	N59.147	W59.090	AS PER DETAIL S31
MH4	61.10	N58.450 E58.833	W58.431	COVER CITY STD S24.1 FRAME CITY STD S25 STRUC. OPSD 701.011
MH5	60.93	E58.350	N58.328	COVER CITY STD S24.1 FRAME CITY STD S25 STRUC. OPSD 701.011
MH9	60.93	E59.420	W59.380	COVER CITY STD S24.1 FRAME CITY STD S25 STRUC. OPSD 701.011 C/W 148mm DRIFICE PLUG

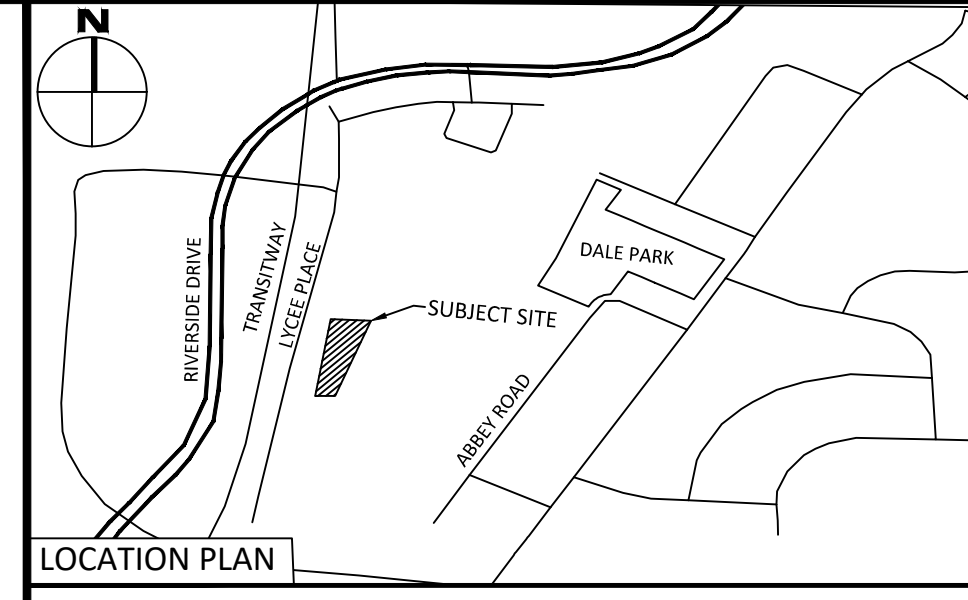

LEGEND

	CONCRETE BARRIER CURB		LIMIT OF CONSTRUCTION
	CONCRETE WALKWAY		DRAINAGE SWALE
	PROPOSED ASPHALT		DRAINAGE DITCH
	PROPOSED PEASTONE		SLOPING AT 3% UNLESS SPECIFIED
	STORM SEWER MANHOLE		SURFACE ELEVATION
	CATCHBASIN MANHOLE		SWALE ELEVATION
	CATCHBASIN		TOP OF WALL ELEVATION
	SANITARY SEWER MANHOLE		BOTTOM OF WALL ELEVATION
	FIRE HYDRANT		OVERLAND FLOW ROUTE
	WATER VALVE		SILTY FENCE BARRIER
	WATER METER		STRAW BALE CHECK DAM
	REMOTE WATER METER		

FOR REVIEW ONLY
NOT FOR CONSTRUCTION

2	UPDATED PER NEW SP	JAN. 07, 2022
1	ISSUED FOR REVIEW	OCT. 15, 2021

No. Revisions Date
Check and verify all dimensions before proceeding with the work. Do not scale drawings.

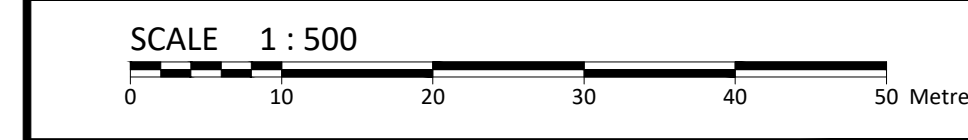

McINTOSH PERRY
115 Walgreen Road, RR3, Carp, ON K0A 1L0
Tel: 613-836-2184 Fax: 613-836-3742
www.mcintoshperry.com

Client: **FIGURR ARCHITECTS COLLECTIVE**
190 SOMERSET STREET WEST
OTTAWA, ON K2P 0J4

Project: **1633 LYCEE PLACE**

Stamp:

Drawing Title: **SITE SERVICING PLAN**

Scale: 1:500 Project Number: CCO-22-1100

Drawn By: N.V. Checked By: R.F. Designed By: N.V.

Scale: 1:500 Project Number: CCO-22-1100

Drawn By: N.V. Checked By: R.F. Designed By: N.V.

C102

1 C102 SITE SERVICING

- SEWER NOTES:**
- CONSTRUCT ALL SEWERS, CATCH BASINS, MANHOLES AND APPURTENANCES IN ACCORDANCE WITH OPSD STANDARDS AND SPECIFICATIONS, AS WELL AS CITY.
 - SEWER TRENCHING AND BEDDING SHALL CONFORM TO OPSD 802.010 AND 802.013 UNLESS NOTED OTHERWISE.
 - BEDDING SHALL BE A MINIMUM 150mm OF GRANULAR "A", COMPACTED TO MINIMUM 95% STANDARD PROCTOR DRY DENSITY. CLEAR STONE BEDDING SHALL NOT BE PERMITTED.
 - SUB-BEDDING, IF REQUIRED SHALL CONSIST OF 450mm OF COMPACTED GRANULAR "B" TYPE 1.
 - BACKFILL TO AT LEAST 300mm ABOVE TOP OF PIPE WITH GRANULAR "A" OR GRANULAR "B" TYPE 1.
 - TO MINIMIZE DIFFERENTIAL FROST HEAVING, TRENCH BACKFILL (FROM PAVEMENT SUBGRADE TO 2.0 METRES BELOW FINISHED GRADE) SHALL MATCH EXISTING SOIL CONDITIONS.
 - SANITARY SEWERS AND CONNECTIONS 150mmØ AND SMALLER TO BE PVC SDR-28.
 - SEWERS AND CONNECTIONS 200mmØ AND LARGER TO BE PVC SDR-35. BEDDING TO BE TYPE "B" EXCEPT AT RISERS, UNLESS NOTED OTHERWISE.
 - INSULATE ALL STORM AND SANITARY SEWERS/SERVICES THAT HAVE LESS THAN 1.5m OF COVER WITH THERMAL INSULATION AS PER OPSD 1109.030.
 - SEWER CONNECTIONS ARE TO BE MADE ABOVE THE SPRINGLINE OF THE SEWERMAIN AS PER CITY OF OTTAWA STANDARD DRAWING S11.511.1 & S11.2.
 - SUPPLY AND INSTALL ALL PIPING AND APPURTENANCES AS SHOWN AND DETAILED TO WITHIN 1.0m OF BUILDING. ALL ENDS OF SERVICES TO BE PROPERLY CAPPED AND LOCATED WITH 2"x4"x8' LONG MARKER.
 - CONTRACTOR TO TELEVISION (CCTV) ALL PROPOSED SEWERS ON SITE, OUTLET CONNECTION TO THE MAIN AND PIPES 150mmØ OR GREATER PRIOR TO BASE COURSE ASPHALT. UPON COMPLETION OF CONTRACT, THE CONTRACTOR IS RESPONSIBLE TO FLUSH AND CLEAN ALL SEWERS & APPURTENANCES.
 - DYE TESTING IS TO BE COMPLETED ON SANITARY SERVICE TO CONFIRM PROPER CONNECTION TO SANITARY SEWER MAIN.

- WATERMAIN NOTES**
- CONSTRUCT ALL WATERMANS AND APPURTENANCES IN ACCORDANCE WITH OPSD STANDARDS AND SPECIFICATIONS, AS WELL AS CITY STANDARDS.
 - INDUSTRIAL/COMMERCIAL SERVICE CONNECTIONS TO BE 50mm COPPER PIPING AND SHALL CONFORM TO ASTM 888 TYPE "K" SOFT.
 - WATERMANS AND/OR WATER SERVICES ARE TO HAVE A MINIMUM COVER OF 2.4m. OTHERWISE THERMAL INSULATION IS REQUIRED AS PER CITY STANDARDS (IF AVAILABLE) OR OPSD 1109.030.
 - IF THE WATERMAIN MUST BE DEFLECTED TO MEET ALIGNMENT, ENSURE THAT THE AMOUNT OF DEFLECTION USED IS EQUAL TO OR LESS THAN THAT WHICH IS RECOMMENDED BY THE MANUFACTURER.
 - THERMAL INSULATION OF WATERMANS AT OPEN STRUCTURES AS PER CITY STANDARDS (IF AVAILABLE) OR OPSD 1109.030.
 - VALVES TO BE OPERATED BY CITY STAFF ONLY.
 - NO CONNECTION TO EXISTING WATER NETWORK SHALL BE COMPLETED UNTIL A WATER PERMIT IS OBTAINED FROM THE CITY. CITY TO BE PRESENT FOR WATERMAIN CONNECTION, CONNECTION, EXCAVATION, BACKFILLING AND REINSTATEMENT TO BE COMPLETED BY CONTRACTOR.
 - IT WILL BE THE RESPONSIBILITY OF THE CONTRACTOR TO PERFORM ANY WATERMAIN CONNECTION(S) REQUIRED. THIS SHALL BE COMPLETED IN THE PRESENCE OF A DESIGNATED MUNICIPAL WATER OPERATOR AND THE SELECTED CONTRACTOR SHALL PROVE TO THE SATISFACTION OF THE CITY THAT THEY ARE COMPETENT TO PERFORM THE WORKS PRIOR TO INITIATING CONSTRUCTION.
 - ALL WATERMANS SHALL BE EQUIPPED WITH BUTTERFLY AND GATE VALVES AS PER OPSD 1100.011.
 - ALL FIRE HYDRANTS, VALVE AND VALVE BOX SHALL CONFORM TO OPSD 1103.020.
 - CONCRETE THRUST BLOCKS TO CONFORM TO OPSD 1103.010 AND OPSD 1103.020.
 - ALL WATERMAIN TO BE CLASS 150 DR-18 OR APPROVED EQUIVALENT.
 - ALL WATERMAIN TO BE EQUIPPED WITH TRACER WIRE.

DRAWING: 1633 LYCEE PLACE - Sewer & Watermain - Presentation - 2022-11-06
 LAYOUT: 1633 LYCEE PLACE - Sewer & Watermain - Presentation - 2022-11-06
 LAST PLOTTED: Friday, January 07, 2022 10:07:15 AM
 FILE: 1633 LYCEE PLACE - Sewer & Watermain - Presentation - 2022-11-06.dwg