

Code	Qty.	Botanical Name	Common Name	Size	Condition
AC	5	Amelanchier canadensis	Serviceberry	60mm cal	B + B specimen
AG	3	Aesculus glabra	Ohio Buckeye	50mm cal	B + B specimen
AR	5	Acer rubrum	Red Maple	70mm cal	B + B specimen
AS	3	Acer saccharum	Sugar Maple	60mm cal	B + B specimen
BP	1	Betula papyrifera	Paper Birch	60mm cal	B + B specimen
CD	3	Celtis occidentalis	Common Hackberry	60mm cal	B + B specimen
GB	3	Ginkgo biloba	Maidenhair Tree	70mm cal	B + B specimen
MH	3	Malus 'Harvest Gold'	Harvest Gold Crabapple	60mm cal	B + B specimen
QM	3	Quercus macrocarpa	Burr Oak	60mm cal	B + B specimen
QR	1	Quercus rubra	Red Oak	60mm cal	B + B specimen
AB	3	Abies balsamea	Balsam Fir	2.0m Ht.	B + B specimen
LL	3	Larix laricina	Eastern Larch / Tamarack	2.25m Ht.	B + B specimen
PG	7	Picea glauca	White Spruce	2.5m Ht.	B + B specimen
PS	3	Pinus strobus	White Pine	1.5m Ht.	B + B specimen

Code	Qty.	Botanical Name	Common Name	Size	Condition
ac	75	Amelanchier canadensis	Serviceberry	100cm Ht.	Pot
ca	50	Cornus alternifolia	Paigoda Dogwood	80cm Ht.	Pot
cr	65	Cornus racemosa	Grey Dogwood	100cm Ht.	Pot
hk	125	Hypericum kalmianum	St. John's Wort	40cm Ht.	Pot
hp	175	Hypericum prolificum	Shrubby St. John's Wort	40cm Ht.	Pot
sv	65	Syringa vulgaris alba	White Common Lilac	100cm Ht.	Pot
vl	80	Viburnum lentago	Nannyberry	100cm Ht.	Pot
vl	15	Viburnum lentago	Nannyberry	150cm Ht.	WB
sa	105	Spiraea alba	Meadowsweet	60cm Ht.	Pot
sb	150	Spiraea bumalda 'Dart's Red'	Dart's Red Spirea	50cm Ht.	Pot

Qty.	Botanical Name	Common Name	Condition
75	Calamagrostis acutifolia 'Overdam'	Feather Reed Grass	9cm Pot
50	Imperata cylindrica 'Red Baron'	Japanese Blood Grass	9cm Pot
75	Echinacea purpurea	Purple Coneflower	9cm Pot
350	Geranium macrorrhizum	Bigroot Geranium	9cm Pot
350	Geranium psilostemon 'Gerwat'	Rozanne Geranium	9cm Pot
100	Parthenocissus quinquefolia	Virginia Creeper	9cm Pot
75	Panicum virgatum	Switch Grass	9cm Pot
75	Pinus mugo var. pumilio	Mugho Pine	30cm spr
125	Arctostaphylos Uva Ursi	Bearberry	30cm spr
75	Taxus cuspidata 'Monloo'	Emerald Spreader Yew	30cm spr

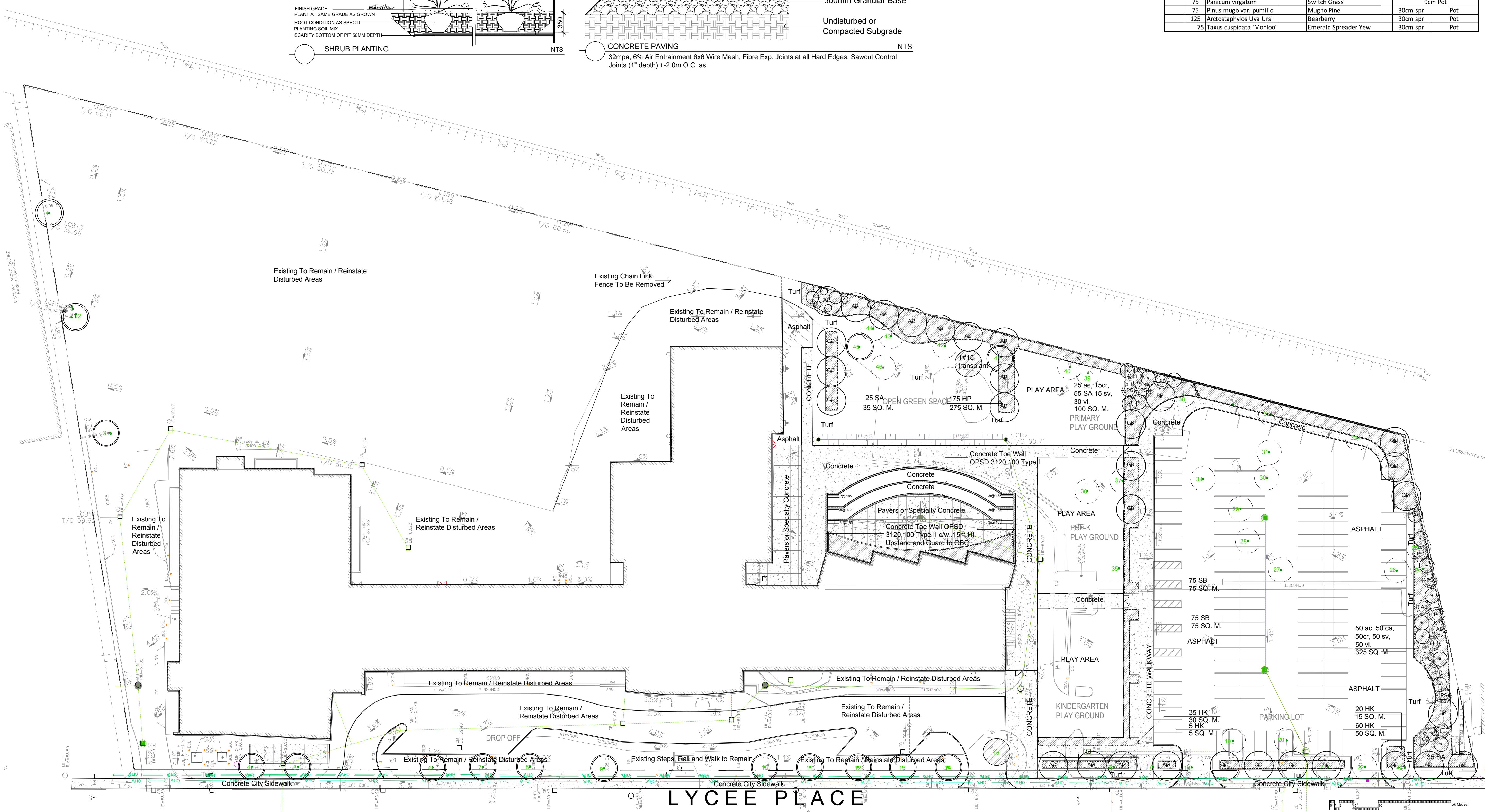

Drawing Remains the Property of/Copyright Reserved by Gino J. Aiello Landscape Architect. Do Not Use or Reproduce Without Approval of Gino J. Aiello. NOT To Be Used For Construction Unless indicated by Revision: "FOR LANDSCAPE CONSTRUCTION". Contractor is Responsible for Verification of Site Locations of all Utilities. Report any Discrepancies Between Site and Drawing Immediately to Gino J. Aiello. Do NOT Proceed Until Clarified.

TURF AREAS TO BE SOD C/W 150MM DEPTH TOPSOIL ON APPROVED SUBGRADE | SOD TO BE #1 GRADE TURFGRASS NURSERY SOD per NSGA - Fine Fescue/Kentucky Bluegrass Sod | PLANTING MIX TO BE APPROVED BY LANDSCAPE ARCHITECT | PLANT MATERIAL TO MEET CNLA STANDARDS/BE APPROVED BY LANDSCAPE ARCHITECT PRIOR TO PLANTING | ALL MATERIALS & WORK TO BE MAINTAINED UNTIL FINAL ACCEPTANCE, (MOWING TURF, WEEDING BEDS, WATERING TURF & PLANTS) & INCLUDE 1 YEAR WARRANTY FROM DATE OF FINAL ACCEPTANCE | PROVIDE WATERING OF ALL PLANT MATERIAL AS REQUIRED FOR PROPER ESTABLISHMENT, UNTIL END OF WARRANTY PERIOD | REFER TO CIVIL ENGINEER'S DRAWING FOR ELEVATIONS / GRADING |

The Landscape Plan is to be read in conjunction with the grading, servicing, site and survey plan | Bare root material to be planted in season only | All plant material locations to be staked on site by the landscape contractor and checked by the landscape architect prior to planting | All trees to be preserved on or directly adjacent to the site will be protected | Plant material are to be installed a minimum of; 3.0m away from any part of any hydro transformer, 3.0m corridor between a fire hydrant and the curb, a 2.5m radius beside or behind a fire hydrant, 2.0m from any servicing/utility line or structure |

LANDSCAPE PLAN LEGEND

- Proposed Coniferous Tree
- Proposed Deciduous Tree
- Existing Tree to Remain
- Existing Tree to be Removed
- Proposed Planting Bed
- Proposed Concrete
- Catch Basin CB/Manhole
- Fire Hydrant
- U/G Water Service
- U/G Storm Service
- U/G Sanitary Service
- O/H Hydro Service

4	FIRST SUBMISSION SPC	JANUARY 11 2022
3	FOR REVIEW / COORDINATION	DECEMBER 20 2021
3	per Updated Site Plan	SEPTEMBER 21 2021
2	80% TENDER REVIEW	AUGUST 30 2021
1	FOR REVIEW / COORDINATION	AUGUST 25 2021
No.	Revision	Date

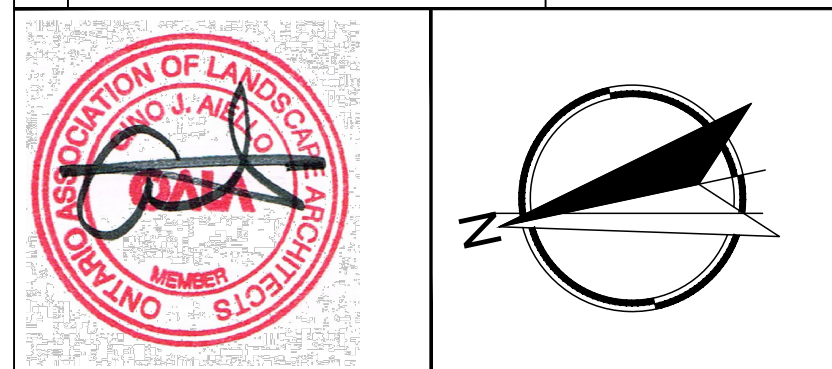

Property Owner
 LYCÉE CLAUDEL
 L'école française internationale d'Ottawa

Gino J. Aiello | landscape architect GJALA.com
 GJA Inc. Gino@GJALA.com (613) 852 1343
 110 Dobbey Road Unit # 9 | Ottawa Ontario | K2T 0C2

Project
LYCEE CLAUDEL
 Site Improvements
 1633 Lycee Place Ottawa

Drawing
Landscape Plan

Date: JULY 2021
 Scale: 1:400
 City of Ottawa
 Dwg - #####

Sheet Number
L1
 D07-###