

- LEGEND:**
- IRON BAR
 - BENCHMARK
 - HYD EX FIRE HYDRANT
 - LIGHT POLE
 - EX LIGHT STANDARD
 - EX STORM MH
 - EX SANITARY MH
 - EX STORM CB
 - EX WATER VALVE
 - EX VALVE CHAMBER
 - EX BELL & HYDRO POLE
 - EX GUY WIRE AND ANCHOR
 - EX TRAFFIC SIGNAL
 - EX GAS VALVE
 - EX SIGN
 - EX TREE
 - SUBJECT PROPERTY
 - PROPERTY LINE
 - EX CONC CURB
 - EX CENTERLINE OF DITCH
 - EX ROAD CENTERLINE
 - EX FENCE
 - EX STORM SEWER
 - EX CONTOUR
 - NEW YARD LIGHT
 - NEW STORM MH
 - NEW SANITARY MH
 - NEW STORM CB
 - NEW STORM CB/MH
 - NEW CONC CURB
 - NEW CURB CUT/DEPRESSED CURB
 - FIRE ROUTE SIGN
 - NEW 1.8m HIGH WOOD FENCE
 - DRAINAGE AREA BOUNDARY
 - CATCHMENT I.D.
 - AREA (ha) | FACILITY FLOW

No.	REVISIONS	Date	By	App.
C	RE-ISSUED FOR SPA	DEC 03 2021	ML	J.S.
B	RE-ISSUED FOR SPA	SEPT 24 2021	ML	J.S.
A	ISSUED FOR SPA	AUG 25 2021	ML	J.S.



exp Services Inc.
 1-1-905-793-9800 | F +1-905-793-0641
 1595 Clark Boulevard
 Brampton, ON L6T 4V1
 Canada
 www.exp.com



- BUILDINGS • EARTH & ENVIRONMENT • ENERGY •
- INDUSTRIAL • INFRASTRUCTURE • SUSTAINABILITY •



Location: **1545 WOODROFFE AVE. OTTAWA, ON**

Title: **POST-DEVELOPMENT SANITARY AREA PLAN**

Designed By: M.L.	Drawn By: M.L.	Checked By: J.S.
Scale: 1:250	Date: APRIL 2020	City Drawing No.:
Project No.: BRM00606364-B0	Drawing No.: C07	CITY DWG. # 17094

CITY # 007-12-21-0056

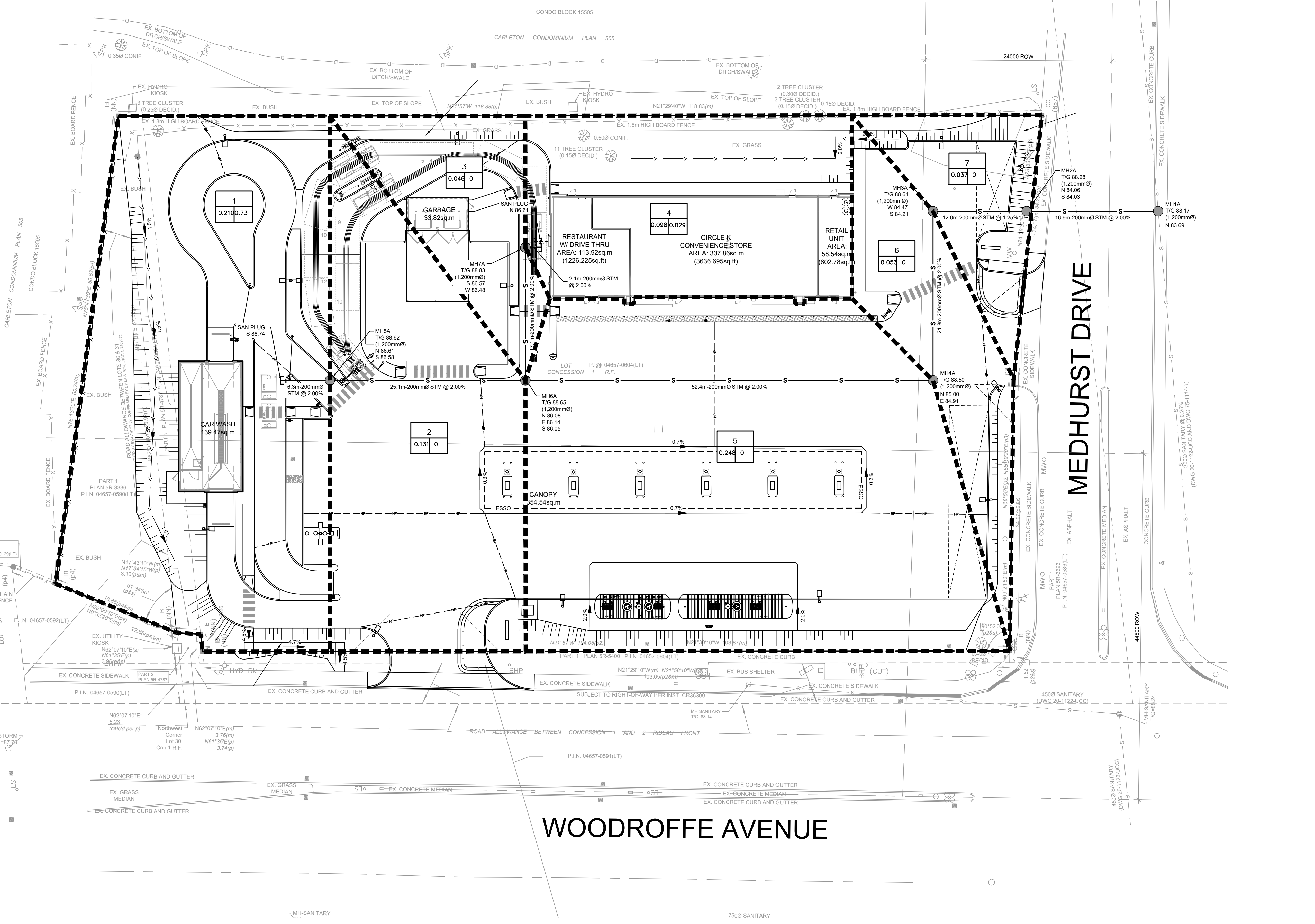

WOODROFFE AVENUE

MEDHURST DRIVE

