

LEGEND

- Existing Deciduous Tree to Remain
- Existing Coniferous Tree to Remain
- Proposed Deciduous Tree
- Proposed Coniferous Tree
- Proposed Deciduous Shrub
- Proposed Coniferous Shrub
- Proposed Perennial
- Proposed Bike Rack
- Proposed Barrier-free Signage
- Proposed 1.8m Shadowbox Wood Fence
- Existing 1.8m Board Fence

Re. L3.0 for planting and furnishing details

#1- re. comments from City

| Key | Botanical Name | Common Name | Qty | Size | Conditions | Spacing | Remarks |
|----------------------------------------|----------------------------------|---------------------------|-----|------------|------------|---------|-------------------------------------------------------|
| Deciduous Trees | | | | | | | |
| AT | Acer x freemanii 'Celebration' | Celebration Maple | 5 | 60mm cal | WB | | full crown |
| AM | Amelanchier leavis | Allegheny Serviceberry | 5 | 50mm cal | WB | | full crown |
| AR | Acer rubrum | Red Maple | 6 | 60mm cal | WB | | full crown |
| GT | Gleditsia triacanthos | Honey Locust | 6 | 60mm cal | WB | | full crown |
| Coniferous Trees | | | | | | | |
| AB | Abies concolor | White Fir | 3 | 200cm | WB | | uniform spread |
| PP | Picea glauca | White Spruce | 3 | 200cm | WB | | uniform spread |
| Shrubs | | | | | | | |
| Co | Cornus alba 'Siberica' | Redbark Dogwood | 44 | 40cm 3gal | Cont. | 120cm | min. 5 canes |
| Ju | Juniperus sabinna 'Blue Danube' | Blue Danube Juniper | 60 | 40cm 3 gal | Cont. | 100cm | uniform spread |
| Po | Potentilla fruticosa 'Red Ace' | Red Ace Cinqufoil | 20 | 40cm 3 gal | Cont. | 60cm | plant in offset lines / zig zag pattern to fill space |
| Rh | Rhus aromatica 'Gro-Low' | Fragrant Sumac | 53 | 2gal | Cont. | 100cm | plant in offset lines / zig zag pattern to fill space |
| Sj | Spiraea japonica 'Flaming Mound' | Flaming Mound Spirea | 66 | 40cm 3 gal | Cont. | 75cm | plant in offset lines / zig zag pattern to fill space |
| Ta | Taxus x media 'Wardii' | Ward's Yew | 19 | 40cm 3 gal | Cont. | 100cm | plant in offset lines / zig zag pattern to fill space |
| Perennials / Ornamental Grasses | | | | | | | |
| ach | Achillea millefolium 'Paprika' | Paprika Yarrow | 129 | 1gal | Cont. | 50cm | plant in offset lines / zig zag pattern to fill space |
| hem | Hemerocallis 'Anzac' | Anzac Daylily | 286 | 1gal | Cont. | 50cm | plant in offset lines / zig zag pattern to fill space |
| pan | Panicum virgatum 'Prairie Fire' | Prairie Fire Switch Grass | 92 | 1gal | Cont. | 60cm | plant in offset lines / zig zag pattern to fill space |
| rud | Rudbeckia 'Hirta' | Black Eyed Susan | 242 | 1gal | Cont. | 50cm | plant in offset lines / zig zag pattern to fill space |

PLANT NOTES:

ALL PLANT MATERIAL SUBJECT TO STANDARD TWO (2) YEAR MAINTENANCE PERIOD COMMENCING UPON ISSUANCE DATE OF THE CERTIFICATE OF SUBSTANTIAL COMPLETION AND ACCEPTANCE OF THE ABOVE GROUND WORKS.

QUANTITIES INDICATED ON THE PLAN TO GOVERN.

DO NOT PLANT IN SWALE CENTRES.

▲ THE MINIMUM OF SOIL AREA PER TREE IS 10 SQUARE METERS.

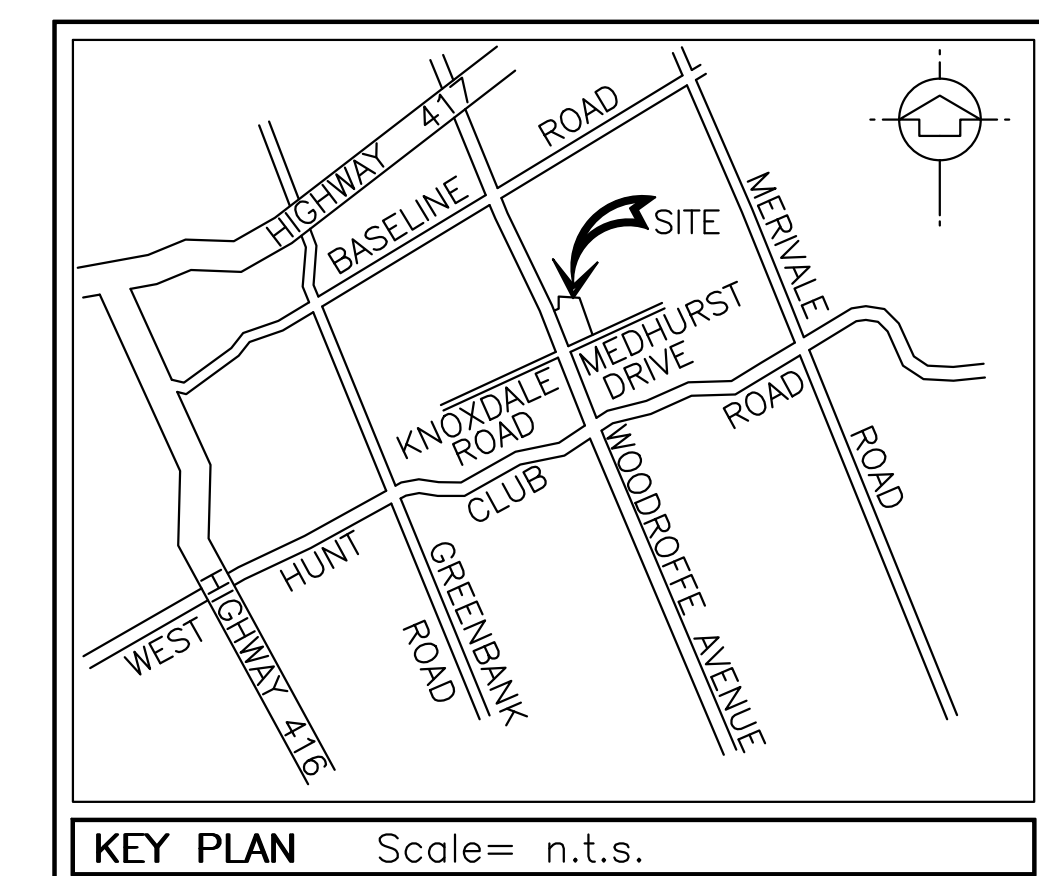

wood.

Unless otherwise agreed in a written contract between Wood and its client, this document: (i) contains information, data and design that is confidential and may not be copied or disclosed; and (ii) may be used by the client only in the context and for the express purpose for which it was intended. Any use of, or reliance on, this document by any third party is the party's sole risk.

COPYRIGHT NOTICE

This drawing is the property of the above referenced Professional and is not to be used for any purpose other than the specific project and site named herein, and cannot be reproduced in any manner without the express written permission from the Professional.

04/21/21 FOR CLIENT REVIEW
04/27/21 ISSUED FOR SPA
09/21/21 RE-ISSUED FOR SPA
12/03/21 RE-ISSUED FOR SPA

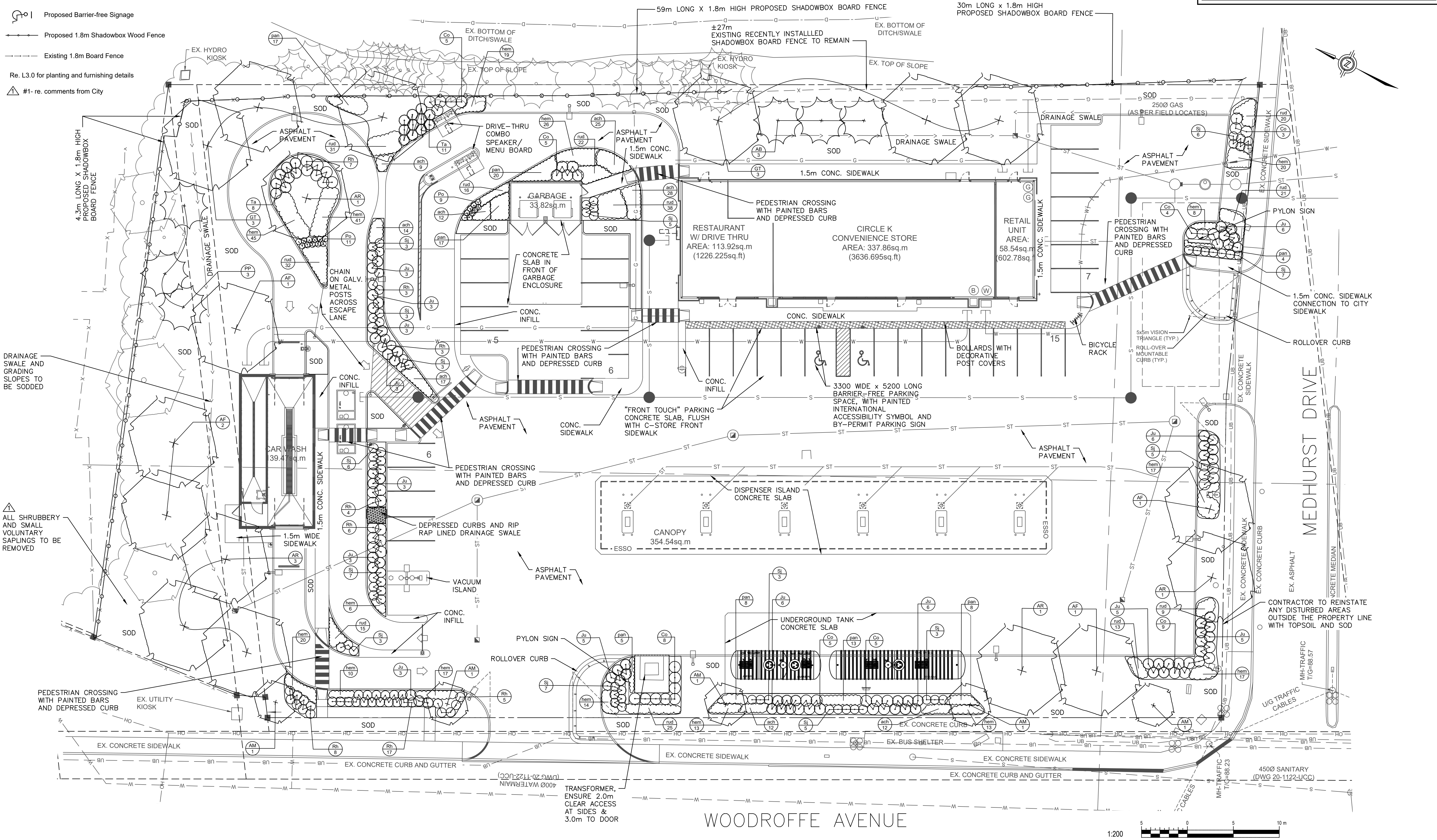

PROFESSIONAL SEAL

ska

Stempski Kelly Associates Inc.
Design Landscape Architecture Planning
P.O. Box 399, Fergus, ON, N1M 3E2
Voice (519) 787 4313
stasio@ska-design.ca www.ska-design.ca

PROFESSIONAL IN CHARGE
S. STEMPSKI
PROJECT MANAGER
S. LAWRENCE
QUALITY CONTROL
F. RIVARD
DRAWN BY
J. YI

PROJECT NAME
CIRCLE K STORES INC.
R&R No. 52287

NEPEAN ONTARIO

1545 WOODROFFE AVENUE
NEPEAN, ON, CANADA
K2G 1W2



PROJECT NUMBER
BE20207036

SHEET TITLE
LANDSCAPE PROPOSED PLANTING AND LANDSCAPING PLAN

SHEET NUMBER
L2.0