

NOTES:
 - $f_c = 35 \text{ MPa}$, EXPOSURE CLASS C1
 - REFER TO SITE PLAN FOR ELEVATIONS
 - REFER TO CIVIL DRAWINGS FOR LOCATIONS / EXTENTS

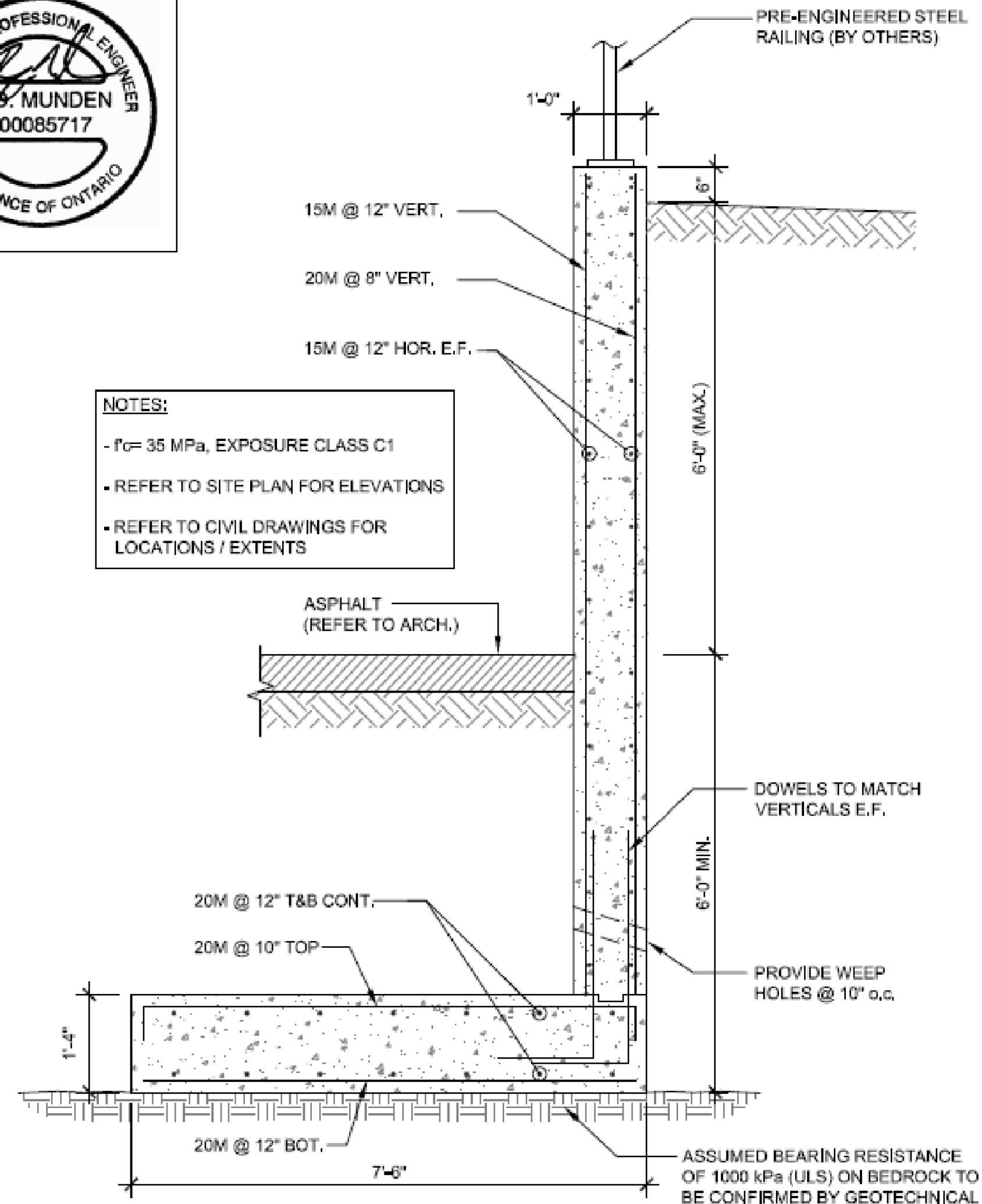

SECTION: TYPICAL RETAINING WALL

SCALE 1/2"=1'-0"

| | | | |
|--|---|--|----------------------------------|
| | PROJECT DYMON SELF-STORAGE 1375 CLYDE AVE., OTTAWA, ON | DRAWN S. HAGEN DESIGNED R. MUNDEN DATE DEC 2018 SCALE 1/2"=1'-0" PROJECT NO. 17-0185C | DRAWING NO. SK1 |
| | DRAWING RETAINING WALL | | |

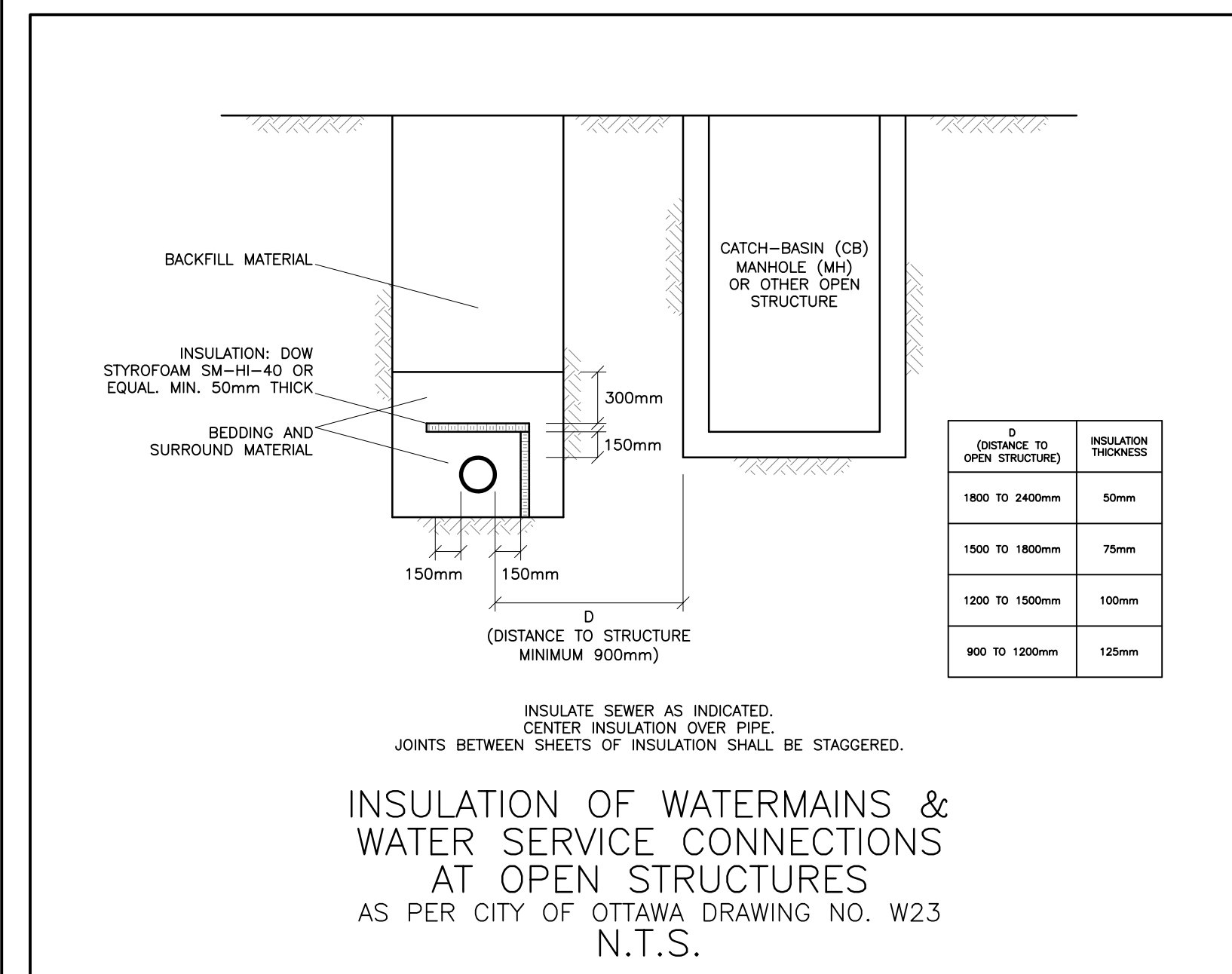

INSULATION OF WATERMAINS & WATER SERVICE CONNECTIONS AT OPEN STRUCTURES
 AS PER CITY OF OTTAWA DRAWING NO. W23
 N.T.S.

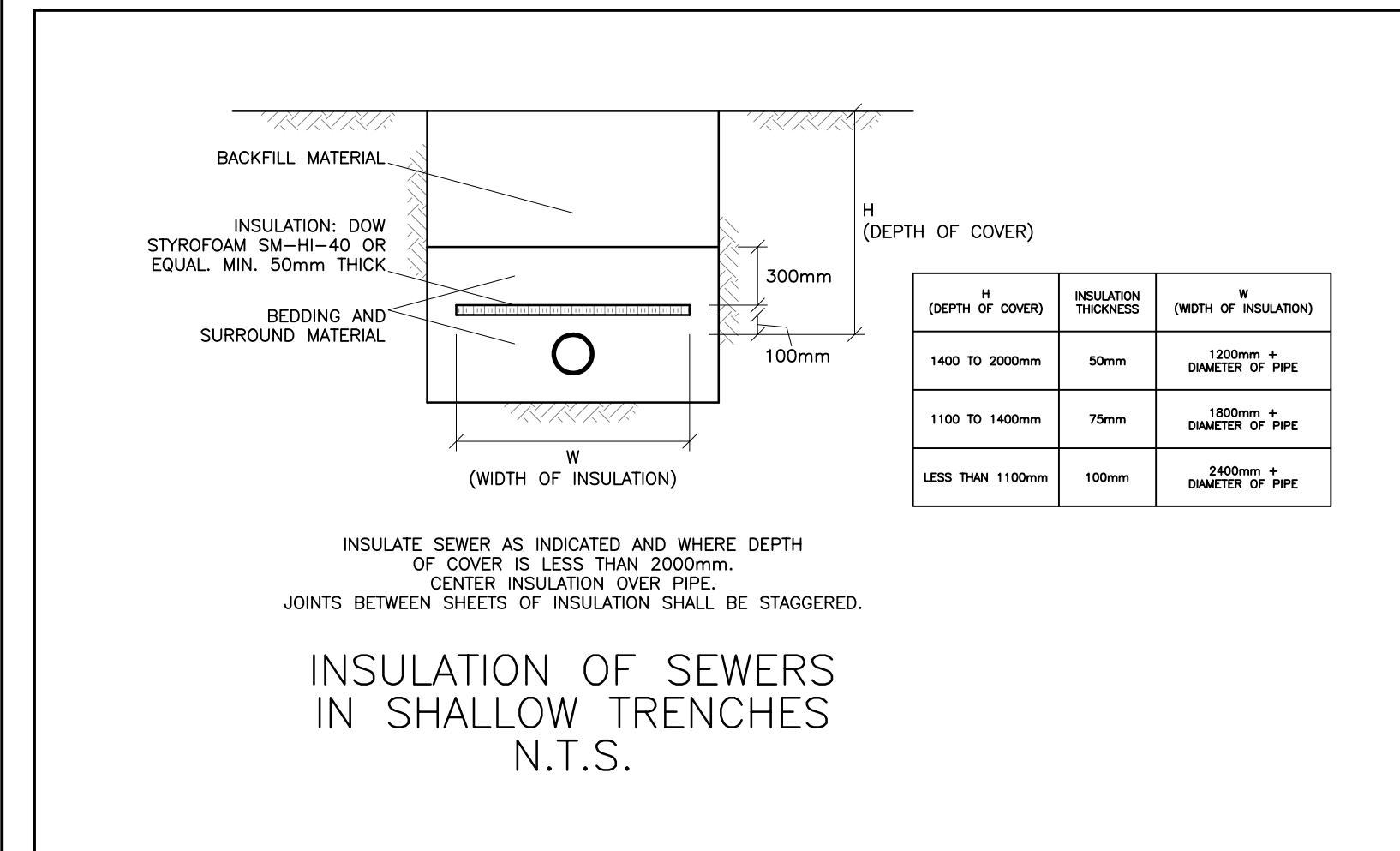

INSULATION OF SEWERS IN SHALLOW TRENCHES
 N.T.S.

REFER TO NOTES & DETAILS ON DRAWINGS C-5 & C-6

KEY PLAN

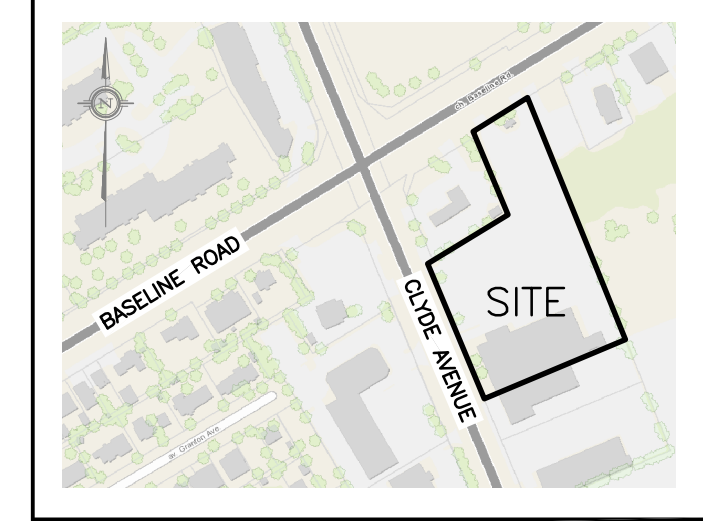

| No. | DATE | REVISION |
|-----|-----------|-------------------------|
| 5 | DEC 14-21 | RE-ISSUED FOR APPROVAL |
| 4 | DEC 9-21 | ISSUED FOR PERMIT |
| 3 | NOV 23-21 | ISSUED FOR COORDINATION |
| 2 | JAN 8-20 | ISSUED FOR APPROVAL |
| 1 | DEC 12-19 | ISSUED FOR COORDINATION |

D. B. GRAY ENGINEERING INC.
 Stormwater Management - Grading & Drainage - Storm & Sanitary Sewers - Watermain
 700 Long Point Circle 613-425-8044
 Ottawa, Ontario d.gray@dbgrayengineering.com

Project
PROPOSED 6-STORY STORAGE FACILITY & 1-STORY BUILDING
1375 CLYDE AVENUE
 OTTAWA, ONTARIO

DETAILS 2

| | | |
|---------------------------------|---|---|
| | Engineer's Seal D.B. GRAY 17016502 DEC 14-21 PROVINCE OF ONTARIO | Drawn D.B.G. Hor. Scale Vert. Scale Date SEP 17-19 Job No. 19058 |
| NOT VALID UNLESS SIGNED & DATED | | Drawing No. C-7 of 8 |