

-
- TYP. UNDERGROUND WATER STORAGE INSULATION**
- TASK NOTES:**
- 1) TWO 50000L PRECAST CONCRETE TANKS BY WILKINSON HEAVY PRECAST LTD. (OR EQUIVALENT) TO BE USED FOR FIVE WATER STORAGE. TANKS ARE TO BE CONNECTED WITH EACH OTHER WITH 200MM PIPE. HYDRANT TO BE INSTALLED DIRECTLY ABOVE TANK AS SHOWN ON C300.
 - 2) TANKS TO BE COVERED IN 4" OF RIGID INSULATION IN A 1" SHAPE UP TOP A DEPTH OF 2.4m UNFINISHED GRADE.
 - 3) TANKS TO BE INSTALLED IN ACCORDANCE WITH RECOMMENDED INSTALLATION PROCEDURES AS SHOWN IN WILKINSON INSTALLATION GUIDELINES AND LIFTING ASSEMBLY INSTRUCTIONS.

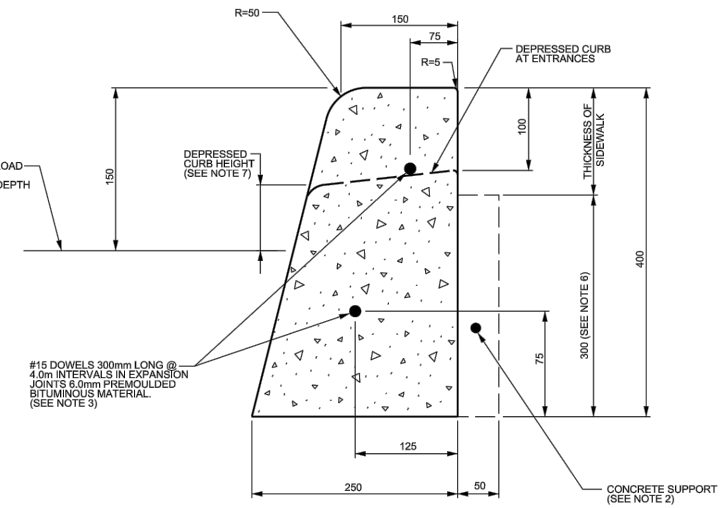

NOTES:

1. THE FULL CURB DEPTH SHALL BE CARRIED THROUGH THE DERESSED ACCESS CROSSING.
2. A CONCRETE SUPPORT IS REQUIRED WHEN RAIL ALIGNMENT TO THE SIDEWALK.
3. IF AN EXISTING CURBING DURING MAINT BE USED.
4. THE EXPOSURE DURING EXCAVATION MATERIAL AND THE #4 DOWELS ARE TO BE PLACED AT THE END OF THE EXTRUSION
5. ALL OVERLAYS ARE IN MILLIMETERS UNLESS OTHERWISE SPECIFIED.
6. DUMMY JANTS SHALL BE 25mm DEPT. FRONT, BACK AND TOP OF SECTION AT 3m SPACING.
7. FOR DERESSED CURB AT ENTRANCES USE 250.
7. DERESSED CURB HEIGHT: FOR PEDESTRIAN CURB RAMP'S 6 TO 8 mm AND FOR PRIVATE ENTRANCES 6 TO 25mm.

- ### GENERAL NOTES

DESIGN PROVISIONS

 - THESE WALLS ARE DESIGNED FOR THE FOLLOWING CONDITIONS:

RETAINING WALL TYPE	1	2	3	4	5	6	7	8	9	10	11	12	13	14	15	16	17	18	19	20	21	22	23	24	25	26	27	28	29	30	31	32	33	34	35	36	37	38	39	40	41	42	43	44	45	46	47	48	49	50	51	52	53	54	55	56	57	58	59	60	61	62	63	64	65	66	67	68	69	70	71	72	73	74	75	76	77	78	79	80	81	82	83	84	85	86	87	88	89	90	91	92	93	94	95	96	97	98	99	100
RETAINING WALL TYPE	1	2	3	4	5	6	7	8	9	10	11	12	13	14	15	16	17	18	19	20	21	22	23	24	25	26	27	28	29	30	31	32	33	34	35	36	37	38	39	40	41	42	43	44	45	46	47	48	49	50	51	52	53	54	55	56	57	58	59	60	61	62	63	64	65	66	67	68	69	70	71	72	73	74	75	76	77	78	79	80	81	82	83	84	85	86	87	88	89	90	91	92	93	94	95	96	97	98	99	100
 - THESE WALLS ARE DESIGNED FOR THE FOLLOWING CONDITIONS:

RETAINING WALL TYPE	1	2	3	4	5	6	7	8	9	10	11	12	13	14	15	16	17	18	19	20	21	22	23	24	25	26	27	28	29	30	31	32	33	34	35	36	37	38	39	40	41	42	43	44	45	46	47	48	49	50	51	52	53	54	55	56	57	58	59	60	61	62	63	64	65	66	67	68	69	70	71	72	73	74	75	76	77	78	79	80	81	82	83	84	85	86	87	88	89	90	91	92	93	94	95	96	97	98	99	100
RETAINING WALL TYPE	1	2	3	4	5	6	7	8	9	10	11	12	13	14	15	16	17	18	19	20	21	22	23	24	25	26	27	28	29	30	31	32	33	34	35	36	37	38	39	40	41	42	43	44	45	46	47	48	49	50	51	52	53	54	55	56	57	58	59	60	61	62	63	64	65	66	67	68	69	70	71	72	73	74	75	76	77	78	79	80	81	82	83	84	85	86	87	88	89	90	91	92	93	94	95	96	97	98	99	100
 - THESE WALLS ARE DESIGNED FOR THE FOLLOWING CONDITIONS:

RETAINING WALL TYPE	1	2	3	4	5	6	7	8	9	10	11	12	13	14	15	16	17	18	19	20	21	22	23	24	25	26	27	28	29	30	31	32	33	34	35	36	37	38	39	40	41	42	43	44	45	46	47	48	49	50	51	52	53	54	55	56	57	58	59	60	61	62	63	64	65	66	67	68	69	70	71	72	73	74	75	76
---------------------	---	---	---	---	---	---	---	---	---	----	----	----	----	----	----	----	----	----	----	----	----	----	----	----	----	----	----	----	----	----	----	----	----	----	----	----	----	----	----	----	----	----	----	----	----	----	----	----	----	----	----	----	----	----	----	----	----	----	----	----	----	----	----	----	----	----	----	----	----	----	----	----	----	----	----	----

#8		
#7		
#6		
#5		
#4		
#3	ISSUED FOR CITY COMMENTS 8	29 / 11 / 2021
#2	ISSUED FOR CITY COMMENTS 7	24 / 08 / 2020
#1	ISSUED FOR CITY COMMENTS 6	26 / 03 / 2020
NO.	REVISION	DATE (DD/MM/YYYY)

767, Notre Dame, Local 42, Embarras, Ontario, K0A 1M1
693-0700 blengineering.ca

BERGERON CONSTRUCTION
172 ST.-THOMAS ROAD
VARS, ON, K0A 3H0

12 UNIT APARTMENT BUILDING
5574 ROCKDALE ROAD
VARS, ON

POST DEVELOPMENT STORM DRAINAGE PLAN

PAPER FORMAT:	24x36
DRAWN BY:	BF + GB
CHECKED BY:	GB
DATE:	11-2021
SCALE:	1:500
PROJECT NUMBER:	19-276

PAGE:

C500