

LEGEND

- Existing Deciduous Tree to Remain
- Existing Coniferous Tree to Remain
- Proposed Deciduous Tree
- Proposed Coniferous Tree
- Proposed Deciduous Shrub
- Proposed Coniferous Shrub
- Proposed Perennial
- Proposed Bike Rack
- Proposed Barrier-free Signage
- Proposed 1.8m Shadowbox Wood Fence
- Existing 1.8m Board Fence
- Re. L3.0 for planting and furnishing details
- #1- re. comments from City

PLANT LIST									
Key	Botanical Name	Common Name	Qty	Size	Conditions	Spacing	Remarks		
Deciduous Trees									
AF	Acer x freemanii 'Celebration'	Celebration Maple	5	60mm cal	WB				full crown
AM	Amelanchier laevis	Allegheny Serviceberry	5	50mm cal	WB				full crown
AR	Acer rubrum	Red Maple	6	60mm cal	WB				full crown
GT	Gleditsia triacanthos	Honey Locust	6	60mm cal	WB				full crown
Coniferous Trees									
PP	Picea glauca	White Spruce	3	200cm	WB				uniform spread
AB	Abies concolor	White Fir	3	200cm	WB				uniform spread
Shrubs									
Co	Cornus alba 'Siberica'	Redbark Dogwood	50	40cm 3gal	Cont.	120cm			min. 5 canes
Ju	Juniperus sabinia 'Blue Danube'	Blue Danube Juniper	53	40cm 3 gal	Cont.	100cm			uniform spread
Po	Potentilla fruticosa 'Red Ace'	Red Ace Cinqfoil	20	40cm 3 gal	Cont.	60cm			plant in offset lines / zig zag pattern to fill space
Rh	Rhus aromatica 'Gro-Low'	Fragrant Sumac	50	2gal	Cont.	100cm			plant in offset lines / zig zag pattern to fill space
Sj	Spiraea japonica 'Flaming Mound'	Flaming Mound Spirea	63	40cm 3 gal	Cont.	75cm			plant in offset lines / zig zag pattern to fill space
Ta	Taxus x media 'Wardii'	Ward's Yew	20	40cm 3 gal	Cont.	100cm			plant in offset lines / zig zag pattern to fill space
Perennials / Ornamental Grasses									
ach	Achillea millefolium 'Paprika'	Paprika Yarrow	129	1gal	Cont.	50cm			plant in offset lines / zig zag pattern to fill space
hem	Hemerocallis 'Anzac'	Anzac Daylily	325	1gal	Cont.	50cm			plant in offset lines / zig zag pattern to fill space
pan	Panicum virgatum 'Prairie Fire'	Prairie Fire Switch Grass	102	1gal	Cont.	60cm			plant in offset lines / zig zag pattern to fill space
rud	Rudbeckia 'Hirta'	Black Eyed Susan	274	1gal	Cont.	50cm			plant in offset lines / zig zag pattern to fill space

PLANT NOTES:
 ALL PLANT MATERIAL SUBJECT TO STANDARD TWO (2) YEAR MAINTENANCE PERIOD COMMENCING UPON ISSUANCE DATE OF THE CERTIFICATE OF SUBSTANTIAL COMPLETION AND ACCEPTANCE OF THE ABOVE GROUND WORKS.
 QUANTITIES INDICATED ON THE PLAN TO GOVERN.
 DO NOT PLANT IN SWALE CENTRES.
 ▲ THE MINIMUM OF SOIL AREA PER TREE IS 10 SQUARE METERS.

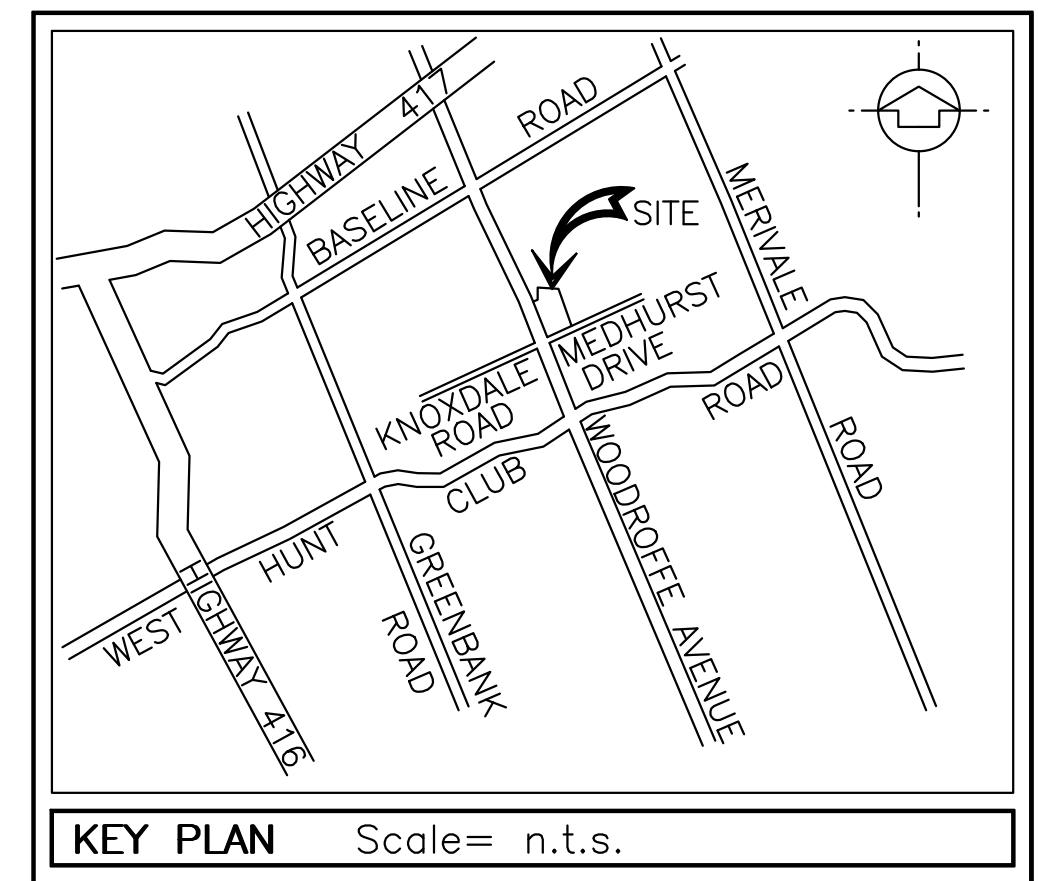

Unless otherwise agreed in a written contract between Wood and its client, this document: (i) contains information, data and design that is confidential and may not be copied or disclosed; and (ii) may be used by the client only in the context and for the express purpose for which it was intended. Any use of, or reliance on, this document by any third party is that party's sole risk.

COPYRIGHT NOTICE
 This drawing is the property of the above referenced Professional and is not to be used for any purpose other than the specific project and site named herein, and cannot be reproduced in any manner without the express written permission from the Professional.
 04/21/21 FOR CLIENT REVIEW
 04/27/21 ISSUED FOR SPA
 09/21/21 RE-ISSUED FOR SPA

PROFESSIONAL SEAL

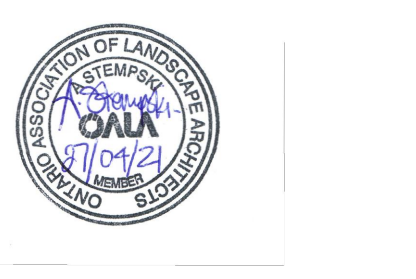

ska
 Stempski Kelly Associates Inc.
 Design | Landscape Architecture | Planning
 P.O. Box 399, Fergus, ON, N1M 3E2
 Voice: (519) 787-4313
 stasko@ska-design.ca www.ska-design.ca

PROFESSIONAL IN CHARGE
 S. STEMPSKI
PROJECT MANAGER
 S. LAWRENCE
QUALITY CONTROL
 F. RIVARD
DRAWN BY
 J. YI

PROJECT NAME
CIRCLE K STORES INC.
R&R No. 52287
NEPEAN ONTARIO
 1545 WOODROFFE AVENUE
 NEPEAN, ON, CANADA
 K2G 1W2



CIRCLE K STORES INC.

PROJECT NUMBER
 BF20207036

SHEET TITLE
LANDSCAPE PROPOSED PLANTING AND LANDSCAPING PLAN

SHEET NUMBER
L2.0

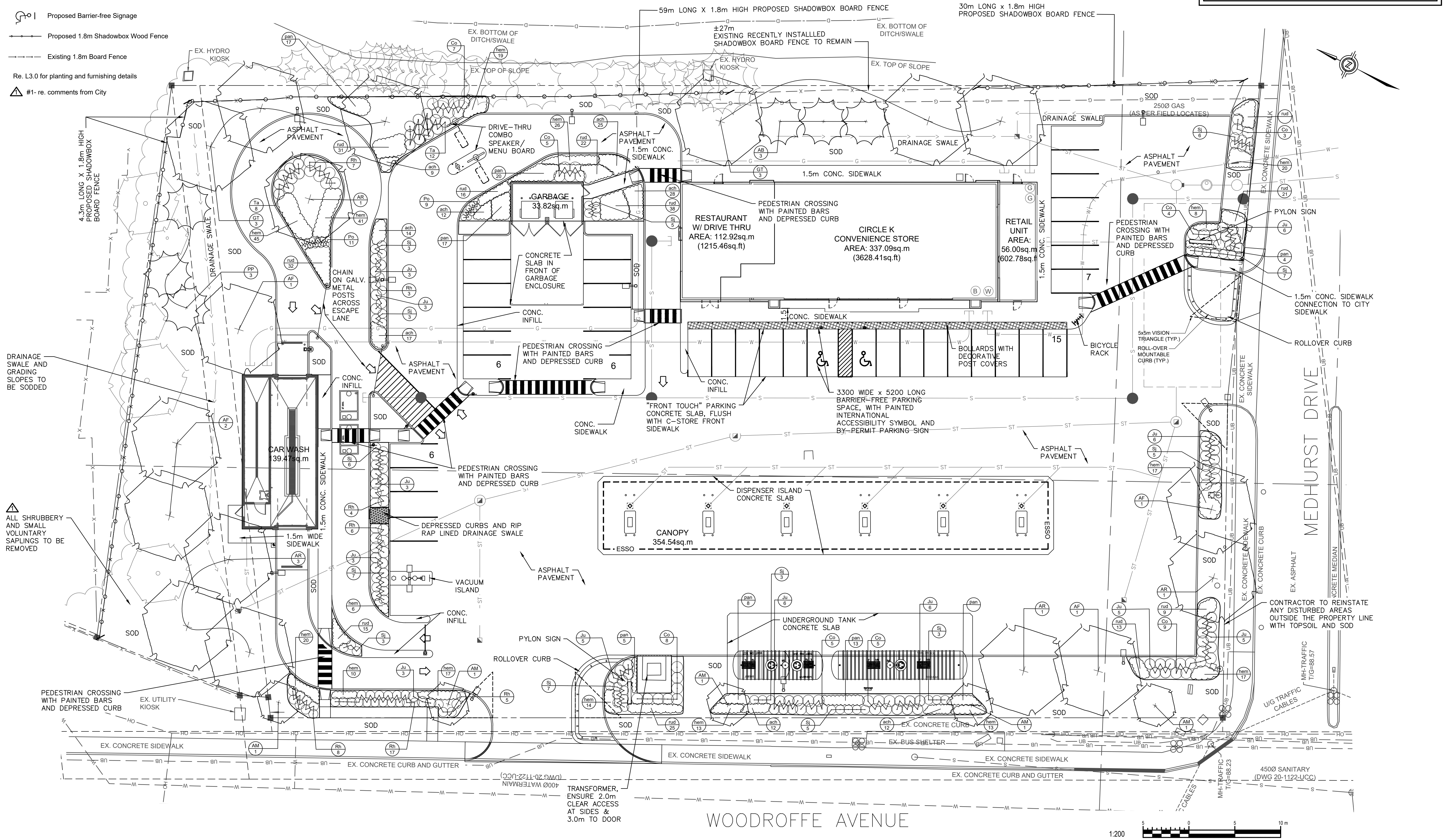

WOODROFFE AVENUE

