

Copyright Reserved

The Contractor shall verify and be responsible for all dimensions. DO NOT scale the drawing - any errors or omissions shall be reported to Stantec without delay.
The Copyrights to all designs and drawings are the property of Stantec. Reproduction or use for any purpose other than that authorized by Stantec is forbidden.

Legend

- AREA ID
- RUNOFF COEFFICIENT
- STORM DRAINAGE AREA ha.
- STORM DRAINAGE BOUNDARY
- EX. AREA ID
- EX. RUNOFF COEFFICIENT
- EX. STORM DRAINAGE AREA ha.
- EX. STORM DRAINAGE BOUNDARY
- 100YR. PONDING LIMITS
- DIRECTION OF OVERLAND FLOW
- PROPOSED STORM SEWER
- PROPOSED DITCH INLET CATCHBASIN
- EXISTING STORM SEWER
- EXISTING CATCHBASIN
- EXISTING SUBDRAIN CATCHBASIN
- EXISTING SWALE
- THERMAL INSULATION ON STORM SEWER WHERE COVER IS LESS THAN 1.5m. THERMAL INSULATION ON WATERMAIN WHERE COVER IS LESS THAN 2.4m AS PER W22.

- FINAL SERVICE LATERAL SIZES TO BE CONFIRMED BY MECHANICAL CONSULTANT.
- ALL ROOF EAVES TROUGH TO OUTLET TO INTERNAL SURFACE PARKING AREAS.

Revision	By	Appd.	YY.MM.DD
3	ISSUED FOR SPA	JP	DT 21.09.09
2	ISSUED FOR SPA	JP	DT 21.04.30
1	ISSUED FOR SPA	JP	DT 20.12.16

File Name:	160401585-DB	JP	DT/SG	JP	DT	20.11.06
Permit-Seal		Dwn.	Chkd.	Dgn.	YY.MM.DD	

Client/Project
RICHCRAFT GROUP OF COMPANIES
2280 ST. LAURENT BLVD
PROPOSED RESIDENTIAL DEVELOPMENT
TRAILSEDGE BLOCK 193 & 194
OTTAWA, ON

Title
STORM DRAINAGE PLAN

Project No. 160401585
Drawing No. SD-1
Scale 1:500
Sheet 9 of 11
Revision 3

DWG# 18359

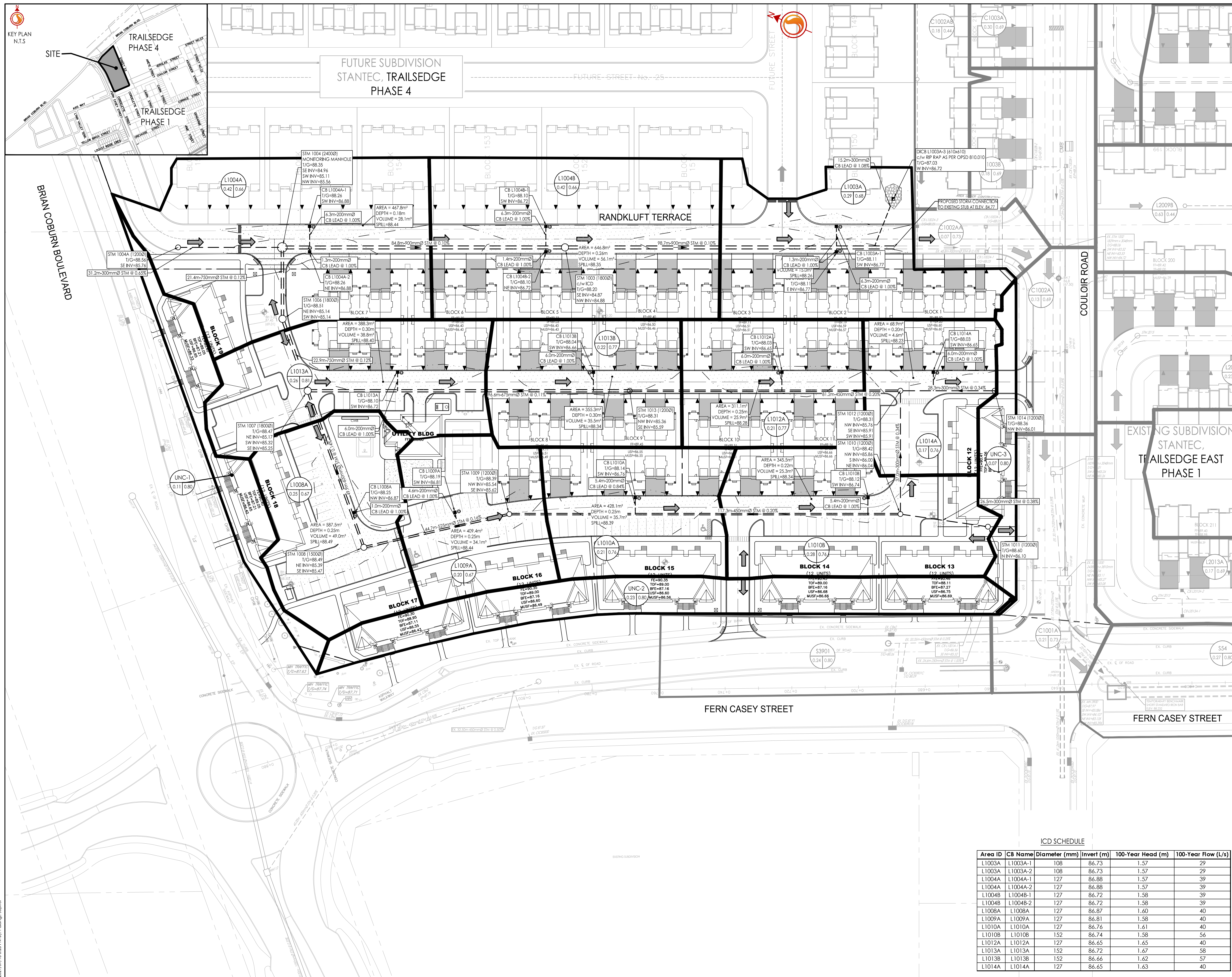

ICD SCHEDULE

Area ID	CB Name	Diameter (mm)	Invert (m)	100-Year Head (m)	100-Year Flow (L/s)
L1003A	L1003A-1	108	86.73	1.57	29
L1003A	L1003A-2	108	86.73	1.57	29
L1004A	L1004A-1	127	86.88	1.57	39
L1004A	L1004A-2	127	86.88	1.57	39
L1004B	L1004B-1	127	86.72	1.58	39
L1004B	L1004B-2	127	86.72	1.58	39
L1008A	L1008A	127	86.87	1.60	40
L1009A	L1009A	127	86.81	1.58	40
L1010A	L1010A	127	86.76	1.61	40
L1010B	L1010B	152	86.74	1.58	56
L1012A	L1012A	127	86.65	1.65	40
L1013A	L1013A	152	86.72	1.67	58
L1013B	L1013B	152	86.66	1.62	57
L1014A	L1014A	127	86.65	1.63	40

W:\active\160401585\design\drawing\160401585-DB.dwg
2021/09/13 3:25 PM by P. Babin, J. Poirier