

THIS PLAN IS ISSUED FOR SITE PLAN CONTROL ONLY.
ADDITIONAL DETAILING AND SPECIFICATIONS ARE
REQUIRED PRIOR TO TENDERING AND CONSTRUCTION.

PLEASE CONFIRM KEYPLAN BEFORE
GENERAL NOTES

- All general site information and conditions compiled from existing plans, site visits and consultant's field notes. Report all discrepancies prior to any work. No responsibility is born by the Consultant for unknown subsurface conditions.
- The location of the utilities is approximate only, and the exact location must be determined by consulting the municipal authorities and utility companies concerned. The Contractor shall prove the location of utilities and shall be responsible for adequate protection from damage.
- All dimensions shown are to be verified on site prior to any construction. No deviations are to be made from the layouts as shown on this plan without prior consultation with the Landscape Architect and Owner.
- No other trees to be removed without prior approval by Landscape Architect.

No.	ISSUE	DATE
7		
6		
5		
4		
3	RE-ISSUED FOR SITE PLAN CONTROL	Jul 09/21
2	RE-ISSUED FOR SITE PLAN CONTROL	Apr. 28/21
1	ISSUED FOR SITE PLAN CONTROL	Sep. 01/20

SCALE:
1:25
0

IBI GROUP
Suite 400 - 333 Preston Street
Ottawa ON K1S 5N4 Canada
tel 613 225 1311 / 613 241 3300 fax 613 225 8868
ibigroup.com

Ruhland & Associates Ltd
208-1750 Courtwood Crescent, Ottawa, Ontario K3C 2B5
T (613) 324-4744 x 300 F (613) 324-4731 info@rah.ca www.rah.ca

PROJECT NORTH:
PROFESSIONAL STAMP:

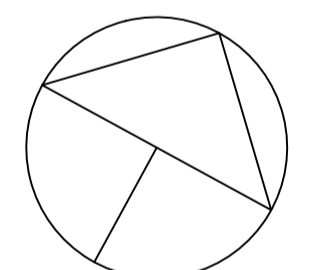

PROJECT:
**COWAN'S GROVE BLOCK 223
JAZZ STACKED TOWNHOMES**

DRAWING:
LANDSCAPE PLAN

DESIGN:	M.R.	DRAWING NO:	L-01
DRAWN:	M.M.	G-C NO:	
CHECKED:	M.R.		
PLOTTED:			

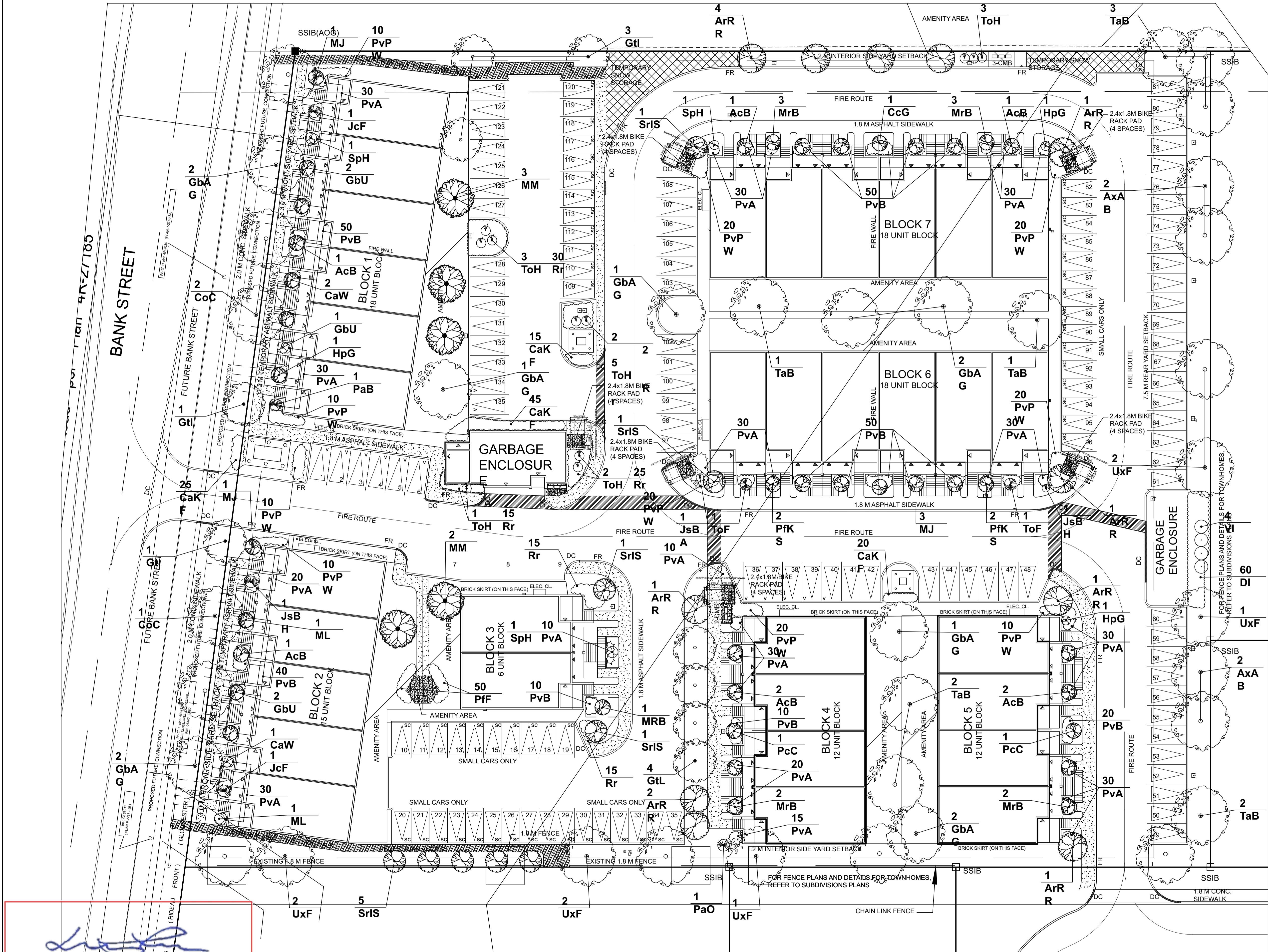

LILY XU, MCIP, RPP
MANAGER, DEVELOPMENT REVIEW SOUTH
PLANNING, INFRASTRUCTURE & ECONOMIC
DEVELOPMENT DEPARTMENT, CITY OF OTTAWA

APPROVED
By Lily Xu at 6:01 pm, Aug 30, 2021

COWAN'S GROVE BLOCK 223 Tree Planting						
Key	Qty	Botanical Name	Common Name	Size	Remarks	Notes
CO						
Coniferous Trees - Small Ornamental						
JcF	2	Juniperus chinensis 'Fairview'	Fairview Juniper	100 cm ht.	Potted	Small Ornamental Conifer
JsBA	1	Juniperus scopulorum 'Blue Arrow'	Blue Arrow Juniper	100 cm ht.	Potted	Small Ornamental Conifer
JsBH	2	Juniperus scopulorum 'Blue Haven'	Blue Haven Juniper	100 cm ht.	Potted	Small Ornamental Conifer
PcC	2	Pinus cembra 'Chalet'	Chalet Swiss Stone Pine	80cm ht.	Potted	Small Ornamental Conifer
ToH	12	Thuja occidentalis 'Holmstrup'	Holmstrup Cedar	100 cm ht.	Potted	Small Ornamental Conifer
Coniferous Trees - Small						
PaO	1	Picea abies 'Ohlendorffii'	Ohlendorff Spruce	150 cm ht.	Potted / BB	Small Conifer
PaB	1	Pinus aristata 'Bristlecone'	Bristlecone Pine	80cm ht.	Potted / BB	Small Conifer
ToF	1	Thuja occidentalis fastigiata	Pyramidal White Cedar	125 cm ht.	Potted / BB	Small Conifer
Deciduous Trees - Small Ornamental						
CaW	3	Caragana arborescens 'Walker'	Walker's Weeping Caragana	125cm stem	Potted staked	Ornamental Tree
ML	2	Malus 'Lollizam'	Lollipop Crab Apple	125cm stem	Potted staked	Ornamental Tree
GbU	5	Ginkgo biloba 'Umbrella'	Umbrella Ginkgo	50cm ht	Potted staked	Ornamental Tree
HpG	3	Hydrangea paniculata 'Grandiflora' tree form	Pegee Hydrangea	40mm cal.	WB staked	Ornamental Tree
SpH	3	Syringa pubescens 'Hers'	Weeping Lilac	125cm stem	Potted staked	Ornamental Tree
Deciduous Trees - Small						
AcB	8	Amelanchier canadensis 'Ballerina'	Ballerina Serviceberry	50mm cal.	WB staked	Small Deciduous Tree
CcG	3	Craetagus crus-galli var. inermis	Thornless Cockspur Hawthorn	250cm ht	WB staked	Small Deciduous Tree
MJ	5	Malus 'Jeffwall'	Green Wall Crab Apple	175cm ht	WB staked	Small Deciduous Tree
MrB	11	Malus 'Royal Beauty'	Royal Beauty Crab Apple	40mm cal.	WB staked	Small Deciduous Tree
PfKS	4	Pyrus fauriei 'Korean Sun'	Korean Sun Pear	175cm ht	WB staked	Small Deciduous Tree
Deciduous Trees						
ArRR	11	Acer rubrum 'Red Rocket'	Red Rocket Red Maple	60mm cal.	WB staked	Medium Deciduous Tree
AxAB	4	Acer x freemanii 'Autumn Blaze'	Autumn Blaze Maple	70mm cal.	WB staked	Medium Deciduous Tree
CoC	3	Celtis occidentalis 'Chicagoland'	Chicagoland Hackberry	70mm cal.	WB staked	Medium Deciduous Tree
GbAG	11	Ginkgo biloba Autumn Gold	Autumn Gold Maidenhair Tree	70mm cal.	WB staked	Medium Deciduous Tree
Gtl	9	Gleditsia triacanthos 'Impcole'	Imperial Honeylocust	70mm cal.	WB staked	Medium Deciduous Tree
MM	5	Malus x Makamik	Makamik Crabapple	50mm cal.	WB staked	Large Ornamental Tree
SrlS	9	Syringa reticulata 'Ivory Silk'	Ivory Silk Tree Lilac	50mm cal.	WB staked	Large Ornamental Tree
Sp	8	Syringa prestoniae	Preston Lilac			
TaB	9	Tilia americana 'Boulevard'	Boulevard Linden	70mm cal.	WB staked	Medium Deciduous Tree
UxF	8	Umus x 'Frontier'	Frontier Elm	70mm cal.	WB staked	Medium Deciduous Tree

Plant List - Shrubs & Perennials					
ID	Qty	Botanical Name	Common Name	Scheduled S	Remarks
Shrubs					
DI	60	Diervilla lonicera	Bush Honey Suckle	50 cm ht.	Potted, 1.0m o.c.
PfF	50	Potentilla fruticosa 'Farreri'	Gold Drop Potentilla	50cm ht.	Potted, 0.85m o.c.
Rr	125	Rosa rugosa	Rugosa Rose	50 cm ht.	Potted, 1.0m o.c.
SnS	50	Spiraea nipponica 'Snowmound'	Snowmound Spirea	51 cm ht.	Potted, 1.0m o.c.
VI	4	Viburnum lentago	Nannyberry	50 cm ht.	Potted, 1.0m o.c.
Perennials					
CaKF	105	Calamagrostis acutifolia 'Karl Foerster'	Karl Foerster Feather Reed Grass	1 gallon Pot	0.80m o.c.
PvA	360	Flowering Perennials type A		150mm Pot	0.60m o.c.
PvB	180	Flowering Perennials type B		150mm Pot	0.60m o.c.
PvPW	200	Panicum virgatum 'Prairie Winds'	Cheyenne Sky Switch Grass	1 gallon Pot	0.75m o.c.

- A SUBSOIL / SUBGRADE CULTIVATED LAYER
- B PLANTING MEDIUM
- C ROOTBALL / POT
- D TOP OF ROOT CROWN TO BE FLUSH WITH PLANTING SOIL
- E 1-METAL POST (40x 40x 2100 mm) PLACE AT OUTSIDE OF ROOTBALL AND FASTEN TO TRUNK WITH 3 mmØ GALVANIZED WIRE AND 25 mmØ 2 PLY REINFORCED HOSE (PARALLEL TO CURB). INSTALLED ON PREVAILING WIND SIDE OF TREE
- F 50-75 mm MULCH LAYER, KEEP MULCH AWAY FROM STEMS AND PROVIDE 100mm DEEP SAUCER.
- G PRUNE DAMAGE, DISEASED OR WEAK BRANCHES AS PER ACCEPTED HORTICULTURAL PRACTICE. DO NOT DAMAGE OR REMOVE LEADER
- H FIRST ROW OF SHRUBS TO BE PLANTED 600mm MINIMUM FROM FRONT OF CURB (AT TREE LOCATIONS, 900mm ELSEWHERE).

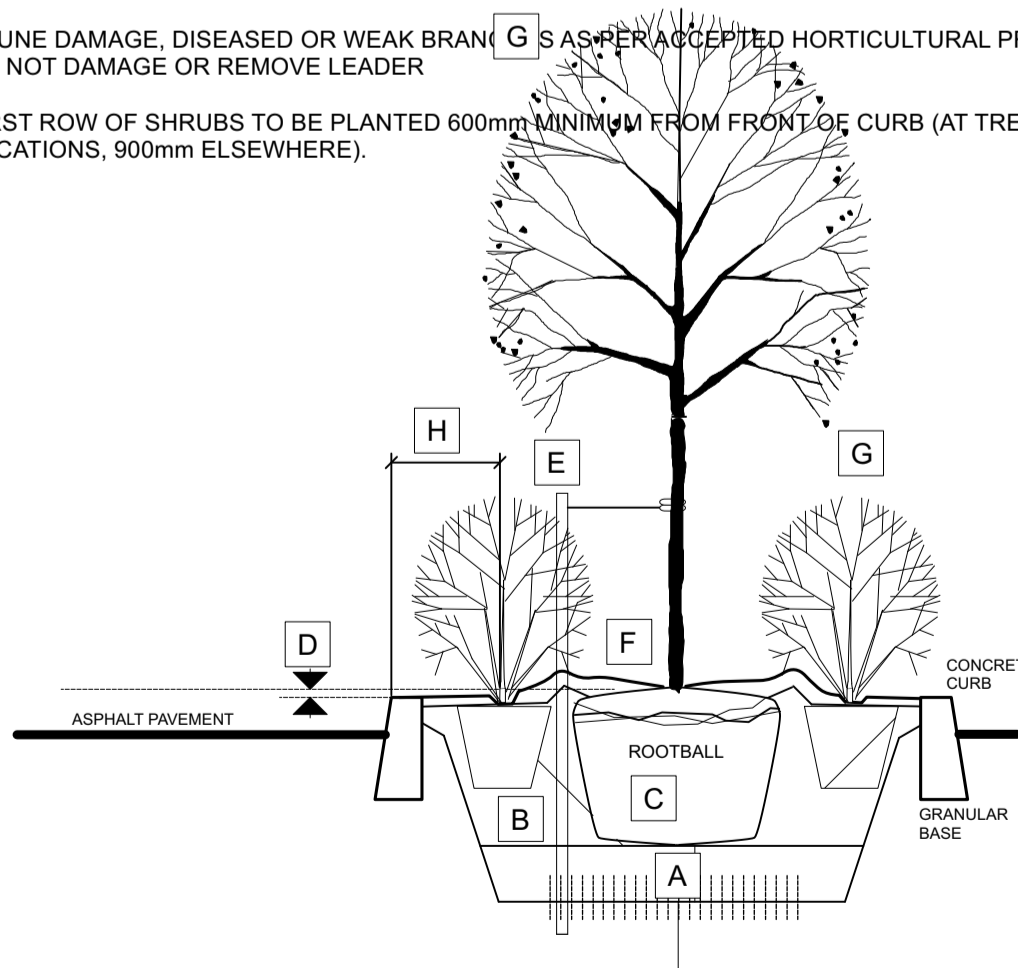

PLANTING IN ISLANDS

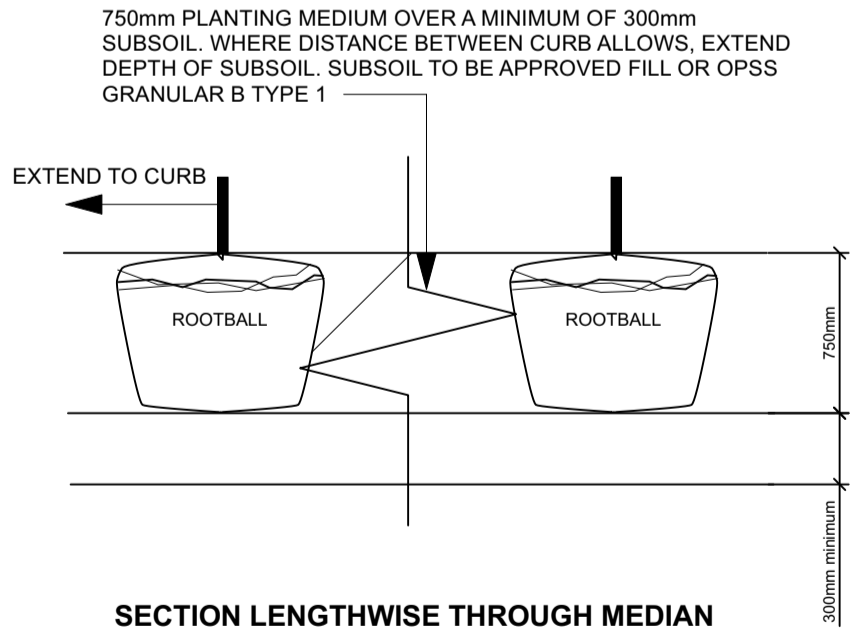

SECTION LENGTHWISE THROUGH MEDIAN

Bed Preparation

- EXCAVATE OR PLACE FILL FOR PLANTING BED TO PROVIDE 750mm MINIMUM DEPTH OF PLANTING MEDIUM AND 300mm DEPTH SUBSOIL (CONTINUOUS BETWEEN TREES). CULTIVATE PLANTING SUBSOIL INTO SUBGRADE TO A DEPTH OF 150mm.
- PLACE COMPACTED PLANTING MEDIUM ON SUBSOIL TO ACHIEVE FINAL GRADE.
- CENTRE OF BED TO BE CROWNED ABOVE ADJACENT GRADE TO APPROVAL OF CONSULTANT.

- A 450mm COMPACTED PLANTING MEDIUM, DEEPEN AT TREES
- B ROOTBALL, TOP OF ROOT CROWN TO BE FLUSH WITH PLANTING MEDIUM
- C 350mm PLANTING MEDIUM / SUBSOIL CULTIVATED LAYER. CULTIVATE AT TREE PIT BOTTOM. SEE NOTE BELOW.
- D EDGE TO DEPTH OF 100mm
- E 50-75 mm MULCH LAYER, KEEP MULCH AWAY FROM STEMS
- F PRUNE DAMAGE, DISEASED OR WEAK BRANCHES AS PER ACCEPTED HORTICULTURAL PRACTICE, DO NOT DAMAGE OR REMOVE LEADER
- G FIRST ROW OF PERENNIALS TO BE PLANTED 600mm FROM EDGE OF BED/CURB FIRST ROW OF SHRUBS TO BE PLANTED 900mm FROM EDGE OF BED/CURB
- H PROVIDE 150 mm DEEP SAUCER AT TREES
- I PLANT SPECIES TO HAVE A MINIMUM SEPARATION BETWEEN PLANT CENTRES:
- 1.2m BETWEEN DECIDUOUS SHRUBS AND SPREADING EVERGREEN SHRUBS OR PERENNIALS
 - 0.9m BETWEEN SPREADING EVERGREEN SHRUBS AND PERENNIALS
 - 0.6m BETWEEN PERENNIAL TYPES

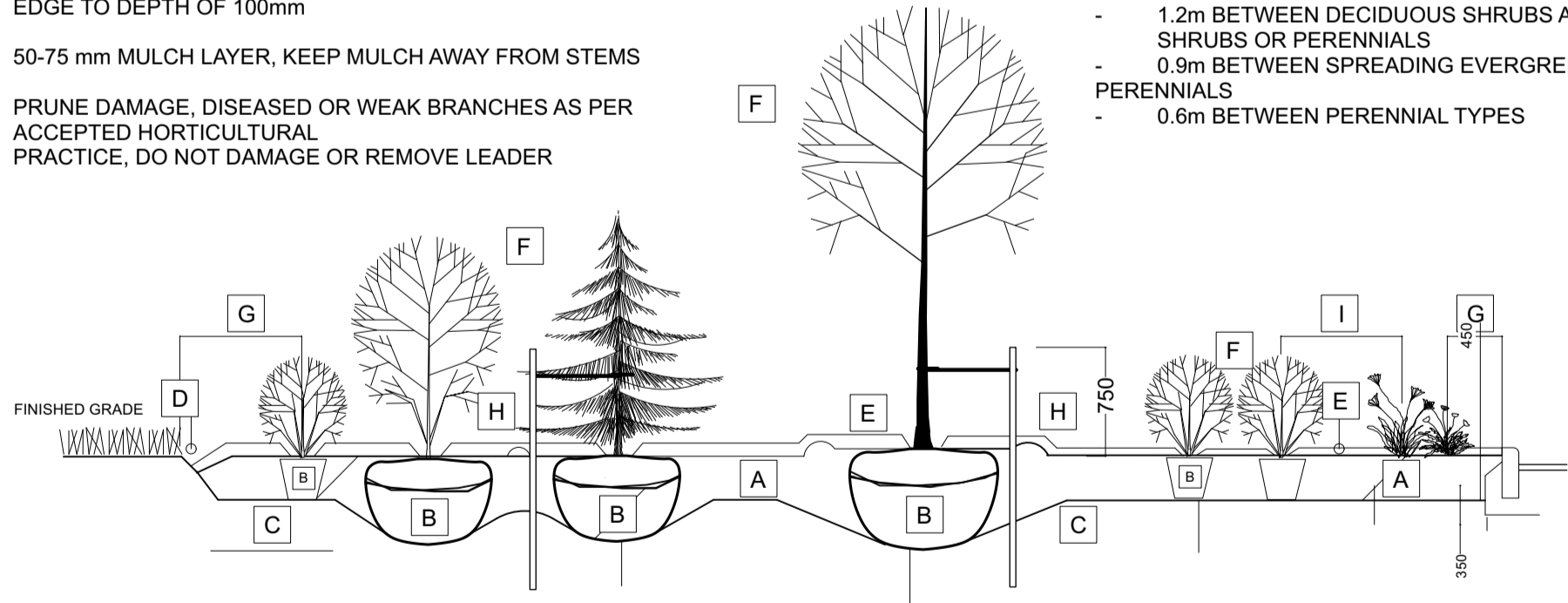

BED PREPARATION

- EXCAVATE OR PLACE FILL FOR PLANTING BED TO PROVIDE 450mm MINIMUM DEPTH OF PLANTING MEDIUM. PLANTING BED TO BE DEEPEENED AT TREE LOCATIONS. IF BASE OF PIT IS OVER EXCAVATED, RAISE BOTTOM TO PROPER LEVEL WITH COMPACTED PLANTING MEDIUM.
- PLACE 150mm PLANTING MEDIUM ON SUBGRADE AND CULTIVATE INTO TOP 200mm OF SUBSOIL. SEE NOTE BELOW.
- PLACE REMAINDER OF PLANTING MEDIUM OVER CULTIVATED PORTION TO ACHIEVE FINAL GRADE.
- CENTRE OF BED TO BE CROWNED ABOVE ADJACENT GRADE TO APPROVAL OF CONSULTANT.
- ENSURE POSITIVE DRAINAGE AWAY FROM BUILDING WALLS WHERE APPLICABLE.

TREE PLANTING:

- CUT AND REMOVE TOP 1/3 OF BURLAP AND WIRE BASKET FROM ROOTBALL.
- PLACE 1-METAL POST (40 x 40 x 2100 mm) AT OUTSIDE OF ROOTBALL AND FASTEN TO TRUNK WITH APPROVED TREE TIES. INSTALLED ON PREVAILING WIND SIDE OF TREE
- WATER THOROUGHLY SUBSEQUENT TO PLANTING.
- WRAP TREE TRUNK AFTER INSPECTION OF TREES BY LANDSCAPE ARCHITECT.
- PROTECT TREE FROM RODENT DAMAGE.
- REMOVE TREE RINGS, STAKES AND TRUNK WRAPPING AFTER WARRANTY PERIOD.

PLANTING BED DETAIL ON GRADE

NOTE:

PLANTING BED AREAS: EXCAVATE TO 500mm BELOW FINAL GRADE TO ACHIEVE ROUGH GRADE ELEVATION. WHERE GRAVEL IS ENCOUNTERED ROUGH GRADE LEVEL TO BE 1000mm BELOW FINAL GRADE. PLACE APPROVED SUBSOIL IN THESE LOCATIONS TO OBTAIN PLANTING MEDIUM DEPTH. PLACEMENT OF SUBSOIL TO BE PAID AT UNIT PRICE PER m³ OF SUBSOIL PLACED MEASURED ON SITE.



Urbandale Construction
2193 Arch Street, Ottawa, ON
K1G 2H5
613-731-6331

THIS PLAN IS ISSUED FOR SITE PLAN CONTROL ONLY.
ADDITIONAL DETAILING AND SPECIFICATIONS ARE
REQUIRED PRIOR TO TENDERING AND CONSTRUCTION.

GENERAL NOTES:

- All general site information and conditions compiled from existing plans, surveys and consultant's field notes. Report all discrepancies prior to any work. No responsibility is born by the consultant for unknown subsurface conditions.
- The location of the utilities is approximate only, and the excavation should be determined by consulting the municipal authorities and utility companies concerned. The Contractor shall prove the location of utilities and shall be responsible for adequate protection from damage.
- All dimensions shown are to be verified on site prior to any construction. No deviations are to be made from the layouts as shown on this plan without prior consultation with the Landscape Architect and Owner.
- No other trees to be removed without prior approval by Landscape Architect.

7		
6		
5		
4		
3	RE-ISSUED FOR SITE PLAN CONTROL	Jul 09/21
2	RE-ISSUED FOR SITE PLAN CONTROL	Apr. 28/21
1	ISSUED FOR SITE PLAN CONTROL	Sep. 01/20
No.	ISSUE	DATE

SCALE:



Ruhland & Associates Ltd

208-1750 Courtwood Crescent, Ottawa, Ontario K3C 2B5
F (613) 324-4744 x 300 F (613) 324-4731 info@ruhl.ca www.ruhl.ca

PROJECT NORTH:	PROFESSIONAL STAMP:
PROFESSIONAL STAMP:	PROJECT NORTH:

PROJECT:	
COWAN'S GROVE BLOCK 223	
JAZZ STACKED TOWNHOMES	
DRAWING:	
LANDSCAPE PLANT LIST & DETAILS	
DESIGN: M.R.	DRAWING NO: L-02
DRAWN: M.M.	G-C NO:
CHECKED: M.R.	
PLOTTED:	