

SECTION SWALE
N.T.S.

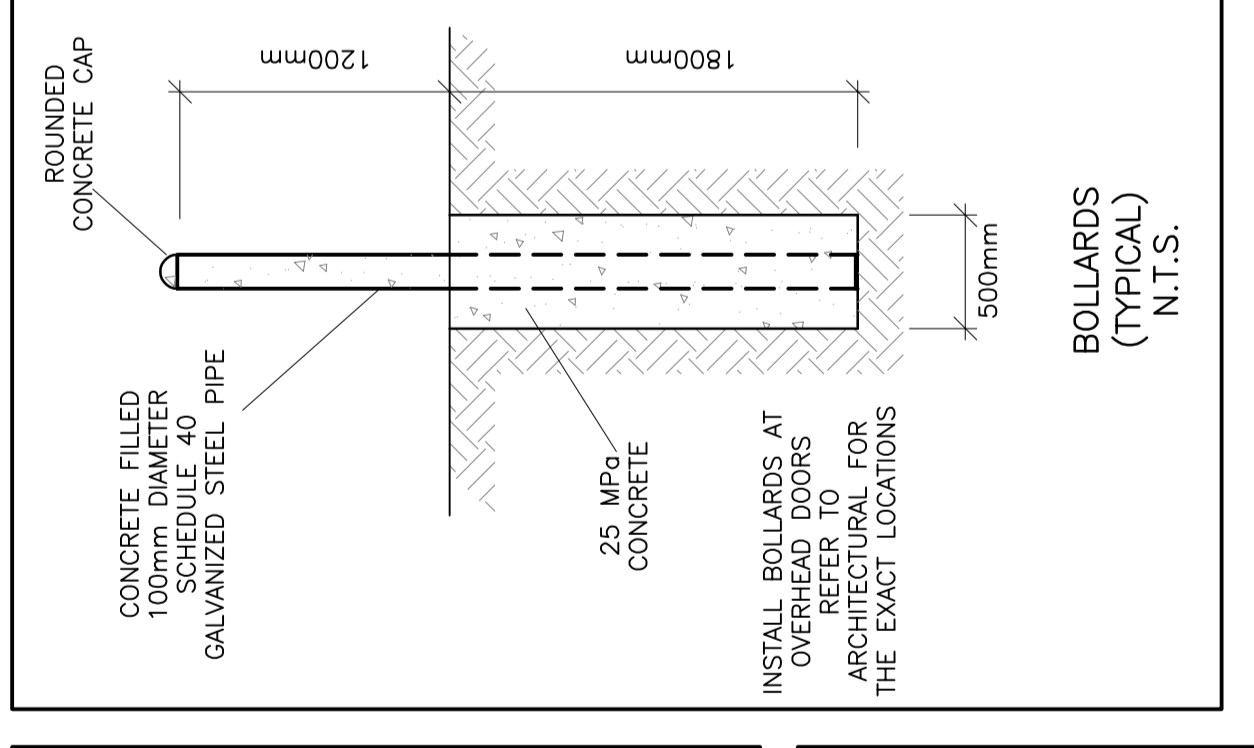

BOLLARDS
(TYPICAL)
N.T.S.

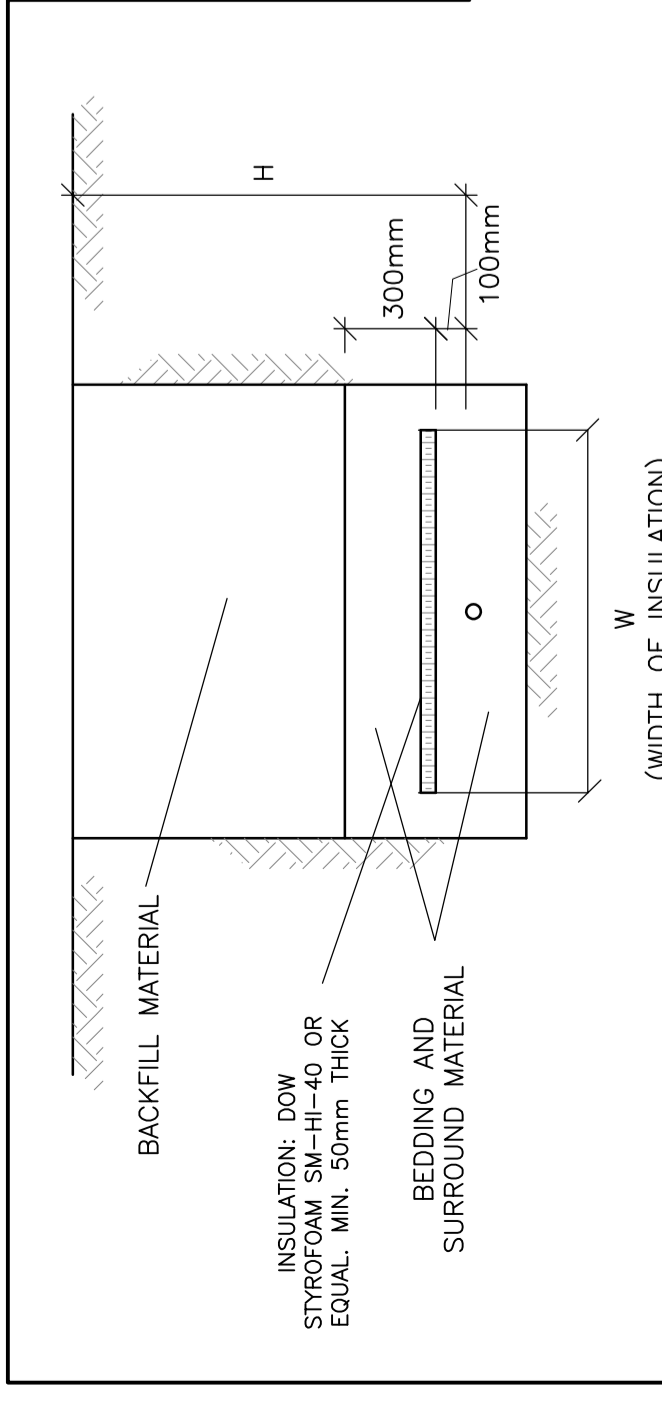

INSULATE SEWER AS INDICATED AND WHERE DEPTH OF COVER IS LESS THAN 2400mm. CENTER INSULATION OVER PIPE. JOINTS BETWEEN SHEETS OF INSULATION SHALL BE STAGGERED.

INSULATION OF WELL WATER LINE
SHALLOW TRENCHES
N.T.S.

H (DEPTH OF COVER)	INSULATION THICKNESS	W (WIDTH OF INSULATION)
1800 TO 2400mm	50mm	1200mm
1500 TO 1800mm	75mm	1800mm
1200 TO 1500mm	100mm	2400mm

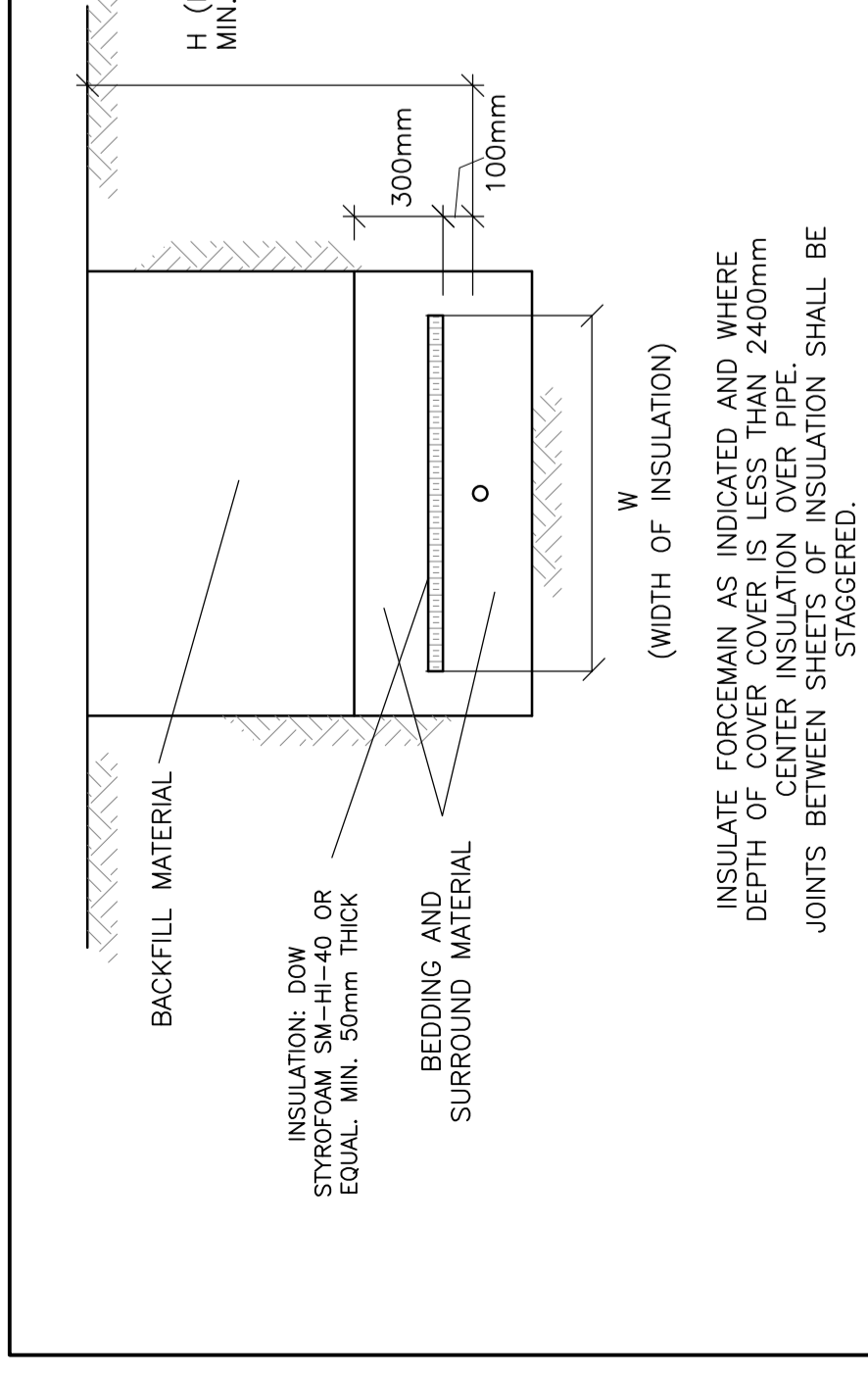

INSULATE FORCEMAIN AS INDICATED AND WHERE DEPTH OF COVER IS LESS THAN 2400mm. CENTER INSULATION OVER PIPE. JOINTS BETWEEN SHEETS OF INSULATION SHALL BE STAGGERED.

INSULATION OF SANITARY
FORCEMAIN IN SHALLOW TRENCHES
N.T.S.

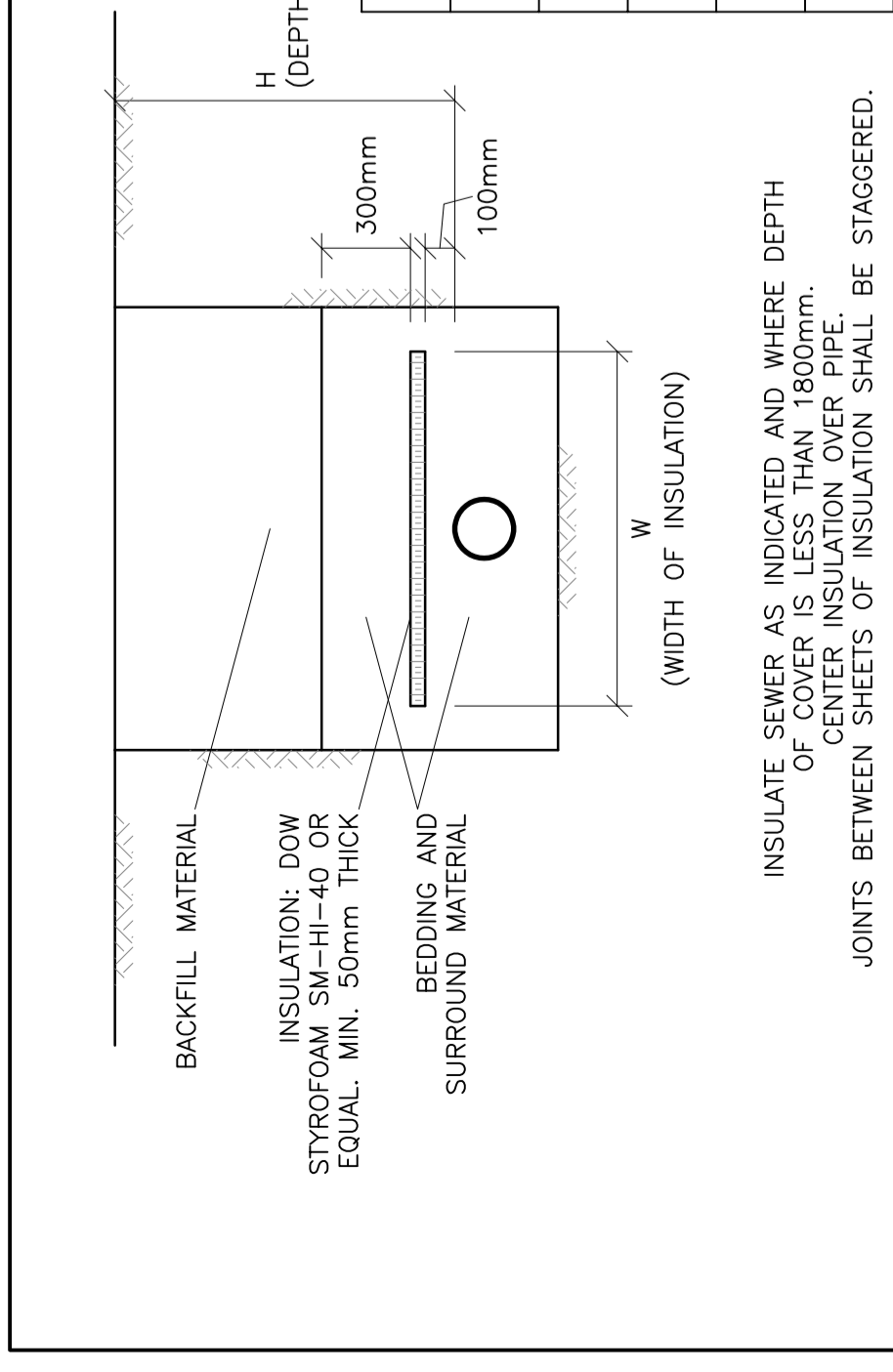

INSULATE SEWER AS INDICATED AND WHERE DEPTH OF COVER IS LESS THAN 2400mm. CENTER INSULATION OVER PIPE. JOINTS BETWEEN SHEETS OF INSULATION SHALL BE STAGGERED.

INSULATION OF SEWERS
IN SHALLOW TRENCHES
N.T.S.

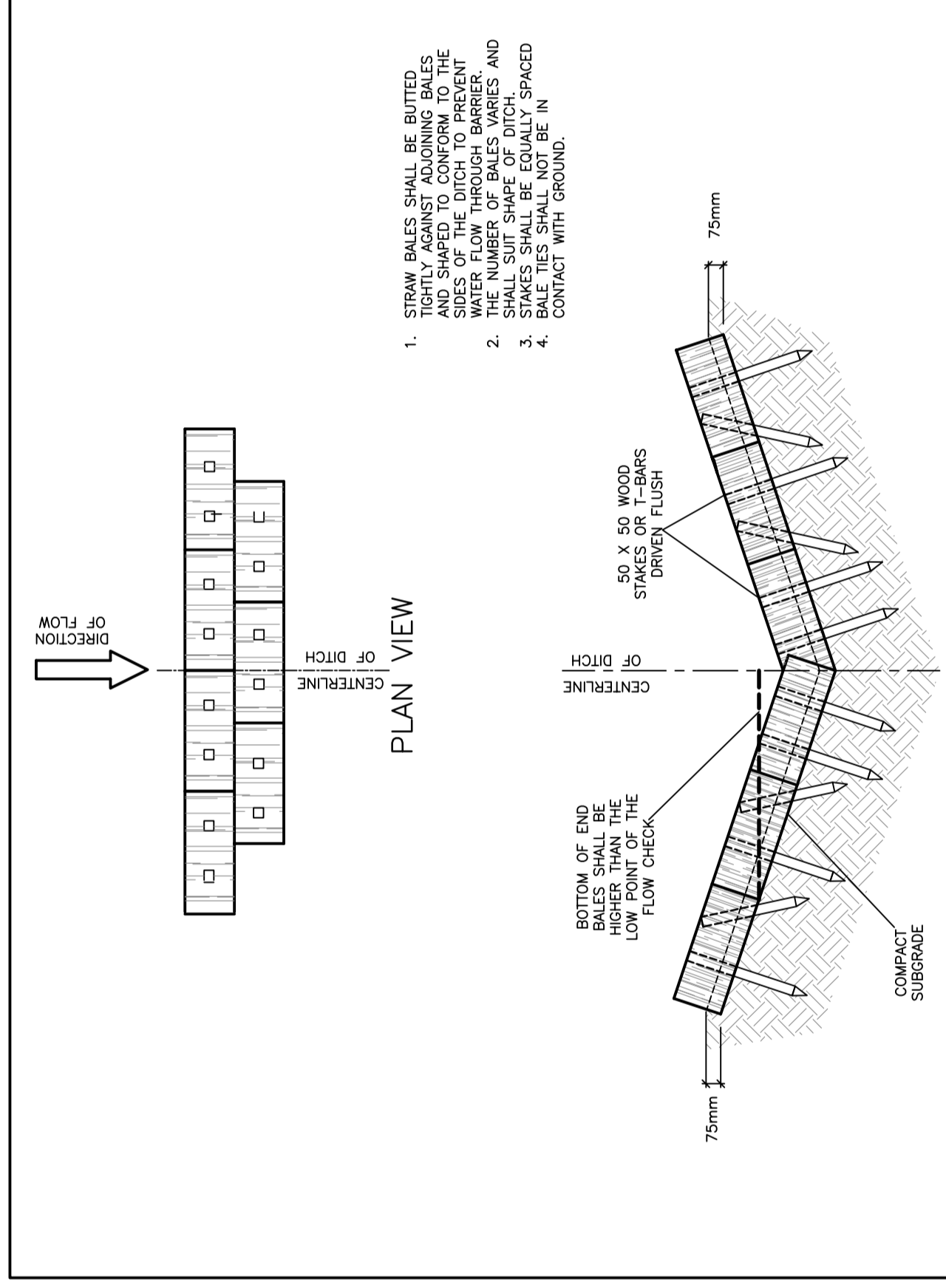

STRAW BALE FLOW
CHECK DAM
AS PER OPSD 219.180
N.T.S.

1. STRAW BALES SHALL BE BITTED TOGETHER TO CONFORM TO THE WATER FLOW THROUGH BARRIER.
2. STAKES SHALL BE EQUALLY SPACED AND CONTACT WITH GROUND.
3. STAKES SHALL BE EQUALLY SPACED AND CONTACT WITH GROUND.
4. CONTACT WITH GROUND.

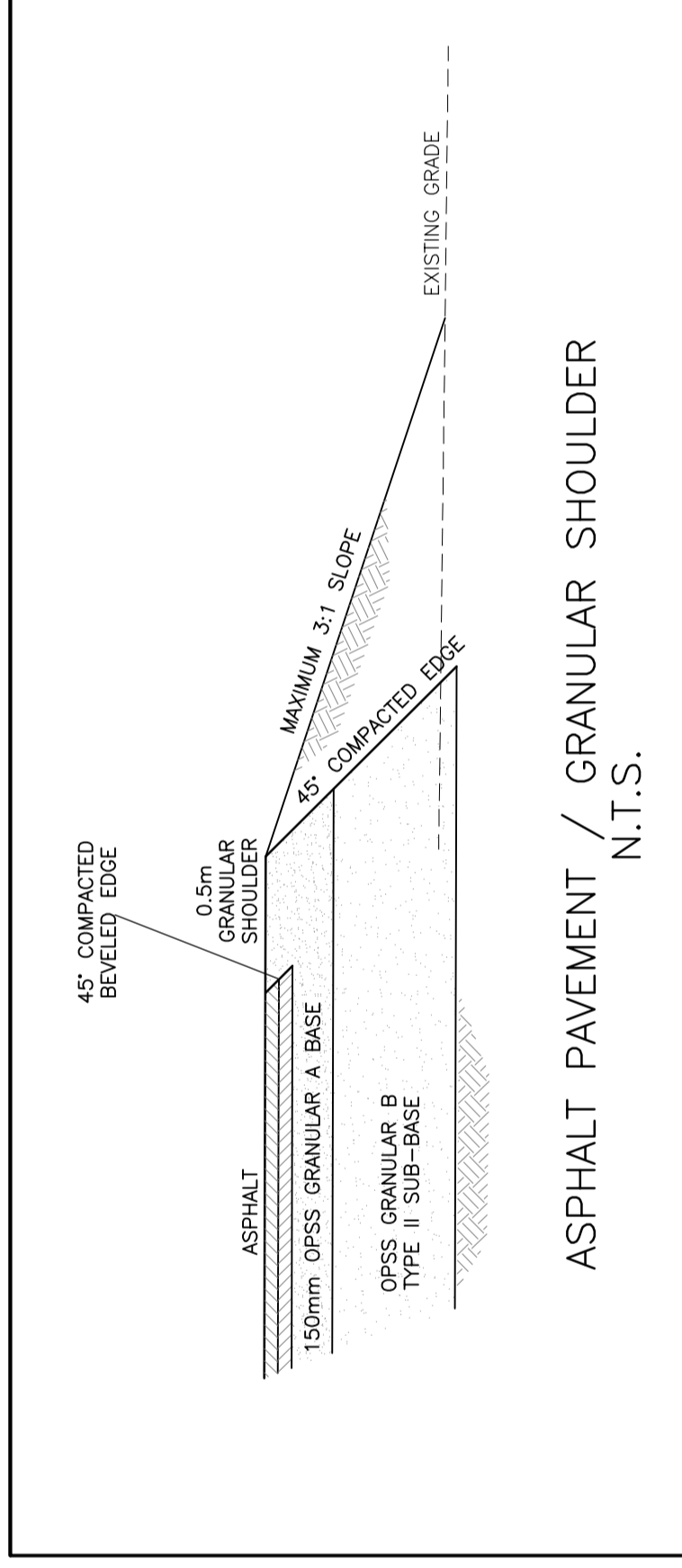

ASPHALT PAVEMENT / GRANULAR SHOULDER
N.T.S.

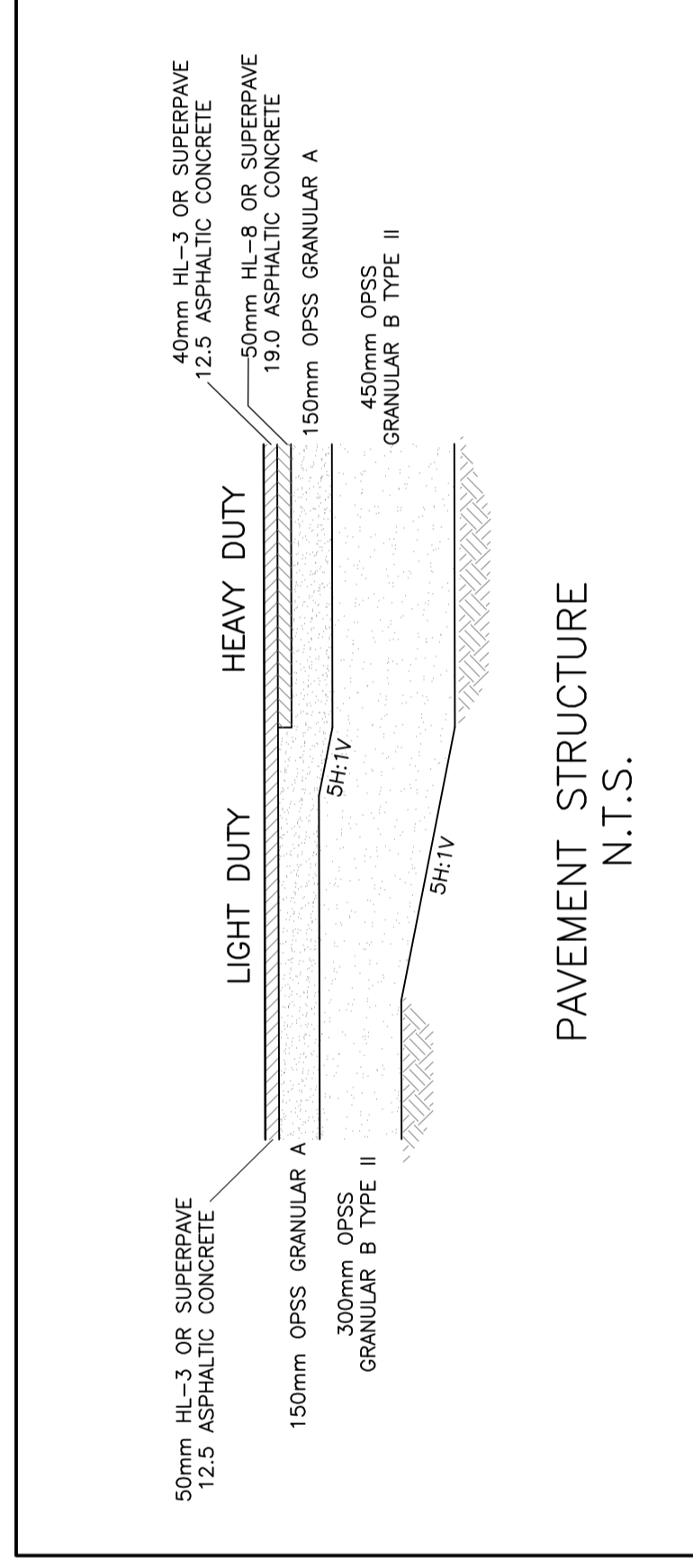

PAVEMENT STRUCTURE
N.T.S.

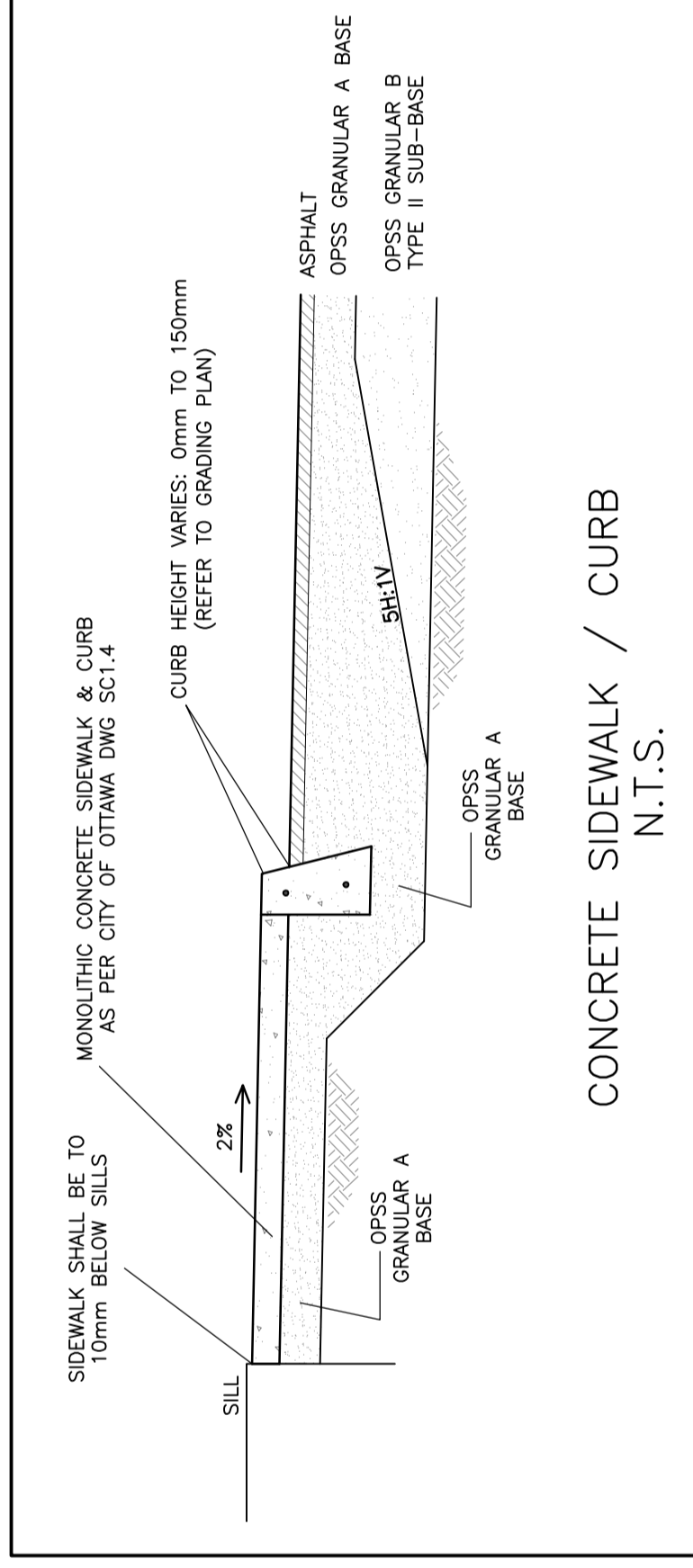

CONCRETE SIDEWALK / CURB
N.T.S.

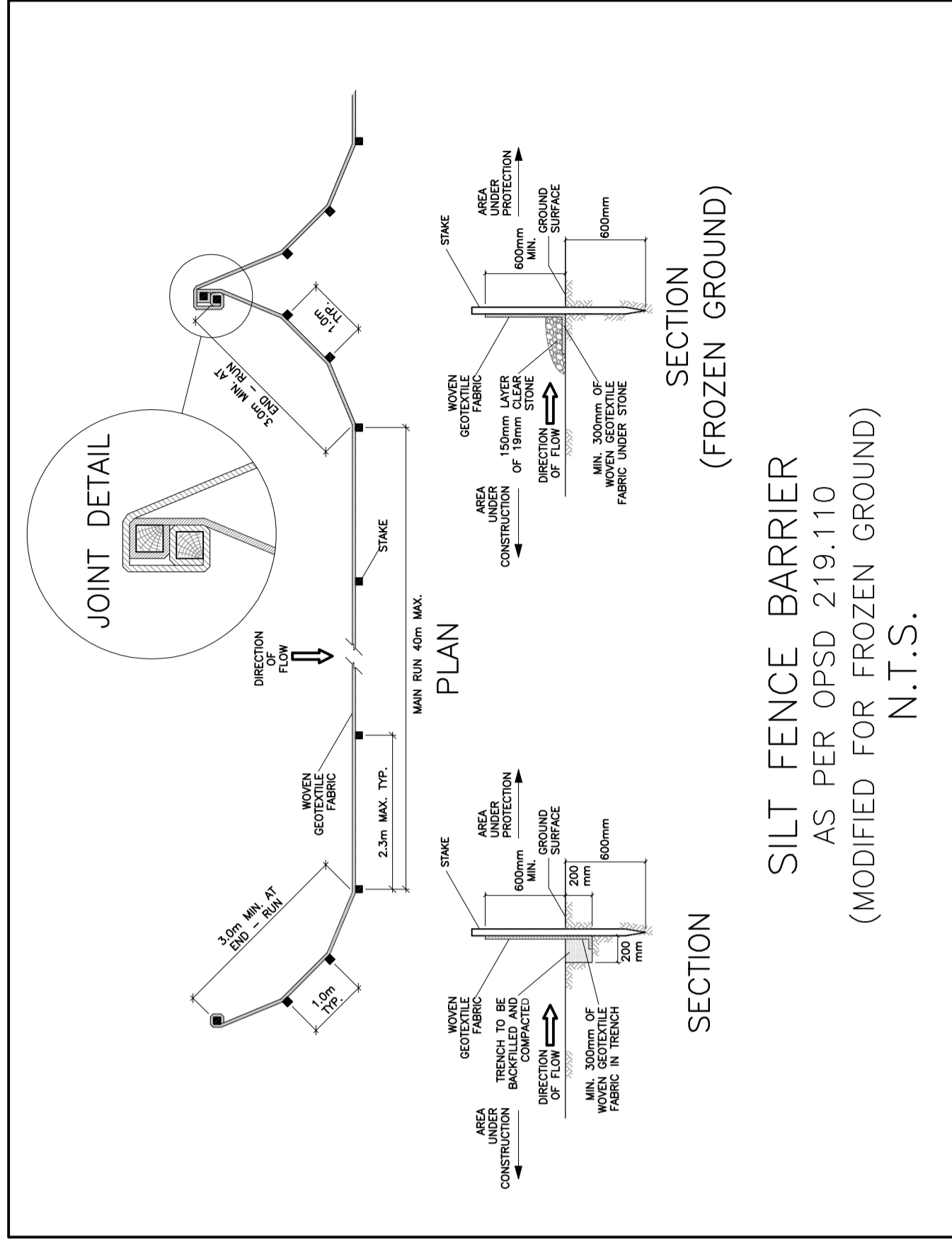

SILT FENCE BARRIER
AS PER OPSD 219.110
(MODIFIED FOR FROZEN GROUND)
N.T.S.

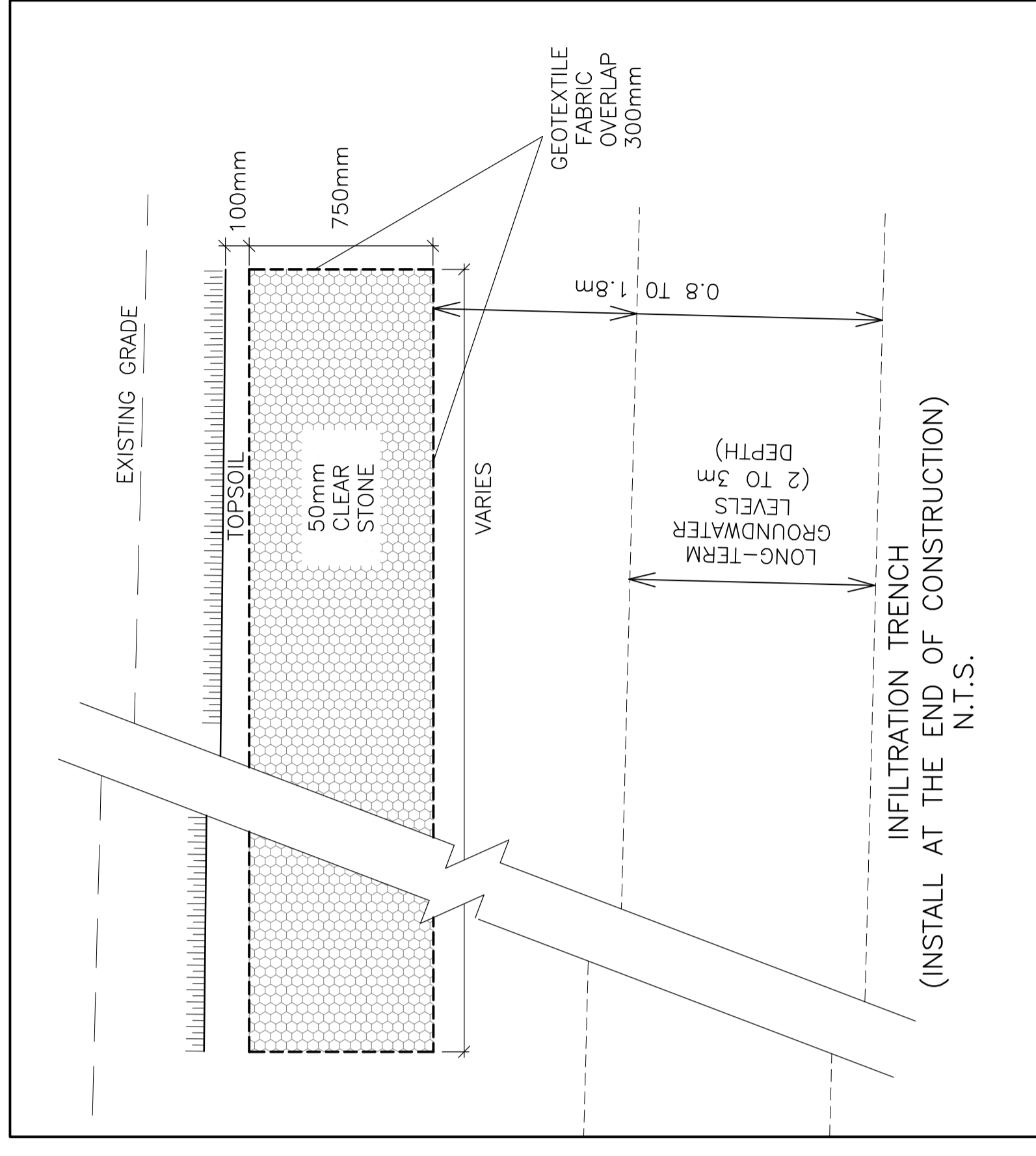

INFILTRATION TRENCH
(INSTALL AT THE END OF CONSTRUCTION)
N.T.S.

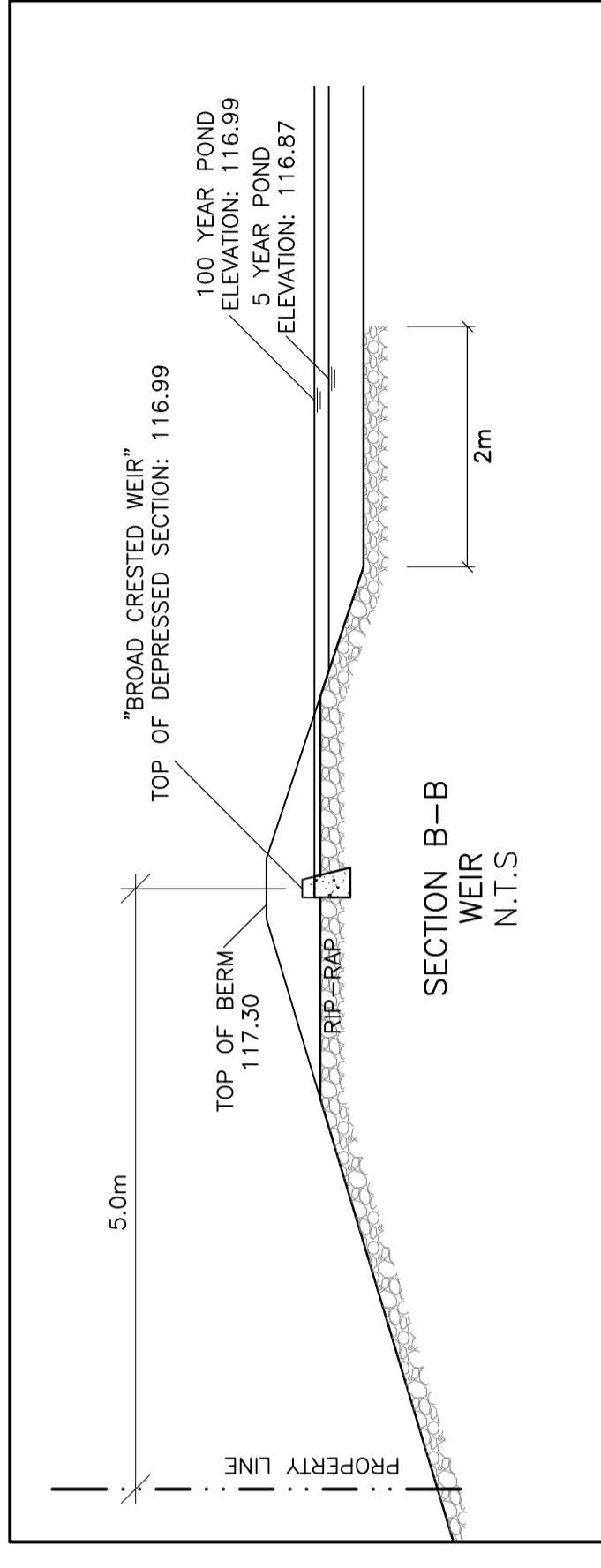

SECTION B-B
WEIR
N.T.S.

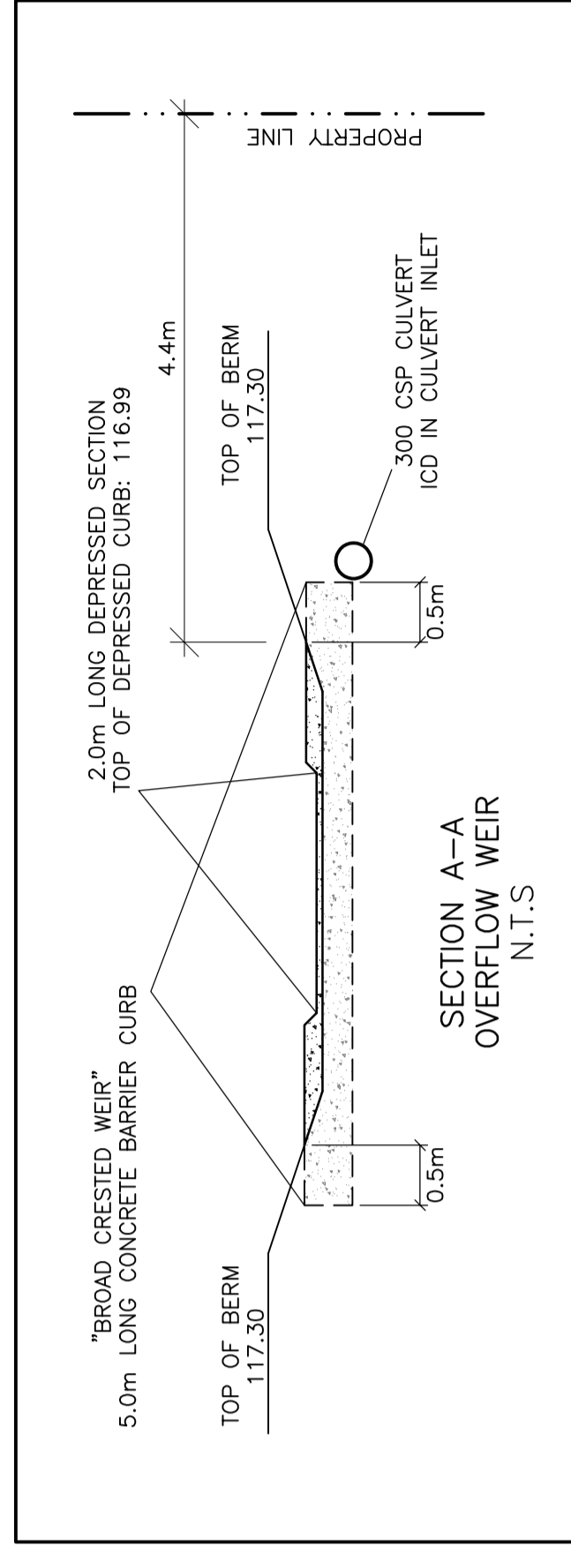

SECTION A-A
OVERFLOW WEIR
N.T.S.



KEY PLAN

No.	DATE	REVISION
1	JAN 27-21	ISSUED FOR REVIEW & COORDINATION
2	MAR 12-21	ISSUED FOR APPROVAL
3	APR 22-21	ISSUED FOR BUILDING PERMIT
4	JUN 14-21	RE-ISSUED FOR APPROVAL
5	JUL 26-21	RE-ISSUED FOR APPROVAL

D. B. GRAY ENGINEERING INC.
 Surveyor Management Consulting & Engineering - Survey & Surveying Services - Estimators
 700 Long Point Circle
 Ottawa, Ontario K1G 0A4
 613-425-8044
 dgray@dbgrayengineering.com

Project
**CLS ROOFING LTD
 OFFICE & WAREHOUSE
 2167 MCGEE SIDE ROAD
 OTTAWA, ONTARIO**

Drawing Title
DETAILS

Drawn	Checked	Scale	Date	Rev. No.
D.B.G.	D.B.G.	1:250	18-20	20088

Engineer's Seal
 Drawing No. **C-4**
 of **6**
#18432