

|  |  |            |
|--|--|------------|
| LOCATION: 2742 MARCH ROAD, DUNROBIN, ON, K0A 1T0 |  |            |
| PROPERTY DESCRIPTION:                            | MARCH CON 4 PT LOT 27 RP;4R22610 PARTS 3 AND 4   |            |
| ZONING REQ'S                                     |  |            |
| ZONE:  | RC - RURAL COMMERCIAL ZONE [706r]H(10)   |            |
| PROPOSED USE:                                    | CAR DEALERSHIP   |            |
| ZONE PROVISIONS:                                 | PERMITTED  | PROVIDED   |
| MINIMUM LOT AREA                                 | 4,000 M²   | 4,021.8 M² |
| MINIMUM LOT WIDTH                                | 4.5 M  | 41.6 M     |
| MAXIMUM LOT COVERAGE                             | 25%  | 1%         |
| MAXIMUM BUILDING HEIGHT                          | 11 M   | 3.25M      |
| MINIMUM SETBACKS:                                |  |            |
| FRONT YARD                                       | 10 M   | 10 M       |
| REAR YARD  | 10 M   | 77.69 M    |
| INTERIOR SIDE YARD (E)                           | 3 M  | 35.6 M     |
| INTERIOR SIDE YARD (W)                           | 3 M  | 3 M        |
| CORNER SIDE YARD                                 | 6 M  | N/A        |
| LANDSCAPING OF YARDS                             | REQUIRED FRONT AND CORNER SIDE YARDS TO BE LANDSCAPED, EXCEPT FOR DRIVEWAYS CROSSING THE FRONT OR CORNER SIDE YARD LEADING TO A PARKING AREA.  |            |
| OUTDOOR STORAGE                                  | OUTDOOR STORAGE PERMITTED IN INTERIOR SIDE & REAR YARD ONLY. OUTDOOR STORAGE NOT PERMITTED EXCEPT FOR THE DISPLAY & SALES OF AUTOMOBILES. OUTDOOR STORAGE MUST BE SCREENED FROM STREETS & ABUTTING RESIDENTIAL USES. |            |
| PARKING<br>(STALL SIZE 5.2M X 2.6M)              | CAR DEALERSHIP<br>2 / 100M² OF GROSS FLOOR AREA OF SALES/SHOWROOM. 2 / SERVICE BAY.<br>1 / 100M² OF OTHER GROSS FLOOR AREA   |            |
|  | REQUIRED   | PROVIDED   |
| PARKING STALLS                                   | 2  | 4          |
| BARRIER FREE STALLS                              | 0  | 0          |
| LOADING SPACES                                   | 0  | 0          |

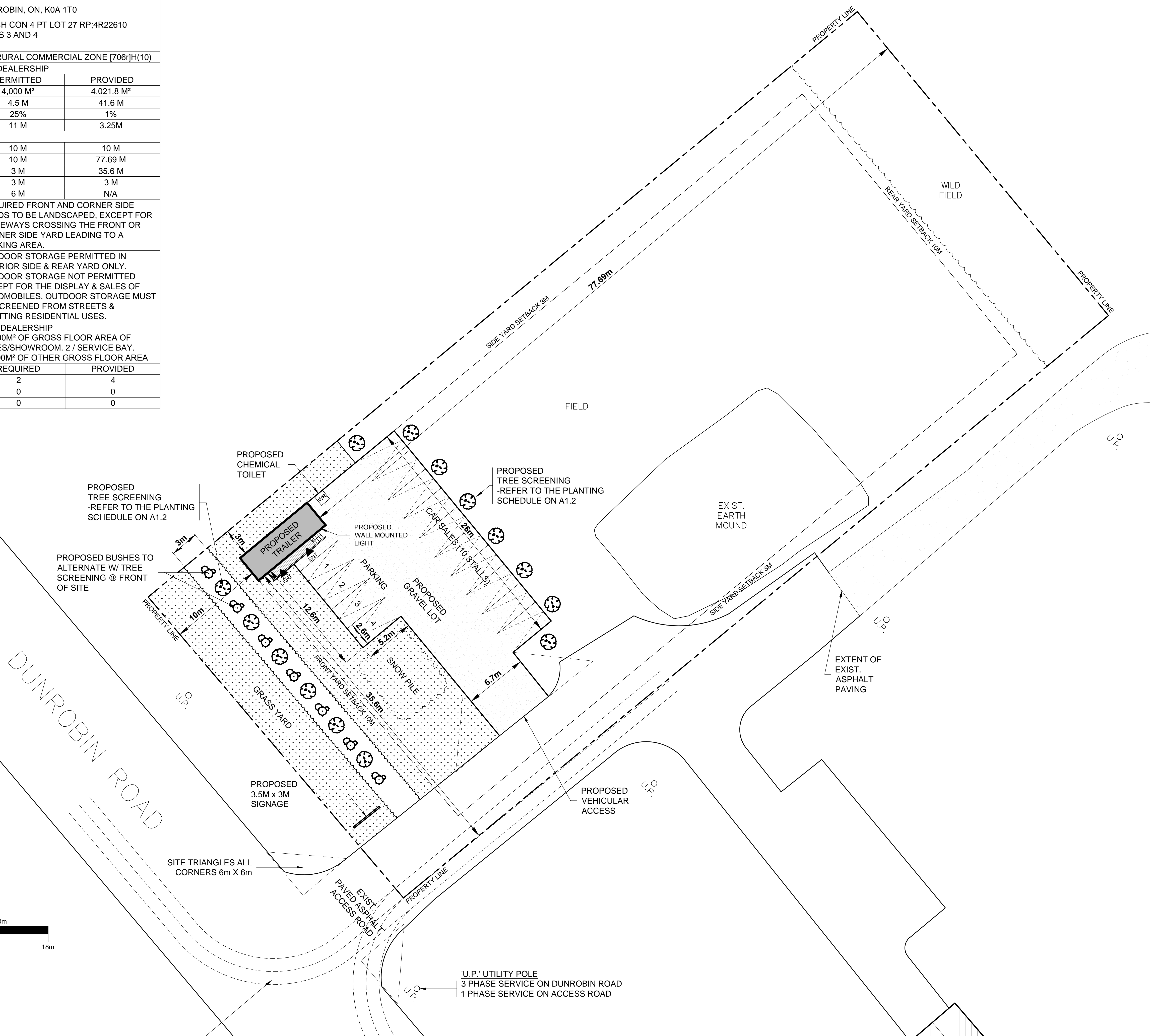

NorthTown Engineering Inc.  
212-430 Hazeldean Road, Kanata, ON. K2L 1T9  
Tel: 613-709-4691 www.northtowneng.com

STAMP/SEAL:-

|     |          |                              |       |         |          |
|-----|----------|------------------------------|-------|---------|----------|
|     |          |                              |       |         |          |
|     |          |                              |       |         |          |
|     |          |                              |       |         |          |
| 1   | 17.06.21 | ISSUED FOR SITE PLAN CONTROL | ME    | AO      | ABRZ     |
| REV | DATE     | DESCRIPTION                  | DRAWN | CHECKED | APPROVED |

OWNER: Mr. Omar Alnader  
Ph. (613) 204-1771

ADDRESS: 2742 Dunrobin Road  
Dunrobin, ON  
K0A 1T0

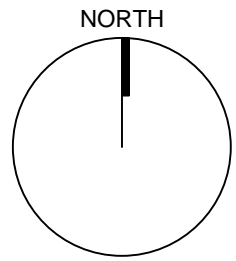

PROJECT NAME & LOCATION

2742 DUNROBIN RD.  
CAR DEALERSHIP

DRAWING TITLE:

SITE & LANDSCAPE PLAN

DRAWING NO:

A1.1

|             |            |       |       |
|-------------|------------|-------|-------|
| DATE        | 23.11.2020 | REV.  | 0     |
| PROJECT NO: | NTE 200119 | SCALE | 1:200 |