

INLET CONTROL DEVICE (ICD) DATA (Circular Orifice Plate)													
STREET NAME	CB ID	OUTLET PIPE			INVERT DEPTH		TOP OF GRATE	INVERT		ICD DIA. (mm)	RELEASE RATE AT MAX. ALLOWABLE PONDING (L/S)	GRATING COVER	CB Type
		DIA. (mm)	TYPE	LENGTH (m)	INLET INV. DEPTH (m)	OUTLET INV. DEPTH (m)		INLET	OUTLET				
PARKING LOT	CB 1A	200	PVC	11.0	1.5	1.05	89.91	88.41	88.86	83	15	S19 PERFORATED	Single OPSD 400.010
PARKING LOT	CB 1B	200	PVC	11.0	1.5	1.05	89.82	88.32	88.77	83	15	S19 PERFORATED	Single OPSD 400.010
PARKING LOT	CB 1C	200	PVC	0.8	-	1.38	89.58	88.20	83	15	S19 PERFORATED	Single OPSD 400.010	
PRIVE KIZIS PRIVATE	CB 2A	200	PVC	7.7	1.5	1.05	89.72	88.22	88.67	83	15	S19 PERFORATED	Single OPSD 400.010
PRIVE KIZIS PRIVATE	CB 2B	200	PVC	0.4	-	1.38	89.18		87.80	83	15	S19 PERFORATED	Single OPSD 400.010

*ICDs TO BE PIAS-TECH STORMWATER TECH ORIFICE PLATE OR APPROVED EQUIVALENT

*CBs TO HAVE 1.0m EXTENDED SUMP BELOW PERFORATED PIPE INVERT. PERFORATED PIPE TO INCLUDE STORMTANK SHIELD OR APPROVED EQUIVALENT GOS5 TRAP. REFER TO DRAWING DS-1 FOR DETAIL.

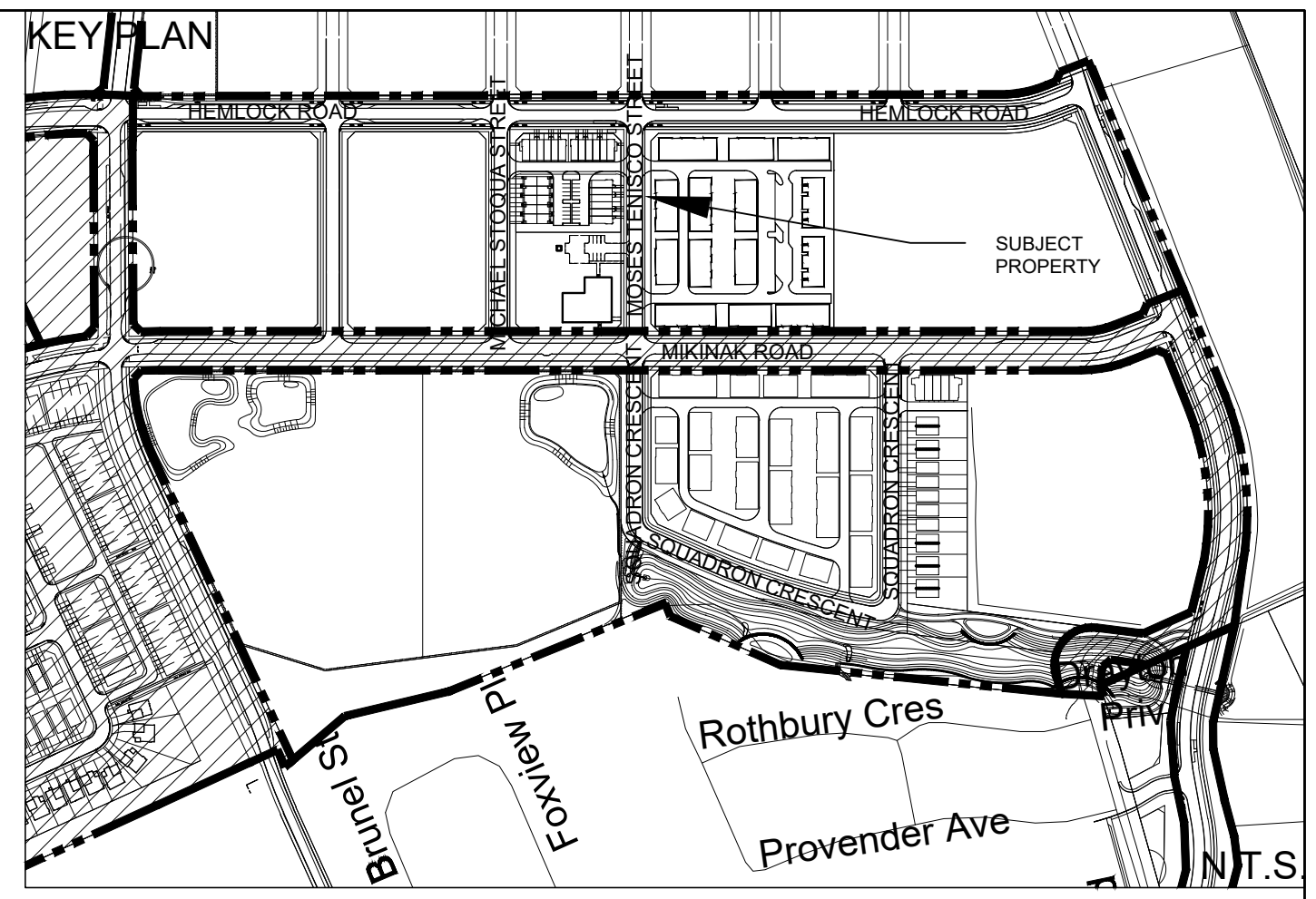

LEGEND

- PROPERTY LINE
- PROPOSED WATERMAIN
- PROPOSED SANITARY SEWER
- PROPOSED STORM
- PROPOSED PERFORATED SUBURBAN
- PROPOSED VALVE BOX
- PROPOSED FIRE HYDRANT
- PROPOSED STORM MANHOLE
- PROPOSED SANITARY MANHOLE
- PROPOSED CATCH BASIN
- PROPOSED CB 'T'/PROPOSED AREA DRAIN (PER CITY STD. S30 & S31)
- CLAY SEAL TO BE INSTALLED AS PER PATERSON GROUP GEOTECHNICAL REPORT (1 - 15mm WTR SERVICE (WATER METER DETAILS ON DWG 07 - DETAILS)
- 1 - 38mm WTR SERVICE (BOTTOM UNIT)
- 1 - 135mm SAN SERVICE (WATER METER DETAILS ON DWG 07 - DETAILS)
- 1 - 135mm SAN SERVICE (TOP UNIT)
- 1 - 135mm SAN SERVICE (WATER METER DETAILS ON DWG 07 - DETAILS)

COMMUNITY MAILBOX

- TWSI (TACTILE WALKING SURFACE INDICATOR) UNDERSIDE OF FOOTING (USF)
- PEDESTRIAN CROSSWALK
- DEPRESSED CURB BARRIER CURB (CITY STD SCL-1)
- SOG SLAB ON GRADE UNIT
- CLAY SEAL (REFER TO GENERAL NOTES No. 2 ON DWG. No.1 AND GEOTECHNICAL CONSULTANT'S SPECIFICATIONS)
- WINDOW WELLS NOTE: MUST BE INDIRECTLY CONNECTED TO FOOTING DRAINS

GEOTECHNICAL RECOMMENDATIONS:
FOR BUILDING FOOTINGS REFER TO GEOTECHNICAL RECOMMENDATIONS PROVIDED BY PATERSON GROUP INC. PROJECT NO. PGS345-MEMO 04 REVISION 3, DATED FEBRUARY 24, 2021

GEOTECHNICAL RECOMMENDATIONS:
FOR CLAY SEAL REFER TO GEOTECHNICAL RECOMMENDATIONS PROVIDED BY PATERSON GROUP INC. PROJECT NO. PGS345-MEMO 03 REVISION 3, DATED FEBRUARY 24, 2021

EXISTING UNDERGROUND SERVICES AND UTILITY LOCATIONS DERIVED FROM THE BEST AVAILABLE DATA, AS-CONSTRUCTED DRAWINGS, UTILITY DRAWINGS AND INFRASTRUCTURE MAPPING PROVIDED BY THE CITY OF OTTAWA.

CONTRACTOR TO CONFIRM ELEVATIONS AND LOCATIONS OF EXISTING UNDERGROUND SERVICES AND UTILITIES WITHIN THE RIGHT OF WAY PRIOR TO INSTALLATION OF SITE SERVICING INFRASTRUCTURE.

THE CONTRACTOR SHALL IMPLEMENT BEST MANAGEMENT PRACTICES, TO PROVIDE FOR PROTECTION OF THE AREA DRAINAGE SYSTEM AND THE RECEIVING WATERCOURSE, DURING CONSTRUCTION ACTIVITIES. THE CONTRACTOR ACKNOWLEDGES THAT THE FAILURE TO IMPLEMENT APPROPRIATE EROSION AND SEDIMENT CONTROL MEASURES MAY BE SUBJECT TO PENALTIES IMPOSED BY ANY APPLICABLE REGULATORY AGENCY.

A NON-NON-WOVEN GEOTEXTILE LINER, SUCH AS TERRAFIX 360R OR EQUIVALENT SHOULD FULLY SURROUND THE CLEAR STONE TO PREVENT MIGRATION OF FINES INTO THE CLEAR STONE.

NOTE:
ALL HOMES ARE REQUIRED TO BE EQUIPPED WITH BACKFLOW PREVENTERS.

NOTE:
PRESSURE REDUCING VALVES ARE REQUIRED FOR ALL BLOCKS. PRESSURE CHECKS ARE TO BE COMPLETED.

EXISTING SERVICES NOTE:
1. CONTRACTOR TO LOCATE EXISTING SERVICES.
2. STORM AND SANITARY SERVICES TO BE CAPPED AT PROPERTY LINE.
3. WATER SERVICES TO BE BLANKED AT MAIN BY CITY FORCES.
4. EXCAVATION, BACKFILLING, AND REINSTATEMENT BY CONTRACTOR.

EXISTING UNDERGROUND AND ABOVE GROUND INFORMATION
FROM WATERIDGE VILLAGE AT ROCKCLIFFE SUBDIVISION DESIGN DRAWINGS PREPARED BY IBI GROUP (CONTRACT NO. 38298)
GENERAL PLAN OF SERVICES
DRAWING NO. 100D, DATED JUNE 15, 2018.
DRAWING NO. 100E, DATED APRIL 16, 2018.
PLAN & PROFILE OF SQUADRON CRESCENT MOSES TENNISCO (STA. 0+400 TO STA. 0+700) DRAWING NO. 135, DATED JUNE 18, 2018.
PLAN & PROFILE OF MICHAEL STOQUA STREET (MIKINAK TO HEMLOCK ROAD) DRAWING NO. 133, DATED JUNE 18, 2018.
GRADING PLAN
DRAWING NO. 210, 211, 212, DATED FEBRUARY 2, 2018.
DRAWING NO. 213, DATED NOVEMBER 13, 2017.
DRAWING NO. 214, DATED AUGUST 2, 2017.
DRAWING NO. 215, DATED DECEMBER 5, 2017.
PONDING PLAN
DRAWING NO. 213, DATED JUNE 16, 2018.

NOTE:
EXACT LOCATION OF EX. SERVICES TO BE CONFIRMED IN THE FIELD. CONTRACTOR TO AVOID CONFLICTS WITH EXISTING SERVICES. CONTRACT TO ENSURE NO BENDS ARE LOCATED WITHIN THE CITY OF OTTAWA ROW

NOTE:
ALL SANITARY SEWER MAINTENANCE HOLES ARE TO BE INSTALLED WITH WATERTIGHT COVERS AS PER OPSD 401.030.

NOTE:
LOT SERVICES ARE TO BE INSTALLED AS PER CITY OF OTTAWA STANDARD S11.3.

NOTE:
ALL STORM AND SANITARY SERVICES ARE REQUIRED TO BE EQUIPPED WITH BACKWATER VALVE

NOTE:
PRESSURE REDUCING VALVES ARE REQUIRED FOR ALL BLOCKS. PRESSURE CHECKS ARE TO BE COMPLETED.

CONTRACTOR TO ENSURE THAT WATERMAIN SERVICES ARE 2.4m BELOW GRADE.

WATER INSPECTOR TO BE CONSULTED
PRIOR TO WATERMAIN CONSTRUCTION
TO DETERMINE BEST PRACTICE FOR ALL WATERMAIN CONNECTIONS TO EXISTING WATERMAIN ON MOSES TENNISCO STREET.

BLOCK 4 WATER SERVICES TO BE 38mm DIA.
FOR THE BOTTOM UNIT AND 25mm DIA. FOR TOP UNIT STUBBED 2.4m BELOW GRADE 1.2m FROM BUILDING FOUNDATION.

BLOCKS 1-3 WATER SERVICES TO BE 19mm DIA.
STUBBED 2.4m BELOW GRADE 1.2m FROM BUILDING FOUNDATION.

SANITARY SERVICES TO BE 135mm DIA. @ 1.0% (MIN) 0.5m BELOW USF
STORM SERVICES TO BE 150mm DIA. @ 1.0% (MIN) 0.5m BELOW USF

IN-SITU INFILTRATION TESTING REQUIRED AFTER FILL FOR BLOCK 22 HAS BEEN PLACED AND COMPACTED AND PRIOR TO THE INSTALLATION OF LOW IMPACT DEVELOPMENT PRACTICE.

14	G.G.G.	21-03-22	ISSUED FOR SITE PLAN AMENDMENT-SUBMISSION 9
14	G.G.G.	21-02-24	ISSUED FOR SITE PLAN AMENDMENT-SUBMISSION 8
13	A.J.T.	20-12-21	ISSUED FOR SITE PLAN AMENDMENT-SUBMISSION 7
12	A.W.T.	20-10-06	ISSUED FOR SITE PLAN AMENDMENT-SUBMISSION 6

No.	BY	DATE	DESCRIPTION
TOPOGRAPHIC INFORMATION			
TOPOGRAPHIC INFORMATION PROVIDED BY IBI GROUP PROJ. NO. 38298 DATED NOVEMBER 13, 2017			
SITE SERVICING AND STORMWATER MANAGEMENT STUDY			
SERVICES AND STORMWATER MANAGEMENT RECOMMENDATIONS PROVIDED BY DSEL PROJ. NO. 17-948 DATED MARCH 2021			
BENCH MARK			
ELEVATIONS ARE GEODETIC, REFERRED TO CITY OF OTTAWA VERTICAL BENCHMARK NO. 396 ELEV= 95.06 METERS			

SITE PLAN INFORMATION	
SITE PLAN PROVIDED BY KORSIAK URBAN PLANNING DATED MARCH 18, 2021	

GEOTECHNICAL STUDY	
GEOTECHNICAL RECOMMENDATIONS PROVIDED BY PATERSON GROUP INC. PROJECT NO. PGS345-1 REVISION 2, DATED FEBRUARY 23, 2021	

MATTAMY HOMES	WATERIDGE - BLOCK 22 PHASE 1B
----------------------	--------------------------------------

david schaeffer engineering ltd

120 Iber Road Unit 103
Stittsville, Ontario, K2S 1E9
Tel. (613) 836-0856
Fax. (613) 836-7183
www.DSEL.ca

S.L. MERRICK
100166523
2021-07-22
PROVINCE OF ONTARIO

110 Laurier Ave W
Ottawa, Ontario, K1P 1J1
Tel. (613) 580-2400
www.Ottawa.ca

© DSEL

SITE SERVICING PLAN			
DRAWN BY:	A.W.T.	CHECKED BY:	S.L.M.
DESIGNED BY:	S.L.M.	CHECKED BY:	A.D.F.
SCALE:	1:250	PROJECT No.	17-948
			SHEET No.
			04

