

LEGEND

- Existing Deciduous Tree to Remain
- Existing Coniferous Tree to Remain
- Proposed Deciduous Tree
- Proposed Coniferous Tree
- Proposed Deciduous Shrub
- Proposed Coniferous Shrub
- Proposed Perennial
- Proposed Bike Rack
- Proposed Barrier-free Signage
- Proposed 1.8m Shadowbox Wood Fence
- Existing 1.8m Board Fence
- Re. L3.0 for planting and furnishing details

Key	Botanical Name	Common Name	Qty	Size	Conditions	Spacing	Remarks
<b>Deciduous Trees</b>							
AM	Amelanchier leavis	Allegheny Serviceberry	4	50mm cal	WB		full crown
AR	Acer rubrum	Red Maple	7	60mm cal	WB		full crown
<b>Coniferous Trees</b>							
PP	Picea glauca	White Spruce	6	200cm	WB		uniform spread
<b>Shrubs</b>							
Ac	Amenlanchier canadensis	Serviceberry	8	125cm 7 gal	Cont.		Clump form min 3 trunks
Co	Cornus alba 'Siberica'	Redbark Dogwood	46	40cm 3gal	Cont.	120cm	min. 5 canes
Ju	Juniperus sabina 'Blue Danube'	Blue Danube Juniper	54	40cm 3 gal	Cont.	100cm	uniform spread
Po	Potentilla fruticosa 'Red Ace'	Red Ace Cinqufoil	20	40cm 3 gal	Cont.	60cm	plant in offset lines / zig zag pattern to fill space
Rh	Rhus aromatica 'Gro-Low'	Fragrant Sumac	51	2gal	Cont.	100cm	plant in offset lines / zig zag pattern to fill space
Sj	Spiraea japonica 'Flaming Mound'	Flaming Mound Spirea	63	40cm 3 gal	Cont.	75cm	plant in offset lines / zig zag pattern to fill space
Ta	Taxus x media 'Wardii'	Ward's Yew	18	40cm 3 gal	Cont.	100cm	plant in offset lines / zig zag pattern to fill space
<b>Perennials / Ornamental Grasses</b>							
ach	Achillea millefolium 'Paprika'	Paprika Yarrow	129	1gal	Cont.	50cm	plant in offset lines / zig zag pattern to fill space
hem	Hemerocallis 'Anzac'	Anzac Daylily	299	1gal	Cont.	50cm	plant in offset lines / zig zag pattern to fill space
pan	Panicum virgatum 'Prairie Fire'	Prairie Fire Switch Grass	102	1gal	Cont.	60cm	plant in offset lines / zig zag pattern to fill space
rud	Rudbeckia 'Hirta'	Black Eyed Susan	252	1gal	Cont.	50cm	plant in offset lines / zig zag pattern to fill space

PLANT NOTES:  
 ALL PLANT MATERIAL SUBJECT TO STANDARD TWO (2) YEAR MAINTENANCE PERIOD COMMENCING UPON ISSUANCE DATE OF THE CERTIFICATE OF SUBSTANTIAL COMPLETION AND ACCEPTANCE OF THE ABOVE GROUND WORKS.  
 QUANTITIES INDICATED ON THE PLAN TO GOVERN.  
 DO NOT PLANT IN SWALE CENTRES.

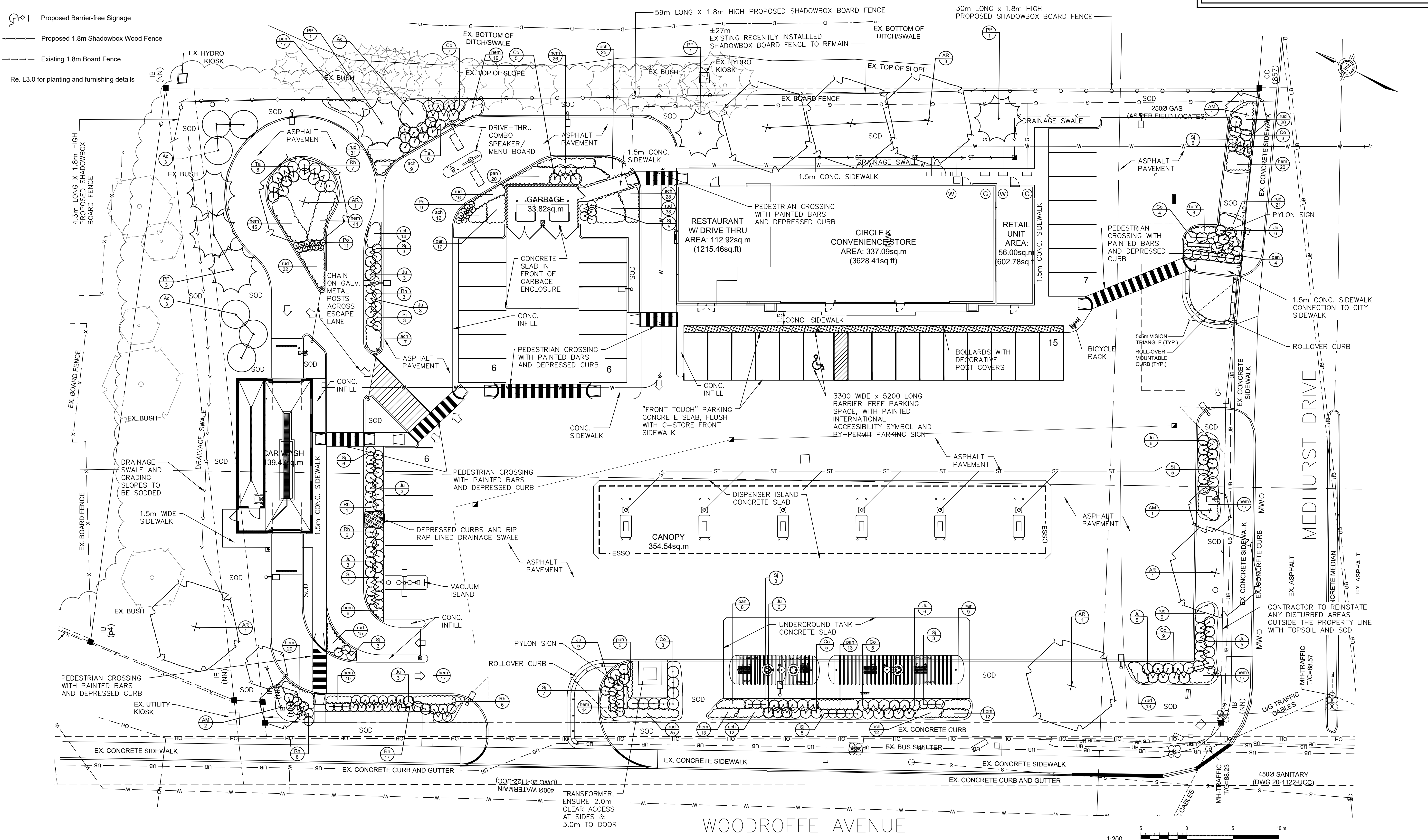
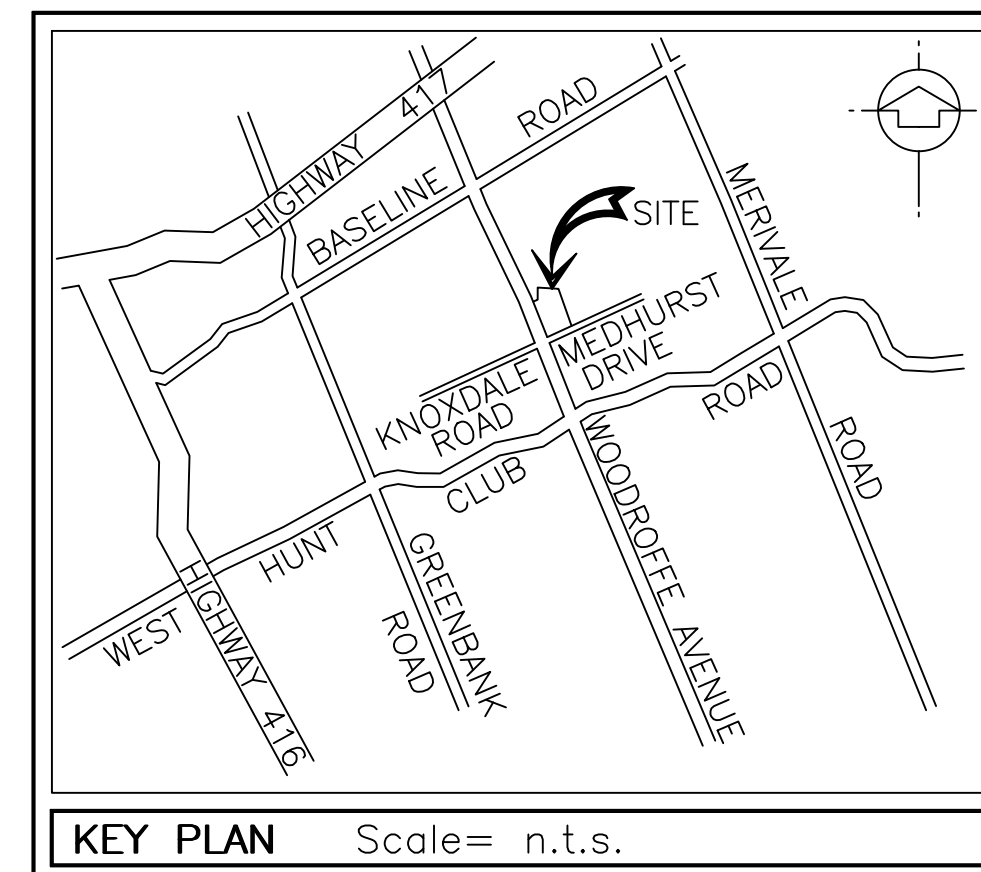

Unless otherwise agreed in a written contract between Wood and its client, this document: (i) contains information, data and design that is confidential and may not be copied or disclosed; and (ii) may be used by the client only in the context and for the express purpose for which it was intended. Any use of, or reliance on, this document by any third party is that party's sole risk.

**COPYRIGHT NOTICE**  
 This drawing is the property of the above referenced Professional and is not to be used for any purpose other than the specific project and site named herein, and cannot be reproduced in any manner without the express written permission from the Professional.

04/21/21 FOR CLIENT REVIEW  
 04/27/21 ISSUED FOR SPA



**ska**  
 Stempski Kelly Associates Inc.  
 Design | Landscape Architecture | Planning  
 P.O. Box 399, Fergus, ON, N1M 3E2  
 Voice: (519) 787-4311  
 stasio@ska-design.ca www.ska-design.ca

**PROFESSIONAL IN CHARGE**  
 S. STEMPSKI  
**PROJECT MANAGER**  
 S. LAWRENCE  
**QUALITY CONTROL**  
 F. RIVARD  
**DRAWN BY**  
 J. YI

**PROJECT NAME**  
**CIRCLE K STORES INC.**  
**R&R No. 52287**  
**NEPEAN ONTARIO**  
 1545 WOODROFFE AVENUE  
 NEPEAN, ON, CANADA  
 K2G 1W2



**CIRCLE K STORES INC.**  
**PROJECT NUMBER**  
 BE20207036  
**SHEET TITLE**  
**LANDSCAPE PROPOSED PLANTING AND LANDSCAPING PLAN**  
**SHEET NUMBER**  
**L2.0**

Drawing Name: L3.0 - Woodroffe Ave - Circle K Stores Inc. - Design/Planting/Construction/Utilities/Structural/Landscape/Signage/Utility/Other: No. 27, 2021 - 4/27/21 - 4/27/21 - 4/27/21 - 4/27/21