

- LEGEND:**
- IRON BAR
 - BM BENCHMARK
 - HYD EX. FIRE HYDRANT
 - EX. LIGHT POLE
 - EX. LIGHT STANDARD
 - EX. STORM MH
 - EX. SANITARY MH
 - EX. WATER VALVE
 - EX. STORM CB
 - EX. VALVE CHAMBER
 - EX. BELL & HYDRO POLE
 - EX. GUY WIRE AND ANCHOR
 - EX. TRAFFIC SIGNAL
 - EX. GAS VALVE
 - EX. SIGN
 - EX. TREE
 - SUBJECT PROPERTY
 - PROPERTY LINE
 - EX. CONC. CURB
 - EX. CENTERLINE OF DITCH
 - EX. ROAD CENTERLINE
 - EX. FENCE
 - EX. CONTOUR
 - NEW YARD LIGHT
 - NEW STORM MH
 - NEW SANITARY MH
 - NEW STORM CB
 - NEW STORM CBMH
 - NEW CONC. CURB
 - NEW CURB CUT/DEPRESSED CURB
 - EX. ELEVATION
 - EX. ELEVATION TO REMAIN
 - NEW ELEVATION
 - NEW SLOPE
 - MAX 3:1 SLOPING
 - OVERLAND FLOW

No.	REVISIONS	Date	By	App.
B	ISSUED FOR SPA	APR 27 2021	LMB	J.S.
A	ISSUED FOR COORDINATION	APR 21 2021	LMB	J.S.

LICENSED PROFESSIONAL ENGINEER
 J.D. STERN
 100232894
 April 27, 2021
 PROVINCE OF ONTARIO

exp Services Inc.
 +1 905.793.0800 | +1 905.793.0641
 1595 Clark Boulevard
 Brampton, ON L6T 4V1
 Canada
 www.exp.com

exp.

- BUILDINGS • EARTH & ENVIRONMENT • ENERGY •
- INDUSTRIAL • INFRASTRUCTURE • SUSTAINABILITY •

Owner/Client:

Location:
 1545 WOODROFFE AVE.
 OTTAWA, ON

Title:
GRADING PLAN

Designed By: LMB Drawn By: LMB Checked By: J.S.
 Scale: 1:250 Date: APRIL 2020 City Drawing No.:
 Project No.: BRM00606364-B0 Drawing No.: **C01**

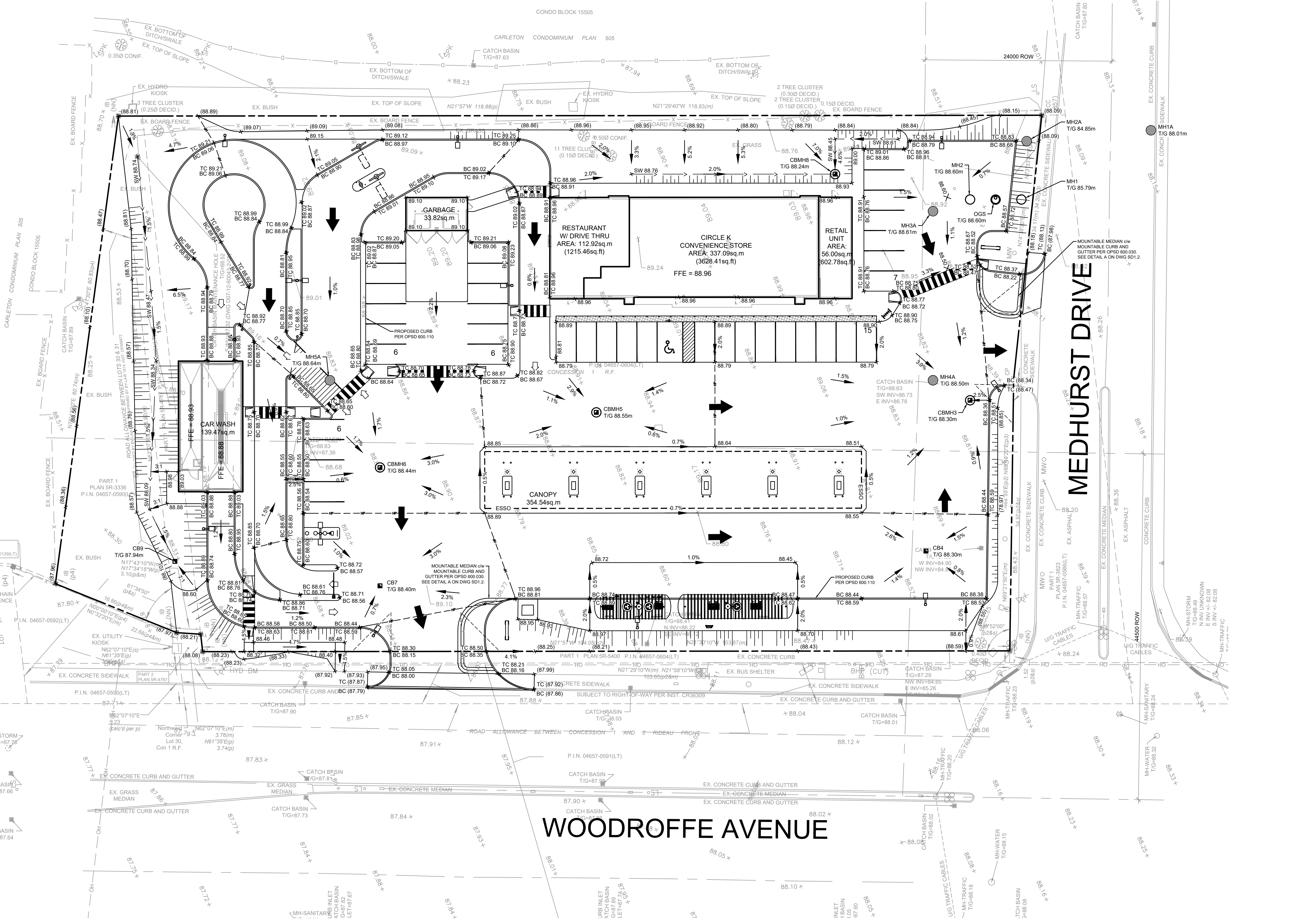

WOODROFFE AVENUE

MEDHURST DRIVE

