

**PLANTING NOTES**

- THE DETAILS ON THIS SHEET DO NOT REPRESENT ANY PARTICULAR SPECIES.
- TREES AND SHRUBS AS INDICATED IN THE DETAILS REPRESENT BOTH CONIFEROUS AND DECIDUOUS SPECIES.
- MATERIAL PLANTED IN GROUP SHALL BE SET IN CONTINUOUS PLANTING BEDS. MULCH SHALL COVER THE ENTIRE PLANTING BEDS.
- CENTRE LINE OF SHRUBS SHALL NOT BE CLOSER THAN 2.4m FROM BUILDING FACE TO PROTECT BUILDING FOOTINGS AND INSULATION.
- PRUNING - TO SUIT SPECIES - PRUNE BRANCHES BY 1/3 TO REMOVE DAMAGED OR OBJECTIONABLE BRANCHES FOLLOWING PROPER HORTICULTURAL PRACTICE. DO NOT PRUNE LEADERS.
- FIRMLY COMPACT BACKFILLED PLANTING MIXTURE TO ELIMINATE AIR POCKETS OR PREVENT SETTLEMENT.
- PLANTING MATERIAL QUALITY STANDARDS:
  - ALL PLANT MATERIALS TO CONFORM TO THE CANADIAN NURSERY LANDSCAPE ASSOCIATION FOR VARIETY, SIZE AND CONDITION.
  - PLANT MATERIAL COLLECTED FROM WILD SOURCES WILL NOT BE ACCEPTED.
  - LANDSCAPE ARCHITECT RESERVES THE RIGHT TO REFUSE ACCEPTANCE OF ANY PLANT DISPLAYING POOR GROWTH HABITS, INJURY OR DISEASE.
  - ANY PLANTS THAT DO NOT CONFORM TO THE ABOVE STANDARDS WILL BE PROMPTLY REMOVED FROM THE SITE BY THE CONTRACTOR AND REPLACED WITH MATERIAL OF ACCEPTABLE QUALITY AT NO ADDITIONAL COST TO THE PROJECT.
- PLANTING SOIL:
  - SOIL TEXTURE BASED ON THE CANADIAN SYSTEM OF SOIL CLASSIFICATION TO CONSIST OF:
    - CLAY: 14-20%
    - SILT: 0-35%
    - SAND: 45-70%
    - ORGANIC MATERIAL: 4-10%
    - pH: 6-8
  - SPREAD TOPSOIL TO FOLLOWING MINIMUM DEPTHS AFTER SETTLEMENTS UNLESS OTHERWISE NOTED ON DETAILS:
    - 300mm FOR PERENNIALS
    - 500mm FOR SHRUB BEDS
    - 1000mm FOR TREE PLANTING
- MULCH:
  - MULCH SHALL BE SHREDDED WOOD VARYING IN SIZE FROM 25-125mm IN LENGTH FROM CONIFEROUS TREES.
- TREES PLANTED IN BESSERER PARK TO BE INSTALLED AS PER CITY OF OTTAWA SPECIAL PROVISIONS F-8047 AND F-8024 INCLUDING A TWO YEAR WARRANTY AND WATERING SCHEDULE.

**PAVING NOTES - NON PERMEABLE**

- BEDDING SAND SHALL BE MANUFACTURED SAND FOR BEDDING. IT SHALL BE HARD, DURABLE, CRUSHED STONE PARTICLES, CONFORMING TO GRADATION OF CONCRETE SAND AS SPECIFIED IN CSA-A23.1 DO NOT USE LIMESTONE SCREENING, STONE DUST OR JOINT SAND FOR BEDDING SAND.
- JOINT SAND SHALL BE HARD, DURABLE ANGULAR PARTICLES, FREE FROM CLAY LUMPS, CEMENTATION, ORGANIC MATERIAL, FROZEN MATERIAL AND OTHER DELETERIOUS MATERIALS. JOINT SAND SHALL FILL SPACES BETWEEN PAVERS.
- PASS MECHANICAL PLATE VIBRATOR OVER UNIT PAVING TO ACHIEVE COMPACTION OF SAND IN JOINTS. ENSURE JOINTS ARE FULL AT COMPLETION OF COMPACTION.
- SURFACE OF FINISHED PAVEMENT SHALL BE FREE FROM DEPRESSIONS EXCEEDING 3mm AS MEASURED WITH 3m STRAIGHT EDGE.
- ALL MEASUREMENTS ARE IN MILLIMETERS UNLESS STATED OTHERWISE.

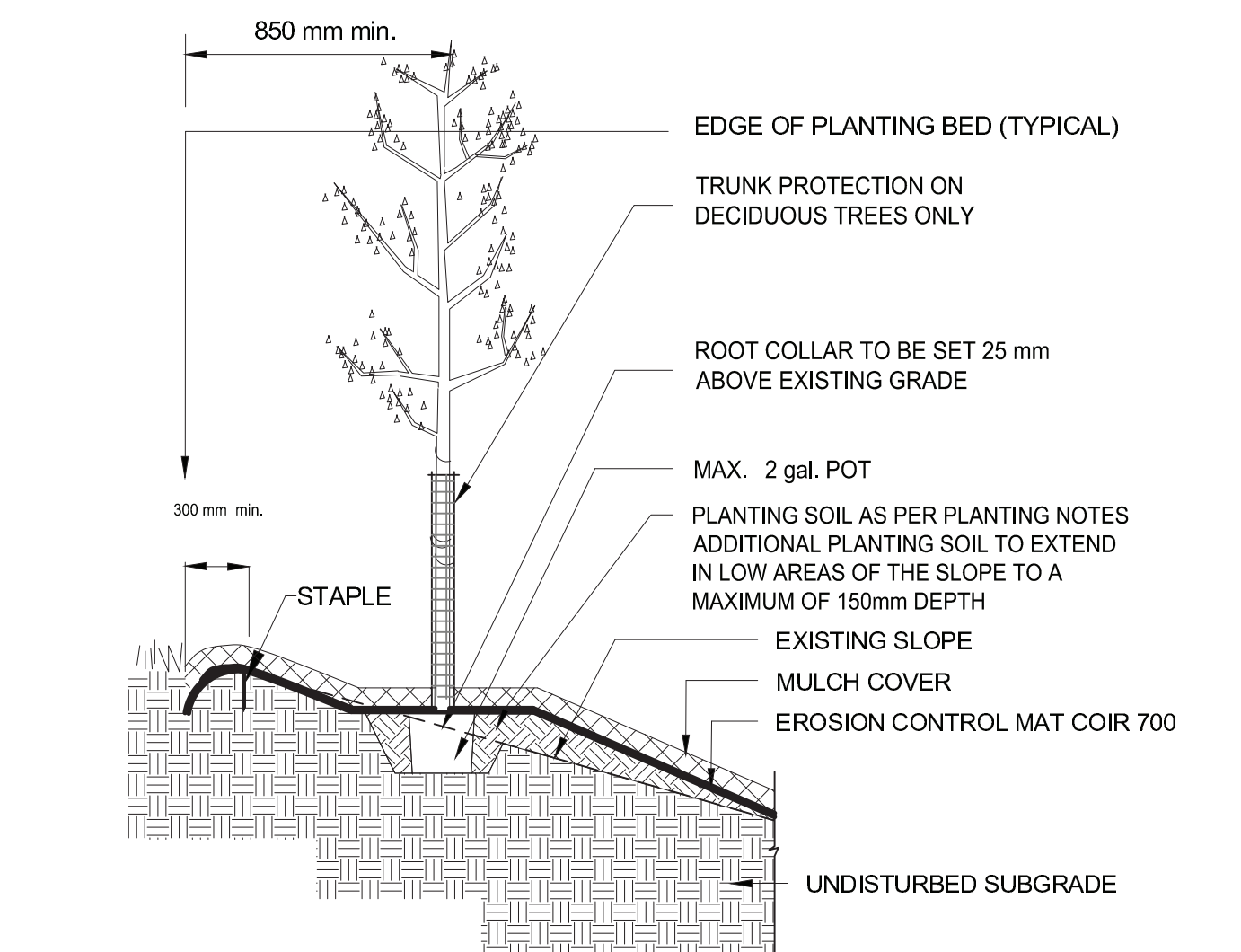
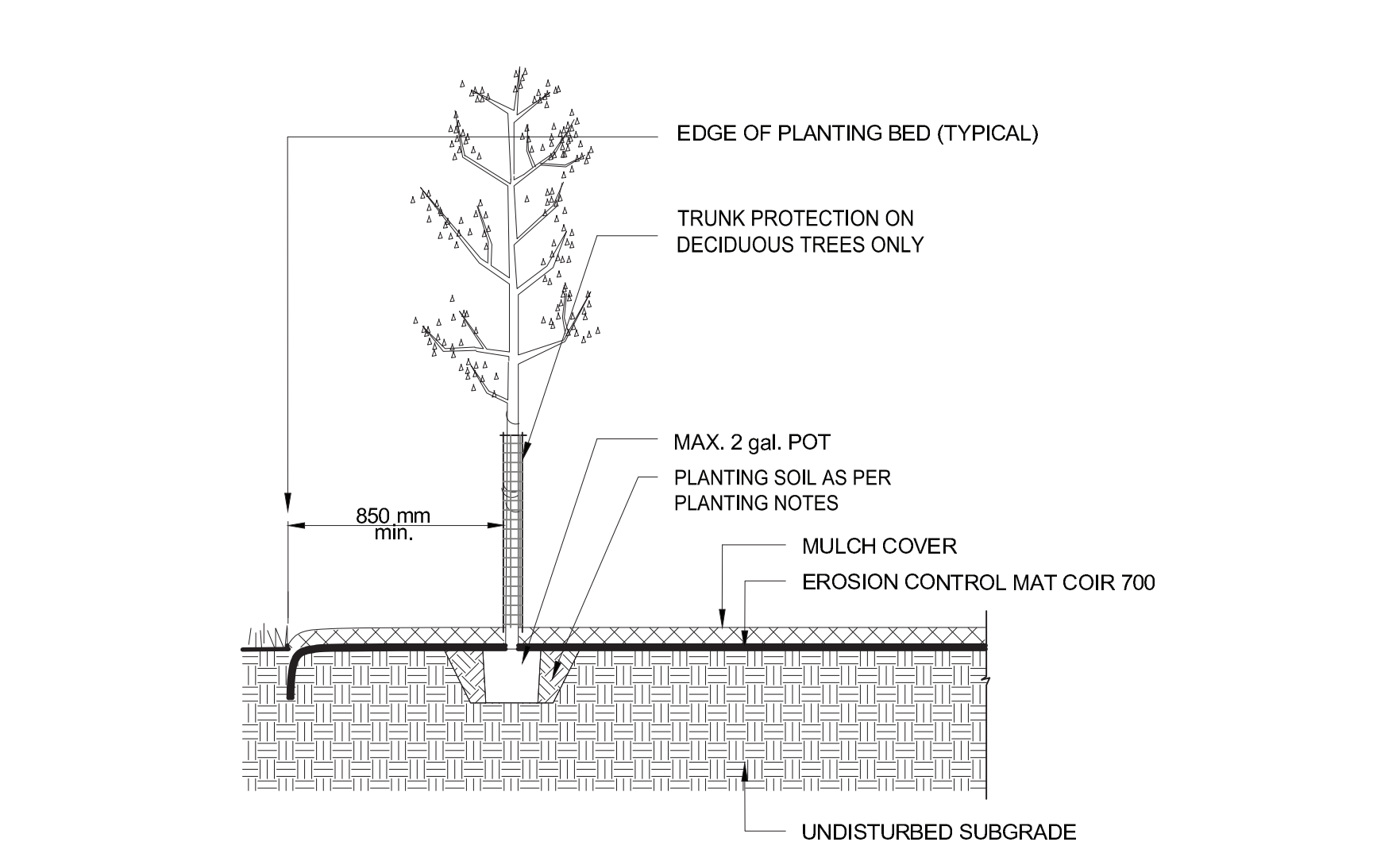
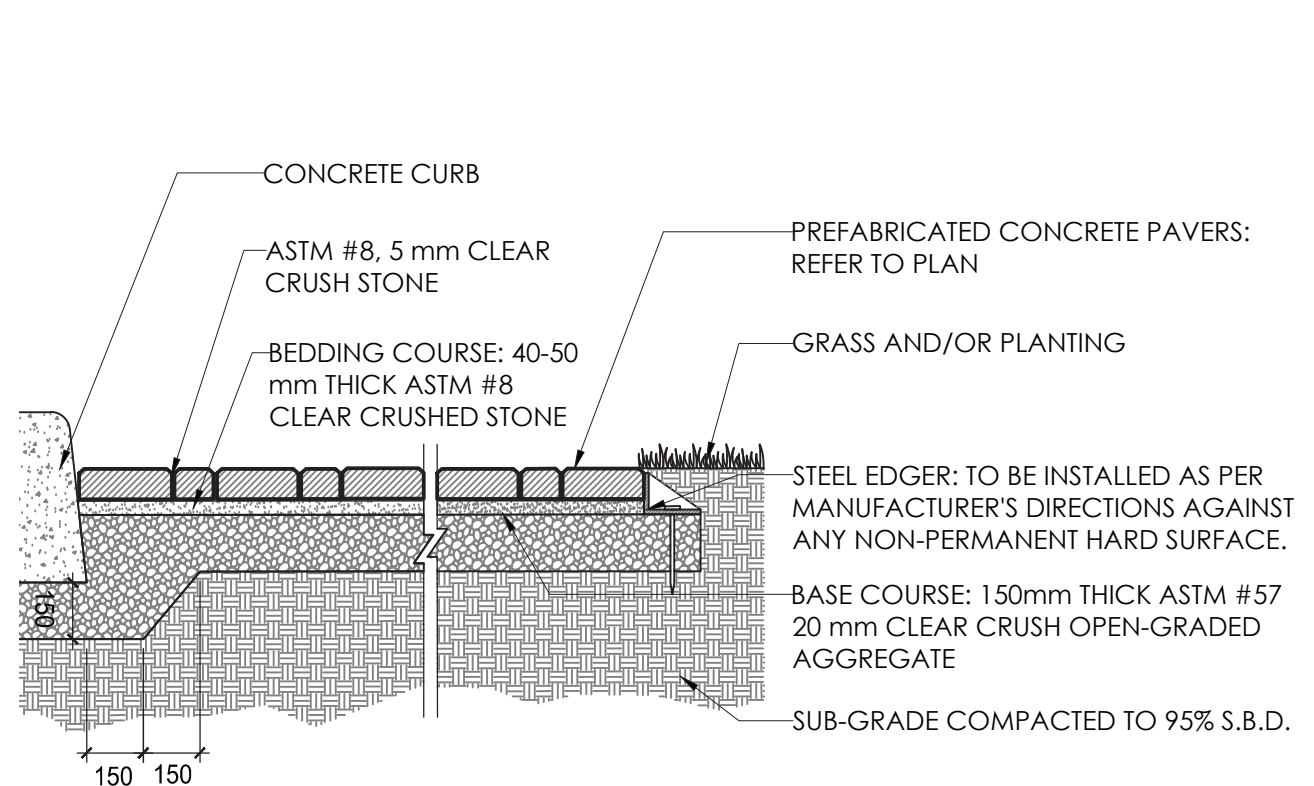
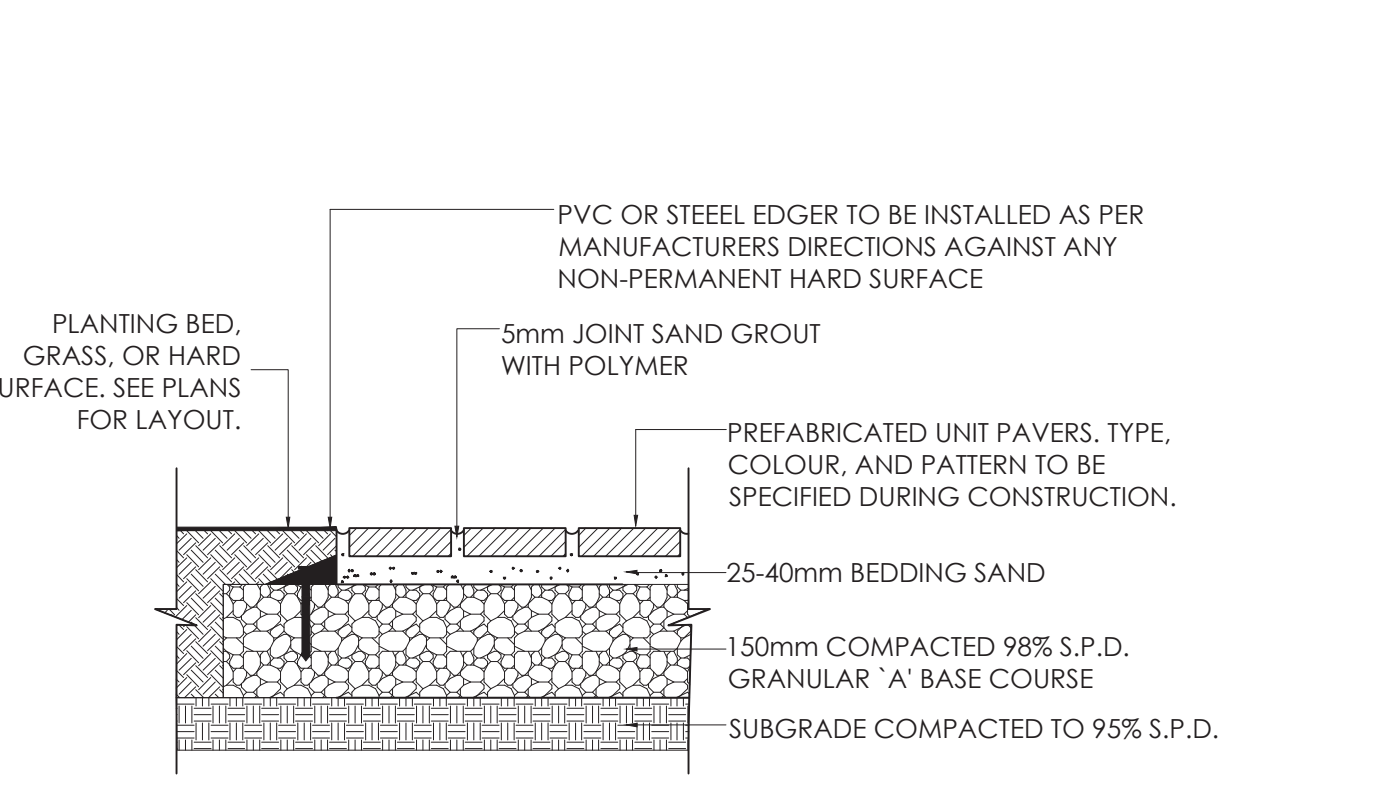
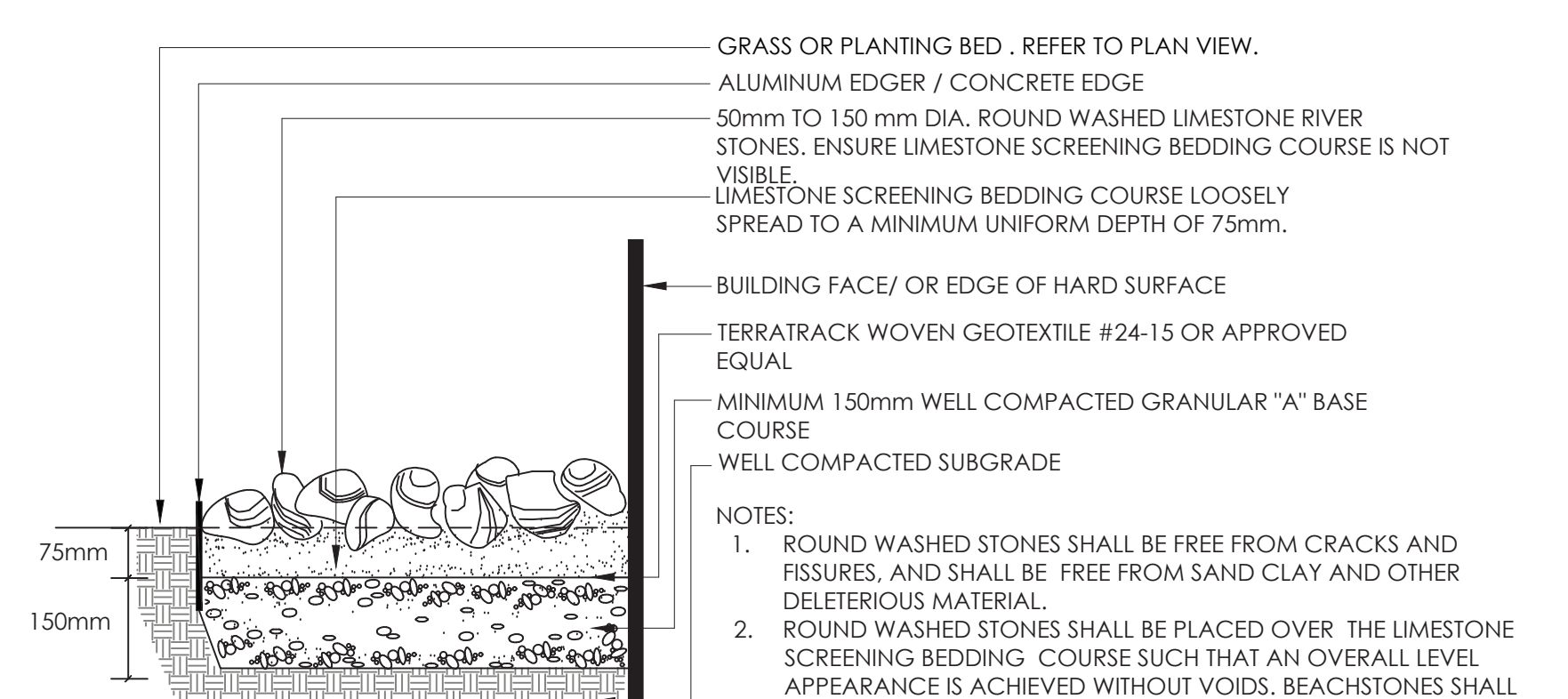
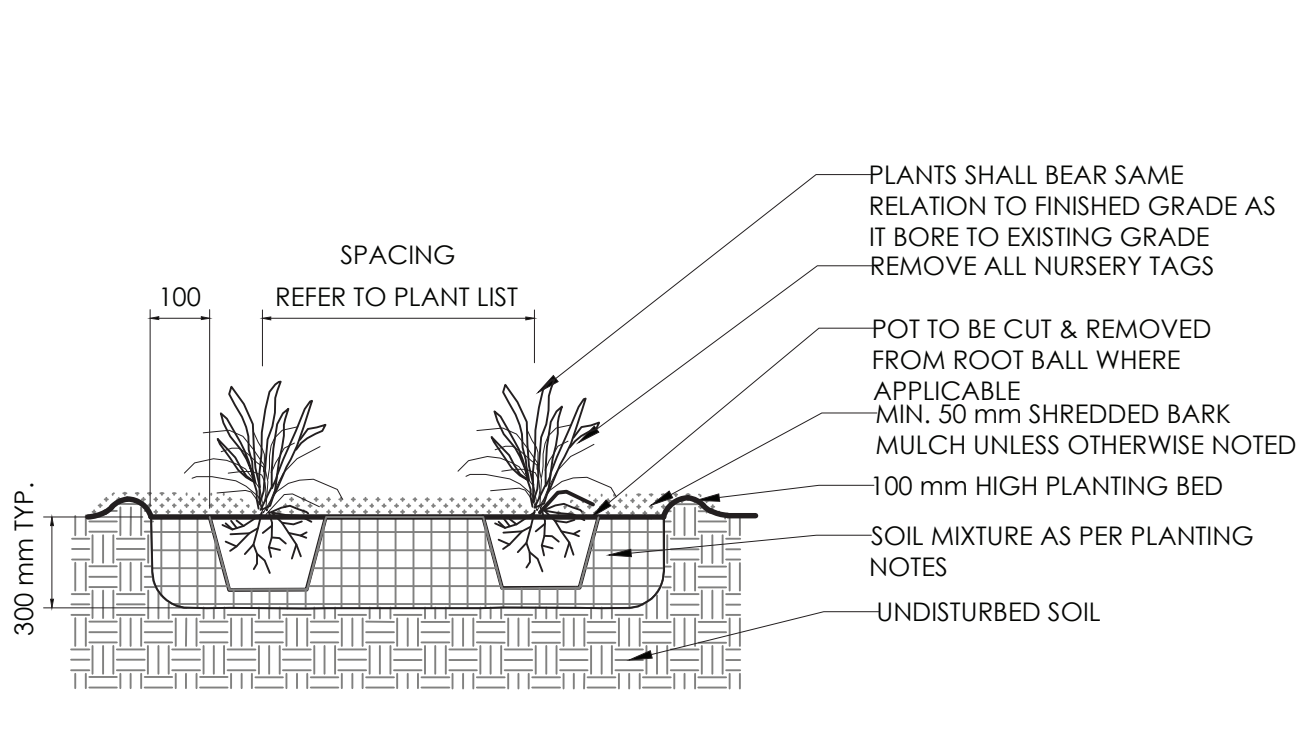
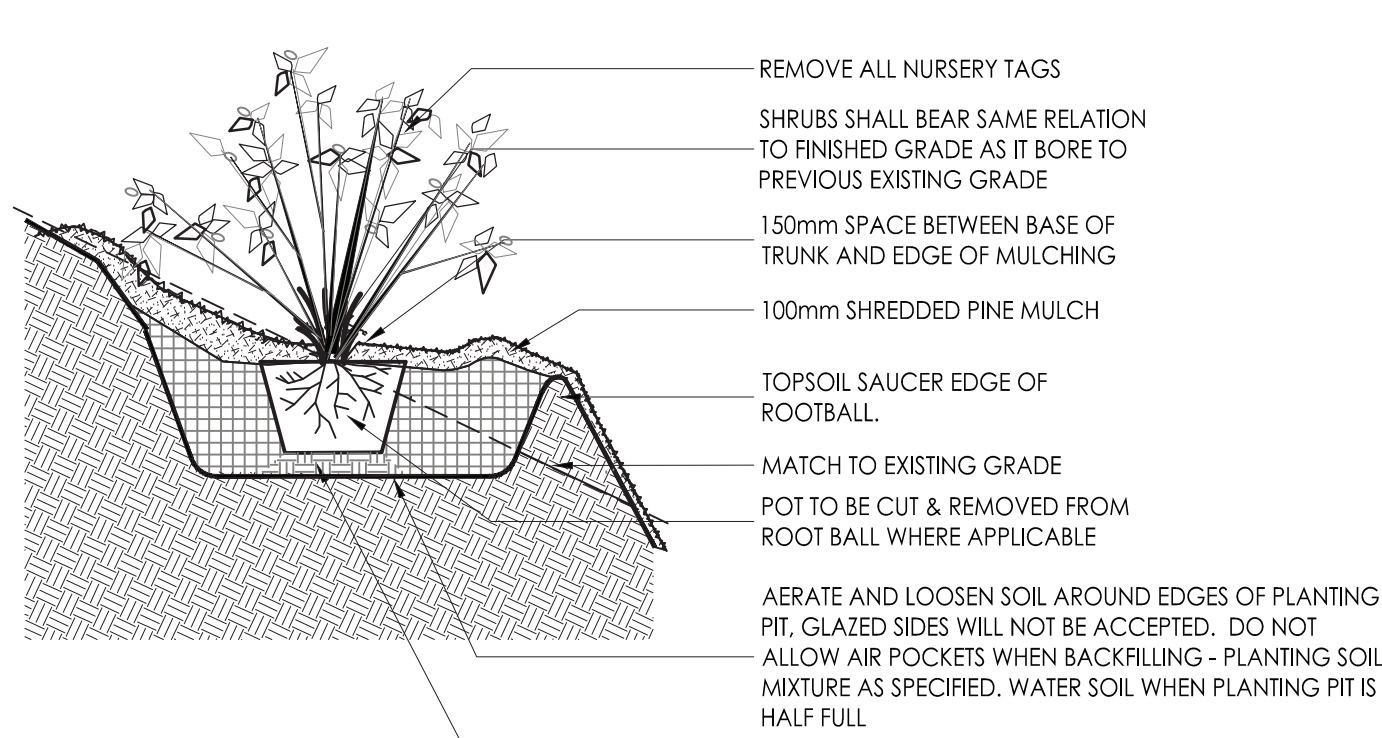
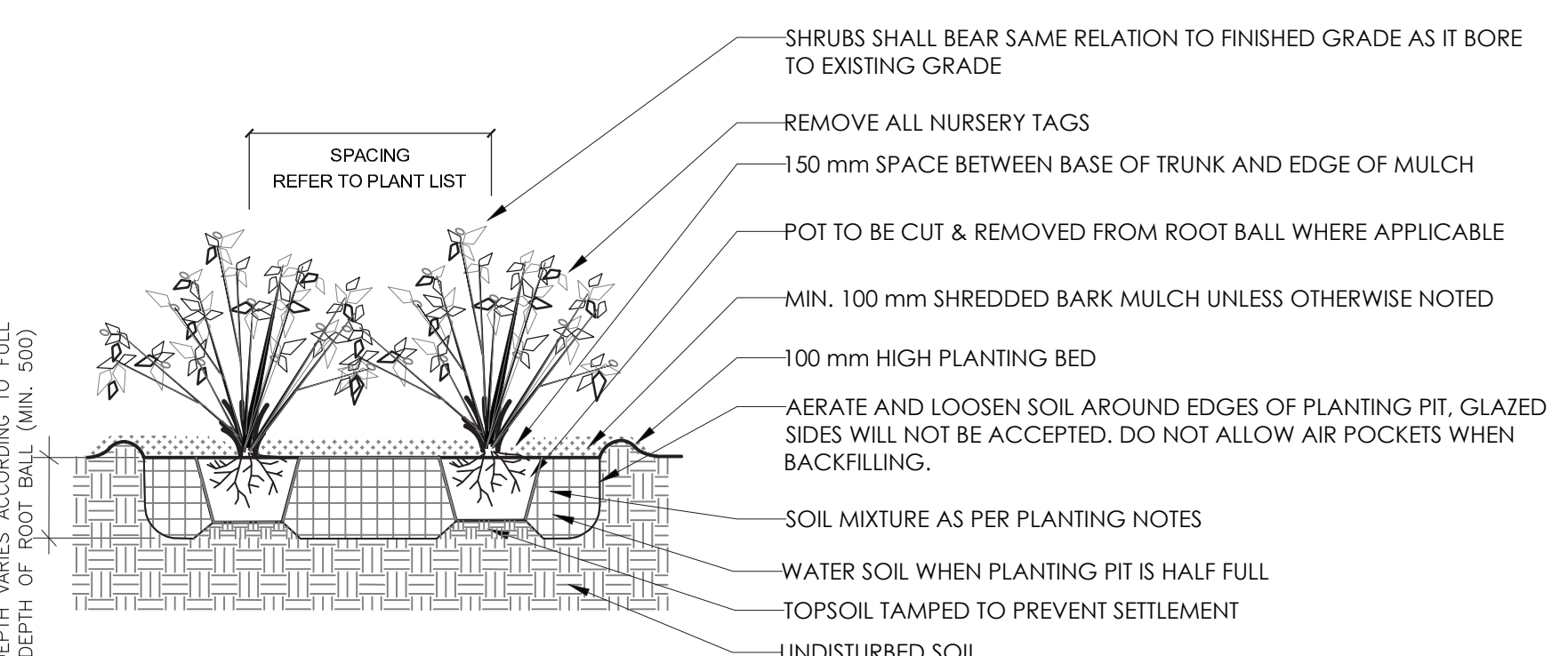
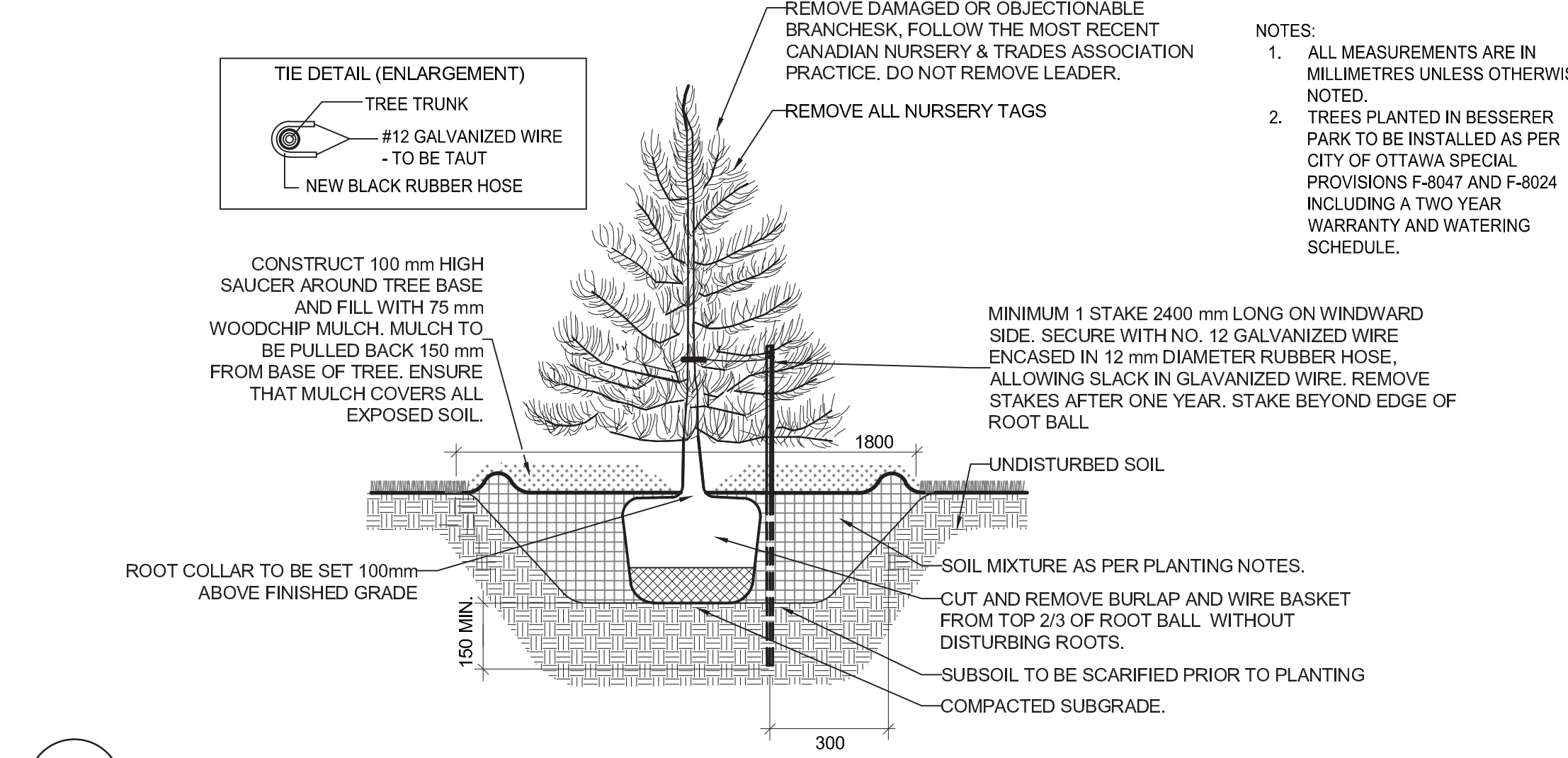
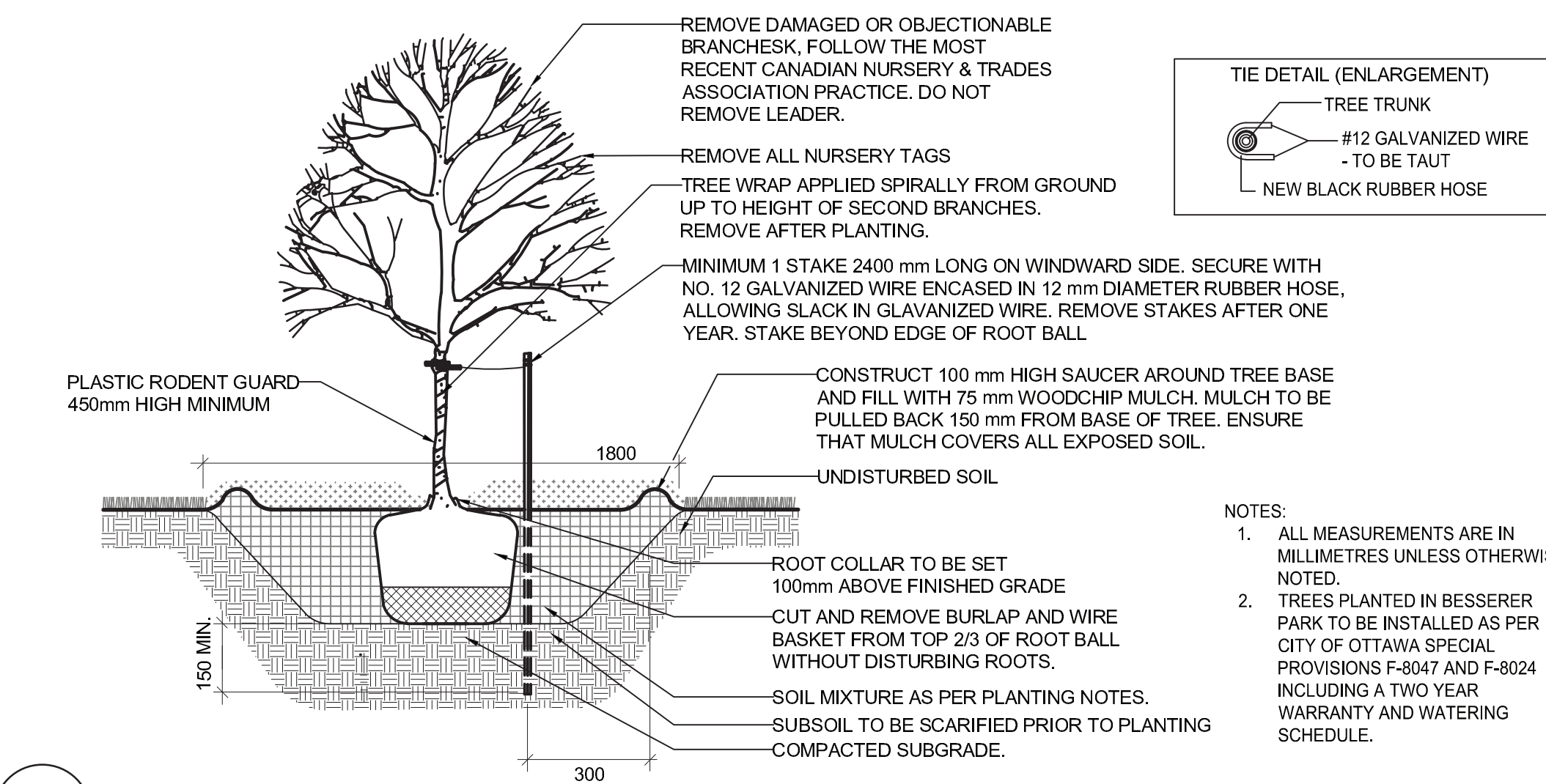

7	REVISED AS PER CITY COMMENTS	IL	IL	21.03.23
4	REVISED SITE PLAN	GM	IL	19.10.11
3	REVISED SITE PLAN	LZ	IL	18.10.26
2	REVISED SITE PLAN	IL	IL	17.01.23
1	ISSUED TO SITE PLAN CONTROL APPROVAL	BD	IL	16.10.19
Revision		By	Appd.	YY.MM.DD
File Name: 160401234-LB		BD	IL	IL
		Dwn.	Chkd.	Dign.
				YY.MM.DD

Permit-Seal



Client/Project  
**TC UNITED GROUP**

244 FOUNTAIN PLACE

OTTAWA, ON

Title  
**LANDSCAPE DETAILS**

Project No.	Scale	Revision
160401234	VARIES	
Drawing No.	Sheet	Revision
L103	2of 2	7