

- GENERAL NOTES:**
- It is the responsibility of the appropriate contractor or official to report any errors, omissions or discrepancies on this plan with actual site conditions to the Landscape Architect before proceeding with construction.
  - The contractor is to notify all utility companies and authorities prior to any excavation and ascertain locations of underground services.
  - The contractor is to reinstate all areas and items damaged as a result of construction activity.
  - The contractor is to comply with all pertinent codes and by-laws.
  - The contractor is to maintain a positive surface run-off throughout the entire construction period.
  - The Landscape Architect is not responsible for subsurface conditions.
  - The contractor is to identify all existing trees to remain on site with the Landscape Architect prior to construction.
  - The contractor is to stake the proposed location of all plant material in conjunction with the Landscape Architect prior to excavation.
  - Minimum distances for selected deciduous trees are as follows:
    - Building Foundations 7.5m
    - Sidewalks 1.5m
    - Public Streets 2.5m
    - Underground Infrastructure 2.0m
  - All trees within 1m of underground utility trenches are to be excavated by hand.
  - Remove all protective wrapping from tree trunks after installation.
  - Staking of trees shall only be performed if necessary.
  - Ensure that mulch is pulled back a min. distance of 75mm from base of tree trunk.

#### EXISTING TREE LIST

KEY	qty	BOTANICAL NAME	COMMON NAME	SIZE	CONDITION	REMARKS
TREES						
AN	*	Acer negundo	Manitoba Maple	100-300mm DBH	GOOD	See Plan
AP	*	Acer platanoides	Norway Maple	100-500mm DBH	POOR-GOOD	See Plan
AS	*	Acer saccharum	Sugar Maple	250mm DBH	GOOD	See Plan
CK	2	Acer platanoides 'Crimson King'	Crimson King Maple	450-500mm DBH	GOOD	See Plan
PG	3	Picea glauca	White Spruce	350-400mm	POOR-FAIR	See Plan
RC	*	Rhamnus cathartica	Common Buckthorn	100-200mm DBH	FAIR-GOOD	See Plan
TF	1	Thuja occidentalis 'Fastigiata'	Pyramidal White Cedar	150mm DBH	GOOD	See Plan
TO	2	Thuja occidentalis	Eastern White Cedar	100-200mm DBH	FAIR-GOOD	See Plan
UA	3	Ulmus americana	American Elm	100-150mm DBH	POOR-FAIR	See Plan
UP	*	Ulmus pumila	Siberian Elm	100-850mm DBH	POOR-GOOD	See Plan

#### PROPOSED PLANT LIST

KEY	qty	BOTANICAL NAME	COMMON NAME	SIZE	CONDITION	REMARKS
SHRUBS						
AH	26	Hydrangea arborescens 'Annabelle'	Annabelle Hydrangea	3 gal. pot	Potted	800 mm o.c.
AW	10	Spiraea x bumalda 'Anthony Waterer'	Anthony Waterer Spiraea	600mm ht.	Potted	1000 mm o.c.
DW	8	Cornus sericea	Red Osier Dogwood	800mm ht.	Potted	1200 mm o.c.
GS	11	Spiraea x arguta	Garland Spiraea	800mm spr.	Potted	1000 mm o.c.
JT	8	Juniperus sabinina 'Tamariscifolia'	Tamarix Juniper	600 mm spr.	Potted	800 mm o.c.
MP	5	Pinus mugo 'Pumilio'	Dwarf Mugo Pine	800mm spr.	Potted	800mm o.c.
RR	25	Rosa rugosa	Rugosa Rose	800 mm ht.	Potted	1200 mm o.c.
SS	15	Sorbaria sorbifolia 'Sem'	Sem False Spiraea	600mm ht.	Potted	800 mm o.c.
PERENNIALS & ORNAMENTAL GRASSES						
DL	22	Hemerocallis 'Stella D'Oro'	Stella D'Oro Day Lily	150mm pot	Potted	300 mm o.c.
DL2	15	Hemerocallis 'Dad's Best White'	Dad's Best White Daylily	150mm pot	Potted	400 mm o.c.
GC	12	Hemerocallis 'Joan Senior'	Joan Senior Daylily	150mm pot	Potted	400 mm o.c.
KF	27	Calamagrostis 'Karl Foerster'	Karl Foerster Grass	250mm pot	Potted	800 mm o.c.
PA	28	Pennisetum alopecuroides 'Little Bunny'	Little Bunny Dwarf Fountain Grass	100mm pot	Potted	450 mm o.c.
RG	34	Phalaris arundinacea 'Strawberries & Cream'	Strawberries & Cream Ribbon Grass	250mm pot	Potted	600 mm o.c.
YG	8	Yucca glauca	Spanish Bayonet	3 gal. pot	Potted	800 mm o.c.

#### PROPOSED PLANT LIST

KEY	qty	BOTANICAL NAME	COMMON NAME	SIZE	CONDITION	REMARKS
TREES						
AC	2	Amelanchier canadensis 'Single-Stem'	Single-Stem Serviceberry	60mm cal.	B&B	Single leader
AM	3	Acer ginnala	Amur Maple	60mm cal.	B&B	
HL	1	Clethra alnifolia 'Draves'	Steeplekeeper Honeylocust	60mm cal.	B&B	
JL	4	Syringa reticulata	Japanese Tree Lilac	60mm cal.	B&B	
PO	1	Picea omorika	Serbian Spruce	1.8m ht.	B&B	
QR	3	Quercus rubra	Northern Red Oak	60mm cal.	B&B	
SM	3	Acer saccharum	Sugar Maple	60mm cal.	B&B	

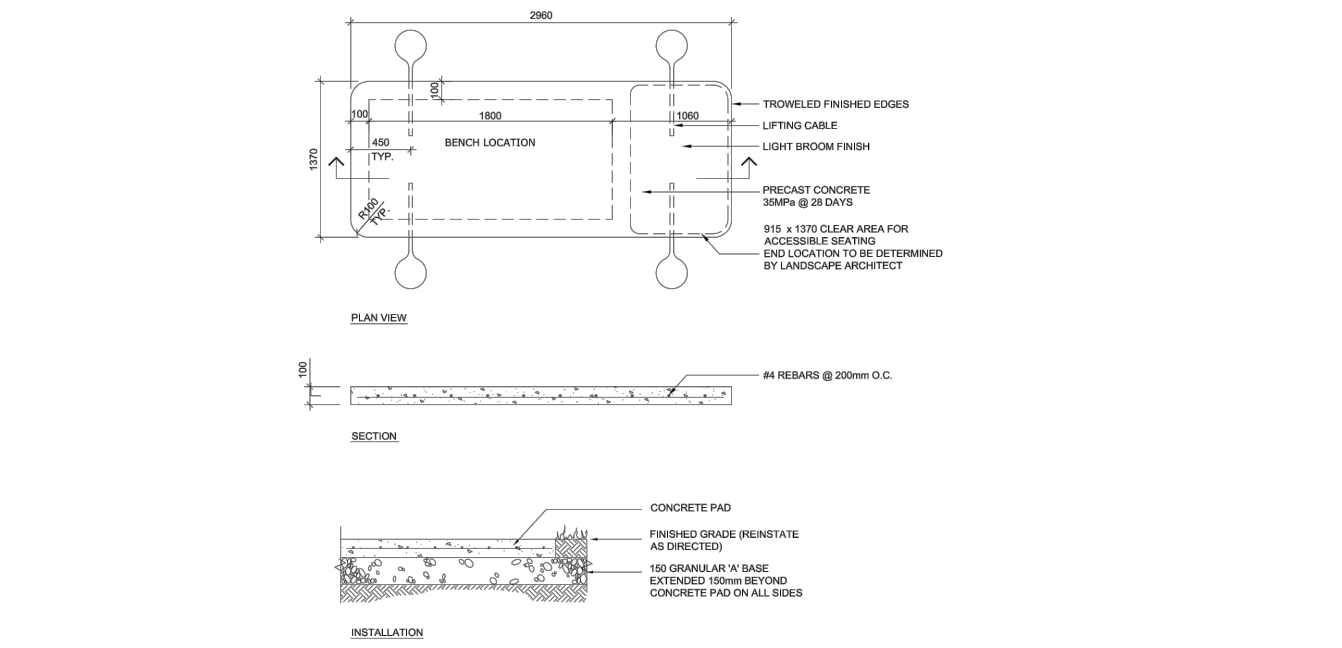

#### ACCESSIBLE CONCRETE PAD FOR BENCHES

SCALE: NTS

#### 1 TREE CONSERVATION REPORT & LANDSCAPE PLAN

SCALE: 1:250

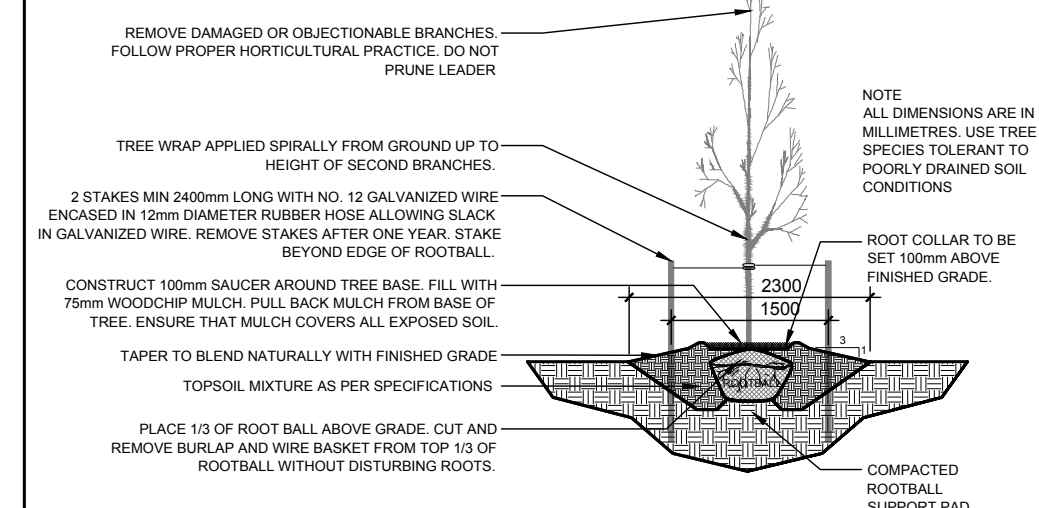

#### 2 DECIDUOUS TREE PLANTING

SCALE: NTS

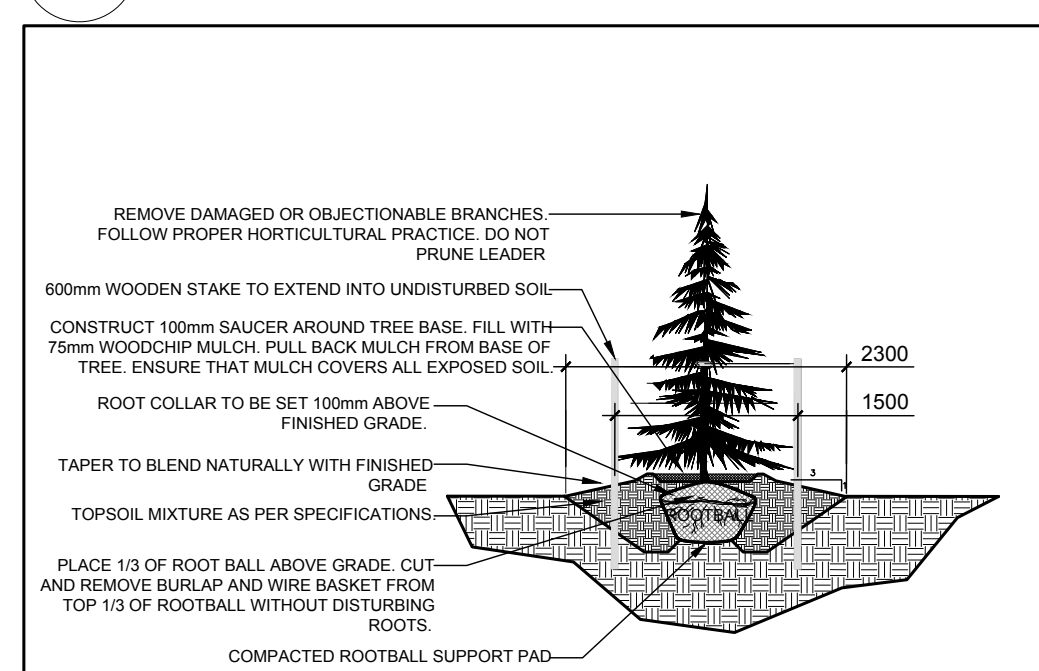

#### 3 CONIFEROUS TREE PLANTING

SCALE: NTS

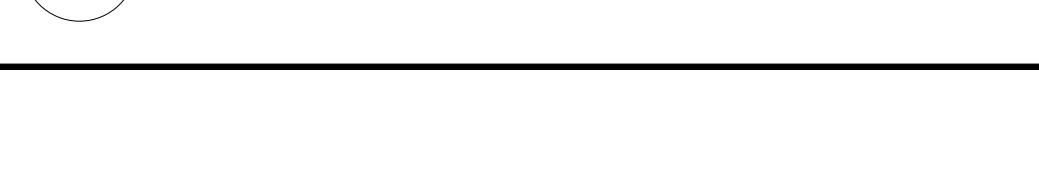

#### 4 SHRUB / PERENNIAL / ORNAMENTAL GRASS PLANTING

SCALE: NTS

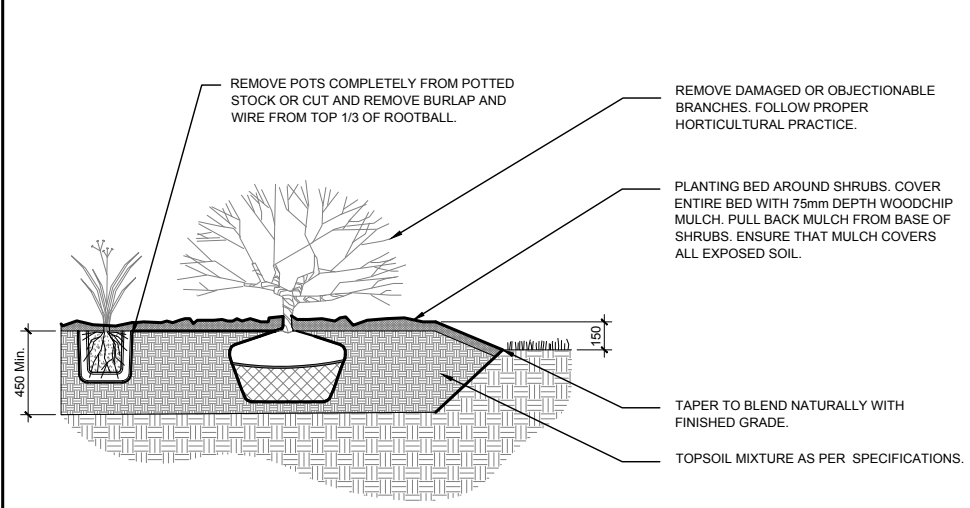

#### 5 TREE PROTECTION FENCE

SCALE: NTS

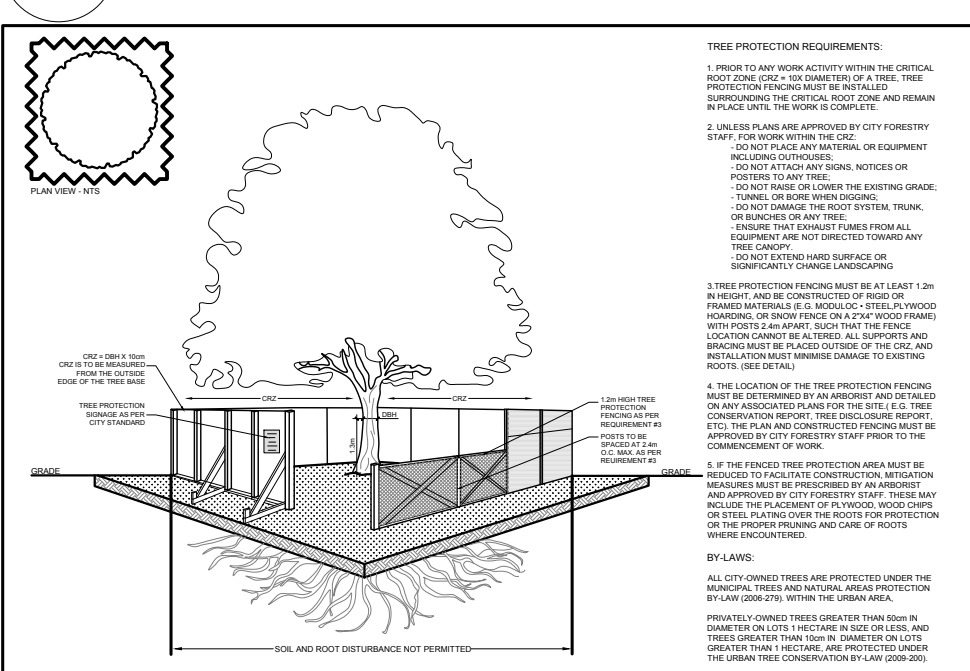

#### 6 1.5m Ht. ORNAMENTAL METAL FENCE

SCALE: NTS

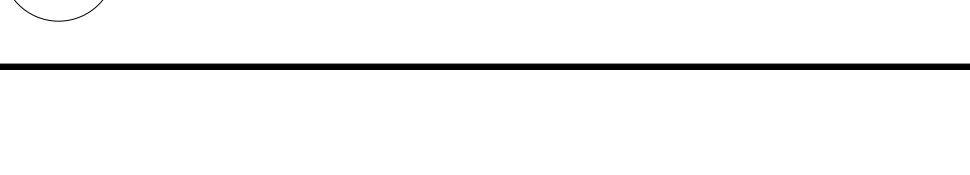

#### 7 LIGHT DUTY WALKWAY CONCRETE PAVING

SCALE: NTS

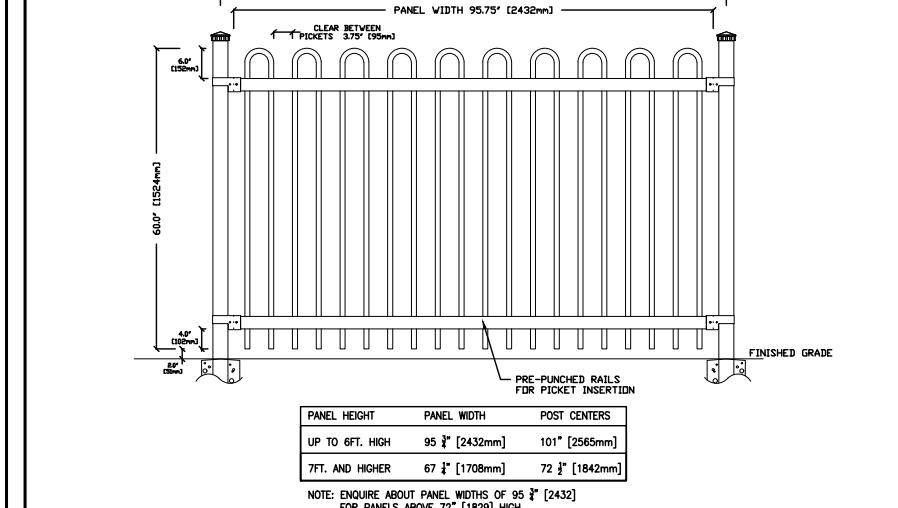

#### 8 WASTE RECEPTACLE CONCRETE BASE

SCALE: NTS

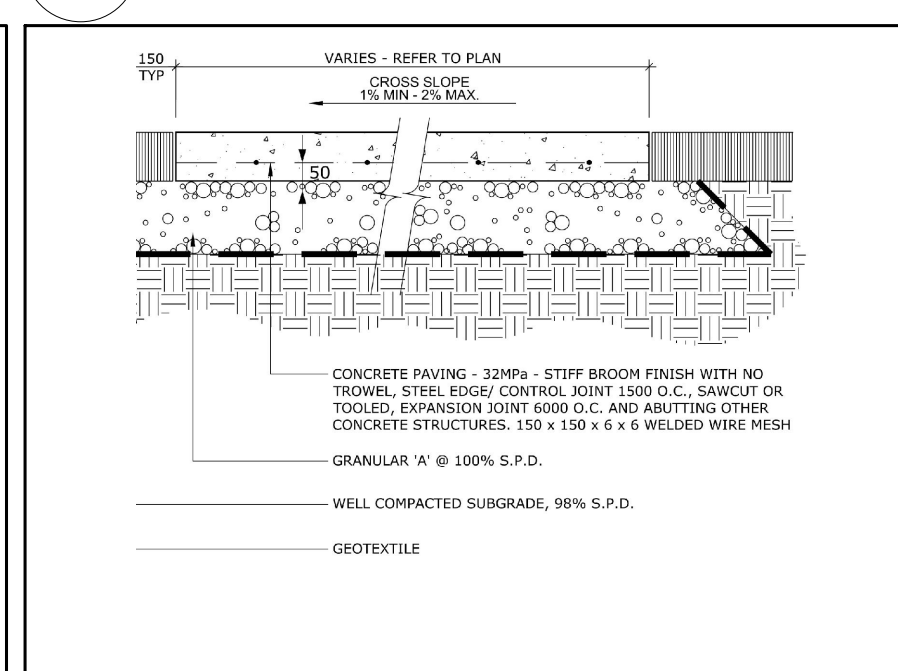

#### 9 1.5m Ht. WOOD PRIVACY FENCE

SCALE: NTS

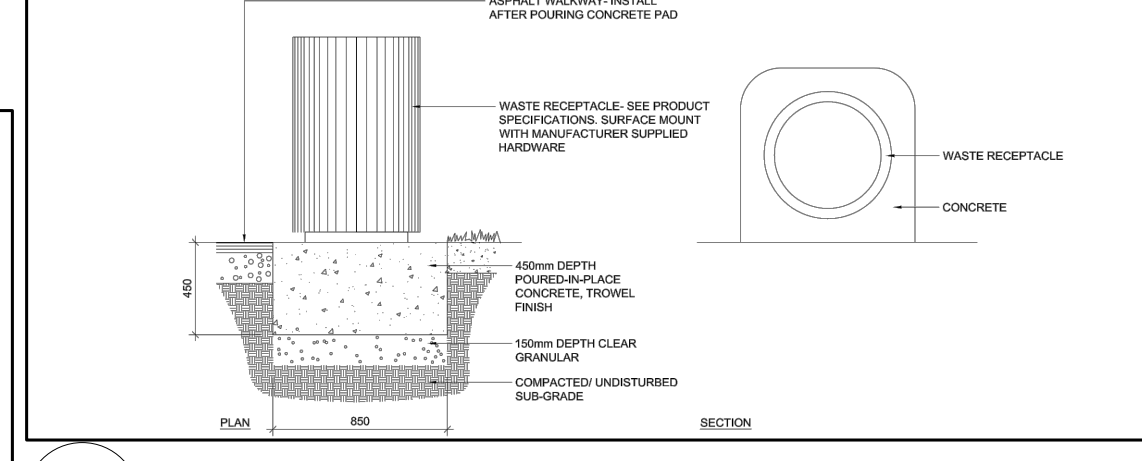
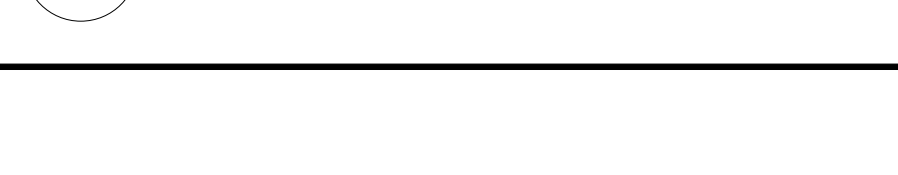

#### 10 ACCESSIBLE CONCRETE PAD FOR BENCHES

SCALE: NTS

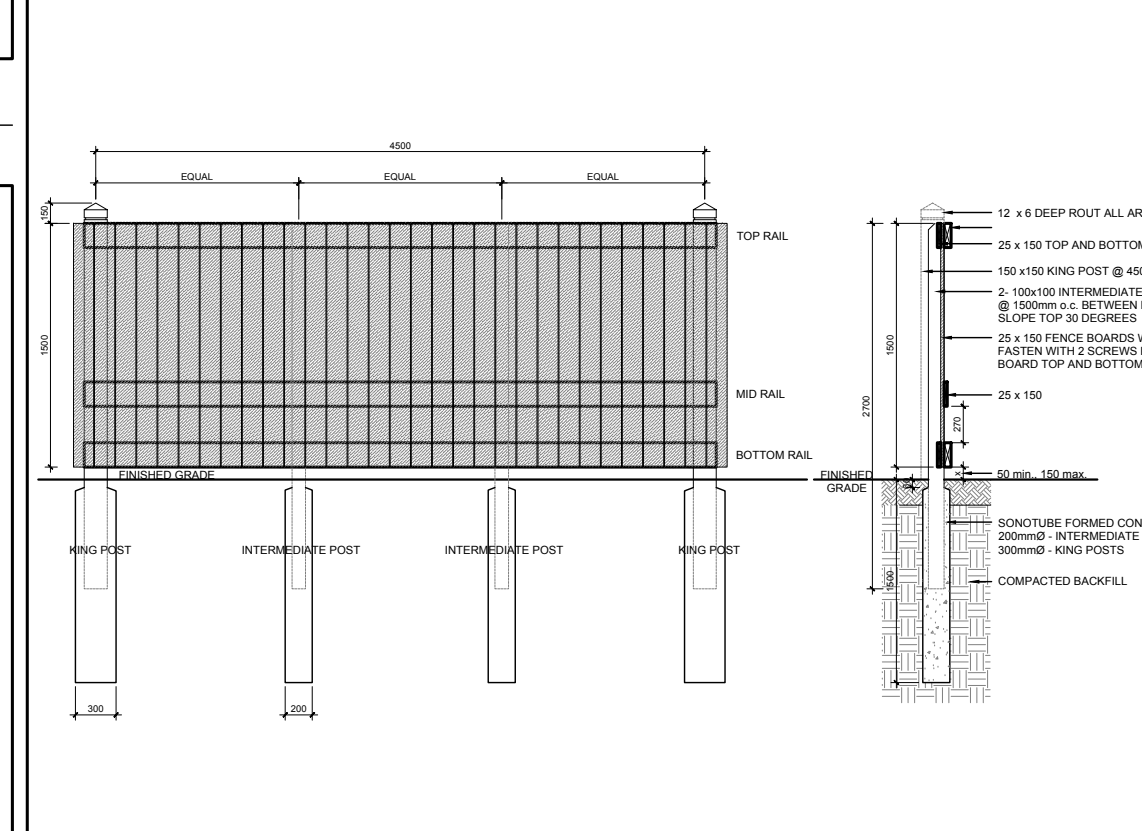

#### 11 1.5m Ht. WOOD PRIVACY FENCE

SCALE: NTS

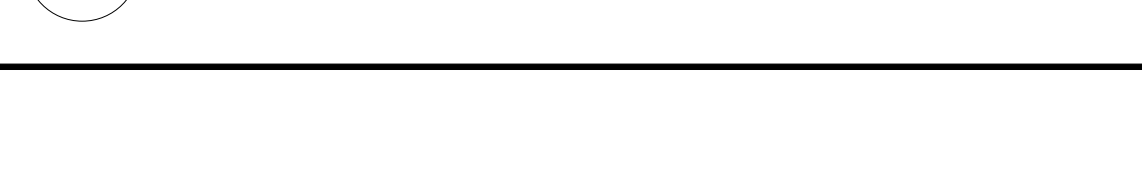

CLIENT: **ROSE PARK**  
RETIREMENT COMMUNITY

CONSULTANTS

ARCHITECTS: **NEUF ARCHITECTS**  
6630, BOUL. RENÉ-LEVESQUE O. 32E ÉTAGE, MONTRÉAL, QC  
Tél. (514) 967-1117

SURVEYORS: **ANNIS O'SULLIVAN VOLLEBECK LTD.**  
14, CONDOURSE GATE, SUITE 500, NEPEAN, ON  
Tél. (613) 727-0850

CIVIL ENGINEERS: **NOVATECH ENG. CONSULTANTS LTD.**  
240, MICHAEL COWPLAND DRIVE, SUITE 200, OTTAWA, ON  
Tél. (613) 933-9943

LEGEND

- EXISTING TREE TO REMAIN
- GROUP OF EXISTING TREES / HEDGE TO REMAIN
- EXISTING TREE TO BE REMOVED
- GROUP OF EXISTING TREES TO BE REMOVED
- PROPOSED DECIDUOUS TREE
- PROPOSED CONIFEROUS TREE
- PROPOSED SHRUBS / PERENNIALS / ORNAMENTAL GRASSES
- PROPOSED PRECAST CONCRETE PAVERS
- PROPOSED RIVERSTONE MULCH
- PROPOSED SODDED GRASS AREA
- PROPOSED TREE PROTECTION FENCE
- PROPOSED 1.5m HT. ORNAMENTAL METAL FENCE
- PROPOSED WOOD BOARD FENCE (REFER TO PLAN FOR HEIGHT)
- PROPOSED WASTE RECEPTACLE
- PROPOSED BENCH

PROJECT: **CARLING RETIREMENT HOME & RENTAL**  
1705 CARLING AVENUE, OTTAWA ON

DRAWING: **TREE CONSERVATION REPORT & LANDSCAPE PLAN**

STAMP: **ASSOCIATION OF LANDSCAPE ARCHITECTS**  
MEMBER

SCALE: **AS SHOWN**

START DATE: **OCTOBER 2020**

PROJECT NO.: **20CLG2003**

PROJECT NORTH

DRAWING NO.: **L.1**

PLOT SIZE ARCH-D